

Il Colonnato  
Minera stone  
dining table Ø165  
5 legs,  
by Mario Bellini

# Minera stone dining table

Ø165  
5 legs

Designer  
Mario Bellini

Collection  
Il Colonnato

Reference  
KSA1-009-00

1/2

In this project, Mario Bellini took his inspiration from a basic elemental structure in architecture. His design emulated the colonnade of classical architecture, in which a sequence of columns supports a portico, in this case a table top. The base is a visually closed volume, despite being materially open. When seen from a different viewpoint, perception changes completely, as the columns no longer overlap and the space appears empty.

cm/inch

76,2/30  
73,7/29

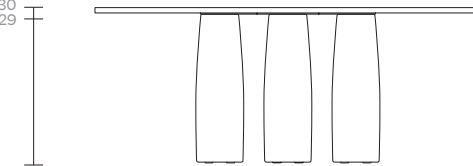

cm/inch

Ø165/64,9

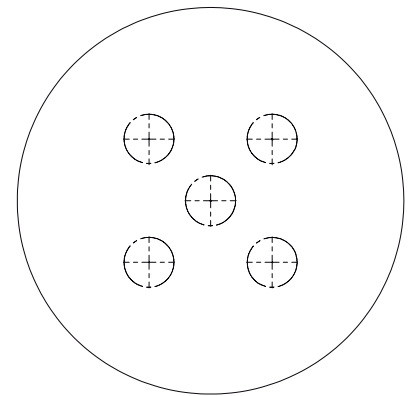

34,9  
/13,7



# Minera stone dining table Ø165 5 legs

Designer  
Mario Bellini

Collection  
Il Colonnato

Reference  
KSA1-009-00

2/2

## Materials

---

Minera Stone  
Water repellent

## Other Characteristics

---

 Adjustable Legs

## Colour Options

---

## Minera Stone

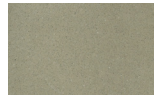

Antique Rose  
MI3



Atlas  
MI4



Red Fort  
MI6

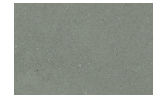

Stoneware  
MI7

## Maintenance

---

Clean with mild soap using sponge or cloth. Be gentle while cleaning, do not scrub aggressively the fabric. Once cleaned please make sure you remove soap excess.

In case of aggressive stains clean with diluted household bleach.

Clean stains promptly. The longer it remains, more difficult will be to remove.

Once cleaned the fabric steam iron the fabric. Just use steam, be carefull NOT placeing the iron directly in the fabric it will get damage.