

# Euclide

design : F. Rota



Series composed of cabinets, low cabinets and bookshelves.

**Case:** fiberboard veneered and finished Mano Opaca.

**Back panel and sliding doors:** in aluminium finished Mano Lucida or matt laquered or in extra-light transparent tempered glass.

**Notes:** trays in fibreboard finished Mano Lucida, which can be positioned as desired, complete the series.

ante scorrevoli in vetro / sliding glass doors

B162AV

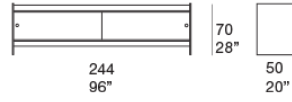

anta scorrevole in legno / sliding wooden door

B162AL

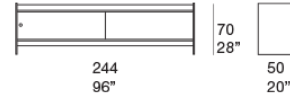

B162BL

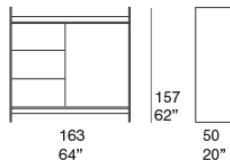

2 ante scorrevoli / two sliding doors

B162CL

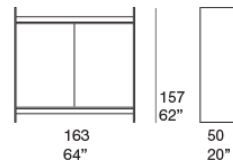

Libreria / bookshelf

B162D

