

1	AS-00002216-	Cutting Head SUB-Assy.	1
2	AS-00002215-	Rocker Arm SUB-Assy	1
3	AS-00002217-	Slide EXT.Assy.	1
4	MA-00001082-	Handle Flat Head Screw	4
5	TU-00001087-	Bronze Bushing	1
6	MA-00001088-	Compression Spring	1
7	MA-00001047-	Retaining Ring	4
8	TU-00001089-	Shaft-Trigger	2
9	CA-00001008-	Triger Sand Casting	1
10	MA-00001090-	Pillar Plst Knob	1
11	MA-00001211-	t=0.05mm SS	0~3
	MA-00001212-	t=0.10mm SS	0~3
	MA-00001214-	t=0.15mm SS	0~3
Item	ERP No.	Description	Qty

MODEL NO.	DWG NO.
P327	AS-00002218-00
TITLE:	
FSC Cutting Head Final Assy.	

ITEM	DESCRIPTION	PART No.	QTY
1	CLAMP ASSEMBLY	17-xxx	1
2	VERTICAL TRACK SUB-ASSEMBLY	17-xxx	1
3	CLAMP LEVER ASSEMBLY	17-xxx	1
4	CLAMP YOKE ASSEMBLY	17-xxx	1
5	BRONZE SHOULDER BUSHING	17-xxx	4
6	PIVOT ARM (WITH SLOT)	17-xxx	2
7	ECCENTRIC BOLT	17-xxx	2
8	M4 X 5mm SET SCREW	17-xxx	4
9	M6 X 16mm FLAT HEAD SCREW	17-xxx	2
10	RETAINING RING	17-xxx	2
11	LEVER PIVOT	17-xxx	1
12	4.3mm DIA. X 25mm LG SPLIT PIN	17-xxx	1
13	PIVOT SHAFT	17-xxx	1
14	M6 X 20mm SOCKET HEAD CAP SCREW	17-xxx	2
15	M10 FLAT WASHER	17-303	4
16	M10 LOCK WASHER	17-xxx	4
17	M10 X 25mm HEX HEAD BOLT	17-302	4
18	ECCENTRIC LOCKING BLOCK	17-xxx	2
19	PIVOT ARM SHAFT	17-xxx	2

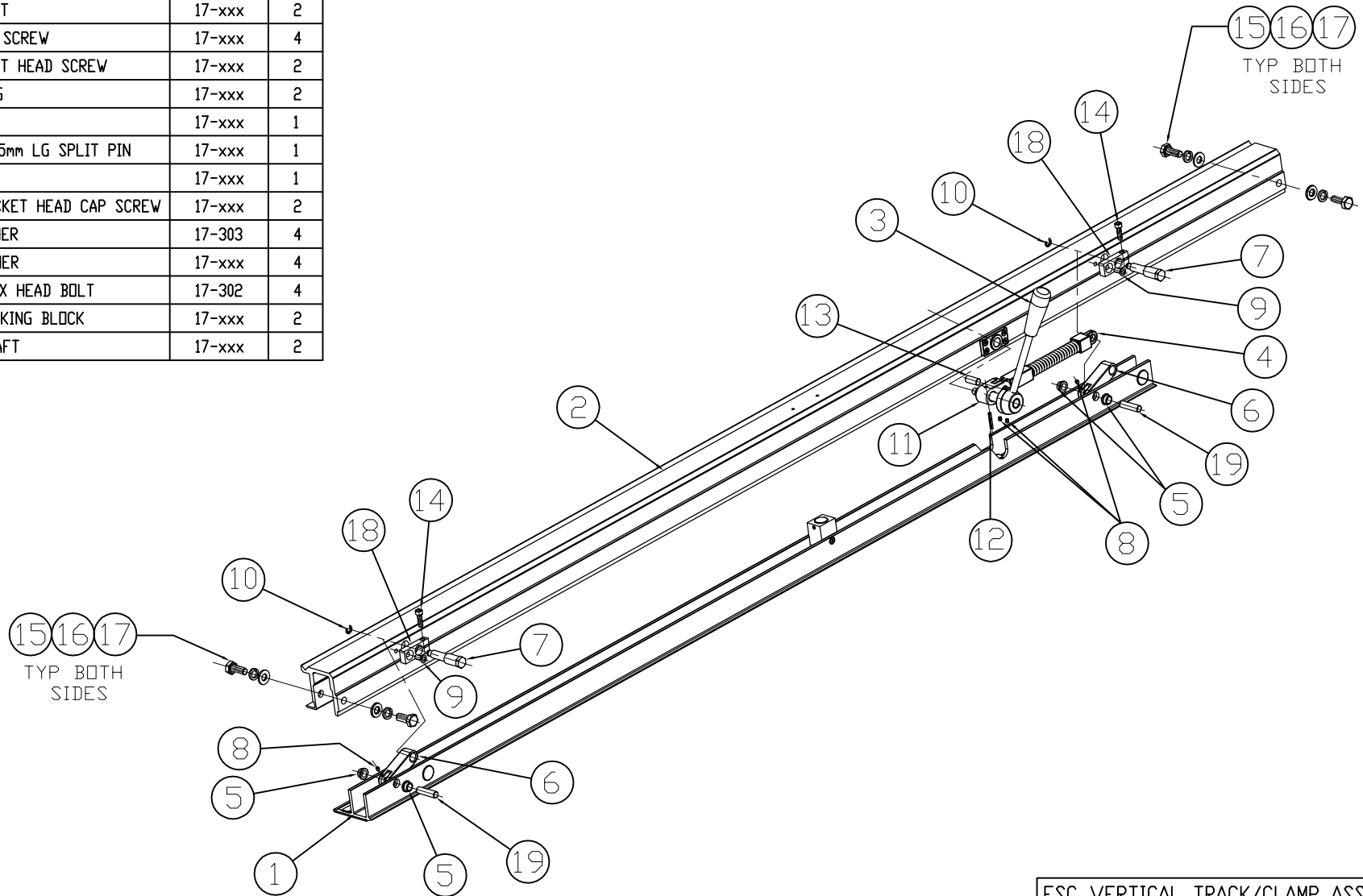

FSC VERTICAL TRACK/CLAMP ASSEMBLY