



**PACKAGE CONTENTS:**

Trike Deck - (21325)	slotted wheel stop- (21331) and (21332)
Ramps (2) - (21315)	front wheel stop- (21336)
1" dia ext pipe - (21329)	quick pin (6)- (11358)
3/4" dia ext pipe- (21330)	5/16 x 3/4 bolt (6)- (12128)
1" dia round bar- (15265)	5/16 lock washer (6)- (12304)
stabilizer foot (2)- (15261)	5/16 nut (6)- (12305)
wheel stop (2)- (15546)	

**3-WHEELED CYCLE ATTACHMENT**  
**Part Number 21300**

**Assembly Instructions:**

1. Remove contents from packaging and check for any broke or missing pieces.
2. Remove original ramp from end of air lift.
3. Center the 3-Wheeled Cycle Ext. (21325) over the end of the lift.
4. Insert extension pipes (21330) and (21329) in there corresponding holes. Use quick pins (11358) in both ends of each pipe.
5. Insert 1" solid bar (15265) through foot tube on air lift, slide stabilizer feet (15261) on each end of solid bar. Use quick pins (11358) on both ends of the bar to secure feet in place.
6. Bolt on wheel stops(15546) and (21336) with supplied 5/16" bolts, washer and nuts.
7. Insert original air lift ramp, and new extension ramps (21315) into the provided slots at the back of the trike deck.

**Warning: It is the users responsibility to make sure all quick pins, and wheel stops are in place before attempting to load a trike onto the lift. Never leave motorcycle/trike unattended on the lift. Always secure motorcycle/trike with tie-downs.**

**Note: When loading a "spyder" it will need to be backed onto the lift. Depending on rear tire width, the CV-17 cycle vise may not work, in which case the vise will need to be removed and the provided wheel stop (21336) will need to be bolted on the front of the lift top.**

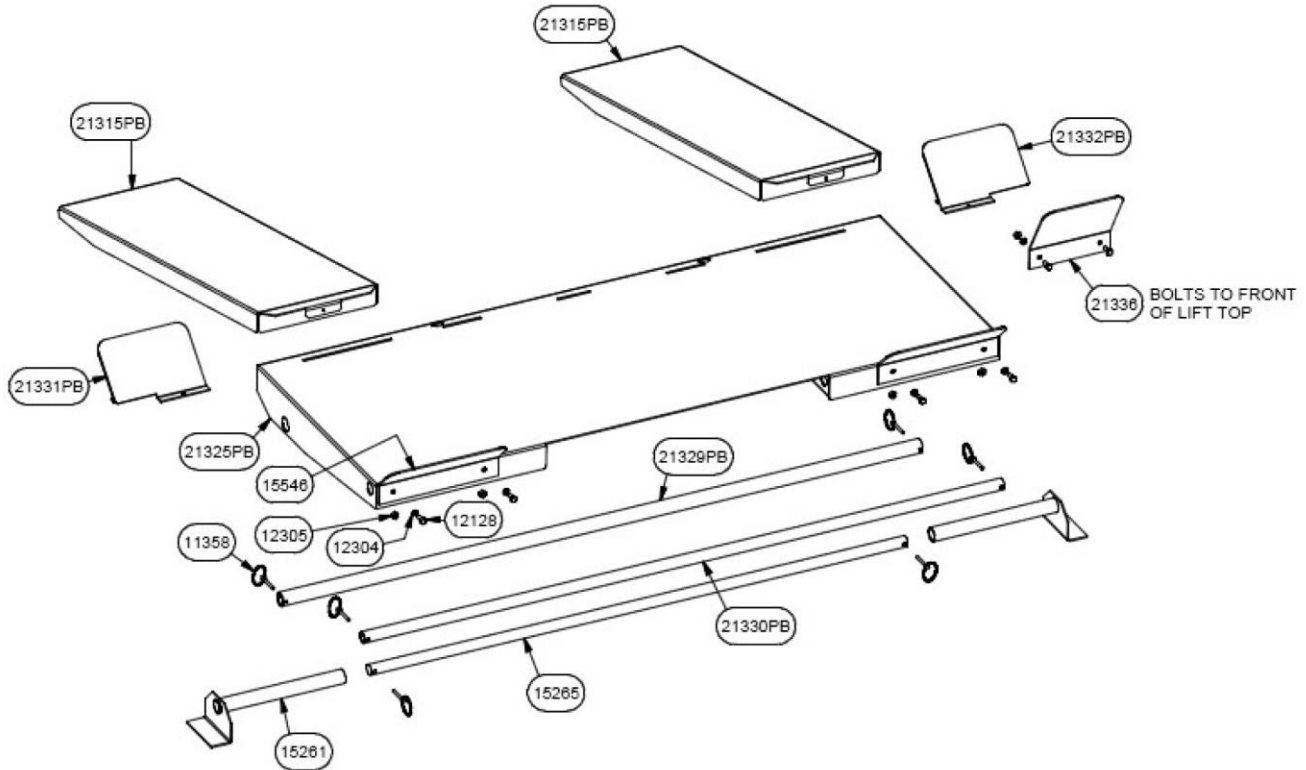

QTY	PART NO.	DESCRIPTION	QTY	PART NO.	DESCRIPTION
6	11358	PIN QUIK 250-1 4 QP	2	21315PB	SIDE EXT RAMP ASSY
6	12128	SCREW 5/16-18 X 3/4 HHCS GRADE	1	21325PB	TRIKE DECK ASSY
6	12304	WASHER 5/16 SPLIT LOCK	1	21329PB	EXT PIPE 1" X 63-1/2"
6	12305	NUT 5/16-18 HEX PLATED ZINC GR5	1	21330PB	EXT PIPE 3/4" X 63-1/2"
2	15261	ASSY SWIVEL STABILIZER PTD BLACK	1	21331PB	WHEEL STOP RH
1	15265	SHAFT STABILIZER 53.25 PTD BLACK	1	21332PB	WHEEL STOP LH
2	15546	WHEEL STOP TRIKE BOB	1	21336	FRONT WHEEL STOP