



BASIC TRAINING SERIES PREACHER CURL
No. 54031 WHITE 55031 SILVER

CHECK ITEM QTY DESCRIPTION

| | | |
|----|----|------------------------------|
| 1 | 1 | Seat Pad |
| 2 | 1 | Seat Pad Frame |
| 3 | 4 | 5/16" Lockwasher |
| 4 | 4 | 5/16" Flatwasher |
| 5 | 2 | 5/16"x1-3/4" Bolt |
| 6 | 1 | 2"x2"Finishing Cap |
| 7 | 1 | Pop Pin/Locking Pin |
| 8 | 1 | Seat Base Frame |
| 9 | 1 | Left Upright Frame |
| 10 | 4 | 1/2" x 3-1/8"Bolt |
| 11 | 14 | 1/2" Flatwasher |
| 12 | 6 | 1/2"x1-3/8" Bolt |
| 13 | 2 | Base Frame |
| 14 | 4 | 4-7/16"x 2-1/2" Foot Pads |
| 15 | 1 | Left Bar Holder |
| 16 | 8 | 3/8"x1" Alien Flat Head Bolt |
| 17 | 1 | Arm Pad |
| 18 | 1 | Pad Mount Frame |
| 19 | 2 | 5/16x2-3/8" Bolt |
| 20 | 1 | Right Bar Holder |
| 21 | 1 | Right Upright Frame |
| 22 | 6 | 1/2" Lockwasher |
| 23 | 4 | 1/2" Nylon Locknuts |
| 24 | 1 | Warranty Card |
| 25 | 1 | Serial # Sticker |
| 26 | 1 | Hardware Card |
| 27 | 1 | Large York Decal |
| 28 | 1 | Warning Label |
| 29 | 1 | Assembly Instruction |

Rev. 08/08/2007

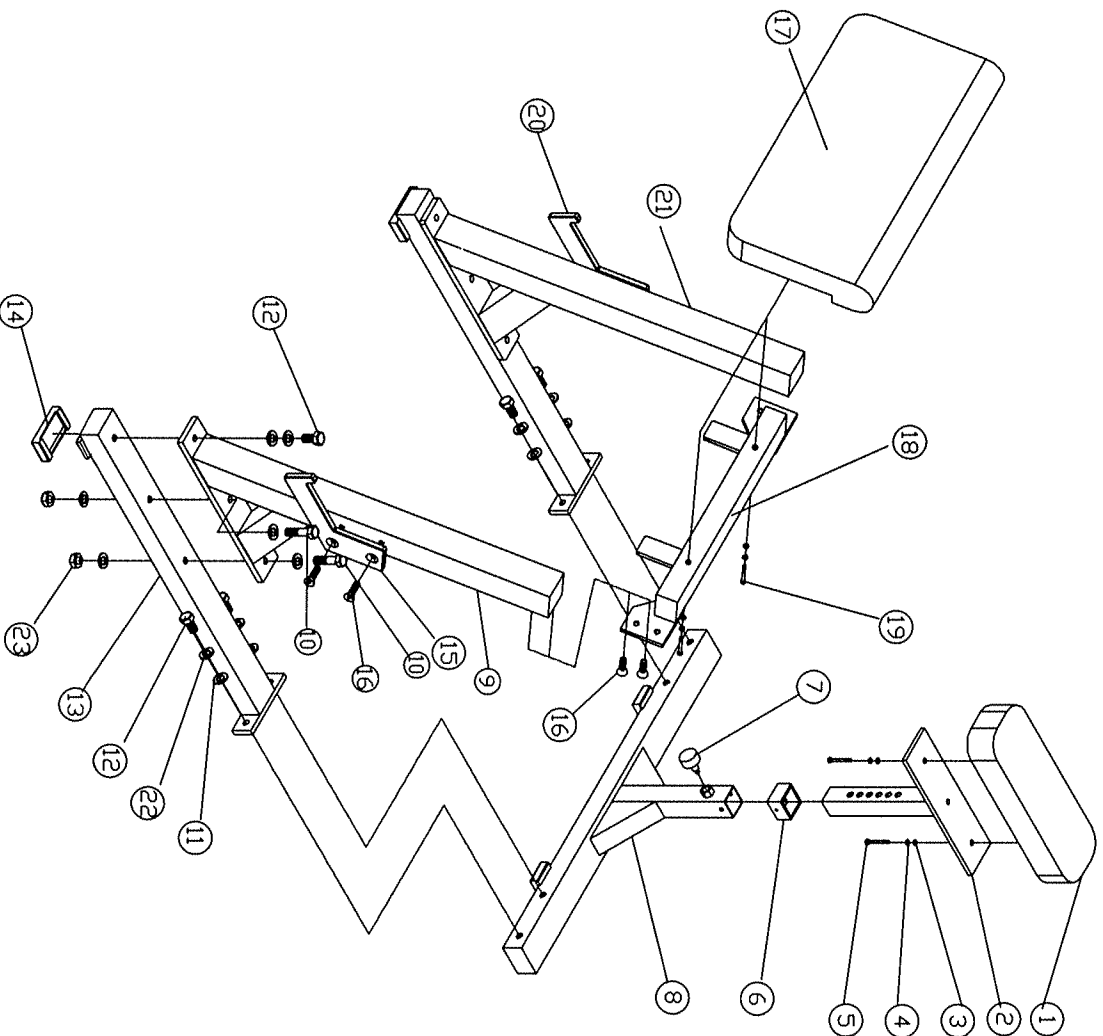

**IF PARTS ARE MISSING, DO NOT CALL THE STORE WHERE YOU PURCHASED THIS ITEM - THEY DO NOT STOCK PARTS.
 PLEASE CONTACT YORK BARBELL CUSTOMER SERVICE AT (800)358-9675 OR (717)767-6481