



Cordless Grass Trimmer Lawn Edge Operator's Manual



WARNING:

Read carefully and understand all **INSTRUCTIONS** before operating. Failure to follow the safety rules and other basic safety precautions may result in serious personal injury. Save these instructions in a safe place and on hand so that they can be read when required. Keep these instructions to assist in future servicing.

SYMBOLS



Warning, safety alert.



Read and follow all safety precautions in the owner's manual.



Protective goggles/visor, protective helmet & hearing protection.



Do not expose to rain.



Beware of thrown or flying objects to bystanders. Keep bystanders a safe distance away from the machine.



Thrown objects can ricochet and result in personal injury or property damage. Wear protective clothing and boots.



Beware of falling objects. Keep bystanders away.

SAFETY INSTRUCTIONS

General Safety Instructions

WARNING

Read all safety warnings and all instructions.

Failure to follow the warnings and instructions may result in electric shock, fire and/or serious injury.

CORDLESS HEDGE TRIMMER SAFETY WARNINGS

1. Keep all parts of the body away from the cutter blade. Do not remove cut material or hold material to be cut when blades are moving. Make sure the product is switched off when clearing jammed material. A moment of inattention while operating the product may result in serious personal injury.
2. Carry the product by the handle with the cutter blade stopped. When transporting or storing the product always fit the cutting device cover. Proper handling of the product will reduce possible personal injury from the cutter blades.
3. Hold the product by insulated gripping surfaces only, because the cutter blade may contact hidden wiring of its own cord. Cutter blades contacting a "live" wire may make exposed metal parts of the product "live" and could give the operator an electric shock.
4. Check the hedge for foreign objects before operation, e.g., wire fences.
5. Hold the product properly, e.g., with both hands if two handles are provided. Loss of control can cause personal injury.

ADDITIONAL SAFETY WARNINGS



Read carefully before use.

Keep for future reference.

TRAINING

1. Read the instructions carefully. Be familiar with the controls and the proper use of the appliance.
2. Never allow children to use the product.
3. Never allow people unfamiliar with these instructions to use the appliance. Local regulations may restrict the age of the operator.
4. Never operate the appliance while people, especially children, or pets are nearby.
5. The operator or user is responsible for accidents or hazards occurring to other people or their property.

PREPARATION

1. Wear safety goggles and ear muffs while operating.
2. Always wear substantial footwear and long trousers. Do not operate the equipment when barefoot or wearing open sandals.
3. Always wear suitable working clothes during working, which allow freedom of movement.
4. Never operate the appliance which is damaged, incomplete or changed without approval of the manufacturer.

OPERATION

1. Disconnect the battery from the product:
 - Whenever you leave the product,
 - Before clearing a blockage,
 - Before checking, cleaning or working on the product,
 - If the product starts to vibrate abnormally.
2. Operate the product only in daylight or in good artificial light.
3. Do not overreach and keep your balance at all times.
4. Always be sure of your footing on slopes.
5. Walk, never run.
6. Keep all ventilation openings clear of debris.
7. Never blow debris in the direction of bystanders.

MAINTENANCE AND STORAGE

1. Keep all nuts, bolts and screws tight to be sure the product is in safe working condition.
2. Check the collection bag frequently for wear or deterioration.
3. Replace worn or damaged parts.
4. Store the product only in a dry place.
5. Use only spare parts and accessories approved by the manufacturer.

Residual risks

Even if you are operating this product in accordance with the provisions, residual risks will always still remain. The following dangers can arise in connection with the structure and design of this product:

1. Health defects resulting from vibration emission if the product is being used over longer period of time or not adequately managed and properly maintained.
2. Injuries and damage to property to due to broken accessories or hidden objects that are suddenly dashed.
3. Injuries and damage to property to due to thrown and fallen objects.

⚠️ WARNING

This product produces an electromagnetic field during operation! This field may under some circumstances interfere with active or passive medical implants! To reduce the risk of serious or fatal injury, we recommend persons with medical implants to consult their physician and the medical implant manufacturer before operating this product!

Vibration and noise reduction

To reduce the impact of noise and vibration emission, limit the time of operation, use low-vibration and low-noise operating modes as well as wear personal protective equipment.

Emergency

Familiarise yourself with the use of this product by means of this instruction manual. Memorise the safety directions and follow them to the letter. This will help to prevent risks and hazards.

1. Always be alert when using this product, so that you can recognize and handle risks early. Fast intervention can prevent serious injury and damage to property.
2. Stop the motor and disconnect the battery from the product if there is any malfunction. Have the product checked by a qualified professional and repaired, if necessary, before you put it into operation again.

PRODUCT SPECIFICATIONS

SKU	GUT083
Rated Voltage	20V DC
No Load Speed	8500rpm
Cutting Device	Trimfast blade
Cutting Swath Diameter	9.8"
Guaranteed Sound Power Level	93 dB(A)

ASSEMBLY

⚠️ WARNING

Remove the battery pack before cleaning or maintaining the tool, fitting the plant guard before making any adjustments to the tool, especially around the string head. Remove battery pack before transporting or storing the tool.

Attaching or Replacing Blade

Place the wider eyelet of cutting blade over the metal stud and firmly pull until blade is completely seeded on stud.

Remove in opposite order.

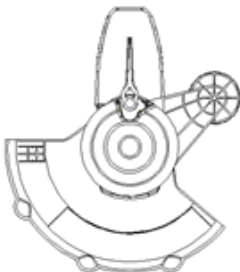

Fig.1

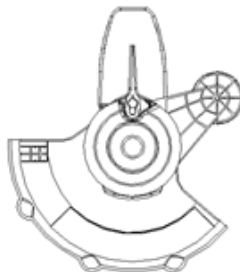

Fig.2

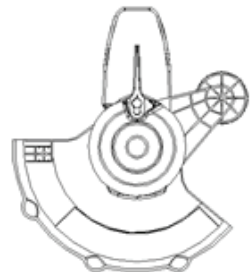

Fig.3

Fitting the guard

The guard is an essential part of the tool and must ALWAYS be used. Otherwise, damage to the trimmer and injury to the operator may occur. The guard is not fitted to the trimmer when it is delivered to you to avoid damage in transit.

Align the guard with the trimmer head as shown (Fig.4)

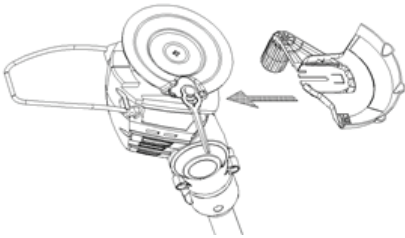

Fig.4

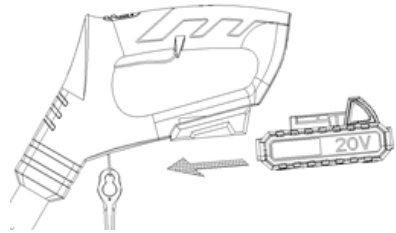

Fig.5

Fitting and Removing the battery



The battery should always be removed whenever you are not using the tool and especially when you are adjusting or transporting the tool to avoid accidental operation.

To insert the battery, slide it into the grass trimmer until it latches into place. Check that the battery is securely locked into place (Fig.5)

To remove the battery, press and hold the button on the two side of the battery pack and slide the battery away from the trimmer.

OPERATION



BEFORE OPERATING THIS TOOL, ENSURE THAT THE GUARD IS FITTED TO THE HEAD OF THE MACHINE. NEVER USE THE MACHINE WITHOUT THE GUARD.

Starting/Stopping the trimmer:

To switch the trimmer on, first push forward the unlock knob (1) then hold the switch handle (2), the trimmer is running. You can release the unlock knob.

To switch the trimmer off, release the switch handle. Be aware that the blade will continue to rotate for a short period.

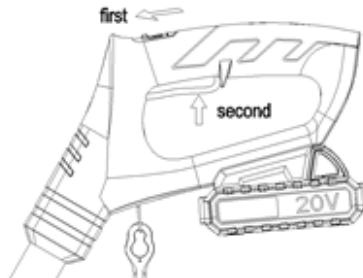

Fig.6

Adjusting Auxiliary Handle

The auxiliary handle (5) is height and angle adjustable. To adjustable the handle, first release the handle lock nut on the side of the handle. Rotation the auxiliary handle to desired position and slide the handle support to the desired height clamp in position. Tighten the lock nut.

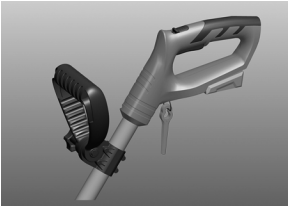

Fig.7

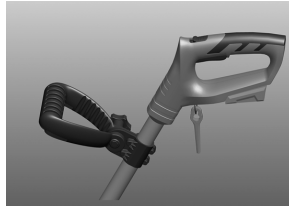

Fig.8



Fig.9

Setting The Trimmer Head Angle

The angle of trimmer head can be set to different working positions.

Press the angle adjustment button(15) with one hand and rotate the trimmer head to the required position. Release the button and the head will lock into place. There are 3 preset lock positions.

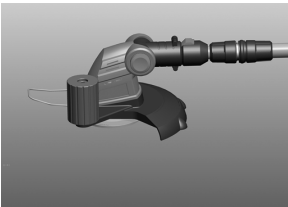

Fig.10

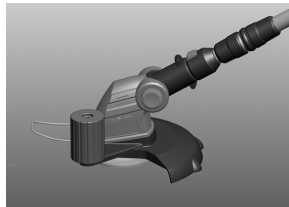

Fig.11



Fig.12

Setting The Handle Length

Turn the lock sleeve towards the 'unlock' symbol about half a turn. Slide the lower part of the trimmer up or down to the desired length. Lock it in position by turning the lock sleeve towards the 'lock' symbol.

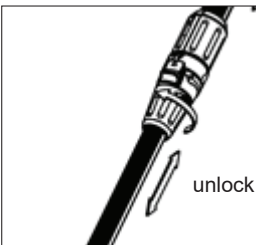

Fig.13

Trimming Mode

There are 2 working positions, for normal trimming (shown in Fig.14) and for edging (shown in Fig.15).

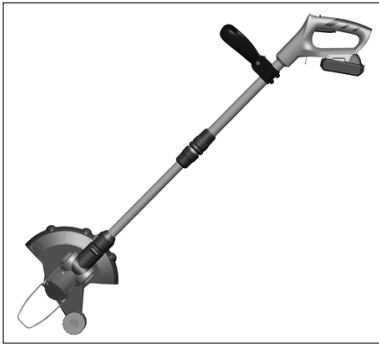

Fig.14



Fig.15

To use the trimmer in edging mode, as shown in Fig.16. Slide the lock sleeve and edging function button (10) and rotate the lower part of the trimmer 90° until the button aligns with the angle adjustment handle (11). Release the locking knob. Then setting the trimmer head angle as shown in FIG.10. The trimmer will lock into edging mode (Fig.15). Return to normal trimming mode as shown in Fig.17.

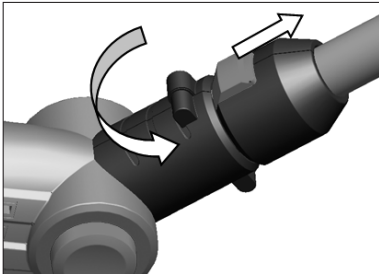

Fig.16

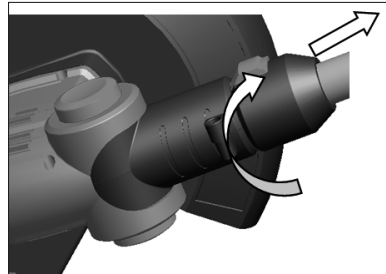

Fig.17

CHARGING PROCEDURE

⚠ WARNING

The battery pack is not fully charged at the factory. Before attempting to charge them, thoroughly read all the safety instructions.

1. To assure that the charger you use are applicable to the battery pack.
2. Plug the charger plug into the charging hole of the battery pack.
3. Plug the charger into any suitable standard outlet.
4. Let the battery pack charge initially for the green light is twinkled. If the power lights are all lighting, the battery pack is fully charged.

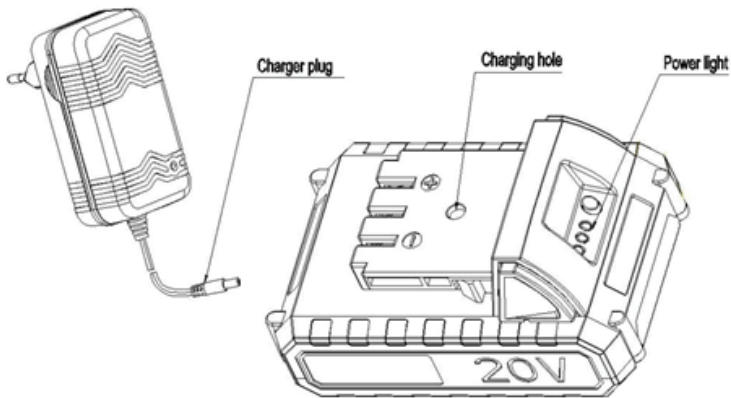

Recharge discharged batteries as soon as possible after use or battery life may be greatly diminished. For longest battery life, do not discharge batteries fully. It is recommended that the batteries be recharged after each use.

WARNING

Fire Hazard. When unplug the output plug from the charging hole, be sure to unplug the charger from the outlet first, then disconnect the charger output plug from the charging hole.

Important Charging Notes

1. Your tool was sent from the factory in an uncharged condition. Before attempting to use it, it must be charged.
2. CAUTION: To reduce the risk of damage to the batteries, NEVER charge them in an air temperature below 40°F (4.5°C) or above 105°F (40.5°C). Also, NEVER charge them if the battery temperature is below 40°F (4.5°C) or above 105°F (40.5°C). Longest life and best performance occur when batteries are charged with an air temperature of approximately 75°F (24°C). NOTE: The tool will not charge if the tool temperature is below approximately 32°F (0°C) or above 113°F (45°C).
3. While charging, the charger may hum and become warm to touch. This is a normal phenomenon and does not indicate a problem.
4. If the batteries do not charge properly—(1) Check current at receptacle by plugging in a lamp or other appliance. (2) Check to see if receptacle is connected to a light switch which turns power off when you turn out the lights. (3) Move charger and tool to a surrounding air temperature of 40°F (4.5°C) to 105°F (+40.5°C). (4) If the receptacle and temperature are OK, and you do not get proper charging, please send the tool and charger to us.
5. The tool should be recharged when it fails to produce sufficient power on jobs which were easily done previously. Battery life may be greatly diminished if batteries are discharged deeply. DO NOT CONTINUE using product with its batteries in a depleted condition. Recharge discharged batteries promptly.
6. To maximize battery life:
 - a. Do not fully discharge batteries.
 - b. Fully recharge batteries after each use.
 - c. Store tool in a location where the surrounding air temperature is approximately 40°F-75°F (4.5°C - 24°C).
 - d. Disconnect charger from tool after charge is complete. WARNING: Fire Hazard. When disconnecting the charger from the tool, be sure to unplug the charger from the outlet first, then disconnect the charger cord from the tool.

ENVIRONMENTAL PROTECTION



We are certain that you share out love of nature, and that you have already devoted some thought to ways of protecting the environment. It may well be that you are already familiar with some of the following recommendations and view them as a matter of course. However, the list doubtless includes some helpful suggestions which are new to you, and which you could put to good use.

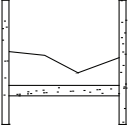

Please observe the usual periods of rest.
Do not trim grass at lunchtime, at night or on Sundays and holidays.
Please also consult the relevant publications in your community.
Under no circumstances put the grass clippings in the dustbin

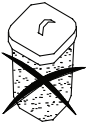

Put the grass clippings onto the compost heap alternating with other garden waste.
They make a very good "mulch". Grass clippings can be spread under bushes or trees; they are a natural means for preventing the growth of weeds and they protect the ground from drying up.



Protect your little neighbors.
A garden is inhabited by small animals such as beetles and frogs. Try to drive off any animals before trimming and allow them to find a temporary retreat. An island in the garden looks attractive and also offers animals a refuge. Allow plants to finish blooming, and then they will flower even better the following year.

MAINTENANCE, STORAGE, AND DISPOSAL

1. Disconnect the battery pack from the machine before carrying out maintenance or cleaning work.
2. When not in use store the machine out of the reach of children.
3. Use only manufacturer recommended replacement parts and accessories.
4. To clean the tool, remove battery pack and use only mild soap and a damp cloth to clean the tool. Do not immerse tool in water or spray with a hose. Do not allow any liquid to get inside it. Do not clean with a pressure washer.
5. Inspect and maintain the machine regularly. Have the machine repaired only by an authorized repairer.
6. The battery must be removed from the appliance before it is scrapped.
7. The appliance must be disconnected from the supply mains when removing the battery.
8. The battery is to be disposed of safely.

MAJOR PARTS OF THE GRASS TRIMMER

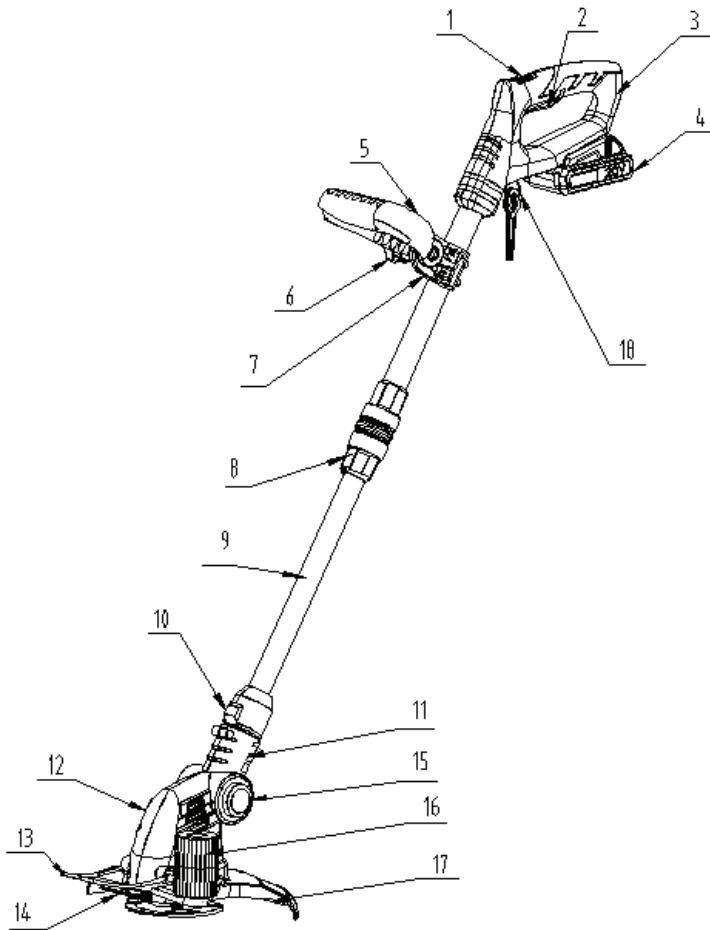

Part No.	Description	Q'ty	Part No.	Description	Q'ty
1	Unlock Knob	1	10	Lock Sleeve And Edging Function Button	1
2	Switch Handle	1	11	Angle Adjustment Handle	1
3	Main Handle	1	12	Trimmer Head	1
4	Battery Pack	1	13	Flower Guard	1
5	Auxiliary Handle	1	14	Cutting Device (Blade)	1
6	Handle Lock Nut	1	15	Angle Adjustment Button	1
7	Handle Support	1	16	Edging Function Wheel	1
8	Locking Sleeve (Length Adjustment)	1	17	Safety Guard	1
9	Telescopic Pole	1	18	Blade Penda	1



Great Circle USA
Support Line: 1-866-493-0524
help@greatcircleus.com
www.greatcircleus.com