

- This Product should be installed according to this manual.
- Please read this manual carefully and install properly.
- Please keep this manual for future reference.
- Please register Warranty for proper service.

Supreme...
HYGIENE AND COMFORT

IMPORTANT SAFEGUARDS

• READ ALL INSTRUCTIONS BEFORE INSTALLATION AND USE

⚠ DANGER - To reduce the risk of electrocution:

1. Do not place or store product where it can fall or be pulled into a tub or sink.
2. Do not place in or drop into water or other liquid.
3. Do not reach for a product that has fallen into water.
If this happens unplug the unit and then remove it from water immediately.

⚠ WARNING - To reduce the risk of burns, electrocution, fire, or injury to persons.

1. Close supervision is necessary when this product is used by, on, or near children.
Do not use attachments not recommended by the manufacturer.
2. Use this product only for its intended use as described in this manual.
3. Never operate this product if it has a damaged cord or plug or if it is not working properly, if it has been dropped or damaged, or dropped into water. Return the product to a service center for examination and repair.
4. Keep the cord away from heated surfaces.
5. Never block the air openings of the product or place it on a soft surface, such as a bed or couch, where the air openings may be blocked. Keep the air openings free of lint, hair, and the like.
6. Do not use the unit if you are sleeping or tired to the point of being drowsy.
7. Never drop or insert any object into any opening or hose.
8. Do not use outdoors or operate where aerosol (spray) products are being used or when oxidated products are being administered.
9. Unplug this product before filling. Fill (reservoir) with water. Do not overfill (or specify filling instructions)

SAVE THESE INSTRUCTIONS

Cautions Before Installation

WIRING REQUIREMENT

THIS PRODUCT MUST BE PLUGGED into a regular voltage Grounded GFCI outlet (North America 120V AC, 60Hz / Europe 220-240V~, 50/60Hz). The rated power consumption is 1,400W. In locations where only a standard two-prong outlet is available, it is the responsibility of the user to install a grounded three-prong outlet. Using higher voltage is dangerous and may result in a fire or other accident. This product is not responsible for damage resulting from the use of it on other than specified voltage, or operating it without proper grounding.

⚠ WARNING

This Product must be on a separated circuit.
No other appliance should share the circuit with this product.
Sharing a circuit could cause the branch circuit fuse to blow or the circuit breaker to trip.
Continuous usage under these conditions may result in fire or property damage.

GROUND INSTRUCTIONS

This appliance has to be grounded.

- 1 This product has to be grounded. In the event of an electrical short circuit, grounding reduces the risk of electric shock by providing an escape wire for the electric current. This product is equipped with a cord having a grounding wire with a grounding plug. The plug must be plugged into an outlet that is properly installed and grounded.
Danger - Improper use of the grounding plug can result in a risk of electric shock. If repair or replacement of the cord or plug is necessary, do not connect the grounding wire to either flat blade terminal. Consult with a licensed electrician if you have concerns about whether the product is properly grounded.
- 2 This product is for use on a normal 120 V circuit, and has a grounding plug that looks like the plug illustrated in sketch A in Figure 1. A temporary adapter, which looks like the adapter illustrated in sketches B and C, may be used to connect this plug to a 2-pole receptacle as shown in sketch B if a properly grounded outlet is not available. The temporary adapter should be plugged into a properly grounded outlet (sketch A) and should be installed by a licensed electrician. The green colored rigid ear, lug, and the like extending from the adapter must be connected to a permanent ground such as a properly grounded outlet box cover. Whenever the adapter is used, it must be held in place by the screw.

Preferred Connection

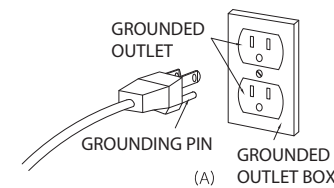

Temporary Connection

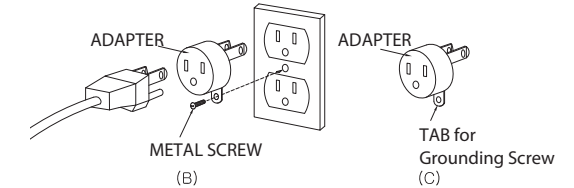

- Figure 1-

⚠ DANGER

IMPROPER GROUNDING CAN RESULT IN A RISK OF ELECTRIC SHOCK.

Electric wiring has to be done in accordance with all local codes, or in the absence of local codes, with National Electrical Codes.

The use of an extension cord is not recommended or advised. If it is necessary to use an extension cord, use only a three-prong extension cord (one to one), and a three slot built-in GFCI receptacle that will accept the plug on this product. The marked rating of the extension cord should be equal to or greater than the electrical rating of the unit (10amp). Consult a licensed electrician if you are not sure whether the unit is properly grounded.

REMARK

- 1 Instruction and caution statements for cleaning, user maintenance, operations recommended by the manufacturer, such as lubricator non lubrication, and a warning to the user that any other servicing should be performed by an authorized service representative that the product has no user serviceable parts.

IMPORTANT SAFEGUARDS / GENERAL CAUTION

PLEASE OBSERVE THE FOLLOWING PRECAUTION BEFORE USING THIS PRODUCT

WARNING Indicates potentially hazardous situation which, if not avoided, could result in death or serious injury.

CAUTION Indicates potentially hazardous situation which, if not avoided, may result in minor or moderate injury or in damage to the product or other property.

• Indications

Prohibited	Prohibited generally	Use of fire prohibited	Disassembling, remodeling prohibited.
	Do not spray water	Wet hands prohibited	Do not put in water
Observe at all times	Observe at all times	Grounding	Unplug the power cord

Safety Warning

Do not supply electrical power to the product until it is installed on the toilet and the water supply hose is properly connected.

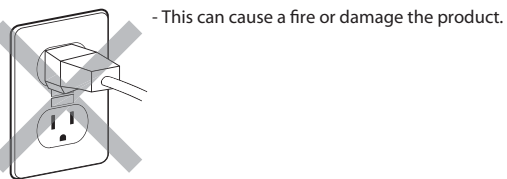

Do not plug in the power cord before connecting the water supply hose

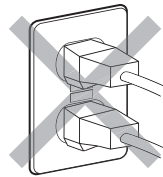

Do not use this product with multiple electronics connected in one power outlet.

About Low Temperature Burns-
 - Children, elderly, patients and those who are physically limited should use the low temperature setting for the seat, water and dryer.
 - After using the unit at high temperatures, the temperature should be re-adjusted to 'low' for the elderly, children and for those with sensitive skin.
 - Those who cannot adjust the temperature or those who have sensitive skin should take special precautions.

When cleaning, do not use cleaning detergents (oxidized products, sink products, toilet cleaning products, and any types of stain removers) on the external surface of the electronic toilet seat, and also do not spray air fresheners or aromatic products onto seat in attempts of eliminating odors.



- Using cleaning detergents or air fresheners can change the color of the external surface and can also cause problems with seat functions.

Sitting on the heated seat or using the dryer for an extended period of time can potentially cause low degree burning. Special precautions should be taken for children, those who cannot adjust the temperature, and those who have sensitive skin.

Safety Warning

Connect the this product to the cold water supply pipe carrying potable water. Do not connect to an industrial water supply line that does not carry water of drinking quality.

Observe at all times

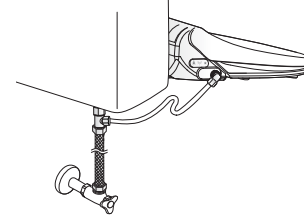

- This will negatively effect hygiene and performance.

Do not use a damaged power cord or a loosely fitted electric outlet.

Observe at all times

- This can cause an electric shock.

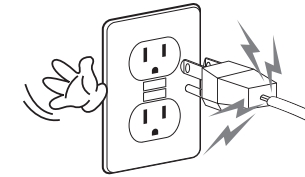

Do not separate, disassemble, repair or remodel the unit, or allow foreign substances inside the unit.

Disassembling

- This can cause a fire or electric shock.
 - Only qualified service personnel should repair this product.



Do not splash water on the main unit or power cord, and do not utilize it in areas of high levels of humidity.

Do not spray water

- This can cause a fire or electric shock.



This product must be grounded before usage and plugged into an AC 120V/60Hz power outlet.

Grounding

- If grounding is not done, it can cause fire or electric shock.



Do not touch the power cord with wet hands.

Wet hands prohibited

- Do not plug or unplug the power cord with wet hands as it can cause electric shock or bodily injury.

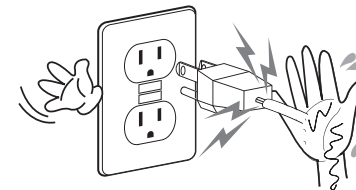

Unplugging the power cord

Prohibited

- Failure to do so can cause an electric shock.

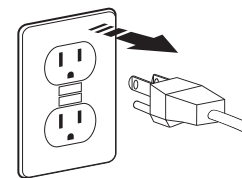

Keep the cord away from cigarettes or flammable substances.

Use of fire prohibited

-This can cause electric shock or bodily injury.



! Cautions



Do not stand on top of the seat cover, seat or on top of main unit.

Prohibited



- This can damage or break the unit.



Do not use a broken product.
As the unit is a bathroom appliance, do not use it for any other purposes.

Prohibited



Do not slam or close the seat or seat cover forcefully.

Prohibited



Prevent children from putting foreign substances or inserting their hands into the dryer outlet or onto the nozzle.

Prohibited



! Cautions



Do not put the product in water.

Do not put in water

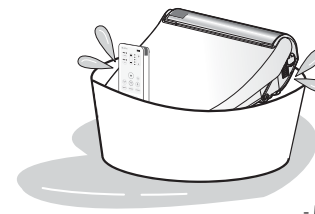

- May cause damage or electric shock



Wipe off with dry cloth if dust or foreign substances on the power plug.

Observe at all time

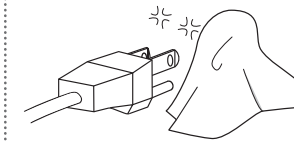

Do not pull the connecting hose forcefully or bend it.

Prohibited

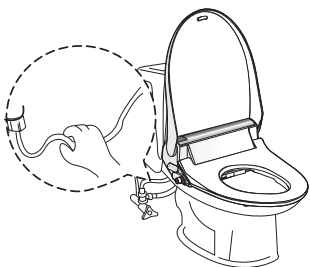

Install product in areas out of direct sunlight.

Prohibited

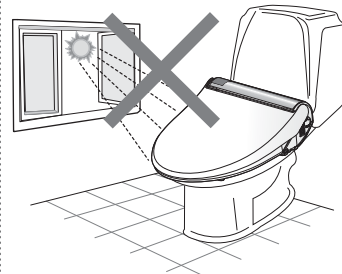

- May cause discoloring or other effects to unit.



Guardian should pay extra attention when children, elderly, or those who cannot independently sit on the seat.

Prohibited



Do not operate the unit without seating.

Prohibited



- May cause of wet floor or damage other materials.



Do not let urine contact the dryer outlet or nozzle area.

Observe at all time



When cleaning or not using the product over a long period of time, be sure to unplug the

Observe at all time

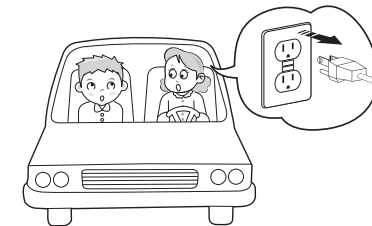

- Observe at all times unit. (refer to page 32)



When the following people sit down on the seat, a guardian should pay extra attention so that they will not fall when sitting on the toilet seat or standing up from it (Children, elderly, or those who cannot independently sit on the seat)



Sitting on the heated seat or using the dryer for an extended period of time can potentially cause low degree burning. Special precautions should be taken for children, those who cannot adjust the temperature, and those who have sensitive skin.

ATS-2000R

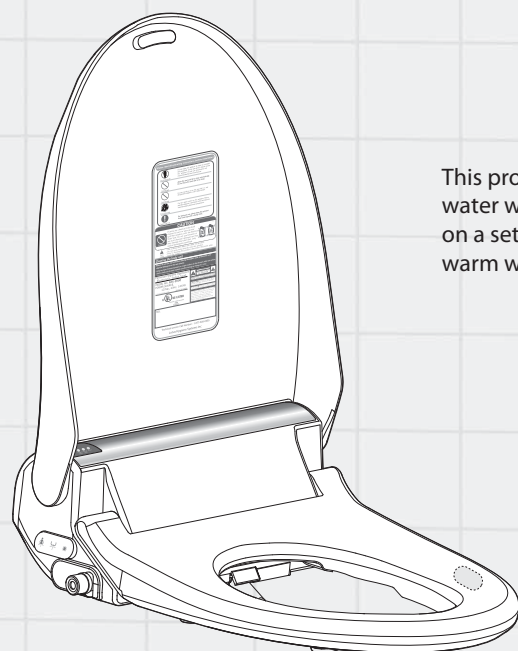

This product enables you to use warm water wash for long periods of time on a set temperature with digital warm water control.



ATS-2000R

Special and Unique functions

- **Purestream.**
Strong but soft water stream massages the rectum area to help ease bowel movement.
- **Oscillate wash function.**
40~70 revs per second Vibrating pump enables to clean the desired area for Wash and Lady wash.
- **Massage wash function.**
Water stream automatically repeats strong and soft pattern to experience massage effect.
- **Auto Wash & Dryer**
Pre-programmed Wash for 30 seconds, then Dryer for 1 minute.

Preparation

IMPORTANT SAFEGUARDS & GENERAL CAUTIONS	2
Product's special & unique functions	8
Product & components	10
Product structure and designations	11
Control designations	12

Install & uninstall

Precaution before installation	14
Installation	15
Check points after installation	18
Separation from the toilet bowl	19

Operation

Basic operation	20
Detailed operation	22
Battery in remote	27

Others

Trouble shooting	28
Maintenance	29
Storing	30
Specifications	31
Information to users	32
Warranty	33

Product & components

Features

Purestream	Strong but soft water stream massage the rectum area to help ease defecate.
Wash	Helps to clean the desired area with fast & delicately
Lady	A gentle and dedicated stream of water, produced by a separated nozzle group, cleans the vaginal area safely and comfortably.
Auto Wash & Dryer	Pre-programmed wash for 30 seconds, then dryer for 1 minute.
Instant/continual heating system	Most efficiently applied instant heating and warm water control to experience continual warm water stream unlike the other water tank system.
User focused controls	Ergonomically designed control parts enable user to control the unit more comfortably.
Oscillate function	Nozzle moves back and forth automatically to have wider cleansing area for each user.
Massage function	Water stream automatically repeats strong and soft pattern to experience massage effect.
Eco/Deo	Energy save function controls the system with best energy saving environment.
Easy installation	Easy to install and uninstall the unit with one touch button located under the main unit.

Components

For plumbing

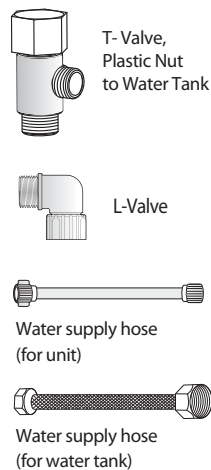

For product mounting

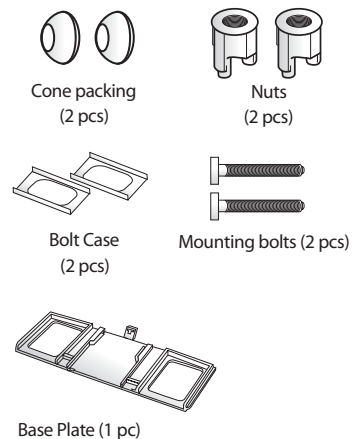

For remote control

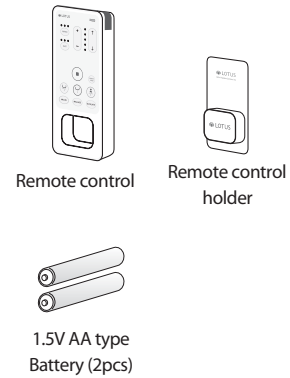

Installation instructions



Product structure and designations

Main unit

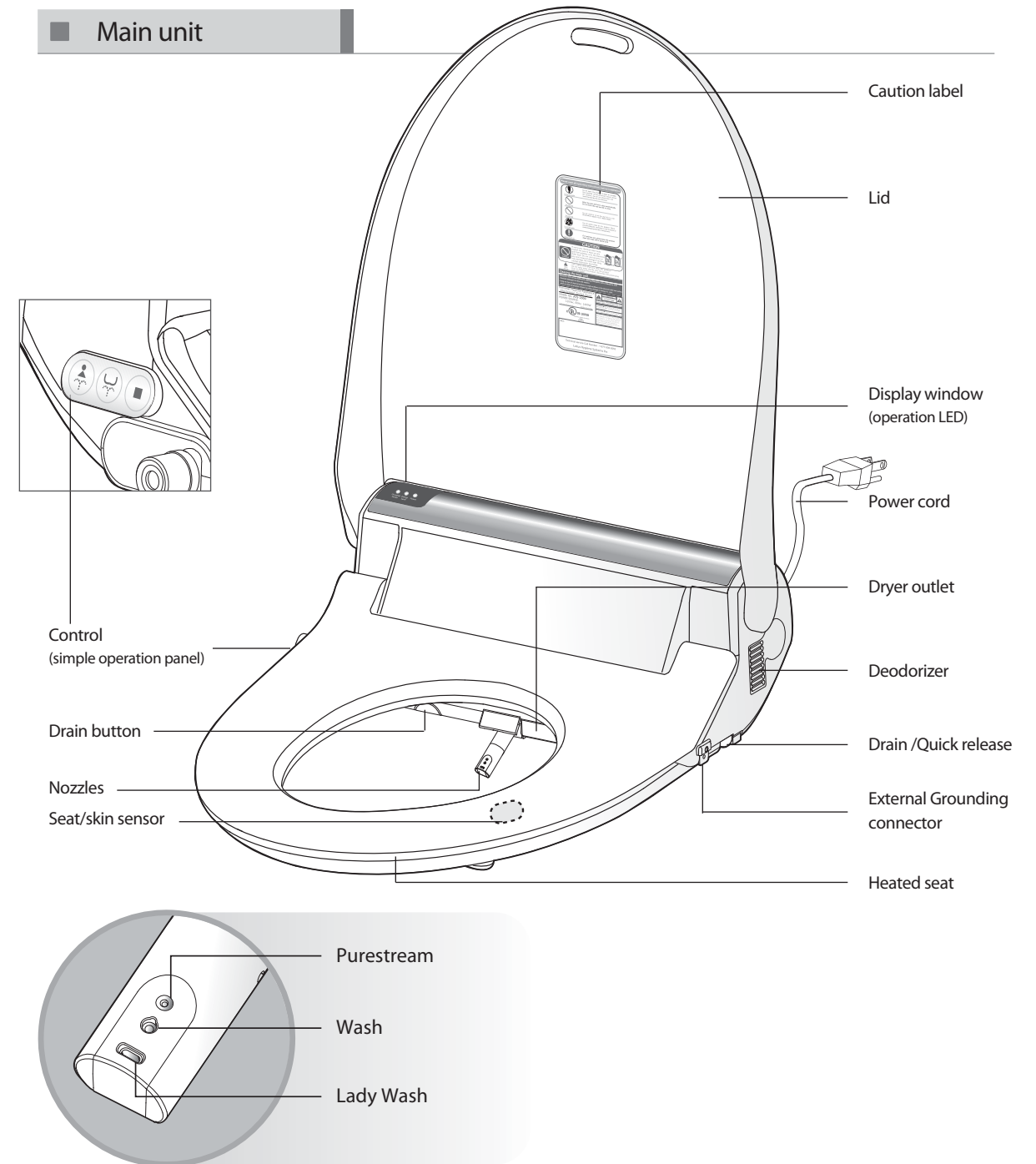

Use only External Grounding if there is no grounding connected from the power plug.

Control designations

Remote control

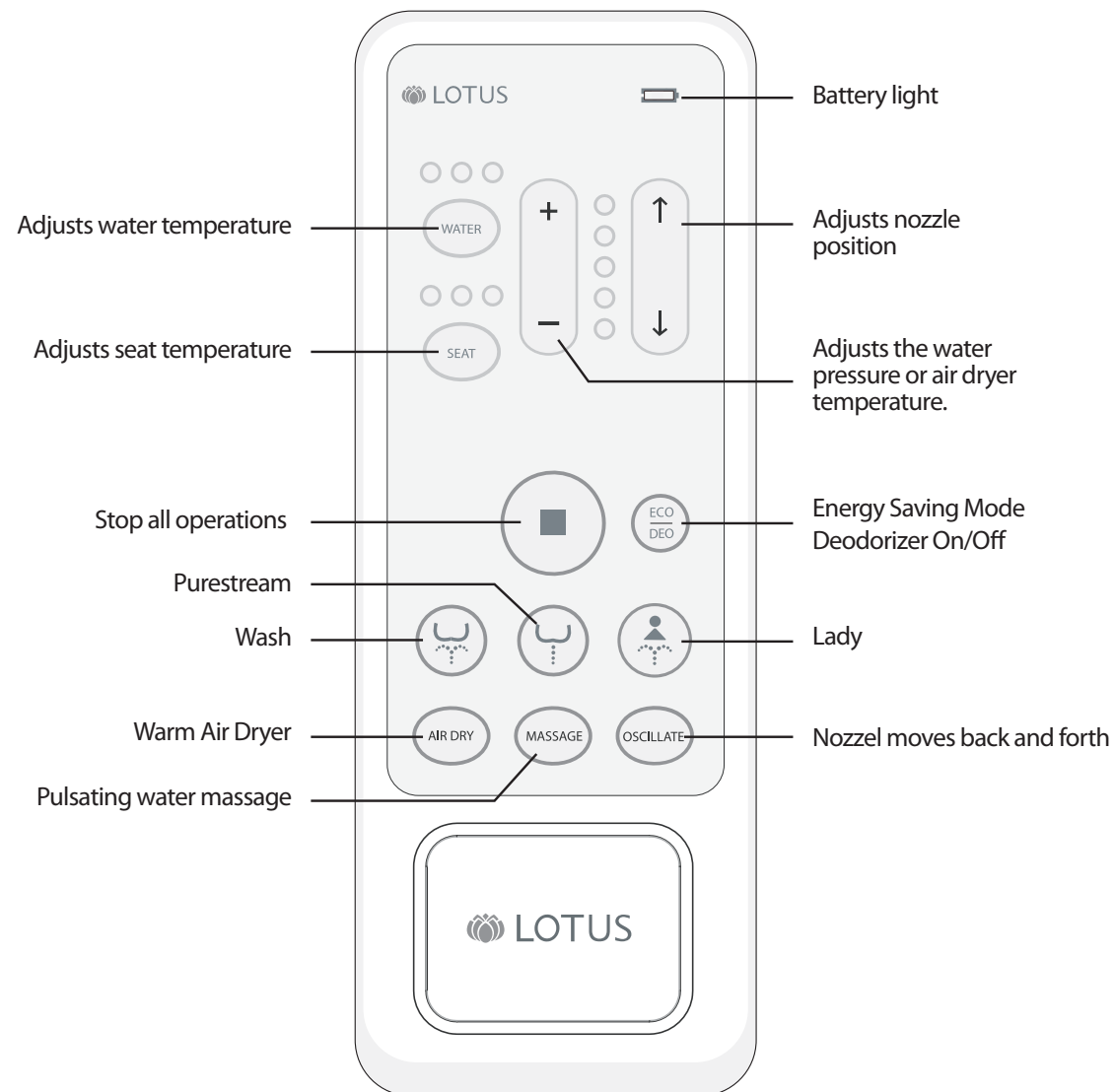

Simple operation panel

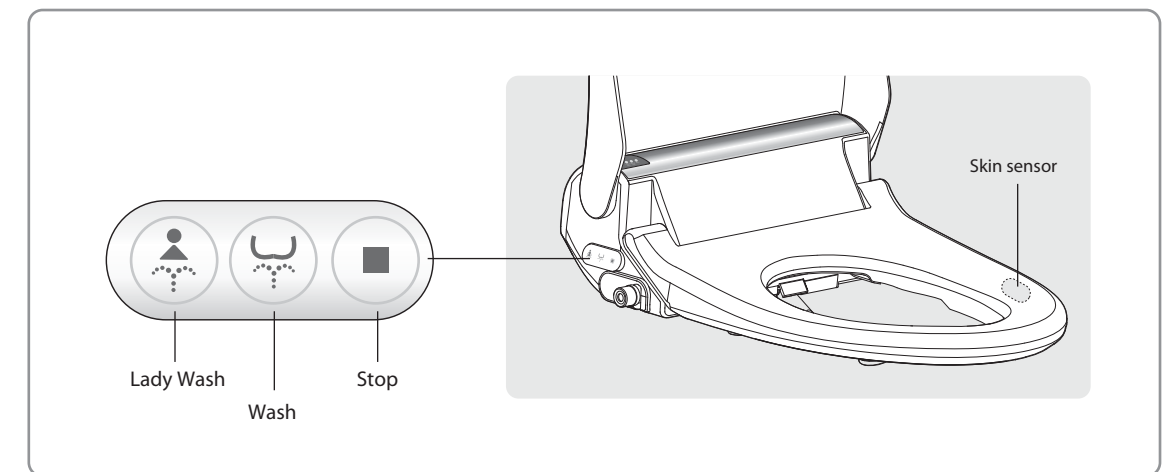

Always sit in the middle of the unit and do not sit to the side of the seat.
(Product will not function if the skin sensor is not activated.)

When the water temperature is set at Low, Mid or Hi, for use of Wash, Lady, Purestream wash, the water temperature will be about Low(93.2° F), Mid(98.6° F), Hi(104° F).
(If the unit's input water temperature is lower than 50°, the water temperature could be lower than the above noted temperatures)

! Sitting on the heated seat or using the dryer for an extended period of time can potentially cause low degree burning. Special precautions should be taken for children, those who cannot adjust the temperature, and those who have sensitive skin.

! The remote LED light will automatically shut off if the user does not press any button for 10 seconds to save battery.

Precaution before installation

First time setup

■ Checking water valve in bathroom

1 Removing existing seat and lid

- Release the bolts on both sides of the existing toilet seat to remove the seat and lid.
- Store the removed seat, nut and water hose in a safe area in case you move or need it to be reinstalled.

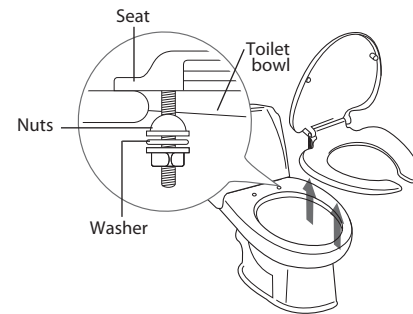

⚠ Cautions

Please check the toilet bowl size before installation.

2 Shut off water supply valve and disassemble the water hose from the water tank.

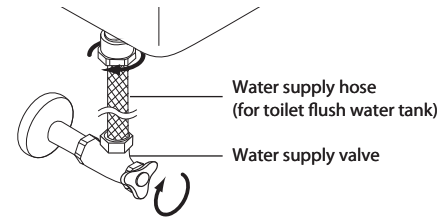

3 Connect the T-valve to water tank. First remove water hose, then install T-valve.

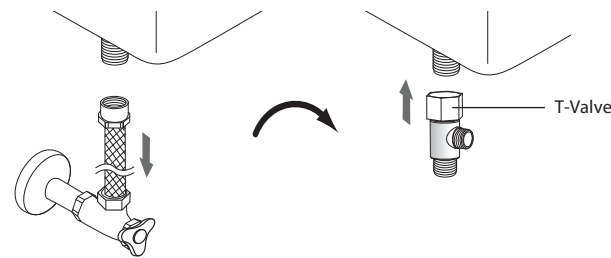

4 Connect the water supply hose to the assembled T-valve.

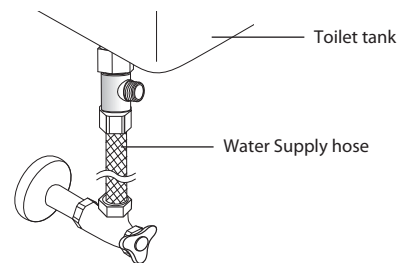

Installation

⚠ Warning

- This product requires 120V usage.
- Please do not plug in the electrical cord prior to installation.
- Please consult with a licensed electrician if electrical work is needed, and in case a grounded outlet is not available, grounding should be done in order to prevent short circuits or electric shock.

■ Installing

- 1) Put the bolt into the bolt case and align it with the top of the base plate.
- 2) Insert bolt with bolt case onto the base plate.
- 3) After this is done hold the bolts, slide it into the bottom of the unit until it snaps in place.

If you do not hear a 'click' sound when slid into the main unit onto the base plate, it is not installed properly and unit could move when using product.

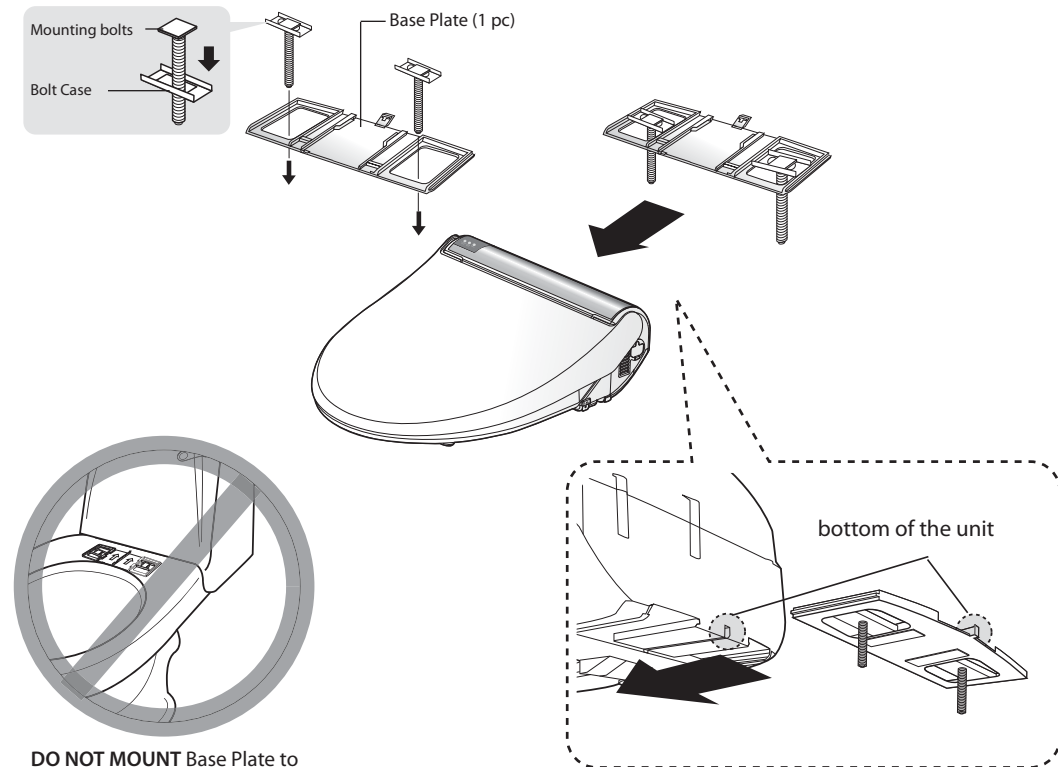

Installation

2 Connect L- valve to the main inlet, then connect water hose to L-valve.

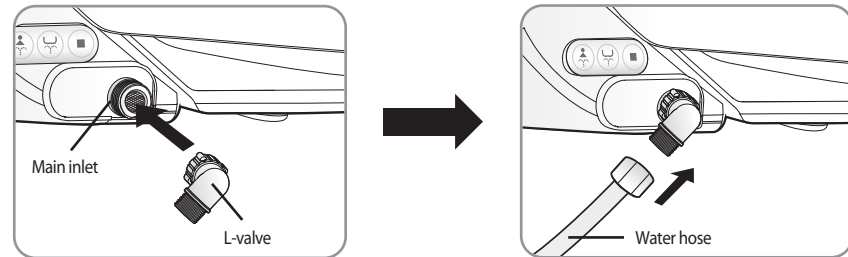

3 Install the main unit and insert the mounting bolts to the toilet mounting holes.

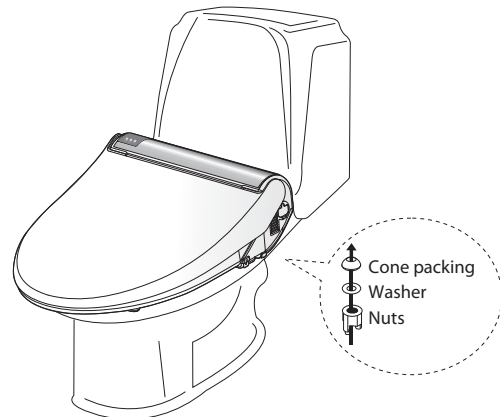

4 Once the base plate is attached to the unit, align the unit and toilet fixture facing front, and then insert the mounting bolts to the toilet mounting holes.

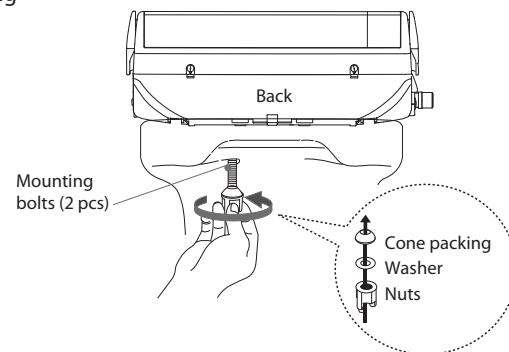

⚠ Cautions

Please make sure not to interrupt water opening handle when connecting water filter or T-valve.

5 Connect the water supply hose to the assembled T-valve & filter as illustrated

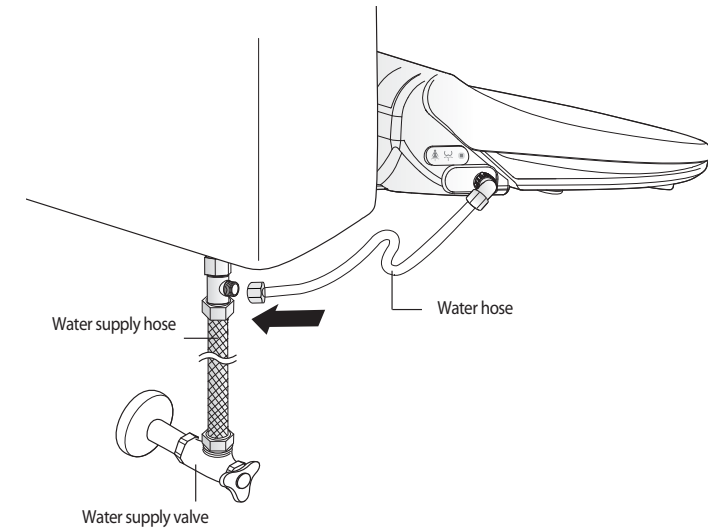

6 Turn on the water to allow water to flow.

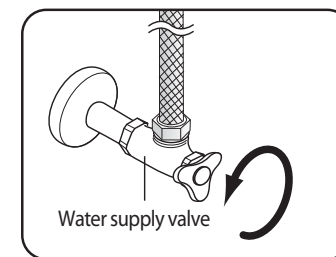

7 Remote Control

- Select a convenient spot near the toilet to attach the remote control holder.
- Make sure that the selected spot will not be exposed to water and the area where you intend to affix the holder is clean and dry.
- Remove film from the double sided tape located on the back of the remote control holder and place the holder in the selected area.
- On remote control insert the two(2) batteries (1.5V AA) ensure that the poles on the batteries correspond to the directions on the remote control.

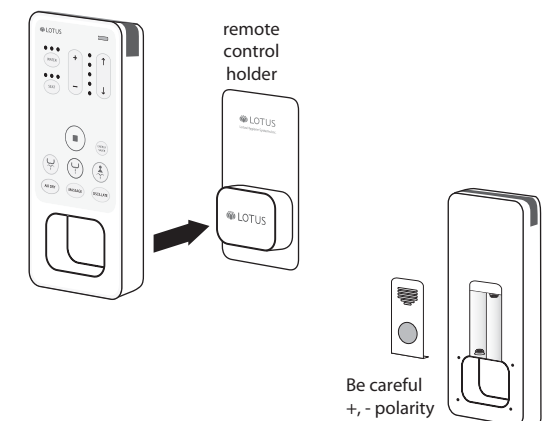

Check points after installation

- 1 Turn on the water supply valve. Check connecting areas (1~5) if there is any water leakage.

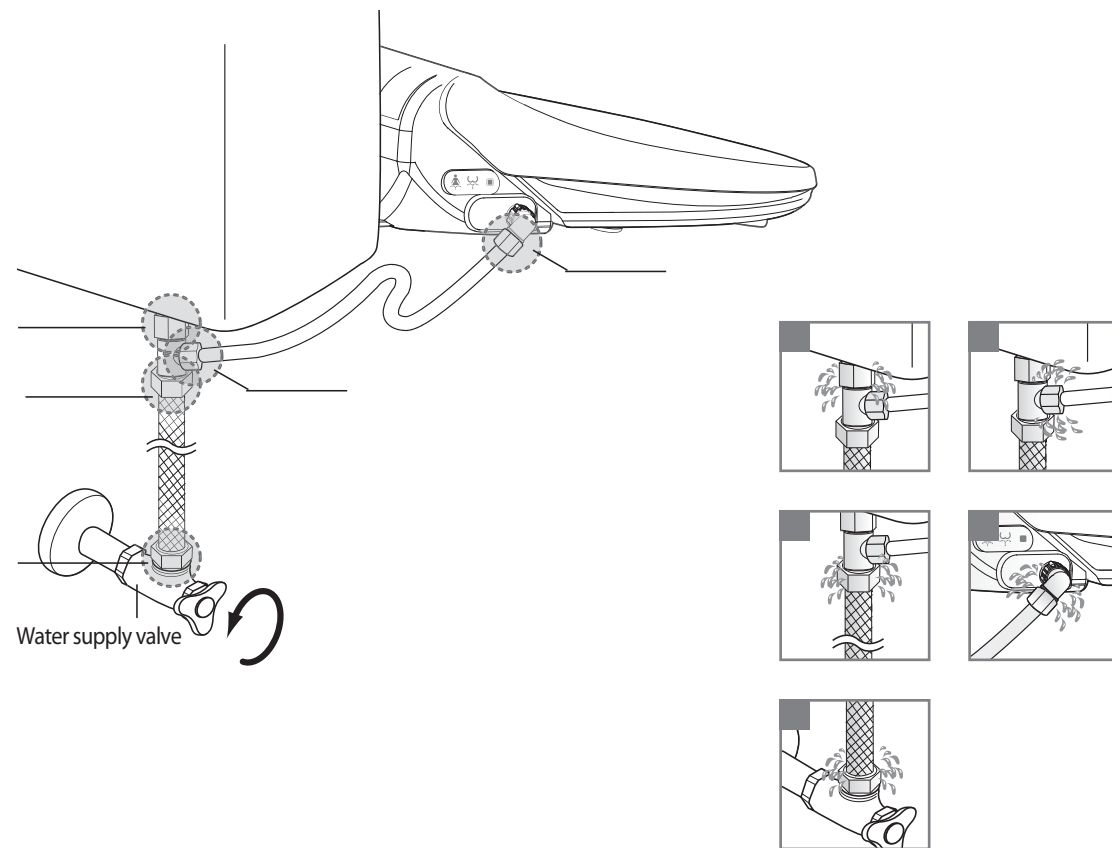

- 2 Plug the power cord to the electric outlet.

- 1) When plug is connected to electric outlet, the power lamp will be on with sound for operating preparation.
- 2) Press  (Wash) button for water entrance to unit.
- 3) When the water has entered, there will be a "Beep" sound signifying ready for use.

Separation of unit from the toilet bowl

Please follow the instructions below when moving or separating the unit from the toilet for cleaning purposes.

- 1 Disconnect the power plug.
- 2 Shut the water supply valve.
- 3 Push and hold the water drain button next to nozzle until the water is completely drained from the water tank.
- 4 Loosen the nut on the hose that is connected to the unit, and then separate the electronic toilet seat from the toilet in the following order as illustrated.

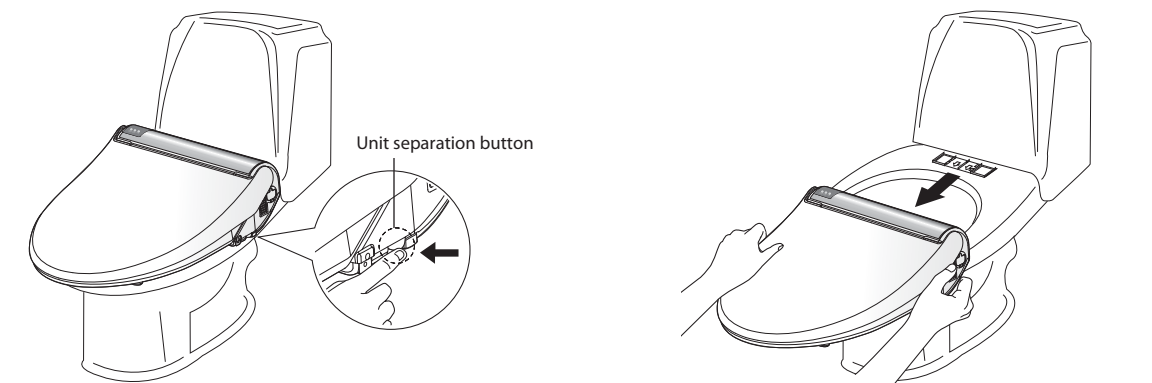

While pushing the button (area shown as an arrow) push the electronic toilet seat slightly toward the front and then the body unit will begin to slide out. Next, lightly pull the unit toward the front and it will detach from the toilet.



Do not turn the seat upside-down. This can cause damage to the unit as well as fire hazard.

- 5 Disconnect the T-valve from the water supply. (Refer to page 14~16)
- 6 Connect the water hose to the toilet which was disassembled while installing the electronic toilet seat, and turn the water valve to the left to open it. See if there is any leaking from the water hose connection.
- 7 Re-install the toilet seat and lid that was separated when installing the electronic toilet seat.
Steps 1~4 are instructions for separation of the unit for basic cleaning purposes,
Steps 5~7 are instructions for separation when moving, etc.

Basic operation

CAUTION



CAUTION

Please press the "off" or "low" button for seat temperature when the following persons use it. Special precautions should be taken for children, those who cannot adjust the temperature, and those who have sensitive skin

Sit down on the seat

- Sit on the toilet seat so that the skin sensor can fully be activated.
- When occupied the seat light on the unit should light up.

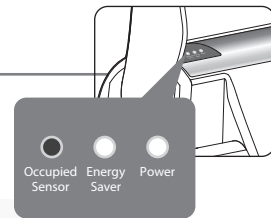

Warning

- Do not press the control buttons harder than needed. This can cause damage.
- The skin sensor of the seat is only activated with bodily contact, please be sure to pull down your clothes amply and do not cover the seat with any clothing items, as it can prevent the seat from activating.

Wash Buttons

Press **WASH** (♂), the nozzle comes out and sprays warm water to posterior. If you press "OSCILLATE", the nozzle moves back and forth automatically. Press again to stop nozzle move.

Press **LADY** (♀), the nozzle comes out and sprays warm water to feminine area. If you press "OSCILLATE", the nozzle moves back and forth automatically. Nozzle stops moving when the switch is pressed again and it automatically stops after two minutes.

Press **PURESTREAM** (♂), the nozzle sprays a highly concentrated water stream that can induce a smooth bowel movement.

Warm Air Dryer

- The display light for the (high), (low) on the remote will turn on while the dryer is activated.
- The selected function can be used up to 3 minutes.
- Before using the dryer, wipe the wet area with toilet paper to allow for fast drying.

Warning

- In using dry function, deodorant function is not active.
- When drying is not being used, deodorant function is activated

Basic operation

Auto Wash & Dryer

- Pressing message only will activate the *Auto Wash & Dryer* function:
Wash (30 seconds) + Dryer (1 minute) - automatically stops.



Stop Button

- Press this button to stop all operations.

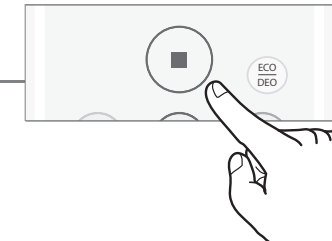

Automatic self cleaning nozzle

- This product has an automatic nozzle self-cleaning function that cleans the nozzle before and after each use. (Normal vibration and noise will be heard and felt during this process.)

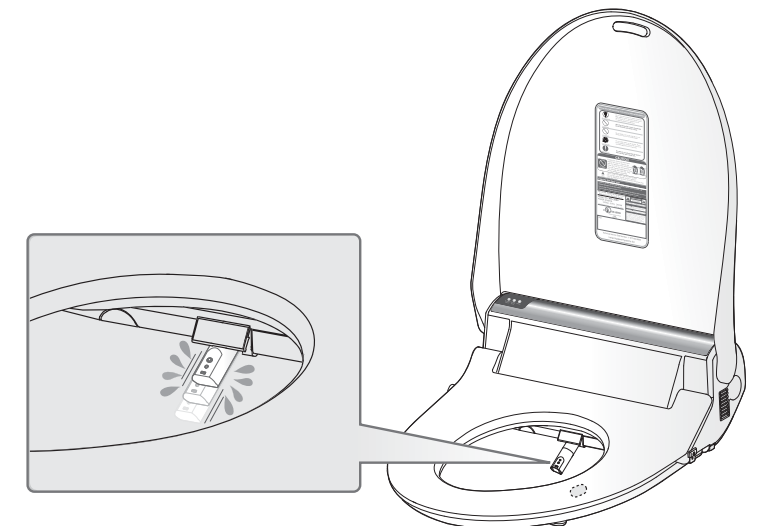

Detailed operation

Simple operation key & Remote

* Press once to activate LED light, press again to activate the function

* After using 10 minutes remote will automatically revert to energy save function

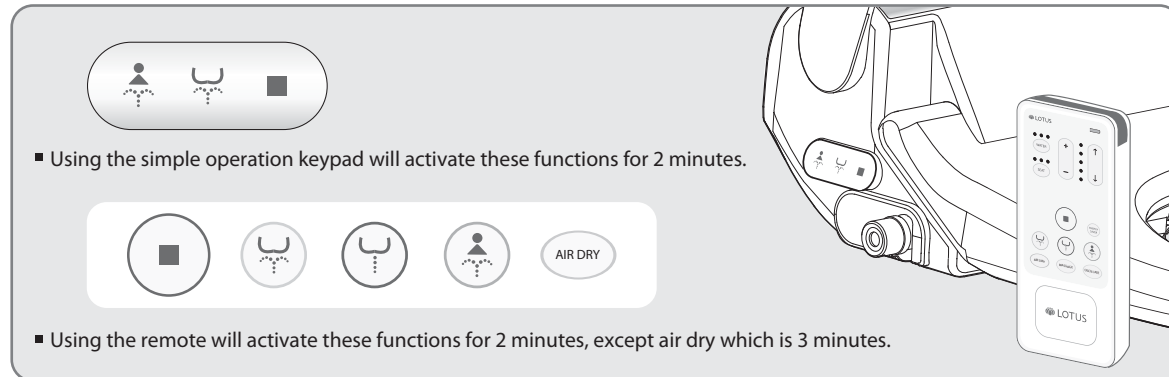

- Water pressure & nozzle position of Wash and Lady function is adjusted to 3 levels from the simple operation keypad.
- After using simple operation keypad, remote's move, massage, oscillate function is deactivated.
- Press the same function again on wall remote, remote's massage, massage is activated.

OSCILLATE Auto nozzle wash

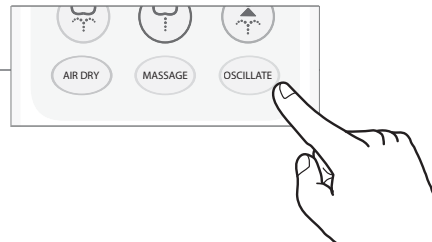

- Nozzle can be cleaned **without the seat being occupied.**
- Press and hold "oscillate" Button until water begins to wash the nozzle.
- Flushing will continue for 20 seconds and retract on its own.

SEAT Seat temperature adjustment

- The seat temperature (● ● ●) can be adjusted to the desired level with the SEAT button

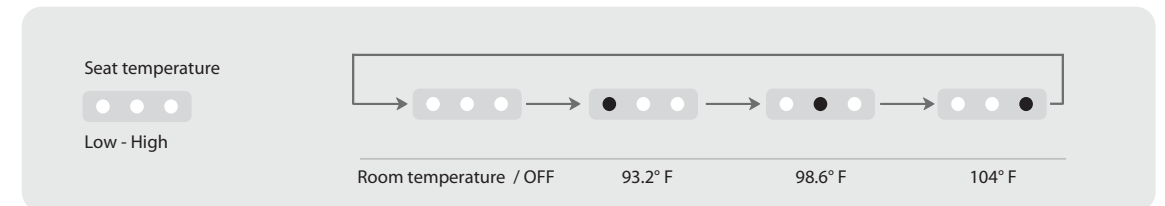

Warning

- Seat temperature varies depending on ambient temperature.
- Closing the lid when not using will keep the temperature constant and save on electricity.

Nozzle position adjustment

- When using the wash functions use front(↑), back(↓) buttons to adjust the nozzle to suit your needs.
- Nozzle position is saved based on last use.
- * The nozzle functions can be adjusted 5 positions.

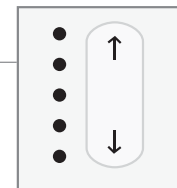

Warm air dryer adjustment

- Adjust the dry temperature by pressing high(+), low(-)
- Air dryer temperature is saved based on last use.
- * The dryer temperature can be adjusted 5 levels

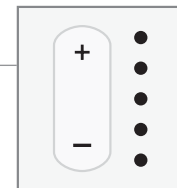

Detailed operation

Water pressure adjustment

- Press high (+), low(-) for the Water/Dryer (Water pressure can be adjusted 1~5 levels).
- Right before used water pressure is storage.

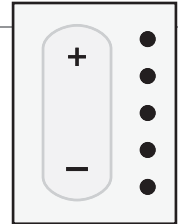

Water temperature adjustment

- When pressing **WATER** button the display light(●●●●) will change to allow the adjustment of the water temperature to the desired level.
- This product can maintain constant warm water.

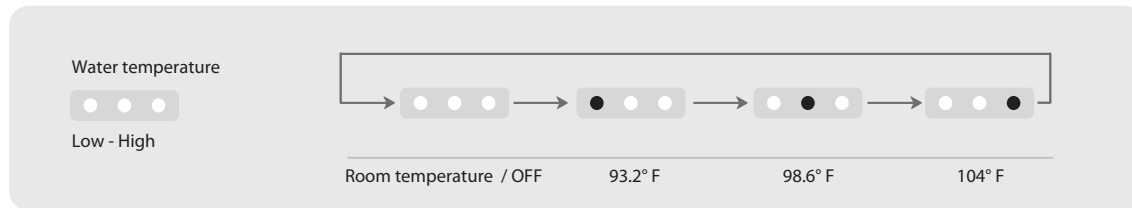

Massage

- While using Wash, Purestream or Lady wash press **MASSAGE** button, to activate massage function. (press massage button again to deactivate)

Automatic massage function: This function automatically activates 'Massage' function for Wash, Purestream, and Lady wash without pressing 'Massage' button every time it is use.

How to select & cancel Automatic massage function

After using Wash, Purestream, or Lady wash press 'stop' button. And then press 'massage' button for 3 seconds within 30 seconds of pressing 'stop', automatic massage is activated with a solid beep sound. Press again for 3 seconds, function will be cancelled with two beeping sounds. When automatic massage function is selected, the massage function activates automatically for Wash, Purestream, and Lady wash without pressing massage button.



press 3 seconds
Single Chime
to activate



press 3 seconds
Double Chime
to cancel

- Selection sound is single Chime, cancellation sound is double Chime
- Once massage function is selected, it will continually work after blackout or power is re-plugged.

Oscillate

- While using Wash, Purestream or Lady wash press **OSCILLATE** button, to activate oscillate function. (press oscillate button again to deactivate)

Automatic oscillate function: This function automatically selects 'Oscillate' function for Wash, Purestream and Lady wash without pressing 'Oscillate' button every time it is use.

How to select & cancel Automatic Oscillate function

After using Wash, Purestream, or Lady wash press 'stop' button. And then press and hold 'Oscillate' button for 3 seconds within 30 seconds of pressing 'stop', *automatic oscillate* is activated with a solid beep sound. Press again for 3 seconds, function will be cancelled with two beeping sounds. When *automatic oscillate* function is selected, the oscillate function activates automatically for Wash, Purestream, and Lady wash without pressing oscillate button.



press 3 seconds
Single Chime
to activate



press 3 seconds
Double Chime
to cancel

- Selection sound is single Chime, cancellation sound is double Chime
- Once massage function is selected, it will continually work after blackout or power is re-plugged.

Detailed operation

Battery in Remote

■ Eco (Economy mode)

- Press  button until LED light is on.
- Eco saver is maintained at about 89.6°F seat temperature.
- The Eco function is turned off while using the unit. Eco turns back on when seat is unoccupied.

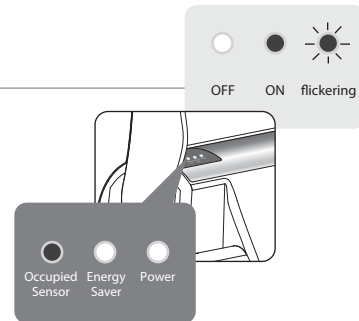

 Eco mode will result in lower seat temperatures.

Other energy saving tips

In order to save energy, please abide by the following instructions:

- Keep seat cover closed when not in use to prevent heat from being lost.
- Keep temperature set to low.
- Unplug the power cord if you do not plan to use it for a long period of time.

■ Deo (Deodorizer)

■ Deodorizer ON / OFF

Press and hold  button for 3 seconds to set up

The deodorizer is activated when the unit is occupied. It automatically stops in about 1 minute after user leaves.



BEEP

Eco / Deo button press and hold for 3 seconds
Single Chime



BE-BEEP

Eco / Deo button press and hold for 3 seconds
Double Chime

• Selection sound is a single Chime, double Chime for cancel.

Automatically stops 1 minute after unoccupied.

Warning

- In using dry function, deodorizer function is deactivated.
- When dry function is not being used, deodorizer function is activated

■ Change battery

- LED is not displayed after pressing buttons on remote, change battery
- LED is displayed by pressing button, function is activated by pressing again
- LED is automatically shut off before 10 seconds
- After changing battery, reset settings(temperature, functions)

When the unit is stopped by pressing stop button on the 'simple operation panel', timer on remote control will still continue to run until remaining time is used.

Ex.) If a user presses wash function from remote (programmed timer 2 min. / dryer 3 min.) and then press stop button on 'simple operation panel' after 1 min. use, operation from remote will not work for remaining 1 min. (2 min. for dryer)

For another quick use, press ' stop' button on remote control for reset timer then functions on remote will work properly.

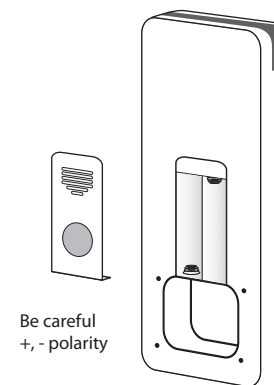

Warning



- Please change battery, LED is off before 10 seconds from starting use

Trouble shooting

Trouble shooting	Factors to check
The water does not spray	<ul style="list-style-type: none"> - Check if the water tank is filled. - See if the water valve is closed. - Check if the water filter (strainer) is clogged.
The unit is not operating	<ul style="list-style-type: none"> - Check if the power cord is connected. - See if the power is turned off from the main unit. - See if you are correctly sitting on the seat so that the skin sensor switch will function properly. (Make sure that the Skin sensor on the seat touches your skin when you sit on the seat.)
Water is leaking	<ul style="list-style-type: none"> - After checking if the plumbing is correctly connected, if water is leaking from the main unit disconnect and contact service personnel.
Water pressure is weak	<ul style="list-style-type: none"> - Check if the water pressure is set at "low". - Check if the water filter (strainer) is clogged.
Seat, water and dryer is not warm	<ul style="list-style-type: none"> - See if the water temperature is set to "low". - Check if the dryer temperature is set to "low".
When move speed of nozzle is delayed	<ul style="list-style-type: none"> - when using 4 minutes continuously, speed is slowing down. - 30 seconds after, the speed is reverted normal.
When the nozzle doesn't come out	<ul style="list-style-type: none"> - See if the skin sensor on the seat is touching the skin.
When water is cold or warm	<ul style="list-style-type: none"> - Adjust the temperature to (mid, high). - If someone has already used the wash function, wait about 3 minutes to use it. - Sit on the seat for approximately 3 minutes and then use it.
Body unit shakes	<ul style="list-style-type: none"> - Tighten the bolt (do not over-tighten)
Dryer does not work	<ul style="list-style-type: none"> - See if the skin sensor on the seat is touching the skin.

Maintenance

■ Cleaning the NOZZLE

Nozzle can be cleaned manually at any time without seat being occupied. Press () button for 3 seconds and nozzle will come out without Spraying water. After cleaning the nozzle, Press () button to retract nozzle.

NOTE: Only works on the simple operation keypad.

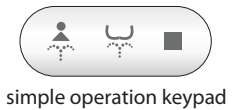
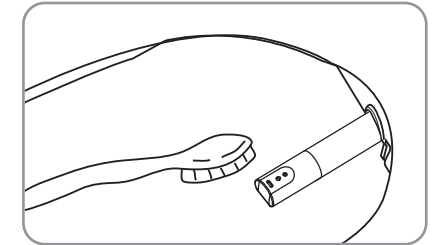

■ Cleaning the Strainer

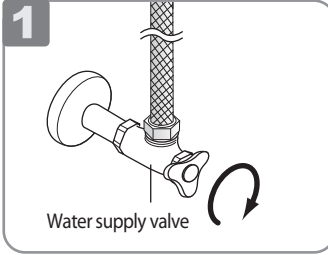
- 

Water supply valve

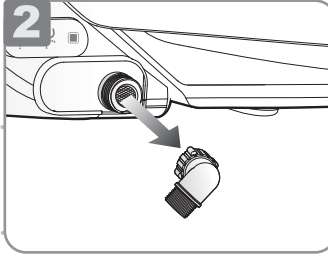
Close the shut off valve by turning the water valve to the right
- 

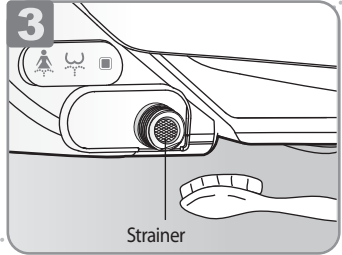
Separate the strainer by using a coin turn it to the left
- 

Strainer

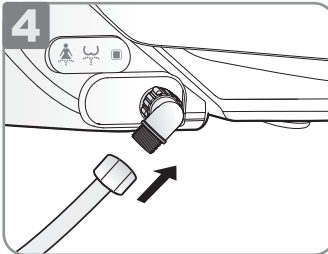
Clean the strainer with a small brush or water
- 

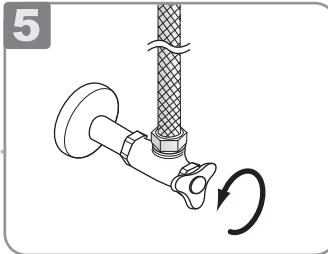
Re-screw the water strainer nut
- 

Open the shut off valve

* Checking leakage in valve connection

Storing

1 Disconnect the power plug

2 Shut the valve by turning it to the right

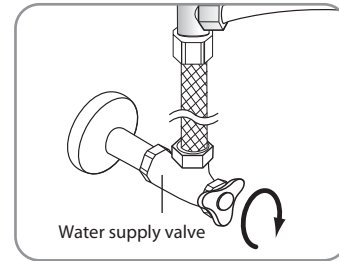

3 If you do not intend to use this product for longer, drain the water from this product

When pressing the drain button located on the side of the body unit, the water in the tank will completely drain into the toilet bowl

This electronic toilet seat has considered the user's convenience in that the water can be drained easily without removing the unit from the toilet seat

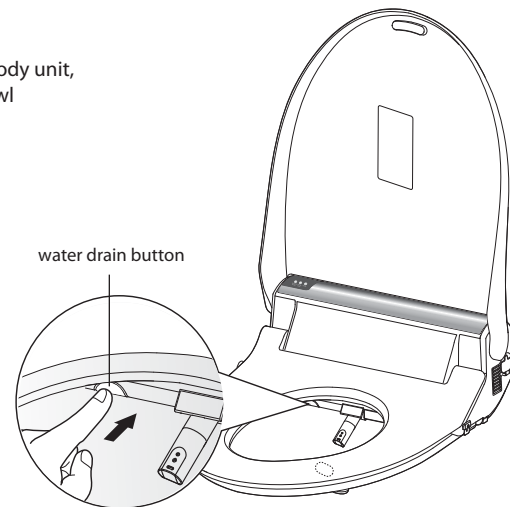

Maintenance for winter season

1 Check the power cord if it is plugged in or not

2 Connect power cord always to prevent water from freezing

3 If the product is not used for a long period of time, please disconnect the power cord and drain the water from the internal unit

4 Please do not keep this product outdoors during the winter as the cold temperature may damage the product

Specifications

Product Design and product standard of products for performance, without notice can be changed

Recommend water pressure is 1.0~7.0 kgf/cm²

Specification		ATS-2000R
Power rating		120V / 60Hz / 1,340W - 1,400W
Water inlet type	Type	Direct Inlet Flow Type
	Water inlet pressure	5.7 ~ 107 psi
Wash device	Wash	Max. 700cc ±80cc / min.
	Lady	Max. 750cc ±80cc / min.
	Water pressure adjustments	5 levels
	Warm water temperature control	Room Temp. 93.2°F, 98.6°F, 104°F
	Heater	1,340W - 1,400W
Heated Seat	Safety device	Manual type bi-metal, Thermal fuse, Temperature Sensor inlet & outlet
	Temperature control	Room Temp. 93.2°F, 98.6°F, 104°F
	Heater	55W
Warm Air Dryer Device	Safety device	Thermal fuse, temperature sensor in seat
	Warm air control	(Room temp. ~ 131° F, 5 levels)
	Heater	250W
Safety device		Thermal fuse
Purestream		○
Deodorizer		○
Economy mode		○
Inlet water temperature		41°F ~ 94°F (recommend 50°F ~ 94°F)
Ambient temperature		41°F ~ 94°F (recommend 50°F ~ 94°F)

Weight

10.6 lbs (Packed: 16.5lbs)
4.8kg (Packed: 7.5kg)

Dimensions

W: 15.4in, L: 20.9in, H: 6in
W: 392mm, L: 531mm, H: 152mm

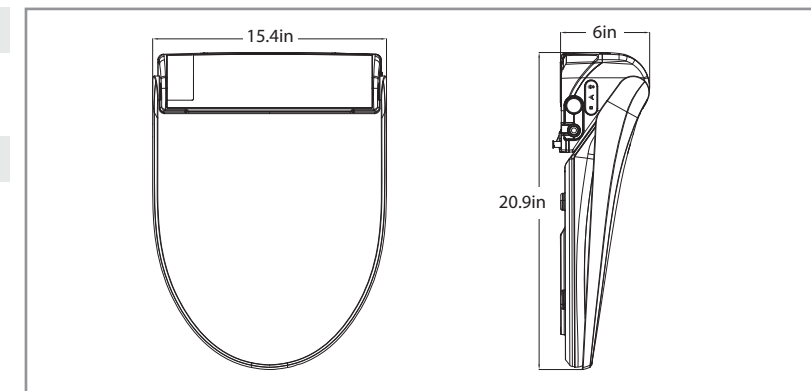

This equipment has been tested and found to comply with the limits for a Class B digital device, pursuant to part 15 of the FCC Rules. These limits are designed to provide reasonable protection against harmful interference in a residential installation. This equipment generates, uses and can radiate radio frequency energy and, if not installed and used in accordance with the instructions, may cause harmful interference to radio communications. However, there is no guarantee that interference will not occur in a particular installation. If this equipment does cause harmful interference to radio or television reception, which can be determined by turning the equipment off and on, the user is encouraged to try to correct the interference by one more of the following measures:

- Reorient or relocate the receiving antenna.
- Increase the distance between the equipment and receiver.
- Connect the equipment into an outlet on a circuit different from that to which the receiver is connected.
- Consult the dealer or an experienced radio/TV technician for help.

Warning

- Any changes or modifications not expressly approved by the manufacturer could void the user's authority to operate the equipment and limited warranty.

Warranty

1. Defects and/or malfunctions from failure to properly install, operate and/or maintain the unit in accordance with the installation manual
2. Damage from abuse, fire, flood, freeze, and any other acts of nature
3. Damage resulting from unauthorized alternations, attachments and/or repairs
4. If the product was not installed properly
5. Damage to the unit by animals, mice or insects
6. Damage caused by excess moisture or from water clogging the bathroom or rest room
7. Damage from not being installed in accordance with all applicable local codes, ordinances and good trade practices
8. Color fading due to use in wrong environment
9. Damage from chemicals
10. The warranty will not covered without providing the date of purchase with original receipt

WARRANTY REGISTRATION

To ensure your warranty protection you must complete and return this card with a copy of your receipt to us within 15 days after date of purchase to validate your warranty.

Model _____ *Serial Number _____

Purchaser

Name _____ Company _____

Address _____

City _____ Country _____

Phone _____ Fax _____ E-mail _____

Dealer (Company)

Name _____ Company _____

Address _____

* The serial number is located on the backside of the unit.

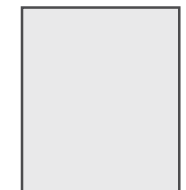

Lotus Hygiene Systems Inc.

1621 E. St. Andrew Pl.,
Santa Ana, CA 92705

1.877.808.0055
www.LotusSeats.com