



# Inline 100

AXIAL INLINE EXHAUST FAN

- Energy efficient high performance motor.
- Rated to 50,000 hrs continuous run time.
- Minimal noise level.
- Room to room air transfer.
- Ideal for cupboards, pantries and small spaces.
- Maintains healthy fresh air circulation.
- Easy fix mount brackets.
- AC Plug and lead included.

# Inline 100



## AXIAL INLINE EXHAUST FAN

Strong performance axial Inline exhaust fan suited for 100mm ducting. Easy install plug & lead included.



### DIMENSIONS

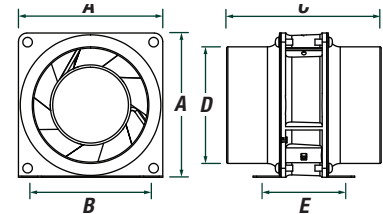

A	B	C	D	E
120mm	101mm	128mm	Ø97mm	69mm

### EXHAUST

- Air Volume:** 119m<sup>3</sup>H (33L/sec)
- Motor Power:** 18 watts
- Noise Level:** 40dB(A)
- Ball Bearing:** Yes
- Duct Outlet:** Ø100mm
- Speed (RPM):** 2700rpm

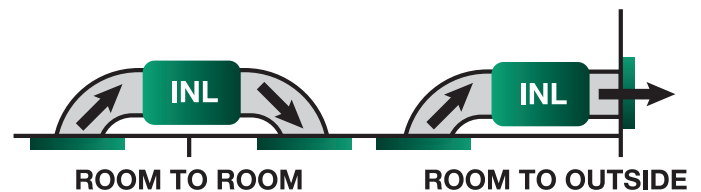

### INSTALLATION

- Duct Inlet/Outlet:** Ø100mm
- Recommended**
- Min Install Depth:** 150mm
- Power Input:** 220-240V~50Hz
- IP Rating:** IP44
- Installation:** AC Plug and Lead

### SHIPPING

- Packaging Size:** 145 x 170 x 145mm
- Gross Weight:** 1kg
- Carton Size:** 655 x 360 x 315mm
- Carton Weight:** 14kg
- Carton Qty:** 12 Pieces

### INCLUDES

- 1 x Inline Motor
- 1 x AC Plug and Lead

### AVAILABLE EXTRAS

- VAD100** Ø100mm 3m Alum Ducting
- VPVC100** Ø100mm 3m PVC Ducting
- VTROTIMER** 1-25min Run-on-Timer
- VTMSSENSOR** 1-20min Motion Sensor
- V100FG** Ø100mm external grille

Model	Outer Carton	EAN13 Barcode
 <b>INLINE 100</b> <b>INL100</b>	19339310009143	 9 339310 009146 >

**ventair**<sup>tm</sup>  
THE AIR MOVEMENT SPECIALISTS

- +61 3 9775 0556
- +61 3 9775 0775
- sales@ventair.com.au

4 Capital Place, Carrum Downs Vic 3201  
www.ventair.com.au