



product specification

www.oriel-lighting.com.au | quality lighting at affordable prices

GEL CONNECTOR

SKU:OLA16/314

12V GEL Connectors for garden lights

Description

GARDEN LIGHT 12V GEL CONNECTOR for DC garden light installations. Two required per light connection (supplied in a two-pack). Easy to use, with a protective gel to reduce corrosion on the wires. Suitable for use with our range of 12V garden lighting. The second image shows how the connectors are used to attach a light onto a 12v lighting circuit: the 12v cable is cut, one of each end is inserted into each gel connector, along with a wire from the light itself.

Additional information



Brand	Oriel Lighting
Colour	Clear
Indoor / Outdoor / Alfresco	Outdoor
Overall Height	1.5
Overall Width	2.5
Overall Depth	2.5
Item Dimensions	L25 W25
Fitting Length	L25
Fitting Width	W25
Fitting Other Dimension	Max Cable Diameter 4mm
Fitting Material	Plastic
Primary Material	ACRYLIC
Supplier Code	OLA16/314
UPI	9324879211888
DIY	A competent handy-person can DIY
Warranty / Guarantee	1 Year Replacement Guarantee

Images

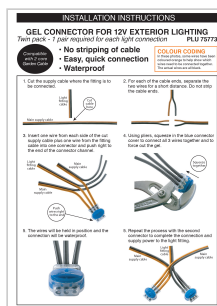

Unless stated, fittings do not include globes (bulbs). No representations are made as to the suitability of this product for your application. All fixed lights (other than DIY lights) should be installed by a licensed electrical contractor. Due to continuing product development, some specifications may change over time. Refer to our detailed Terms and Conditions, online at: www.oriel-lighting.com.au | Details and specifications are current at the time of printing, and with constant product development, subject to change.

(c) Oriel Lighting