

# Circa Recessed Wall Light Installation Guide

We strongly recommend that you read this manual carefully before installation.  
Installation MUST be carried out by a qualified and licensed electrician.



Replacement  
Warranty

## Models Parameters

MLXC33W	3W Recessed Wall Light 3000K White
MLXC33M	3W Recessed Wall Light 3000K Matt Black

## Installation Instructions

### Step 1

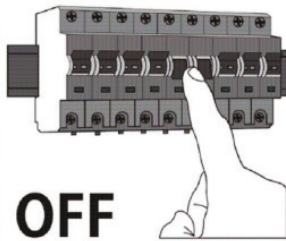

**OFF**

Switch off the mains.

### Step 2

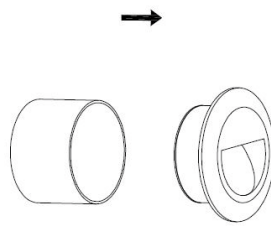

Unscrew and remove the mounting bracket.

### Step 3

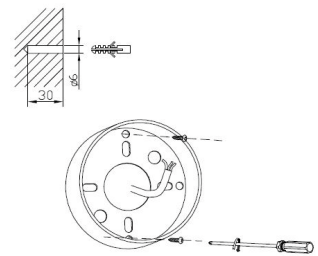

Mount the bracket on the desired surface using the two screws supplied.

### Step 4

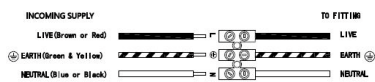

Wire to main as illustrated above.

### Step 5

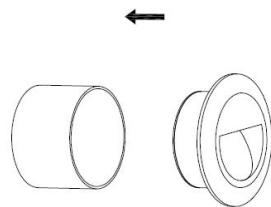

Attach fitting back onto the mounting bracket.

### Step 6

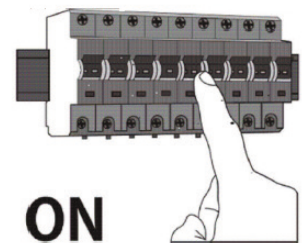

**ON**

Switch on the mains.

## Accessories Included

- 2x screws
- 2x wall plugs

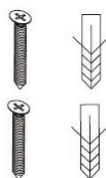

# Circa Recessed Wall Lights Installation Guide

Data Table

Models	Power (W)	PF	CCT (K)	Weight (KG)	Operation Temperature (Degree)	IP
MLXC33W	3	$\geq 0.5$	3000	0.3	+40° -20°	54
MLXC33M	3	$\geq 0.5$	3000	0.3	+40° -20°	54

## WARNING

- Installation of product **MUST** follow SAA standards and meet local authority regulations.
- Installation **MUST** be carried out by a qualified and licensed electrician.
- Light **MUST** be earthed.
- Light **MUST** be firmly installed to a flat solid surface, wall or ceiling.
- **DO NOT** immerse any part of the light fitting into water or any form of liquid.
- **DO NOT** look directly into the LED light.
- The warranty is **VOID** if product is not installed according to this installation guide.

## 2 Year Replacement Warranty

Visit our website for details <https://www.martecaustralia.com.au/warranty-statement/>

