

INSTALLATION INSTRUCTIONS AND CUT OUT TEMPLATE



MARVEL 3-IN-1 BATHROOM MATE

Model No. :	21478/05	21478/06
Colour :	White	Black

Congratulations on the purchase of your new quality Brilliant Bathroom Heater. Before first using, it is most important that you read and follow the instructions in this Installation Manual, even if you feel you are quite familiar with this type of product. Find a place and keep this manual handy for future reference.

THIS BATHROOM HEATER MUST BE INSTALLED BY A QUALIFIED ELECTRICAL CONTRACTOR in accordance with the latest AS/NZS 3000 and relevant amendments. AN ELECTRICAL SAFETY CERTIFICATE MUST BE ISSUED ON COMPLETION OF THE INSTALLATION

FOR YOUR SAFETY:

- This product must be used only as described in this manual. Any other use not recommended by the manufacturer may cause fire, electric shock, or injury to persons. If you have questions, contact the manufacturer or local agent.
- All wiring must be carried out by a licensed electrician in accordance with all applicable national / local codes and standards. Also check with the local council regulations regarding installation of exhaust fans.
- Any alterations or additions to building wiring must be completed by a licensed electrician or person authorised by legislation to work on the fixed wiring of any electrical installation.
- Be aware of the height of your installation. Refer to 'Working at Heights' guide from your local or State Authorities.
- Ensure the power is OFF before the installation.
- When cutting into the ceiling material, care must be taken to ensure you do not damage electrical wiring and other hidden utilities.
- The heater must be properly earthed/grounded.
- The heat lamp is extremely hot when in use. Do not touch the heat lamp with any part of your body when in use. Allow the lamps to cool sufficiently before touching or replacement.
- For the purpose of avoiding any fumes leaking into your bathroom, the duct for the heater must not be laid together with ducts for air-fuelled water heaters or other open-fire appliances.
- Power cable used for wiring must be rated for a minimum 10A load. (Refer AS/NZS 3000 requirement)
- This appliance is not intended for use by persons (including children) with reduced physical, sensory or mental capabilities, or lack of experience and knowledge, unless they have been given supervision or instruction concerning use of the appliance by a person responsible for their safety.
- Children should be supervised to ensure that they do not play with the unit.

IMPORTANT NOTE:

- The important safeguards and instructions given in this manual are not meant to cover all possible conditions and situations that may occur. It must be understood that common sense, caution and care are factors which cannot be built into any product. The persons caring for and using the unit must supply these factors.
- The unit must be installed in accordance with AS/NZS 3000 and relevant amendments, and all local building codes relating to damp locations.
 - Before commencing any cutting, check in the ceiling space that there are no obstructions such as ceiling joists and that there is sufficient height clearance (at least 100mm) above the unit. Check that the electrical wiring can be routed from the wall switches to the mounting location.
 - Ceiling insulation should be kept well clear of the unit and all ducting equipment.
 - The unit should **NOT** be installed directly above a shower or bathtub.
 - The unit must **NOT** be installed where it will be subject to direct splashing.
 - Your Bathroom Heater is designed for installation in flat ceilings only. Do not install on a sloping ceiling or a vertical wall.
 - The Infra-Red heat lamps are not designed to heat the entire room area, they provide instant heat to persons standing directly below them. Install your Bathroom Heater above the area where 'drying off' usually occurs.
 - Your Bathroom Heater is not been designed for extended periods of operation, as this could cause overheating and premature failure.
 - For the exhaust fan to work efficiently, replacement air of a volume equivalent to what is being extracted must be able to enter the room. In general this air would be drawn under the door, or through a slightly open window. If the room is airtight, the fan will function poorly. If roof cavity is restricted or not well ventilated it is recommended that duct and vent be used to extract steam to an outside area.

WARNING:

- To prevent injury, this apparatus must be installed by a Licensed Electrical Contractor.
- For indoor use only
- Do not attempt to press touch switch at very high frequencies (faster than one switch per second) as this may result in premature failure.
- If the switch is used to operate appliances intended for supervised use (eg. heater), ensure that the appliance instructions are followed and the appliance is physically supervised whilst on. Do not allow any cables, furnishings, flammable materials or other items to come in contact with any surface of a heater.

CLEARANCE REQUIREMENT:

- This unit must be mounted at least 250mm away from vertical walls.
- A minimum clearance of 100mm is required above the top of the unit.
- Additionally a minimum of 75mm clearance is required between the sides of unit and joists, walls or insulation.

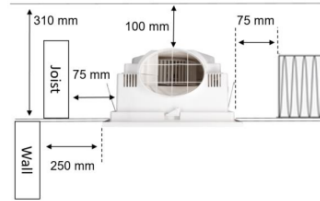

INSTALLATION

- CAUTION:** Before installing the heater, make sure you have turned OFF the electricity supply.
- Your MARVEL Bathroom Mate heater has been designed for use on ceilings between 2.4 and 2.7m in height. 75mm minimum clearance is required near all ceiling joists.
- Mark the ceiling with a pencil outline 475mm x 325mm, and cut out a hole in the ceiling at the chosen area Fig. 1. Make sure a distance between the edges and wall is no less than 250mm. There should be a minimum 100mm clearance above the unit.
- Before commencing any cutting, check in the ceiling space that there are no obstructions such as ceiling joists, cables or pipes.
- To remove the fascia panel, pull the fascia panel out and unclip the spring wires then pulling away from the main body.
- Twist and unplug the LED connectors, make sure not to damage the LED panel.
- Insert the Heater unit into the hole, ensuring that the 6 fasteners are at closed position so that the unit can pass through the hole without damaging the ceiling.
- Securely fix the unit by using a screw driver to screw the 6x fasteners clockwise until the screws are tight. Fig. 2. **NOT OVER TIGHTEN** the screw, this will damage the plaster board, but ensure it is secure.
- Reattach the LED connectors and fascia panel back to the unit.
- For installation where external venting is required or is your choice, select a suitable location in either the roof or exterior wall to vent out the exhausted air/steam and cut out a 150mm hole.
- Put the ventduct into the vent hole and seal the space around the hole using a suitable sealant and coving where necessary.
- Fit the in-house end of the duct to the fan outlet, and fix the end with duct clip / cable tie. Ensure that the ducting is kept as straight as possible.

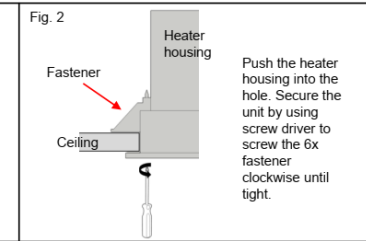
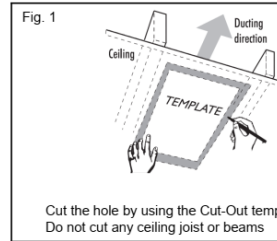

WIRING DIAGRAM & TECHNICAL PARAMETERS

INPUT VOLTAGE :	230/240V AC 50Hz	MOTOR POWER :	55W
TOTAL POWER :	1100W	LED PANEL :	2 X 8W LED, CCT 3000K / 4200K / 6000K
CONSTRUCTION :	Class I	IP RATINGS :	IPX2
SWITCH :	3 Gang 250V 15A	DUCT SIZE :	Ø 150mm
HEAT TUBE :	1 x 1000W 240V 50Hz R7	APPLICATION :	Zone 3 in bathroom, * Refer to AS/NZS3000

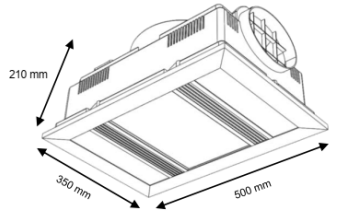
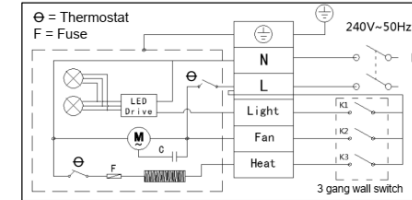

NOTE: The exhaust fan will automatically turn on to keep operating temperatures in the optimum range.

ELECTRICAL WIRING:

- NB: This unit is fitted with thermostat switch which will operate to automatically switch the exhaust fan on, in the event that the heat lamp are left on, and the internal temperature of the unit exceeds 50°C.
- Ensure that the power is turned OFF before carrying out any work on electrical installations.
 - Clip the switches to the backing plate in the desired order, and install the plate onto the wall.
 - Connect the wiring to the three switches as per the electrical diagram.
 - Remove the terminal cover on the heater unit, and wire according to the label adjacent to the terminal block. Ensure all cables are securely connected before refitting the terminal cover.
 - Clean the fascia and LED panels with a soft damp cloth, and switch the unit ON, checking operation of all functions

OPERATION:

Your MARVEL bathroom mate heater uses Infra-Red heating lamps as a source of heat. It also combines the functions of exhaust and light.

Heating:

- Turn ON/OFF "Heat" button to activate the heater. The exhaust fan will automatically turn on to keep operating temperatures in the optimum range.
 - The heater is supplied with 1 x 1000W Infra-Red Lamp.
- Exhaust Fan:
- Turn ON/OFF "Fan" button to activate the fan.
 - The Fan will exhaust odours and steam in a quick and efficient manner.

Lighting:

- Turn ON/OFF "Light" button to activate the LED lights.
- To change the colour temperature, turn the "Light" button OFF and ON fast.
- To maintain the colour temperature you choose, after turning OFF the "Light" button wait at least (20 to 30 seconds) before turning ON the "Light" button.

INSTALLATION INSTRUCTIONS AND CUT OUT TEMPLATE



MARVEL 3-IN-1 BATHROOM MATE

Model No. :	21478/05	21478/06
Colour :	White	Black

CLEANING:

- Switch OFF power before commencing cleaning, and allow unit to cool to room temperature.
- Regularly wipe fascia using a soft cloth soaked with neutral detergent. Ensure the unit has cooled to room temperature before handling.
- Ensure Lamp holders are free from any foreign objects and/or dust.
- The centrifugal fan requires regular cleaning to ensure optimum performance. With the power OFF, regularly wipe the fan clear of all dust and dirt.
- Clean the exhaust ducting kit, ensuring there are no obstructions at the exit.
- Use only a soft damp cloth to clean your Brilliant Bathroom Heater. If detergents are required, use only a neutral detergent that will not damage the fascia.

REMOVING / REPLACING THE HEAT LAMP:

- Ensure to switch OFF the main power before removing / replacing the heat lamp, and allow the unit to cool to room temperature. (Fig. A)
- To remove the fascia panel, pull the fascia panel out and unclipping the spring wires then pulling away from the main body. Twist and unplug the LED connectors, ensure to not damage the LED panel. (Fig. B)
- Unscrew the screws at both end of the glass fixing bars. (Fig. C) Then carefully slide the glass out. (Fig. D)
- To remove the heat lamp, push the lamp toward direction "1" then gently pull the lamp out "2". (Fig. E) as both ends of the lamp holder secures the lamp via springs.
- To replace the heat lamp, place the lamp into the lamp holder "1" then gently push the lamp into the other end. Ensure the heat lamp coated side facing the reflector. Ensure that the lamp is securely sitting in the lamp holders.
- Carefully slide the glass back. (Fig. G) Replace the glass fixing bars previously removed and ensure screws are tightened. (Fig. H)
- Replace the fascia panel (Fig. I) Reconnect the LED plugs carefully and ensure the screw plugs are tightened.
- Ensure the fascia panel is alighted and sits properly in the housing. (Fig. J)
- Reconnect the main power supply. (Fig. K)
- Turn On the wall switch to test the heat lamp.

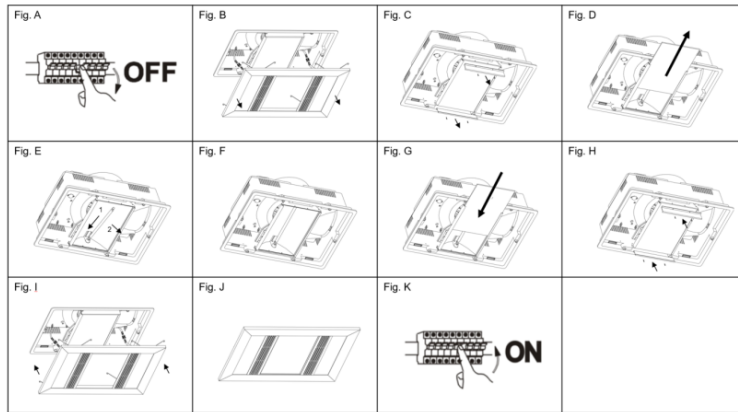

4

SPARE PARTS:

PRODUCT	DESCRIPTION	CODE
LED Driver	DC48-72V 0.24A 16W Max 80V	21478SP001
HEAT TUBE/LAMP	1 X 1000W 240V 50Hz R7	21478SP002
FROSTED GLASS	Frosted tempered heat resistant glass	21478SP003

WARRANTY:

The original purchaser of this Bathroom Heater is provided with the following warranty subject to the following conditions

Brilliant Lighting warrants this product against defects in manufacture and workmanship for a period of 3 years from date of purchase. For products used in non-domestic or commercial applications, Brilliant Lighting warrants this product for a period of 3 months from date of purchase. This warranty is only valid for products installed by a qualified electrical contractor and operated within the guidelines specified by Brilliant Lighting, and within the correct operating voltage ranges as stated on the product's rating label.

Warranty does not include damage or loss arising from incorrect installation, operation or maintenance of this product, damage caused through modification, incorrect installation, and service by unqualified or unauthorised personnel or lack of regular maintenance and cleaning. Proof of installation by qualified personnel may be required, eg. Electrical Safety Certificate. Proof of purchase must be supplied with all warranty claims.

This warranty is provided in addition to any other rights and remedies of the customer under any law. In applications not intended for household, personal or domestic use, liability is limited to replacement or reimbursement of product only. Brilliant Lighting does not warranty the costs of removal or re-installation of this product or associated components.

Our goods come with guarantees that cannot be excluded under the Australian Consumer Law. You are entitled to a replacement or refund for a major failure and compensation for any other reasonably foreseeable loss or damage. You are also entitled to have the goods repaired or replaced if goods fail to be of acceptable quality and the failure does not amount to a major failure.

Any claim under this warranty must be made within 3 years of the date of purchase of the product. To make a claim under the warranty, at your own expense take the product (with proof of purchase – receipt or similar) to the store where you purchased the product or contact Brilliant Lighting at the address below.

This warranty is given by:

Brilliant Lighting (Aust) Pty. Ltd.
 ABN 37 006 203 694
 956 Stud Road Rowville, VIC 3178
 Phone: 03 9765 2555
 Email: warranty@brilliantlighting.com.au
 Website: www.brilliantlighting.com.au
 MADE IN CHINA

5

475 mm

325 mm