

DOULTON® / FAIREY® WATER FILTER

Countertop Water Filter – Operating & Exchange Instructions



Caution : Working Temperature : 5°C ~ 38°C and Water Pressure : 5 bar

Installation : (It is important to wash your hands thoroughly after servicing the Filter)

T1 (Near “IN” white plastic hose) KDF / Fluoride

1. Unscrew the Sump from the Base.
2. Remove ceramic cartridge (Fig.A) from its protective Sleeve.
3. Screw the candle on to the base with the hole end. **Do not Over tighten.**
4. Screw the threaded sump into the Base. **Hand tighten only.**

T2 (Near “Out” Inverted J-shaped hook tube) Ceramics Filter

5. Repeat step 1 - 4.
6. **Connecting Pipework and Fittings:** Screw the diverter valve to the cold tap or mixer tap (Fig.1) if a male thread is visible. If not, an approved adapter will be required to convert to the relevant threads. If the thread is not enough to allow full contact with the washer, add the space onto the existing washer.

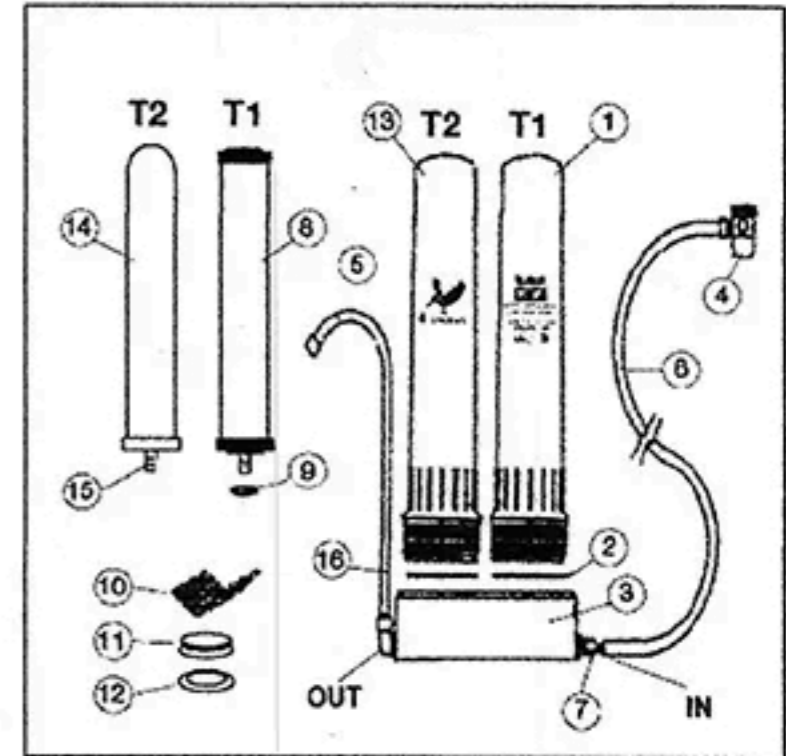

Note : Allow the water to run for a minimum of 5-10 minutes or 20 liters, allow the filter to stand for 8 hours to condition the filter to the water source and then let the water run for 2 minutes or 3 liters of water to waste. After carrying out this procedure the filter is now ready for use.

visit www.doulton.com.sg / email to us: admin@doulton.sg for after service & support!

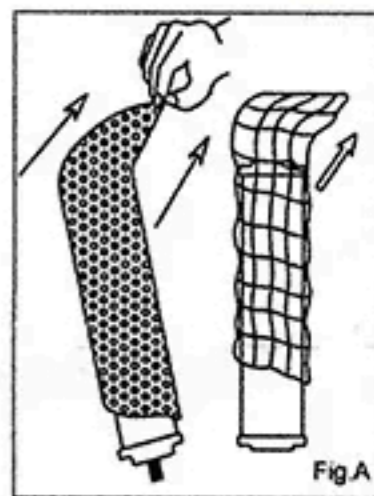

1. Conditioning the Filter

The Filter unit should now be ready for drinking. To avoid any problems caused by air-locks in the filter housing, the unit should be held flat down in the kitchen sink with the sump only 3/4 tightened. Turn on the cold tap partially then pull the knob on the diverter valve outwards to allow water to slowly fill the unit for the first time until water appears through the connection between the sump and the head. Turn off the water and tighten the sump fully.

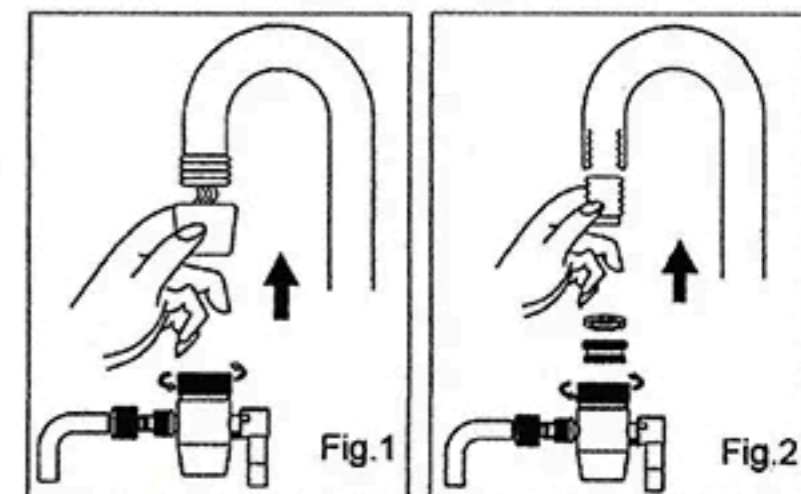

2. Servicing the Filter

Cleaning(Fig.B), removal and replacement of filter cartridge is carried out as follows:
With the cold tap turned off, hold the filter unit upside-down over the sink unit. Unscrew the sump which will be full of water, from the lid. The cartridge can now be removed from the base and cleaned in accordance with operating and exchange instructions, or replaced as described in 2. After a new cartridge has been re-installed, recondition the filter as described in 1.0

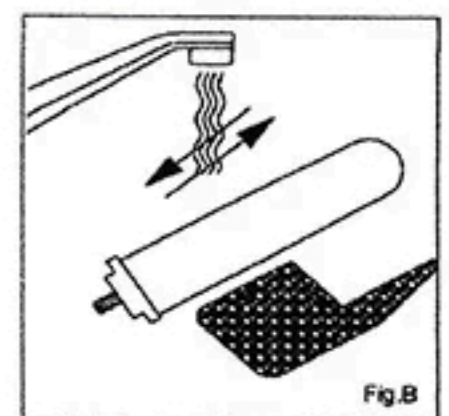

3. Replace Cartridge :

Flouride Pre-filter : 3 months ; KDF Pre-filter & Ceramics Filter : 6 - 12 months

Filter Cartridge has a service life which is according to water quality and water consumption.