



Installation / User Manual

**Roller Tensioner for Narrow, Standard & Wide
Drums (S100500, S100501, S100502)**



Superwinch Ltd

Unit E1, Union Mine Road
Pitts Cleave, Tavistock
Devon. PL19 0NS
Tel: +44 (0)1822 614101
Fax: +44(0)1822 615204

Superwinch LLC

359 Lake Road,
Dayville, CT 06241
U.S.A
Tel: (860) 928 7787
Fax: (860) 928 1143

Superwinch LLC

20750 SW 115th Ave
Tualatin, Oregon 97062
U.S.A
Tel: (860) 412 1480
Fax: TBD

Contents

CAUTION STATEMENT 4

Introduction: 4

Installation: 5

Use: 10

Maintenance: 10

Parts Diagram:..... 11

Warranty: 12

CAUTION STATEMENT

Please read entire contents of document before installation. Failure to do so could result in injury or Superwinch LLC / Superwinch LTD is not responsible for improper installation of equipment or failure to adhere to cautions and warnings.

Introduction:

This device is designed to aid in the storage and feed out of wire rope and to keep tension on the rope during no load conditions; therefore, increasing winch and rope life. This device is not intended to be used with synthetic rope.

WARNING! – All procedures in this installation / user manual must be followed. If instructions are not followed, severe injury, bodily harm, and or property damage could occur.

WARNING! – Superwinch winches are not to be used to lift, support, or otherwise transport persons. Any such use shall be considered to invalidate the warranty and Superwinch shall not be held responsible for any claims arising from such use.

WARNING! – Personal protective equipment (safety glasses and leather gloves) must be worn at all times during installation of tensioner.

Installation:

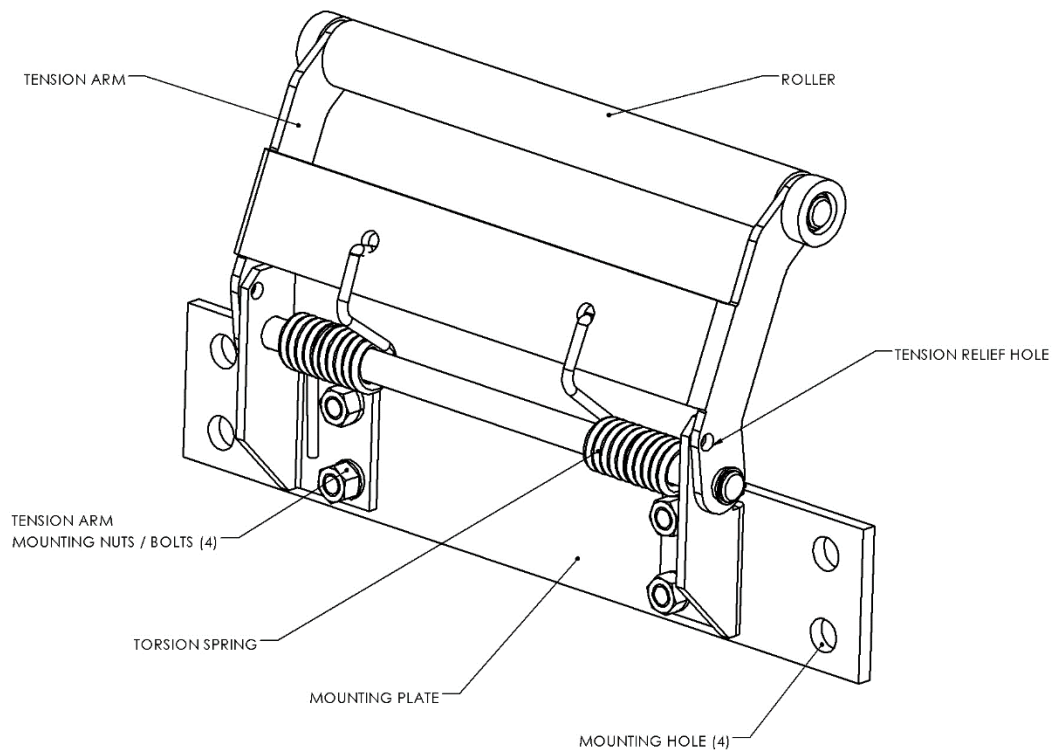

Figure 1 - Tensioner Terminology

1. Roller tensioner is installed differently based on how the rope is fed onto the drum of the winch. Select which mode the installation will be made before installing tensioner.
WARNING! – Do not attempt to remove tension arm mounting nuts / bolts. This could result in permanent injury or damage to tensioner and / or other property.

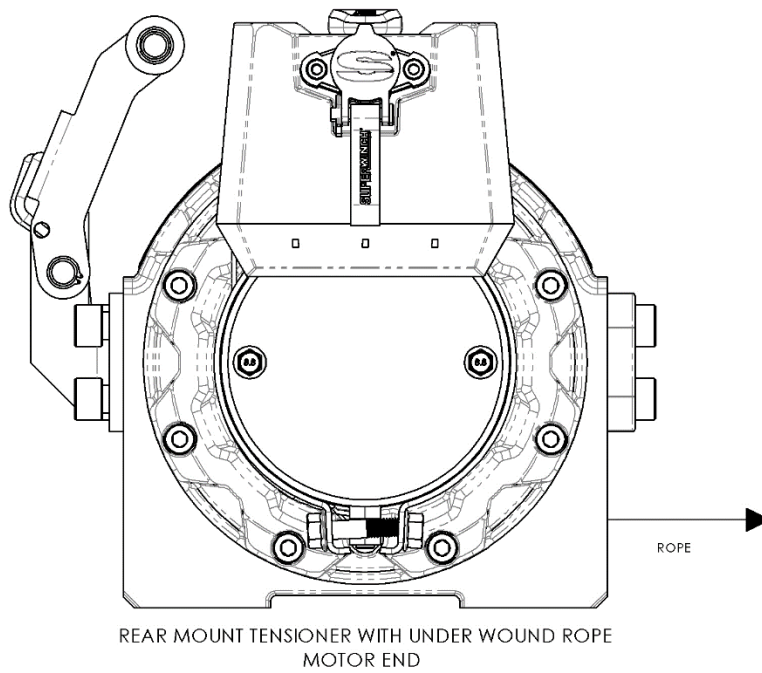

Figure 2 - Rear Mount

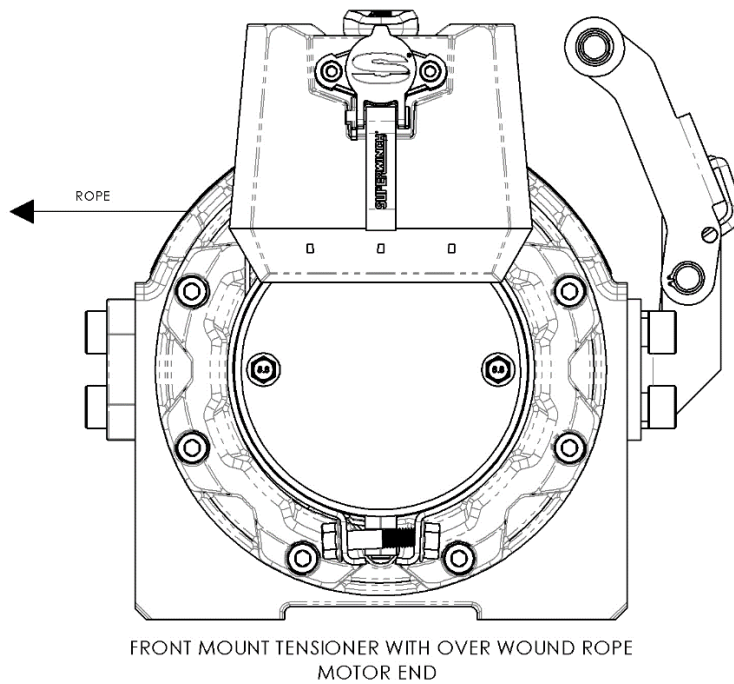

Figure 3 - Front Mount

2. Tensioner will come pre-tensioned. If it becomes necessary to remove tensioner from winch, pre-tensioning will be required before beginning re-installation. To accomplish

this, place tension mounting bar in vise. Carefully tension spring until tension relief holes (shown in figure 4) line up. While under tension, place 6mm dowel pins in relief holes and slowly release tension on roller.

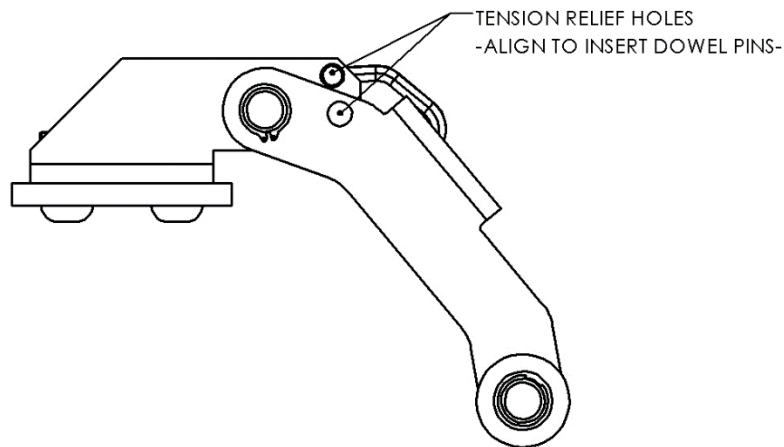

Figure 4 - Tension Relief Holes

3. Installation of tensioner may be accomplished with winch installed or uninstalled on intended equipment.
4. For purposes of this manual installation will be on rear mount with and under wound drum. For other installation adjust instructions for applicable install. Support winch on solid surface and remove appropriate tie bar. Set tie bar bolts aside for use with installing tensioner. (see figure 5)

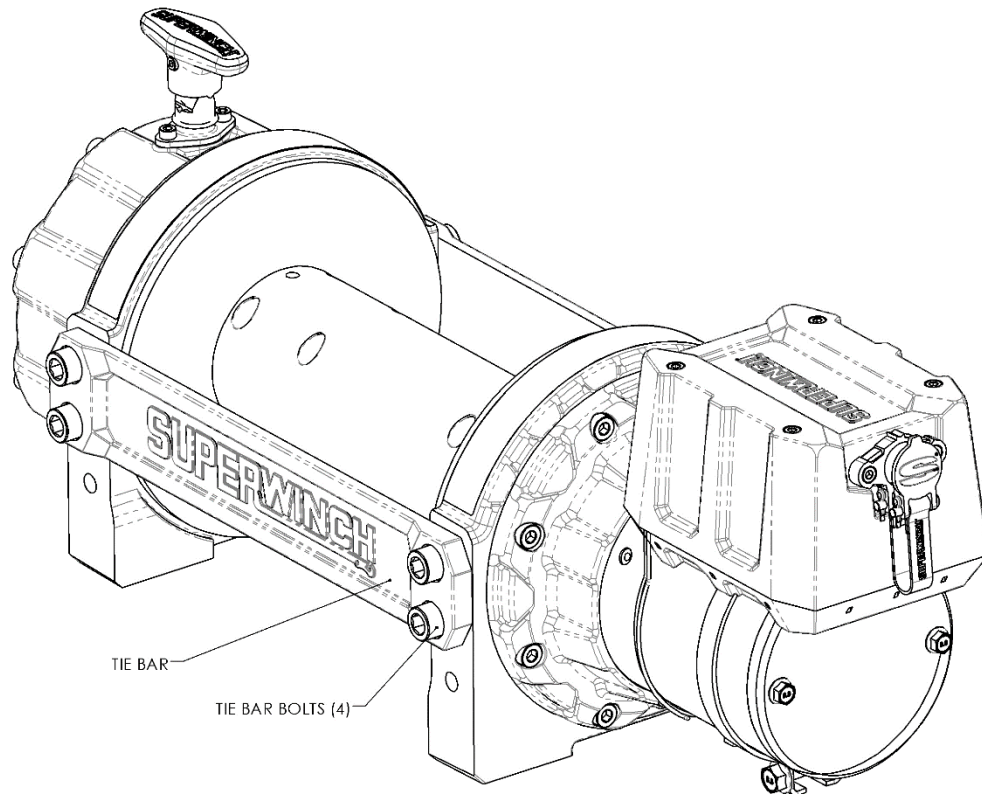

Figure 5 - Tie Bar Location

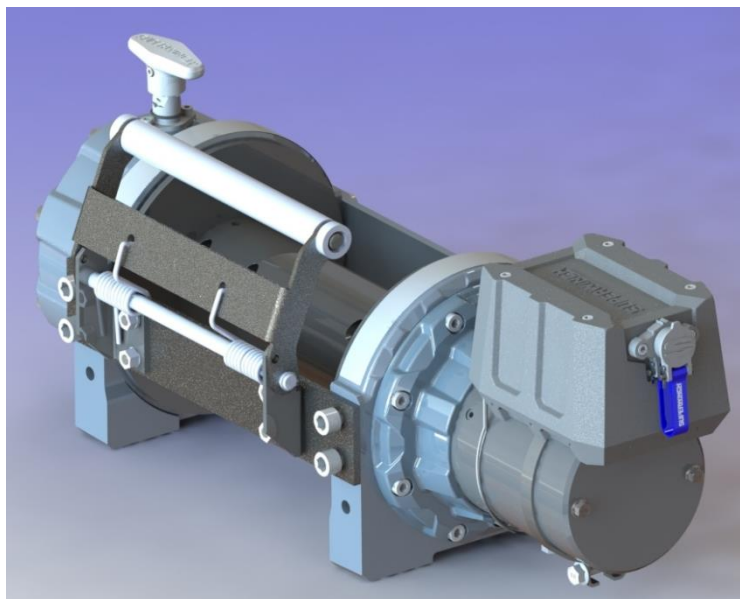

Figure 6 - Tensioner Mounted

5. Align tensioner as shown in figure 6 and reinstall all four tie bar bolts to 80Nm (59lb*ft)
Carefully pull tensioner away from drum (assuming winch is mounted) and remove

dowel pins from tension relief holes. Ensure that rollers fit between drum flanges without contact with drum flange.

WARNING! – Tensioner is fitted with extremely high strength torsion springs. Keep hands away from springs, roller arm and their vicinity.

6. With tensioner applied, disengage winch clutch and remove all rope from drum. Check that the set screw is tight and / or rope is properly tied to drum.
7. Re - engage winch clutch and carefully “winch – in” with light tension (wearing gloves) on the rope for 5 – 6 wraps. Ensure wraps are tight and neatly wrapped.
8. Apply moderate tension to rope and carefully winch in ensuring wraps are neatly wrapped onto drum until all rope is fully seated on drum.

Use:

WARNING! – Tensioner is fitted with extremely high strength torsion springs. Keep hands away from springs, roller arm and their vicinity.

WARNING! – Beware of the pinch / trapping hazard between drum (rope) and tensioner.

WARNING! – Always use hand saver, supplied with winch, to guide hook for last meter of rope.

1. Ensure that wire rope / synthetic rope is neatly wrapped onto drum in smooth layers at all times. An unevenly wrapped rope will drastically reduce the efficiency of the tensioner.
2. Operate the winch as normal. If in doubt, consult the winch Owner's Manual.

Maintenance:

WARNING! – Tensioner is fitted with extremely high strength torsion springs. Keep hands away from springs, roller arm and their vicinity.

1. Periodically refit the wire rope when necessary to keep it neatly wrapped and thus the tensioner working efficiently.
2. Check all fasteners for tightness at regular intervals to ensure safe operation of winch and tensioner.
3. Check tension roller for wear. Excessive deterioration can lead to failure or rope damage.
4. Lubricate roller pin at regular intervals with a general purpose grease.

Parts Diagram:

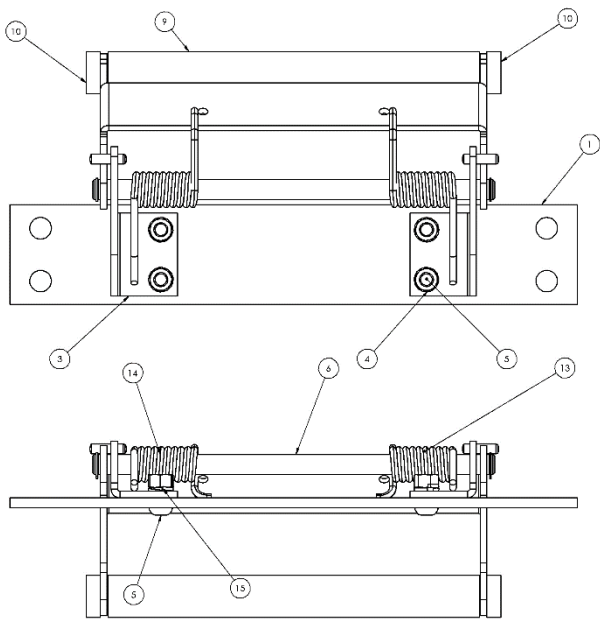

ITEM NO.	DESCRIPTION	Default/ QTY.
1	TIE BAR,CABLE TENSIONER- STD.	1
2	BRACKET, SUPPORT, R.H.	1
3	BRACKET, SUPPORT, L.H.	1
4	NUT, M8 X 1.25	4
5	BHCS, M8 X 1.25 X 20MM	4
6	SPRING SUPPORT PIN, STD.	1
7	ROLLER PIN, STD.	1
8	ROLLER ARM, STD.	1
9	ROLLER, STD.	1
10	ROLLER	2
11	SNAP RING	2
12	CIRCLIP	2
13	TORSION SPRING	1
14	TORSION SPRING	1
15	M8 SPRING WASHER	4
16	PIN-Dowel-6mm x 22mm	2

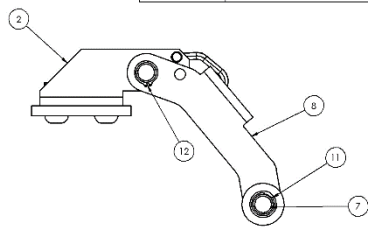

Warranty: