

# USER'S MANUAL

## SMART LOCKS



DH101 Smart Door Lock -  
Deadbolt



# DH101

Smart Door Lock - Deadbolt

**DIGITAL HOME**  
Making your home SECURE. And a SMART one

## FEATURES

- Virtual Key Access
- Access Expiry
- Backup Key
- Security Lockout Mode
- Low power consumption
- Emergency Power
- Anti-peep Touchscreen
- Time and Attendance

## DETAILS

**Technology:** Synchronization

**RFID access:** 200

**PIN Code access:** 1000

**Mobile App access:** 1000

**Door Thickness:** 38 - 50 mm

**Dimension:** 60 x 142 x 30 mm

**Batteries:** 4pcs AAA

**Weight:** 1.5 kg

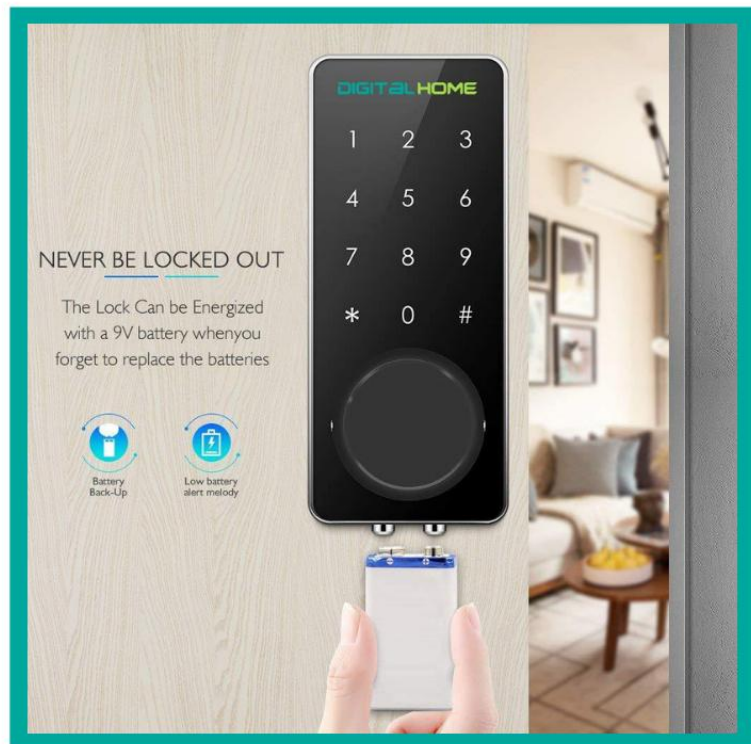

## MODE OF ACCESS

Mobile App

PIN Code

RFID Card

Mechanical Key

works with the Google Assistant

WORKS WITH amazon alexa



SCAN ME

# **Installation Guide**

# **Smart Deadbolt**

# **Lock**

# Specifications

<b>Model</b>	DigitalHome Smart Doorlock
<b>Material</b>	Zinc Alloy
<b>Current Rating (Standby)</b>	~30uA
<b>Current Rating (Active)</b>	~200mA
<b>Batteries</b>	4 x AA Alkaline (Non - Rechargeable)
<b>Unlock Mechanism</b>	Bluetooth, PIN code, Keys

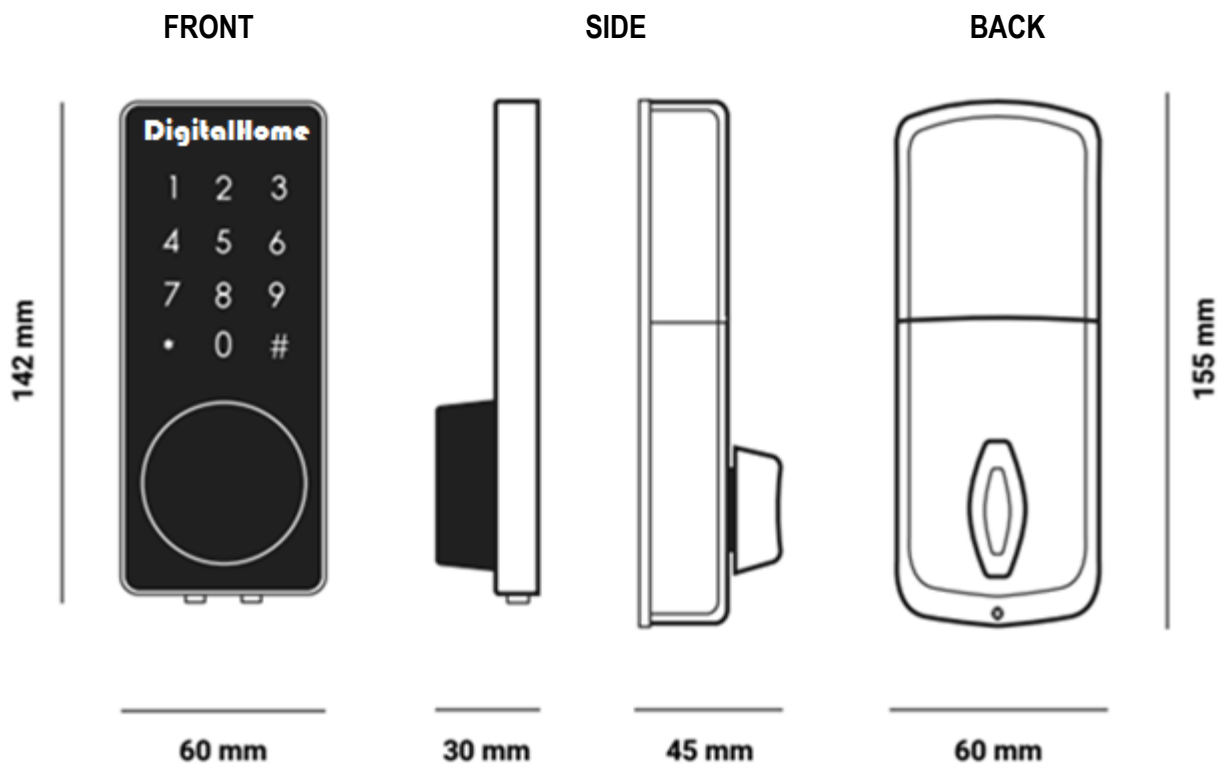

# Requirements

## Clearance from Door Edge

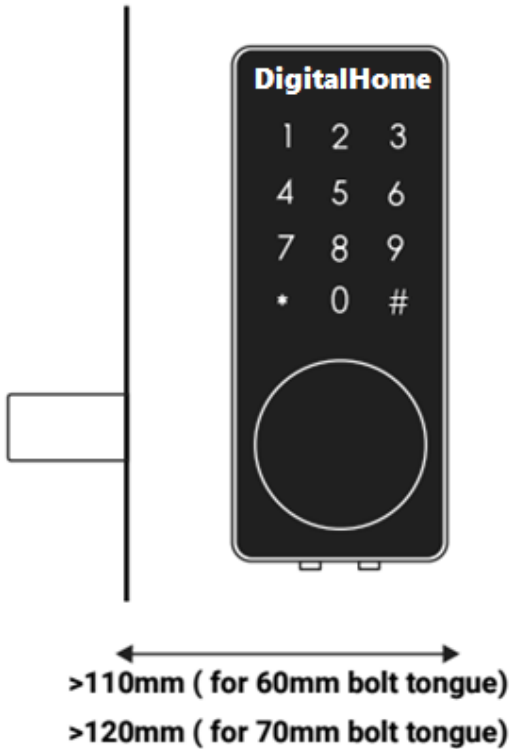

## Door Thickness

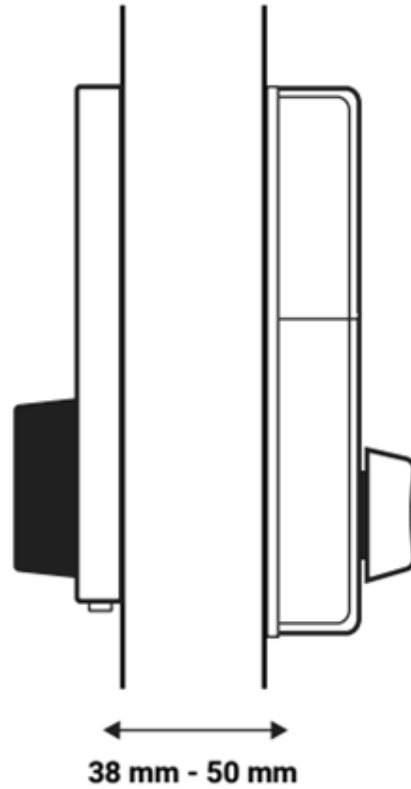

Door and door frame material: Wood (Recommended)  
Gap between door and door frame: <3mm (Recommended)

\*Please ensure that there is an existing handle on your door for push - pull access

\* Not for: metal gates, glass doors or sliding doors. If you are unsure if your door is suitable, send us web links to your door pictures to [support@digitalhome.ph](mailto:support@digitalhome.ph)

# What's Included



Front Assembly



Rubber Gasket

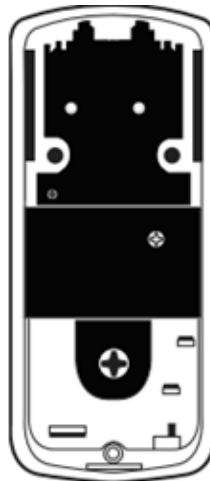

Back Assembly

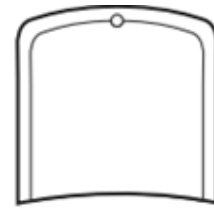

Battery Case Lid

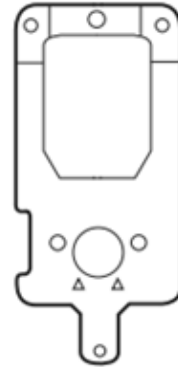

Back Plate

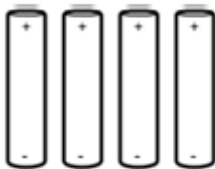

AA Batteries



Keys

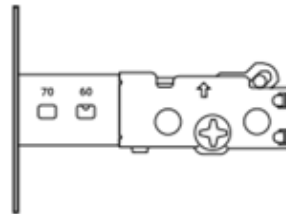

Bolt Assembly



Strike Plate

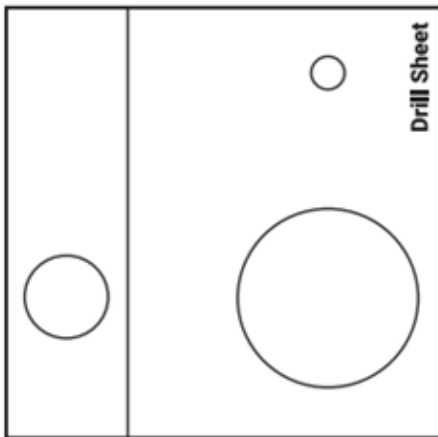

Drill Sheet



5 mm  
Bolt Screw



25 mm  
Wood Screw



22 mm  
Bolt Screw



40 mm  
Bolt Screw



Screw  
Holder



Strike Plate  
Housing

# Recommended Tools

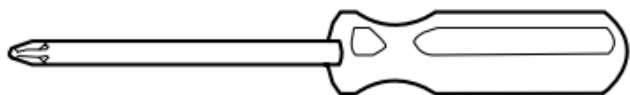

**#2 Phillips Screw Driver**

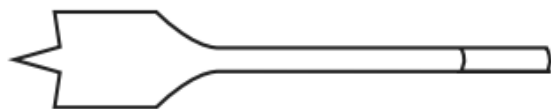

**25mm Spade Bit**

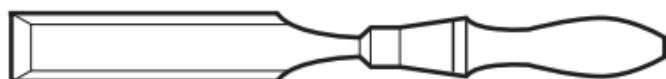

**Chisel**

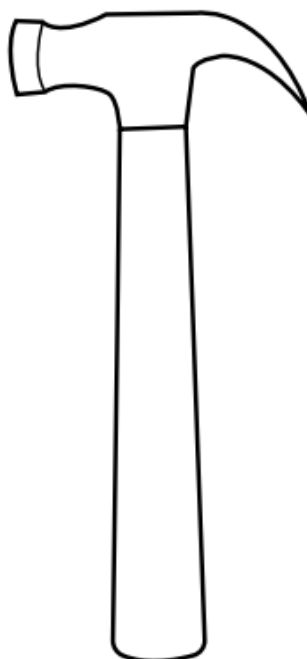

**Hammer**

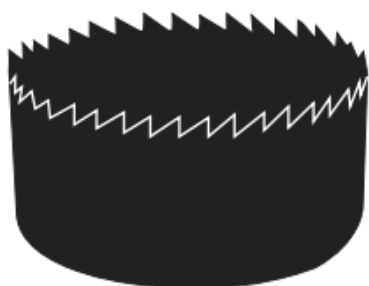

**54 mm Hole Saw**

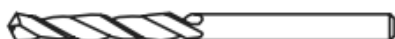

**10 mm Drill Bit**

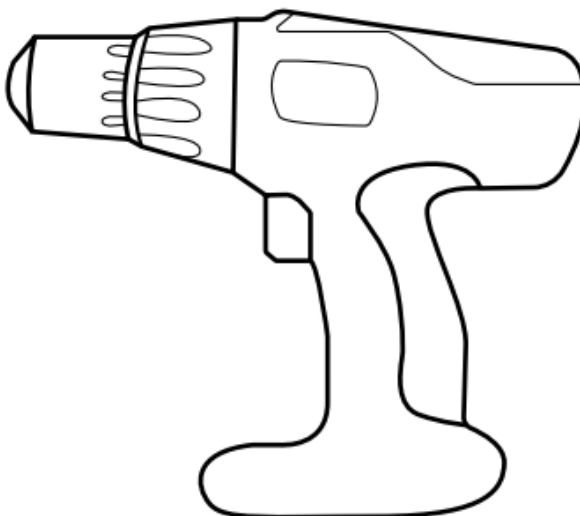

**Drill**

# Installation Type

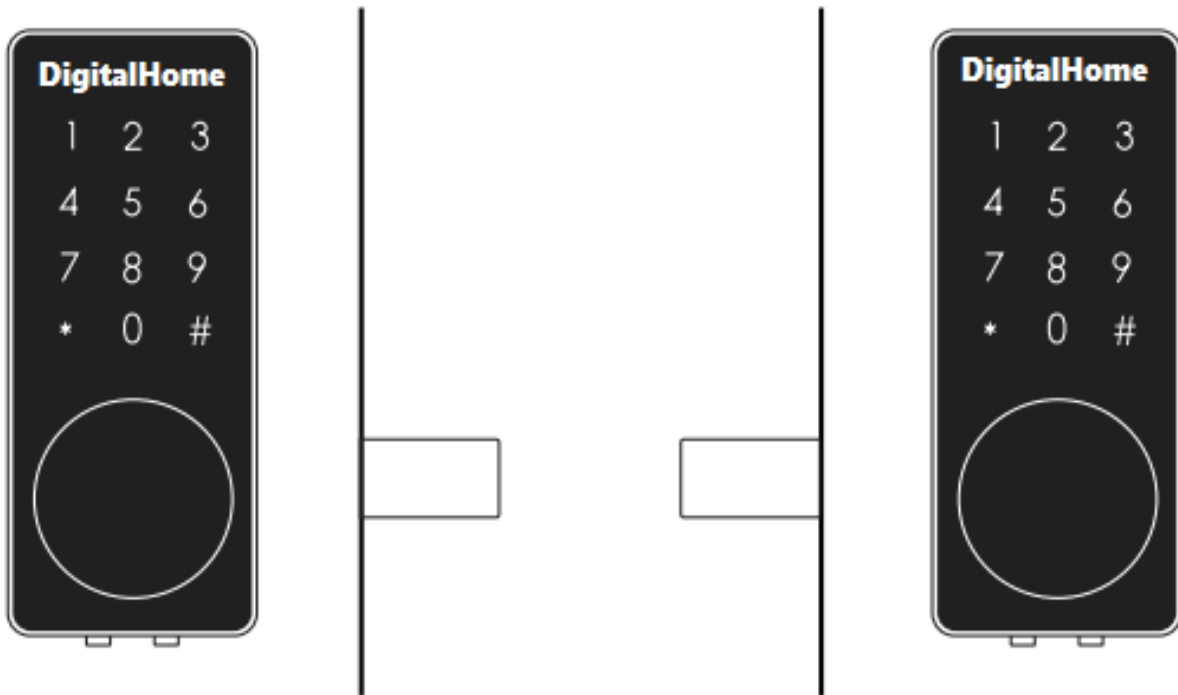

**a. Right installation**

**b. Left installation**



# Drill holes on door (For new installation)

1. For new doors or doors without existing deadbolt lock, you will need to drill holes in your door to mount your deadbolt. Use measurements provided on the Drill Sheet to drill holes in the door.

**Left installation**

**Right installation**

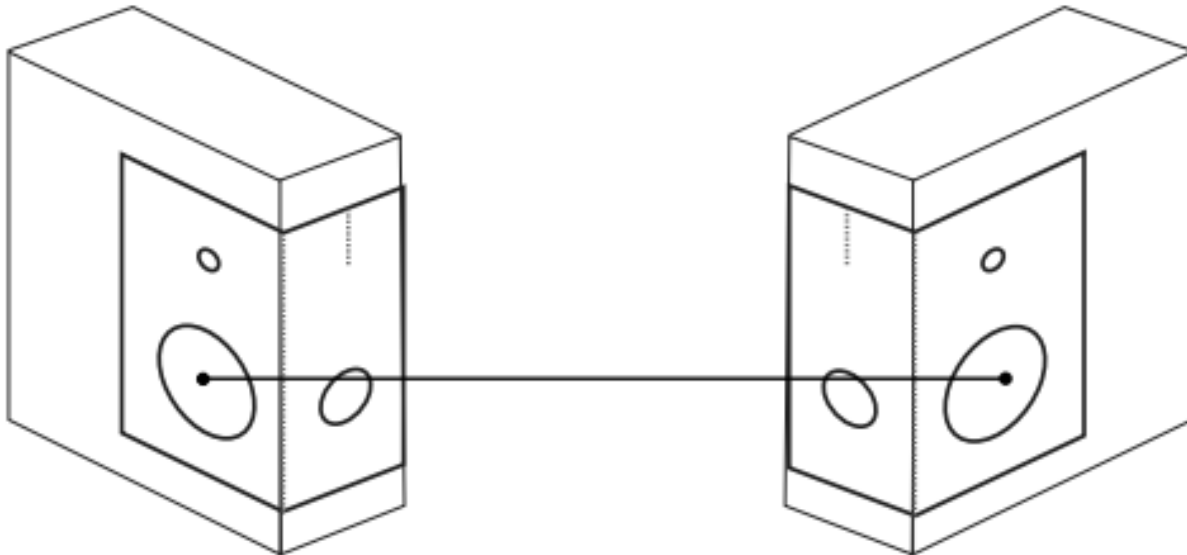

Determine height of door to install.

Make sure this is aligned to the centre of door edge

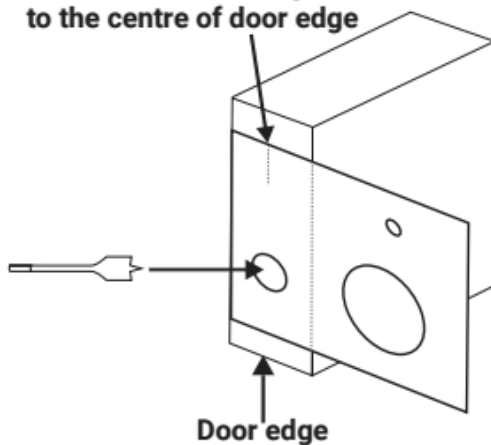

Fold here

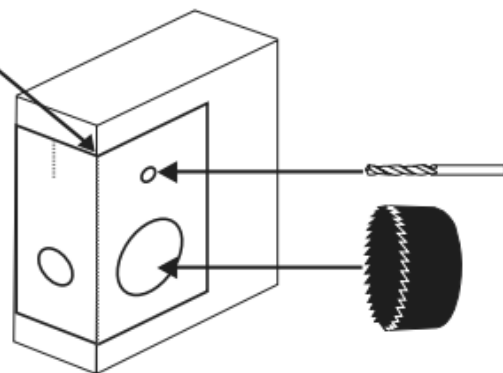

\* Mark the center of the holes and then drill for accuracy.

# Insert bolt assembly

1. If you are replacing your current deadbolt lock, industry standards are 60mm or 70mm backset. To determine which backset length you should use, so measure the distance (x) between the center of 54mm hole to door edge.

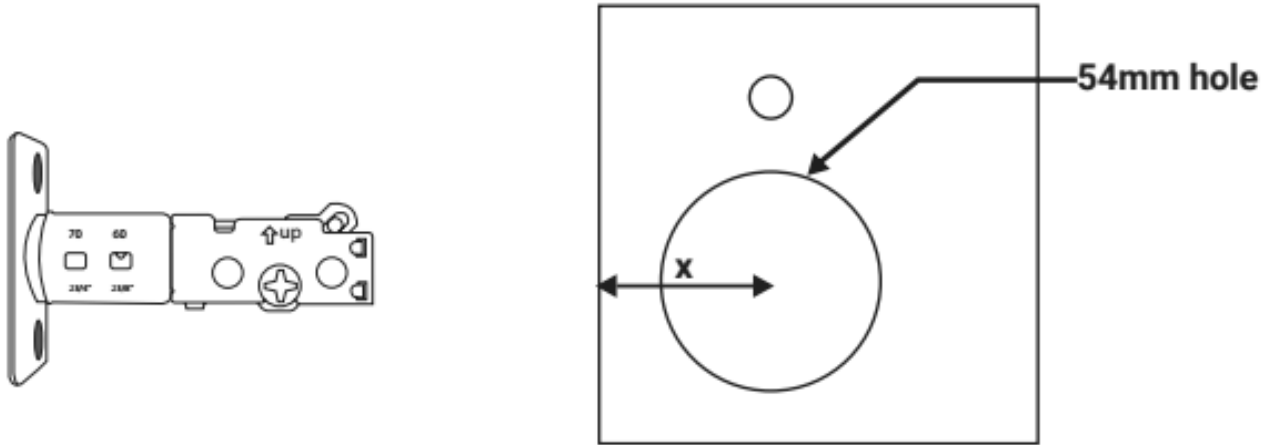

**2. Prepare bolt assembly based on the distance (x)**

**Bolt ships with bolt assembly in 60mm position. If required, twist the bolt and pull to extend (simultaneously) to 70mm backset position (current drill dimensions are fitted for 60mm position).**

60mm position

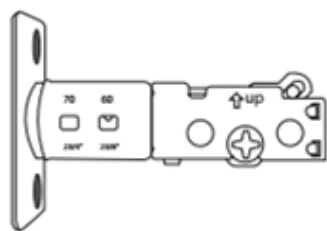
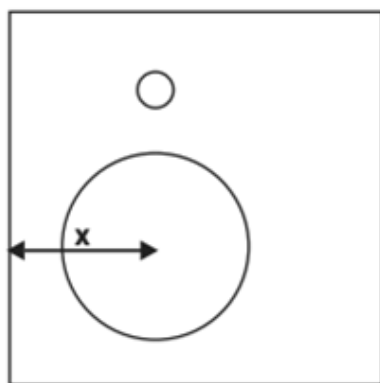

70mm position

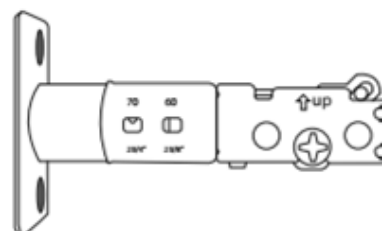
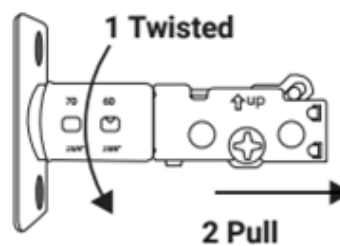
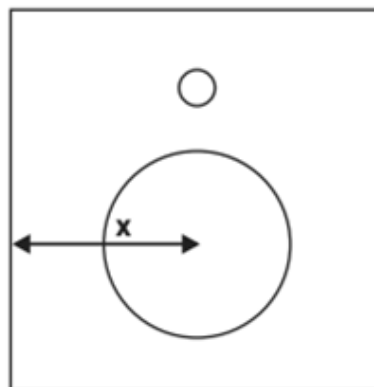

3. Insert bolt assembly.

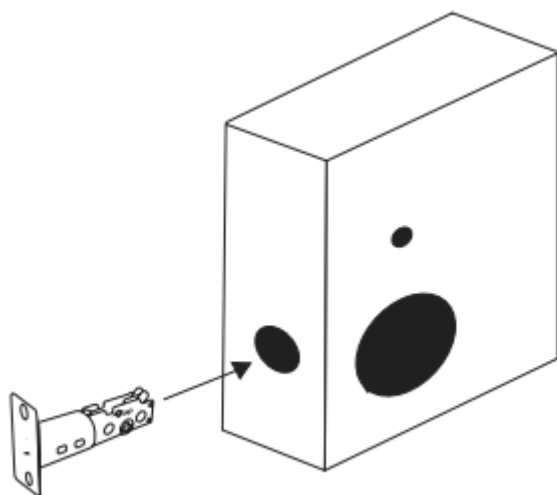

4. Mark around the plate of the bolt tongue and chisel about 2mm or until bolt tongue plate is flush with the door.

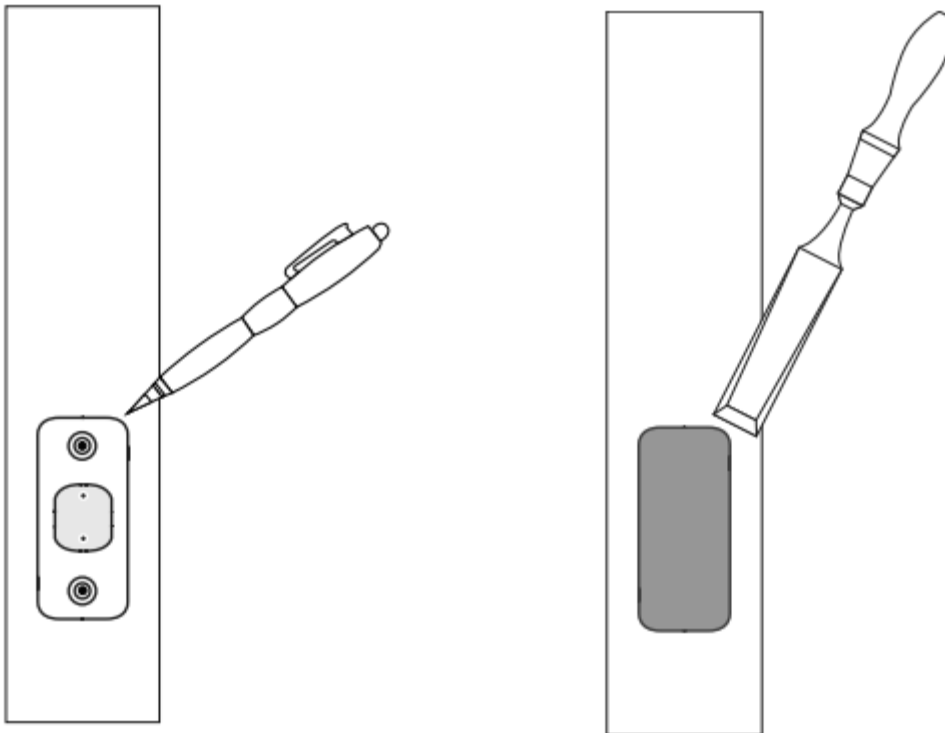

5. Secure the bolt assembly onto door using 2 x 25mm wood screws.

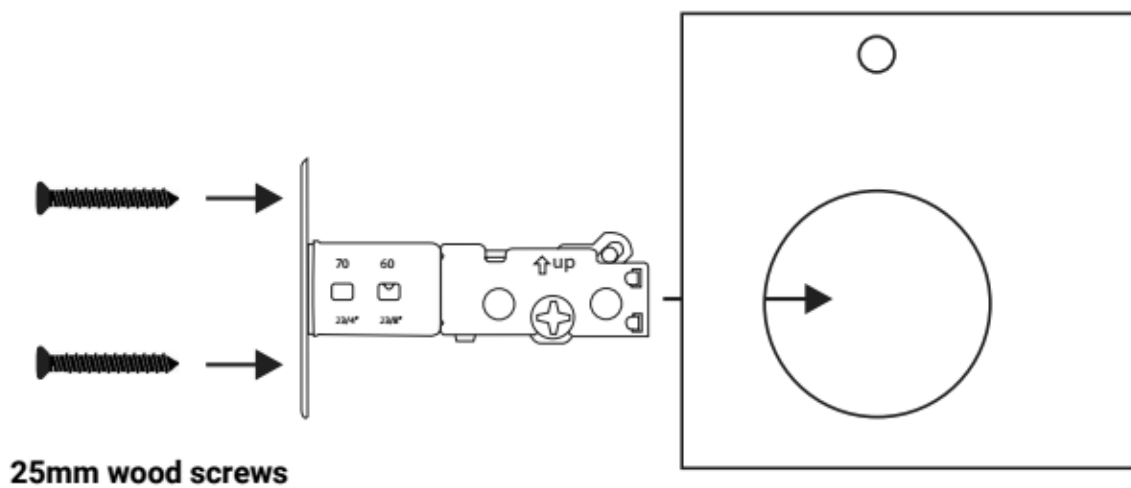

# Prepare lock and parts

## 1. Set Back Assembly

### a. Right installation (Refer to page 6 for installation type)

To install the lock for right-side installation (i.e. bolt locks to the right from outside the door), ensure the toggle button on the back assembly is set to R.

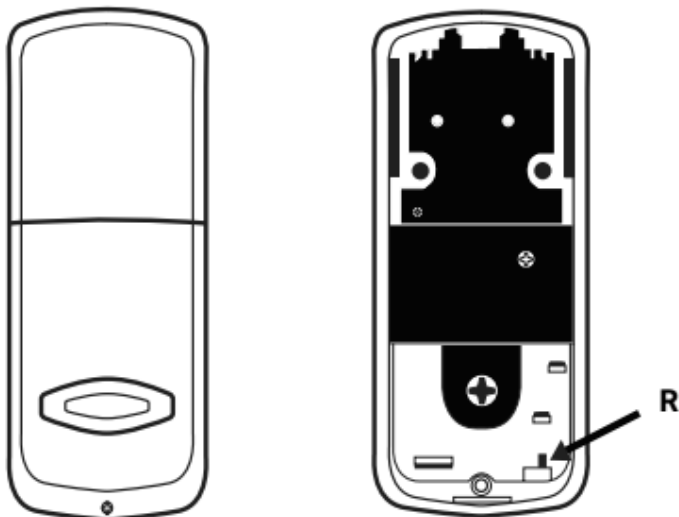

### b. Left installation (Refer to page 6 for installation type)

To install the lock for left-side installation (i.e. bolt locks to the left from outside the door), ensure the toggle button on the back assembly is set to L.

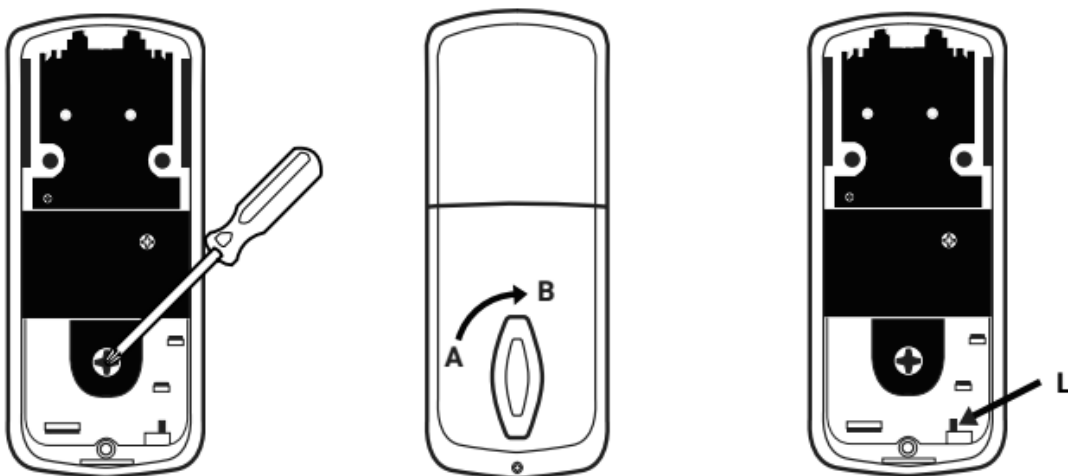

Unscrew the small screw in order to turn thumbturn.

Adjust thumbturn to ensure that the magnet below the thumbturn is moving from

Tighten the small screw. Shift toggle to L position.

2. Check that the thumb turn has been set correctly. It should turn in the following orientation.

### Right installation

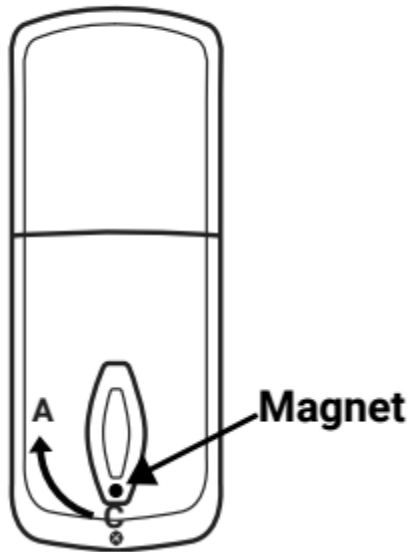

### Left installation

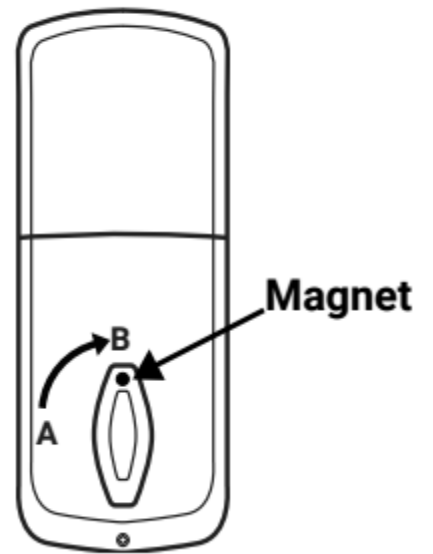

3. Screw on Screw Holder into the 10mm hole on the Front Assembly

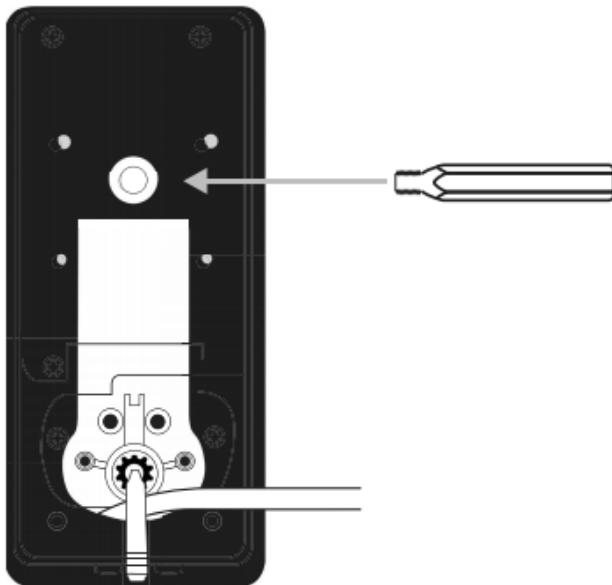

# Mount lock

1. Set Tailpiece on the Front Assembly according to the following alignment.

2. Fit Front Assembly (with Rubber Gasket attached) through the 54mm hole and 10mm hole. Ensure that the tailpiece slots through the bolt assembly according to the previously set alignment.

## a. Left installation

The tailpiece must be turned anti-clockwise all the way until it is in the vertical position. Slot it vertically through the Bolt Assembly

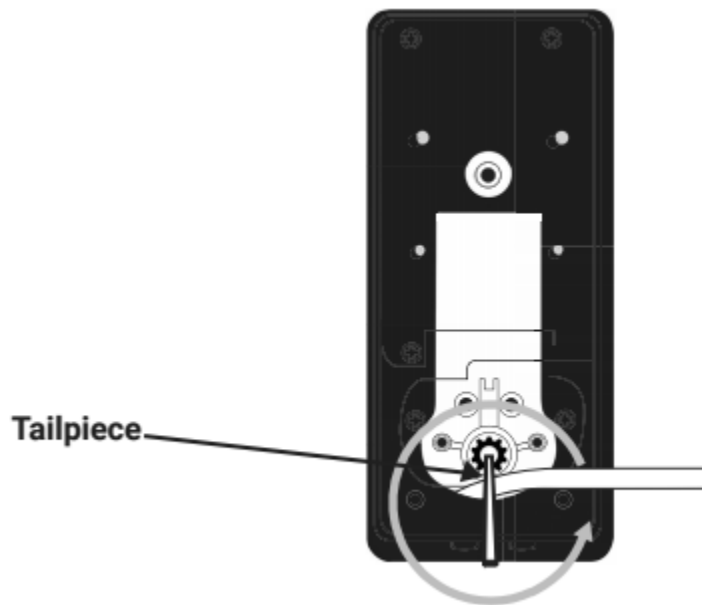

## b. Left installation

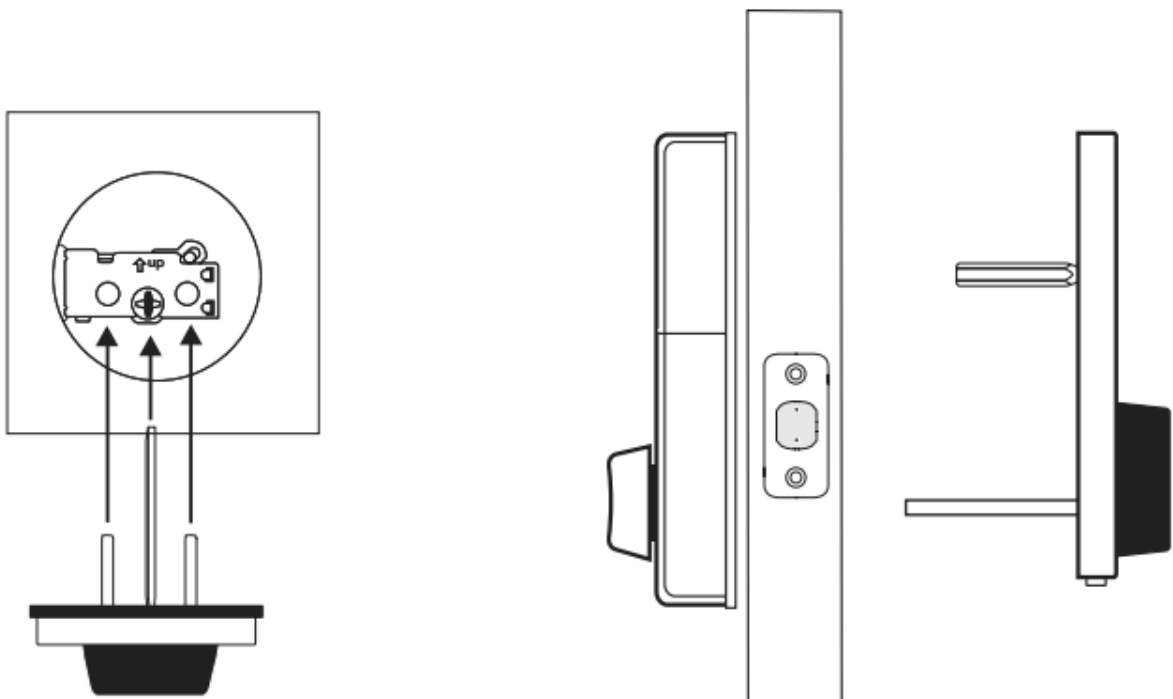

**a. Right installation**

The tailpiece must be turned clockwise all the way until it is in the horizontal position. Slot it horizontally through the Bolt Assembly

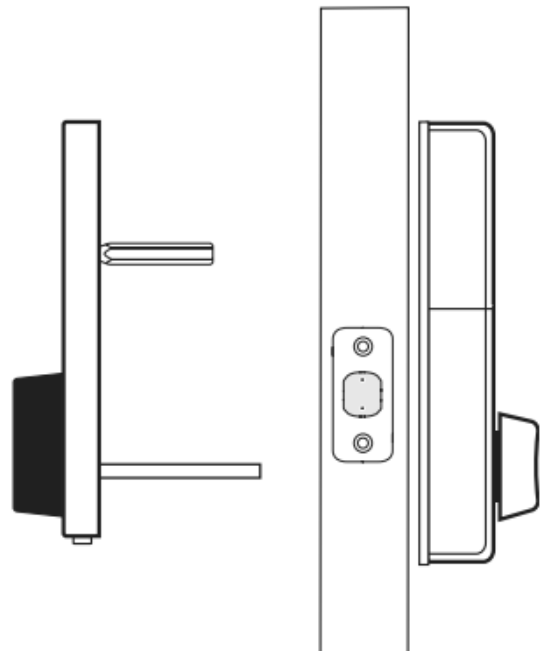
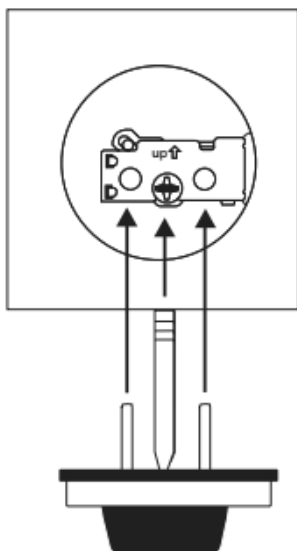
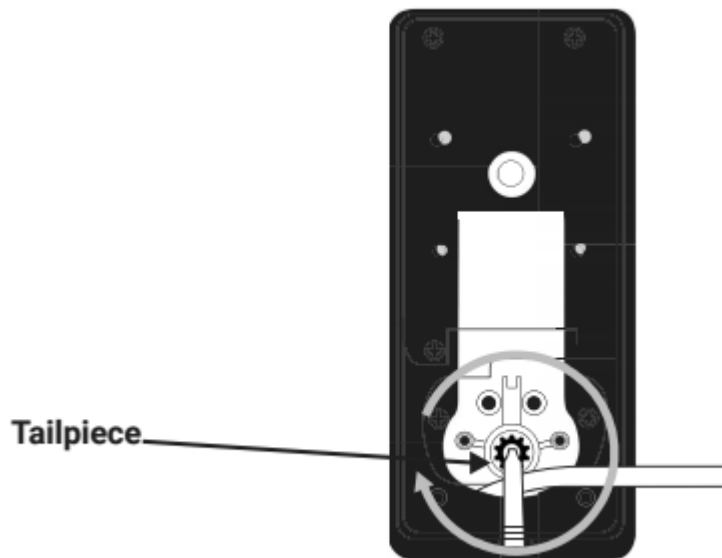

**3. Secure the Front Assembly using the Back Plate.**

To do this, place the Back Plate (ensuring the correct side placement), and screw it to the Front Assembly using the three 40mm bolt screws



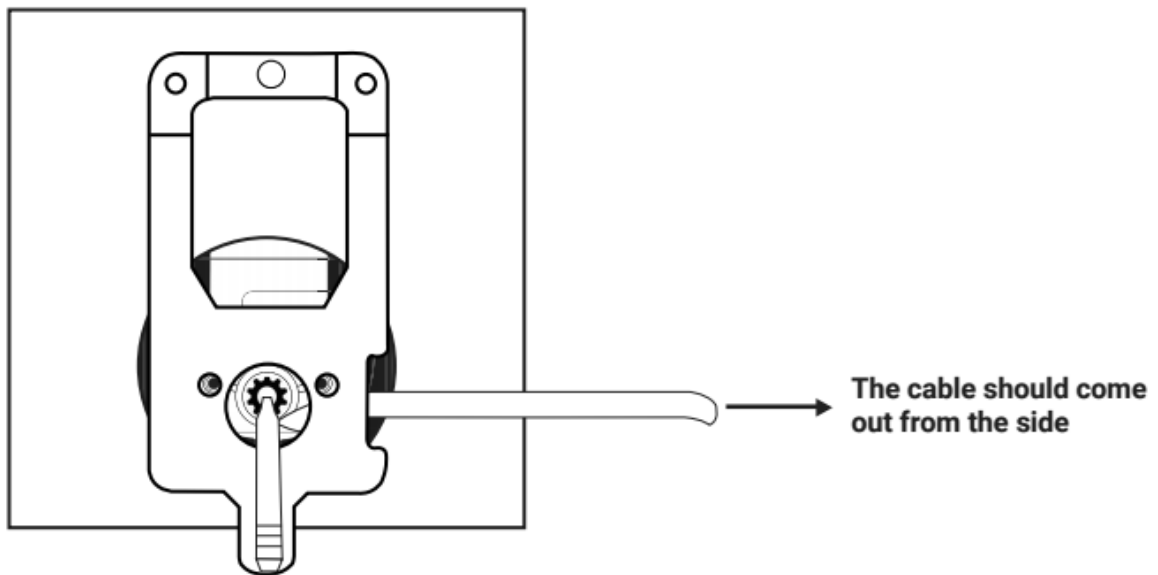
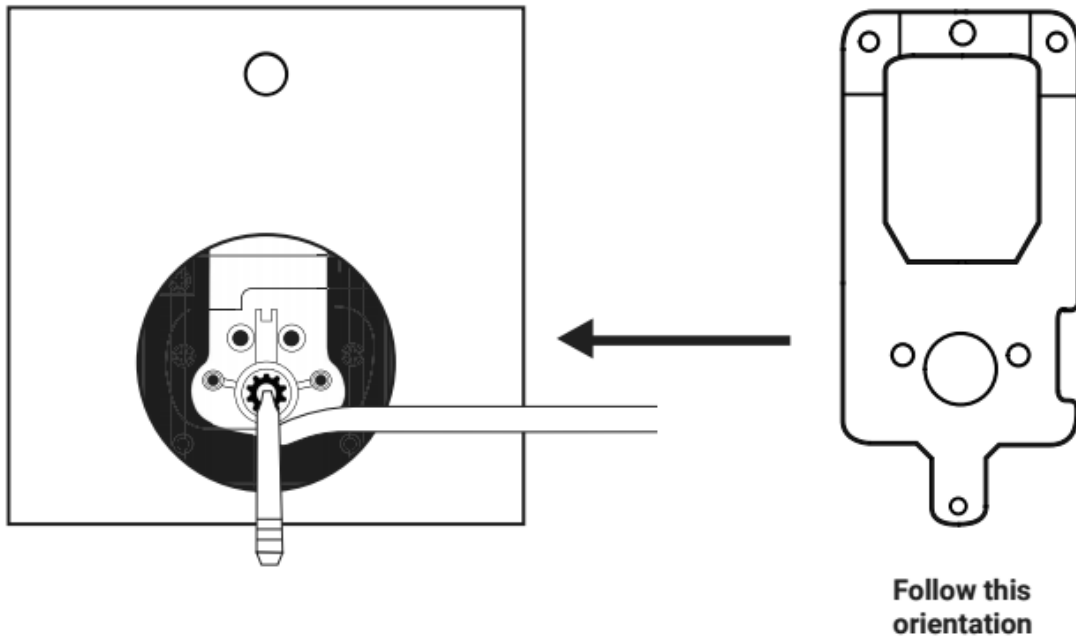

4. Fit Back Assembly over the Back Plate, aligning the three holes (two under the Battery Cradle, and one at the bottom of the Back Assembly) to the Back Plate

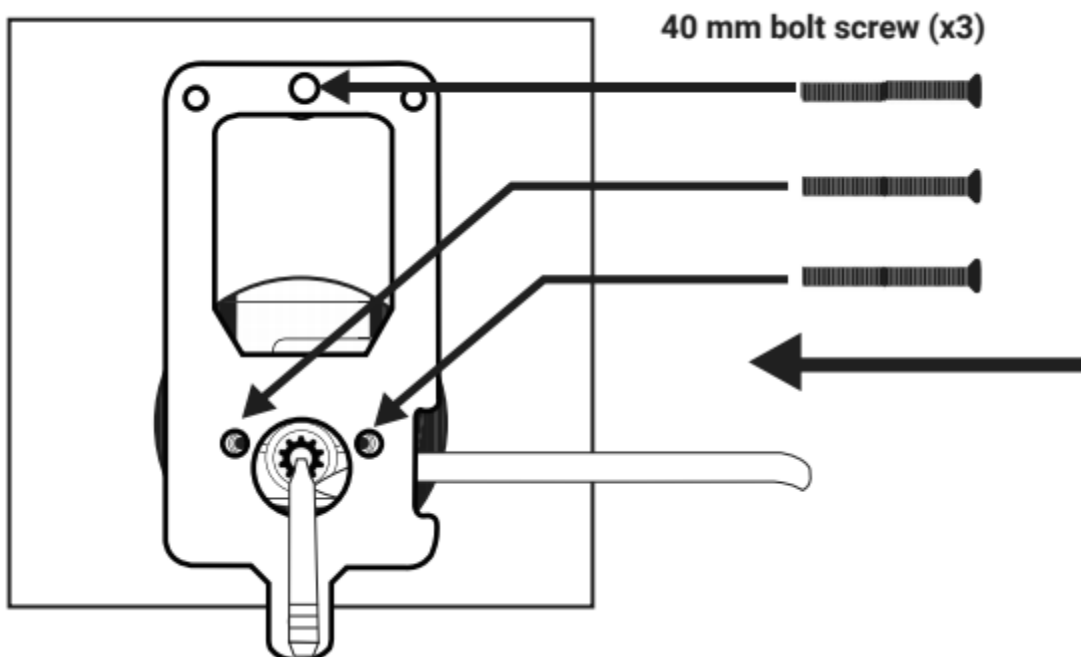

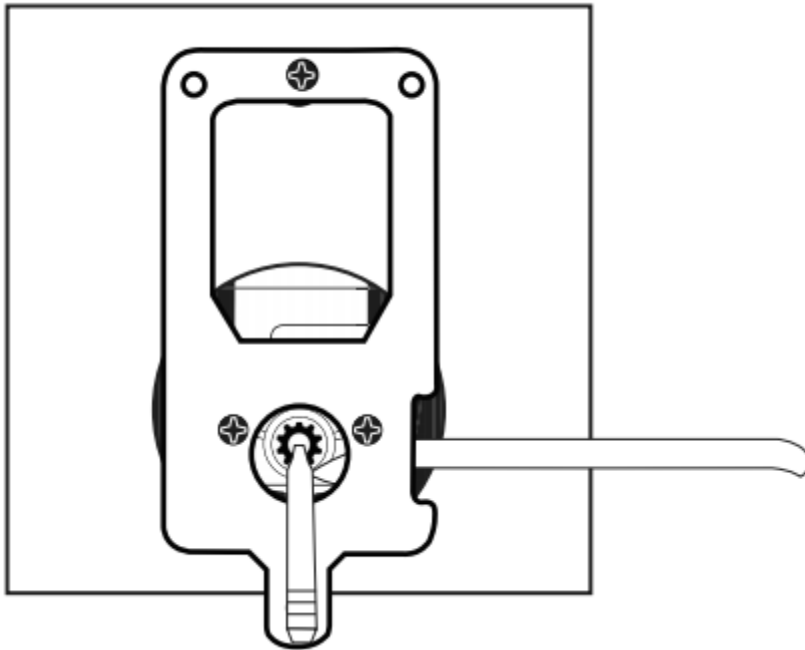

**5. Connect wire connector from Front Assembly through 54mm hole to Back Assembly. Make sure that the wire is installed properly and securely.**

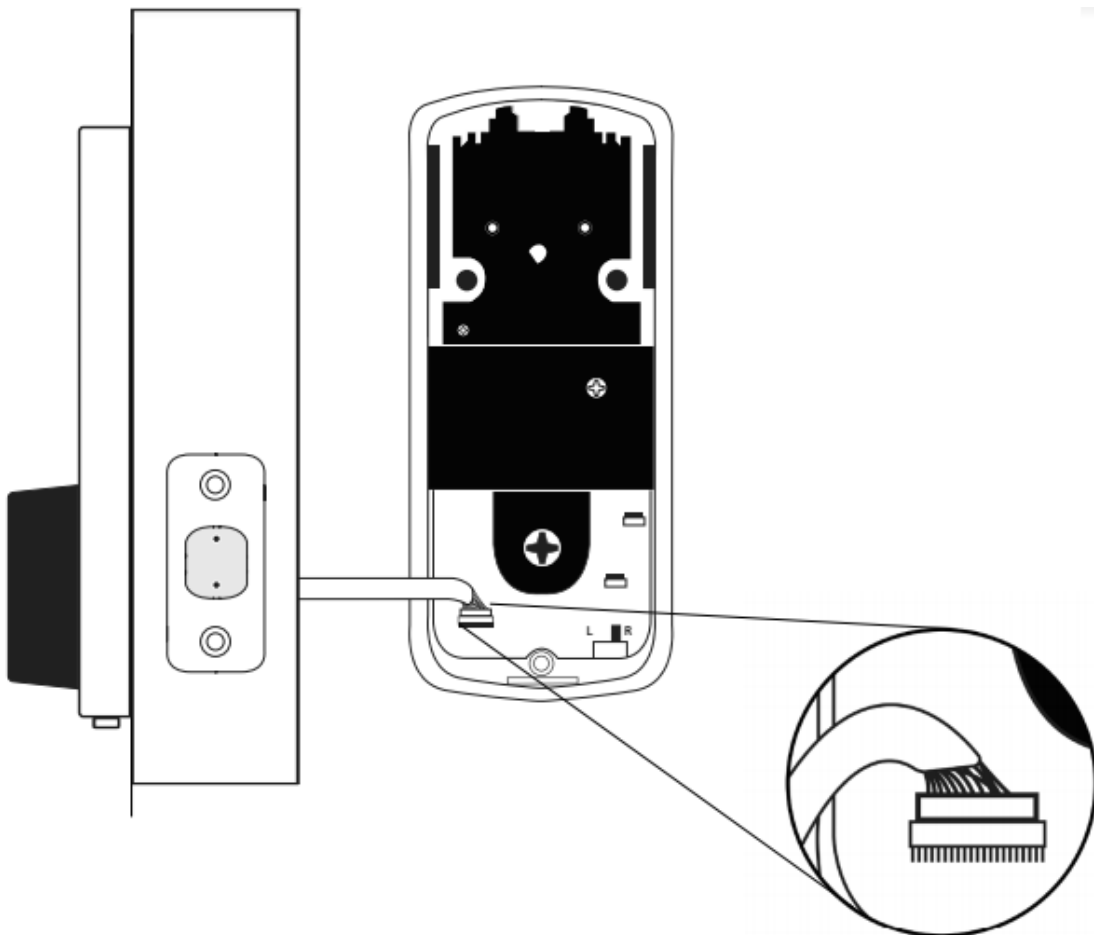



**6. Remove the Battery Case Lid**

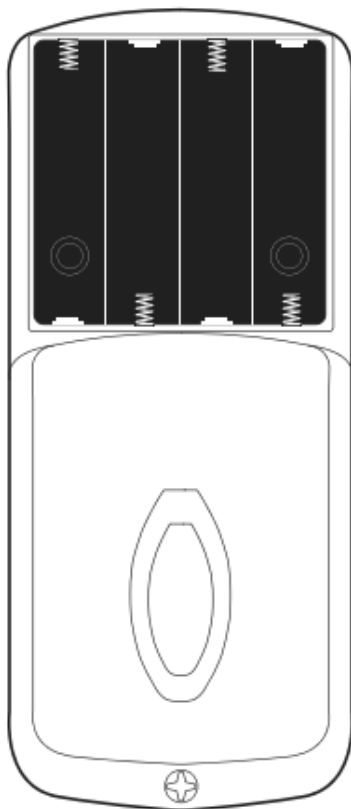

**Use a sharp object to depress pin and pull battery case upwards.**

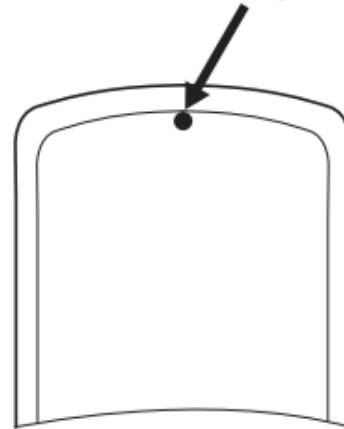

**7. Secure the two holes under the battery casing with 2 x 5mm bolt screws and the bottom with 22mm bolt screw**

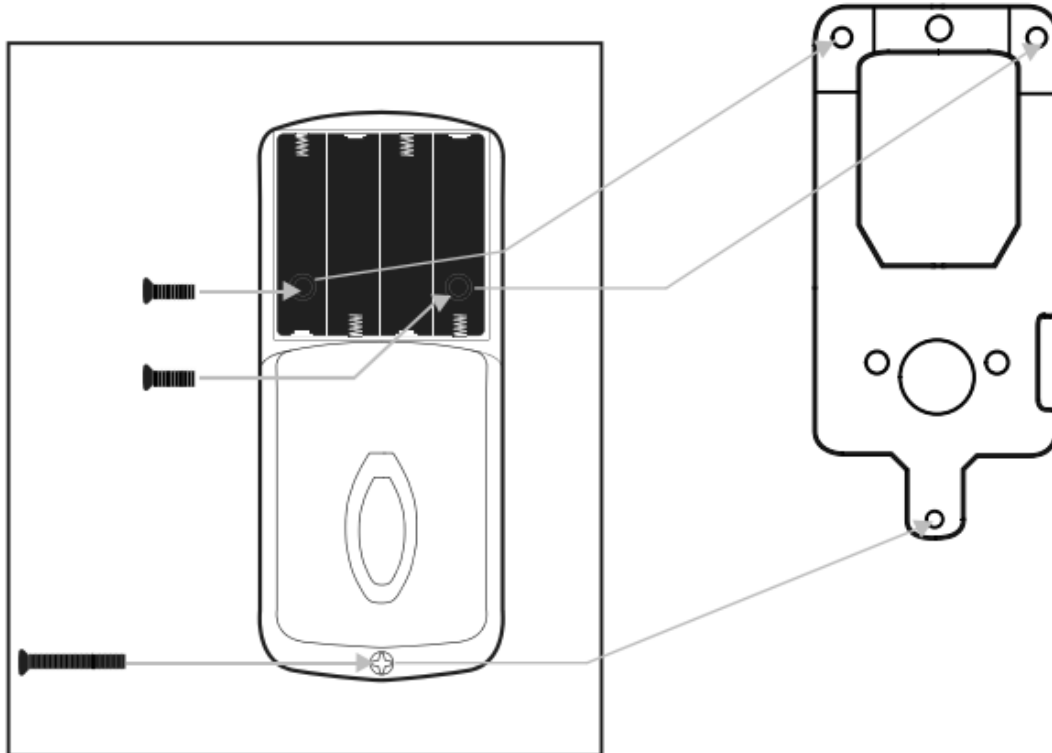

**Align holes on back assembly to back plate and screw in.**

**\* Make sure this is turned to 'unlock' position.**

**\* For right installation, turn thumbturn clockwise before mounting and for left installation, turn thumbturn anti-clockwise before mounting.**

**8. Make sure 4 x AA Batteries are inserted correctly before closing the Battery Case Lid**

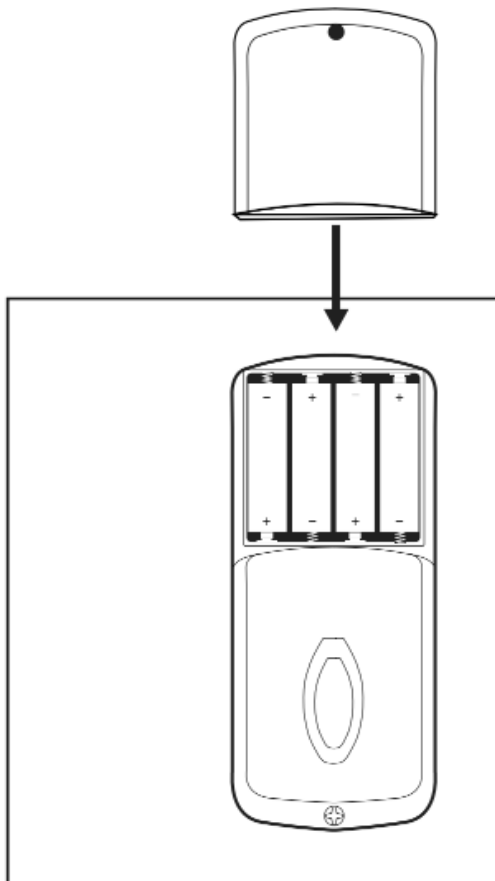

# Test lock

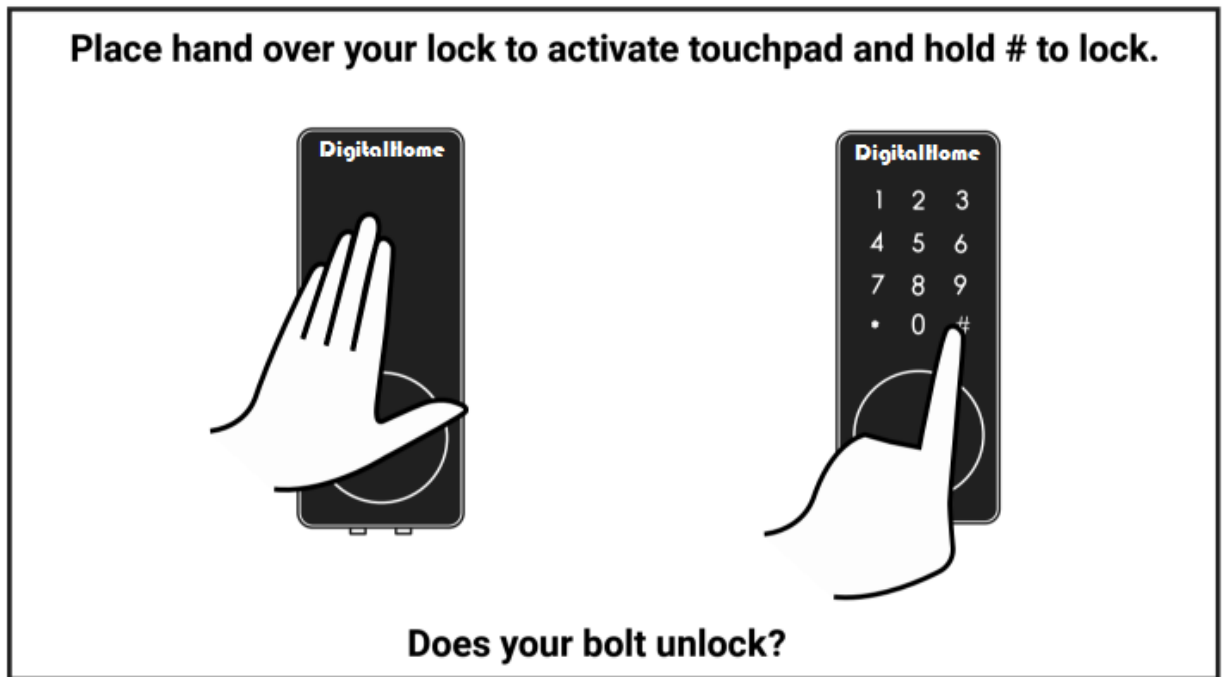

Yes

No

**Congrats!**  
Lock is correctly installed.  
Proceed to next steps.

**Bummer!**  
Does bolt tongue slide out  
when you turn the thumbturn?

Yes

**Left-Right toggle incorrectly set.**

Troubleshoot: Try setting the left-right toggle on your back assembly to the correct side



No

**Tailpiece and/or thumbturn incorrectly set.**

Troubleshoot: Disassemble lock and install it again.

# Drill holes in door frame

1. Make sure to align the lock to the frame and mark it down.

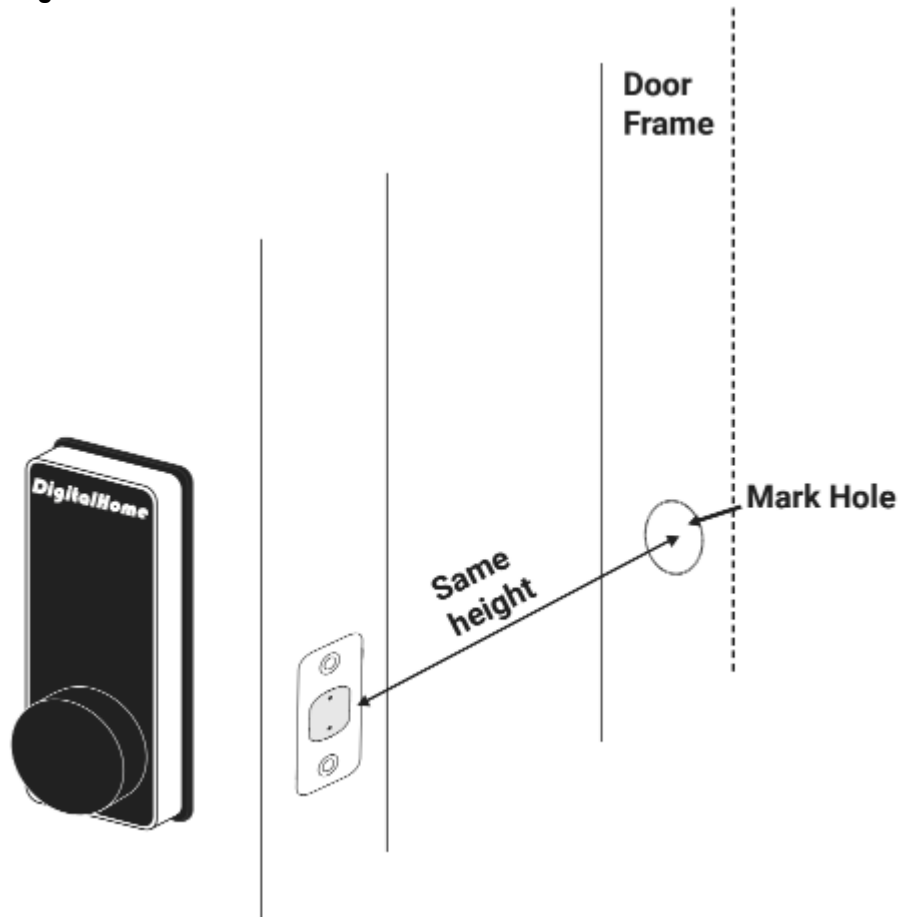

2. Mark out where the bolt tongue locks then drill a corresponding hole on door frame.

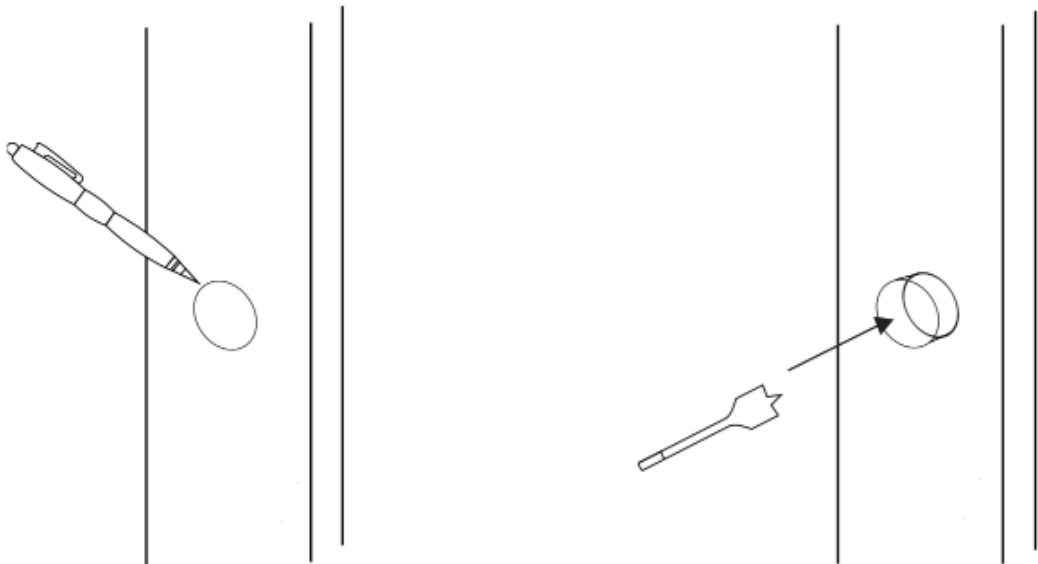

3. Mark out the strike plate and use the chisel 2mm or until the strike plate is flush.

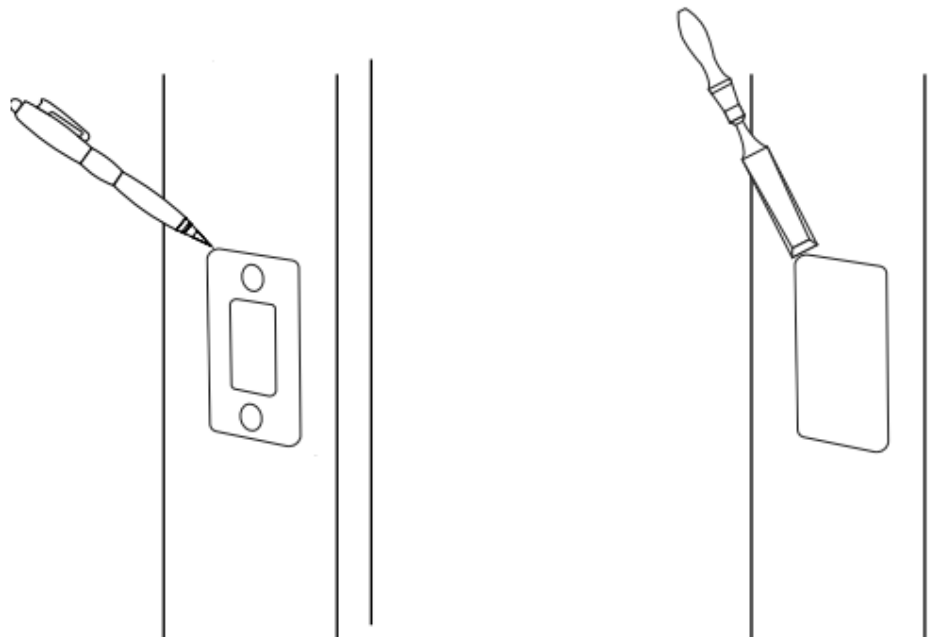

4. Secure strike plate housing and strike plate using 2 x 25mm wood screws.

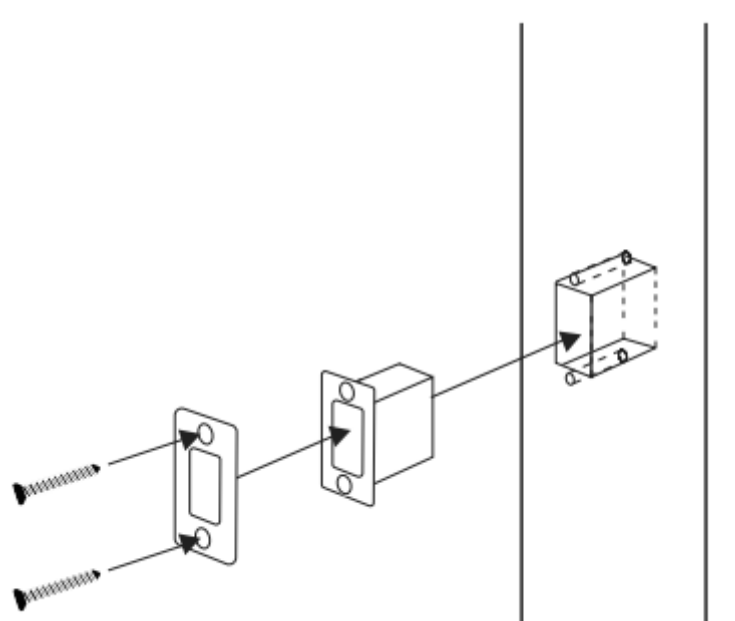



# Sciener Smart Lock

Smart Your Life



## ( I ) Introduction

## ( II ) Software installation

## ( III ) Main functions

- **1 registration and login**

- 1.1 security question settings
- 1.2 login authentication
- 1.3 ways of identifying
- 1.4 login successful

- **2 key management**

- 2.1 lock supporting
- 2.2 lock adding
- 2.3 lock upgrading
- 2.4 error diagnosis and time calibration

- **3 key management**

- 3.1 one-time passcode
- 3.2 key management
- 3.3 **deadline warning**
- 3.4 search lock record

- **4 passcode management**

- 4.1 permanent passcode
- 4.2 time-limited passcode
- 4.3 one-time passcode
- 4.4 **clear code**
- 4.5 cyclic passcode
- 4.6 custom passcode
- 4.7 passcode sharing
- 4.8 passcode management

- **5 card management**

- **6 fingerprint management**

- **7 Bluetooth unlock**

- **8 attendance management**

- 8.1 attendance management
- 8.2 staff management
- 8.3 attendance statistics
- 8.4 attendance check
- 8.5 property settings
- 8.6 time settings
- 8.7 workday settings
- 8.8 holiday settings

- **9 system setting**

- 9.1 key groups management
- 9.2 transfer admin rights
- 9.3 AI customer service
- 9.4 about the APP

- **10 gateway management**

- 10.1 gateway adding
- 10.2 manual

# Introduction

Sciener App is a management software for smart lock . This APP can be used to manage various types of smart locks, including door locks, parking locks, safe locks, bicycle locks, and so on. The App and the lock communicate via Bluetooth BLE to unlock, lock, hardware upgrade, read operation record, etc. on the App. The Bluetooth key can also help open the door lock through the AI watch.

Currently, the App supports Chinese (Simplified and Traditional), English and Spanish. More languages will be supported in the future.

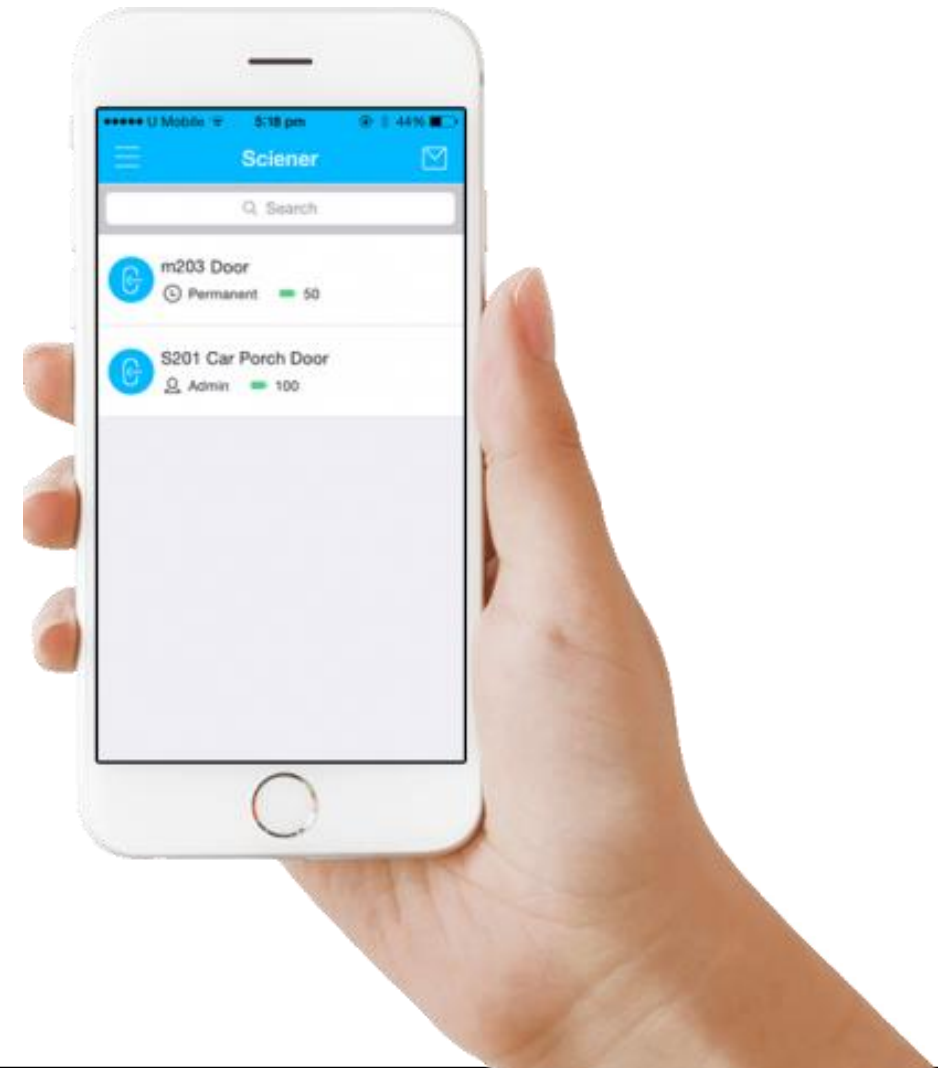



Scan to download Sciener

## Software installation

The software (iOS version) can be downloaded from the app store, and the Android version can be downloaded from the application store of Google play, App Store, Baidu, Ali, 360, Huawei, and Xiaomi.



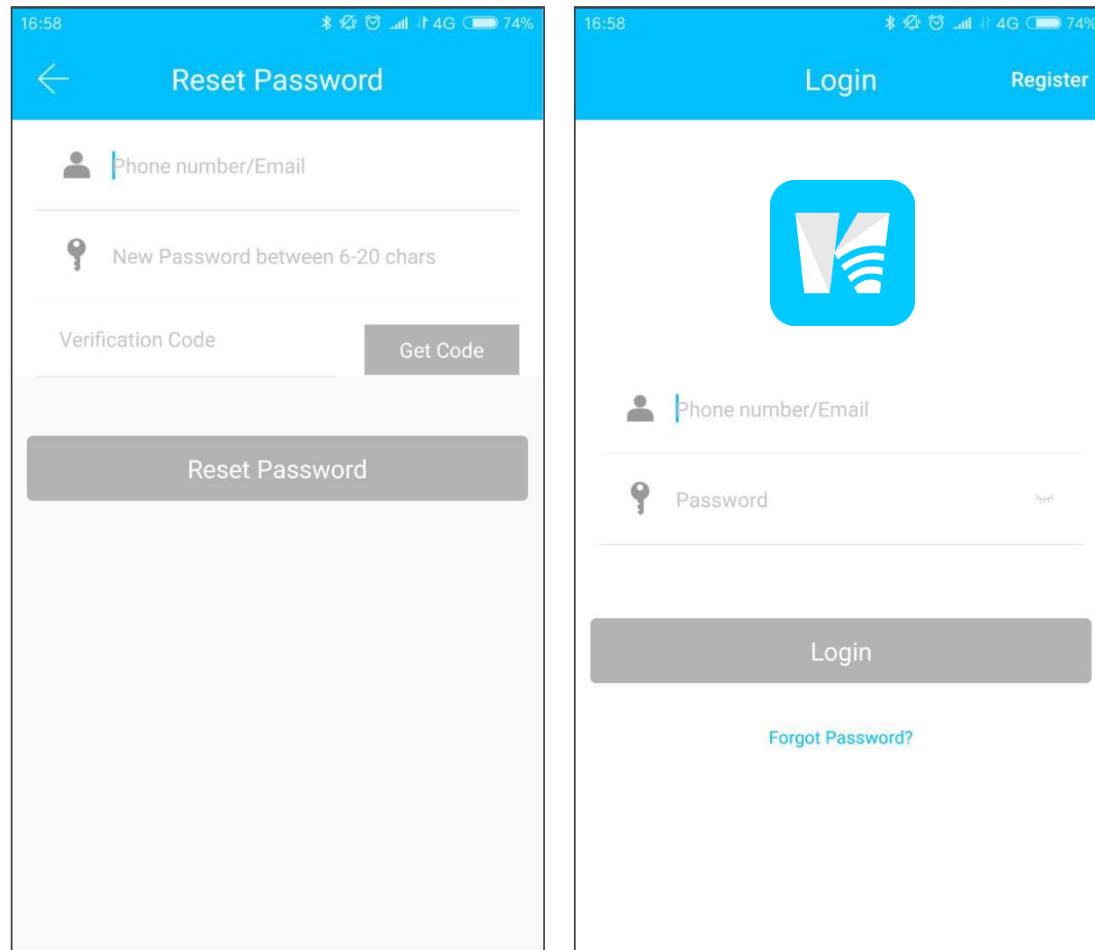

## 1. Registration and login

Sciener users can register the account by mobile phone and Email which currently support 200 countries and regions on the world. The verification code will be sent to user' s mobile phone or email, and the registration will be successful after the verification.

# 1.1 Security question settings

You will be taken to the security Questions, settings page when registration is successful. When log in on a new device, the user can authenticate himself by answering the above questions.

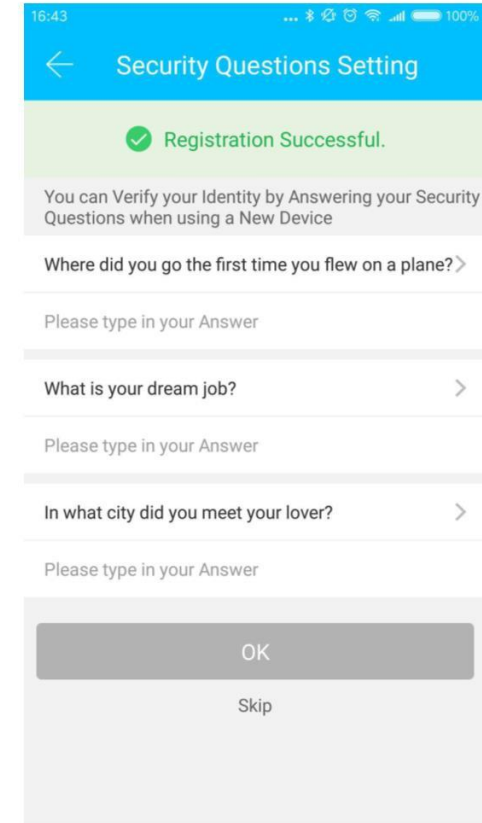
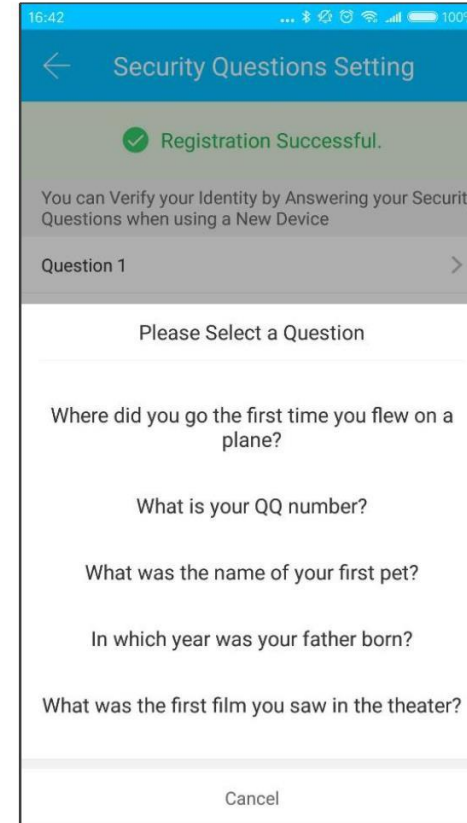
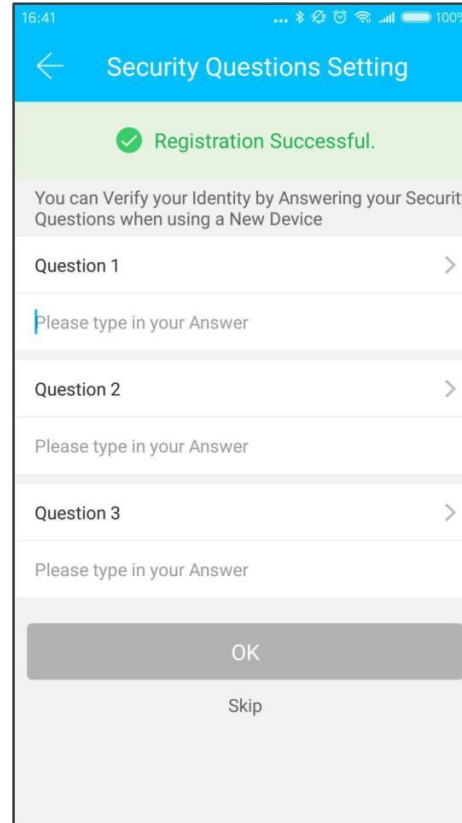

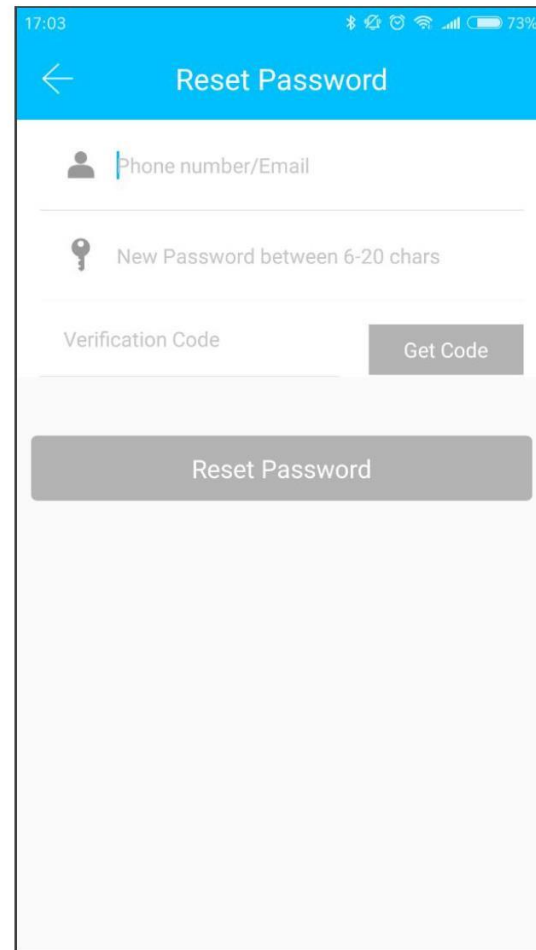
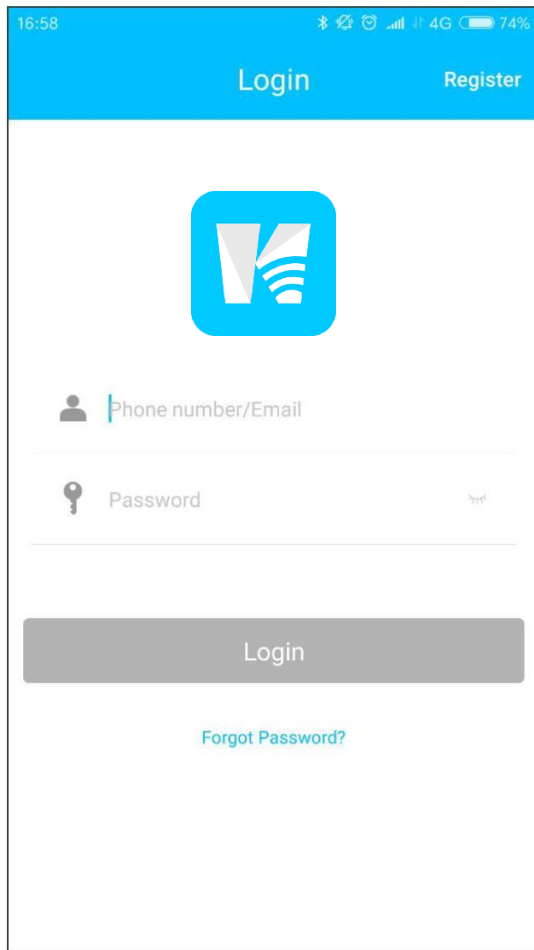

## 1.2 Login authentication

Log in with your mobile phone number or email account on the login page. The mobile phone number is automatically recognized by the system and does not input the country code. If you have forgotten your password, you can go to the password page to reset your password. When reset the password, you can receive a verification code from your mobile phone and email address.

When the account is logged in on the new mobile phone, it needs to be verified. When it is passed, you can log in on the new mobile phone. All the data can be viewed and used on the new mobile phone.

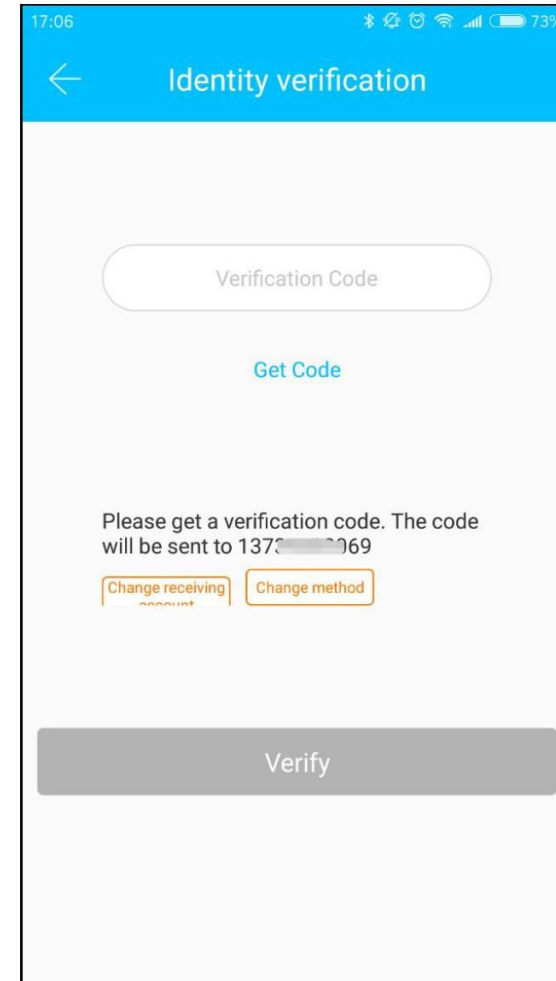

## 1.3 Verification mode

There are two ways of security verification. One is the way to get the verification code via the account number, and the other is the way to answer the question. If the current account is set the "answer the question" verification, then when the new device is logged in, there will be an "answer question verification" option.

verify with verification code  
as shown :

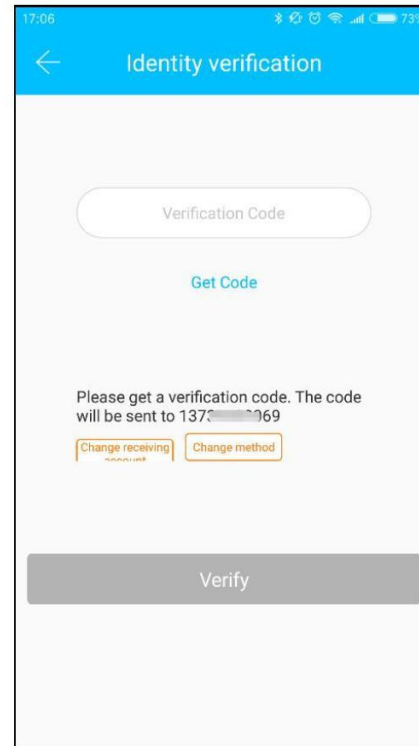



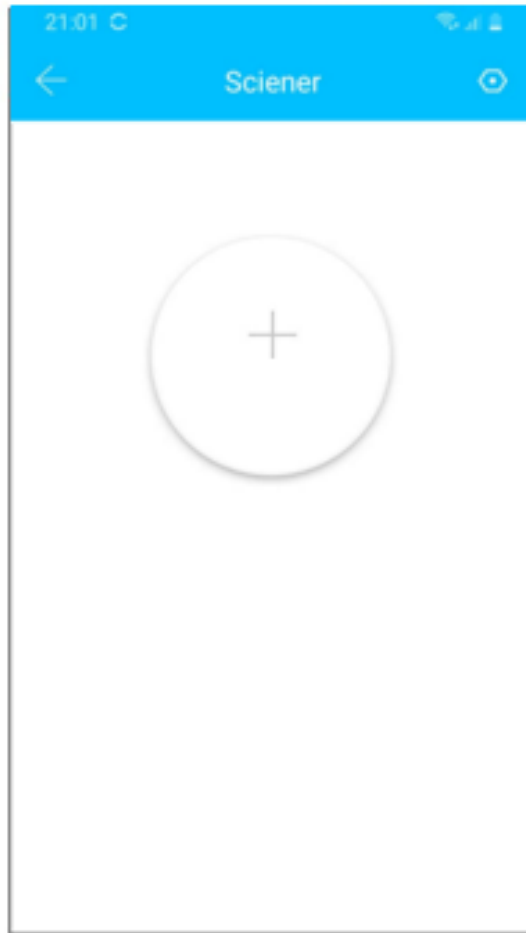

no lock adding

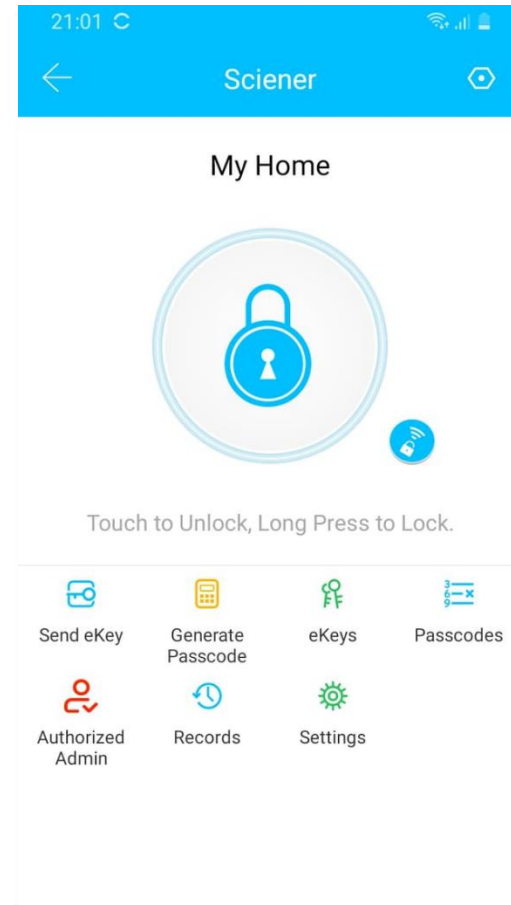

the account with lock

## 1.4 Login successful

The first time you use the lock lock app, if there is no lock or key data in the account, the home page will display the button to add the lock. If there is already a lock or key in the account, the lock information will be displayed.

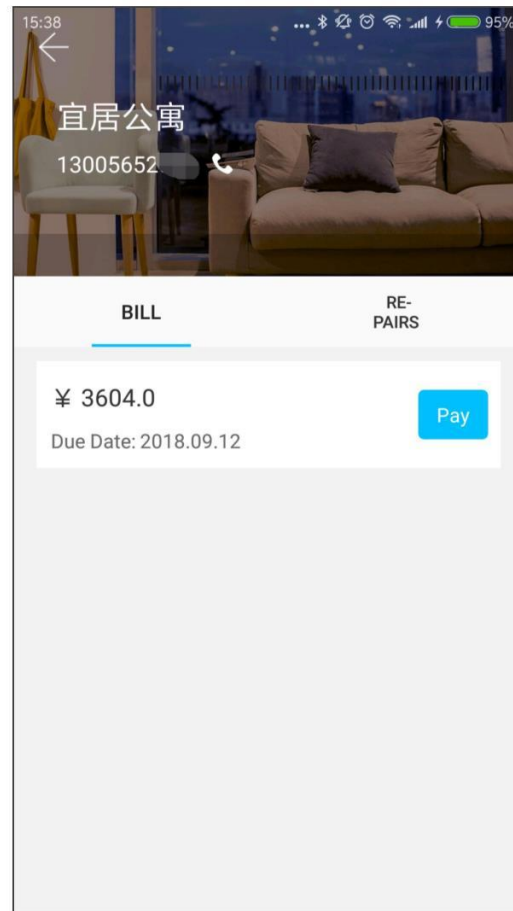
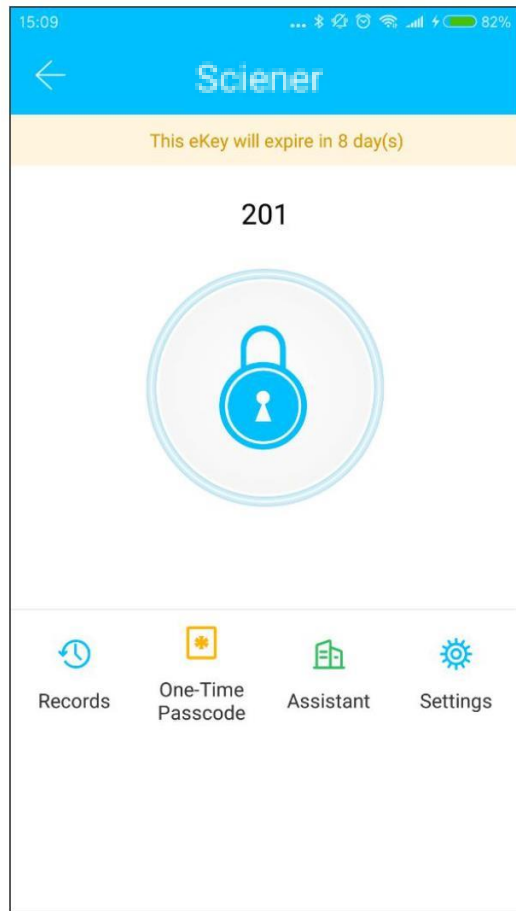

### Apartment assistant

The apartment assistant module can be seen in the lock app only when the key comes from the apartment.

In the apartment assistant module, you can pay rent and repair. The landlord collects the rent from the Room Master APP and sends the rent bill to the tenant. According to actual usage, the bill includes rent, water and electricity, gas, property, broadband, etc.

## 2. Lock management

The lock must be added on the app before it can be used. The addition of a lock refers to the initialization of the lock by communicating with the lock via Bluetooth. Please stand beside the lock. Once the lock is added successful, you can manage the lock with the app including sending a key, sending a password, and so on.



When the lock is added, the adder becomes the administrator of the lock. At the same time, the lock cannot enter the setup mode by touching the keyboard. This lock can only be re-added after the current administrator has deleted the lock. The operation of deleting the lock needs to be done by Bluetooth beside the lock.

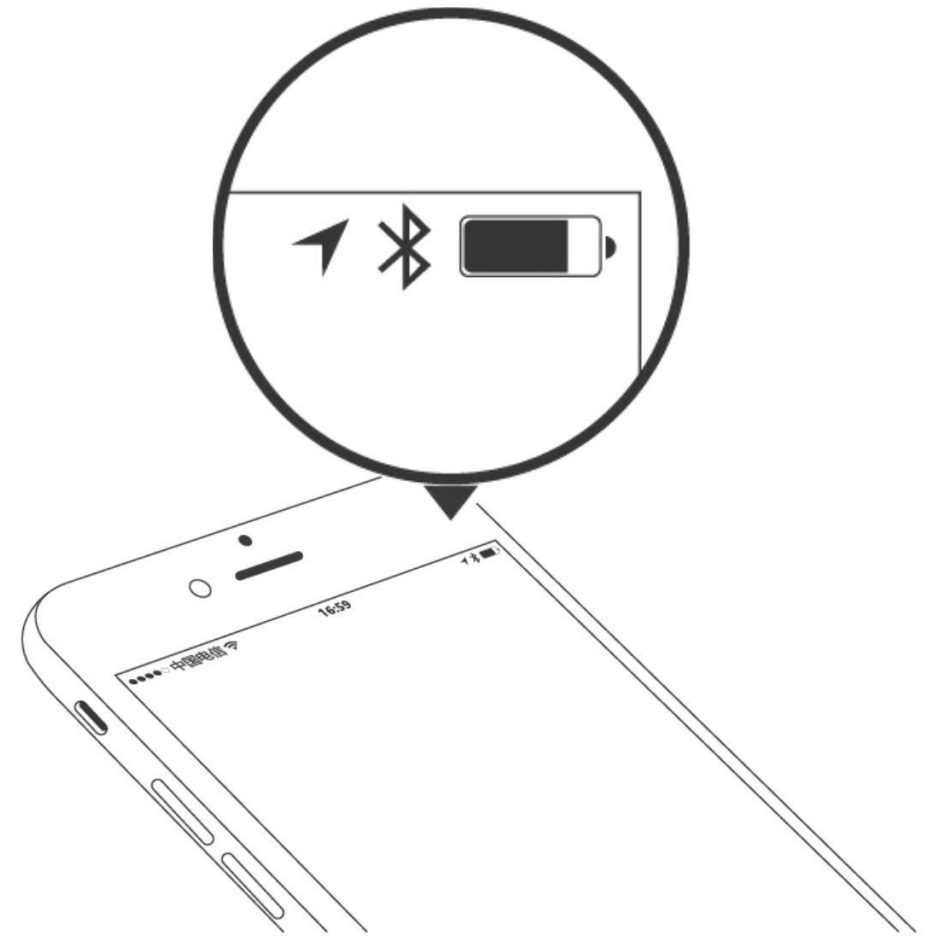

### User management

You can see the customer's name and phone number in the lock user list. Click on the customer you need, then it will display the door lock information and room number.

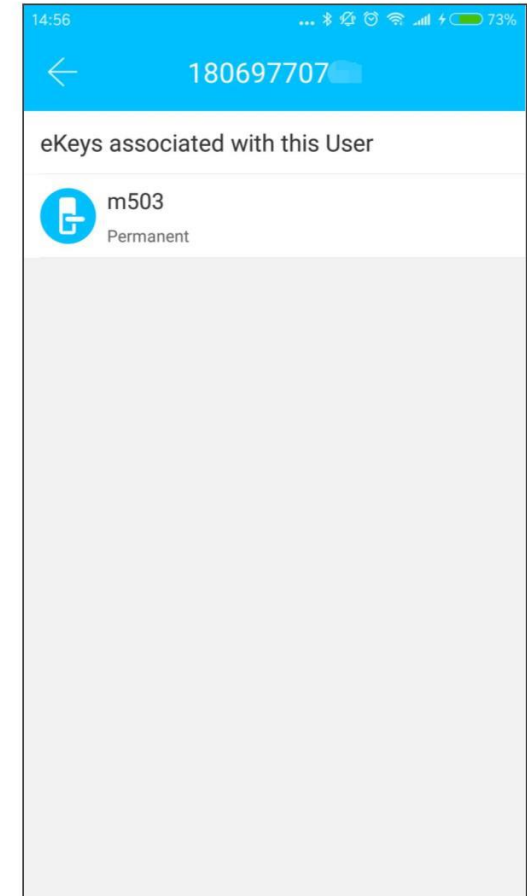
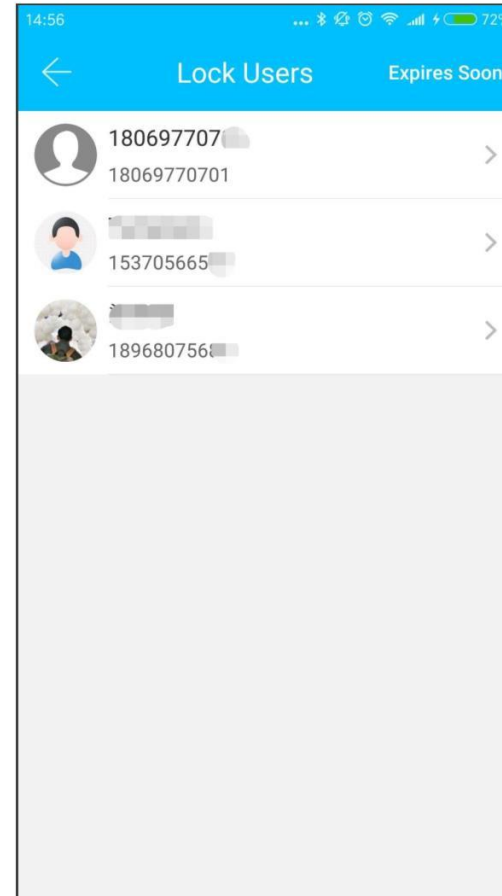

## 2.1 Lock supporting

The Sciener App supports multiple types of lock, including door locks, padlocks, safe locks, smart lock cylinders, parking locks, and bicycle locks. When adding a device, you must firstly select the lock type. The lock needs to be added to the app after entering the setting mode. A lock that has not been added will enter the setting mode as long as the lock keyboard is touched. The lock that has been added needs to be deleted on the App first.

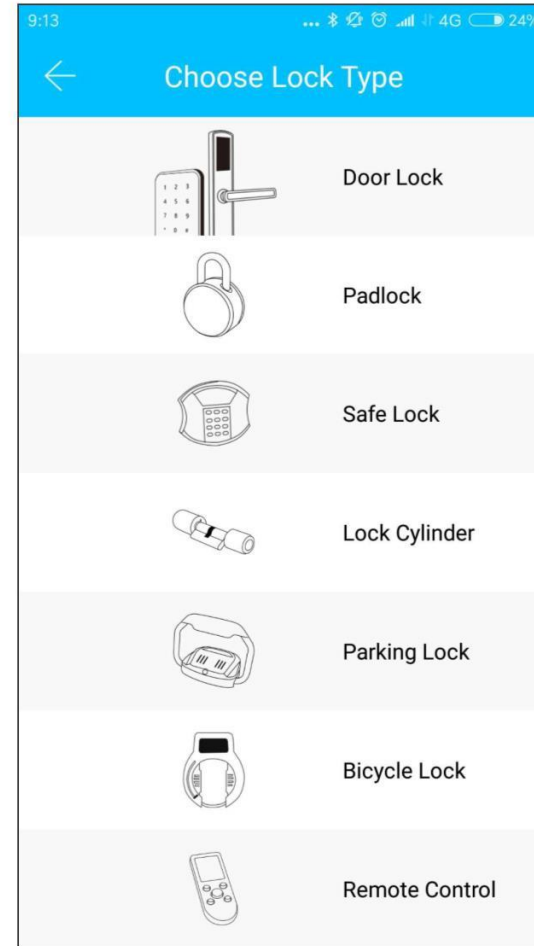

## 2.2 Lock adding

The initialization data of the lock needs to be uploaded to the network. The data needs to be uploaded when the network is available to complete the entire whole adding process.

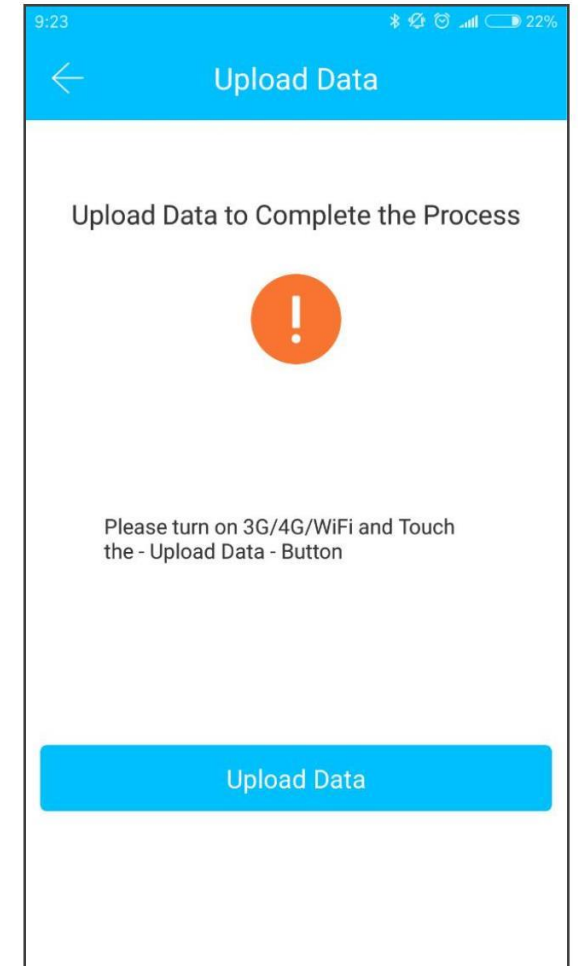
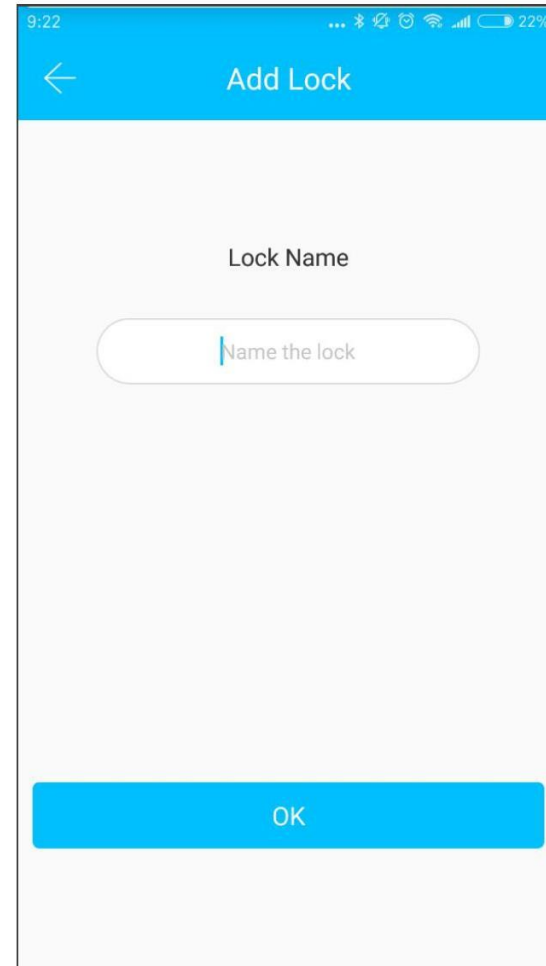

## 2.3 Lock upgrade

User can upgrade the lock firmware on the Sciener APP. The upgrade needs to be done via Bluetooth next to the lock. When the upgrade is successful, the original key, password, IC card, and fingerprint can continue to be used.

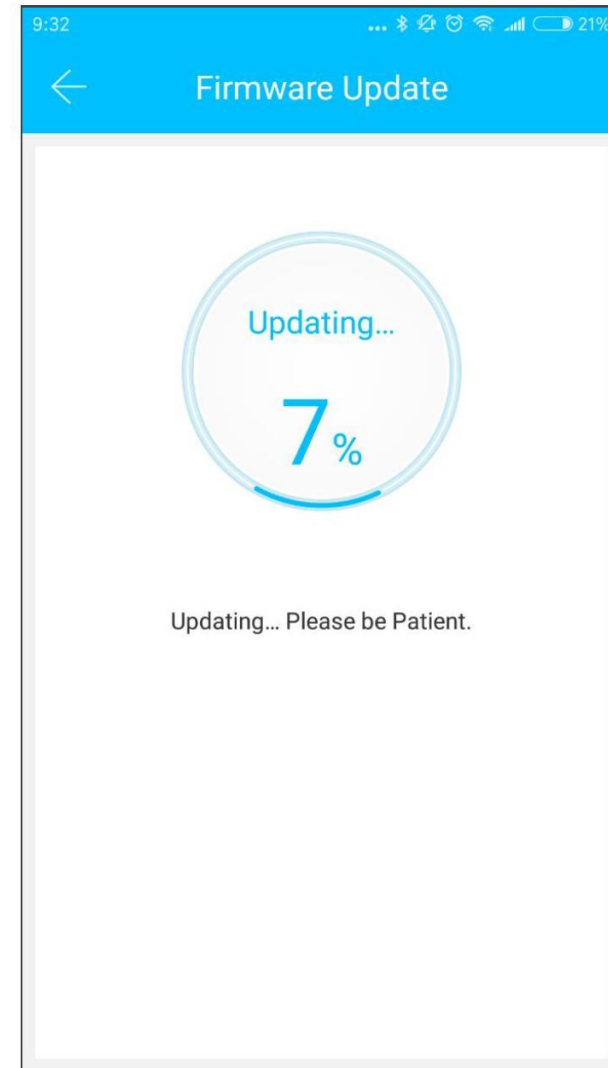

## 2.4 Error diagnosis and time calibration

Error diagnosis aims to help analyze the system problems. It needs to be done via Bluetooth beside the lock.

If there is a gateway, the clock will be calibrated firstly through the gateway. If there is no gateway, it needs to be calibrated by the mobile phone Bluetooth.

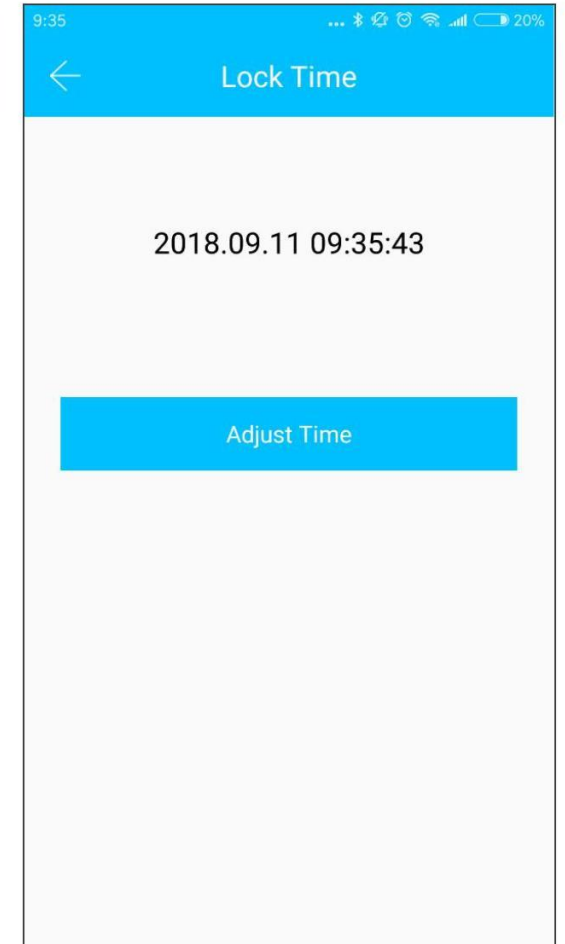
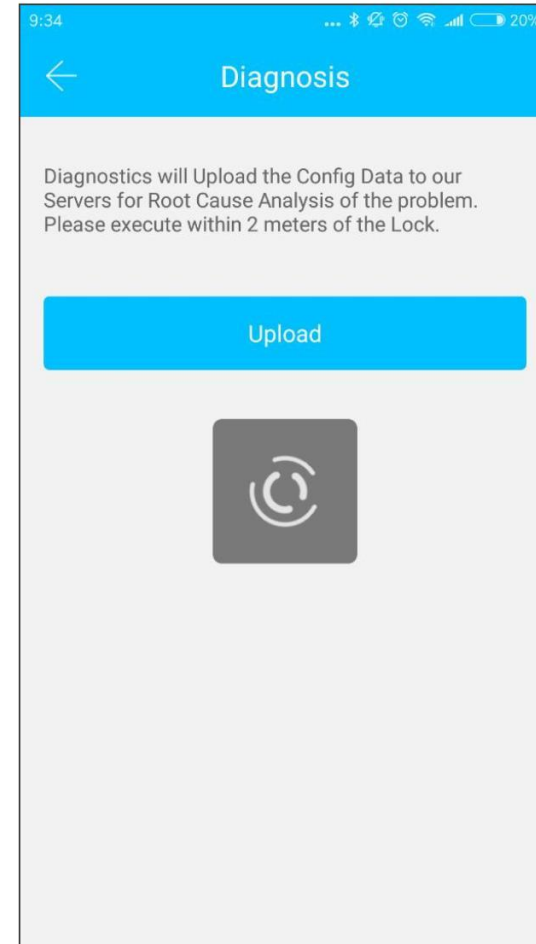



### 3. Ekey management

After the administrator successfully adds the lock, he owns the highest administrative rights to the lock. He can send keys to others. Meanwhile he can increase the key management that is about to expire.

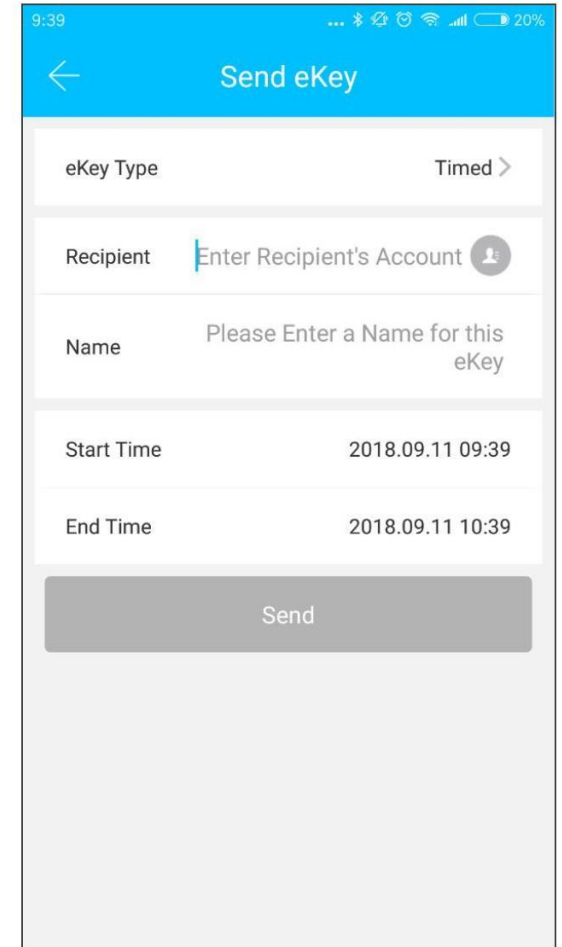
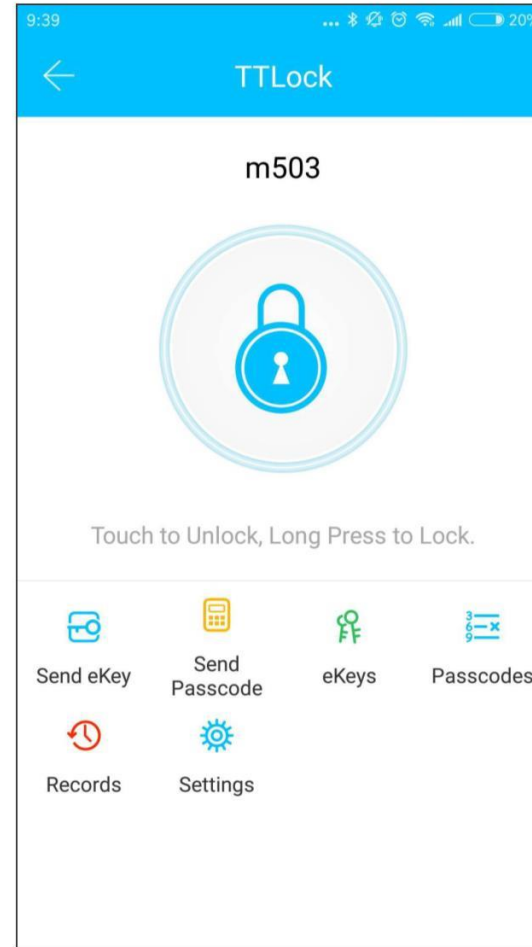

Click the type of lock it will show the time-limited ekey, one-time ekey and permanent ekey.

Time-limited ekey: The ekey is valid for the specified time.

Permanent ekey: The ekey can be used permanently.  
One-time ekey: the ekey will be automatically deleted once it has been used.

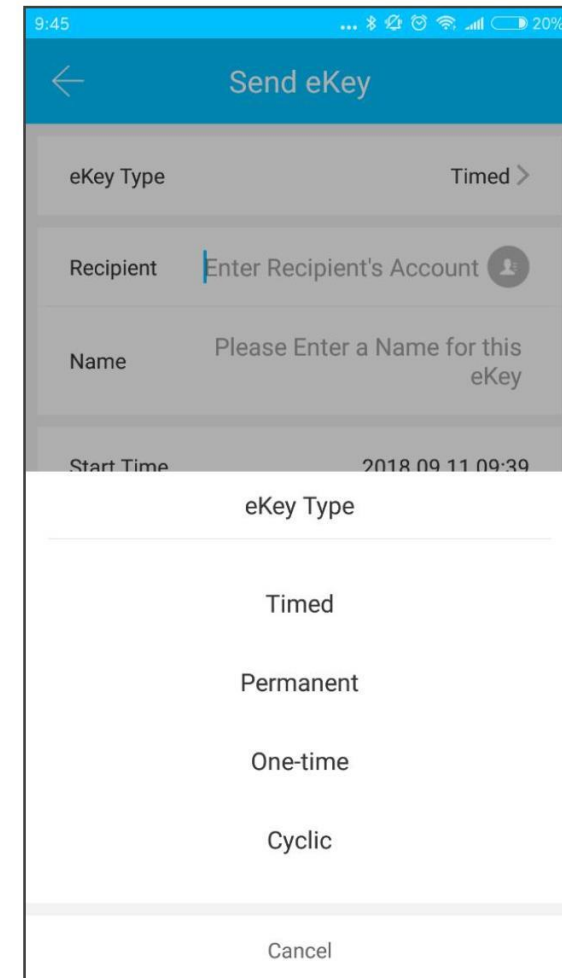

## 3.1 One-time passcode

The ekey sent from the Room Master APP has the function of obtaining a one-time passcode.

as shown :

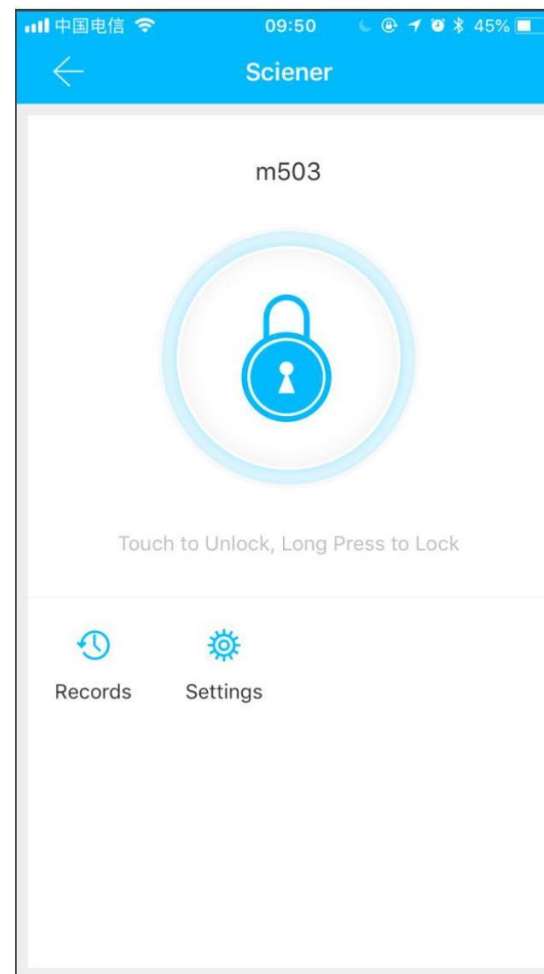

## 3.2 Ekey management

The manager can delete ekey, reset ekey, send and adjust the ekey, meanwhile he can search the lock record.

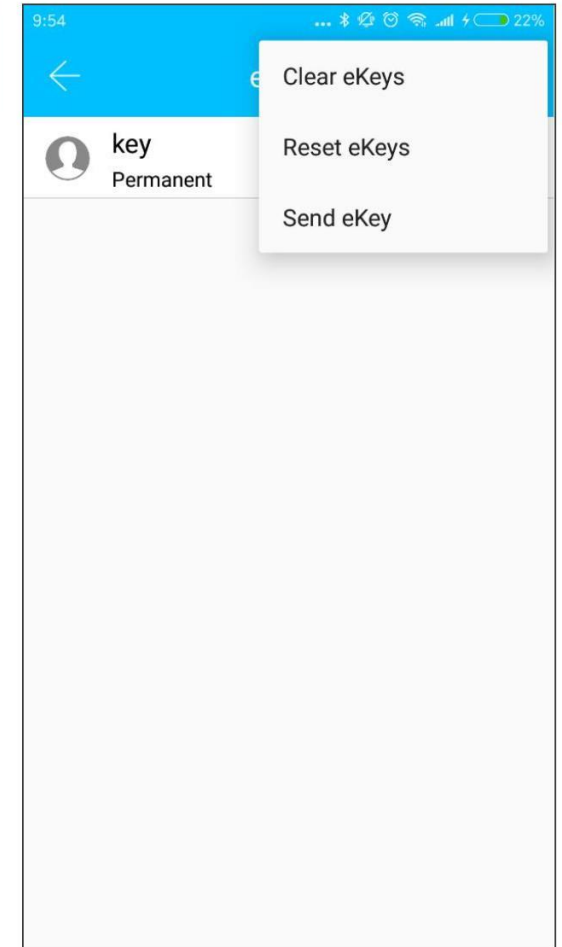
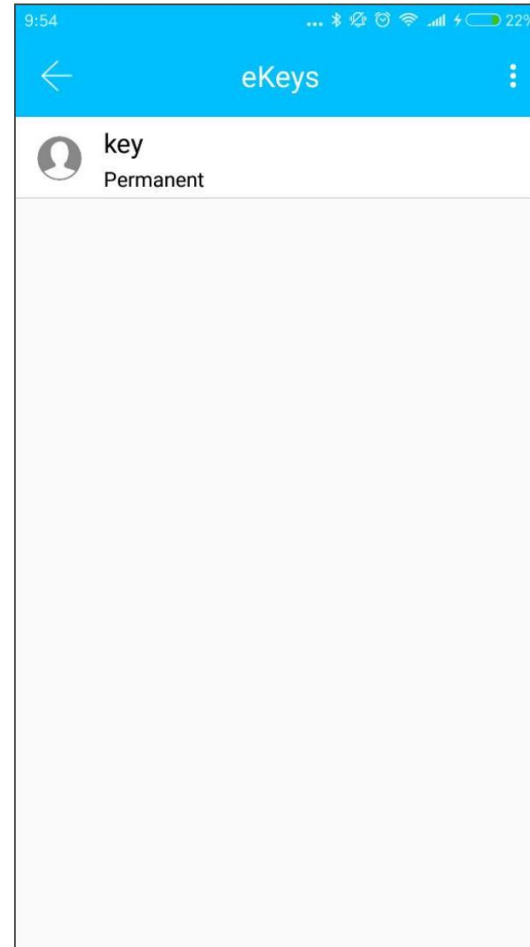

## 3.3 Deadline warning

System will show two colors for deadline warning. The yellow means close to expiring and the red means it has expired.

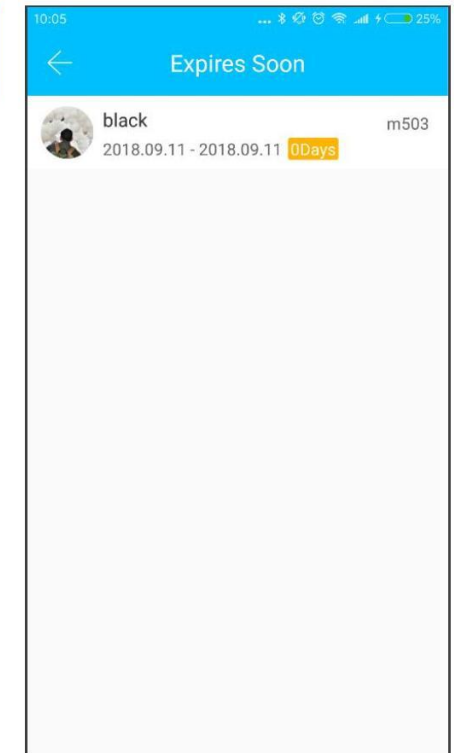
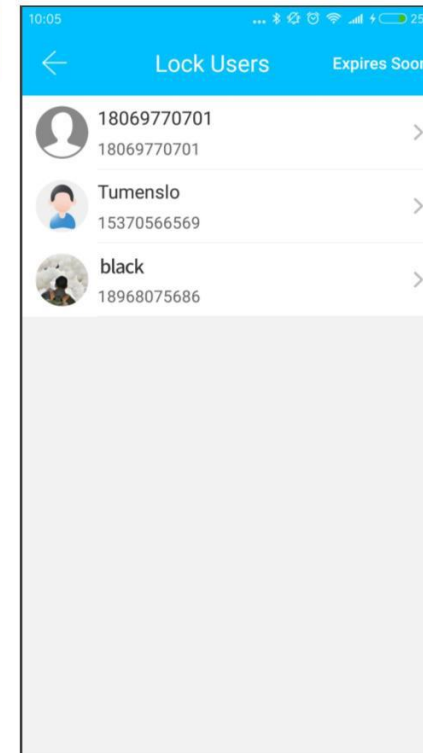
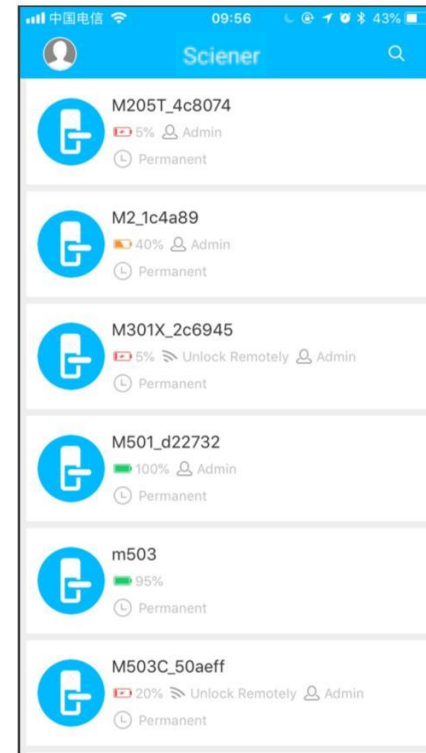

## 3.4 Search lock record

The administrator can query the unlock records of each key.

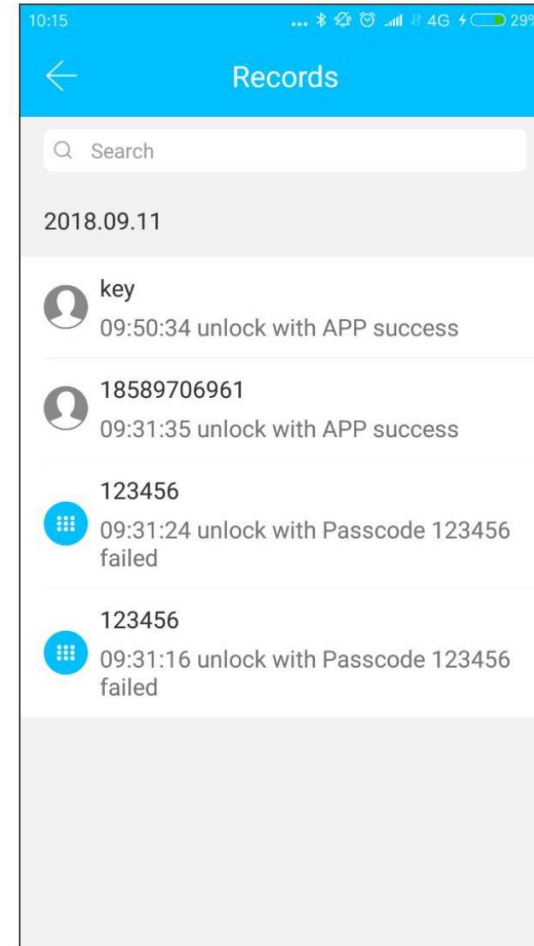

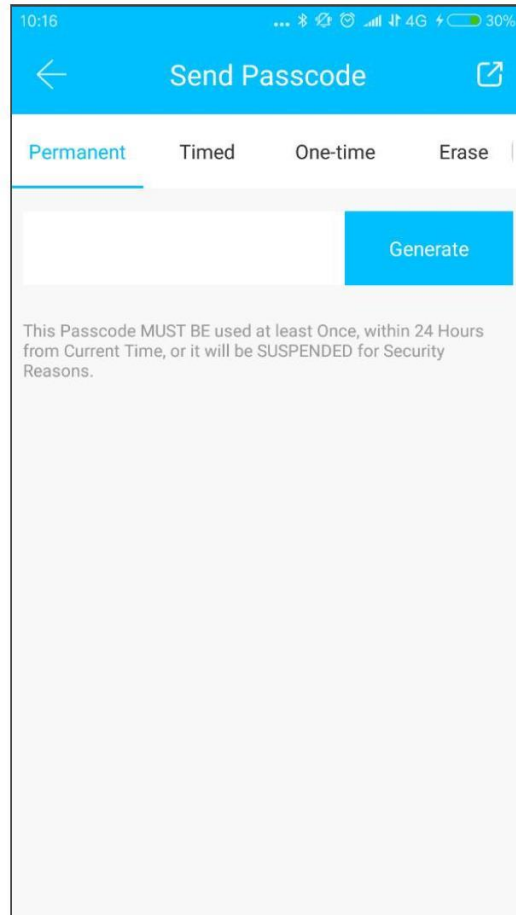

## 4. Type of passcode

After inputting the passcode on the keyboard of the lock, press the unlock button to unlock. Passcodes are classified into permanent, time-limited, one-time, empty, loop, custom, etc.

### 4.1 Permanent passcode

The permanent passcode must be used within 24 hours after it is generated, otherwise it will automatically expire.

## 4.2 Time-limited passcode

The time-limited passcode can own an expiration date, which is a minimum of one hour and a maximum of three years. If the validity period is within one year, the time can be accurate to the hour; if the validity period is more than one year, the accuracy is month. When the time-limited passcode is valid, it should be used within 24 hours, otherwise it will automatically expire.

After inputting the passcode, please press the lock button or # on the right corner to lock the door.

The way to change the passcode: input the original passcode to unlock, then input **“10 # original passcode # new passcode (between 4 numbers and 6 numbers) # input new passcode again # ”** .

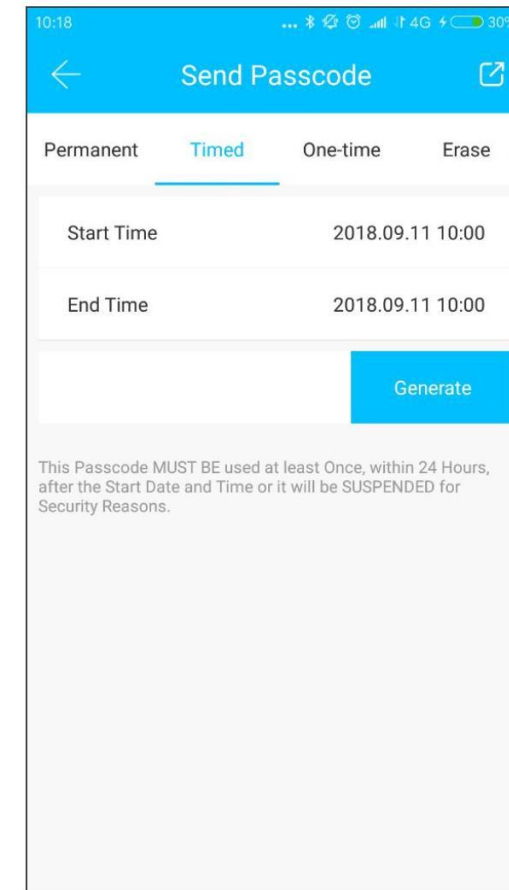



## 4.3 One-time passcode

One-time passcode can only be used for one time, and which is available for 6 hours.

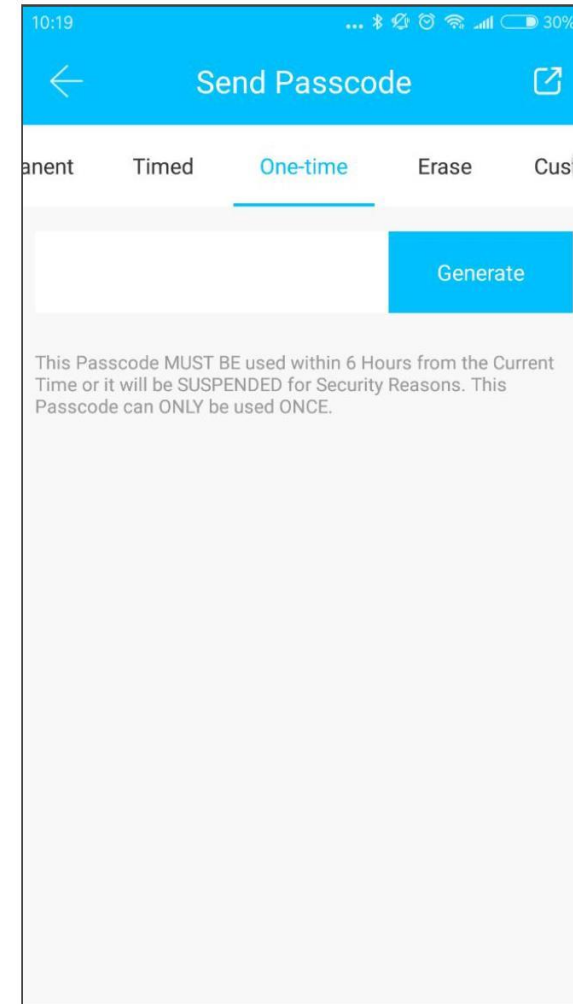

## 4.4 Clear code

Clear code is used to delete all the passcodes the lock has set, and which is available for 24 hours.

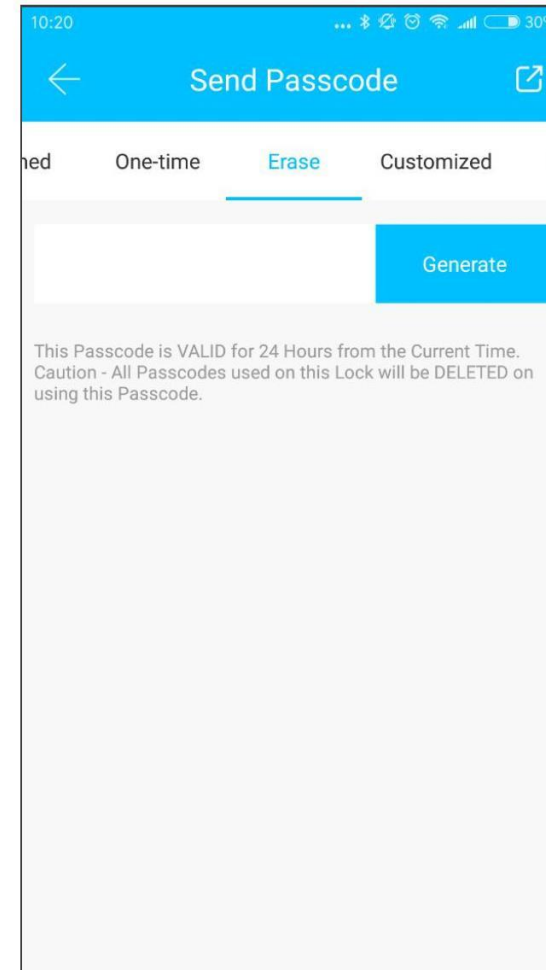

## 4.5 Cyclic passcode

The cyclic password can be reused within a specified time period, including daily type, weekday type, weekend type, and more.

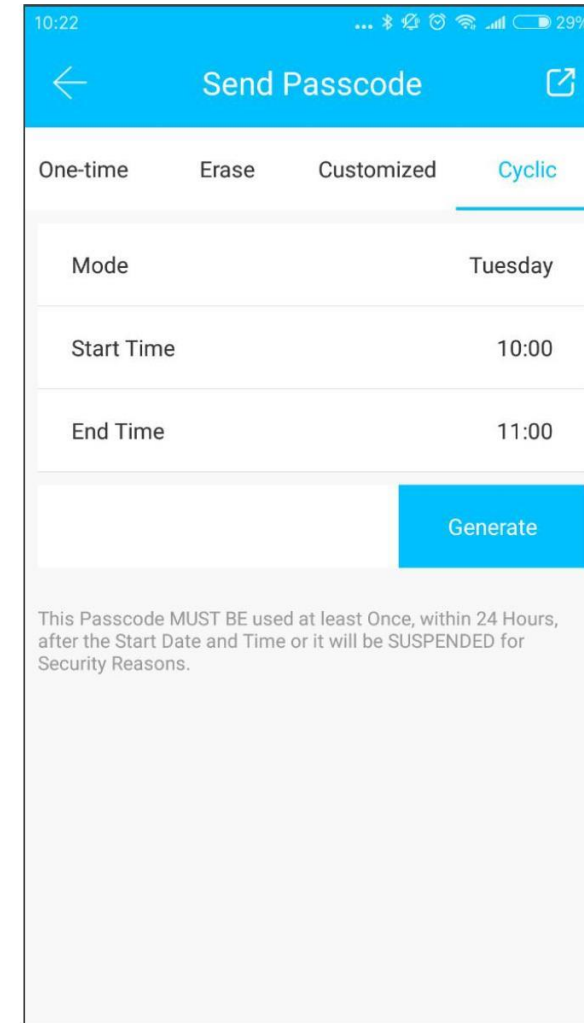

## 4.6 Custom passcode

User can set any passcodes and validity period he wants.

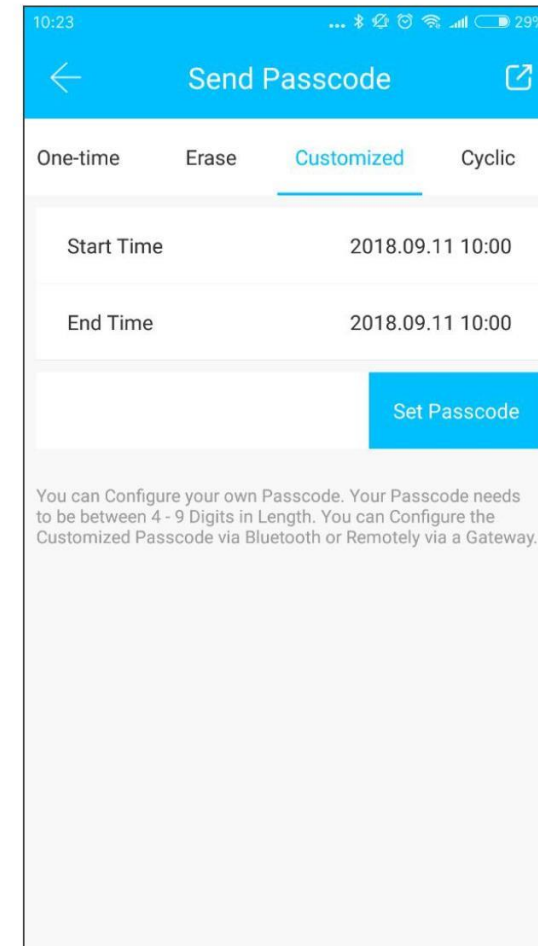

## 4.7 Passcode sharing

The system add new communication ways of Facebook Messenger and Whatsapp to help users share the passcode.

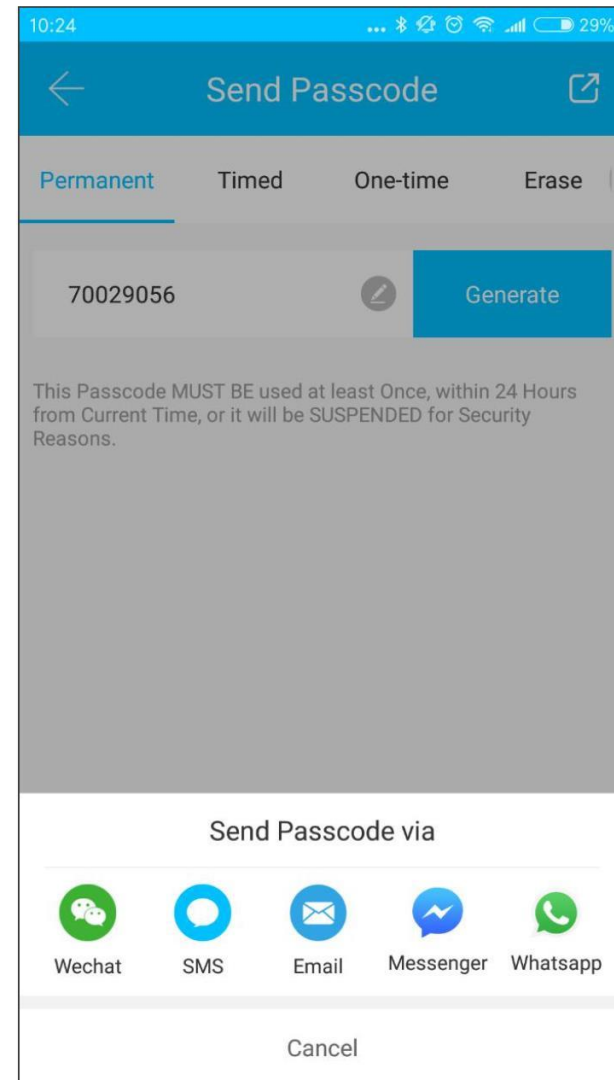

## 4.8 Passcode view and management

All generated passcodes can be viewed and managed in the password management module. This includes the right of changing the password, deleting the password, resetting the password, and unlocking the password.

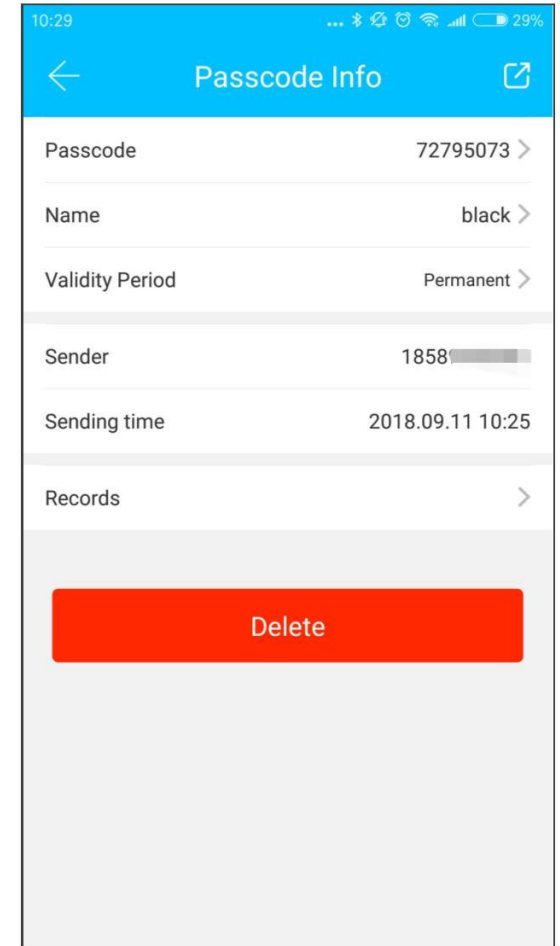
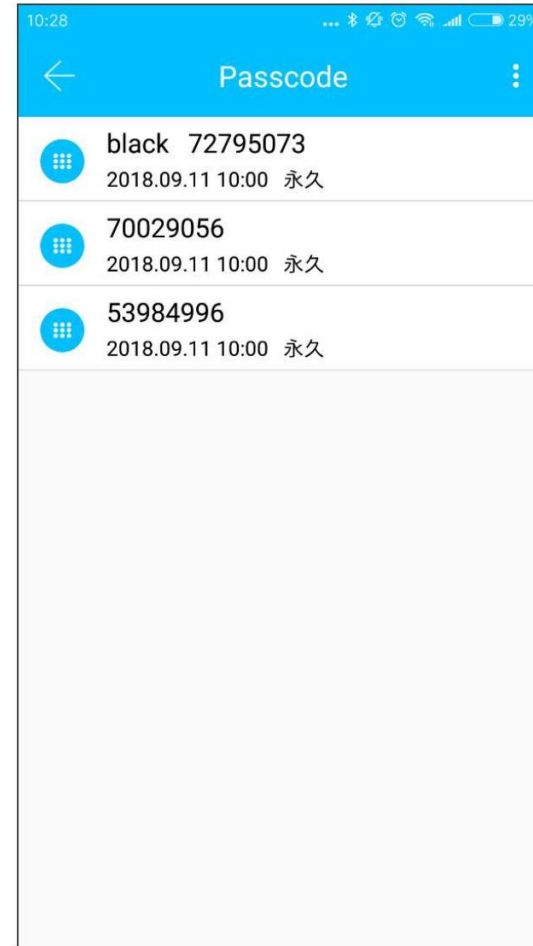

## 5. Card management

You need to add the IC card first. The whole process needs to be done via the app beside the lock. The validity period of the IC card can be set, either permanent or time-limited.

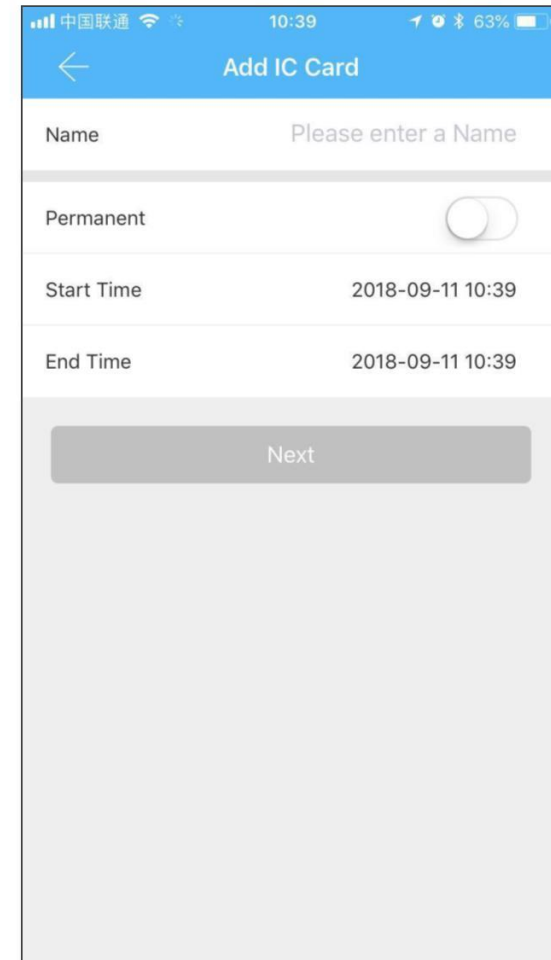

## 5.1 Card view and management

All IC cards can be queried and managed through the IC card management module.

The remote card issuance function is displayed in the case of a gateway. If there is no gateway, the item is hidden.

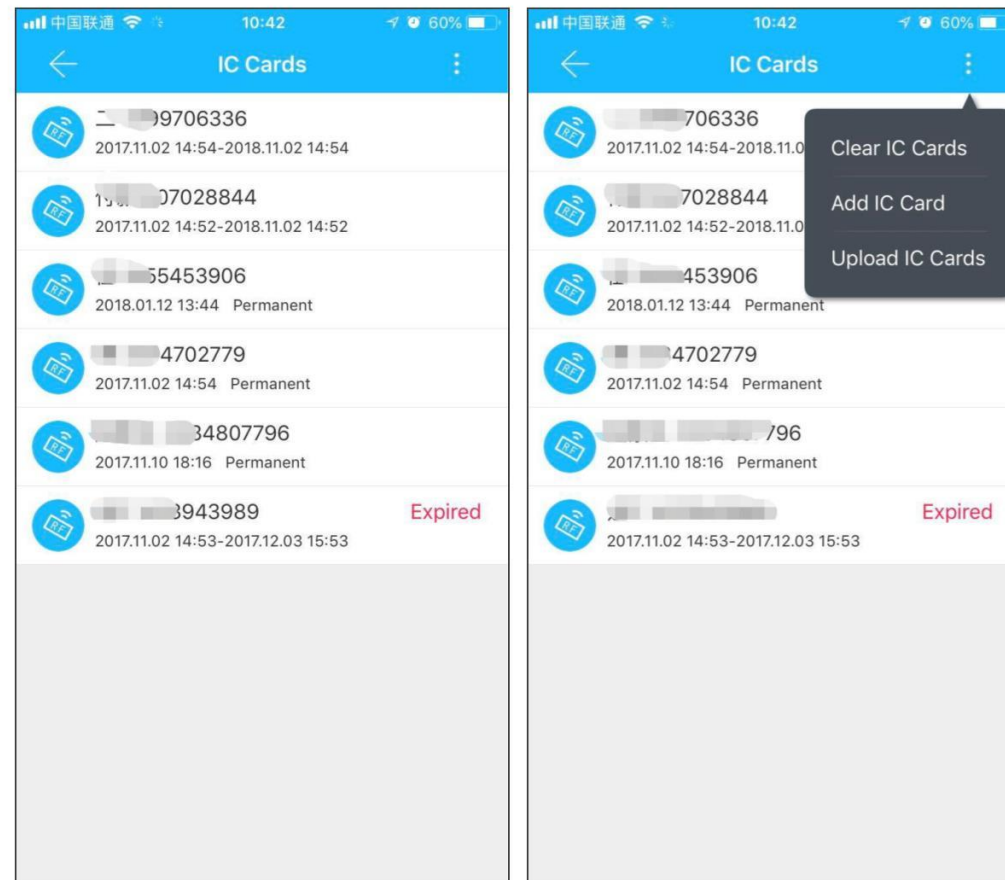



## 6. Fingerprint management

Fingerprint management is similar to IC card management. After adding a fingerprint, you can use the fingerprint to unlock the door.

## 7. Unlock via Bluetooth

User can lock the door via Bluetooth and can also send the Bluetooth ekey to anyone.



Two ways of unlocking the door: a. press the unlock button on the APP; b, touch and light the lock panel.

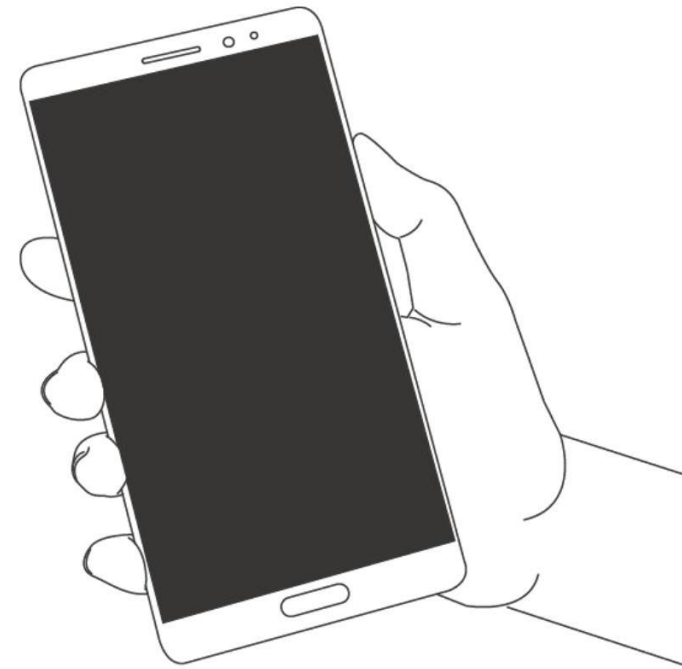

## Use APP to unlock

Click the round button at the top of the page to unlock the door. Since the Bluetooth signal has a certain coverage, please use the APP within the certain area.

## Touch to unlock

You can Open the app and touch the keyboard to unlock the door.

Click the small button to open the door remotely when you have installed the gateway.

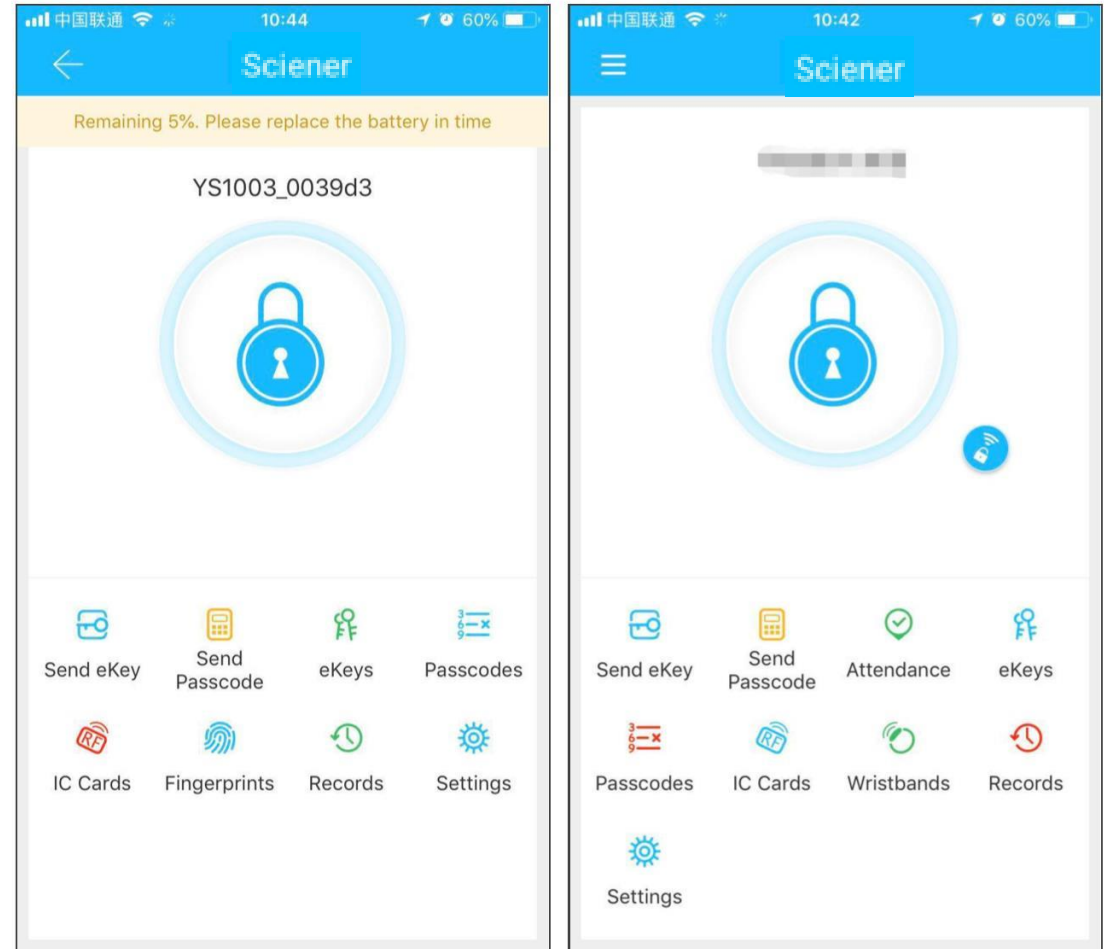

## 8. Attendance management

One product of Sciener is access control, which can be used for company attendance management. The app contains functions of employee management, attendance statistics and so on.

All door locks have attendance function. You can turned the lock on or off in the lock setting.

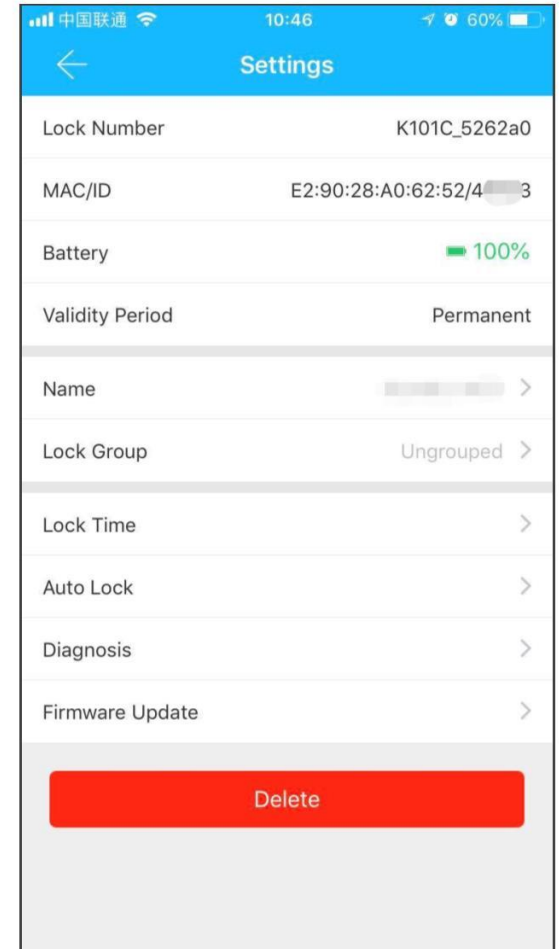
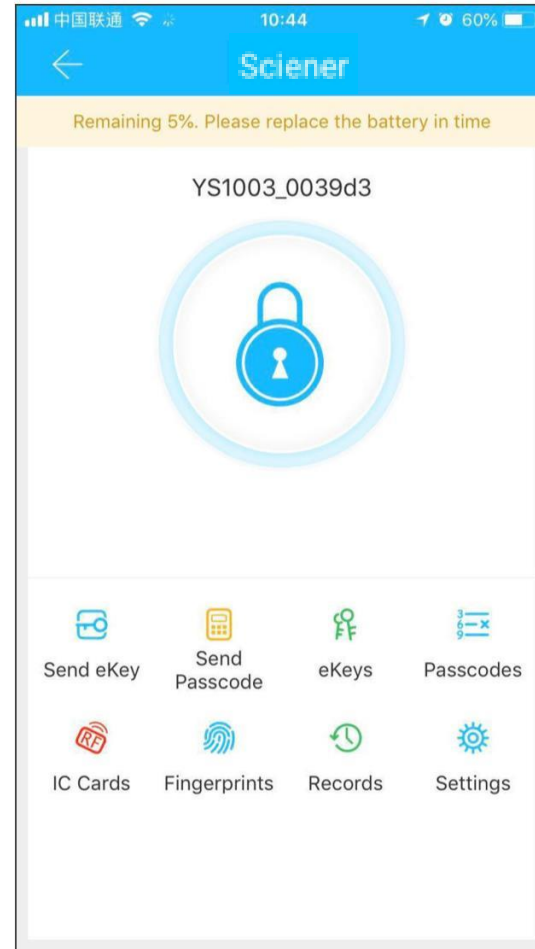

## 8.1 Staff management

Administrator can view and management the staff information in the staff management module.

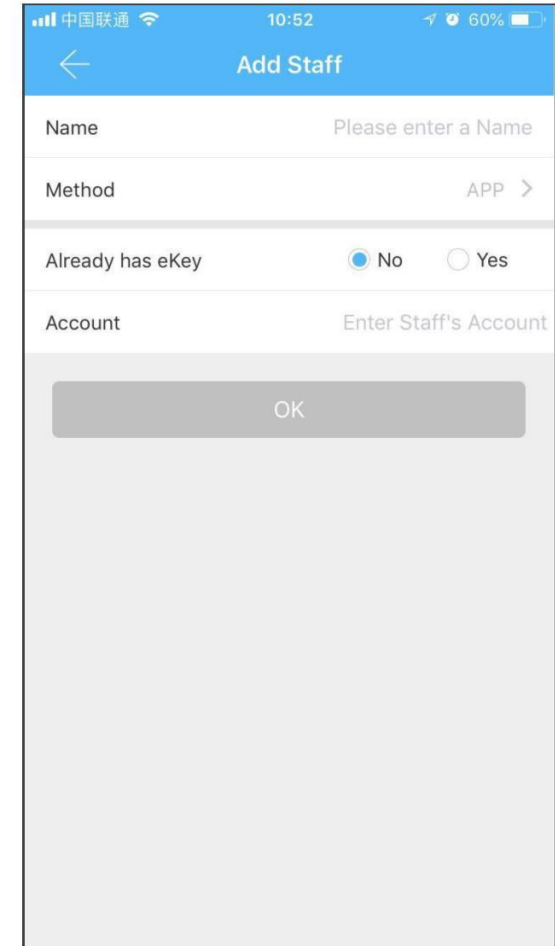
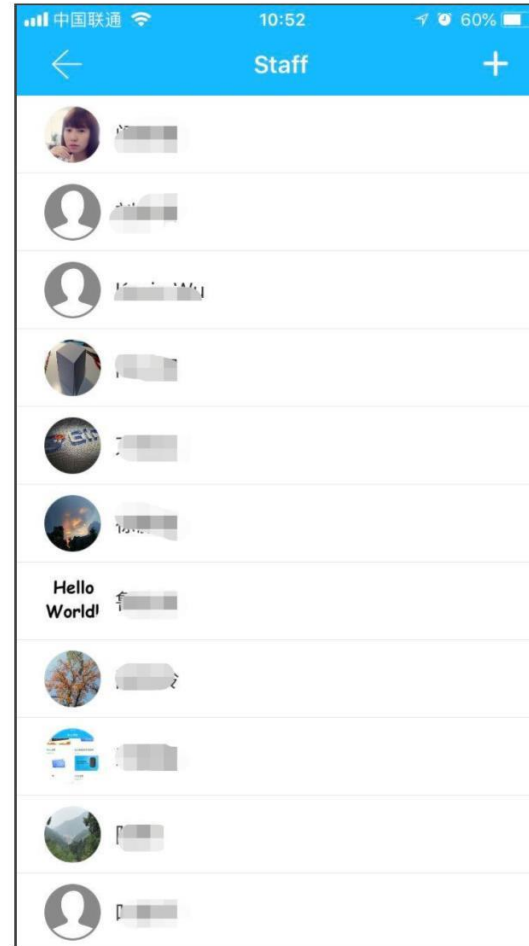

## 8.2 Attendance method

It supports staff attendance in three ways, including App, password, and IC card.

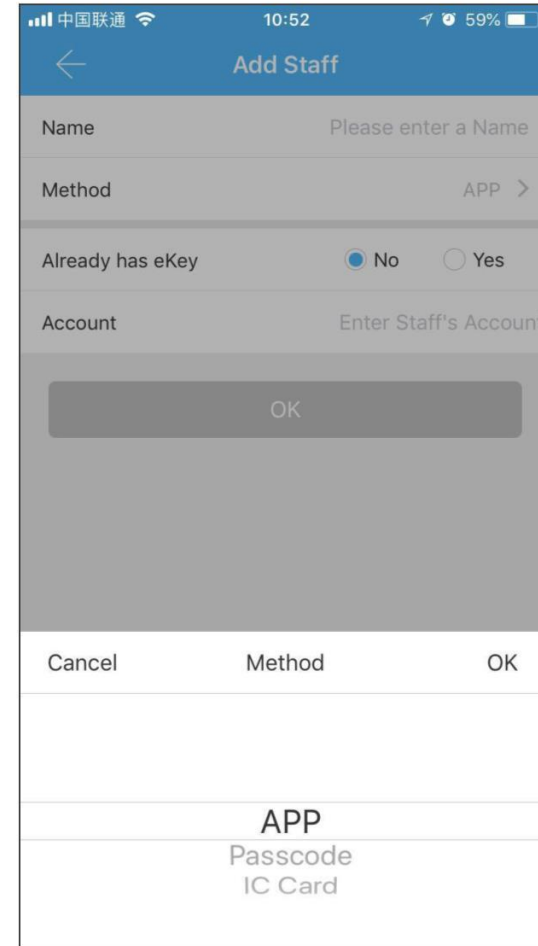

## 8.3 Attendance statistic

In this module, you can check the attendance of all employees on a certain day, according to the time of arrival at the company. Late arrivals, early departures, and unchecked cards are identified in three different colors.

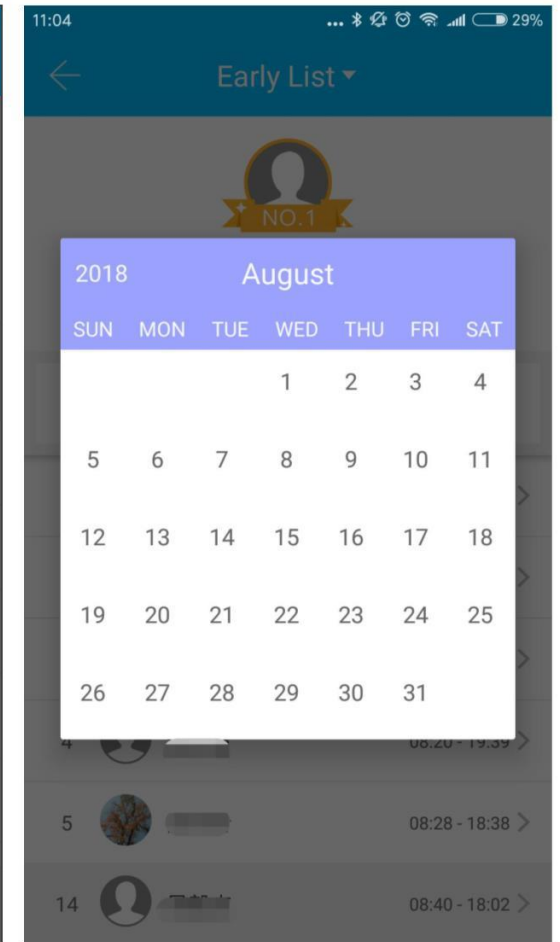
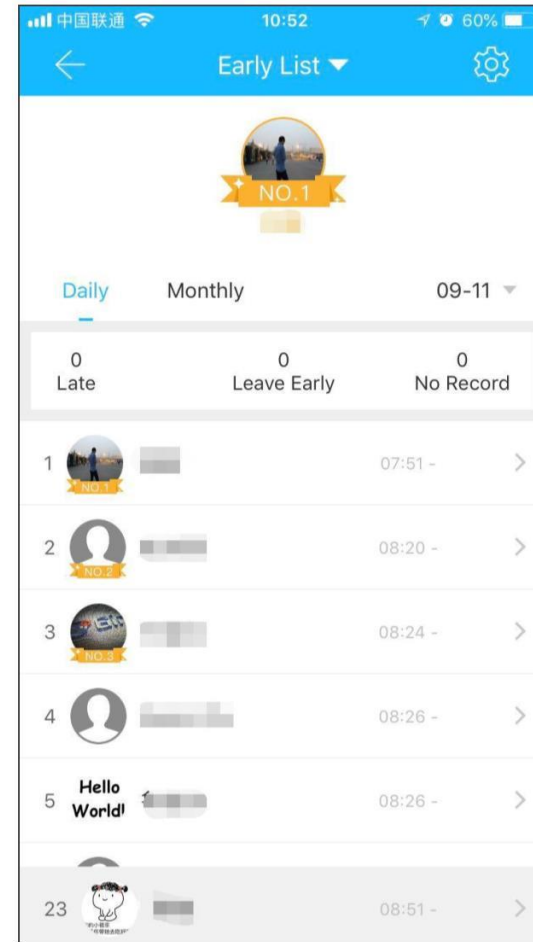

## 8.4 Attendance check

Swipe from left to right to view the staff attendance on different months.

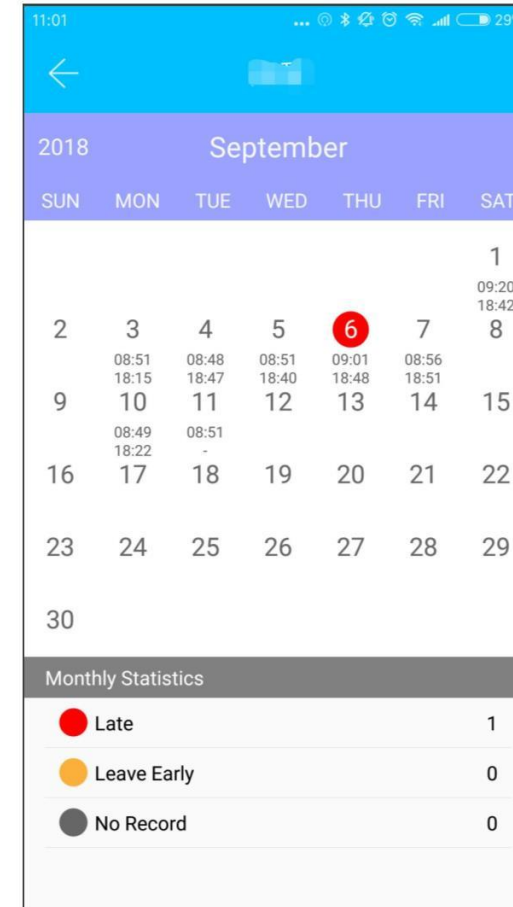



## 8.5 Property settings

In this module, you can set the company name, departments, working hours, working days, and holidays.

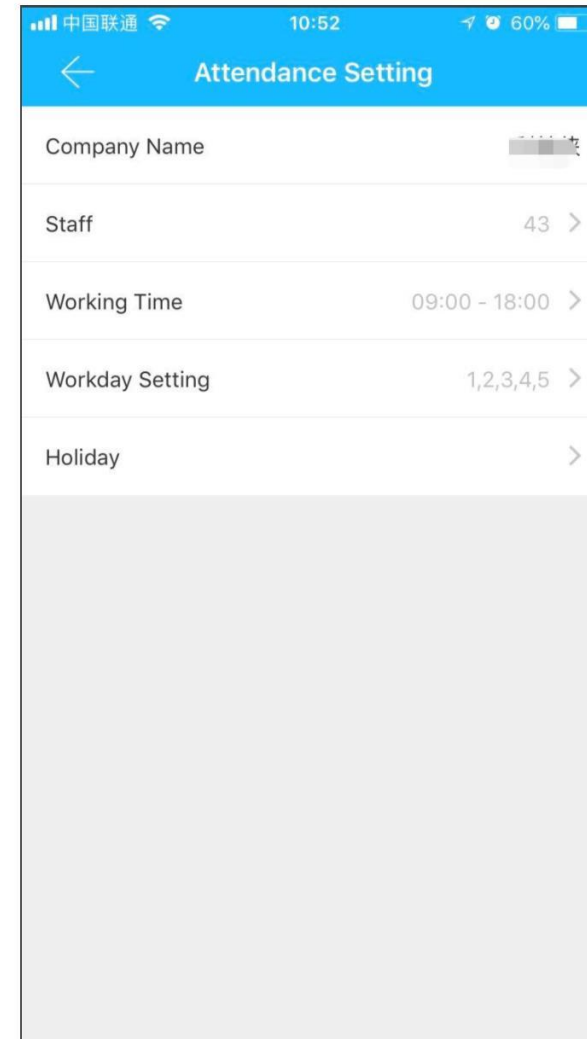

## 8.6 Time settings

The work time settings can judge if you are late or early to leave.

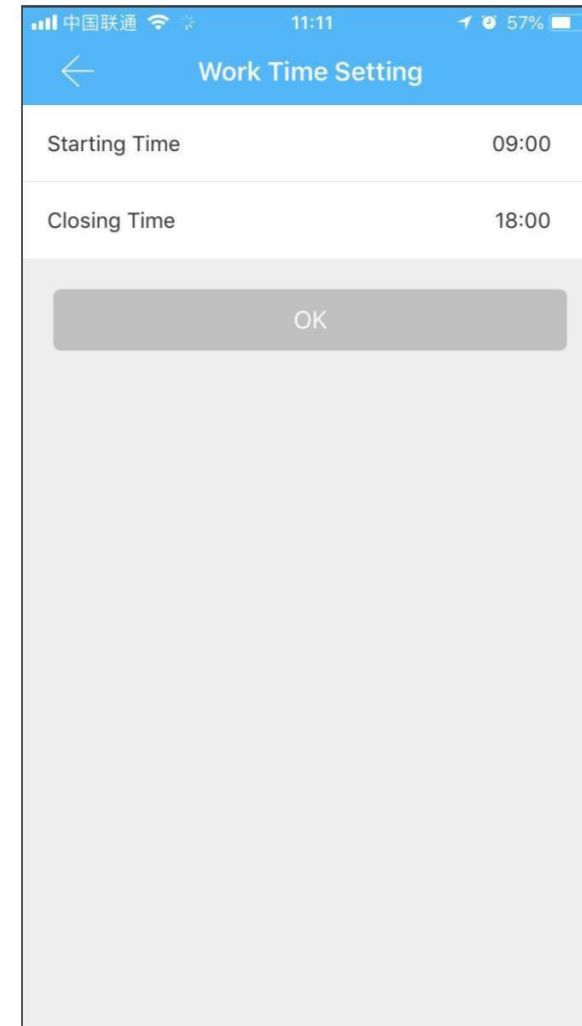

## 8.7 Workday settings

You can set certain workdays you want in this module.

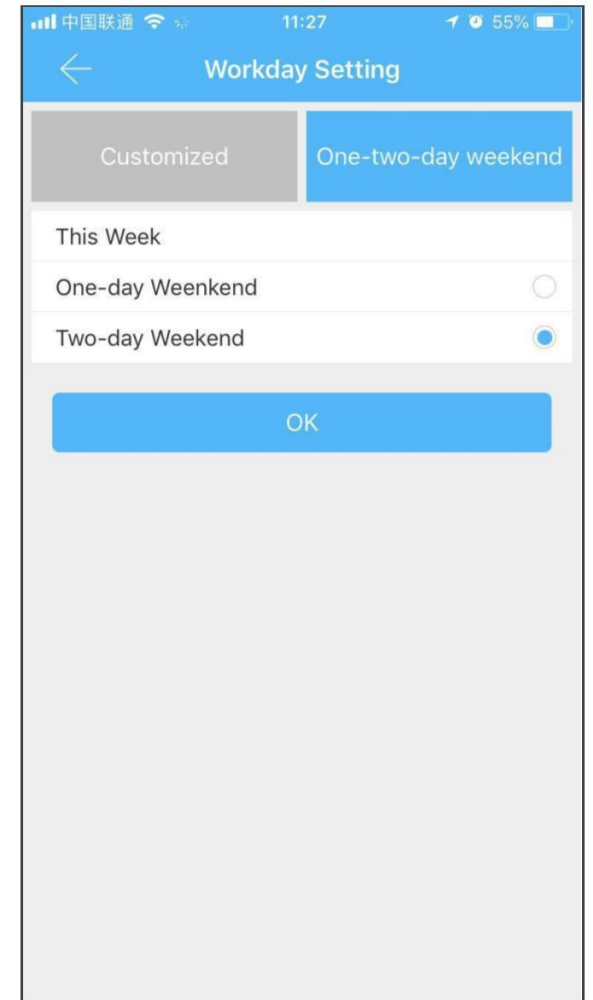
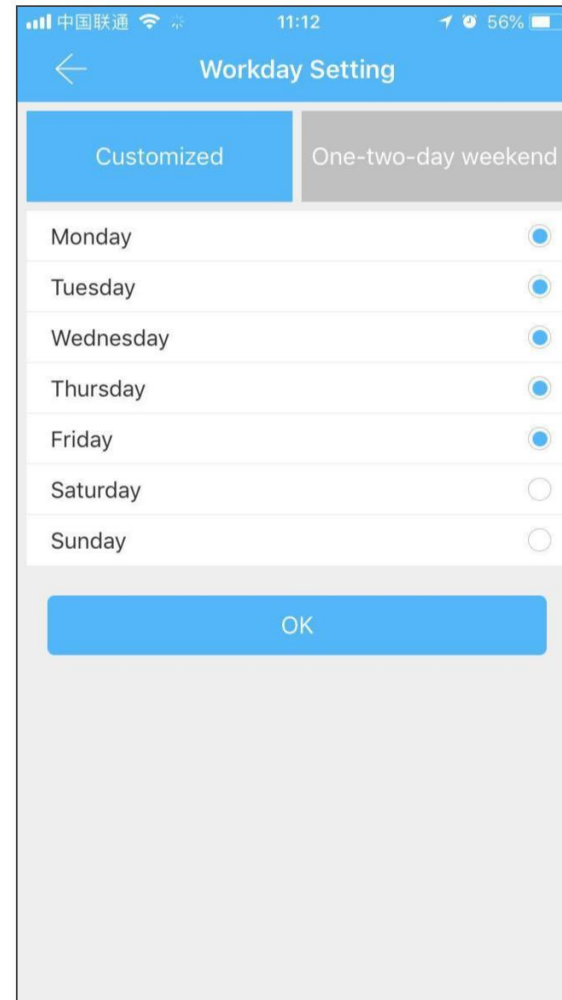

## 8.8 Holiday settings

You can set holidays and workdays according to your need.

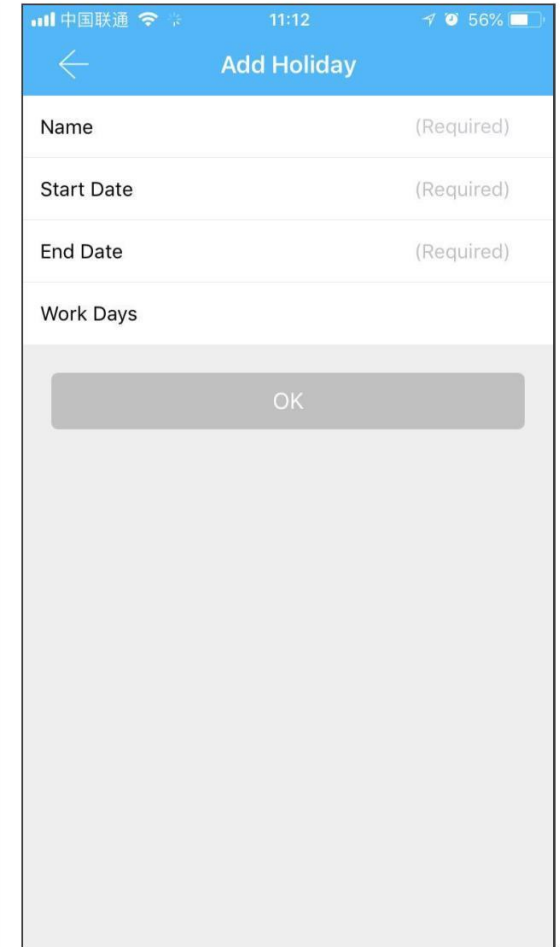
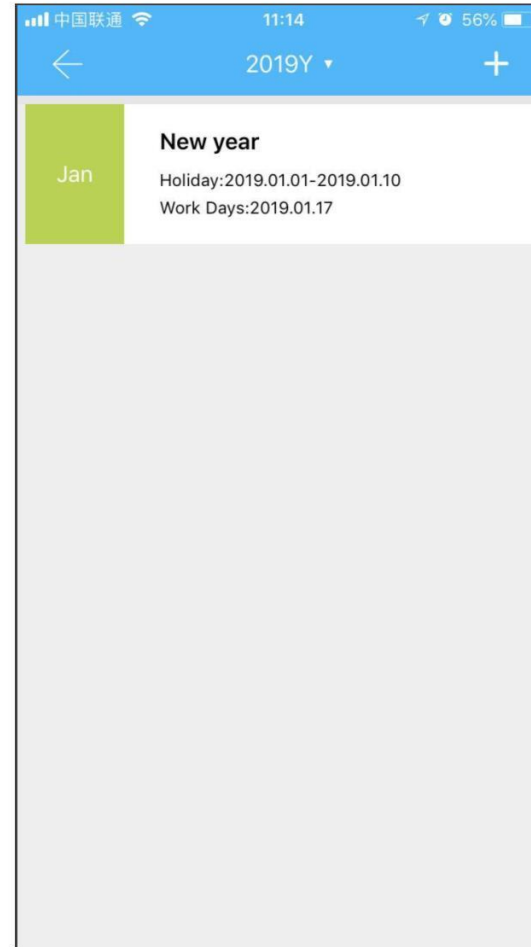

## 9. System settings

In the system settings, it includes touch unlock switch, group management, gateway management, security settings, reminder, transfer smart lock and so on.



Touch unlock setting determines whether you can open the door by touching the lock.

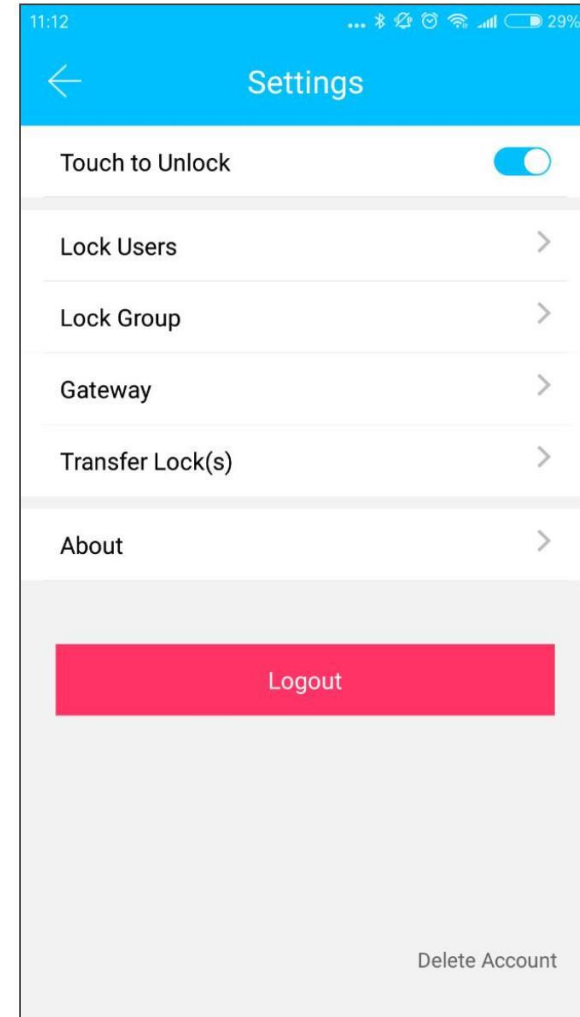

## 9.1 Key groups management

In the case of a large number of keys, you can use group management module.

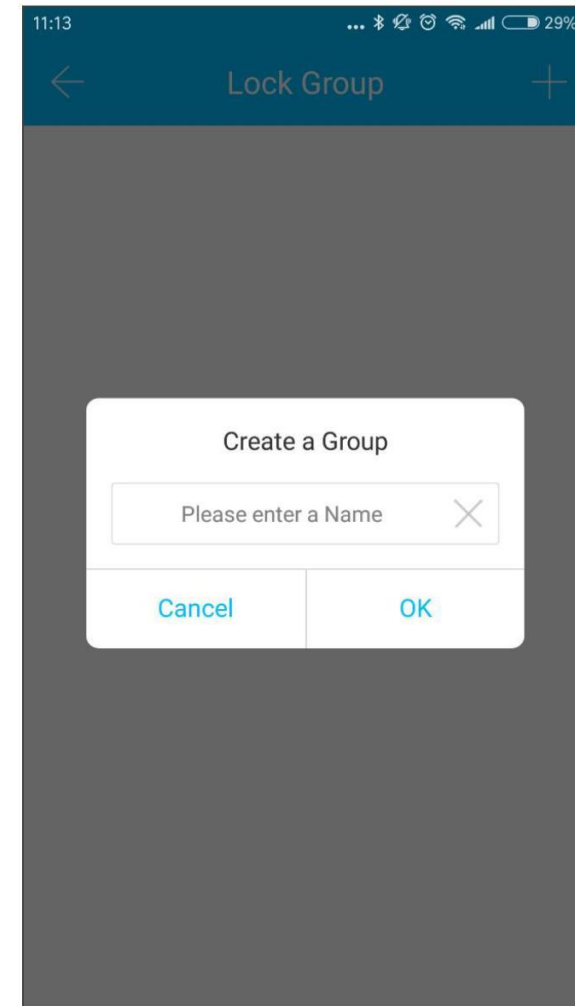

## 9.2 Transfer admin rights

The administrator can transfer the lock to other users or to the apartment (Room Master user). Only the account that manages the lock has the right to transfer the lock.

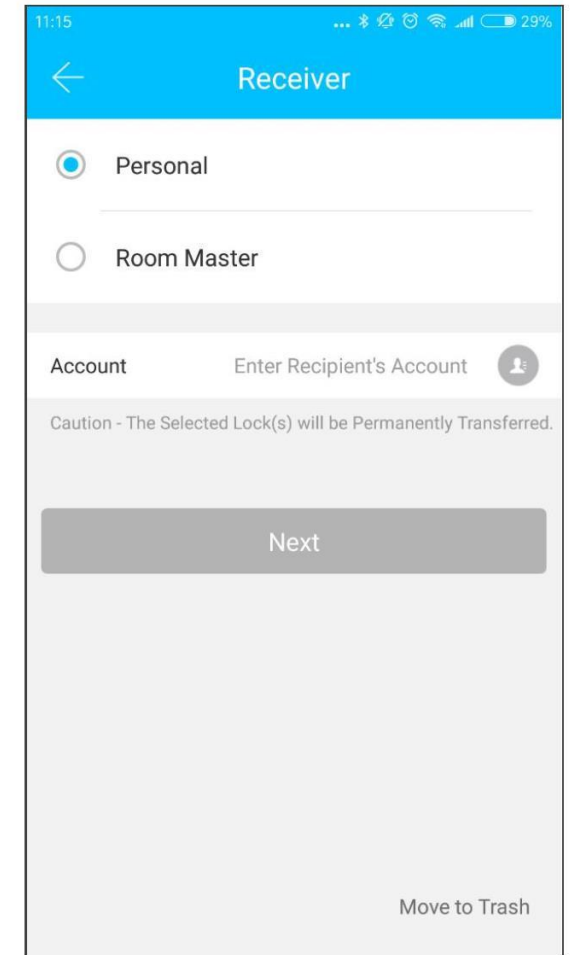
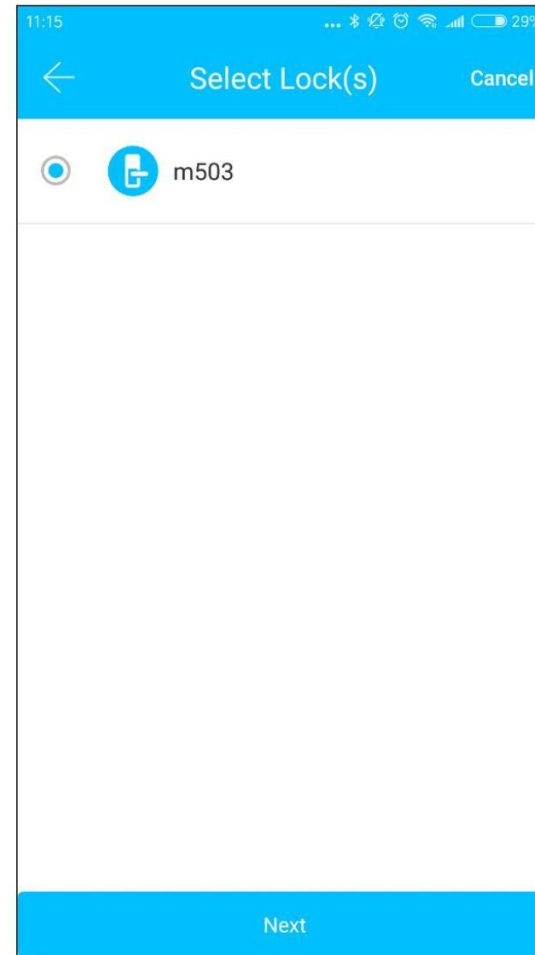

After inputting the account, you will receive a verification code. Filling in the correct number, you will transfer successfully.

 The account of the apartment transfer receive must be the administrator account.

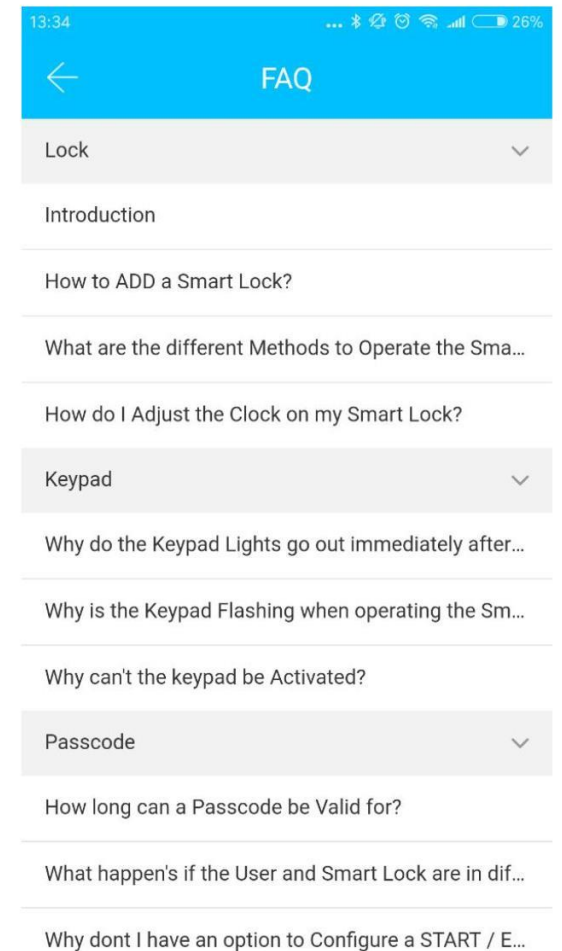
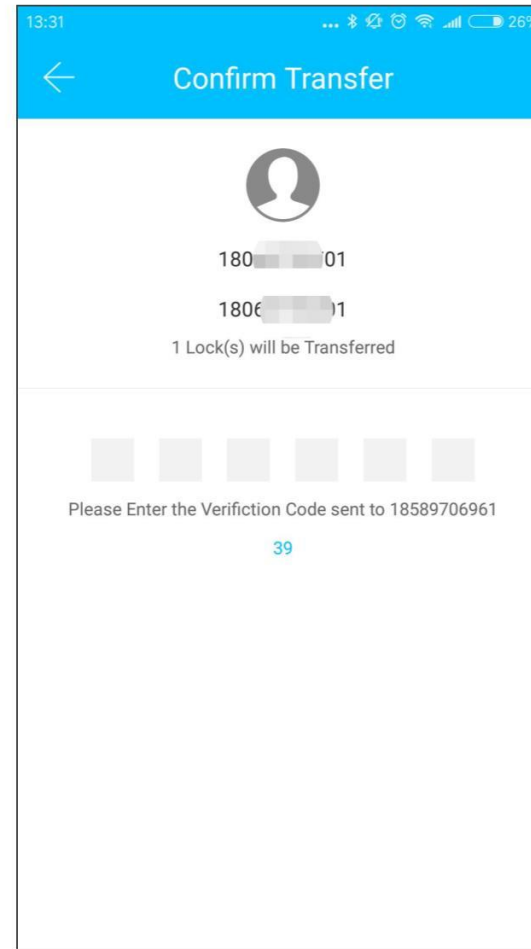



## ( III ) Main functions-customer service

# 9.3 Customer service

You can contact us at  
[support@digitalhome.ph](mailto:support@digitalhome.ph) or visit our  
Facebook page **DigitalhomePhilippines**

## 9.4 About the APP

In the About mobile app, you can check the version number of the app.

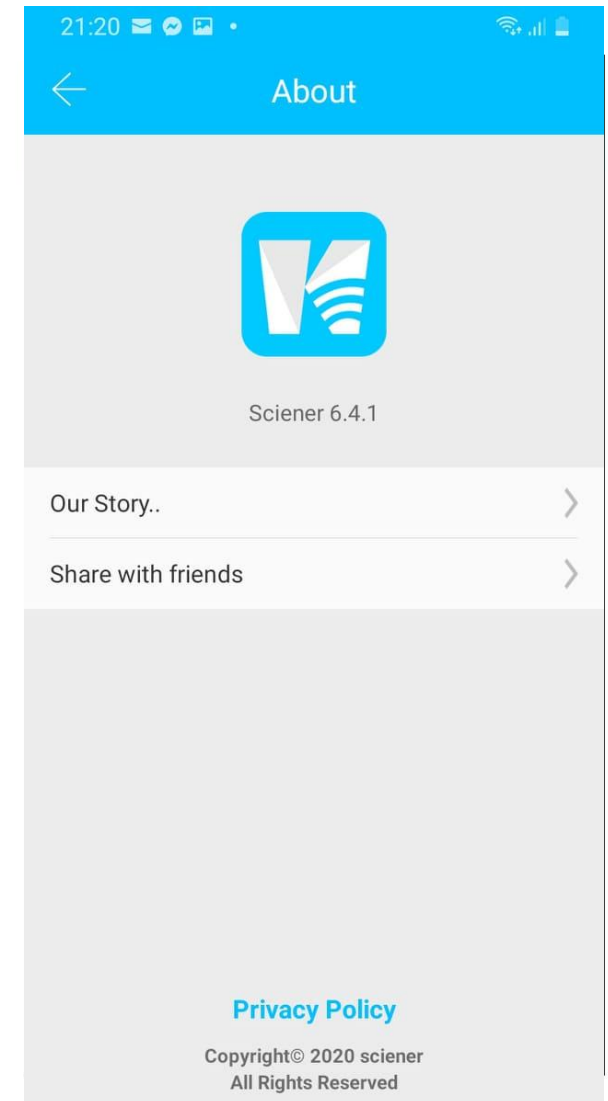
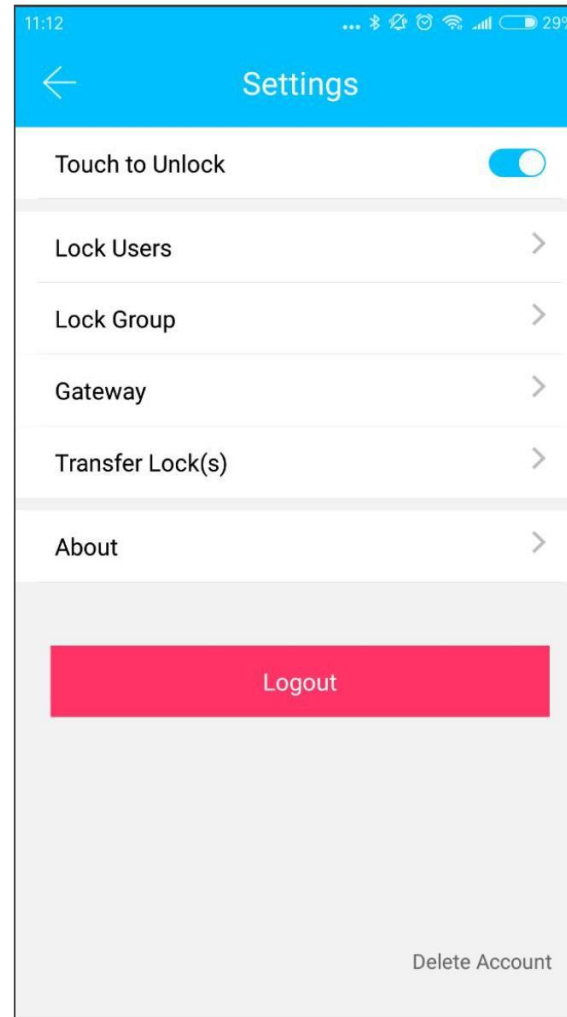

## 10. Gateway management

The Sciener is directly connected via Bluetooth, that is why it is not attacked by the network. The [G2\\_gateway](#) is a bridge between smart locks and home WIFI networks. Through the gateway, the user can remotely view and calibrate the lock clock, read the unlock record. Meanwhile, it can remotely delete and modify the password.



## 10.1 Add the gateway

Please add the gateway via APP

steps :

A、 Connect your phone to the WIFI network which the gateway is connected to.

B、 Click the plus button in the upper right corner and input the WIFI passcode and gateway name.

Click OK and input the passcode for authentication.

C、 Press and hold the setting button on the gateway for 5 seconds. The green light indicate that the gateway has entered the add-on mode.

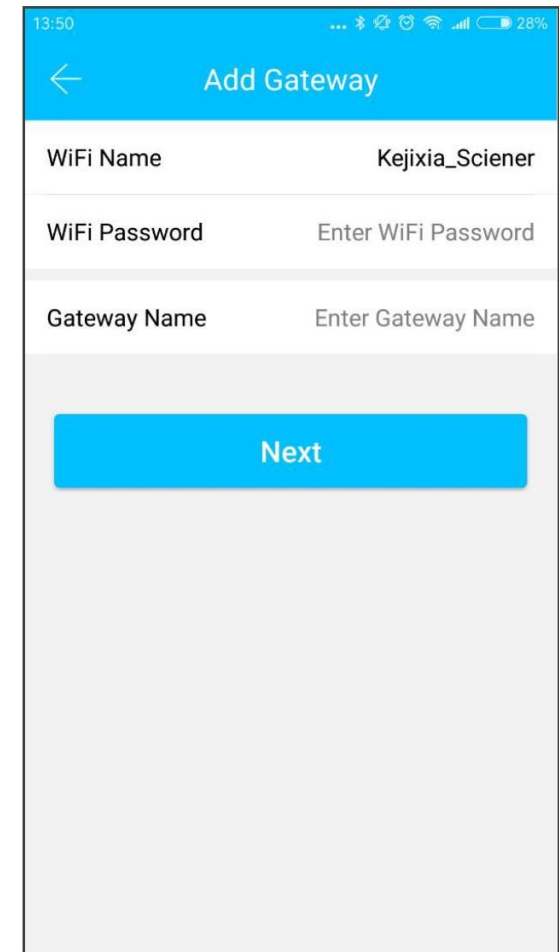
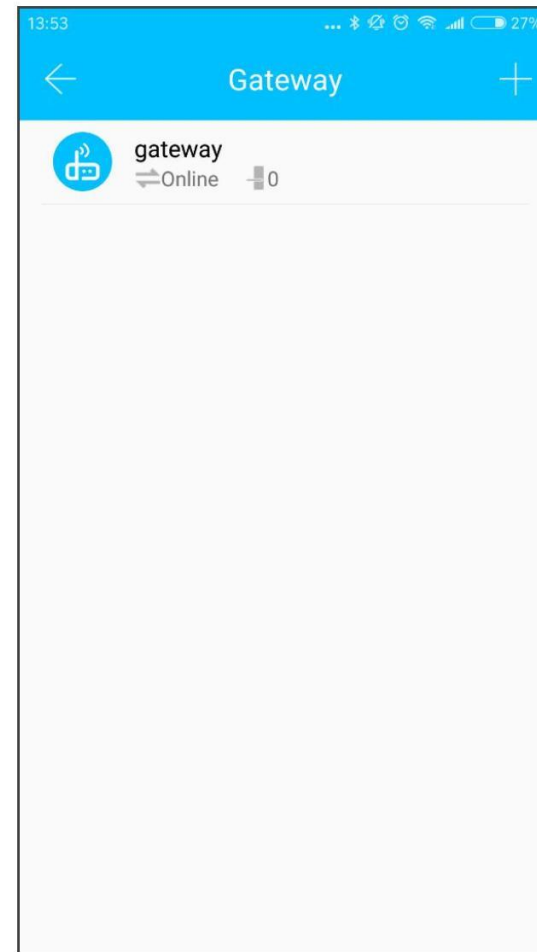

## 10.2 Manual

After a short period of time, you can see which locks are in their coverage in the app. Once the lock is bound to the gateway, the lock can be managed through the gateway.

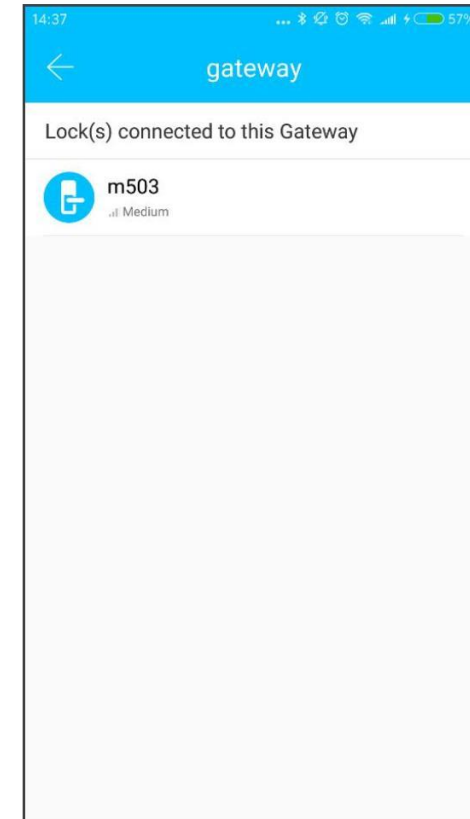
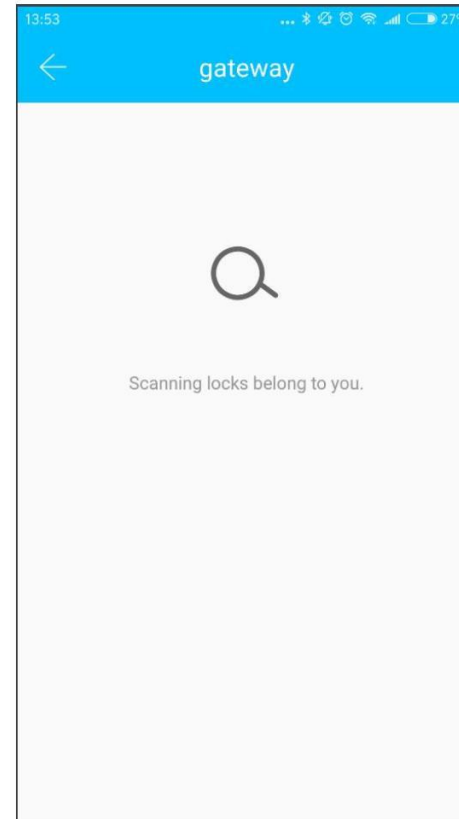

# Making your home SECURE. And a SMART one



**SMART LOCK**



**HOME SECURITY**



**SMART LIGHTING**



**SMART GATE**



**VOICE ASSISTANTS**



**HOME  
AUTOMATION**