

RGB+CCT Remote Control (GL-RC-006Z)

This manual describes RGB+CCT remote control used for our RGB+CCT products. Remote control can control the LED lights up to six different Zones, change the color, dim/brighten the lights, warm/cool white, different programs. In this manual, you will learn.

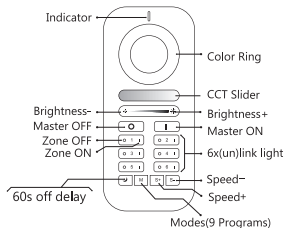

Technical data:

Size:18x55x130mm
Material:PC
Transmitting Power:6dB
Modulation Method:GFSK
Programs:9 kinds
Power:3V(AAA battery*2pcs)
Standby power:15µA
Working Temp:-20°C~60°C
Max control Range: 20m
RF Frequency:2.4GHz
Warranty:2 Years

Battery Installation

Please take the remote control and carefully press the battery cover and push it away in a downward motion. Install two AAA batteries, exactly match the negative (-) pole of each battery to the largest spring. Don't touch the color ring when you install the batteries. Place the battery cover back and install tightly.

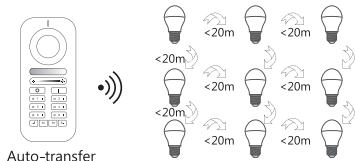

How to link & use

1. Within 3 seconds after power on, click the "on" button of the group to conduct code matching, and the LED light turns green, indicating successful code matching.
2. Long press the "off" button of the remote control to enter the night light mode, and the brightness and color can still be adjusted at this time.
3. Long press the small moon key to enter the 60 seconds delay shutdown state.
4. Long press M key to enter automatic mode.

How to unlink

1. If the LED is still connected to the ZigBee gateway, long press the "on" button on the remote control within 3 seconds after power on or press the button for 5 times continuously, the light will flash for 5 times in the current color;
2. If the LED is not connected in the ZigBee gateway state, long press the "on" button on the remote control within 3 seconds after power on or press the button for 5 times continuously, then the LED light will be fully bright and flashing for 5 times;

Mode description

Mode 1: Static warm light (warm light alone)

Mode 2: Static white light (cold light and warm light are equally bright)

Mode 3: Static cold light (cold light alone)

Mode 4: Static red light

Mode 5: Static green light

Mode 6: Static blue light

Mode 7: RGB fade in fade out (Color fade in fade out from red to green, then to blue, then to red, and so on, speed adjustable.)

Mode 8: RGB flash (Color flash from red to green, then to blue, then to red, and so on, speed adjustable.)

Mode 9: Color breathing (In this mode, the brightness of current color will cycle from from 100%-0%, then from 0%-100%. At the same time, you can switch the color and have a cycle repeatedly. Pressing switch /mode button to exit this mode.)

RGB+CCT Wall Switch (GL-W-003Z)

This Panel Wall switch is designed by a delicate and fashionable tempered glass panel; And we adopt a high precision Capacitive touch screen IC. Touch Screen is very stable; 2.4GHz high RF wireless control with long distance controlling, low power consumption and high speed transmitting rate. This product widely work on our smart LED Lighting, LED Controller and Smart panel controller, etc.

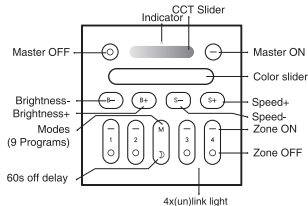

Technical data:

Working Temperature: -20-60 °C
 Input Voltage: 3V(2*AAA Battery)
 Radio Frequency: 2400-2483.5MHz
 Modulation Method: GFSK

Transmitting Power: 6dBm
 Control Distance: 20m
 Standby Power: 15uA
 Size: 80x80x19mm



Auto-transfer

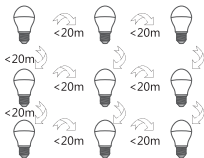

Battery Installation

Please take the wall switch and carefully press the battery cover and push it away in a downward motion. Install two AAA batteries, exactly match the negative (-) pole of each battery to the largest spring. Place the battery cover back and install tightly.

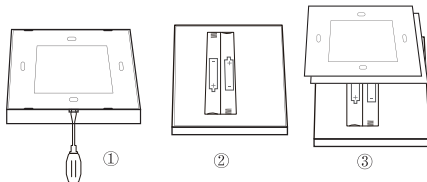

Warranty:

Warranty policy is valid if the product is used in accordance with the instructions and for its intended purpose.

Cleaning and maintenance:

To avoid scratching, the product should only be cleaned with a soft dry cloth. Do not use cleaning agents.

Disposal of your old product:



Your product is designed and manufactured with high quality materials and components, which can be recycled and reused. When this crossed-out wheeled bin symbol is attached to a product it means the product is covered by the European Directive 2011/65/EU.

Please find out for yourself about the local separate collection system for electrical and electronic product.

Please act according to your local rules and do not dispose of your old products with your normal household waste. The correct disposal of your old product will help prevent potential negative consequences for the environment and human health.

