



BIOMETRIC HANDGUN HANGER SAFE LOCK INSTRUCTIONS

OPEN:



STEP 1: Twist key LEFT ↺ (counter-clockwise) to open door for the first time.

INSERT BATTERY OR POWER CABLE:

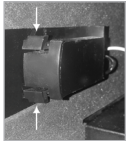

STEP 2: Pinch tabs together and slide out the battery compartment.



STEP 3: Insert a 9V battery into battery compartment & slide battery compartment back into place.

CHANGE YOUR COMBINATION:



DEFAULT COMBINATION:
1-2-3-4-1-2

STEP 4: Hold down **BUTTON 1** until green light turns on - lock will beep twice.

STEP 5: Enter your **current 6-digit combination** - lock will beep twice.

*When opening the safe for the first time, use the factory **DEFAULT COMBINATION: 1-2-3-4-1-2**

STEP 6: Enter your **NEW 6-digit combination** - lock will beep 3 times.

STEP 7: **Re-enter your NEW 6-digit combination** - lock will chime.

Your new combination is now installed.

*If lock beeps 5 times, combination was not installed successfully. Restart from STEP 4.

IMPORTANT! Test your new combination several times with the door open to ensure new combination is properly set before closing and locking safe.

RECORD NEW COMBINATION HERE:

□-□-□-□-□-□

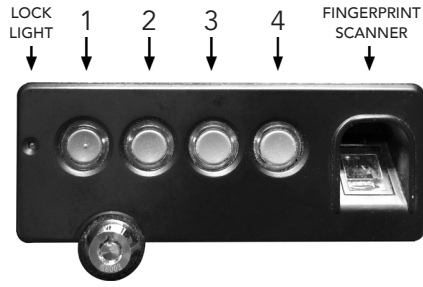

Your Electronic Lock is currently set with the default combination of:
1-2-3-4-1-2

BIOMETRIC FINGERPRINT SCANNER:

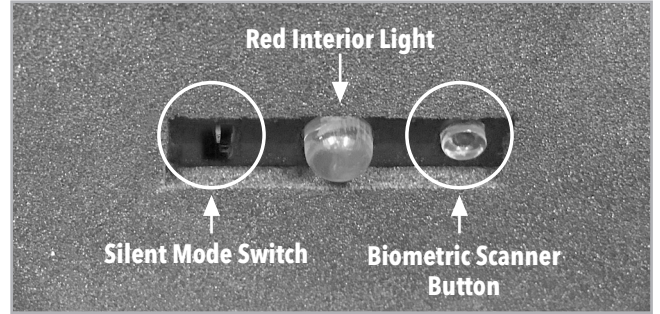

NOTE: This safe WILL open with any fingerprint until the first fingerprint is registered. If it's still opening with every fingerprint you have NOT yet successfully registered your fingerprint.

STEP 8: Press **ONCE** (do NOT hold) biometric scanner button - lock will beep twice / lock light and finger scanner will illuminate green.

STEP 9: Position finger fully on biometric scanner - hold until lock chimes.



Your Fingerprint is Now Installed Successfully.

*If lock beeps 5 times, lock light flashes red, and fingerprint scanner stays green, fingerprint was not installed successfully. Restart from Step 8.

SILENT MODE:

Press the switch next to the interior light to turn silent mode ON/OFF.

BATTERY LIFE:

If you see a continuous red light on - replace battery.

OPERATING INFORMATION:

- Lock will go into standby after 10 seconds of inactivity.
- Lock will go into lockout mode for 5 minutes after 5 wrong combination attempts.

RESET LOCK:

- Hold down biometric scanner button until lock beeps 5 times.
- Lock will reset to the default code: 1-2-3-4-1-2 and erase all registered fingerprints.

HANDGUN HANGER SAFE **SECURITY CABLE INSTRUCTIONS**



STEP 1: Wrap cable around a secure object and insert lock through the loop on the other end of the cable.

STEP 2: Make sure bolt is in unlocked position. Insert locking bolt into hole located at the rear of the safe.

STEP 3: Twist key to the RIGHT (clockwise) to lock cable in place. Remove key.

Your security cable is now installed.

*To unhook cable, insert key and twist to the LEFT (counter-clockwise). Remove lock.

Power Cable Installation

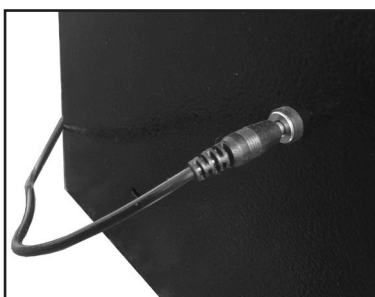

To install power cable, simply insert cord into the power cable hole and plug into an outlet.

Unlocked



Locked

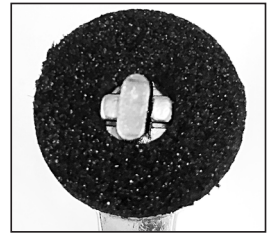

Key will only release while locked.



STEP 1

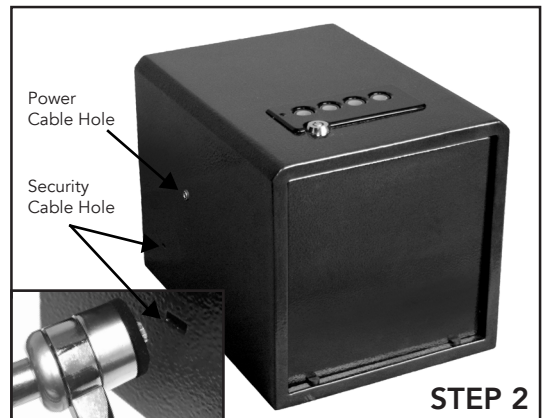

STEP 2

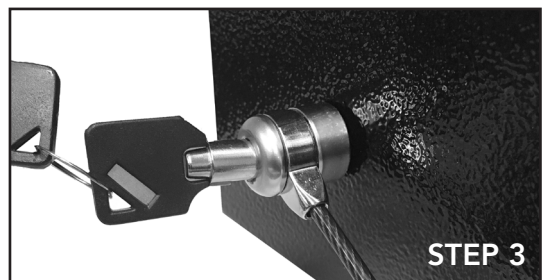

STEP 3

