

USER MANUAL

Zopec PHOTONS Solar Chargers

Models: 60Pro (21SC60P) and 100Pro (21SC100P)



1. PRODUCT CONTENT

1. Zopec Photons Solar Charger
2. One Type C – C Cable

2. PRODUCT DIAGRAM

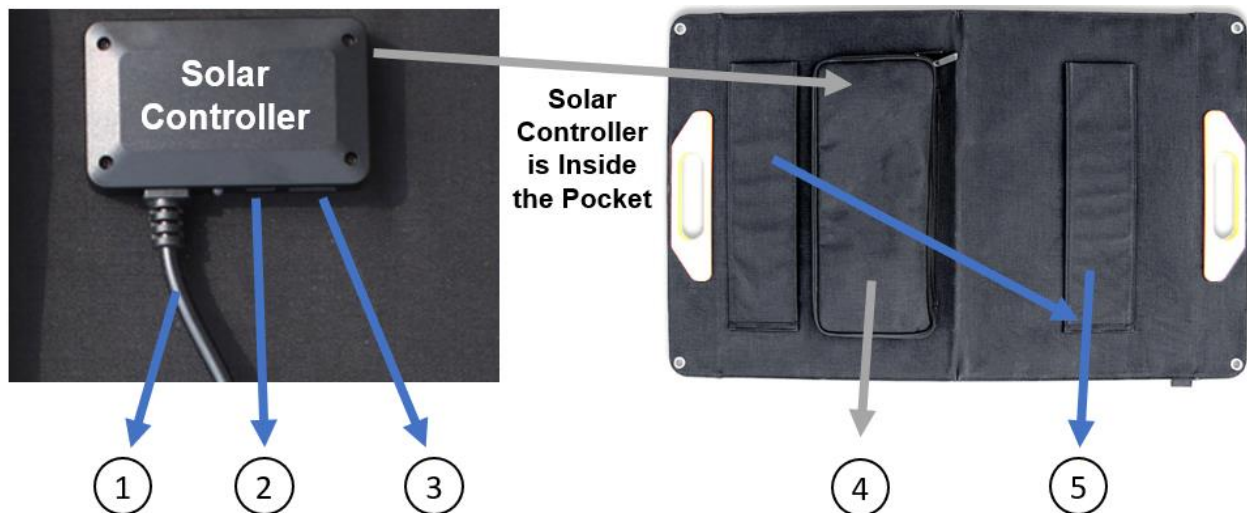

1. DC Output Cable for charging the Zopec Explore Batteries
2. PD60W USB-C Port for charging the Zopec Voyage Batteries and other devices
3. USB-A port for direct charging USB-A devices
4. Outside Pocket, which contains the solar controller and the type C - C cable
5. Kickstands to charge with solar panel off the ground at 45-degree angle

3. PRODUCT DESCRIPTIONS

- Monocrystalline
- Sunlight conversion efficiency is 23%
- ETFE Light Focus Technology absorbs sunlight and maximizes efficiency
- Single fold for easy transport and storage
- Waterproof and Dust Proof (IP67 rating)
- 1 Year Manufacturer Warranty

4. INSTRUCTION FOR USE

- Unzip the Outside Pocket and locate the controller
- Open the solar panel
- Charging your devices:
 1. **Zopec Explore Batteries:** Plug the DC Output cable into the battery charging port. It should start charging.
 2. **Zopec Voyage Batteries:** Plug in the USB-C cable into the PD60W USB-C port on the solar controller. Plug the other end of the USB-C cable to the Zopec Voyage PD charging port. It should start charging.
 3. **Other USB-C devices:** You can charge other USB-C devices. If you have Apple products, then you will need to buy an Apple lightning USB-C cable.
 4. **Other USB-A devices:** You can use the USB-A port to charge any regular USB devices.
- Open the kickstands if desired to charge off the ground at 45-degree angle
- Special Notes:
 1. **Solar charging speed:** It varies with weather conditions. The optimal condition is direct full sun, temperature 59°F - 95°F, and humidity less than 20%. In less optimal conditions, it will charge but at slower speed.
 2. **Keep the solar panel dry:** The water droplets will reflect sunlight and reduce conversion efficiency.
 3. **Cleaning:** use soap and cold water then wipe dry with paper towels.
 4. **Storage:** Keep solar panel closed and store in cool areas.

5. CONTACT US

Please contact us with any questions and warranty claims:

- Address: Zopec Medical, 10044 Flanders CT NE, Suite 300, Blaine MN 55449, USA.
- Website: www.zopec.com , Email: info@zopec.com
- Phone: Please see our website “Contact Us” for the current phone numbers.