

CAT HOUSE

Included

27 Pins

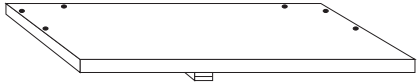

1 Top zBoard (with door stopper)

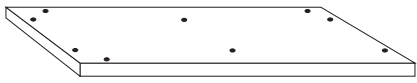

1 Bottom zBoard

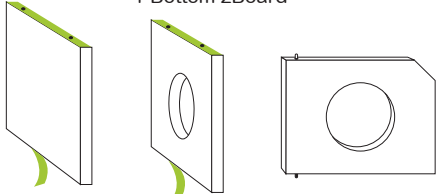

2 Side zBoards 1 Middle zBoard 1 Door with Hole (with hole)

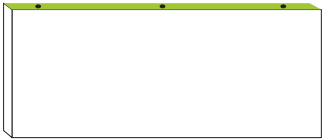

1 Back zBoard



1 Short Back zBoard



2 Short Front zBoards

Important

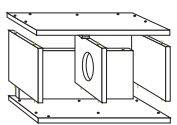

THIS SIDE UP

DO NOT place unit on its side or back as it will compromise its structural integrity.

WARNING: CHOKING HAZARD
Small parts NOT for children under 3 years



- Assemble your unit on a flat even surface
- Make sure zBoard surfaces are clean and dry

- When moving your Way Basics unit, lift from the bottom
- Use indoors and in dry areas only. Do not use in the bathroom

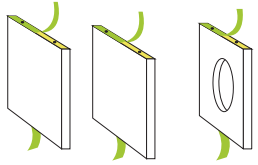

1 Carefully remove the protective layer on the Side zBoards, Middle zBoard and Back zBoard (making sure not to remove the 3M adhesive).
Tip: Peel protective layer from side.

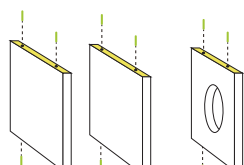

2 Insert pins as shown.

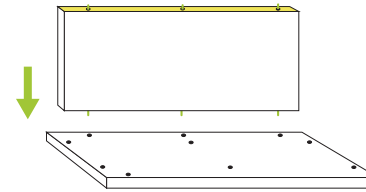

3 Align Back zBoard to holes in the Bottom zBoard (holes on one side).

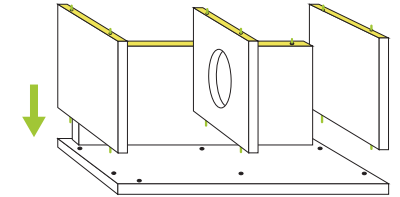

4 Align Side zBoards and Middle zBoard to holes in Bottom zBoard.

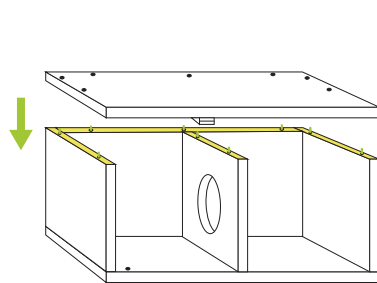

5 Align Top zBoard (with door stopper) as shown and press firmly to secure unit together.

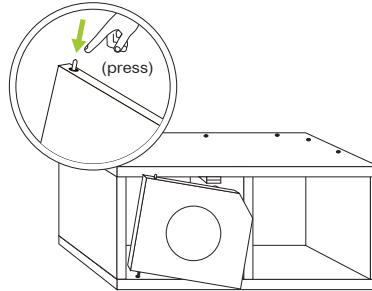

6 Position door as shown. Align bottom door pin to hole. Press on spring loaded top pin and insert

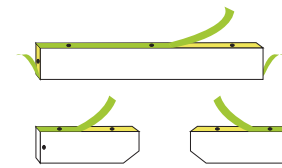

Carefully remove the protective layer on the Short Back zBoard and Short Front zBoards.

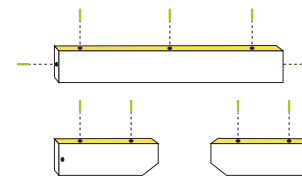

7 Insert pins as shown.

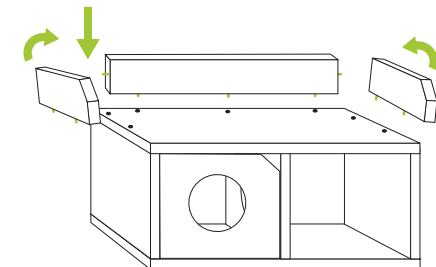

8 Align Short Back zBoard and Short Front zBoard to holes in Top zBoard.

