



All this as Standard

- Toughened glass sliding sash for operator protection
- Toughened glass sides, back and sash for 360° visibility
- Quick-release connections for fast installation and easy relocation
- Very low noise level – only 50 dBA tested to meet CLEAPSS G9 or BS EN 14175
- Flush membrane control panel with visual & audible low airflow alarm
- Excellent containment levels
- GRP moulded worktop to contain spillages
- RCD protected double socket
- Low energy consumption, long life LED flat panel lighting
- Cold water and gas valves, located outside the chamber for ease of operation
- Polypropylene circular drip cup, bottle trap and flexible waste hose
- Built-in aluminium storage cupboard
- External carcass constructed from powder coated aluminium
- Integral 18 kg carbon filter with protective pre-filter
- Sash stop device at 400 mm for operator safety
- Lockable castors
- 12 month free warranty

**FUME CUPBOARD INDEPENDENTLY
TESTED TO CLEAPSS G9**

The fully mobile SSR2000 Sliding Sash Recirculation fume cupboard has been independently tested by CLEAPSS. Easy to manoeuvre, it passes comfortably through a standard door opening, immediately adding fume cupboard capacity to a lab. Glass panels to all four sides make it ideal for demonstrations.

The SSR2000 has been tested to meet the requirements of **CLEAPSS G9** and **BS EN 14175**.

Not all school fume cupboards come with everything a Clean Air unit has as standard. Check what's included when you're comparing products.

Docking Station

- Compact, lockable housing for mains supplies
- Easy to install
- Powder coated white textured finish to match the fume cupboard
- Either a bench mounted or wall mounted model
- Gas and water quick-release couplings plus electrical socket
- Bench mounted model includes flexible waste connection
- Tough 18swg Zintec steel construction
- Stainless steel restraining cable to safeguard service connections
- See Docking Station datasheet for more information

Servicing

- A Clean Air service includes much more than simply face velocity testing – ask us for details
- Full service and maintenance packages available
- Options to lock in prices - Free 5 year extended warranty with 5 year service package*
- Highly trained, DBS-checked test engineers
- Never over-run your test date with our free test scheduling service
- Most makes and models of fume cupboard serviced

* **T&Cs apply see website**

SSR2000 Mobile Fume Cupboard

Technical Specifications

External Dimensions	1000mm wide x 700mm deep x 1950mm high
Internal Dimensions	912mm wide x 465mm deep (baffle to sash) x 960mm high (worktop to soffit)
Sash Opening	840mm wide x 610mm high (max)
Face Velocity	0.4m/s an operating sash height of 400mm
Containment	Protection Factor Robustness of Containment PFr 336,000
Service Connections	Mains supplies via docking station (see separate data sheet)
Power Consumption	300W - fan, light & alarm (excluding socket)
Weight of Unit	150kg

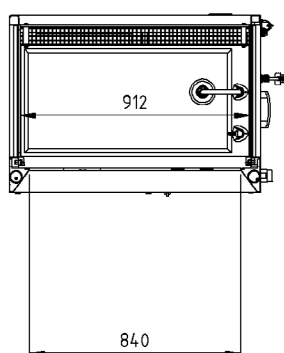
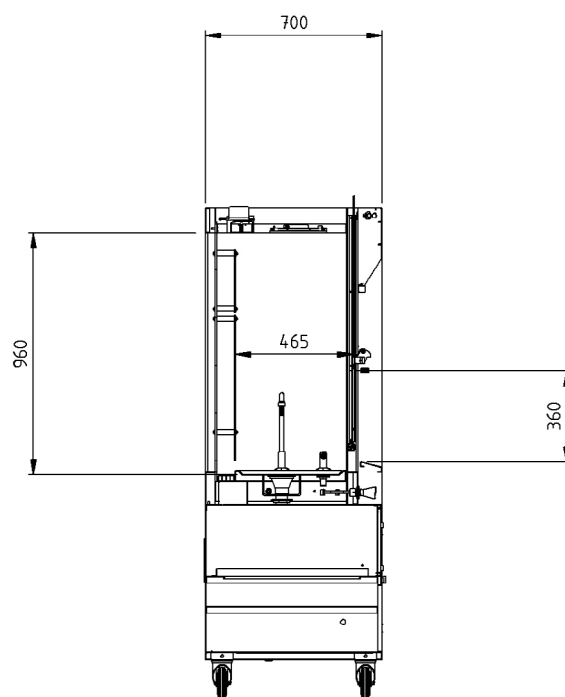
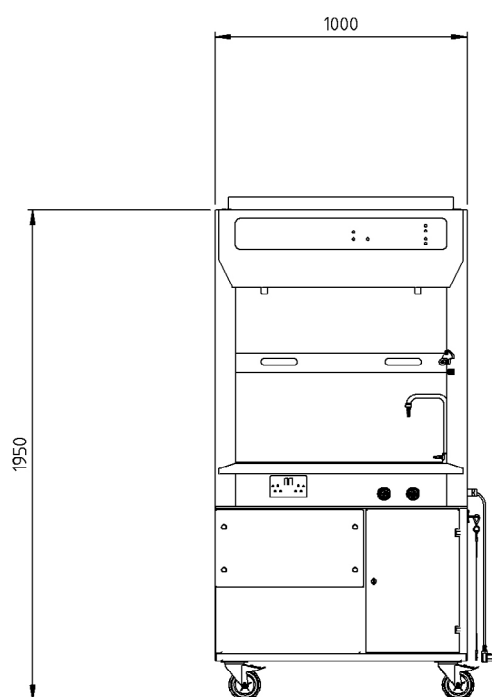

01204 572900
sales@cleanairltd.co.uk
www.cleanairltd.co.uk