

Thanks for purchasing a 9.Solutions product. With great passion, we design our products to be as versatile as possible. We hope that our products contribute to your creative vision.

Sincerely,

The 9.Solutions Team

SPECIFICATIONS:

Weight: 550 g
 Clamping Range: 0-60mm
 Max Load: 20 kg
 Connection(s):
 (1x) 5/8" Receptacle
 (1x) 3/8"-16 Female Thread
 (1x) 1/4"-20 Female Thread
 (2x) M6 Female Thread
 (4x) M5 Female Thread
 (1x) Anchor Point for Cable or Rope
 Package Content(s)
 (1x) Barracuda Clamp

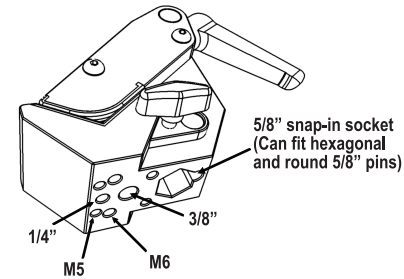

Snap-in socket automatically locks down when a stud or spigot is inserted into the socket. Push button to release the stud.

For safety, always make sure that the button is in its expanded position when a stud is inserted.

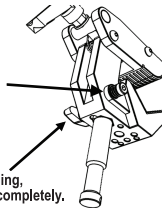

For additional safety and to secure round studs from turning, always tighten thumb screw completely.

Two Barracuda Clamps can be joined to form a double clamp. To join two Barracuda Clamps, use two M5 x 25mm bolts (not included).

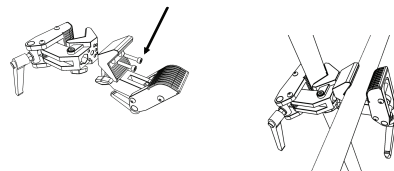

Anchor point for safety cable or rope. Pull up on lever to adjust position of handle in small spaces.



When clamping onto flat objects, make sure to have the clamp as far onto the object as possible. You want the flat object to rest on the flat ledge at the back of the clamp's mouth.

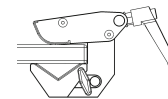

When clamping onto square objects, best results are achieved when the flat area of the upper jaw is flush with a side of the square.

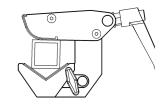

Always follow the safety standards and regulations of the given country where the product is being used.

Visit www.9.solutions for more info.