

Thanks for purchasing a 9.Solutions product.
With great passion, we design our products to
be as versatile as possible. We hope that our
products contribute to your creative vision.

9.SOLUTIONS
Savior Spring Clamp Mini

Sincerely,

The 9.Solutions Team

SPECIFICATIONS:

Weight: 225 g

Clamping Range: 0-45mm (round tubes)

Connections: (2x) 1/4"-20, (2x) 3/8"-16

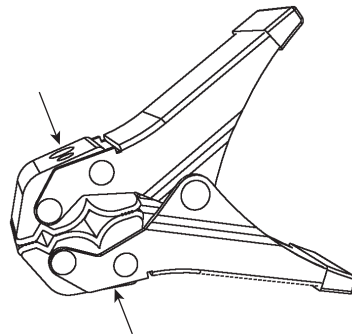

Both jaws are tapped with 1/4"-20 and 3/8"-16 attachment points which enables the user to mount equipment on both sides of the clamp.

Attach a 1/4" SCREW-ON QUICK MOUNT RECEIVER to allow use of the 9.Solutions MAGNETIC QUICK MOUNT SYSTEM.

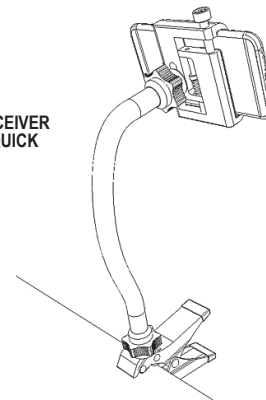
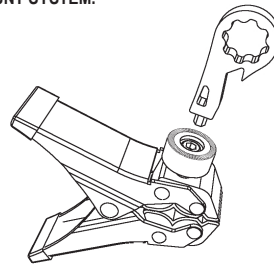

Always follow the safety standards and regulations of the given country where the product is being used.

Visit www.9.solutions for more info.