



## Bluetooth® Receiver Wallplate and Backbox

Item ref: 122.380UK

User Manual

A Bluetooth receiver conveniently housed in a standard 1gang plastic wallplate which allows connection of Bluetooth enabled devices such as smartphones, tablets, iPods etc. Ideal for use in classrooms, boardrooms, kitchens or home studies, the unit comes supplied with a UK power supply and a 50mm back-box for easy installation.

### Technical Specifications and Features

Bluetooth version	5.0
Bluetooth range	Up to 10m (in clear line of sight)
Audio input	Bluetooth or stereo line level (3.5mm jack)
Audio output	Stereo 3.5mm jack or 3-pin screw terminal
Power in	5VDC/1A via UK PSU (supplied) or 2-pin screw terminal
Dimensions	87 x 87 x 35 (wallplate only)
Weight	48g

### Bluetooth Pairing Instructions

- For first time pairing to a new device, press and hold the Pairing button for around 5 seconds until the BT status light on the unit flashes quickly.
- Open the Bluetooth device list on your smart device and select the pairing name "Music BT"
- When the device is connected the BT status light on the unit stays illuminated.,
- The pairing timeout limit is 90 seconds. If pairing has timed out, press and hold the Pairing button again for 1 second to re-enter pairing mode.
- To turn the unit on and off, press and hold the Pairing button again for around 3 seconds.
- When you turn the unit on any previously connected smart devices will automatically repair provided, they are within the 10m transmission range and set as discoverable.
- **NOTE:** the unit can only be connected to one smart device at any time and will automatically repair with the closest device.

### Bluetooth LED Status

- Pairing mode: Fast flash (approx. 1 every second)
- Discoverable mode: Slow flash (approx. 1 every 5 seconds)
- Paired mode: LED on

### In the box

- Bluetooth receiver wallplate
- 50mm Standard backbox
- UK Power supply
- 2pcs Fixing screws
- user guide

## Connection Diagram

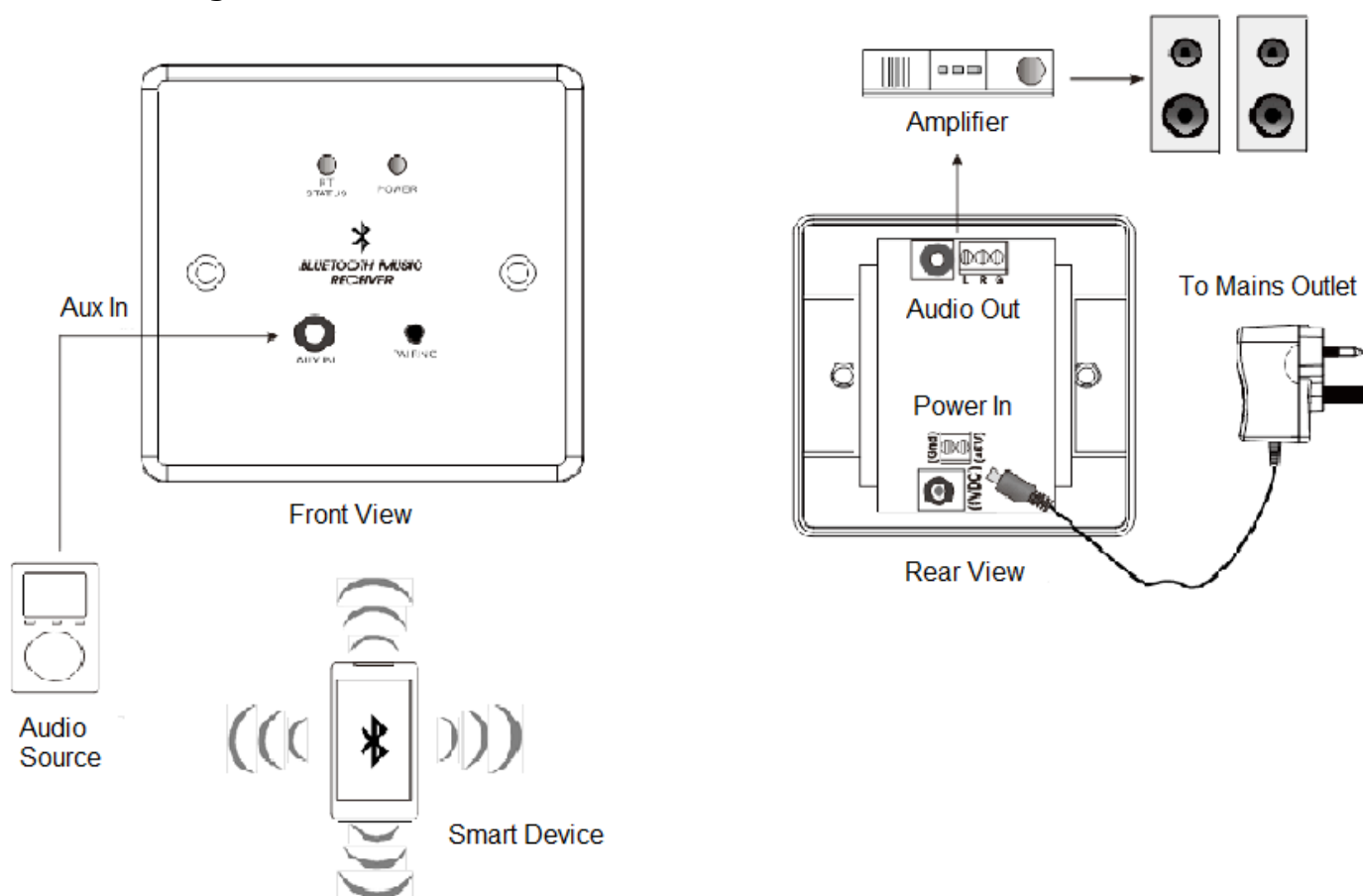

## Warning

- For reasons of electrical safety, this device must never be immersed in water, exposed to damp conditions or excessive force.
- Please do not use this device if you find that it is damaged in any way.
- Do not attempt to repair this device or take it apart under any circumstances, as this will invalidate your warranty.
- Only use the recommended power supply provided and if connecting to mains power internally consult a qualified electrician to carry out the installation.
- Do not locate this device close to a source of heat or expose to high temperatures.



This product is classed as Electrical or Electronic equipment and should not be disposed with other household or commercial waste at the end of its useful life. The goods must be disposed of according to your local council guidelines.

Hereby, AVSL Group Ltd. declares that the radio equipment type: 122.380UK complies with Directive 2014/53/EU

The full text of the EU declaration of conformity for 122.380UK is available at the following internet address:  
<http://www.avsl.com/assets/exportdoc/1/2/122380UK%20CE.pdf>

## Errors and omissions excepted.

Copyright© 2021 AVSL Group Ltd, Unit 2 Bridgewater Park,  
 Taylor Road, Trafford Park, Manchester. M41 7JQ.

AVSL (Europe) Ltd, Unit 3D North Point House,  
 North Point Bus. Park, New Mallow Road, Cork, Ireland.