

HOW TO ASSEMBLE A FABRIC BED

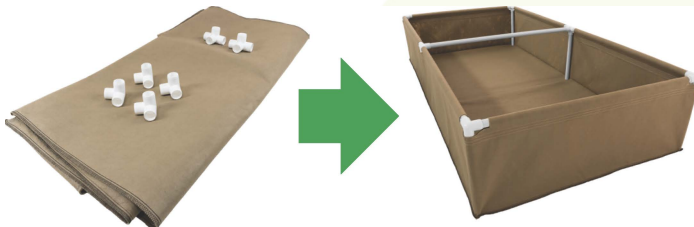

Here's what you'll need:

A Grassroots Fabric Pots Raised Bed (included)
 PVC Fittings (included)
 Screws (included)
 1" PVC Pipe (we recommend buying 20h sections to minimize waste)
 PVC Pipe Cutter
 Mallet (recommended) or Hammer
 File or Sandpaper (optional)
 Drill

Fittings supplied with standard sizes:

4x4 (46"x46"x18"? - (4) 3 way- (O) 4 way- (O) 5 way
 4x4 (46"x46"x18"? - (4) 3 way- (4) 4 way- (O) 5 way (with trellis)
 4x8 (46"x94"x18"? - (4) 3 way- (2) 4 way- (O) 5 way
 4x8 (46"x94"x18"? - (4) 3 way- (6) 4 way- (O) 5 way (with trellis)
 4x16 (48"x192"x18"? - (4) 3 way- (6) 4 way- (O) 5 way
 4x16 (48"x192"x18"? - (4) 3 way- (1 O) 4 way- (6) 5 way (with trellis)

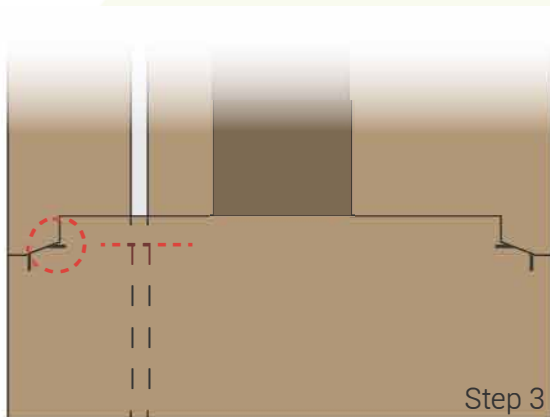

1. Start with the bed on a flat surface. You will begin by cutting the legs of the frame.
2. Pull a corner of the bed up and place a piece of PVC inside the bed vertically.
3. Pull the side fabric tight and cut the PVC where it meets the horizontal sharpie line near the top of the side.
4. This piece will become a leg. You can now cut the rest of the legs to this length. There will be one leg for every notch.

5. Put the proper fittings on to the legs. We will attach crossbars to them in a couple steps.

Note: If you don't have trellis fittings, you will use 3 and 4 way fittings instead of the 4 and 5 way fittings shown.

6. Use a metal file or sandpaper to smooth the bottoms of the legs. This will help the pipe fit all the way into the fitting and not get caught on fabric.

This is especially important if you used a saw to cut the PVC.

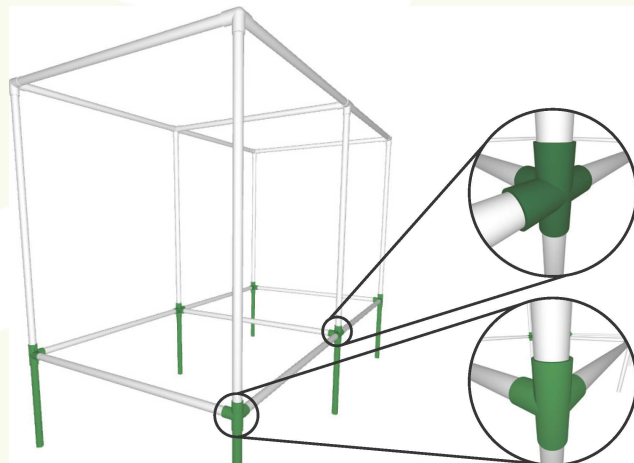

Step 5



Step 7

7. It's time to cut the crossbars. Put a piece of uncut PCV through an end sleeve and cut at the vertical markings.

8. You can use this length to make as many crossbars as you need.

9. Place the end crossbars into their sleeves and fit the corner legs and fittings onto them.

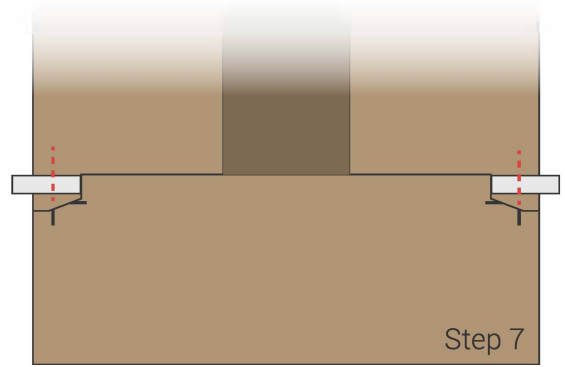

Step 7

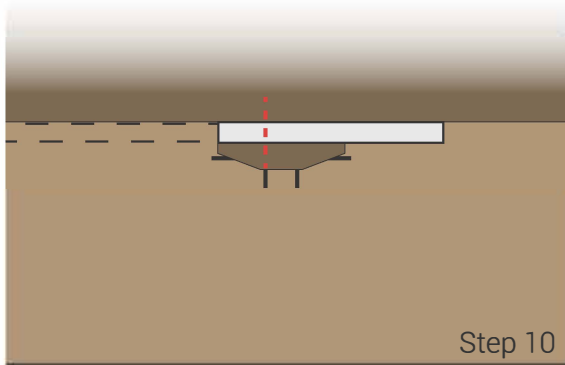

Step 10

10. Start from one side and thread an uncut piece of PVC through an empty sleeve into a leg joint. Make sure the fabric is taut and cut at the first vertical mark.

(In the shown illustration, the pipe continues left into the corner fitting. Do not pre-cut these side pieces. Measure them one at a time.)

11. Stick the next leg on and continue down the length of the bed until you reach the next corner joint.

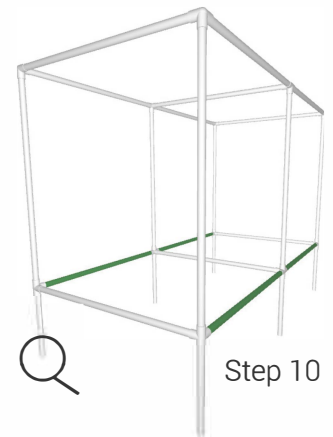

Step 10

No fittings on the bottom of legs

12. Use a mallet to seat the PVC into each joint for a snug fit. Skipping this step may cause the frame to gradually lose stability.

13. If you have trellis fittings, now is a good time to build the trellis. Use the lengths of piping already cut to measure piping for the top of the trellis. You can make your trellis as high as you need.

14. Before filling, use the provided screws and a drill to secure the pipes in the fittings. Make sure not to over tighten the screws!

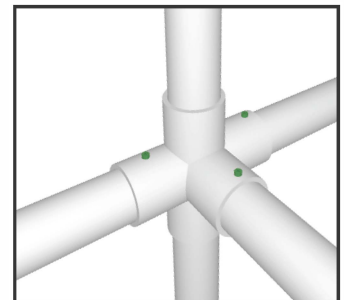

Don't like reading?
Scan this QR code to watch the video.

