

To download full user manual go to <http://www.intova.net/support/intova-manuals/>

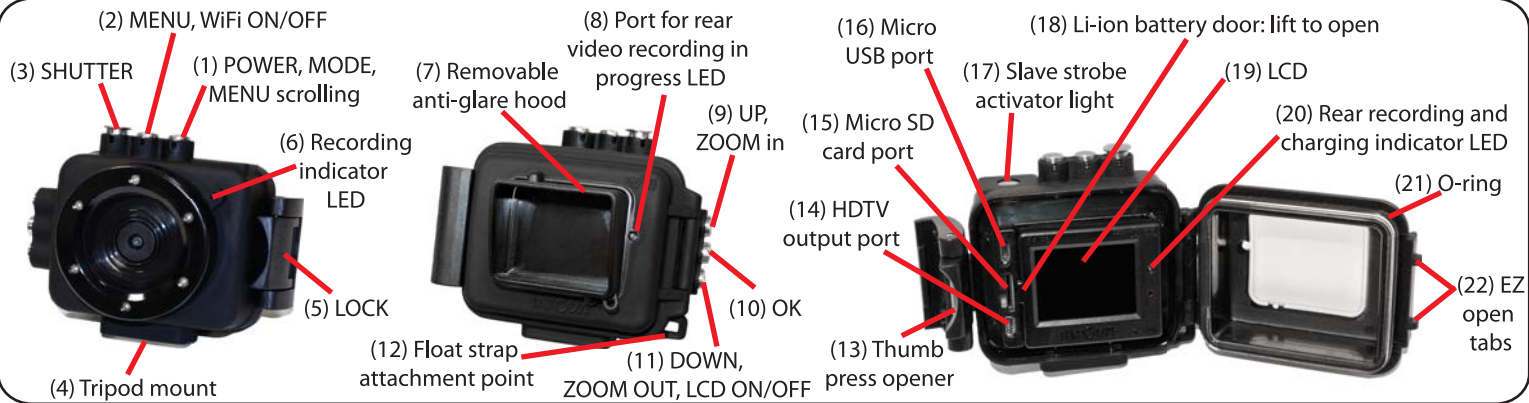

Opening the waterproof housing:

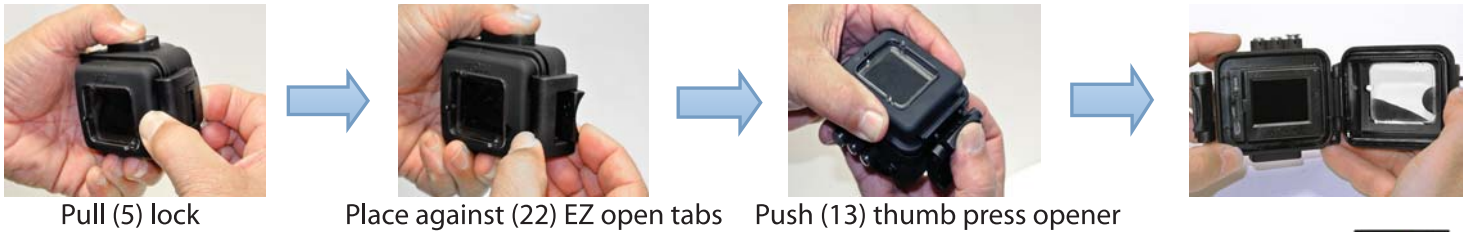

Insert the rechargeable Li-ion battery:

1. Open the battery compartment door by pulling on (18) battery door tab.
2. Insert the removable / rechargeable Li-ion battery (included) into the battery compartment, making sure that the battery contacts are aligned correctly with the contacts in the compartment.
3. Fold the battery puller over the battery and close battery compartment door.



Charging the Li-ion battery:

1. Insert USB cable into (16) Micro USB port.
2. Insert other end of cable into a computer USB port.
3. LCD should show MSDC, CHARGE and OPEN.
4. Scroll down to select CHARGE and press (10) OK.
5. When charge is complete, red LED will turn off.



Preparations:

1. Prior to first use, do a "DEFAULT SETTING" in the SYSTEM sub-menu by pressing MENU button, UP button 2 times to go to SYSTEM, OK button, UP button 4 times, OK button, UP button and OK.
2. With camera off, insert Micro SD card up to 64 GB into (15) card port with gold contacts towards LCD. Micro SD card up to 64 GB (class 10 for HD video recording) must be installed prior to use.
3. Select appropriate TV SYSTEM (NTSC or PAL) in SYSTEM menu.
4. Format SD card as necessary by pressing MENU, go to SYSTEM, OK, UP button 5 times, OK, UP button, and OK. **WARNING:** Format will erase all data from card. Save any data before formatting.

Video:

1. Press (3) SHUTTER button to start.
2. Move camera smoothly when recording.
3. Press (10) OK button to take photo while recording video.
3. Press (3) SHUTTER button to stop.

Photos:

1. Press (1) MODE button to switch to photo mode.
2. Press (3) SHUTTER button and release while holding camera steady.

Zoom:

1. In "System Menu" turn on digital zoom to 4x, 10x, 16x or 60x.
2. In either photo or video mode, press (9) UP to zoom in and (11) DOWN to zoom out.

View mode:

1. In video mode, press (1) MODE button 2 times.
2. Press (11) DOWN or (9) UP buttons to select file.
3. Press (10) OK 2 times to start video and (10) OK again to stop.
4. Press (10) OK to view photo and (1) MODE to go back to thumbnails.
5. Press (1) MODE to go back to main screen.

Deleting files:

1. In view mode, press (2) MENU button and press (10) OK.
2. Press (9) UP button to choose "this" or "all" and press (10) OK.
2. Press (9) UP button to choose "o" and press (10) OK to delete.
4. Press (2) MENU to exit.

Self Capture mode:

1. Press (2) MENU button and select PHOTO.
2. Press (10) OK button.
3. Press (9) UP button 3 times and press (10) OK button.
4. Select OFF, 3, 5, 10 seconds and press (10) OK.
5. Press (2) MENU button to go back to main screen.
6. LCD screen should show self timer icon.
7. Press (3) SHUTTER button to start timer.

Important: Before each use, clean and maintain all O-rings for parts that have been opened by removing any dirt, sand and other debris and lightly lubricating with silicone grease as needed to prevent drying and cracking. Make sure to remove all excess grease before use. Excess grease can cause leakage and failure of seal.

FCC STATEMENT:

This device complies with part 15 of the FCC Rules. Operation is subject to the following two conditions:

- (1) This device may not cause harmful interference, and
- (2) this device must accept any interference received, including interference that may cause undesired operation.

This equipment has been tested and found to comply with the limits for a Class B digital device, pursuant to Part 15 of the FCC Rules. These limits are designed to provide reasonable protection against harmful interference in a residential installation. This equipment generates, uses and can radiate radio frequency energy and, if not installed and used in accordance with the instructions, may cause harmful interference to radio communications. However, there is no guarantee that interference will not occur in a particular installation. If this equipment does cause harmful interference to radio or television reception, which can be determined by turning the equipment off and on, the user is encouraged to try to correct the interference by one or more of the following measures:

- Reorient or relocate the receiving antenna.
- Increase the separation between the equipment and receiver.
- Connect the equipment into an outlet on a circuit different from that to which the receiver is connected.
- Consult the dealer or an experienced radio/TV technician for help.

Changes or modifications not expressly approved by the party responsible for compliance could void the user's authority to operate the equipment.

WARNING: Do not attempt to take apart the camera—there are high voltage parts and dangerous electric shock can occur.

WIFI:

This feature allows camera to be connected to an iOS or Android wireless device such as a smart phone or tablet for remote operation, live viewing and file transferring using the INTOVA EDGE X app.

TO TURN ON WIFI:

1. Press and hold MENU button until "Processing" in red appears. WiFi icon should turn green.
2. To turn off WiFi, press and hold MENU button until WiFi icon turns white with red X.

INTOVA EDGE X WiFi App

1. On an iOS or Android device, go to either the Apple Store or Google Play and type "INTOVA EDGE X" in "search" to find and install the app on your smartphone or tablet. Reboot your device after install.
2. Turn on your EDGE X (with MicroSD card inserted) and turn on WiFi.
3. With your smartphone or tablet, connect to EDGE X WiFi signal. The default network name is "INTOVA EDGE X".
4. Enter the password "1234567890".
5. Open the INTOVA EDGE X app on your smartphone or tablet. See live view, control camera and transfer files by using touch controls as shown below.

***Notice: For some Android phone models, "AUTO CONNECT" function in WiFi advanced menu needs to be disabled.**

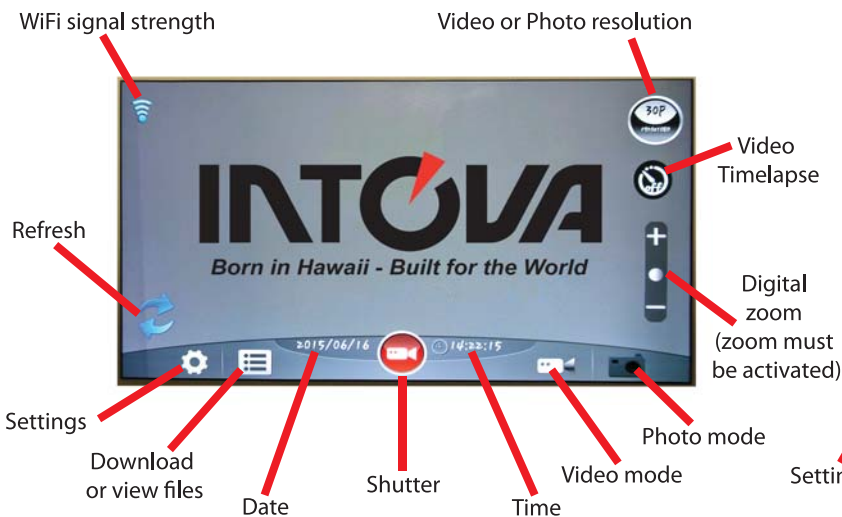

EDGE X app on an Android device

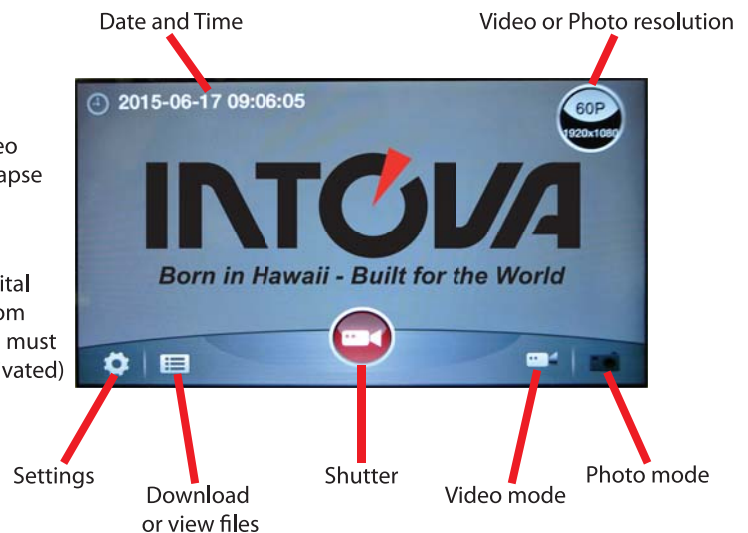

EDGE X app on an iOS device

EDGE X OPTIONAL ACCESSORY (sold separately):

WiFi remote: enables user to remotely start/stop video recording, take a photo and turn off camera. Powered by rechargeable Li-ion battery. Model WIFI REMOTE.

IMPORTANT NOTE: Wireless transmission will not work underwater. Wireless remote is for above water use only.

WiFi remote operations:

- 1) Turn on remote by pressing and holding (2) Power ON remote button for 3 seconds.
- 2) Turn on camera and go to WiFi menu.
- 3) Turn on "REMOTE" feature in WiFi menu.
- 4) Press MENU button to go to main screen.
- 5) Press and hold MENU button for 3 seconds to turn on WiFi.
- 6) Camera and remote are connected when WiFi icon turns green with red "R".
- 7) To start video recording, quickly press and release (1) Video record start button.
- 8) To take photo while recording video, quickly press and release photo button.
- 9) To stop video recording, quickly press and release (2) Power ON remote button.
- 10) To take a photo, quickly press and release (3) Photo button.
- 11) To turn off camera and remote at the same time, press and hold (2) Power ON remote button for 3 seconds.

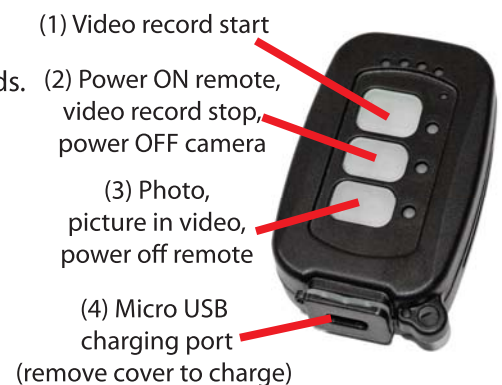

Contents: EDGE X camera, lithium ion battery, USB cable, float strap, anti-glare hood, silicone grease, Quick Start Guide, and optional accessory sheet.

NOTE: As a result of continual improvements, the design and specifications of the product as described in this quick start guide may change without notice..

© 2015 Intova, LLC • All Rights Reserved

1100 Alakea St., 18th Floor Honolulu, Hawaii 96813 USA

www.intova.net rev 6-16-15