



Patient Information Leaflet

ABSORBS DIRECTLY FROM THE STOMACH AND INTESTINES

Intended Use?

Enterogel® is an intestinal absorbent (enterosorbent) tasteless gel intended to be used as an adjuvant to standard rehydration therapy and in the management and reduction of stomach and intestinal illness symptoms such as diarrhoea, gas, stomach cramps, abdominal pain, heartburn, vomiting or nausea. If you are suffering from multiple symptoms or your symptoms persist see your doctor/healthcare professional, they can advise you whether this preparation Enterogel® is suitable for managing your symptoms.

What is Enterogel® used for?

For best results take Enterogel® at the first signs of illness symptoms such as diarrhoea, gas, stomach cramps, abdominal pain, heartburn, vomiting and nausea.

Enterogel® is:

- ✓ Sugar and sweetener free
- ✓ Lactose and dairy free
- ✓ Gluten free
- ✓ Fat free
- ✓ Free from flavours & preservatives

How should I take Enterogel®?

The dose of Enterogel® can be orally administered straight off a spoon followed by fluid or mixed into fluid and then swallowed.

- Shake well before opening.
- For children 1 to 3 years old Enterogel® can be used under advice of a doctor. Enterogel® should be administered orally 1–2 hours before or after a meal. When this product is taken it is recommended to wash it down with sufficient quantity of water or dilute the dose in water of room temperature prior to its administration (in 200 ml of water for adults and children aged 7 and over, 50–100 ml of water for children aged 1–6).
- Use Enterogel® 1–2 hours before or after taking medication. If you are taking any medication, it is recommended you consult your doctor or pharmacist prior to using Enterogel®

Enterogel® in a sachet:

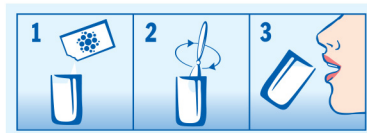

Enterogel® in a tube:

- Shake well before opening.

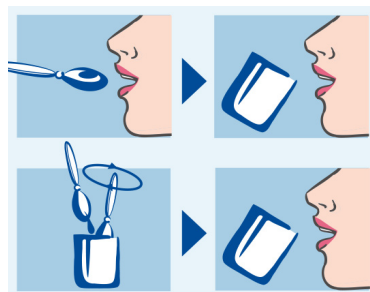

Age	Dosage	How Often
Child 1–6 years old	1 teaspoon or 5g	3 times a day
	or 1/3 of sachet	
Child 7–14 years old	2 teaspoons or 10g	3 times a day
	or 1/2 of sachet	
15+ and adults	1–1.5 tablespoons or 15–22.5g	3 times a day
	1–1.5 sachet	

In case of Diarrhoea

First administration: 2 standard single doses followed by a single dose after every loose bowel movement. Once diarrhoea has stopped it is recommended to continue Enterogel treatment 3 times daily using the standard age related dose for 5 days.

In case of ingestion of substance causing irritation to the stomach or intestines

The standard single dose can be doubled during the first three days of treatment. It is recommended to take Enterogel for 3–5 days.

For the management of short-term (acute) stomach and intestinal illness symptoms

1 standard single dose 3 times daily for 3–5 days or until alleviation of symptoms.

For the management of long-term (chronic) stomach and intestinal illness symptoms

Take 1 standard dose 2–3 times daily for 2–3 weeks. For continued management, take 1 standard dose 1–3 times daily as required.

In cases of Constipation

For those prone to constipation, it is recommended to reduce your dose to 1/3 - 1/2 of the standard dose and assess for bowel tolerance before increasing to a full standard dose. Ensure you remain well hydrated.

What if I miss a dose of Enterogel®?

Do not worry and continue to follow your regular scheduled dose of Enterogel®.

What if I accidentally take a higher dose?

No cases of overdose have been reported.

Effect on ability to drive and operate machines:

Enterogel® does not affect the ability to drive nor the speed of psychomotor reactions.

Pregnancy and breastfeeding

Enterogel® can be taken during pregnancy and breastfeeding. It is recommended to speak to your GP or midwife if you are unwell during pregnancy.

Composition: ORGANIC COMPOUND

Mineral-based Polymethylsiloxane polyhydrate (methylsilicic acid hydrogel) – 70%, water purified – 30%.

What to do if the package is damaged:

Do not use the product if the seal has been broken, damaged or appears to have been tampered with.

Possible side effects. Any treatment can have side effects. Sometimes they can be serious, most of the time they are not. Some common side effects that you may experience are nausea, vomiting, constipation. There may be other side effect that occur.

www.enterogel.com.au

PHARMACOVIGILANCE

Report an Adverse Reaction
Report a Medication Error
Report a Reaction
info@medsilica.com

Manufacturer: Bioline Products s.r.o.
Krátkovská 1338/10, 11000 Prague 1
Czech Republic



**Exclusive distributor in New Zealand
and Australia:**

Medsilica Limited: 9 Walford Drive,
Lynmore, Rotorua, 3010, NZ
Freephone: 0800 757 700
info@medsilica.com
www.medsilica.com

**Distributors in Australia under
Medsilica Limited licenses: The
Sponsor**

Medsilica Australia Pty. Ltd.
55 Oceano St, Copacabana, NSW 2251,
Australia
Freephone: 1800 757 700, info@
medsilica.com.au
www.medsilica.com.au

Wholesale Supplier

RN Labs Pty Ltd: 18/93 Rivergate Place,
Murarrie, QLD 4172
Australia
www.RNLabs.com.au



PREGNANT
WOMEN



BREASTFEEDING
MOTHERS



CHILDREN OVER
1 YEAR OLD



VEGANS

Product Information

MADE IN EUROPE

PACKAGING:

Enterogel® is an oral suspension (a soft paste that you take by mouth) and it comes in either a tube or sachet inside a carton in the following pack sizes: 90g tube, 225g tube, 15g sachet (10 sachets per pack).

STORAGE PARAMETERS:

Store at temperatures between 4–25 °C. Do not freeze. Keep out of the reach of children.

Avoid drying out after opening the package. Use this product within 30 days of opening the tube.

SHELF LIFE:

3 years from the date of release from the manufacture. The expiry date is provided on the bottom flap of the carton next to the hourglass symbol.

ENTEROGEL® ORGANIC COMPOUND

- Enterogel® does not contain material or ingredients of microbial origin.
- Enterogel® does not contain material or ingredients of recombinant origin.
- Enterogel® does not contain material or ingredients manufactured or formulated using a genetically modified organism.
- Enterogel® does not contain material or ingredients of human origin.
- Enterogel® does not contain human blood or its components.
- Enterogel® does not contain material or ingredients of animal origin.
- Enterogel® is not medicated.



LGC is a World Class sports doping control and research laboratory, with more than 50 years of leadership in drug surveillance in sport.

Enterogel®, batch no 309170051, has undergone rigorous testing for a range of substances banned by WADA (the World Anti-Doping Agency) at an ISO 17025 accredited sports anti doping laboratory to provide assurance that they can be used by Olympic athletes without impacting performance.

UKAS Testing Laboratory No: 1187
LGC, Newmarket Road, Fordham,
Cambridgeshire, CB7, 5WW



Medical device 0088