

Kambook - Australia

Ground Floor, Suite 2, 170-180 Bourke Rd
Alexandria NSW 2015, Australia

Locked Bag 2000
Botany NSW 1455
Customer Service Line 1300 139 798
Customer Service Fax 1800 621 337

www.kambook.com.au

Kambook - New Zealand

Private Bag 94411
Botany, Manukau
Auckland 2163
New Zealand
Customer Service Line/
Spare Parts 0800 273 845
Customer Service Fax 0800 288 513

www.kambook.co.nz

KAMBROOK

THE SMARTER CHOICE



INSTRUCTION BOOKLET

Suits all KHT331 models

Important

Please retain your instruction book for future use.

In the event that you need some assistance with your Kambrook appliance, please contact our Customer Service Department on 1300 139 798 (Australia) or 0800 273 845 (New Zealand). Alternatively, visit us on our website at www.kambrook.com.au or www.kambrook.co.nz

Contents

Kambrook Recommends Safety First	p4
Your Kambrook Day Dreamer Reversible Heated Throw	p6
Using Your Kambrook Heated Throw	p8
Care, Cleaning and Storage	p10

IMPORTANT: Please retain your instruction book for future use.

At Kambrook, we believe that safe performance is the first priority in any consumer product, so that you, our valued customer can confidently use and trust our products. We ask that any electrical appliance that you use be operated in a sensible fashion with due care and attention placed on the following important operating instructions.

Important Safeguards For Your Kambrook Day Dreamer Reversible Heated Throw

- Carefully read all instructions before operating the Kambrook heated throw and save for future reference.
- Remove any packaging material and promotional stickers before using the Kambrook heated throw for the first time.
- Use the heated throw only with the detachable controller CTL151 supplied. Refer to the markings on the heating unit for the model number of the controller.
- Connect only to 230V or 240V power outlet.
- Do not pull the heated throw by the flexible cord or use the cord to carry the heated throw.
- Do not attempt to expose the internal wires.
- Extended application at the HIGH heat setting may result in skin irritation or burns.
- Do not use on areas of sensitive skin or areas insensitive to heat.
- Do not use the heated throw with an incapacitated person, an infant or a person insensitive to heat.
- Children under the age of three are not to use this heat throw due to their inability to react to overheating.
- The heated throw is not to be used on or by an invalid, a sleeping or unconscious person, or a person with poor blood circulation unless carefully attended.
- This heated throw is to be used as a wrap only.
- This heated throw is not an electric blanket or an under blanket.
- This heated throw is not intended for medical use in hospitals.
- This heated throw is for household use only.
- Do not use this heated throw for anything other than its intended use. Do not use outdoors.
- Avoid sharp objects. Do not insert pins or any sharp objects into the heated throw as they may damage the electrical wiring.
- Do not use the heated throw in a folded, rucked or rolled state.
- Do not use with wires tucked in.
- Do not sit on, crease or crush the heated throw.
- Do not use the heated throw if it is wet or moist.
- Do not use under clothing, wraps or blankets.
- Do not use the heated throw as an electric blanket. It is not designed for all-night use.
- This heated throw must not be used over a water bed.
- If any abnormality or defect in operation of this heated throw is observed, discontinue its use immediately and contact Kambrook Service Centre.
- Do not fall asleep when using the heated throw. This product is not intended for use while sleeping.
- Do not use the heated throw for animal or pet care.
- Switch the heated throw control to the 'OFF' position, switch off at the power outlet and remove the plug from the power outlet when the heated throw is not in use and before storing.

- Do not dry clean the heated throw. Dry cleaning may have a detrimental effect on the heated throw. Follow the instructions in the Care, Cleaning and Storage section when cleaning and storing the heated throw.
- Do not iron the heated throw.
- Do not bleach the heated throw.
- Regularly inspect the heated throw, power supply cord, plug and controller for any wear, damage or misuse. If signs of these are detected, immediately cease use of the heated throw and return the entire unit to your nearest Kambrook Service Centre for examination, replacement or repair.
- It is recommended that a qualified and registered person inspect your heated throw after each 3 years of use.
- When storing the heat throw, allow it to cool down before folding.
- When storing, fold neatly but not tightly (or roll) in the original packaging without sharp bends in the heating element and store where no other objects will be placed upon it.
- Do not place any items on top of the heated throw when storing to avoid creasing.
- There are no customer serviceable parts inside. The heated throw is fitted with a specially designed controller and no attempt should be made to repair it or to replace the protective fuse. Have the heated throw serviced only by a qualified service agent at your nearest Kambrook Service Centre.

Important Safeguards For All Electrical Appliances

- Fully unwind the power cord before use.
- Connect only to a 230V or 240V power outlet.
- Do not let the power cord hang over the edge of a bench or table, touch hot surfaces or become knotted.
- To protect against electric shock, do not immerse the power cord, power plug or appliance in water or any other liquid or allow moisture to come in contact with the part, unless it is recommended in the cleaning instructions.
- The appliance is not intended for use by persons (including children) with reduced physical, sensory or mental capabilities, or lack of experience and knowledge, unless they have been given supervision or instruction concerning use of the appliance by a person responsible for their safety.
- Children should be supervised to ensure that they do not play with the appliance.
- It is recommended to regularly inspect the appliance. To avoid a hazard, do not use the appliance if power cord, power plug or appliance becomes damaged in any way. Return the entire appliance to the nearest authorised Kambrook Service Centre for examination and/or repair.
- Any maintenance other than cleaning should be performed at an authorised Kambrook Service Centre.
- This appliance is for household use only. Do not use this appliance for anything other than its intended use. Do not use in moving vehicles or boats. Do not use outdoors. **Misuse may cause injury.**
- The installation of a residual current device (safety switch) is recommended to provide additional safety protection when using electrical appliances. It is advisable that a safety switch with a rated residual operating current not exceeding 30mA be installed in the electrical circuit supplying the appliance. See your electrician for professional advice.
- Always turn the appliance to the OFF position, switch off at the power outlet and unplug at the power outlet when the appliance is not in use.
- Before cleaning, always turn the appliance to the OFF position, switch off at the power outlet, unplug at the power outlet and remove the power cord, if detachable, from the appliance and allow all parts to cool.
- Do not place this appliance on or near a heat source, such as hot plate, oven or heaters.
- Position the appliance at a minimum distance of 20cm away from walls, curtains and other heat or steam sensitive materials and provide adequate space above and on all sides for air circulation.

Your Kambrook Day Dreamer Reversible Heated Throw

Heated Throw:

1. Heated throw dimensions approx. 1300 x 1600mm (WxL)



Controller:

2. Detachable controller
3. Power/ Heat Setting button:
Press button to turn the throw on/off and adjust between three heat settings
4. HIGH heat with Green colour LED indicator
5. MEDIUM heat with Blue colour LED indicator
6. LOW heat with Orange colour LED indicator
7. Auto-Off with Red colour indicator: After three hours the heated throw will automatically turn off
8. Controller connector:
Found attached to the heated throw and fits to the controller plug (see 9.)
9. Controller plug with locking clips:
Found at one end of the power cord and plugged into the controller connector on the throw when in use
10. 1.8m power cord

Not Shown:

- Reversible Heated Throw Material: Microplush on one side / Sherpa on the other side
- Flexible heating wire
- Safety overheat protection
- Reusable poly bag:
Ideal for storing the heated throw and controller when not in use

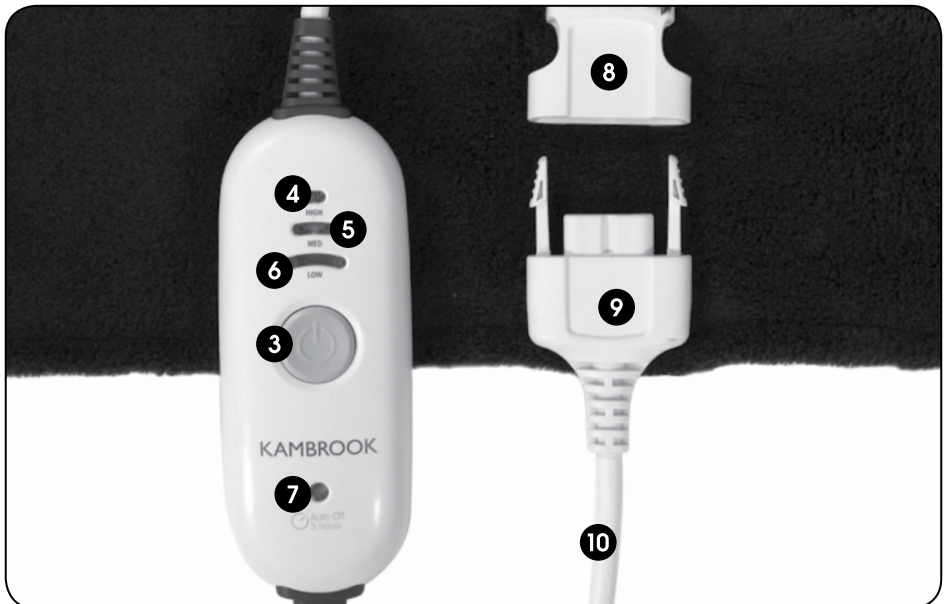

Using Your Kambrook Heated Throw

Before First Use

Remove any promotional material and packaging from the heated throw.

The poly bag is reusable and can be kept for safely storing the throw when it is not in use.

The controller can be found unattached and wrapped inside the throw.

NOTE: The heated throw is designed to be reversible. Heat will generate equally from either side of the throw.

To Connect The Controller

The heated throw has a detachable controller which allows the throw to be machine washable.

Ensure the heated throw Power/Heat Setting button is in the 'OFF' position and not pressed.

Ensure the heated throw is not connected to a 230V or 240V power supply.

To connect your controller, insert the controller plug found at the end of the power cord to the controller connector on the throw.

Ensure that the plug is securely fastened in the socket so that the locking clips are fully inserted and there is no gap between the plug and socket (See Fig. 1).

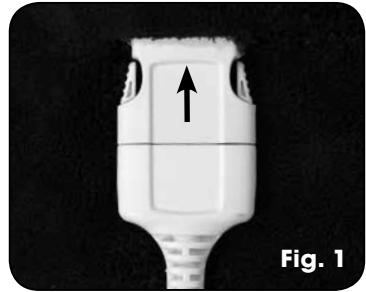

Fig. 1

To Detach The Controller

Press and hold down the locking clips on either side of the plug. (See Fig. 2).

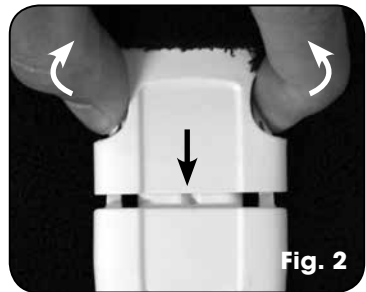

Fig. 2

Pull the controller plug out of the controller connector to detach.

Turning On The Heated Throw

Ensure the heated throw Power/Heat Setting button is in the 'OFF' position and not pressed.

Plug the power cord into a 230V or 240V power outlet and switch the power on.

Press the Power/Heat Setting button once to turn the heated throw 'ON'.

Adjusting The Heat Temperature

The three heat settings allow you to choose the right balance of heat depending on your personal comfort.

Adjust the heat temperature by pressing the Power/Heat Setting button until the desired indicator light illuminates:

LOW Heat Setting

Press the Power/Heat Setting button once and the Orange coloured LED indicator will illuminate.

MEDIUM Heat Setting

Press the Power/Heat Setting button twice and the Blue coloured LED indicator will illuminate.

HIGH Heat Setting

Press the Power/Heat Setting button three times and the Green coloured LED indicator will illuminate.

NOTE: The heated throw will take 40 minutes to reach the desired setting temperature, however you will start feeling warm after 15-20 minutes.

Auto-Off Protection

For added safety, the heated throw is designed with auto-off protection.

After three hours the heated throw will automatically turn off and the Red coloured auto off LED indicator will illuminate and "flash".

To stop the auto-off LED indicator from "flashing" and to continue using the heated throw, press the Power/Heat setting button once to turn the throw 'ON' again.

Set the heat temperature according to your heat preference. The throw is now ready for another three hours of use.

Turning Off The Heated Throw

Press the Power/Heat Setting button until none of the heat setting indicator lights are illuminated. The heated throw is now in the 'OFF' position.

Switch off at the power supply and unplug the power cord from the power outlet.

NOTE: For added safety, after three hours the heated throw automatically switches off.

NOTE: Do not leave the heated throw in contact with the skin for excessive periods of time. For continuous use, it is recommended that the LOW Heat Setting should be used.

Care, Cleaning and Storage

Do not dry clean. Do not iron. Use only the following instructions.

Before cleaning, ensure that the controller is unplugged from the power supply and that the controller is disconnected from the heated throw.

Spot Cleaning

Sponge the affected area using a lukewarm neutral detergent or mild soapy solution. Follow this with sponging, using a clean water solution. Remove any excess water by compressing the wet area between absorbent towels.

Hand Washing

Immerse the heated throw with controllers removed in a soapy solution of lukewarm water and mild, neutral detergent.

Soak for five minutes then gently squeeze the solution through the throw.

Rinse thoroughly in clean, lukewarm water, then gently squeeze any excess water from the heated throw.



WARNING: The controller must be removed from the heated throw before washing.



WARNING: Never immerse the detachable controller in water or any other liquid.



WARNING: DO NOT tumble dry.

Machine Washing

The heated throw can be washed in a domestic washing machine (size permitting) or by a commercial laundry.

To wash your throw in a domestic washing machine, wash on the WOOL or DELICATES setting using a neutral wool detergent or mild soapy solution.

DO NOT wash on a HOT cycle, the temperature must be kept below 30°C.

Do NOT use high speed or extra spin cycles.

Do NOT machine wash with the controller connected to the throw.

Drying

Drape the heated throw across a clothes line and drip dry.

DO NOT use pegs to secure the heated throw in position.

DO NOT dry with a hair dryer or heater.

DO NOT twist or wring dry.

DO NOT tumble dry the heated throw as it may damage the internal heating wires.

DO NOT use moth ball or sprays.

Storage

Pack the heated throw in its original poly bag packaging for best protection.

When storing the heated throw, allow it to cool down before folding.

DO NOT store the heated throw when wet.

Detach the controller from the throw before storing.

When storing, roll neatly but not tightly in the poly bag without sharp bends in the heating wires.

Place the detachable controller on top of the rolled throw before zipping the bag closed.

Store in a cool, clean and dry location.

DO NOT place any items on top of the heated throw when storing to avoid creasing.