

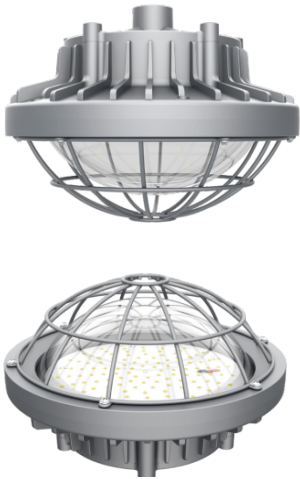

Explosion Proof Low Bay LED Luminaires



Date:..... Location: .....

Product:..... Project:.....

Quantity:..... Catalog# .....

**FEATURES**

- Low bay design, Class 1 Division 2, Group A B C D, Class 2, Division 2, group F and G, class 3, hazardous environment.
- LED: LM80 certified, high efficacy, low decay, long lifespan.130 lm /W ±5, up to 10400lm.
- Lens -tempered glass shock & vibration resistant, Super clear,>90% light transmit.
- IP66 RATED. Housing - Aluminum alloy.
- Meanwell LED Driver,>90% driver efficacy
- 6KV Surge Protection

**SUITABLE APPLICATIONS**

Applicate in Class I, Division 2, Groups A, B, C and D;  
Class II,Division 2, Groups F and G;  
Class III hazardous environment, Certificate No: E475887-UL-CUL

- Waste water treatment, oil and gas refineries, drilling rigs, offshore platforms, petrochemical facilities, chemical plants, coal mines, aviation bases, food plant, Pharmaceutical plant, beverage facilities, and where flammable vapors, gases, ignitable dusts, fibers or flyings are present.

**CONSTRUCTION:**

A corrosion-resistant and high-strength aluminum alloy housing and tempered glass lampshade design

**ELECTRICAL:**

Available as 120-277V input. -20°C to 50°C.

**OPTICAL SYSTEM:**

Lumileds LED chips. High quality tempered glass optics.180° beam angle.

**INSTALLATION&MOUNTING:**

Ceiling mount /Drop mount/ U bracket mount

**WARRANTY:**

5-year limited warranty. Actual performance may differ as a result of end-user environment and application.

**PERFORMANCE**

Model NO	Power Factor	Wattage	Voltage/CurrentInput		Light Efficiency	Kelvin Options
			120V	277V		
CES-GB02-80	0.9	80W	0.66A	0.28A	130LM/W	5000K

► Electric Characteristic

Specification/Model	CES-GB02-80
LED DRIVER	Meanwell LED Driver
Input power	80W
Lumens output	10400LM
Efficiency	130LM/W
CRI	>72
Color Temperature	5000K
Input voltage	120-277V/AC
Light distribution type	180D
Working temperature	-40--+50°C
Junction temperature	<75°C
lamps efficiency	≥90%
Certificate	UL CUL DLC
Equivalent	250-350WMH/HPS

PRODUCT ORDERING GUIDE

CES-GB02-80  
1 2 3

CES - GB02 - 80

CES LEDSION code

GB02 Explosion Proof Low bay LED

80 Power 80W

► DIMENSION

Diameter: 11.8in  
H: 8in

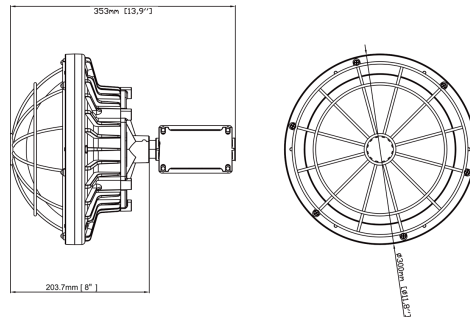

DISTRIBUTION DIAGRAM

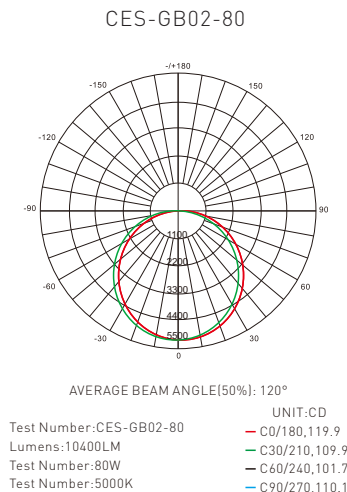

# Explosion Proof Low Bay LED Luminaires

## BEFORE YOU BEGIN

Read these instructions completely and carefully.



## RISK OF ELECTRIC SHOCK

- Turn power off before inspection, installation or removal.
- Properly ground electrical enclosure.
- Make sure the supply voltage is the same as the rated luminaire voltage.



## RISK OF FIRE

- Follow all NEC and local codes.
- Use only UL or IEC approved wire for input/output connections.
- Do not operate in ambient temperature above that indicated on the luminaire nameplate.



## ■ U-Bracket:

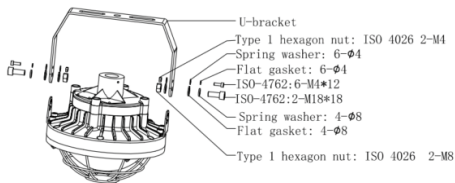
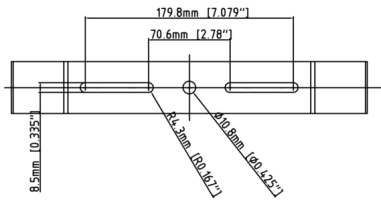

## ■ Ceiling mount and Wall mount

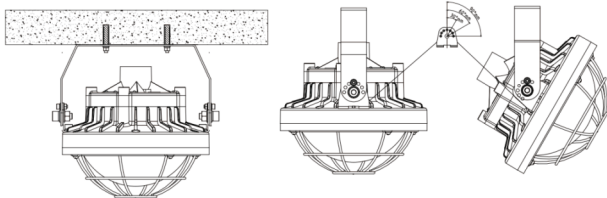

- 1 -

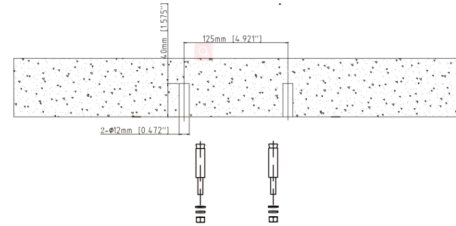

Step1: Open two holes in the wall according to the size in the picture.

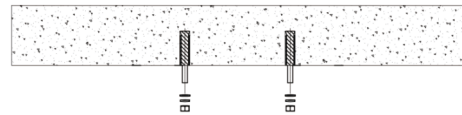

Step2: Install the expansion screws in the holes.

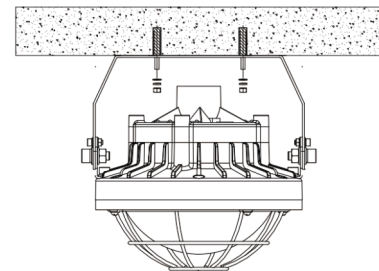

Step3: Align the mounting holes of the CES-GB02-80 U-shaped bracket with the holes of the expansion screw.

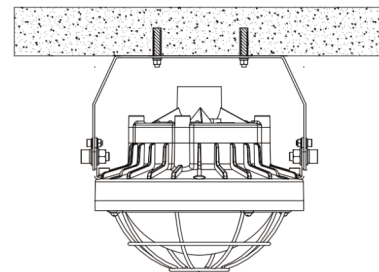

Step4: Use a wrench to tighten the expansion

- 2 -

Explosion Proof Low Bay LED Luminaires

■ Drop mount :

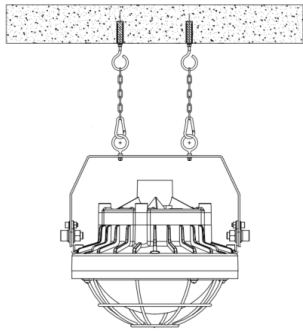

Installation steps (Drop mount) :

Use two M6×90 expansion screws with hooks to fix on the ceiling, and connect the U bracket through the iron chain See Steps.

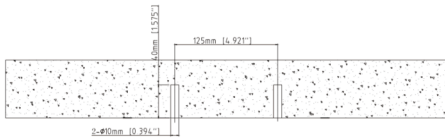

Step1 :Open two holes in the wall according to the size in the picture.

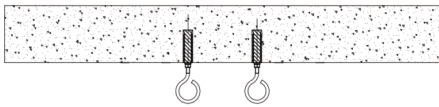

Step2:Install the expansion screws with hooks in the holes.

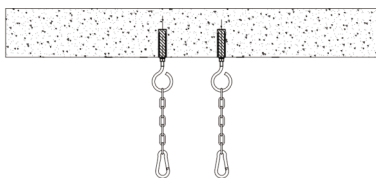

Step3: InstallΦ4 size stainless steel circular chain on the hooks.

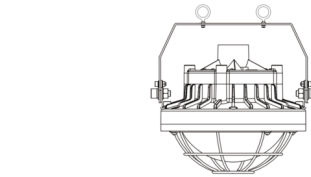

Step4: Use M6 size lifting eye to install on U-bracket.

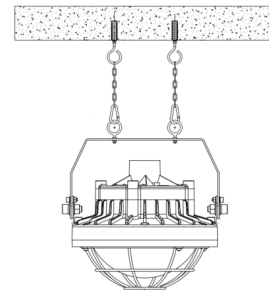

Step5: Hang the lamp on the stainless steel chain.

■ Pole Mount :

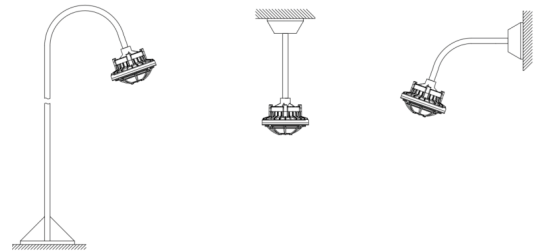

Pole Mount ( Without junction box)

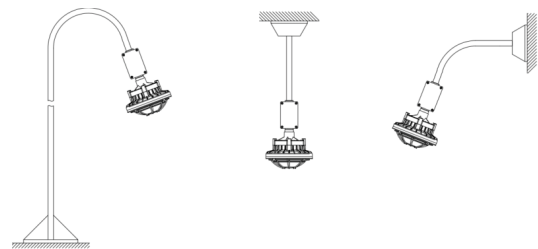

Pole Mount ( With junction box)

Installation steps (Pole mount) :

Use the NPT3/4-14 conduit to connect with the cable entry of CES-EX-GB-02, and use an M3 bolt to lock the thread to ensure that the thread is not loose. See Steps.

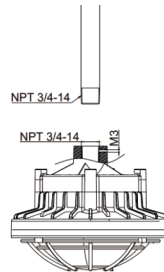

Step1 : Rotate the NPT3/4-14 conduit into the cable entry of CES-GB02-80

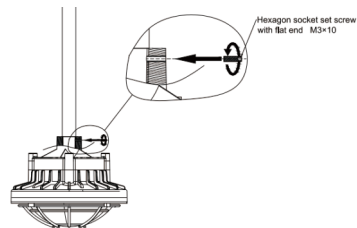

Step2 : Fasten the conduit with an M3 bolt.

Figure 6 Pole Mounting