

PRINTED ON: 9/24/2007

X:\drawings_REVISION\55_EC_RWD_BIKE1

SHEET 1 OF 1	REV E	ECO 3207	MODEL #: 5500XXX	TITLE: M3 INDOOR CYCLE
FROM SERIAL NUMBER: 060822-05004	TO: 070614-14730	DATE FROM: 8/22/2006	TO: 6/14/2007	

Item No	Part No	Description	Qty	Item No	Part No	Description	Qty
1	9253	SCREW - CRPHMS 10-32 X 3/16 SS	9	53	555011	PLATE - MAGNET SUPPORT	1
2	9261	SCREW - CRPHMS 10-32 X 3/8 SS	1	54	555017X	MOUNT - DISPLAY-COMPUTER	1
3	9279	SCREW - SBHTS-TF 5/16-18 X 3/4 ZP	4	55	555051X	COVER - BELT-MAIN	1
4	9287	SCREW - CRPHTS-TF 10-24 X 3/4 SS	1	56	555052X	COVER - BELT-INNER	1
5	9303	SCREW-CRPHTCS-T25 4 X 3/8 SS	4	57	555053	GEAR - POT	1
6	9304	SCREW - CRFCS-PLASTITE 4-20 X 3/8 SS	1	58	555054	SHIFTER - R (RED ONLY)	1
7	9344	WASHER - FW-USS 5/16 ZP	2	59	555055	SHIFTER - L (RED ONLY)	1
8	9369	WASHER - FW-ACFT 5/16 SS	4	60	555056	PIN - MF-5/16 SQ X 2 1/8	1
9	9384	WASHER - FW-ACFT 7/16 SS	4	61	555058	BUSHING - SHORT	2
10	555022	NUT - HAN-HC 7/16-20 SS	4	62	555060X	GUARD - SWEAT-HANDLEBAR	1
11	9500	SCREW - SHCS M6x1 X 10 SS	7	63	555063X	FACE - DISPLAY-COMPUTER (SEE NOTE 9)	1
12	9502	SCREW - SHCS M6x1 X 20 SS (SEE NOTE 3)	9	64	555370	DECAL - DOME-KEISER	1
13	9509	NUT - HELN M6x1 ZP	4	65	555371	DECAL - CAUTION-PEDAL TORQUE	1
14	9511	SCREW - HHCS M8x1.25 X 16 ZP	2	66	555372	DECAL - WARNING - RIDING & SLIDER	1
15	9512	SCREW - BHSCS M8x1.25 X 12 SS(SEE NOTE 5)	2	67	555374	DECAL - HANDLEBAR-POSITION	1
16	9516	SCREW - BHSCS M8x1.25 X 40 SS	2	68	555402	BEARING - 6004ZZ-SHIELDED	2
17	9519	NUT - HAN-HC M8x1.25 SS	2	69	555405	SPRING - TORSION	1
18	9982	NUT - HEAVY SQ. 3/8-16 SS (SEE NOTE 2)	1	70	555406	BELT - POLY V	1
19	105423	BUMPER - MOLDED GLIDE	4	71	555407	WHEEL - 3 IN (SEE NOTE 8)	2
20	105443	DECAL - SERIAL NUMBER	1	72	555410	PAD - BRAKE-FRICTION	1
21	105550	THREAD SEALANT - LOCTITE 242	1	73	555411	SHIFT CABLE	1
22	115036	THREADED INSERT - 5/8 X 3/8 SS	2	74	555413	CORD - COMP TO PICKUP	1
23	115054	PLUG - 2 IN SQ-KEISER	4	75	555417	SADDLE	1
24	505063	PIN - HANDLEBAR-DIA 1/4 X 1-3/4	1	76	555419	SCREW - HSPSS-M10x1.5 X 16 BLK	2
25	505068	BUSHING - 4 PIECE	6	77	555420	SWEAT STRIP - 5/16 X 3/8	1
26	505173	STRAP - PEDAL	2	78	555421X	CRANK ARM - L	1
27	505444	TOE CLIP & STRAP ASSY	1	79	605051	PLUG - GRIP	4
28	505480	RIVET - 1/4 X 3/4 REM PLUG	2	80	966502	BATTERY - AA-CELL	2
29	540831	PEDAL SET - COMBO	1	81	550815	HANDLEBAR	1
30	543091	HOSE - SPACER-LONG	2	82	550828	SA-HANDLE-L	1
31	545420	SCREW - HWHS M8x1 X 22 CS (SEE NOTE 4)	2	83	9501	SCREW - SHCS M6x1 X 16 SS	4
32	550802X	BACK - DISPLAY-COMPUTER (SEE NOTE 9)	1	84	555428	SCREW - HWHS-M8X1X60 CS	2
33	550804	PULLEY - IDLER (SEE NOTE 6)	1	85	9513	SCREW - SHCS M8x1.25 X 12 SS	2
34	550807	SA - SEATPOST	1	86	555066	PULLEY - IDLER MOLDED	1
35	550808	SA - HUB-FLYWHEEL	1	87	550825	KIT-GUARD-FLYWHEEL	1
36	550809	SA - HANDLEBAR (SEE NOTE 1)	1	88	555446	WHEEL - 3 IN-W/BUSHING	2
37	550810	SA - KNOB (SEE NOTE 2)	3	89	555037	SPACER - 032039109	2
38	550811	SA - PULLEY-330MM	1	90	9532	SCREW - CRPHMS 4-40 X 16 SS	1
39	550812	SA - MAGNET HOLDER	1	91	550802	BACK - DISPLAY COMPUTER	1
40	550813X	SA - CRANK ARM-R AXLE SET	1	92	550912	CKT BRD - COMPUTER-BL	1
41	550814X	SA - FRAME-BASE	1	93	555079	FACE - DISPLAY-COMPUTER-BL	1
42	550818X	SA - COVER-LOWER-MF	1				
43	550819XXN	SA - MAIN FRAME - XXN	1				
44	550820XXC	SA - MAIN FRAME - XXC	1				
45	550902	HANDLEBAR - ADJ TUBE	1				
46	550904	CKT BRD - PICKUP	1				
47	550905	CKT BRD - COMPUTER (SEE NOTE 9)	1				
48	555000	PLATE - FRICTION	2				
49	555003	FLYWHEEL	1				
50	555005	HUB CAP - FLYWHEEL	1				
51	555008	MAGNET COVER	1				
52	555009	SLIDER - SEAT	1				

REV E	ECO 3207	MODEL#	5500XXX	TITLE:	M3 INDOOR CYCLE
FROM SERIAL NUMBER:			060822-05004 TO: 070614-14730	DATE FROM:	8/22/2006 TO: 6/14/2007

NOTE 1:
ITEM 81 REPLACES
ITEM 36

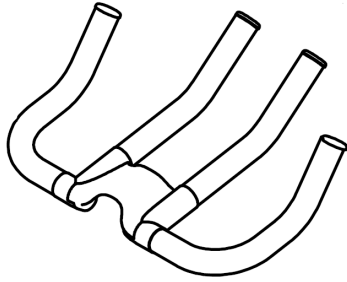

NOTE 2:
ITEM 82
REPLACES ITEM
18 AND ONE OF ITEM 37
FOR FORE AND AFT
ADJUSTMENT ONLY

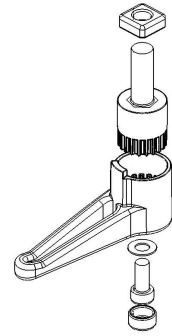

NOTE 3:
ITEM 83
REPLACES
4 OF ITEM 12

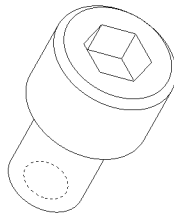

NOTE 4:
ITEM 84 AND NEW AXLE
ITEM 40
REPLACES
ITEM 31

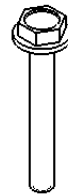

NOTE 5:
ITEM 85
REPLACES
ITEM 15.
REPLACE
ITEM 62 ALSO

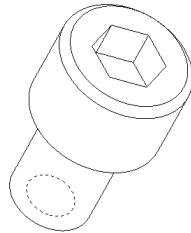

NOTE 6:
ITEM 86
REPLACES
ITEM 33

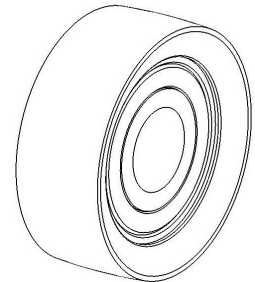

NOTE 7:
ADD ITEM 87

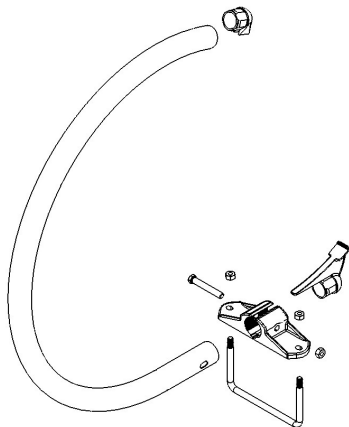

NOTE 8:
ITEMS 88 & 89
REPLACE
ITEM 71.
REPLACE
ITEMS 8,16 & 17
ALSO

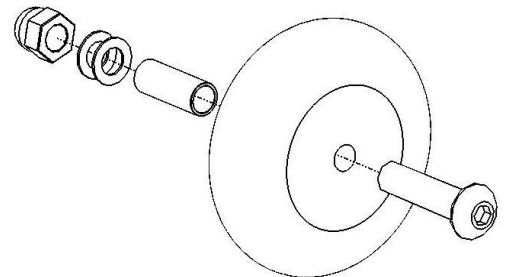

NOTE 9:
3 OF ITEM 5 AND
ITEMS 90,91,92 &
93 REPLACES
ITEMS 32, 47
& 63

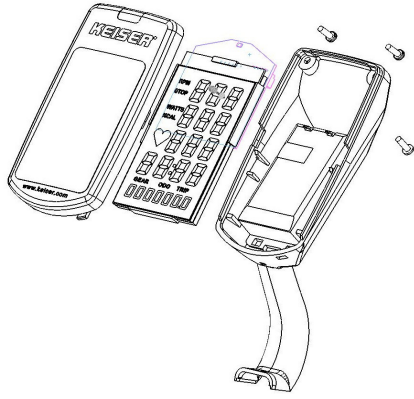

REV E	ECO 3207	MODEL#	5500XXX	TITLE:	M3 INDOOR CYCLE
FROM SERIAL NUMBER:			060822-05004 TO: 070614-14730	DATE FROM:	8/22/2006 TO: 6/14/2007

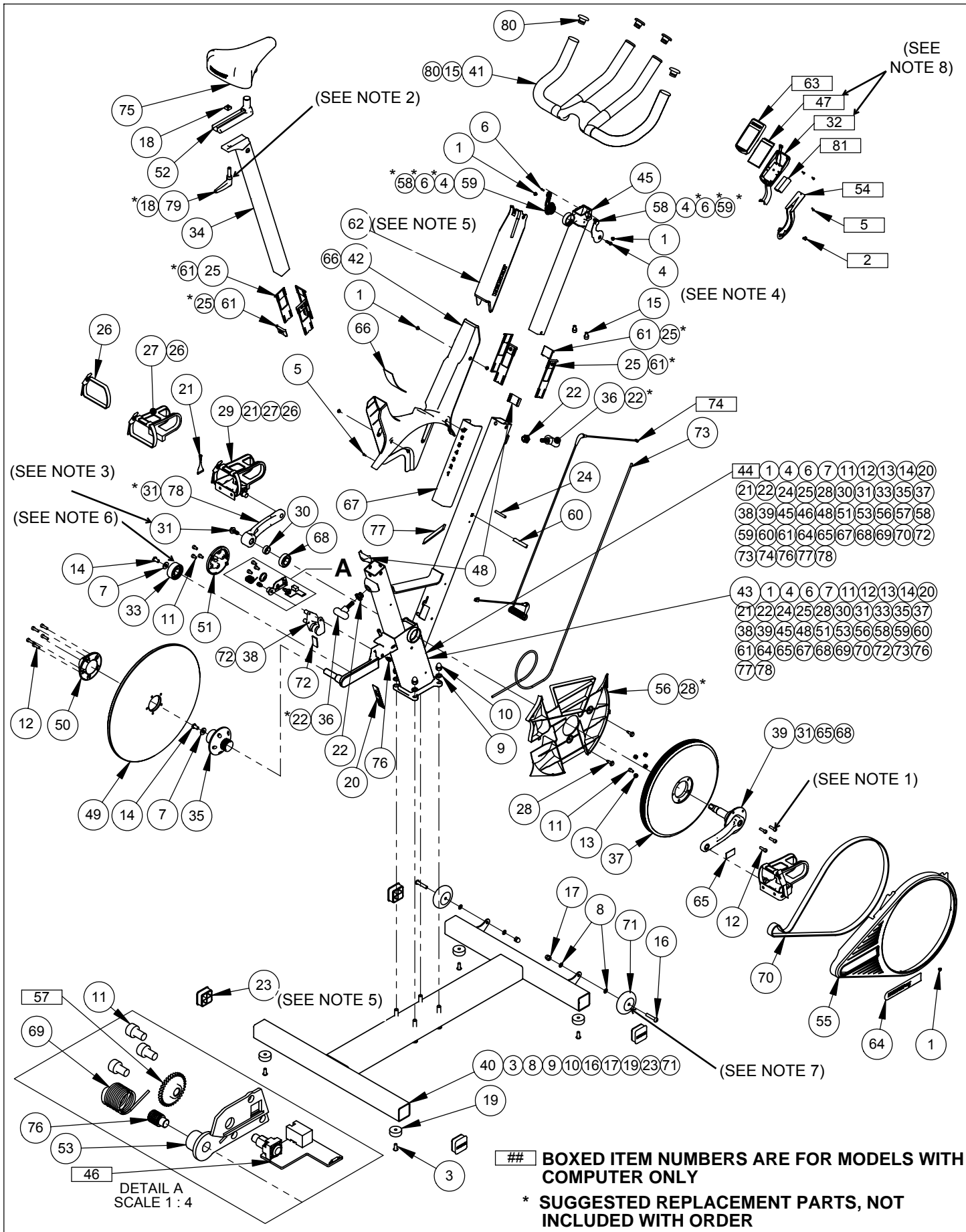

SHEET 1 OF 1	REV E	ECO 3207	MODEL #: 5500XXX	TITLE: M3 INDOOR CYCLE
FROM SERIAL NUMBER: 070614-14731		TO: 080702-09369		DATE FROM: 6/14/2007 TO: 7/2/2008

PRINTED ON: 10/10/2007
X:\drawings_REVISION\55_EC_RWD_BIKE1

Item No	Part No	Description	Qty	Item No	Part No	Description	Qty
1	9253	SCREW - CRPHMS 10-32 X 3/16 SS	9	53	555011	PLATE - MAGNET SUPPORT	1
2	9261	SCREW - CRPHMS 10-32 X 3/8 SS	1	54	555017X	MOUNT - DISPLAY-COMPUTER	1
3	9279	SCREW - SBHTS-TF 5/16-18 X 3/4 ZP	4	55	555051X	COVER - BELT-MAIN	1
4	9287	SCREW - CRPHTS-TF 10-24 X 3/4 SS	1	56	555052X	COVER - BELT-INNER	1
5	9303	SCREW-CRPHTCS-T25 4 X 3/8 SS	4	57	555053	GEAR - POT	1
6	9304	SCREW - CRFCS-PLASTITE 4-20 X 3/8 SS	1	58	555054	SHIFTER - R (RED ONLY)	1
7	9344	WASHER - FW-USS 5/16 ZP	2	59	555055	SHIFTER - L (RED ONLY)	1
8	9369	WASHER - FW-ACFT 5/16 SS	4	60	555056	PIN - MF-5/16 SQ X 2 1/8	1
9	9384	WASHER - FW-ACFT 7/16 SS	4	61	555058	BUSHING - SHORT	2
10	555022	NUT - HAN-HC 7/16-20 SS (SEE NOTE 3)	4	62	555060X	GUARD - SWEAT-HANDLEBAR	1
11	9500	SCREW - SHCS M6x1 X 10 SS	7	63	555063X	FACE - DISPLAY-COMPUTER	1
12	9502	SCREW - SHCS M6x1 X 20 SS (SEE NOTE 1)	9	64	555370	DECAL - DOME-KEISER	1
13	9509	NUT - HELN M6x1 ZP	4	65	555371	DECAL - CAUTION-PEDAL TORQUE	1
14	9511	SCREW - HHCS M8x1.25 X 16 ZP	2	66	555372	DECAL - WARNING - RIDING & SLIDER	1
15	9512	SCREW - BHSCS M8x1.25 X 12 SS(SEE NOTE 4)	2	67	555374	DECAL - HANDLEBAR-POSITION	1
16	9516	SCREW - BHSCS M8x1.25 X 40 SS	2	68	555402	BEARING - 6004ZZ-SHIELDED	2
17	9519	NUT - HAN-HC M8x1.25 SS	2	69	555405	SPRING - TORSION	1
18	9982	NUT - HEAVY SQ. 3/8-16 SS (SEE NOTE 2)	1	70	555406	BELT - POLY V	1
19	105423	BUMPER - MOLDED GLIDE	4	71	555407	WHEEL - 3 IN (SEE NOTE 7)	2
20	105443	DECAL - SERIAL NUMBER	1	72	555410	PAD - BRAKE-FRICTION	1
21	105550	THREAD SEALANT - LOCTITE 242	1	73	555411	SHIFT CABLE	1
22	115036	THREADED INSERT - 5/8 X 3/8 SS	2	74	555413	CORD - COMP TO PICKUP	1
23	115054	PLUG - 2 IN SQ-KEISER	4	75	555417	SADDLE	1
24	505063	PIN - HANDLEBAR-DIA 1/4 X 1-3/4	1	76	555419	SCREW - HSPSS-M10x1.5 X 16 BLK	2
25	505068	BUSHING - 4 PIECE	6	77	555420	SWEAT STRIP - 5/16 X 3/8	1
26	505173	STRAP - PEDAL	2	78	555421X	CRANK ARM - L	1
27	505444	TOE CLIP & STRAP ASSY	1	79	555426	HANDLE - FLAT CLAMP (SEE NOTE 2)	1
28	505480	RIVET - 1/4 X 3/4 REM PLUG	2	80	605051	PLUG - GRIP	4
29	540831	PEDAL SET - COMBO	1	81	966502	BATTERY - AA-CELL	2
30	543091	HOSE - SPACER-LONG	2	82	9501	SCREW - SHCS M6x1 X 16 SS	4
31	545420	SCREW - HWHS M8x1 X 22 CS (SEE NOTE 3)	2	83	555428	SCREW - HWHS-M8X1X60 CS	2
32	550802X	BACK - DISPLAY-COMPUTER (SEE NOTE 8)	1	84	9513	SCREW - SHCS M8x1.25 X 12 SS	2
33	550804	PULLEY - IDLER (SEE NOTE 6)	1	85	550828	SA-HANDLE-L	1
34	550807	SA - SEATPOST	1	86	550825	KIT-GUARD-FLYWHEEL	1
35	550808	SA - HUB-FLYWHEEL	1	87	555066	PULLEY - IDLER-MOLDED	1
36	550810	SA - KNOB	2	88	555446	WHEEL - 3 IN-W/BUSHING	2
37	550811	SA - PULLEY-330MM	1	89	555037	SPACER - 032039109	2
38	550812	SA - MAGNET HOLDER	1	90	9532	SCREW - CRPHMS 4-40 X 16 SS	1
39	550813X	SA - CRANK ARM-R AXLE SET	1	91	550802	BACK - DISPLAY COMPUTER	1
40	550814X	SA - FRAME-BASE	1	92	550912	CKT BRD - COMPUTER-BL	1
41	550815	SA - HANDLEBAR	1	93	555079	FACE - DISPLAY-COMPUTER-BL	1
42	550818X	SA - COVER-LOWER-MF	1				
43	550819XXN	SA - MAIN FRAME - XXN	1				
44	550820XXC	SA - MAIN FRAME - XXC	1				
45	550902	HANDLEBAR - ADJ TUBE	1				
46	550904	CKT BRD - PICKUP	1				
47	550905	CKT BRD - COMPUTER (SEE NOTE 8)	1				
48	555000	PLATE - FRICTION	2				
49	555003	FLYWHEEL	1				
50	555005	HUB CAP - FLYWHEEL	1				
51	555008	MAGNET COVER	1				
52	555009	SLIDER - SEAT	1				

REV E	ECO 3207	MODEL#	5500XXX	TITLE:	M3 INDOOR CYCLE
FROM SERIAL NUMBER:			070614-14731 TO: 080702-09369	DATE FROM:	6/14/2007 TO: 7/2/2008

NOTE 1:
ITEMS 82
REPLACES
4 OF ITEM 12

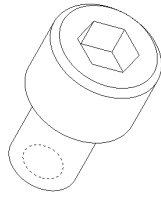

NOTE 2:
ITEM 85
REPLACES
ITEMS 18 & 79
FOR FORE AND AFT
ADJUSTMENT ONLY

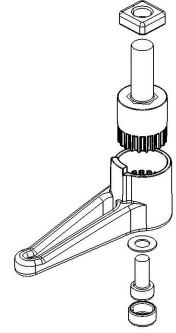

NOTE 3:
ITEM 83 AND NEW AXLE
ITEM 39
REPLACES
ITEM 31

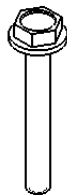

NOTE 4:
ITEM 84
REPLACES
ITEM 15.
REPLACE
ITEM 62 ALSO

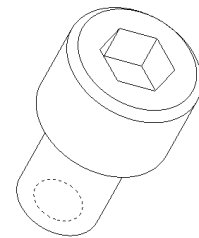

NOTE 5:
ADD ITEM 86

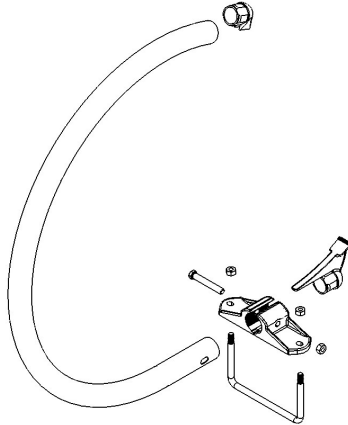

NOTE 6:
ITEM 87
REPLACES
ITEM 33

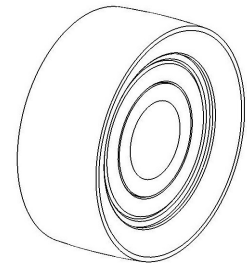

NOTE 7:
ITEM 88 & 89
REPLACE
ITEM 71.
REPLACE
ITEMS 8,16 & 17
ALSO

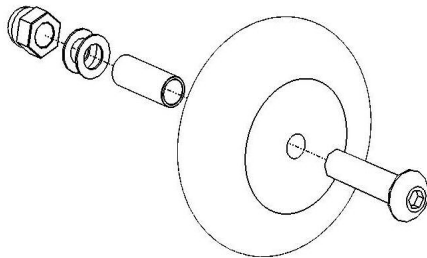

NOTE 8:
3 OF ITEM 5 AND
ITEMS 90,91,92 & 93
REPLACES ITEMS
32 & 47

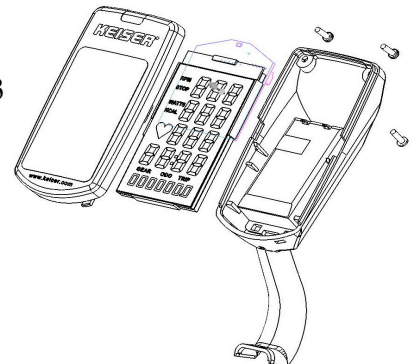

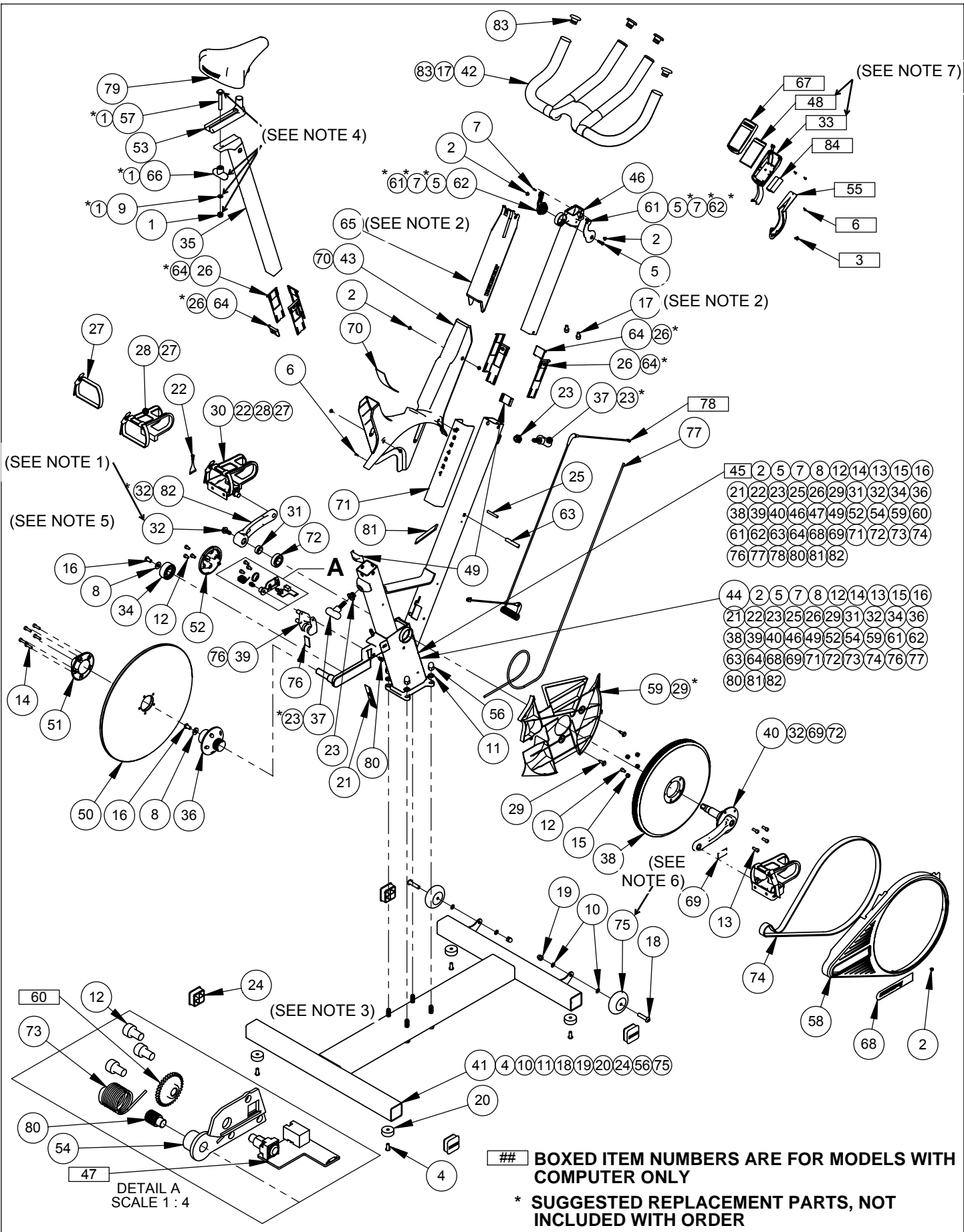

PRINTED ON: 7/30/2008

X:\drawings_REVISION\55_EC_RWD_BIKE

SHEET 1 OF 1	REV E	ECO 3207	MODEL #: 5500XXX	TITLE: M3 INDOOR CYCLE
FROM SERIAL NUMBER: 080702-09370	TO: 0908003-10654	DATE FROM: 7/2/2008	TO: 8/10/2009	

Item No	Part No	Description	Qty	Item No	Part No	Description	Qty
1	9218	NUT - HRLN 3/8-16 SS (SEE NOTE 4)	1	53	555009	SLIDER - SEAT	1
2	9253	SCREW - CRPHMS 10-32 X 3/16 SS	9	54	555011	PLATE - MAGNET SUPPORT	1
3	9261	SCREW - CRPHMS 10-32 X 3/8 SS	1	55	555017X	MOUNT - DISPLAY-COMPUTER	1
4	9279	SCREW - SBHTS-TF 5/16-18 X 3/4 ZP	4	56	555022	NUT - HAN-HC-7/16-20 SS	4
5	9287	SCREW - CRPHTS-TF 10-24 X 3/4 SS	1	57	555024	BOLT - 3/8-16 UNC X 2 1/2 SS (SEE NOTE 4)	1
6	9303	SCREW-CRPHTCS-T25 4 X 3/8 SS	4	58	555051X	COVER - BELT-MAIN	1
7	9304	SCREW - CRFCS-PLASTITE 4-20 X 3/8 SS	1	59	555052X	COVER - BELT-INNER	1
8	9344	WASHER - FW-USS 5/16 ZP	2	60	555053	GEAR - POT	1
9	9355	WASHER - FW-ACFT 3/8 ZP (SEE NOTE 4)	1	61	555054	SHIFTER - R (RED ONLY)	1
10	9369	WASHER - FW-ACFT 5/16 SS (SEE NOTE 6)	4	62	555055	SHIFTER - L (RED ONLY)	1
11	9384	WASHER - FW-ACFT 7/16 SS	4	63	555056	PIN - MF-5/16 SQ X 2 1/8	1
12	9500	SCREW - SHCS M6x1 X 10 SS	7	64	555058	BUSHING - SHORT	2
13	9501	SCREW - SHCS M6x1 X 16 SS	4	65	555060X	GUARD - SWEAT-HANDLEBAR	1
14	9502	SCREW - SHCS M6x1 X 20 SS	5	66	555061	KNOB - T-BLACK-SQ (SEE NOTE 4)	1
15	9509	NUT - HELN M6x1 ZP	4	67	555063X	FACE - DISPLAY-COMPUTER	1
16	9511	SCREW - HHCS M8x1.25 X 16 ZP	2	68	555370	DECAL - DOME-KEISER	1
17	9512	SCREW - BHSCS M8x1.25 X 12 SS(SEE NOTE 2)	2	69	555371	DECAL - CAUTION-PEDAL TORQUE	1
18	9516	SCREW - BHSCS M8x1.25 X 40 SS(SEE NOTE 6)	2	70	555372	DECAL - WARNING - RIDING & SLIDER	1
19	9519	NUT - HAN-HC M8x1.25 SS (SEE NOTE 6)	2	71	555374	DECAL - HANDLEBAR-POSITION	1
20	105423	BUMPER - MOLDED GLIDE	4	72	555402	BEARING - 6004ZZ-SHIELDED	2
21	105443	DECAL - SERIAL NUMBER	1	73	555405	SPRING - TORSION	1
22	105550	THREAD SEALANT - LOCTITE 242	1	74	555406	BELT - POLY V	1
23	115036	THREADED INSERT - 5/8 X 3/8 SS	2	75	555407	WHEEL - 3 IN (SEE NOTE 6)	2
24	115054	PLUG - 2 IN SQ-KEISER	4	76	555410	PAD - BRAKE-FRICTION	1
25	505063	PIN - HANDLEBAR-DIA 1/4 X 1-3/4	1	77	555411	SHIFT CABLE	1
26	505068	BUSHING - 4 PIECE	6	78	555413	CORD - COMP TO PICKUP	1
27	505173	STRAP - PEDAL	2	79	555417	SADDLE	1
28	505444	TOE CLIP & STRAP ASSY	1	80	555419	SCREW - HSPSS-M10x1.5 X 16 BLK	2
29	505480	RIVET - 1/4 X 3/4 REM PLUG	2	81	555420	SWEAT STRIP - 5/16 X 3/8	1
30	540831	PEDAL SET - COMBO	1	82	555421X	CRANK ARM - L	1
31	543091	HOSE - SPACER-LONG	2	83	605051	PLUG - GRIP	4
32	545420	SCREW - HWHS M8x1 X 22 CS (SEE NOTE 1)	2	84	966502	BATTERY - AA-CELL	2
33	550802X	BACK - DISPLAY-COMPUTER (SEE NOTE 7)	1	85	555428	SCREW - HWHS-M8X1X60 CS	2
34	550804	PULLEY - IDLER (SEE NOTE 5)	1	86	9513	SCREW - SHCS M8x1.25 X 12 SS	2
35	550807	SA - SEATPOST	1	87	550825	KIT-GUARD-FLYWHEEL	1
36	550808	SA - HUB-FLYWHEEL	1	88	550828	SA-HANDLE-L	1
37	550810	SA - KNOB	2	89	555066	PULLEY - IDLER-MOLDED	1
38	550811	SA - PULLEY-330MM	1	90	555446	WHEEL - 3 IN-W/BUSHING	2
39	550812	SA - MAGNET HOLDER	1	91	555037	SPACER - 032039109	2
40	550813X	SA - CRANK ARM-R AXLE SET	1	92	9532	SCREW - CRPHMS 4-40 X 16 SS	1
41	550814X	SA - FRAME-BASE	1	93	550802	BACK - DISPLAY COMPUTER	1
42	550815	SA - HANDLEBAR	1	94	550912	CKT BRD - COMPUTER-BL	1
43	550818X	SA - COVER-LOWER-MF	1	95	555079	FACE - DISPLAY-COMPUTER-BL	1
44	550819XXN	SA - MAIN FRAME - XXN	1				
45	550820XXC	SA - MAIN FRAME - XXC	1				
46	550902	HANDLEBAR - ADJ TUBE	1				
47	550904	CKT BRD - PICKUP	1				
48	550905	CKT BRD - COMPUTER (SEE NOTE 7)	1				
49	555000	PLATE - FRICTION	2				
50	555003	FLYWHEEL	1				
51	555005	HUB CAP - FLYWHEEL	1				
52	555008	MAGNET COVER	1				

REV E	ECO 3207	MODEL#	5500XXX	TITLE:	M3 INDOOR CYCLE
FROM SERIAL NUMBER:			080702-09370 TO: 090803-10654	DATE FROM:	7/2/2008 TO: 8/10/2009

NOTE 1:
ITEM 85 AND NEW AXLE
ITEM 40
REPLACES
ITEM 32

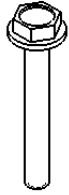

NOTE 2:
ITEM 86
REPLACES
ITEM 17.
REPLACE
ITEM 65 ALSO

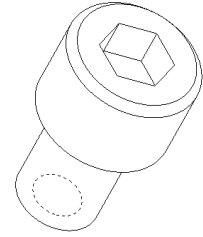

NOTE 3:
ADD ITEM 87

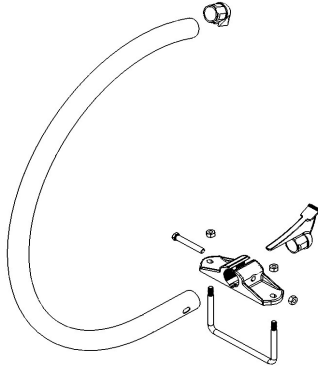

NOTE 4:
ITEM 88
REPLACES ITEMS
1,9,57 & 66
FOR FORE AND AFT
ADJUSTMENT ONLY

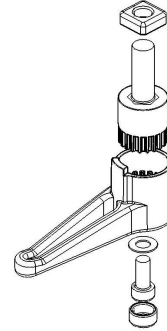

NOTE 5:
ITEM 89
REPLACES
ITEM 34

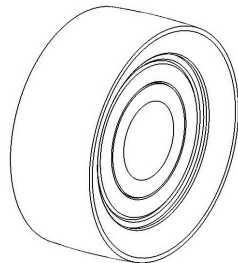

NOTE 6:
ITEM 90 & 91
REPLACE
ITEM 75.
REPLACE ITEMS
10,18 & 19 ALSO

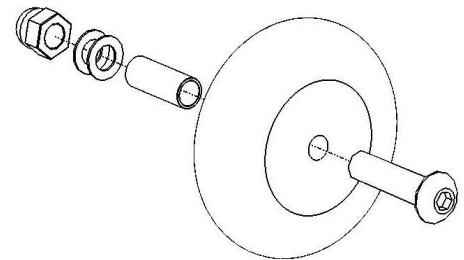

NOTE 7:
3 OF ITEM 6 AND
ITEMS 92,93,94 & 95
REPLACES ITEMS
33 & 48

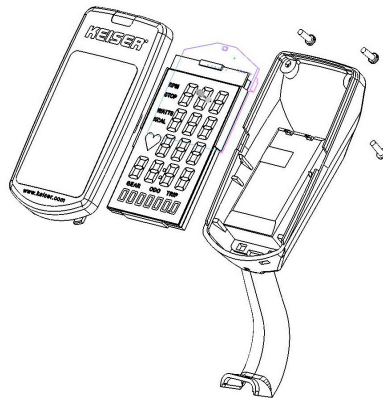

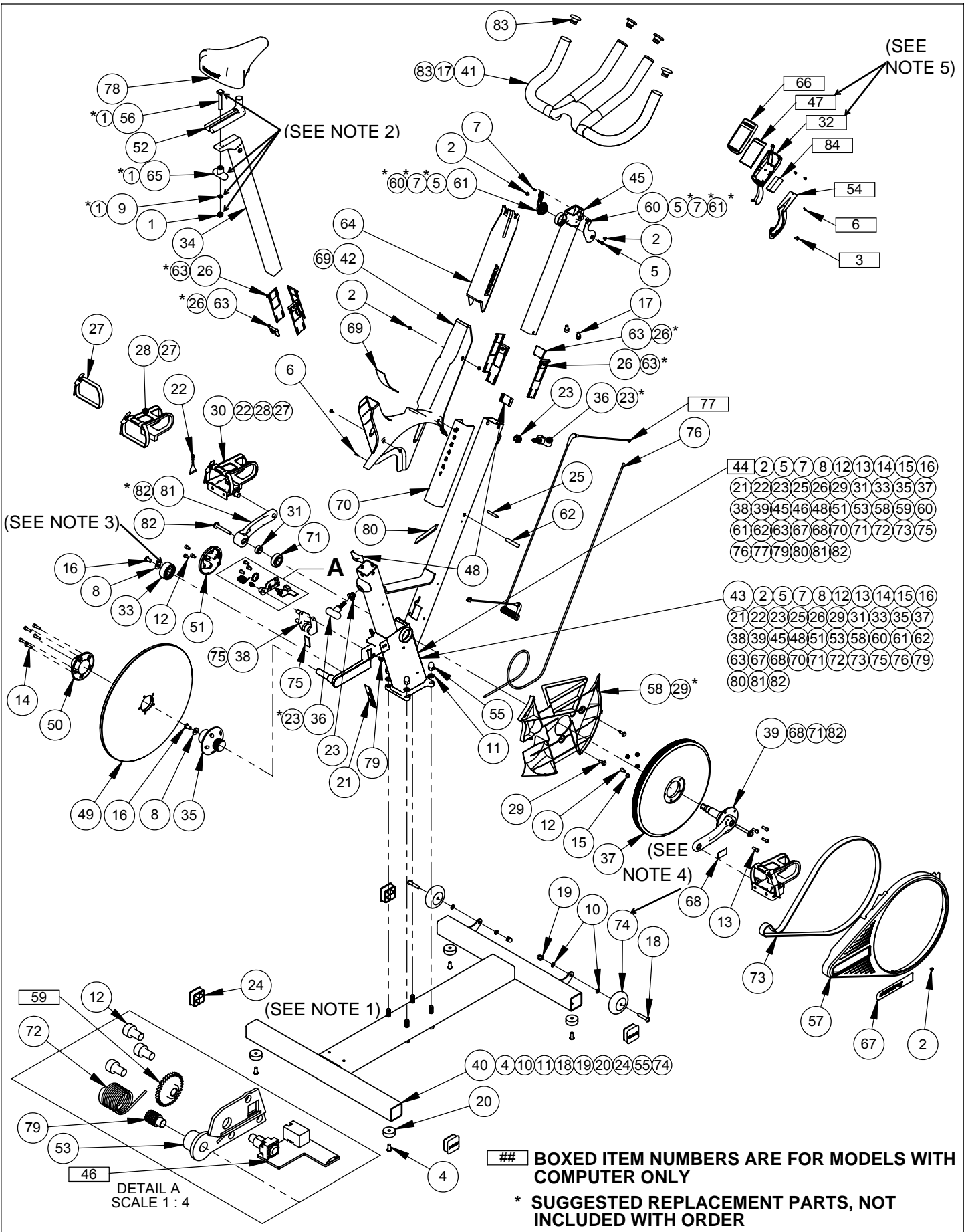

PRINTED ON: 1/29/2010

X:\drawings_REVISION\55_EC_RWD_BIKE\55500XXX_D1

SHEET 1 OF 1	REV E	ECO 3207	MODEL #: 5500XXX	TITLE: M3 INDOOR CYCLE
FROM SERIAL NUMBER: 090803-10655	TO: 100524-10238	DATE FROM: 8/10/2009	TO: 5/25/2010	

Item No	Part No	Description	Qty	Item No	Part No	Description	Qty
1	9218	NUT - HRLN 3/8-16 SS (SEE NOTE 2)	1	53	555011	PLATE - MAGNET SUPPORT	1
2	9253	SCREW - CRPHMS #10-32 X 3/16 SS	9	54	555017X	MOUNT - DISPLAY-COMPUTER	1
3	9261	SCREW - CRPHMS 10-32 X 3/8 SS	1	55	555022	NUT - HAN-HC-7/16-20 SS	4
4	9279	SCREW - SBHTS-TF 5/16-18 X 3/4 ZP	4	56	555024	BOLT - 3/8-16 UNC X 2 1/2 SS (SEE NOTE 2)	1
5	9287	SCREW - CRPHTS-TF #10-24 X 3/4 SS	1	57	555051X	COVER - BELT-MAIN	1
6	9303	SCREW - CRPHTCS-T25 4 X 3/8 SS	4	58	555052X	COVER - BELT-INNER	1
7	9304	SCREW - CRFCS-PLASTITE 4-20 X 3/8 SS	1	59	555053	GEAR - POT	1
8	9344	WASHER - FW USS .375 X .875 X .078 ZP	2	60	555054	SHIFTER - R (RED ONLY)	1
9	9355	WASHER - FW-ACFT 3/8 ZP (SEE NOTE 2)	1	61	555055	SHIFTER - L (RED ONLY)	1
10	9369	WASHER - ACFT 5/16 SS	4	62	555056	PIN - MF-5/16 SQ X 2 1/8	1
11	9384	WASHER - FW ACFT 7/16 SS	4	63	555058	BUSHING - SHORT	2
12	9500	SCREW - SHCS M6x1 X 10 SS	7	64	555060X	GUARD - SWEAT-HANDLEBAR	1
13	9501	SCREW - SHCS M6x1 X 16 SS	5	65	555061	KNOB - T-BLACK-SQ (SEE NOTE 2)	1
14	9502	SCREW - SHCS M6x1 X 20 SS	5	66	555063X	FACE - DISPLAY-COMPUTER	1
15	9509	NUT - HELN M6X1 ZP	4	67	555370	DECAL - DOME-KEISER	1
16	9511	SCREW - HHCS M8X1.25 X 16 ZP	2	68	555371	DECAL - CAUTION-PEDAL TORQUE	1
17	9513	SCREW - SHCS M8x1.25 X 12 SS	2	69	555372	DECAL - WARNING - RIDING & SLIDER	1
18	9516	SCREW-BHSCS M8x1.25 X 40 SS	2	70	555374	DECAL - HANDLEBAR-POSITION	1
19	9519	NUT-HAN-HC M8x1.25 SS	2	71	555402	BEARING - 6004ZZ-SHIELDED	2
20	105423	BUMPER - MOLDED GLIDE	4	72	555405	SPRING - TORSION	1
21	105443	DECAL - SERIAL NUMBER	1	73	555406	BELT - POLY V	1
22	105550	THREAD SEALANT - LOCTITE 242	1	74	555407	WHEEL - 3 IN (SEE NOTE 4)	2
23	115036	THREADED INSERT - 5/8 X 3/8 SS	2	75	555410	PAD - BRAKE-FRICTION	1
24	115054	PLUG - 2 IN SQ-KEISER	4	76	555411	SHIFT CABLE	1
25	505063	PIN - HANDLEBAR-1/4 X 1-3/4	1	77	555413	CORD - COMP TO PICKUP	1
26	505068	BUSHING - 4 PIECE	6	78	555417	SADDLE	1
27	505173	STRAP - PEDAL	2	79	555419	SCREW - HSPSS-M10x1.5 X 16 BLK	2
28	505444	TOE CLIP & STRAP SET ASSY	1	80	555420	SWEAT STRIP - 5/16 X 3/8	1
29	505480	RIVET - 1/4 X 3/4 REM PLUG	2	81	555421X	CRANK ARM - LEFT	1
30	540831	PEDAL SET - COMBO	1	82	555428	SCREW - HWHS-M8 X 1 X 60 CS	2
31	543091	HOSE - SPACER-LONG	1	83	605051	PLUG - GRIP	4
32	550802X	BACK - DISPLAY-COMPUTER (SEE NOTE 5)	1	84	966502	BATTERY - AA CELL	2
33	550804	PULLEY - IDLER (SEE NOTE 3)	1	85	550845	SA-GUARD-FLYWHEEL	1
34	550807	SA - SEATPOST	1	86	550828	SA-HANDLE-L	1
35	550808	SA - HUB-FLYWHEEL	1	87	555066	PULLEY - IDLER-MOLDED	1
36	550810	SA - KNOB	2	88	555037	SPACER - 032039109	2
37	550811	SA - PULLEY-330MM DIA	1	89	555446	WHEEL - 3 IN-W/BUSHING	2
38	550812	SA - MAGNET HOLDER	1	90	9532	SCREW - CRPHMS 4-40 X 16 SS	1
39	550813X	SA - CRANK ARM-RIGHT	1	91	550802	BACK - DISPLAY COMPUTER	1
40	550814X	SA - FRAME-BASE	1	92	550912	CKT BRD - COMPUTER-BL	1
41	550815	SA - HANDLEBAR	1	93	555079	FACE - DISPLAY-COMPUTER-BL	1
42	550818X	SA - COVER-LOWER-MF	1				
43	550819XXN	SA - MAIN FRAME-XXN	1				
44	550820XXC	SA - MAIN FRAME-XXC	1				
45	550902	HANDLEBAR - ADJ TUBE	1				
46	550904	CKT BRD - PICKUP	1				
47	550905	CKT BRD - COMPUTER (SEE NOTE 5)	1				
48	555000	PLATE - FRICTION	2				
49	555003	FLYWHEEL	1				
50	555005	HUBCAP - FLYWHEEL	1				
51	555008	MAGNET COVER	1				
52	555009	SLIDER - SEAT	1				

REV E	ECO 3207	MODEL#	5500XXX	TITLE:	M3 INDOOR CYCLE
FROM SERIAL NUMBER:			090803-10655 TO 100524-10238	DATE FROM:	8/10/2009 TO: 5/25/2010

NOTE 1:
ADD ITEM 85

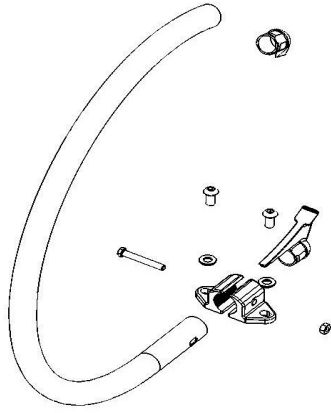

NOTE 2:
ITEM 86
REPLACES ITEMS
1,9,56 & 65
FOR FORE AND AFT
ADJUSTMENT ONLY

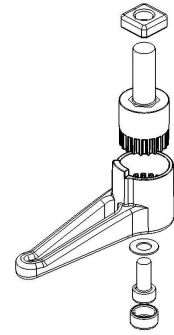

NOTE 3:
ITEM 87
REPLACES
ITEM 33

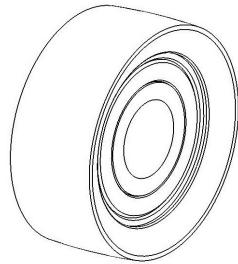

NOTE 4:
ITEMS 88 & 89
REPLACE
ITEM 74.
REPLACE ITEMS
10,18 & 19 ALSO

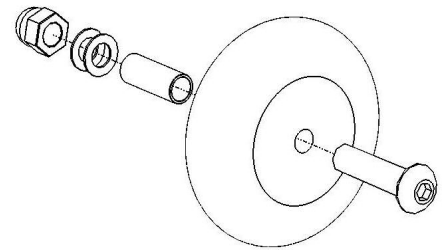

NOTE 5:
3 OF ITEM 6 AND
ITEMS 90,91,92 & 93
REPLACES ITEMS
32 & 47

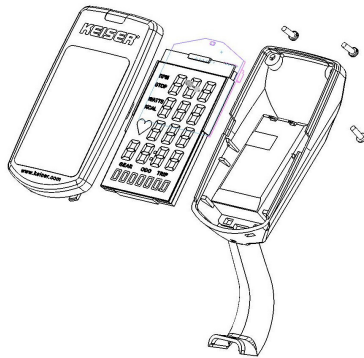

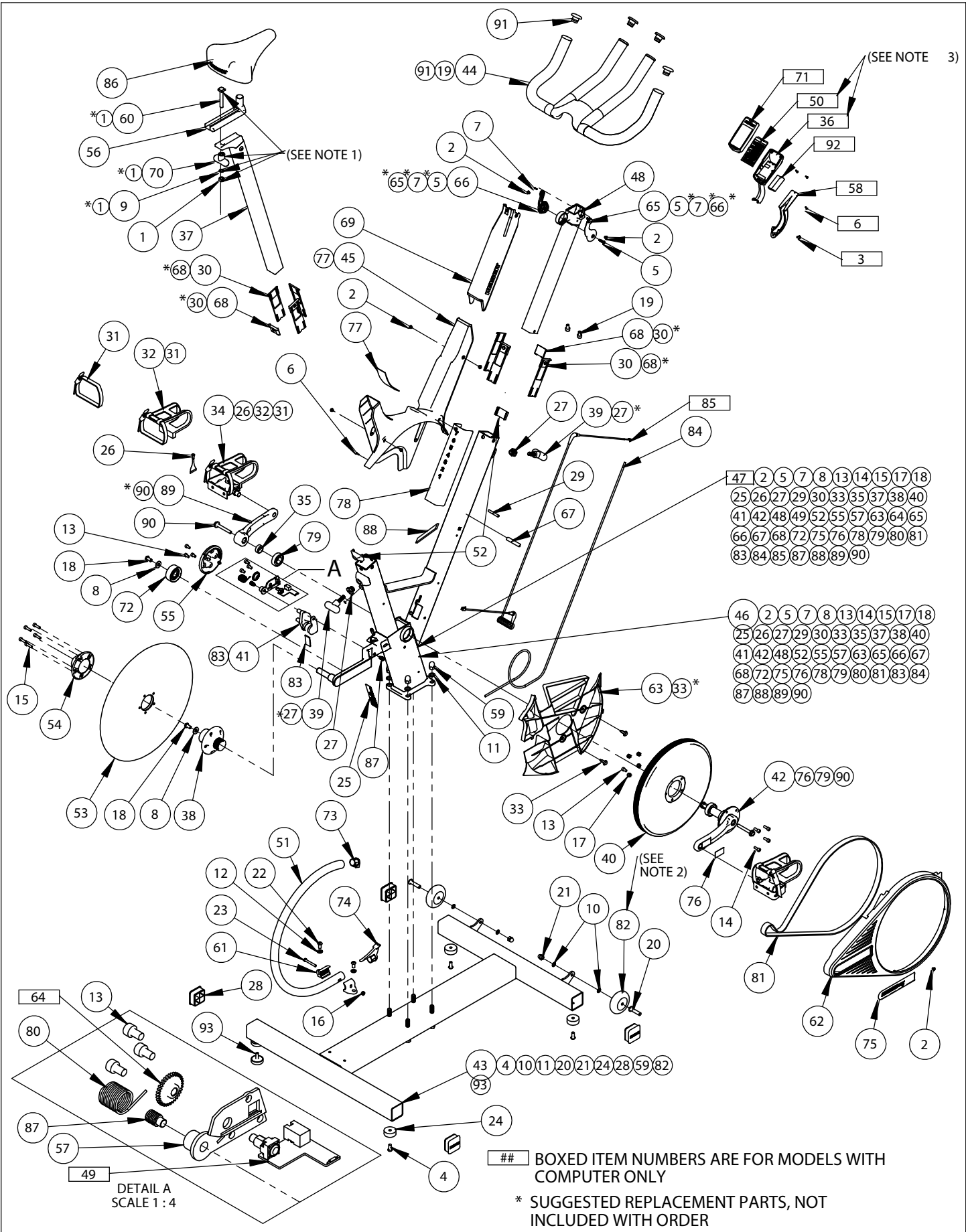

PRINTED ON: 10/15/2012

X:\drawings\REVISION\55_EC_RWD_BIKE\5500XXX1

SHEET 1 OF 1	REV E	ECO 3207	MODEL #: 5500XXX	TITLE: M3 INDOOR CYCLE
FROM SERIAL NUMBER: 100524-10239	TO: 110624-15718	DATE FROM: 5/25/10	TO: 6/24/11	

Item No	Part No	Description	Qty	Item No	Part No	Description	Qty
1	9218	NUT - HRLN 3/8-16 SS (SEE NOTE 1)	1	53	555003	FLYWHEEL	1
2	9253	SCREW - CRPHMS #10-32 X 3/16 SS	9	54	555005	HUBCAP - FLYWHEEL	1
3	9261	SCREW - CRPHMS 10-32 X 3/8 SS	1	55	555008	MAGNET COVER	1
4	9279	SCREW - SBHTS-TF 5/16-18 X 3/4 ZP	3	56	555009	SLIDER - SEAT	1
5	9287	SCREW - CRPHTS 10-24 X 3/4 SS	1	57	555011	PLATE - MAGNET SUPPORT	1
6	9303	SCREW - CRPHTCS-T25 4 X 3/8 SS	4	58	555017	MOUNT - DISPLAY-COMPUTER	1
7	9304	SCREW - CRFCS-PLASTITE 4-20 X 3/8 SS	1	59	555022	NUT - HAN-HC-7/16-20 SS	4
8	9344	WASHER - FW-USS 5/16 ZP	2	60	555024	BOLT - 3/8-16 UNC X 2 1/2 SS (SEE NOTE 1)	1
9	9355	WASHER - FW-ACFT 3/8 ZP (SEE NOTE 1)	1	61	555025	CLAMP - WHEEL GUARD	2
10	9369	WASHER - ACFT 5/16 SS	4	62	555051	COVER - BELT-MAIN	1
11	9384	WASHER - FW-ACFT 7/16 SS	4	63	555052	COVER - BELT-INNER	1
12	9397	WASHER - BONDED 5/16 SS	2	64	555053	GEAR - POT	1
13	9500	SCREW - SHCS M6x1 X 10 SS	7	65	555054	SHIFTER - R (RED ONLY)	1
14	9501	SCREW - SHCS M6x1 X 16 SS	4	66	555055	SHIFTER - L (RED ONLY)	1
15	9502	SCREW - SHCS M6x1 X 20 SS	5	67	555056	PIN - MF-5/16 SQ X 2 1/8	1
16	9508	NUT - HN M6X1 SS	1	68	555058	BUSHING - SHORT	2
17	9509	NUT - HELN M6X1 ZP	4	69	555060	GUARD - SWEAT-HANDLEBAR	1
18	9511	SCREW - HHCS M8X1.25 X 16 ZP	2	70	555061	KNOB - T-BLACK-SQ (SEE NOTE 1)	1
19	9513	SCREW - SHCS M8x1.25 X 12 SS	2	71	555063	FACE - DISPLAY-COMPUTER	1
20	9516	SCREW - BHCS M8x1.25 X 40 SS	2	72	555066	PULLEY - IDLER-MOLDED	1
21	9519	NUT-HAN-HC M8x1.25 SS	2	73	555070	CAP - WHEEL GUARD-TOP	1
22	9524	SCREW - SBHCS M8x1.25 X 16 SS	2	74	555073	CAP - WHEEL GUARD-BOT	1
23	9525	SCREW - HHCS M6X1 X 45 SS	1	75	555370	LABEL - DOME-KEISER	1
24	105423	BUMPER - MOLDED GLIDE	3	76	555371	DECAL - CAUTION-PEDAL TORQUE	1
25	105443	DECAL - SERIAL NUMBER	1	77	555372	DECAL - WARNING - RIDING & SLIDER	1
26	105550	THREAD SEALANT - LOCTITE 242	1	78	555374	DECAL - HANDLEBAR-POSITION	1
27	115036	THREADED INSERT - 5/8 X 3/8 SS	2	79	555402	BEARING - 6004ZZ-SHIELDED	1
28	115054	PLUG - 2 IN SQ-KEISER	4	80	555405	SPRING - TORSION	1
29	505063	PIN - HANDLEBAR-1/4 X 1-3/4	1	81	555406	BELT - POLY V	1
30	505068	BUSHING - 4 PIECE	6	82	555407	WHEEL - 3 IN (SEE NOTE 2)	2
31	505173	STRAP - PEDAL	1	83	555410	PAD - BRAKE-FRICTION	1
32	505444	TOE CLIP & STRAP SET ASSY	1	84	555411	SHIFT CABLE	1
33	505480	RIVET - 1/4 X 3/4 REM PLUG	2	85	555413	CORD - COMP TO PICKUP	1
34	540831	PEDAL SET - COMBO	1	86	555417	SADDLE - GRAY	1
35	543091	HOSE - SPACER-LONG	1	87	555419	SCREW - HSPPSS-M10x1.5 X 16 BLK	2
36	550802	BACK - DISPLAY-COMPUTER (SEE NOTE 3)	1	88	555420	SWEAT STRIP - 5/16 X 3/8	1
37	550807	SA - SEATPOST	1	89	555421	CRANK ARM - L	1
38	550808	SA - HUB-FLYWHEEL	1	90	555428	SCREW - HWHS-M8X1 X 60 CS	2
39	550810	SA - KNOB	2	91	605051	PLUG - GRIP	4
40	550811	SA - PULLEY-330MM DIA	1	92	966502	BATTERY - AA CELL	2
41	550812	SA - MAGNET HOLDER	1	93	995420	BUMPER - MOLDED GLIDE W-SCREW	1
42	550813X	SA - CRANK ARM-R AXLE SET	1	94	550828	SA-HANDLE-L	1
43	550814	SA - FRAME-BASE	1	95	555037	SPACER - 032039109	2
44	550815	SA - HANDLEBAR	1	96	555446	WHEEL - 3 IN-W/BUSHING	2
45	550818X	SA - COVER-LOWER-MF	1	97	9532	SCREW - CRPHMS 4-40 X 16 SS	1
46	550819	SA - MAIN FRAME-PXN	1	98	550802	BACK - DISPLAY COMPUTER	1
47	550820	SA - MAIN FRAME-PXC	1	99	550912	CKT BRD - COMPUTER-BL	1
48	550902	HANDLEBAR - ADJ TUBE	1	100	555079	FACE - DISPLAY-COMPUTER-BL	1
49	550904	CKT BRD - PICKUP	1				
50	550905	CKT BRD - COMPUTER (SEE NOTE 3)	1				
51	553096	TUBE - WHEEL GUARD	1				
52	555000	PLATE - FRICTION	2				

REV E	ECO 3207	MODEL# 5500XXX	TITLE: M3 INDOOR CYCLE
FROM SERIAL NUMBER: 100524-10239 TO 110624-15718		DATE FROM: 5/25/2010 TO 6/24/11	

NOTE 1:
 ITEM 94
 REPLACES ITEMS
 1,9,60 & 70
 FOR FORE AND AFT
 ADJUSTMENT ONLY

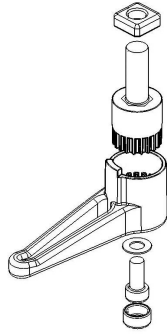

NOTE 2:
 ITEMS 95 & 96
 REPLACE
 ITEM 82.
 REPLACE ITEMS
 10,20 & 21 ALSO

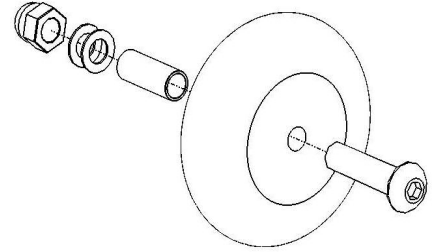

NOTE 3:
 3 OF ITEM 6 AND
 ITEMS 97,98,99 & 100
 REPLACES ITEMS
 36 & 50

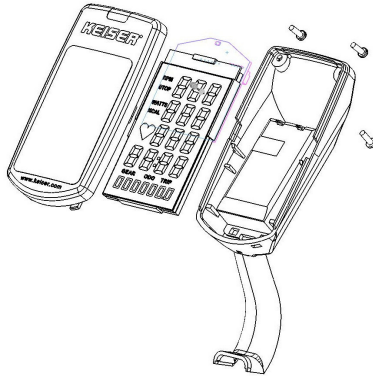

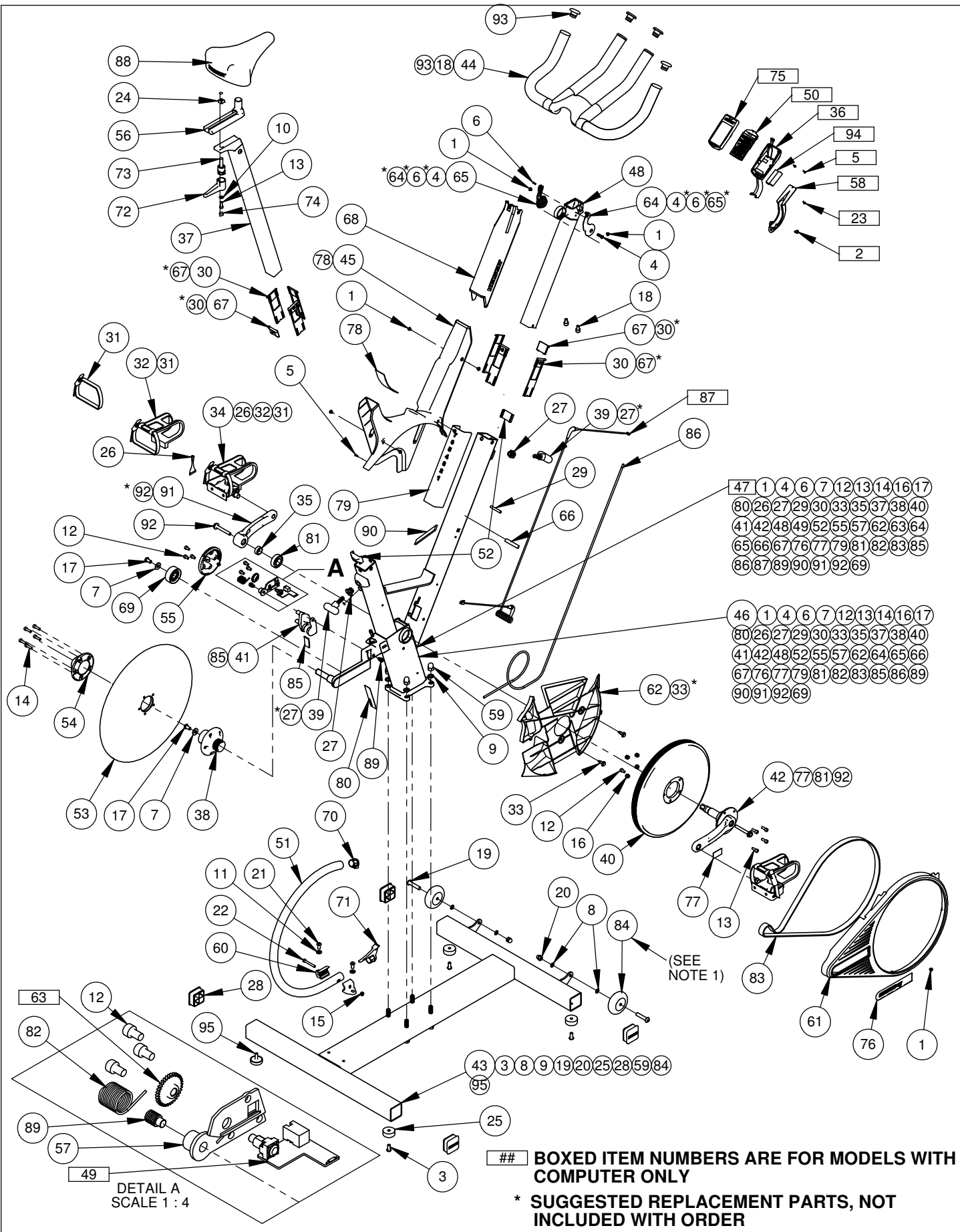

PRINTED ON: 1/16/2013

X:\drawings_REVISION\55_EC_RWD_BIKE\55500XXX

SHEET 1 OF 1	REV E	ECO 3207	MODEL #: 5500XXX	TITLE: M3 INDOOR CYCLE
FROM SERIAL NUMBER: 110624-15719	TO: 120126-02713	DATE FROM: 6/24/11	TO: 1/26/12	

Item No	Part No	Description	Qty	Item No	Part No	Description	Qty
1	9253	SCREW - CRPHMS #10-32 X 3/16 SS	9	53	555003	FLYWHEEL	1
2	9261	SCREW - CRPHMS 10-32 X 3/8 SS	1	54	555005	HUBCAP - FLYWHEEL	1
3	9279	SCREW - SBHTS-TF 5/16-18 X 3/4 ZP	3	55	555008	MAGNET COVER	1
4	9287	SCREW - CRPHTS 10-24 X 3/4 SS	1	56	555009	SLIDER - SEAT	1
5	9303	SCREW - CRPHTCS-T25 4 X 3/8 SS	3	57	555011	PLATE - MAGNET SUPPORT	1
6	9304	SCREW - CRFCS-PLASTITE 4-20 X 3/8 SS	1	58	555017	MOUNT - DISPLAY-COMPUTER	1
7	9344	WASHER - FW-USS 5/16 ZP	2	59	555022	NUT - HAN-HC-7/16-20 SS	4
8	9369	WASHER - ACFT 5/16 SS	4	60	555025	CLAMP - WHEEL GUARD	2
9	9384	WASHER - FW-ACFT 7/16 SS	4	61	555051	COVER - BELT-MAIN	1
10	9391	WASHER - FW-ACFT 1/4 SS	1	62	555052	COVER - BELT-INNER	1
11	9397	WASHER - BONDED 5/16 SS	2	63	555053	GEAR - POT	1
12	9500	SCREW - SHCS M6x1 X 10 SS	7	64	555054	SHIFTER - R (RED ONLY)	1
13	9501	SCREW - SHCS M6x1 X 16 SS	5	65	555055	SHIFTER - L (RED ONLY)	1
14	9502	SCREW - SHCS M6x1 X 20 SS	5	66	555056	PIN - MF-5/16 SQ X 2 1/8	1
15	9508	NUT - HN M6X1 SS	1	67	555058	BUSHING - SHORT	2
16	9509	NUT - HELN M6X1 ZP	4	68	555060	GUARD - SWEAT-HANDLEBAR	1
17	9511	SCREW - HHCS M8X1.25 X 16 ZP	2	69	555066	PULLEY - IDLER-MOLDED	1
18	9513	SCREW - SHCS M8x1.25 X 12 SS	2	70	555070	CAP - WHEEL GUARD-TOP	1
19	9516	SCREW - SBHCS M8x1.25 X 45 SS	2	71	555073	CAP - WHEEL GUARD-BOT	1
20	9519	NUT-HAN-HC M8x1.25 SS	2	72	555074	HANDLE - L-BLACK	1
21	9524	SCREW - SBHCS M8x1.25 X 16 SS	2	73	555075	HANDLE - STUD-BLACK	1
22	9525	SCREW - HHCS M6X1 X 45 SS	1	74	555076	CAP - M6 SHCS-BLACK	1
23	9532	SCREW-CRPHMS 4-40 X 3/8 SS	1	75	555079	FACE - DISPLAY-COMPUTER-BL	1
24	9982	NUT-HEAVY SQ. 3/8-16 SS	1	76	555370	LABEL - DOME-KEISER	1
25	105423	BUMPER - MOLDED GLIDE	3	77	555371	DECAL - CAUTION-PEDAL TORQUE	1
26	105550	THREAD SEALANT - LOCTITE 242	1	78	555372	DECAL - WARNING - RIDING & SLIDER	1
27	115036	THREADED INSERT - 5/8 X 3/8 SS	2	79	555374	DECAL - HANDLEBAR-POSITION	1
28	115054	PLUG - 2 IN SQ-KEISER	4	80	555381	DECAL - SERIAL NUMBER - M3	1
29	505063	PIN - HANDLEBAR-1/4 X 1-3/4	1	81	555402	BEARING - 6004ZZ-SHIELDED	1
30	505068	BUSHING - 4 PIECE	6	82	555405	SPRING - TORSION	1
31	505173	STRAP - PEDAL	1	83	555406	BELT - POLY V	1
32	505444	TOE CLIP & STRAP SET ASSY	1	84	555407	WHEEL - 3 IN (SEE NOTE 1)	2
33	505480	RIVET - 1/4 X 3/4 REM PLUG	2	85	555410	PAD - BRAKE-FRICTION	1
34	540831	PEDAL SET - COMBO	1	86	555411	SHIFT CABLE	1
35	543091	HOSE - SPACER-LONG	1	87	555413	CORD - COMP TO PICKUP	1
36	550802	BACK - DISPLAY-COMPUTER	1	88	555417	SADDLE - GRAY	1
37	550807	SA - SEATPOST	1	89	555419	SCREW - HSPPSS-M10x1.5 X 16 BLK	2
38	550808	SA - HUB-FLYWHEEL	1	90	555420	SWEAT STRIP - 5/16 X 3/8	1
39	550810	SA - KNOB	2	91	555421	CRANK ARM - L	1
40	550811	SA - PULLEY-330MM DIA	1	92	555428	SCREW - HWHS-M8X1 X 60 CS	2
41	550812	SA - MAGNET HOLDER	1	93	605051	PLUG - GRIP	4
42	550813	SA - CRANK ARM-RIGHT	1	94	966502	BATTERY - AA CELL	2
43	550814	SA - FRAME-BASE	1	95	995420	BUMPER - MOLDED GLIDE W-SCREW	1
44	550815	SA - HANDLEBAR	1	96	555446	WHEEL - 3 IN-W/BUSHING	2
45	550818X	SA - COVER-LOWER-MF	1	97	555037	SPACER - 032039114	2
46	550819	SA - MAIN FRAME-PXN	1				
47	550820	SA - MAIN FRAME-PXC	1				
48	550902	HANDLEBAR - ADJ TUBE	1				
49	550904	CKT BRD - PICKUP	1				
50	550912	CKT BRD - COMPUTER-BL	1				
51	553096	TUBE - WHEEL GUARD	1				
52	555000	PLATE - FRICTION	2				

REV E	ECO 3207	MODEL#	5500XXX	TITLE:	M3 INDOOR CYCLE	
FROM SERIAL NUMBER:				110624-15719 TO 120126-02713	DATE FROM:	6/24/11 TO 1/26/12

NOTE 1:
ITEMS 96 & 97
REPLACE
ITEM 84.
REPLACE
ITEMS 8,19 & 20
ALSO

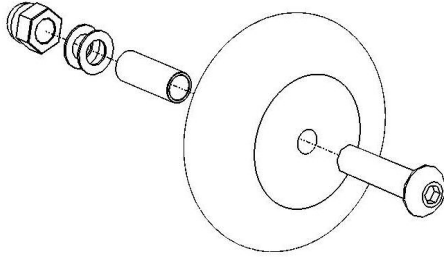

REV E	ECO 3207	MODEL#	5500XXX	TITLE:	M3 INDOOR CYCLE
FROM SERIAL NUMBER:			110624-15719 TO 120126-02713	DATE FROM:	6/24/11 TO 1/26/12