

Broadcast Vision Upgrade Kit 625A

Kit Number 626AK012

Installation Instructions

This instruction sheet describes how to install the Broadcast Vision kit for Cybex Arc models 626A and 626AT.

Tools Required:

- Phillips screwdriver
- Utility knife
- ESD (Electrostatic Discharge) grounding strap
- Headphones (not included)
- 5/32" Allen wrench
- Block, 4" (10 cm)

 Read and understand all instructions thoroughly before installing this kit.

Verify the kit contents shown.

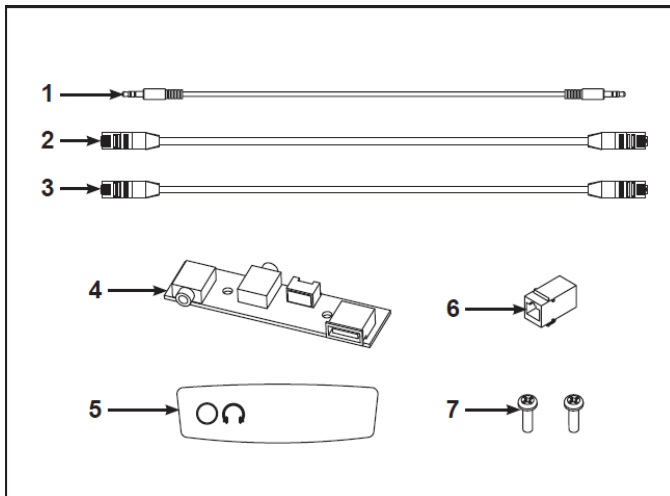

	Description	Qty.
1	Cable, Headphone jack jumper, 770A-357	1
2	Cable, CAT6 4 ft., OAW-24516	1
3	Cable, CAT6 14 ft., OAW-24521	1
4	PCA, Handset audio jack, 770A-247	1
5	Headphone jack decal, 770A-381	1
6	Coupler, OCN-22747	2
7	Screw, 4 x 3/8", HT042510	2

Disconnect power source

Unplug the power cord from the power outlet.

WARNING

Shock and electrocution hazard.

- Unplug unit and let sit 10 minutes before cleaning or performing maintenance.
- Electrical charge can remain in unit after unplugging.
- Keep water and liquids away from electrical parts.

NOTICE

Component damage. Wear an ESD grounding strap during this procedure. Connect ESD grounding strap to frame bolts or unpainted metal of frame. If ESD grounding strap is not available, touch frame bolts or unpainted metal of frame before handling any electronics.

Remove back cover

Remove the four screws securing the back cover to the console assembly using a Phillips screwdriver.

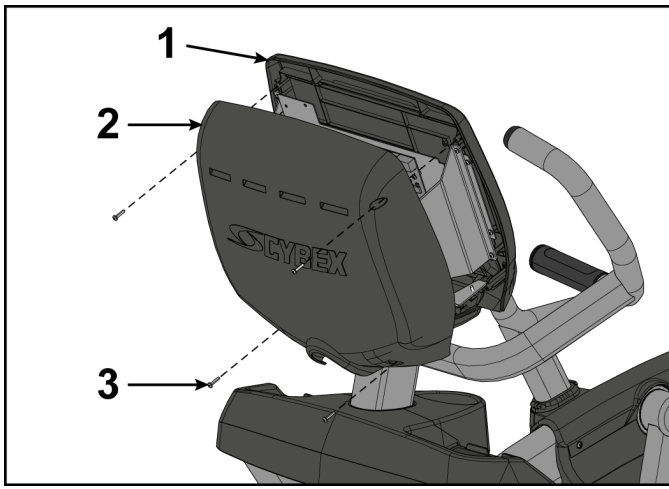

	Description	Qty.
1	Console assembly	1
2	Back cover	1
3	Screws	4

Remove console assembly

Remove the six screws securing the console assembly to the console support using a Phillips screwdriver.

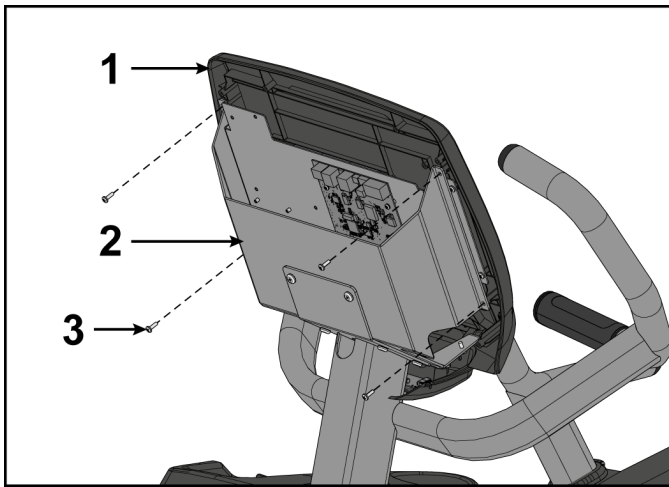

	Description	Qty.
1	Console assembly	1
2	Console support	1
3	Screws	6

Disconnect console cables

1. Disconnect console cables from MCC board.

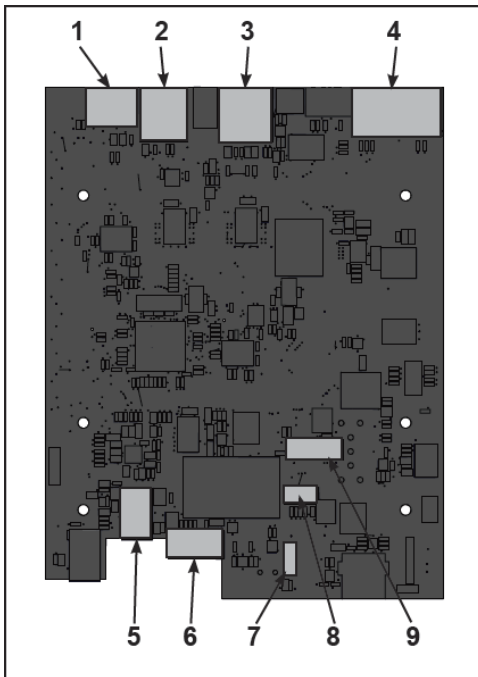

	Description	Qty.
1	MYE/BV, Gray	1
2	CSAFE, Red	1
3	Console cable	1
4	Upper display	1
5	Headphone jack	1
6	iPod (optional)	1
7	Heart rate	1
8	Handset membrane	1
9	iPod board assembly (optional)	1

MCC board cables

2. Unplug cables from MCC board by un-latching connectors with the following procedure:
 - a) Press in the top of the cable connector.

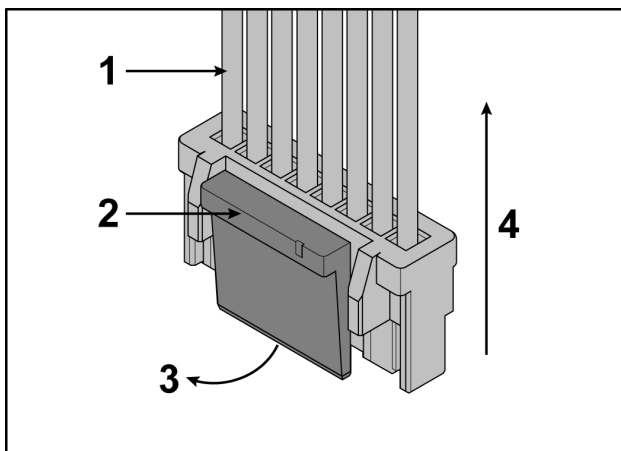

	Description	Qty.
1	DO NOT PULL CONNECTOR OUT BY THE WIRES!	1
2	Step a, Latch	1
3	Step b	1
4	Step c	1

- b) Ensure latch disengages the connector.
- c) Unplug cable by holding down latch and pulling straight out from connector. Do not pull on wires, remove by connector.

3. Unplug optional iPod cable.
The iPod cable is held in place by a notch in the access cover.

a) Press in both side latches of cable connector.

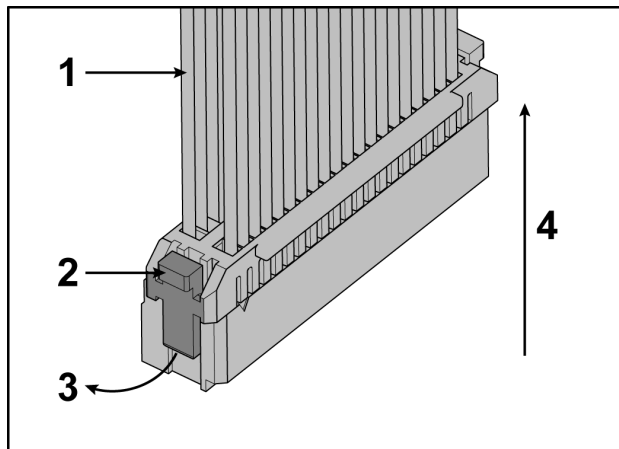

- b) Ensure latches disengage from the connector.
c) Unplug cable by holding down latches on both sides and pulling straight out from connector.
Do not pull on wires, remove by connector.

Install headphone jack board

1. Remove the blank decal from the headphone jack cover using a utility knife.

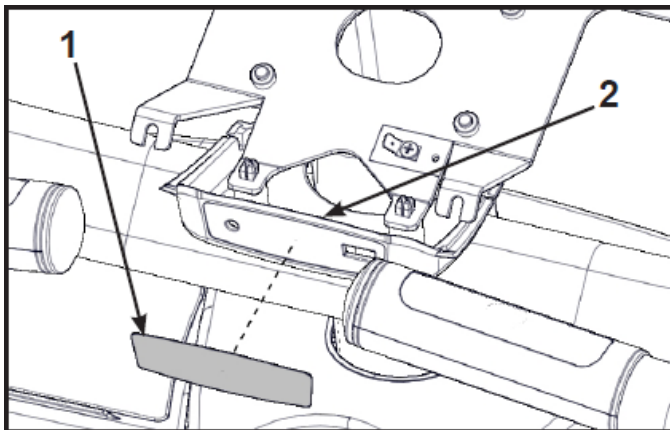

	Description	Qty.
1	Blank decal	1
2	Headphone jack cover	1

- Install the two 4 x 3/8" screws securing the headphone jack board to the headphone jack cover using a Phillips screwdriver.

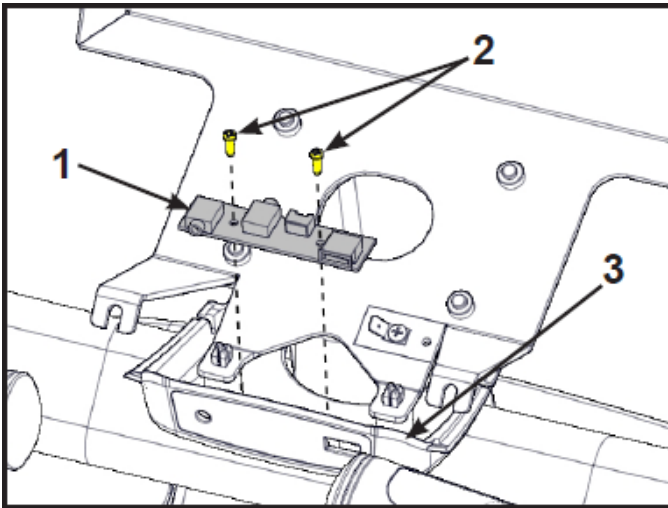

	Description	Qty.
1	Headphone jack board	1
2	Screws, 4 x 3/8"	2
3	Headphone jack cover	1

- Install the headphone jack decal to the headphone jack cover.

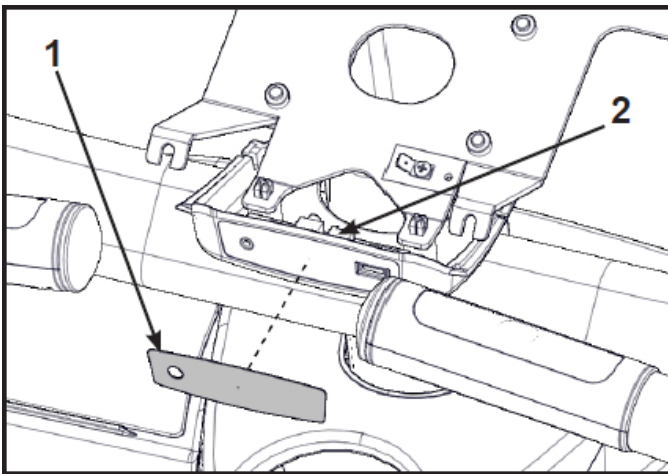

	Description	Qty.
1	Headphone jack decal	1
2	Headphone jack cover	1

- Plug the headphone jack cable into the headphone jack board.

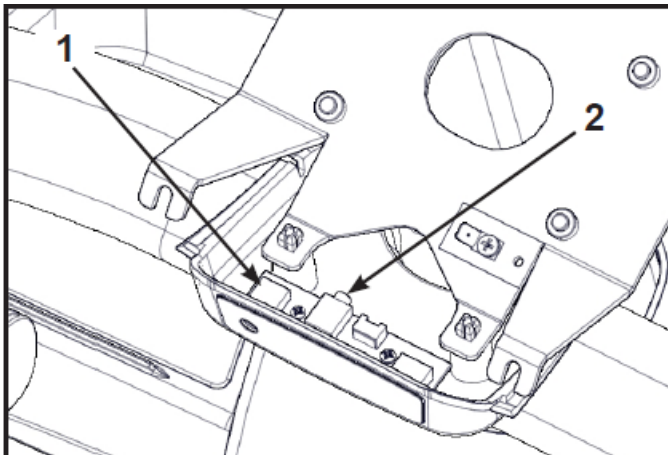

	Description	Qty.
1	Headphone jack board	1
2	Plug cable in here	1

Connect console cables

1. Install console cables to MCC board.

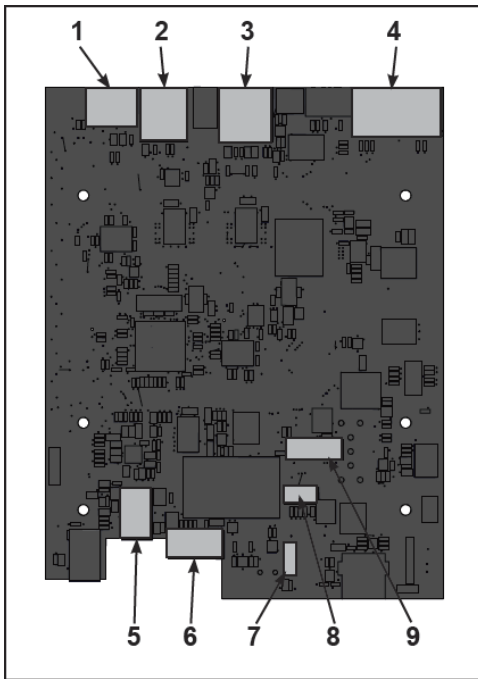

	Description	Qty.
1	MYE/BV, Gray	1
2	CSAFE, Red	1
3	Console cable	1
4	Upper display	1
5	Headphone jack	1
6	iPod (optional)	1
7	Heart rate	1
8	Handset membrane	1
9	iPod board assembly (optional)	1

MCC board cables

2. Plug 4 foot Cat6 cable into gray connector (1) and route through console assembly.
3. Plug headphone jack jumper into headphone jack (5).

Install console assembly

Install the six screws securing the console assembly to the console support using a Phillips screwdriver.

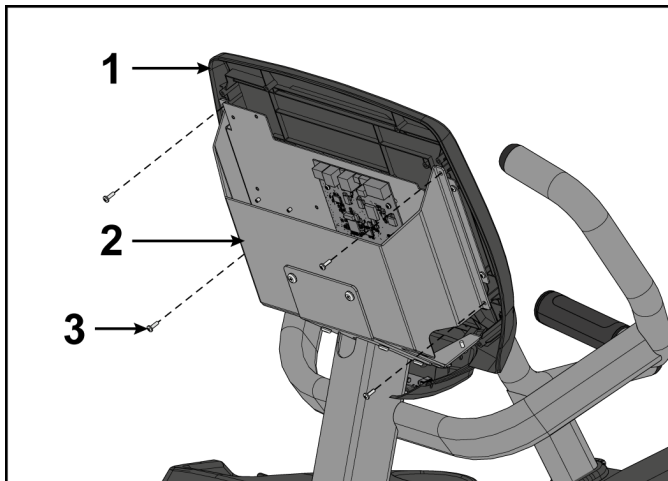

	Description	Qty.
1	Console assembly	1
2	Console support	1
3	Screws	6

Remove tray assembly

1. Remove three screws securing accessory tray bottom to the accessory tray base using a Phillips screwdriver.

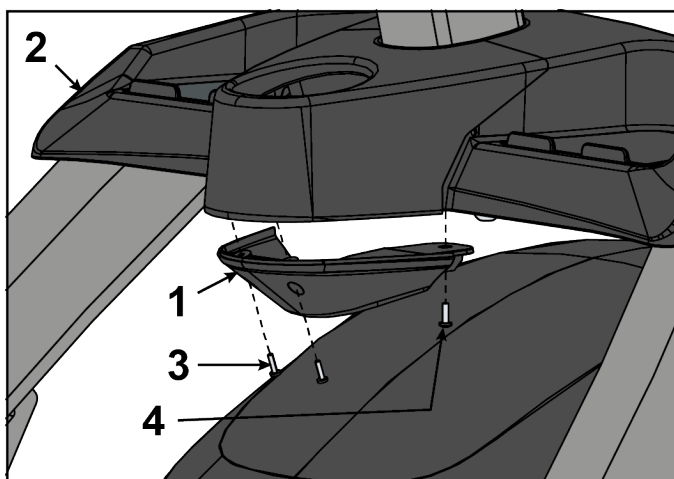

	Description	Qty
1	Accessory tray bottom	1
2	Accessory tray base	1
3	Screw, #6 x 0.50"	2
4	Screw, 8-16 x 0.50"	1

2. Remove two screws securing accessory tray top to accessory tray base using a Phillips screwdriver.

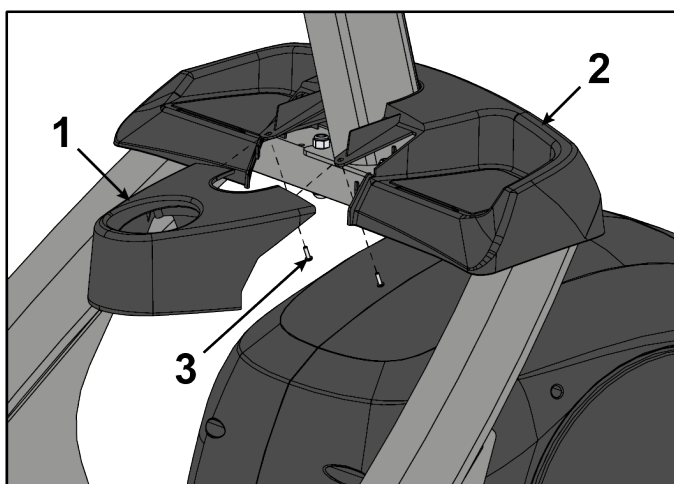

	Description	Qty
1	Accessory tray top	1
2	Accessory tray base	1
3	Screw, 8-16 x 0.50"	2

3. Remove four screws securing accessory tray base to frame using a Phillips screwdriver.

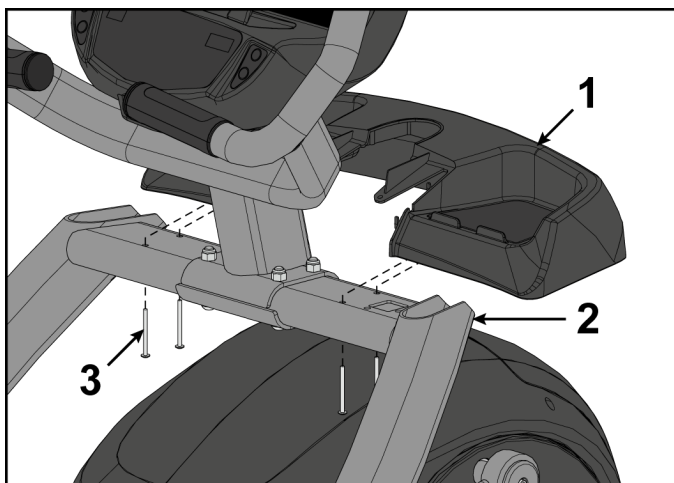

	Description	Qty
1	Accessory tray base	1
2	Frame	1
3	Screws	4

Remove right wheel

1. Place a 4" (10 cm) block under unit to elevate right wheel.

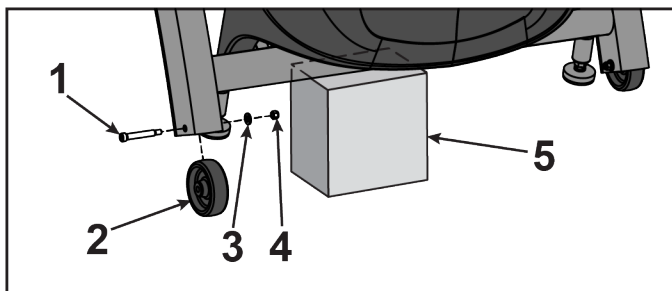

	Description	Qty.
1	Bolt	1
2	Wheel	1
3	Lockwasher	1
4	Nut	1
5	Block	1

2. Remove bolt, lockwasher, and nut securing right wheel using a 7/16" wrench and a 5/32" Allen wrench.

Route Broadcast Vision cables

1. Route 4 foot CAT6 cable through the bottom of console weldment and connect to coupler.

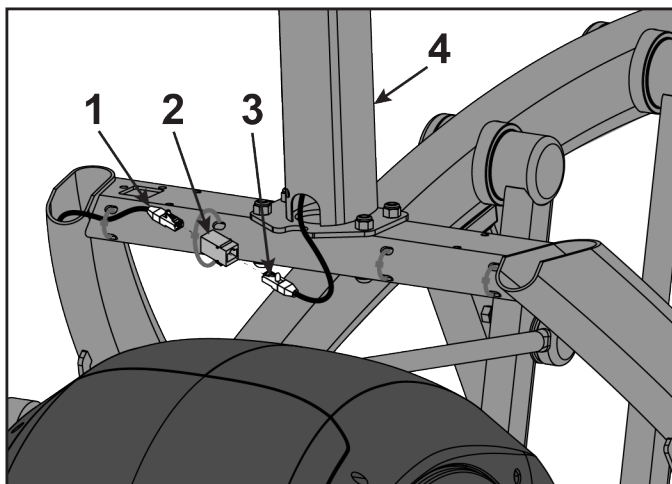

	Description	Qty.
1	Cable, CAT6 14 ft.	1
2	Coupler	1
3	Cable, CAT6 4 ft.	1
4	Weldment	1

2. Connect 14 foot CAT6 cable to coupler.
3. Feed 14 foot CAT6 cable down through the bottom of the frame (where the wheel was removed).

4. Route 14 foot CAT6 cable back up through the bottom of the frame and out the access hole.

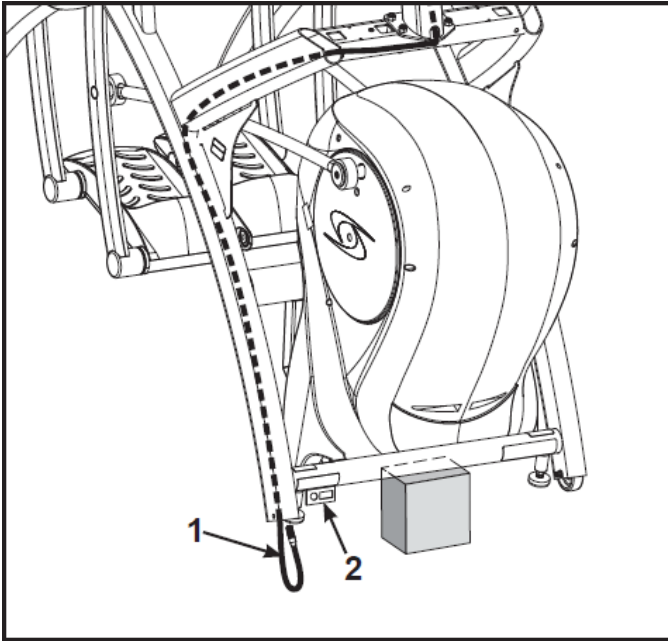

	Description	Qty.
1	Cable, CAT6 14 foot	1
2	Mounting plate	1

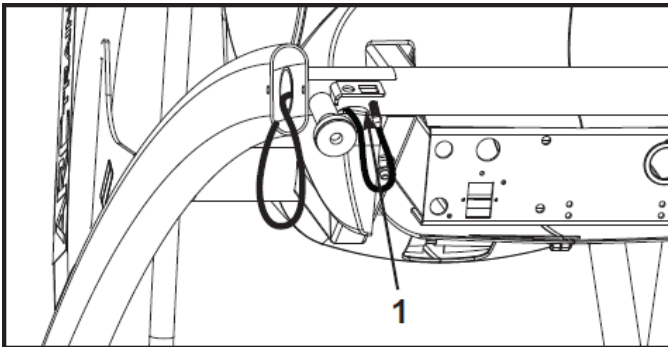

	Description	Qty.
1	Access hole	1

5. Insert the Cat6 coupler into the mounting plate by hooking the upper tab into the mounting plate and snapping in the lower tab.

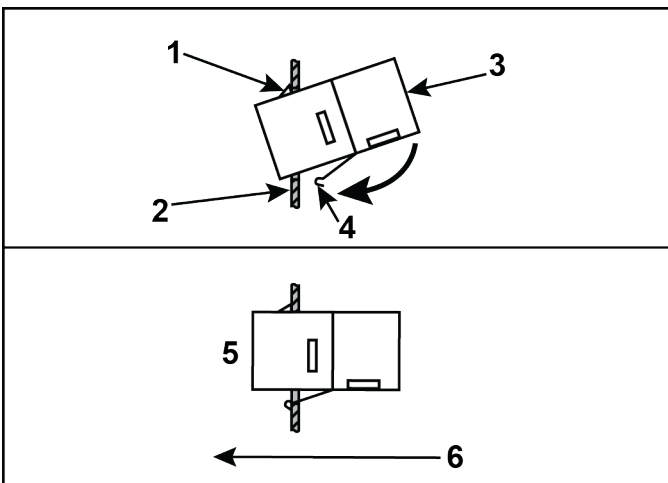

	Description	Qty.
1	Upper tab	1
2	Mounting plate	1
3	Cat6 coupler	1
4	Lower tab	1
5	Installed	1
6	Front of unit	1

6. Plug 14 foot CAT6 cable into coupler.

Install right wheel

1. Install wheel, bolt, lockwasher, and nut securing right wheel using a 7/16" wrench and a 5/32" Allen wrench.

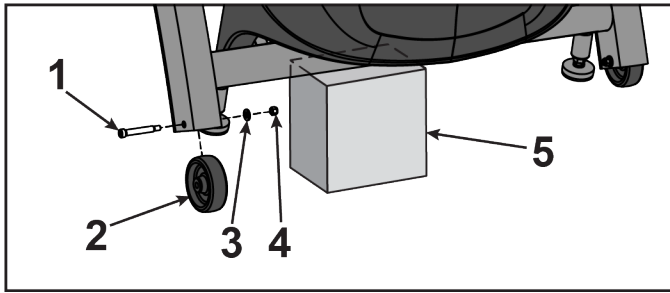

	Description	Qty.
1	Bolt	1
2	Wheel	1
3	Lockwasher	1
4	Nut	1
5	Block	1

2. Remove block.

Install tray assembly

1. Install four screws securing accessory tray base to frame using a Phillips screwdriver.

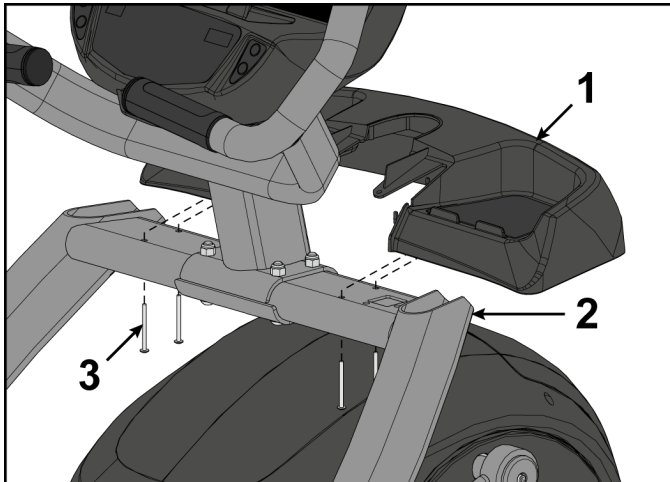

	Description	Qty
1	Accessory tray base	1
2	Frame	1
3	Screws	4

2. Install two screws securing accessory tray top to accessory tray base using a Phillips screwdriver.

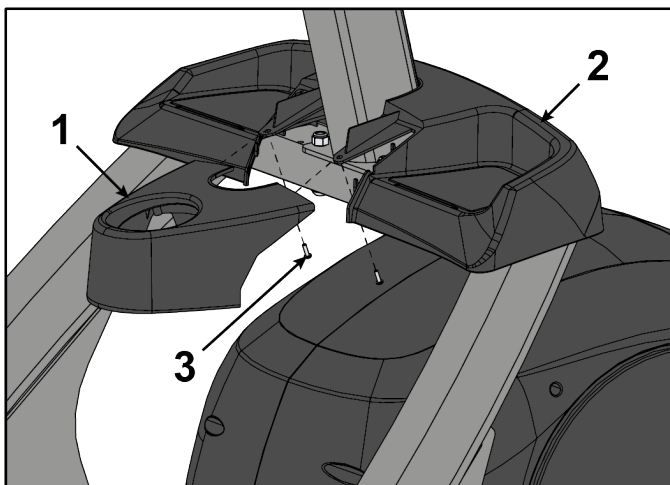

	Description	Qty
1	Accessory tray top	1
2	Accessory tray base	1
3	Screw, 8-16 x 0.50"	2

3. Install three screws securing accessory tray bottom to the accessory tray base using a Phillips screwdriver.

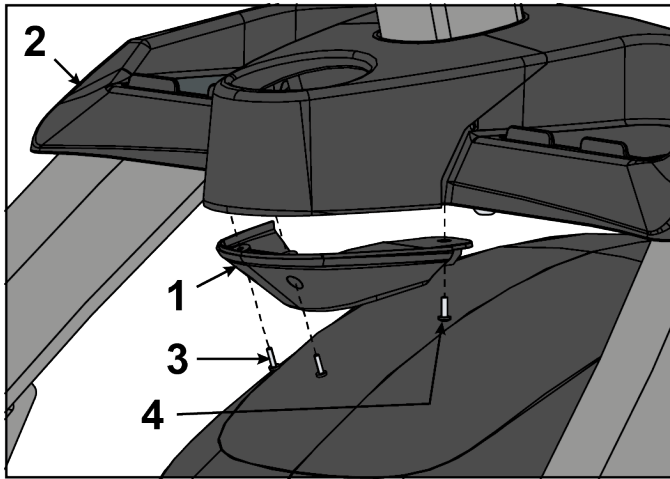

	Description	Qty
1	Accessory tray bottom	1
2	Accessory tray base	1
3	Screw, #6 x 0.50"	2
4	Screw, 8-16 x 0.50"	1

Install back cover

Install the four screws securing the back cover to the console assembly using a Phillips screwdriver.

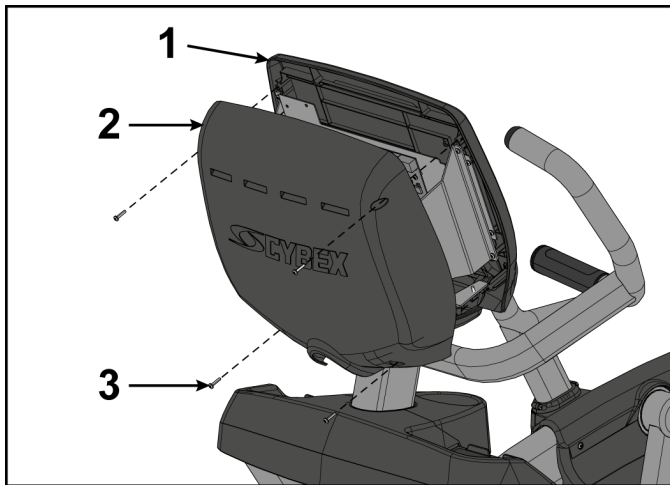

	Description	Qty.
1	Console assembly	1
2	Back cover	1
3	Screws	4

Connect Broadcast Vision to Cybex product

1. Plug the short cable (TV side) of the C.A.B. (Console Adapter Box) or C-tv (Connected TV) into the Broadcast Vision TV.

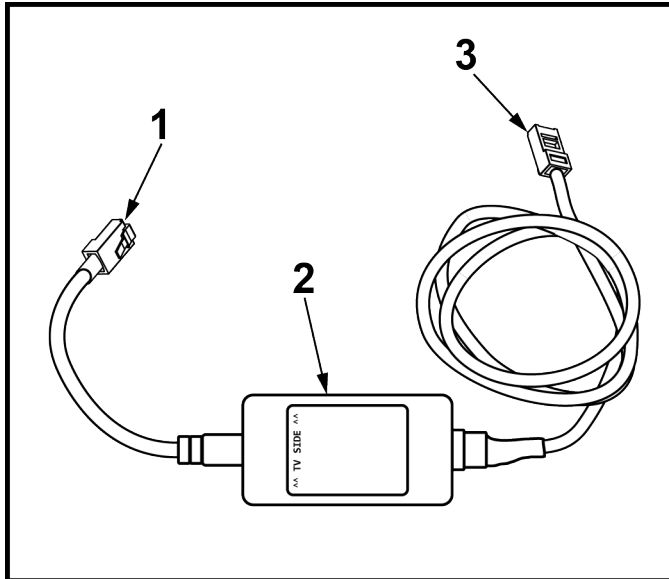





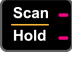

	Description	Qty.
1	Short cable, TV side	1
2	C.A.B. Console Adapter Box or C-tv (Connected TV)	1
3	Long cable, Cybex product side	1

2. Plug the long cable of the C.A.B. (Console Adapter Box) or C-tv (Connected TV) into the coupler at the base of the Cybex product.

C.A.B. (Console Adapter Box) or C-tv (Connected TV) setup option

For self powered units; plug in AC adapter or have another user pedal the unit for the entire procedure.

1. Plug the power cord into the power outlet. (Treadmills and powered units).
2. Turn the main power switch to the on (I) position. (Treadmills and powered units).
The control panel will light up.
3. Press any key to access the Opening Screen.
4. Press and hold the **Scan/Hold**  or **Display option**  and **UP**  keys for 3 seconds.
5. Navigate through the setup menu with the **UP**  and **DOWN**  keys.
6. Navigate to the A/V option.
7. Press the **ENTER**  key once to enter setup values.
8. Select **C.A.B.** (Console Adapter Box) or **C-tv** (Connected TV) from the A/V options.
9. Press the **ENTER**  key again to save any changes and advance forward in the menu.
10. Press the **STOP** key to exit Setup options.

Complete installation

1. Plug the optional power cord into the power inlet.
2. Begin striding the unit until the console lights up.

3. Operate the unit at all levels to verify proper operation.

Cybox® and the Cybox logo are registered trademarks of Cybox International, Inc.
10 Trotter Drive, Medway, MA 02053 • 508-533-4300 • FAX 508-533-5183
© Copyright 2017, Cybox International, Inc. • www.cyboxintl.com • 626A-331 B • March 2017

