

MAIN BODY

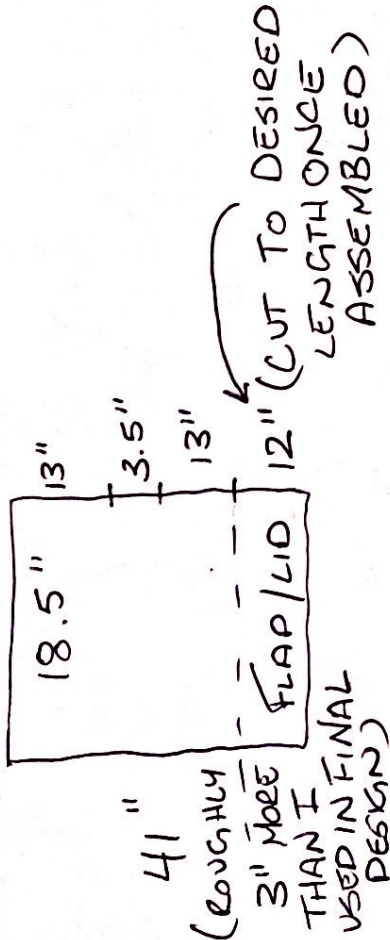

FRONT POCKETS (x2)

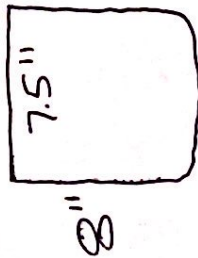

GUSSETS (x2)

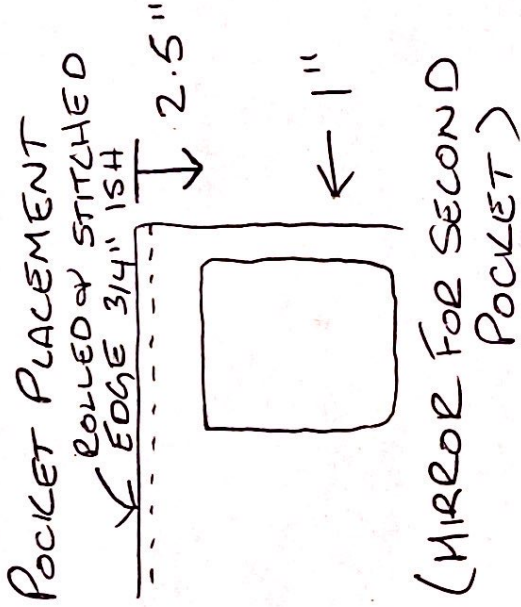
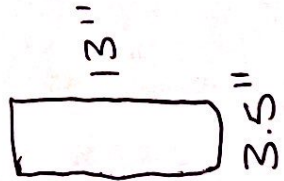

GUSSET D-RING PLACEMENT

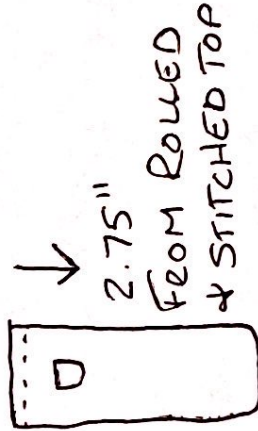

BUCKLE STRAP AROUND BAG (CUT 38.5" LONG X 1" WIDE) (2" FOR BUCKLE END)



STRAP PLACEMENT

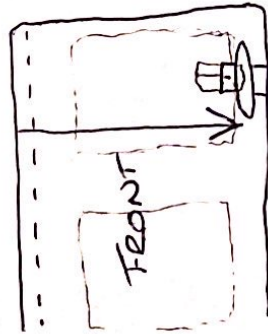
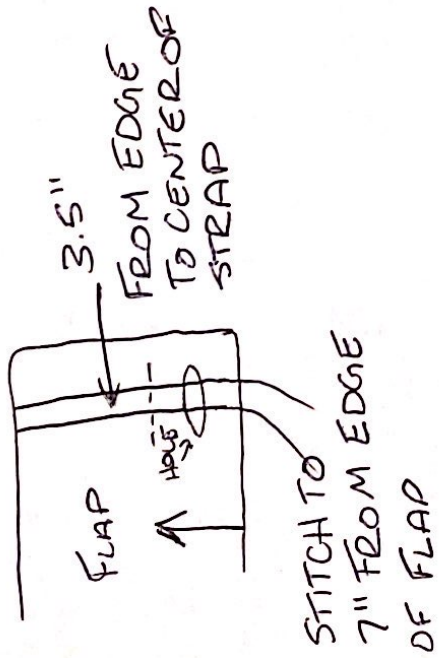

STOP STITCH  
12 1/4" FROM  
TOP DOWN

(FROM STITCH 4"  
UP SHOULD BE  
BOTTOM OF  
BUCKLE)

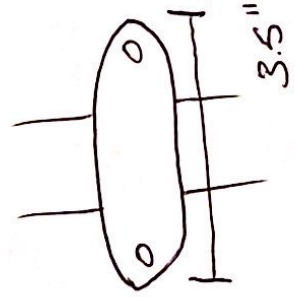

OBLONG HOLE PUNCHED  
1.5" UP FROM BOTTOM  
OF FLAP

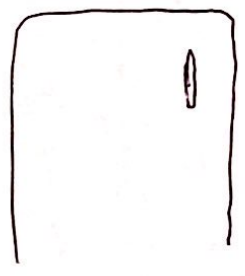

(DO THIS LAST AS YOU MAY  
DECIDE TO TRIM LID  
SHORTER FOR FINAL  
LOOK)

HANDLE

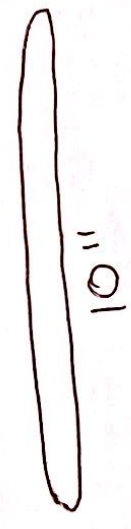

I PERSONALLY MOUNT HANDLES  
LAST BECAUSE I DESIGN FROM  
SCRATCH & DO NOT KNOW FINAL  
PLACEMENT.

CUSTOMIZE ANYTHING  
or  
ENJOY IAN G.