

INSTRUCTIONS FOR USE

178 **G** 1030

⚠ WARNING

Read and understand these Instructions for Use and all safety precautions it contains. Improper use can cause serious or fatal injury and/or illness.

CAUTION—US Federal law restricts this device to sale by or on order of a physician.



eRapid™
nebulizer system



PARI Pharma
Advancing Aerosol Therapies



REGISTER FIRST

WARRANTY ACTIVATION REQUIRED

Three different options to choose from.

 www.pari.com/register

 1.866.335.6943

 Registration card enclosed

ETL CLASSIFIED



Intertek
3045080

Conforms to UL 60601-1
Certified to CAN/CSA C22.2 No. 601.1

A Introduction 3

B Safety Precautions And Important Safeguards 4-5

C Getting Started 6

D Using “AA” Batteries 7

E Using AC Power Supply 7

F eRapid Nebulizer Handset Assembly 8-9

G Taking A Treatment 10-11

H eRapid Nebulizer Handset Cleaning 12-13

I Using the Optional EASYCARE 14

J eRapid Nebulizer Handset Disinfection 14

K Functionality Test 15

L Frequently Asked Questions And Troubleshooting 15

M Specifications 16

These Instructions For Use contain information and safety precautions for the eRapid™ Nebulizer System. Save these Instructions For Use for future reference.

Before using your eRapid Nebulizer System, you should read and understand the entire Instructions For Use. If for any reason you do not understand any part of these Instructions For Use, please call the toll free number below before proceeding with your treatment.

Take special note of all safety precautions marked DANGER and WARNING.

INDICATIONS FOR USE: ERAPID NEBULIZER SYSTEM

The eRapid Nebulizer System is to be used with patients for whom doctors have prescribed medication for nebulization. It is intended for adult and pediatric patients, and may be used in hospitals, hospital-type facilities, nursing homes, sub-acute institutions and home environments.

READ ALL DANGERS AND WARNINGS BEFORE USING**⚠ DANGER**

To reduce the risk of serious or fatal injury from electrocution:

1. DO NOT place or store the eRapid Nebulizer System where it can be in water or fall into a bathtub, sink, or other liquid. Do not place or drop into water or other liquid. Do not use while bathing.
2. DO NOT reach for the eRapid Nebulizer System if it has fallen into water or other liquid. Unplug immediately. Retrieve the eRapid Nebulizer System ONLY after it has been unplugged.

⚠ WARNING

1. The eRapid Nebulizer Handset is for single patient use. DO NOT SHARE your handset with any other people.
2. Read, understand and follow all warnings and instructions in the Instructions For Use prior to using this device.
3. To reduce the risk of serious or fatal injury from electrocution, fire, burns and to reduce the risk of damage and malfunction of the unit:
 - a. DO NOT overload wall outlets or use extension cords.
 - b. Keep all electrical cords away from heated surfaces.
 - c. DO NOT spray liquids onto the housing of the Controller. (See Section C: Getting Started) Liquid may cause damage to the electrical parts and could lead to a malfunction. In the event that liquids enter the Controller, call the number below.
 - d. DO NOT drop or insert any object into any opening on the eRapid Nebulizer System.
 - e. DO NOT operate where oxygen is being administered in a closed environment such as an oxygen tent.

4. Always unplug this product immediately after using and before cleaning.
5. Before use, check your eRapid Nebulizer System or eRapid Nebulizer Handset for proper assembly. All parts must be connected and firmly in place. Use of an improperly assembled eRapid could diminish or eliminate the effectiveness of the treatment.
6. Use ONLY adapters and accessories that are authorized for the eRapid Nebulizer System. Use of unapproved adapters and accessories can lead to improper treatment, injury, or damage to the Controller.
7. The eRapid Handset has unique performance characteristics and should NEVER be substituted for other eFlow Technology Handsets (e.g. Altera®, TRIO®, Investigational eFlow®).
8. NEVER use the eRapid Aerosol Head with any other eFlow Technology Handset (e.g. Altera, TRIO, Investigational eFlow). The eRapid Aerosol Head has its own, unique performance characteristics.
9. NEVER operate the Controller if it is improperly or incompletely assembled or damaged. Section G: Taking A Treatment, shows the alerts to these situations when the eRapid Nebulizer System is improperly assembled, or might be damaged.
10. NEVER operate this product if:
 - a. it has damaged cords or plugs,
 - b. it is not working properly,
 - c. it has been dropped or damaged, or
 - d. it has been exposed to any liquids inside the Controller.

Continued on page 5

⚠ WARNING

11. To reduce the risk of infection, illness, and/or injury from contamination, clean and dry all parts of the eRapid Nebulizer Handset after each treatment. Follow the instructions in Section H to clean the eRapid Nebulizer Handset properly.
12. Cleaning the eRapid Nebulizer Handset properly will help prevent the Aerosol Head from clogging. If the Aerosol Head becomes clogged, the aerosol mist will be reduced or stopped, which may make the treatment ineffective. If clogging occurs, use the instructions in Section H to clean the Aerosol Head.
13. Cleaning the eRapid Nebulizer Handset only removes the medication. To reduce the risk of serious or fatal illness caused by contamination of the eRapid Nebulizer Handset, **YOU MUST ALSO DISINFECT THE eRapid NEBULIZER HANDSET AT THE END OF EVERY TREATMENT DAY.** See Section J for disinfection instructions.
14. This product contains small parts that may present a choking hazard to small children. The eRapid Nebulizer Connection Cord also presents a strangulation hazard.
15. **DO NOT LEAVE CHILDREN UNATTENDED DURING TREATMENT. ALWAYS USE CLOSE ADULT SUPERVISION WHEN ADMINISTERING A TREATMENT TO A CHILD.**
16. Keep the eRapid Nebulizer Handset level when in use. If the handset is tilted, the dosage may not be accurate.
17. Close supervision is necessary when this product is used by or near children or the physically or mentally impaired.
18. **DO NOT** use your eRapid Nebulizer System while driving or in any situation which takes away your full attention.
19. If the eRapid Nebulizer System has been damaged or is not operating properly, call the number below for details. If you suspect that the eRapid Nebulizer System has been damaged or is not working correctly, run the Functionality Test described in Section K.
20. **DO NOT** disassemble the Controller at anytime. There are no user serviceable parts inside the Controller. Call the number below for all service needs.

Check your eRapid Nebulizer System package to ensure you have the following items. Note that two complete Nebulizer Handsets are included.

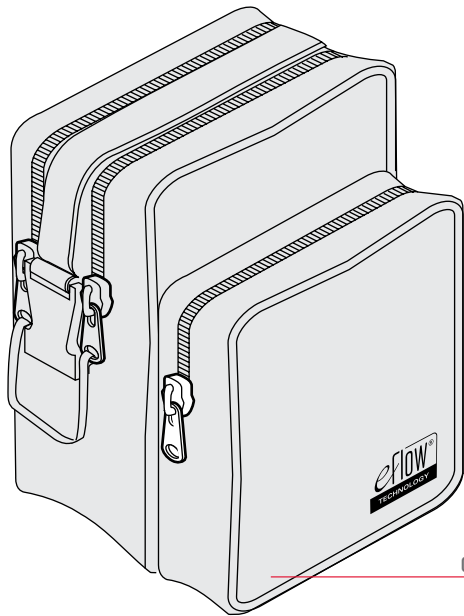

CARRYING CASE

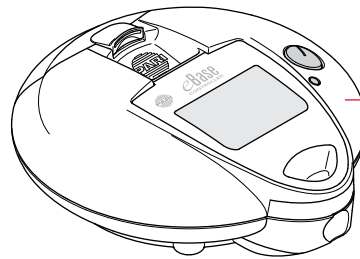

EBASE CONTROLLER

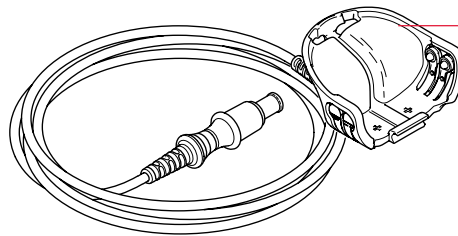

NEBULIZER CONNECTION CORD

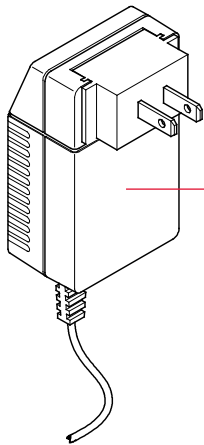

AC POWER SUPPLY

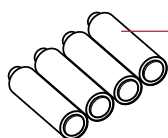

FOUR "AA" BATTERIES

MEDICATION CAP

(NOTE: THE CAP SEAL AND CAP WILL COME AS ONE ASSEMBLED PART)

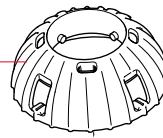

CAP SEAL



MEDICATION RESERVOIR

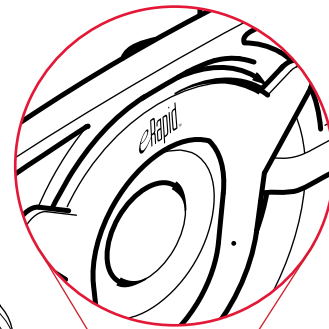
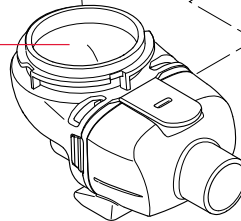

AEROSOL HEAD

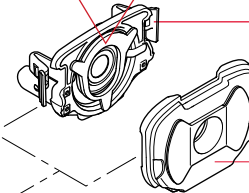

INHALATION VALVE

AEROSOL CHAMBER

MOUTHPIECE WITH EXHALATION VALVE

D USING "AA" BATTERIES

1. The eRapid Nebulizer System is designed to be used with "AA" batteries or with the optional AC Power Supply. Four (4) new "AA" batteries will provide approximately 90 minutes of continuous treatment. You may also use "AA" rechargeable batteries. Please see "Specifications" on the back cover of these Instructions For Use.

NOTE: IT IS STRONGLY RECOMMENDED TO HAVE AN EXTRA BATTERY SET WITH YOU AT ALL TIMES.

2. Open the Battery Door on the Controller by placing your thumb on the tab of the Battery Door and firmly pushing the tab to open the door (Figure 1).

NOTE: The Battery Door is designed to have a tight fit. Questions? Please call the number below.

3. Load the batteries.
4. Each battery chamber has a small figure that shows the proper position of each battery (Figure 2). Using the battery "tips" as guides and starting left-to-right, insert the batteries: Tip Out, Tip In, Tip Out, Tip In.
5. To close the Battery Door, push it closed until you hear it "click" into place. NOTE: Rechargeable and Disposable Batteries vary considerably in terms of storage life and output. An operating life of 90 minutes of use is based on disposable batteries that meet the specifications listed in "Specifications" on the back cover of these Instructions For Use.

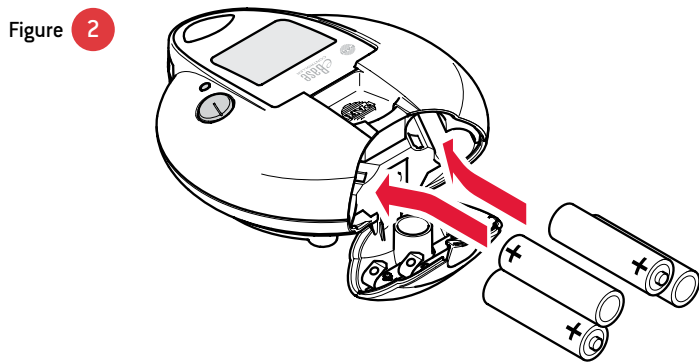
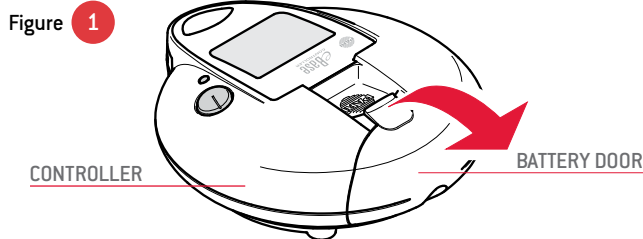

NOTE: Prior to storing the device over an extended period of time (e.g., over 30 days) we recommend you remove the four batteries from the Controller. Doing so saves the batteries and reduces the risk of battery leakage.

E USING AC POWER SUPPLY

1. The Controller can also be used with the AC Power Supply. The AC Power Supply is useful as a back-up power supply when the batteries are depleted. If not already attached, insert the Plug Converter into the AC Power Supply as shown (Figure 3).
2. The AC Power Supply (Figure 3) can be used with 100-240V outlet and will automatically adjust to the incoming voltage. It can be used worldwide, but does require "Plug Converters" for use outside the USA. Additional Plug Converters for the eRapid Nebulizer System are available as optional accessories. Make sure to use the correct Plug Converter for the AC outlet.
3. To connect the AC Power Supply to the Controller, place the Controller on a flat, stable surface. Push the Plug Insert (the round end of the AC Power Supply cord) into the Plug Inlet Port, located on the under side of the Battery Door. (Figure 4). Do not attempt to insert the AC Power Supply Cord into the front of the Controller.
4. Plug the AC Power Supply into the wall outlet.

Figure 3

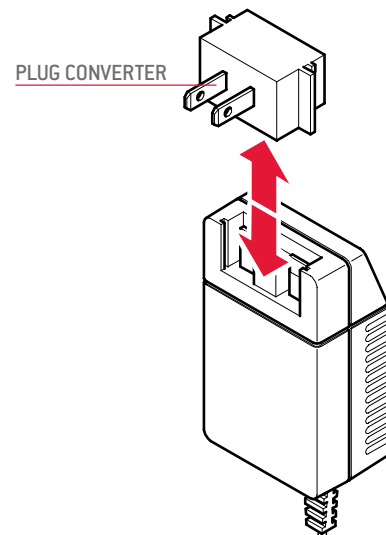
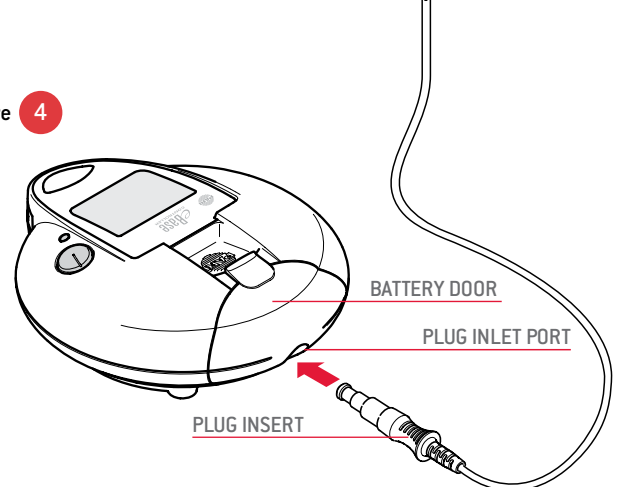

Figure 4



⚠ WARNING

The eRapid Nebulizer Handset is not sterile. **Clean and Disinfect the eRapid Nebulizer Handset before the first use.** (see Section H for Cleaning and Section J for Disinfecting). Inspect all parts to ensure they are clean and are not visibly damaged. Do not use dirty or damaged parts.

1. The Medication Reservoir and the Aerosol Chamber are attached using a “hinge”. First, gently pull up on the tab of the Medication Reservoir (Figure 5a). This will release the Aerosol Chamber so that you may open it (Figure 5b). Ensure that the Inhalation Valve is placed correctly in the Aerosol Chamber. If not, re-insert as shown (Figure 6a-6b).
2. Ensure that the Aerosol Head is inscribed “eRapid” (Figure 7, enlargement). Do not use other eFlow® Technology Aerosol Heads in this device. Additionally, do not use the eRapid Aerosol Head in other eFlow Technology Handsets (e.g. Altera, TRIO, Investigational eFlow). Being careful to touch ONLY the plastic outer ring of the Aerosol Head (Figure 7), press the two flexible plastic tabs on the side of the Aerosol Head while firmly inserting it into the Medication Reservoir (Figures 7a-7b). You should feel the plastic tabs “grab” as you insert it. It is important that you do not touch the metal part of the Aerosol Head (Figure 8).
3. Close the eRapid Nebulizer Handset by pushing the Aerosol Chamber together with the Medication Reservoir until you hear a slight “snap” (Figure 9). If you do not hear a slight snap, open the eRapid Nebulizer Handset and ensure that the Inhalation Valve is seated properly (Figure 6b).
4. Attach Mouthpiece to Nebulizer Handset with Exhalation Valve facing up (Figure 10).
5. Align the hinge part of the eRapid Nebulizer Connection Cord with the rear underside of the eRapid Nebulizer Handset (Figure 11a), then snap it into place (Figure 11b).
6. Place the Controller on a clean, flat, stable surface.
7. Connect the Nebulizer Connection Cord round end to the front of the Controller (Figure 12).

Figure 5

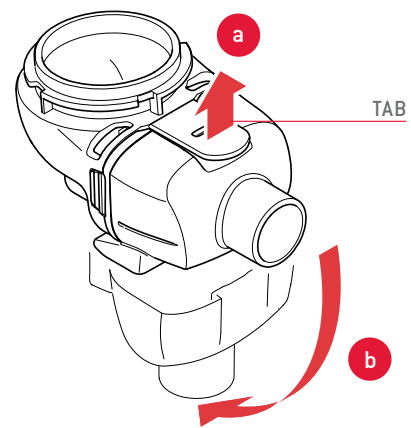

Figure 6a

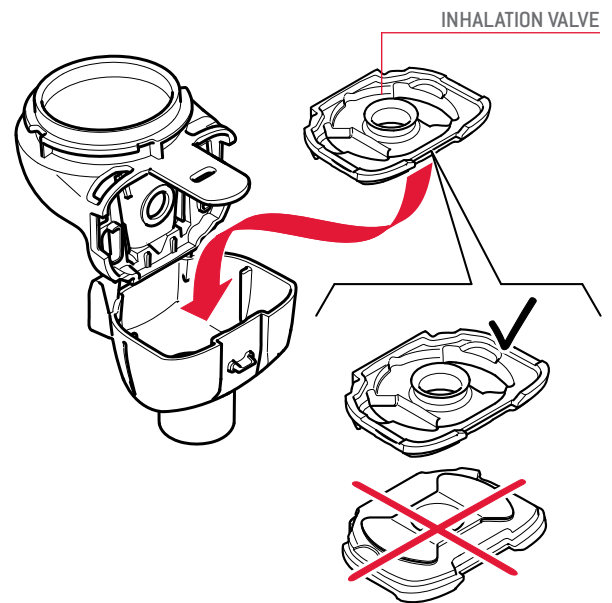

Figure 6b

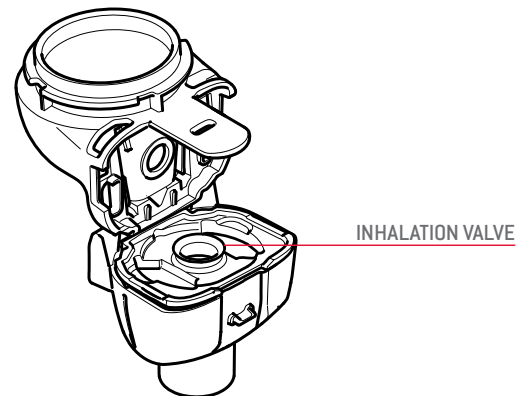

Figure 7

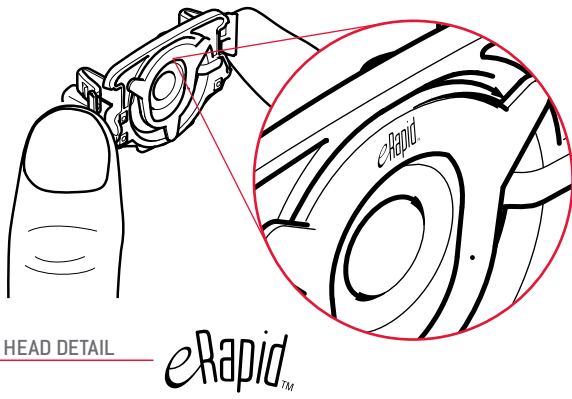

Figure 7a

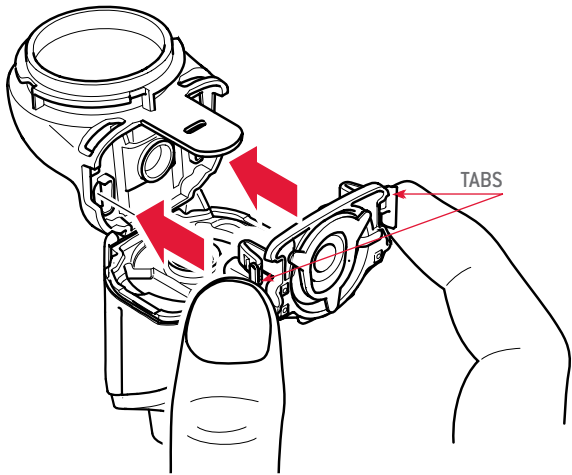

Figure 7b

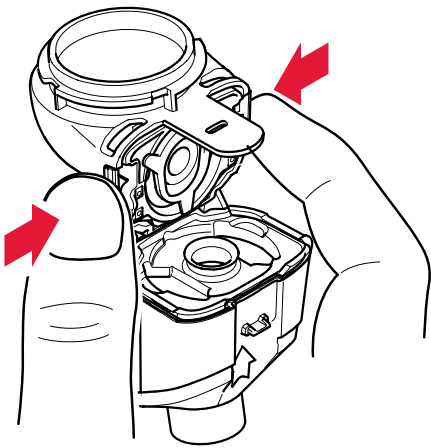

Figure 8

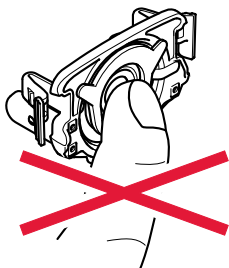

Figure 9

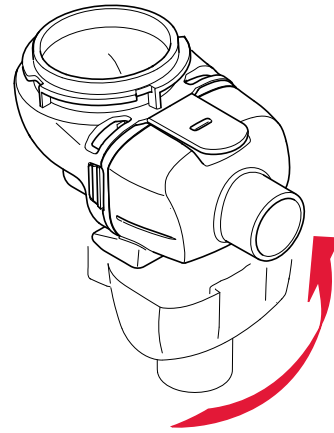

Figure 10

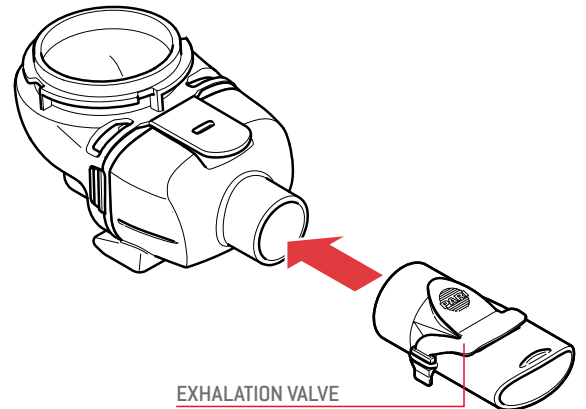

Figure 11

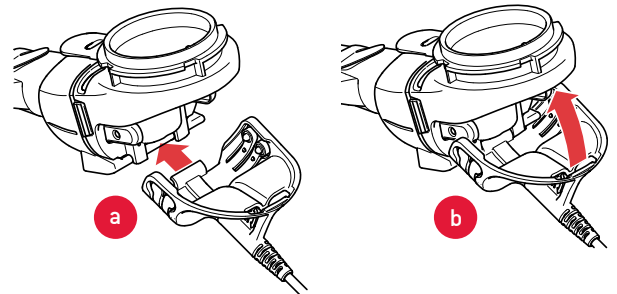
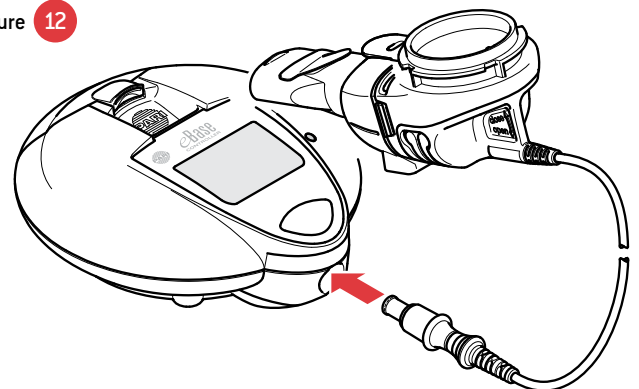

Figure 12



1. Make sure the eRapid Nebulizer Handset is on a flat, stable surface.
2. Pour only the medication prescribed by your physician specifically for the eRapid Nebulizer System into the eRapid Nebulizer Handset Medication Reservoir (Figure 13). **DO NOT USE MEDICATIONS PRESCRIBED FOR OTHER NEBULIZERS IN THE ERAPID NEBULIZER SYSTEM. NOTE: THE MAXIMUM VOLUME FILL IS 6 ML. DO NOT OVERFILL THE MEDICATION RESERVOIR.**
3. Align the Tabs on the Medication Cap with the Tab Slots on the Medication Reservoir (Figure 14a). Turn the Medication Cap clockwise until it stops (Figure 14b). Your eRapid Nebulizer Handset is now ready, and you can begin your treatment (Figure 15).
4. To begin your treatment, sit in a relaxed, upright position. Press and hold the On/Off button for a few seconds (Figure 16). You will hear one “beep” and the status light will illuminate green. The eFlow Technology logo will appear. This is the START screen. (Figures 16-17c). The Controller is now ON.
5. After a few seconds, aerosol mist will begin to flow into the Aerosol Chamber of the eRapid Nebulizer Handset.
6. Your Controller is designed to display the TREATMENT screen (Figure 17b) if the eRapid Nebulizer System is assembled correctly and working properly.
7. Place the Mouthpiece on top of your bottom lip and tongue and close your lips around it. Hold the eRapid Nebulizer Handset level. If held down more than 45 degrees, the Aerosol Head will emit 2 beeps and the status light on the Controller will flash 2 green lights. After approximately 30 seconds the Controller will shut off. If this occurs, hold the eRapid Nebulizer Handset level and press the Controller's On/Off Button to resume the treatment.

NOTE: eBase Controllers supplied with other eFlow Technology devices may not have this software feature.

11. The Controller will shut off automatically at the end of the treatment. Unique to the eRapid Nebulizer Handset design is about 1mL (or 1/5 teaspoon) of residual volume of medication which mimics other general purpose nebulizers intended to deliver approved medications. Open the Medication Cap and check to make sure that there is not more than 1 mL of medication following a complete treatment. If there is, replace the Medication Cap and resume the treatment until only about 1mL remains in the Medication Reservoir (Fig. 19).
12. Once the treatment is complete, disassemble the eRapid Nebulizer Handset for cleaning. Refer to Section H for cleaning instructions.

Figure 13

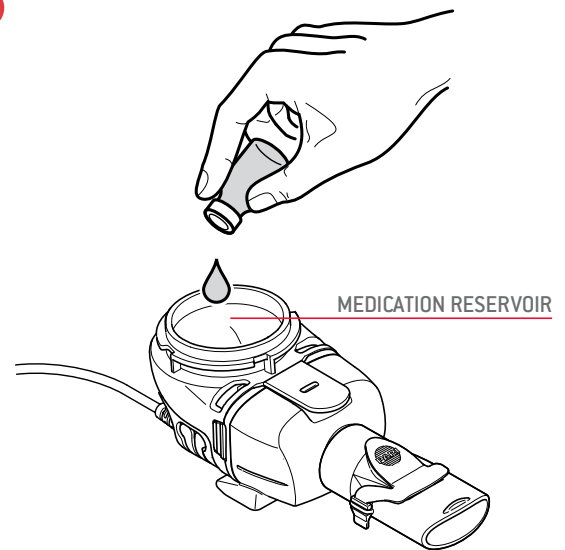

Figure 14

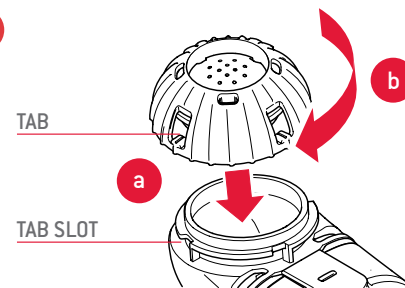
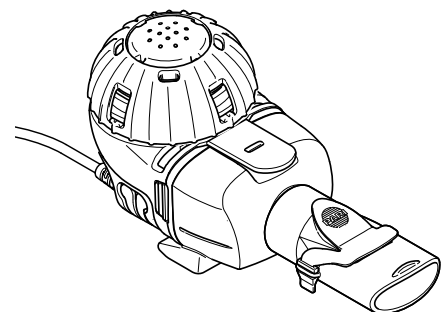

Figure 15



⚠ WARNING

Keep the eRapid Nebulizer Handset level when in use. If the handset is tilted, the dosage may not be accurate.

8. Breathe normally in and out through the Mouthpiece. Continue to inhale and exhale comfortably until the treatment is finished.
9. When all of the medication has been delivered you will hear the Aerosol Head emit 2 beeps, the DOSE COMPLETE screen will appear (Figure 18), and the Controller will automatically shut off.
10. The eBase Controller included with the eRapid includes software that allows a PAUSE, when necessary. If for any reason you must PAUSE in your treatment before its completion, press and hold the Controller's On/Off Button for one full second. The eRapid's PAUSE mode is activated when the LED flashes GREEN and your Controller display switches from the TREATMENT screen to the PAUSE screen (Figure 17c). When you are ready to resume your treatment, press and hold the Controller On/Off Button for one full second. The treatment will then resume, with the Controller display switching from the PAUSE screen to the TREATMENT screen.

Figure 16

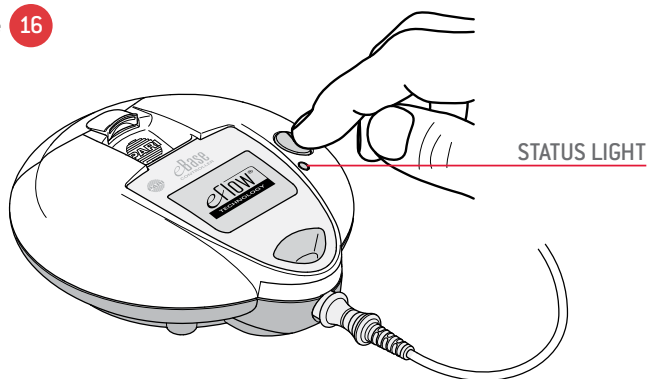

MESSAGE SCREENS-CORRECT ASSEMBLY

Figure 17a



START SCREEN

Figure 17b

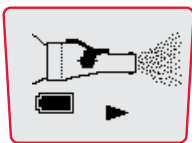

TREATMENT SCREEN
(Battery)

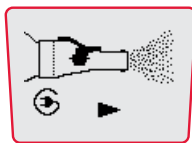

TREATMENT SCREEN
(AC Adapter)

Figure 17c

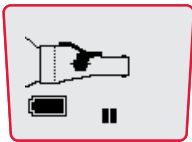

PAUSE SCREEN
(Battery)

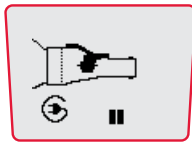

PAUSE SCREEN
(AC Adapter)

NOTE: When the dose is complete the Aerosol Head will emit 2 beeps, the DOSE COMPLETE screen will appear (Figure 18), and the Controller will automatically shut off.

Figure 18



DOSE COMPLETE
Clean Your eRapid
Nebulizer Handset

Figure 19

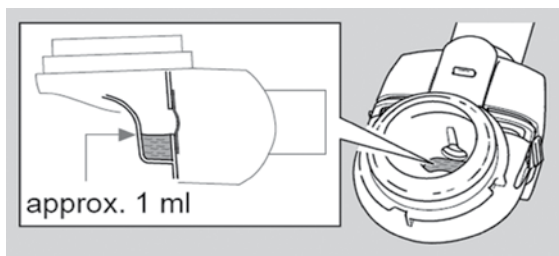

MESSAGE SCREENS & WARNINGS

NOTE: Your Controller has an LCD screen that provides information to you. Think of these screens as “electronic coaching” to ensure proper operation of the eRapid Nebulizer System. Symbols on the screen will “alternate” as shown below. In addition, the Controller status light NEAR THE ON/OFF BUTTON will flash red-green and repetitive alarm beep tones will sound. When the alternating screens appear, follow the text in the “Description/Remedy” to the right of the screen symbols below.

SYMBOL (ALTERNATING SCREENS)	DESCRIPTION/REMEDY
	BATTERY LEVEL LOW. Replace with New Batteries Immediately OR Use AC Power Supply
	PAUSE Mode Replace with New Batteries Immediately OR Use AC Power Supply
	EASYCARE Mode Replace with New Batteries Immediately OR Use AC Power Supply
	INCORRECT ASSEMBLY. Check Nebulizer Connection Cord to Controller. Check Nebulizer Connection Cord to Nebulizer Handset.
	NO MEDICATION DETECTED IN MEDICATION RESERVOIR. Fill Medication Reservoir OR Hold The eRapid Nebulizer Handset Level and Press The On/Off Button.
	BATTERIES ARE EMPTY. Replace with New Batteries Immediately OR Use AC Power Supply.
	CAUTION SCREEN. Device will shut down. Call 1-866-335-6943.

NOTE: After all fault screens have been remedied, the START screen will re-appear (Figure 17a) and the treatment can resume.

⚠ WARNING

To reduce the risk of infection, illness, and/or injury from contamination and/or improper use, **clean the eRapid Nebulizer Handset as soon as possible after your treatment.** Do not wash the Controller, Nebulizer Connection Cord, AC Power Supply or Plug Converters. Use liquid soap designed for washing dishes. Do not use “white” liquid dish soaps (e.g. Ivory or Dove) or antibacterial liquid dish soaps as these may contain additives harmful to the eRapid Nebulizer Handset. Also:

- Do not put the Aerosol Head in a microwave oven.
- Do not attempt to clean the Aerosol Head in a dishwasher.
- Mechanical cleaning of the Aerosol Head with brushes or abrasives may cause irreparable damage.

NOTE: The cleaning instructions described may be used in both home and institutional environments.

1. Disconnect the eRapid Nebulizer Handset from the Nebulizer Connection Cord (Figures 20a and 20b).
2. Disassemble the eRapid Nebulizer Handset parts:
 - a. Remove the Medication Cap from the Medication Reservoir (Figure 21). Dispose of the residual medication (about 1 mL) from the Medication Reservoir in accordance with the drug manufacturer's guidelines.
 - b. Remove the Mouthpiece from the Aerosol Chamber (Figure 22).
 - c. Gently pull up on the tab of the Medication Reservoir. This will release the Aerosol Chamber so that you may open it (Figure 23).
 - d. Remove the Inhalation Valve from the Aerosol Chamber (Figure 24).
 - e. Being careful to touch ONLY the plastic outer ring of the Aerosol Head, press the two flexible plastic tabs on the side of the Aerosol Head and remove the Aerosol Head (Figures 25-26).

NOTE: There is no need to disassemble the Medication Reservoir from the Aerosol Chamber either for Cleaning or Disinfecting. Doing so may damage the hinge that holds them together.

3. Place all eRapid Nebulizer Handset parts as well as the Aerosol Head in warm (about 104° F) tap water with a little dish washing soap (dosage according to the manufacturer's instructions) for 5 minutes (Figure 29). Move the parts around in the soapy water a few times. A soft brush (e.g. a new, unused toothbrush) can be used on all parts to aid with cleaning EXCEPT the Aerosol Head.

Never use a brush or any other object to clean the Aerosol Head (Figure 28). THOROUGH RINSING OF BOTH SIDES OF THE AEROSOL HEAD HELPS TO PREVENT CLOGGING AND ENSURE PROPER OPERATION.

4. Following Step 3, rinse the front and back of the Aerosol Head for about 1 minute under warm running tap water (about 104° F) (Figure 27).
5. Rinse all eRapid Handset parts thoroughly under running, warm tap water. After rinsing shake all parts to remove excess water.

If Disinfecting after Cleaning, skip to Section I and follow the steps.

6. Air dry the eRapid Nebulizer Handset parts on a clean, lint-free towel.
7. After the eRapid Nebulizer Handset parts are completely dry, place them in a bag for storage. DO NOT re-assemble the eRapid Nebulizer Handset until just prior to the next treatment. This is to ensure that the silicone seals do not become warped over time.
8. If the eBase Controller needs cleaning, wipe down with a slightly damp, soft cloth. DO NOT allow liquid to get inside the Controller.

Figure 20

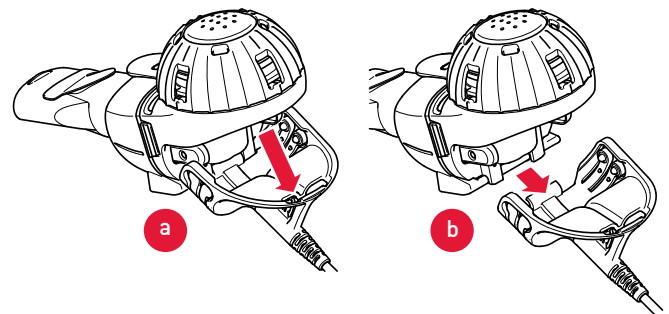

Figure 21

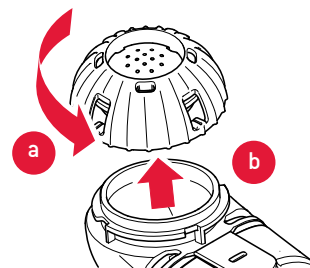

Figure 22

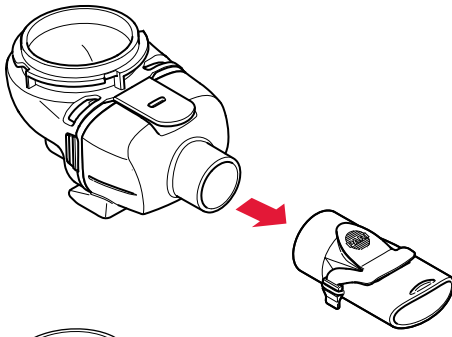

Figure 23

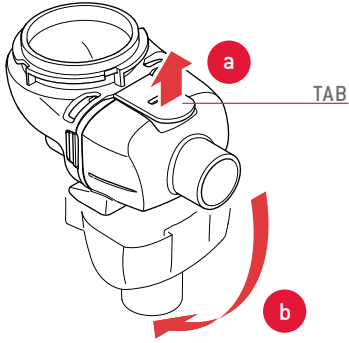

Figure 24

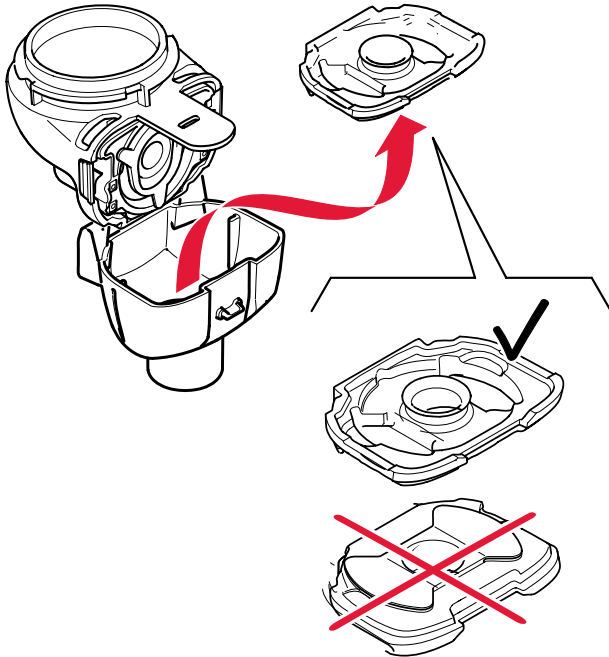

Figure 25

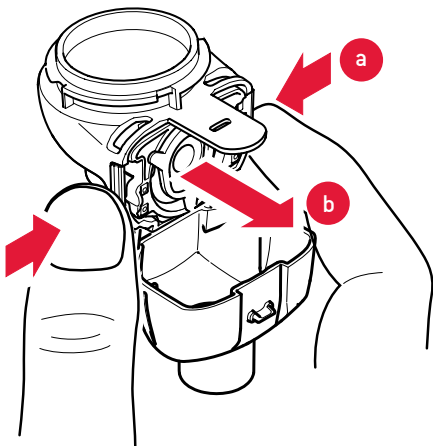

Figure 26

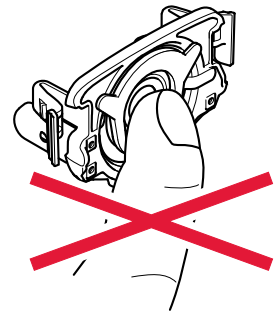

Figure 27

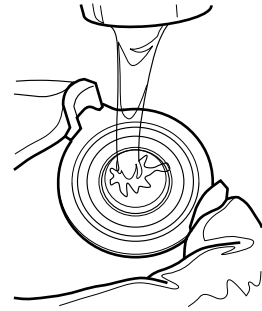

Figure 28

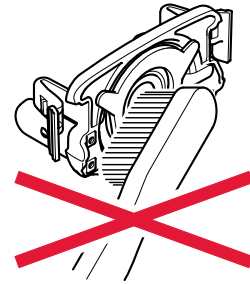
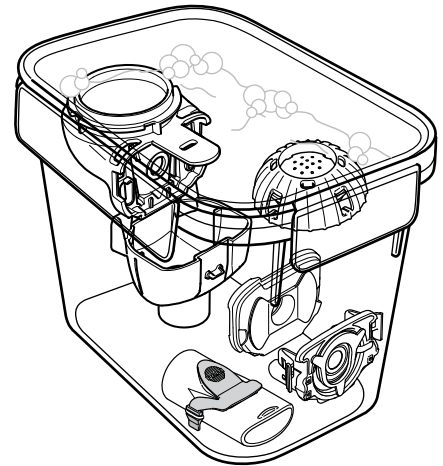

Figure 29



EASYCARE (Fig. 30), available separately, is a cleaning aid designed to maintain the standard performance of the eRapid Aerosol Head. It is important not to use EASYCARE more than 2 times per week to maintain maximum eRapid Aerosol Head life.

1. Read the Instructions For Use for EASYCARE carefully and completely before using it for the first time.
2. Connect EASYCARE to the Controller as described in the EASYCARE Instructions For Use.
3. To start the EASYCARE cleaning cycle press and hold down the On/Off button on the Controller for at least 10 seconds. First you will hear one “beep” and the status light will illuminate green. The START screen (Figure 17a) will appear on the display.
4. After about 10 seconds you will hear a second “beep” and the screen will change showing that the EASYCARE cleaning has started (Figure 31). Release the On/Off button.

NOTE: During EASYCARE cleaning make sure that either one of the EASYCARE screens (Figure 31) are showing in the Controller display. If the TREATMENT screens show (Figure 17b) shut the Controller off and restart the EASYCARE cleaning cycle in accordance with the above instructions.

5. When the EASYCARE cleaning cycle is completed you will hear two “beeps”, and the same DOSE COMPLETE screen will appear (Figure 18). The Controller will automatically shut off.

NOTE: In the event of a malfunction, see the Message Screens and Warnings chart on Page 11, locate the alternating symbols, and take the corrective action noted.

6. Rinse (see Section H) and Disinfect (see Section J) the Aerosol Head after every EASYCARE cleaning cycle.
7. Refer to the EASYCARE Instructions For Use in disassembling and maintaining the EASYCARE.

Figure 30

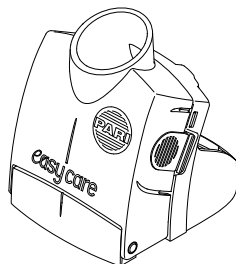
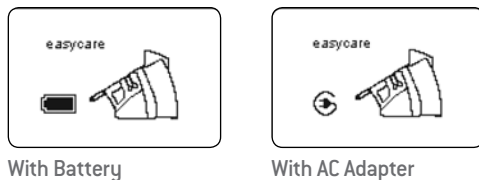

Figure 31



WARNING

To reduce the risk of serious or fatal illness caused by contamination of the eRapid Nebulizer Handset you must also **DISINFECT THE HANDSET AT THE END OF EVERY TREATMENT DAY**. In addition, the eRapid Nebulizer Handset is strictly **FOR SINGLE PATIENT USE ONLY**.

NOTE: The disinfection instructions described may be used in both home and institutional environments.

1. Clean the eRapid Nebulizer Handset as described in Section H.
2. AT THE END OF EVERY TREATMENT DAY, disinfect the eRapid Nebulizer Handset with a commercially available medical device disinfectant such as Control III®. **Follow the disinfectant manufacturer’s directions for use.**
3. The eRapid Nebulizer Handset may also be disinfected by boiling the parts, including the Aerosol Head, in a clean pot of DISTILLED water for a full 5 minutes. **Do not boil in regular tap water, as it may damage the Aerosol Head.**
4. Air dry the eRapid Nebulizer Handset parts on a clean, lint-free towel (Figure 32).
5. After the eRapid Nebulizer Handset parts are completely dry, place them in a bag for storage. **DO NOT** re-assemble the eRapid Nebulizer Handset until just prior to the next treatment. This is to ensure that the silicone seals do not become deformed over time.
6. Hospitals and clinics can sterilize the eRapid Nebulizer Handset parts by wet autoclaving at 250° F (121° C) for 30 minutes. **Follow the autoclave manufacturer’s instructions for use.**

Figure 32

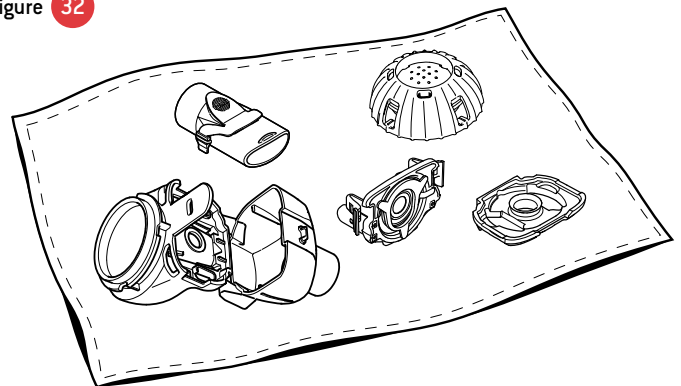

A Functionality Test takes only a few minutes and is helpful if you suspect the eRapid Nebulizer Handset is not working properly. Follow the steps below and use only 2.5 mL (about 1/2 teaspoon) sodium chloride 0.9% (normal saline) for the Functionality Test.

1. Assemble the eRapid Nebulizer Handset as described in Section F, but do not attach the Mouthpiece.
2. Follow the procedure in Section G for taking a treatment. However, for this Functionality Test only, use 2.5 mL (about 1/2 teaspoon) of sodium chloride 0.9% instead of medication.
3. Using a stop watch or clock with a second hand, time the complete Functionality Test from when the eRapid Nebulizer Handset starts producing aerosol until the Controller automatically turns off.
4. After the Controller has automatically shut off, remove the Medication Cap and check the amount of liquid in the Medication Reservoir. Only about 1 mL (about 1/5 teaspoon) of the solution should remain. If more than 1 mL remains, clean the Aerosol Head and repeat the test. If, after proper cleaning, there is still more than 1 mL remaining in the Medication Reservoir, call 1-866-335-6943 for details.
5. If the time to nebulize the sodium chloride 0.9% is less than 5 minutes, the eRapid Nebulizer Handset is functioning correctly. If it takes more than 5 minutes to nebulize the sodium chloride 0.9%, call 1-866-335-6943 for details. Clean the eRapid Nebulizer Handset after this Functionality Test.

FREQUENTLY ASKED QUESTIONS AND TROUBLESHOOTING

QUESTION 1: How much medication should be left in the Medication Reservoir at the end of a treatment?

Answer: Following treatment only about 1 mL (1/5 teaspoon) of medication should be remaining in the Medication Reservoir. If less than 1 mL remains, check for leaks and make sure the eFlow Nebulizer Handset is held level during treatment. If more than 1 mL remains, put the Medication Cap back on and restart the treatment. Following treatment, clean the Aerosol Head (Section H). If, after proper cleaning, more than 1 mL remains in the Medication Reservoir, call 1-866-335-6943.

QUESTION 2: How long should each treatment take?

Answer: With normal operation and proper cleaning the eRapid Nebulizer Handset should deliver 2.5 mL of sodium chloride 0.9% in less than 5 minutes. If more than 5 minutes is required to deliver 2.5 mL of sodium chloride 0.9%, call 1-866-335-6943.

QUESTION 3: When I turn on my eRapid Nebulizer System, nothing happens. Why does there not seem to be any power?

Answer: If you are using batteries, use the figures in each battery compartment to verify that the batteries are inserted correctly. If the batteries are positioned properly, check to see if the alternating BATTERY LEVEL LOW icons are flashing on the controller display. If they are, replace the batteries or use the AC Power Supply.

Answer: If you are using the AC Power Supply, check the adapter connection to be sure it is firmly connected to the adapter port located underneath the battery compartment. Be sure that the adapter is plugged into a working wall outlet.

QUESTION 4: How long will a new set of batteries last?

Answer: A new set of batteries will provide approximately 90 minutes of continuous treatment.

Answer: Consider using rechargeable batteries.

QUESTION 5: What if no mist is coming out of the eRapid Nebulizer Handset?

Answer: First, check that the Controller has power. Secondly, make sure the Nebulizer Connection Cord is correctly attached. Thirdly, check to be sure that the eRapid Nebulizer Handset has been assembled properly (Section F). Lastly, check to be sure medication is in the Medication Reservoir. If the eRapid Nebulizer System still does not function properly, call 1-866-335-6943.

QUESTION 6: What if liquid is leaking from the eRapid Nebulizer Handset during the treatment?

Answer: Check to see if the Inhalation Valve has been deformed by storing the eRapid Nebulizer Handset assembled.

Answer: Be sure the Inhalation Valve is properly attached to the Aerosol Chamber to prevent leaks (Section F, Figures 6a and 6b).

Answer: Ensure the Aerosol Head is inserted correctly (Section F, Figures 7, 7a and 7b). Next, ensure the Medication Reservoir and the Aerosol Chamber are closed correctly (Section F, Figure 9).

QUESTION 7: What if my Controller shuts off before my treatment begins, or does not restart?

Answer: Press the On/Off button for one full second. If it still shuts off after several (3-4) attempts, call 1-866-335-6943.

QUESTION 8: What if my Controller does not shut off at the end of my treatment?

Answer: Press the On/Off button again.

Answer: Disconnect the AC Power Supply from the Controller and remove the batteries.

Please note that the Controller has a built-in, automatic shutoff after 20 minutes of operation. Before it shuts off the Controller will display the CAUTION screen, not the DOSE COMPLETE screen (see Message Screens and Warnings). This is not a malfunction. However, if this situation continues three or four times, call 1-866-335-6943.

QUESTION 9: When I started my EASYCARE the EASYCARE screen did not appear on the display and the TREATMENT screen appeared instead. What do I do?

Answer: Press and hold the Controller's On/Off Button for three full seconds. A 5-beep alarm tone will sound, the status light on the Controller will flash RED-GREEN, and the TREATMENT INTERRUPTED screen will appear. After 10 seconds the Controller will automatically shut off. Restart the EASYCARE cycle as described in Section I. When the EASYCARE screen appears you are in the EASYCARE mode. If this situation occurs several (3-4) times call 1-866-335-6943.

Weight: Controller and eRapid Nebulizer Handset	6 oz
Weight: Controller, eRapid Nebulizer Handset, and Batteries	9.5 oz
Dimensions of eRapid Nebulizer Handset	1.97" X 2.26" X 5.18"
Electrical Requirements	110 V - 240 V, 50 Hz/60 Hz
Power Wattage	2.0 Watts under normal load
Min. Fill Volume.....	2.0 mL
Max. Fill Volume.....	6.0 mL

TRANSPORT / STORAGE

Ambient Temperature	-4° to 140° F
Ambient Humidity	10% to 95%

RECHARGEABLE BATTERIES

Rechargeable Batteries	1.2V-1.5V, min 1500mAh
Rechargeable Battery Operation	About 90 minutes of continuous treatment
Rechargeable Battery Charge Time	up to 15 hours, (depends on type of battery charger)

DISPOSABLE BATTERIES

Panasonic Evoia or equivalent	1.5V
Panasonic Power Digital or equivalent	1.5V

MANUFACTURED IN GERMANY & DISTRIBUTED BY:

PARI Respiratory Equipment, Inc.
 2412 PARI Way
 Midlothian, VA 23112
 Tel: Toll Free (U.S.A. only) 1-800-FAST-NEB (327-8632)
 Canada and International 1-804-253-PARI (7274)
www.pari.com

PATENT NOS:

US 6,962,151; US 6,983,747; US 7,252,085; US 7,931,212; US 7,458,372 and; US 7,316,067. Additional patents pending.

DESIGN AWARDS:



©2012 PARI Pharma GmbH. All rights reserved. Altera, eFlow and TRIO are registered trademarks of PARI Pharma GmbH. eRapid is a trademark of PARI Pharma GmbH. Touchspray Technology® is under license from the Technology Partnership plc. Control III is a registered trademark of Maril Products, Inc.

178D1009 Rev B 10/12

