

# biēm

BUTTER SPRAYER

## Quick Start Guide

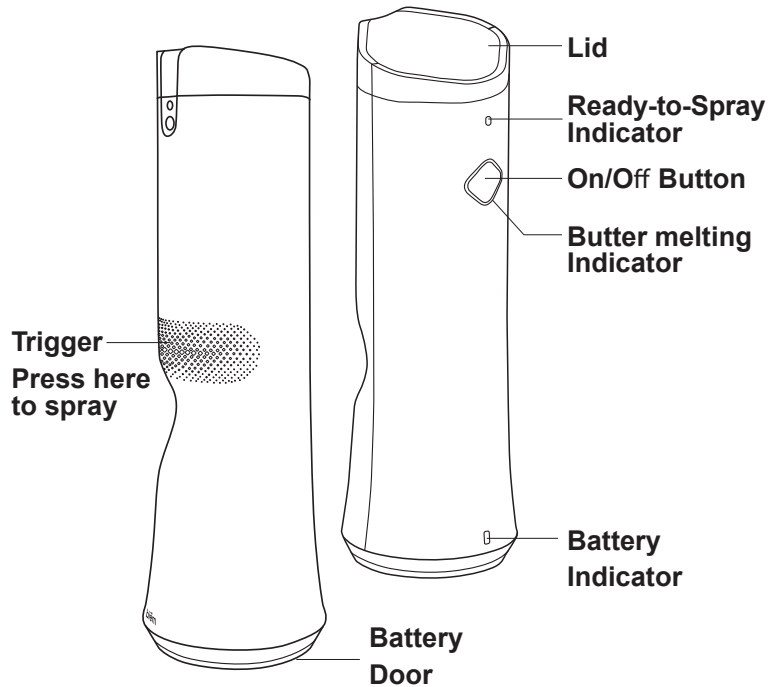

## To use biēm:

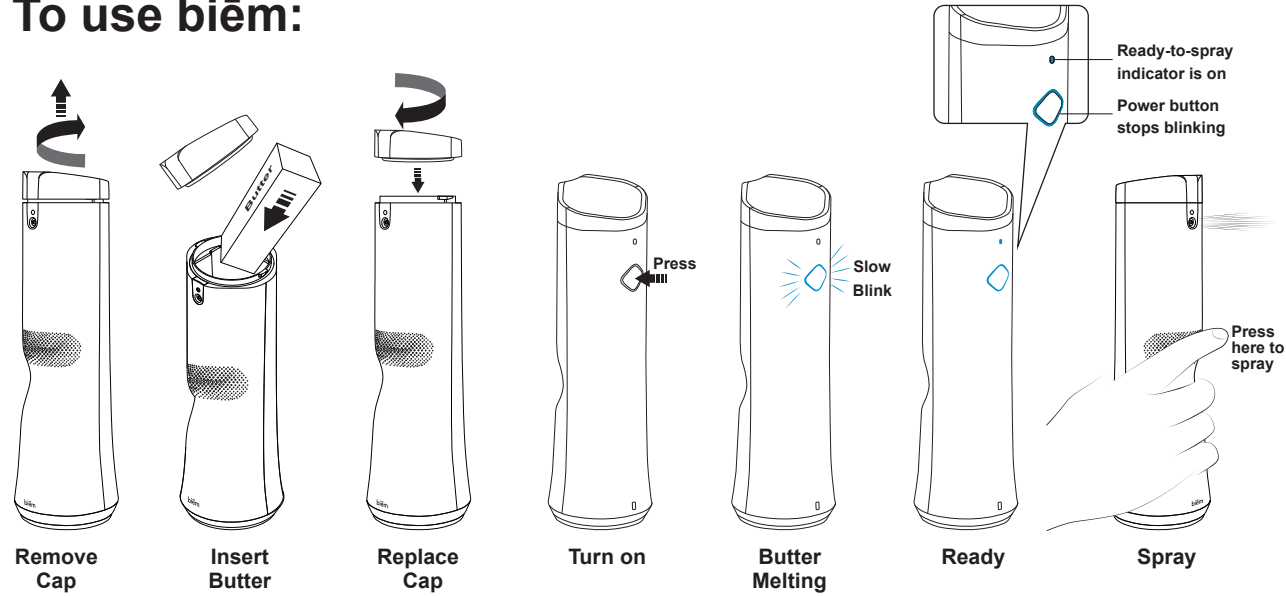

## Recharging the battery:

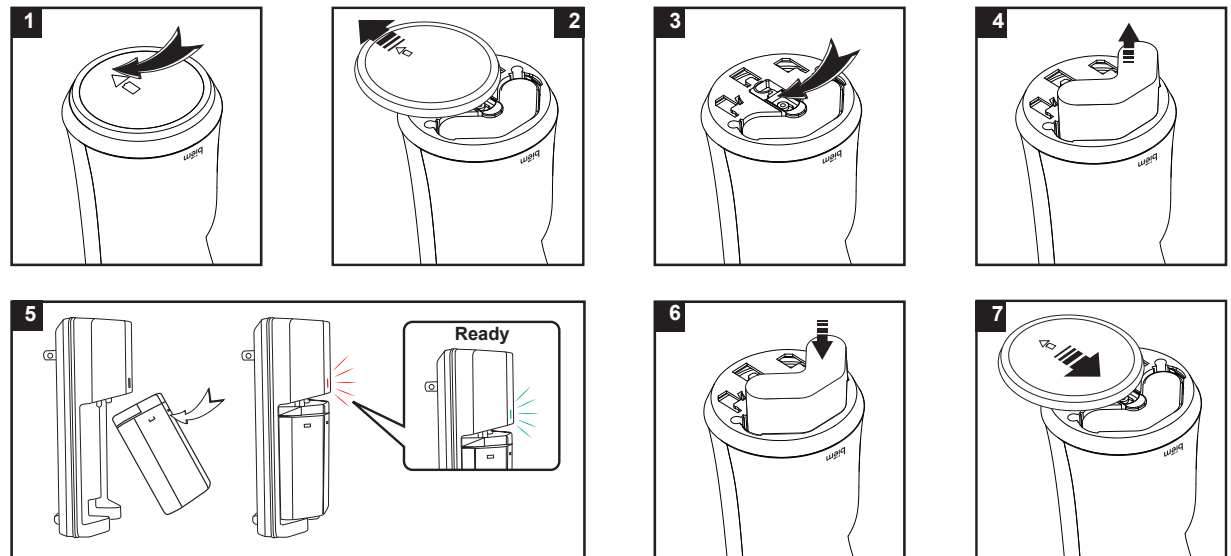

Please scan for customer service, FAQ's, and more information about biēm

[www.biēmspray.com](http://www.biēmspray.com)

# biēm

BUTTER SPRAYER



Please scan for customer service, FAQs, and more information about biēm

[www.biemspray.com](http://www.biemspray.com)

## More about biēm

- Never submerge your biēm. Also, biēm cannot go in the dishwasher. Doing so will void the warranty.
- Clean the biēm by running the cleaning cycle (below) and wiping the outside with a cloth dampened with water and mild dishwashing soap.
- While butter will stay fresh in the biēm if used regularly and stored on the counter, the biēm can also be stored in the refrigerator. Note that initial start time may be longer if it has been refrigerated.
- Do not store biēm in the freezer.
- Always store biēm upright.

## Warranty

biēm will repair or replace (at our option) your unit free of charge for 12 months from the date of purchase if the unit is defective in workmanship or materials. To claim your repair/replacement, the product must be returned to biēm along with proof of purchase. In the absence of the purchase receipt, the warranty will be 12 months from the date of manufacture.

This warranty does not apply to normal wear or damage from misuse, abuse, improper storage and handling, installation, accident, unauthorized repair or alteration.

If you experience a problem that is not noted in this guide, our Consumer Relations Team may have a simple solution to your problem.

Please contact our Consumer Relations Team at [customerservice@biemspray.com](mailto:customerservice@biemspray.com) or visit [www.biemspray.com](http://www.biemspray.com) for details.

## Cleaning

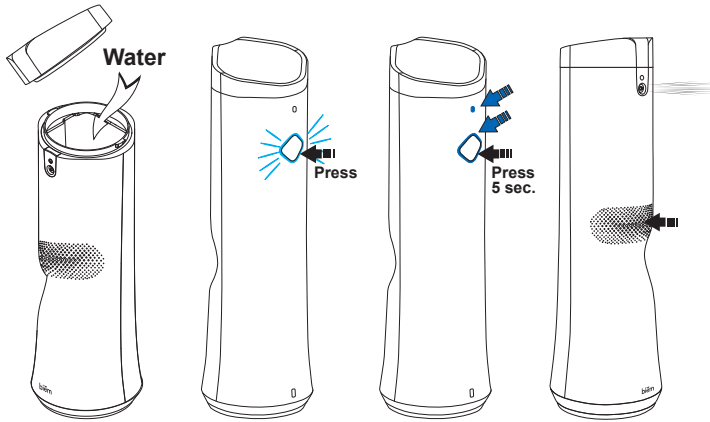

Fill biēm 2/3 up with hot water, add 1 drop of dish soap and shake for a few seconds.

Turn biēm on by pressing the on/off button.

Press and hold the on/off button for 5 seconds. Top light and power lights turn dark blue.

Spray for 10 seconds then rinse with clean water. Spray again and empty water.

## Troubleshooting: Does not spray

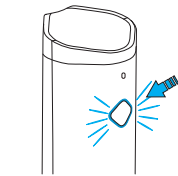

Butter is melting

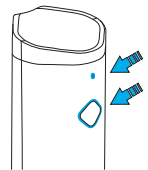

Wait until ready; both lights are solid blue

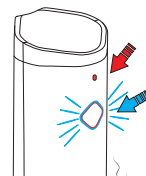

Top light is red; butter is out

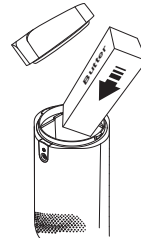

Add butter

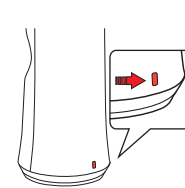

Battery light is red

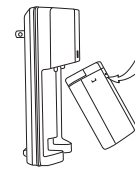

Charge the battery

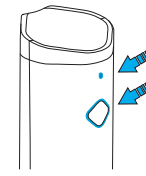

Both lights are on, but only air is spraying

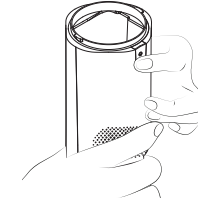

Remove lid and block the nozzle with your finger until bubbles are seen in the chamber.

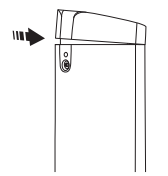

Cap is not on correctly

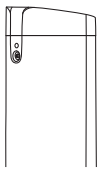

Remove and replace