

# VISTA



## VISTA 8 INSTALLATION GUIDE

[TRUGOLF.COM](http://TRUGOLF.COM)

## CONTENTS

|                                   |    |
|-----------------------------------|----|
| Setup Assistance .....            | 1  |
| Frame Diagram .....               | 2  |
| Assemble Frame .....              | 4  |
| Enclosure .....                   | 8  |
| Wiring .....                      | 13 |
| Computer Components Diagram ..... | 16 |
| Overhead Light Instructions ..... | 18 |
| Clone Displays .....              | 19 |
| Ball Placement: Full Shots .....  | 20 |
| Ball Placement: Putting .....     | 20 |
| Troubleshooting .....             | 21 |
| Diagnostics .....                 | 22 |

## SETUP ASSISTANCE

We suggest you watch a few videos before or during setup to help you assemble your Vista 8 Golf Simulator.

Simply scan the QR Code below or visit: <https://trugolf.com/vista-setup>



**For further assistance visit TruGolf Customer Support at:**

<https://trugolf.com/support>

or call

877-711-6691 | 801-677-1123

9:00am - 5:00pm MST Monday - Friday

**Want more golf courses or need to replace that worn hitting mat?**

Scan the QR Code below or visit: <https://trugolf.com/shop>

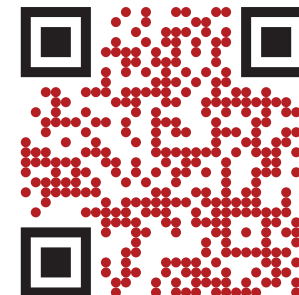

## FRAME DIAGRAM

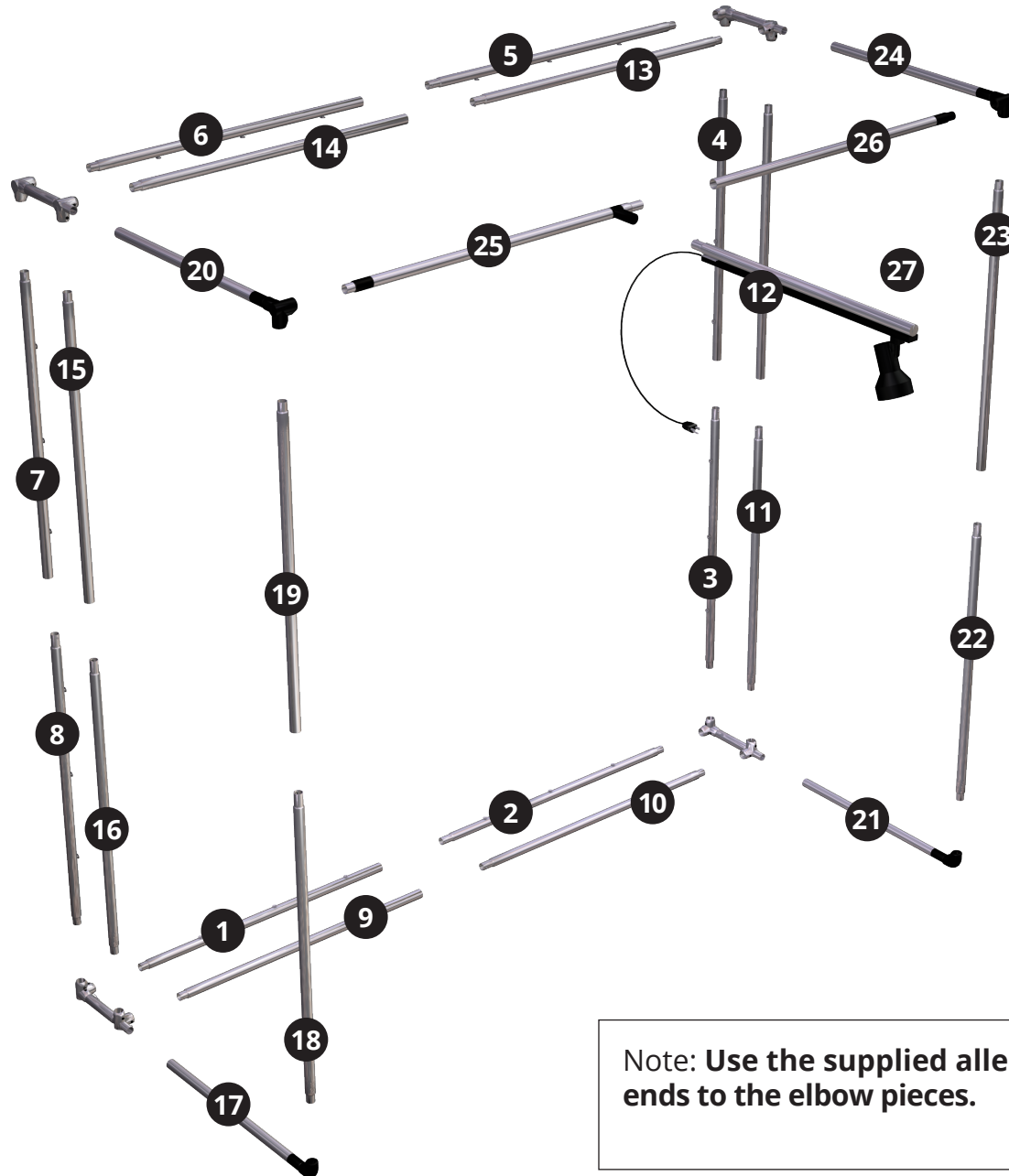

Note: Use the supplied allen wrench to fasten the tubular ends to the elbow pieces.

## ASSEMBLE FRAME

### STEP 1 | CORNER PIECES

Start assembling the frame with the back corner pieces. Place these several feet from the back wall and 8 feet apart.



### STEP 2 | CONNECT CORNERS

Connect the frame tubular pieces by sliding the male & female ends together until the SPRING BUTTON pushes through the hole and locks the pieces together. Connect corners together using the pieces shown below. **Tighten elbow pieces using the supplied allen wrench.**

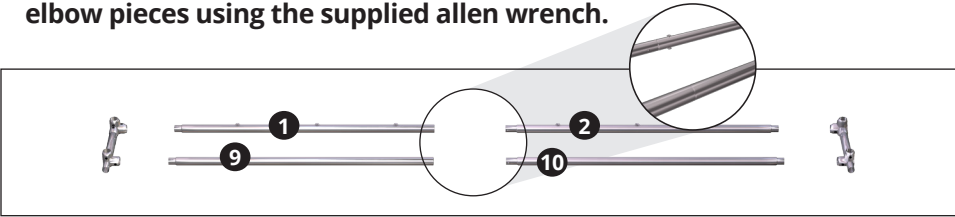

### STEP 3 | ASSEMBLE SIDES

Connect the side frame pieces to the base as shown below. **Tighten elbow pieces using the supplied allen wrench.**

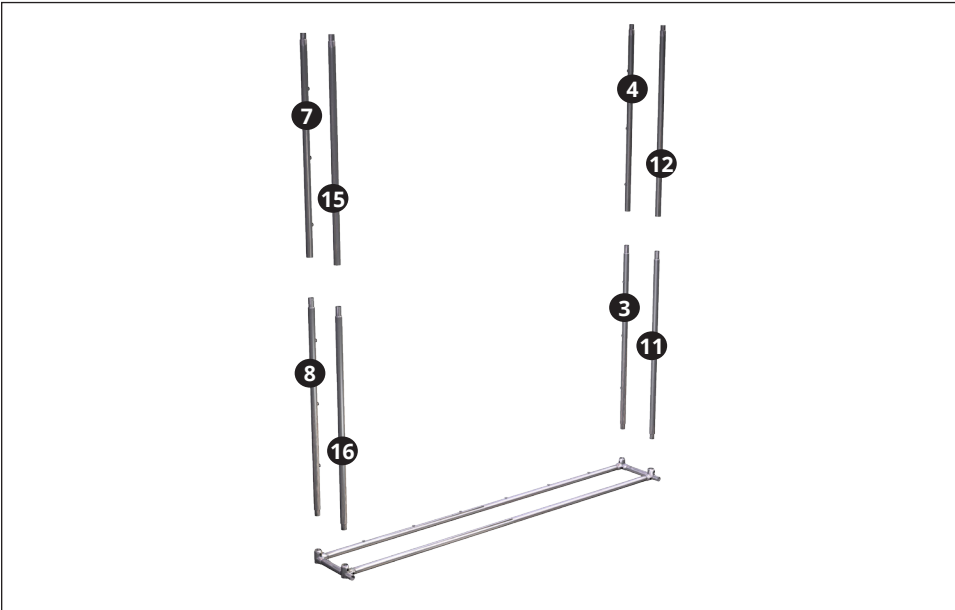

### STEP 4 | TOP CORNER PIECES

Assemble the top portion of the frame. Connect **corners** to the sides, then insert the top frame pieces between **the corners** as shown below. **Tighten elbow pieces using the supplied allen wrench.**

*Tip: To make assembling the frame top easier, tip the frame forward and lay it on the ground.*

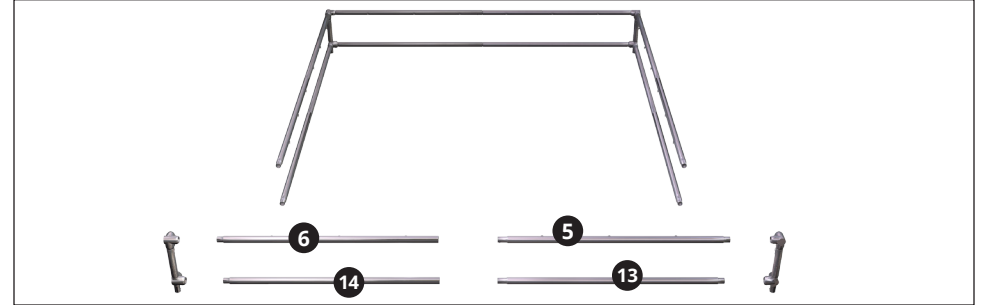

### STEP 5 | ATTACH THE SCREEN

From within the frame, unfold the SCREEN, black side up.



On each corner loop the bungee cord ends over the hooks that are mounted on frame as shown below.

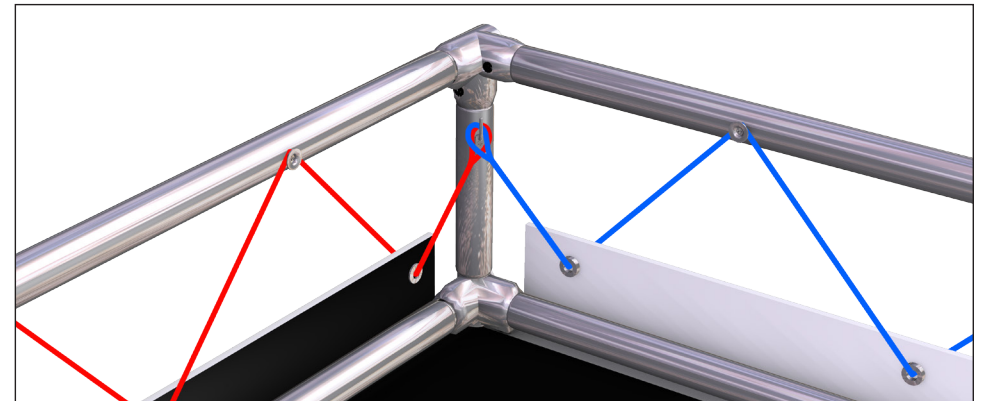



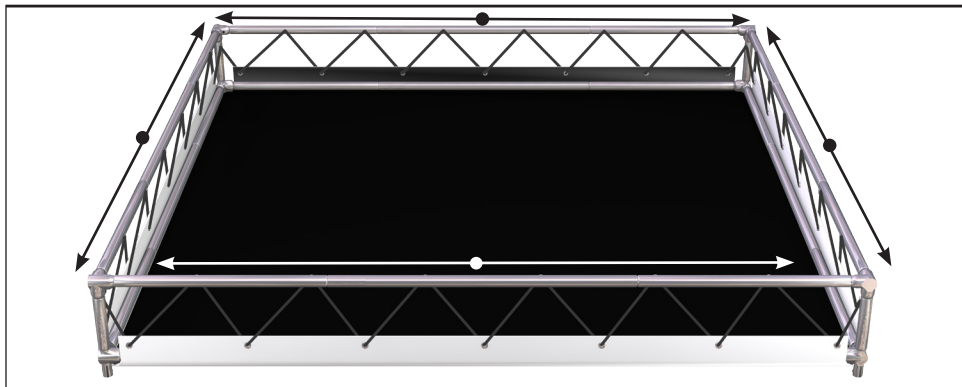

Attach the remaining bungee cord to the frame. Start from the center moving out to the corners. Stretch bungee cord up and onto the **INSIDE KNOBS** to create a zigzag pattern.

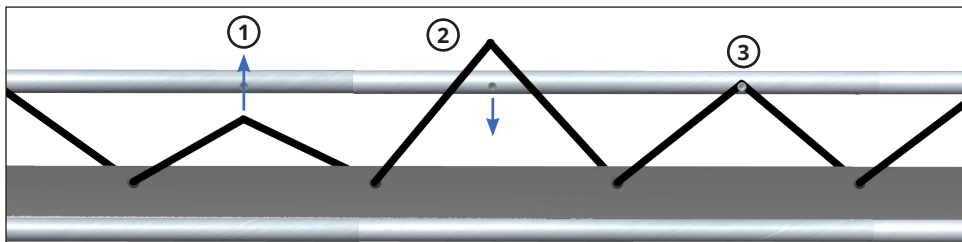

### STEP 6 | STAND IT UP

Tip the frame back up.



### STEP 7 | SIDES AND TOP

Assemble the walls as shown below. **Tighten elbow pieces using the supplied allen wrench.**

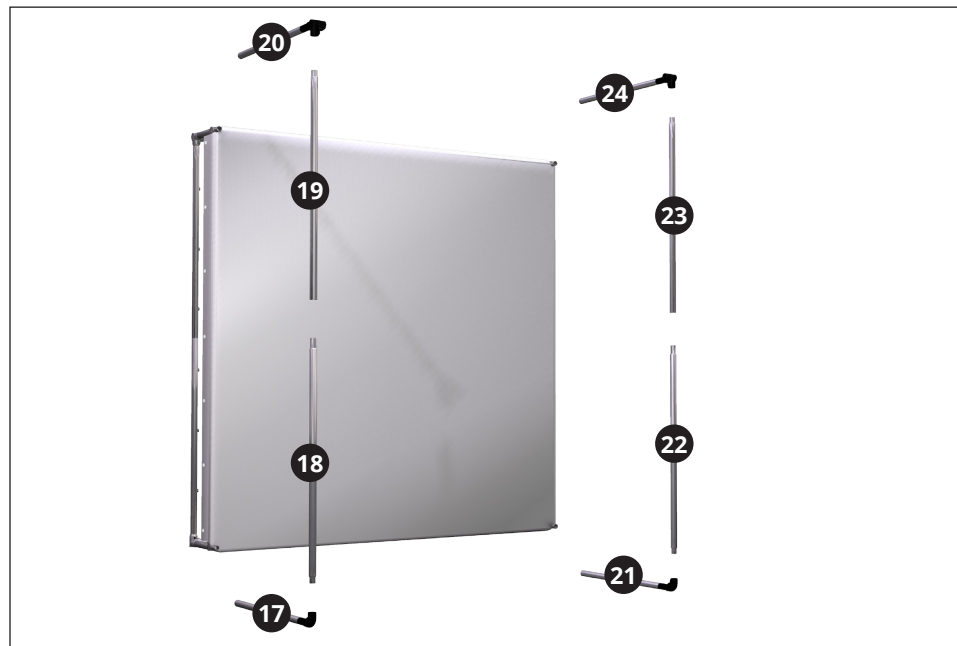

Next, assemble the **FRONT** of the frame, start from one side and work your way to the other. Connect the **LIGHT BAR [27]** last. **See Overhead Light Instructions (pg 20) for connecting light.**

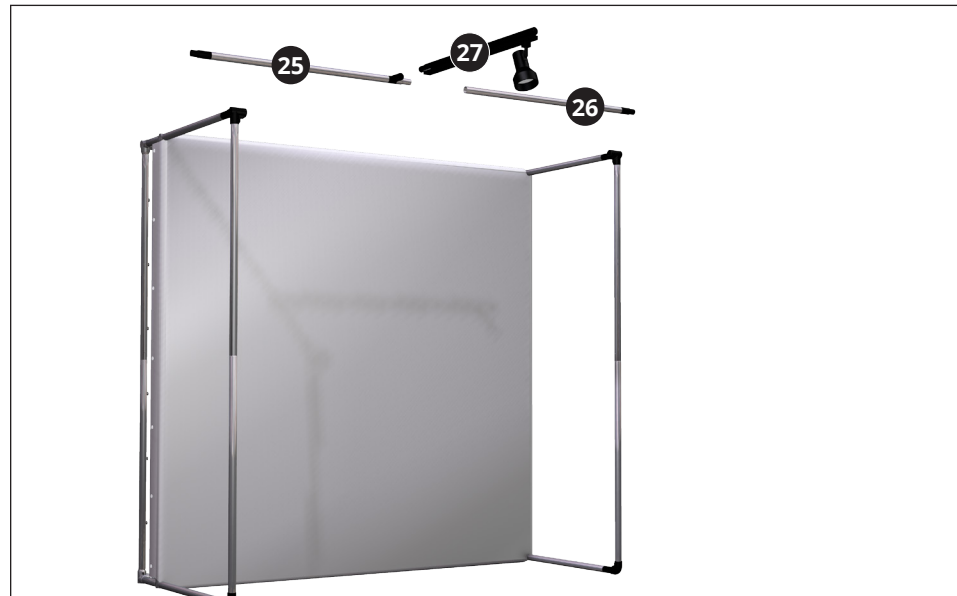

## ENCLOSURE

### STEP 1 | TOP

The enclosure is attached by stretching the fabric around the frame attaching the fabric back onto itself using the Velcro.

2 Cables will need to be run along the frame as you wrap.

1. BNC cable (25ft)
2. Power Extension cord for overhead light

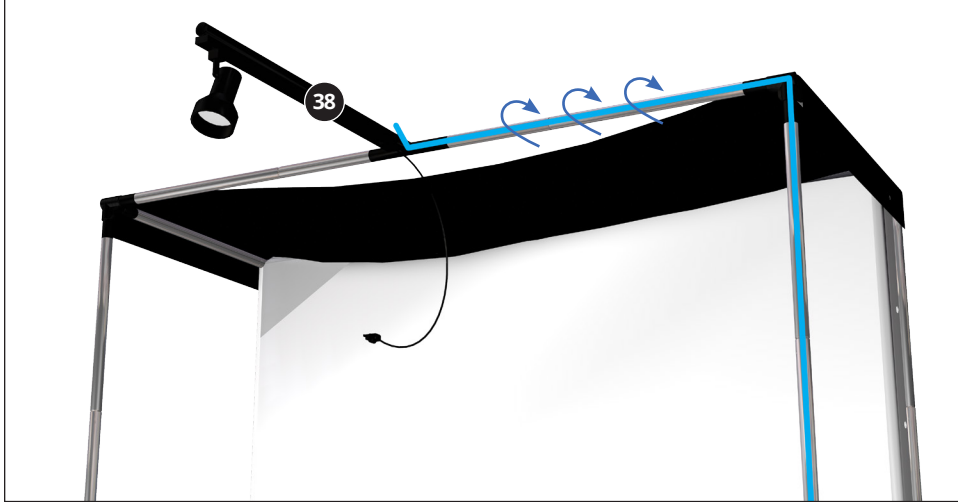

Begin installing the top enclosure at the Light Bar [27] working your way to the corners, include the cables as you go. Feed BNC cable end through the hole in the ceiling.

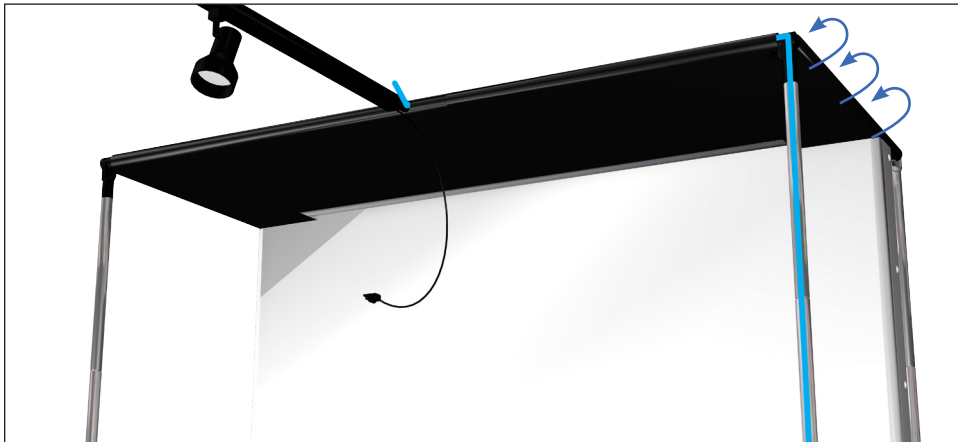

Next, starting from the front corners work your way long the sides towards the back of the frame, stretching the fabric around the frame attaching the fabric back onto itself using the Velcro.

### STEP 2 | TOP BUNGEEES

Once the top sides have been attached, continue securing the enclosure back edge to the frame using the integrated bungee system.

*TIP: This is done in a similar fashion used to attach the screen.*

First, attach the ends of the bungee cord to the frame as shown below.

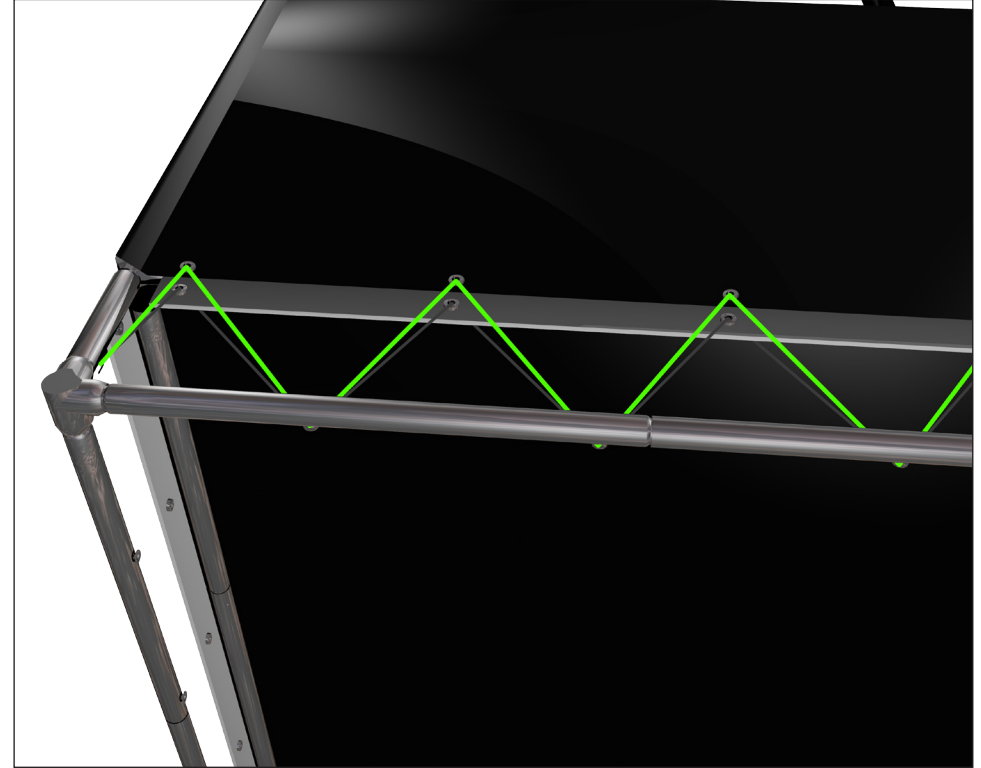

Next, stretch bungee cord onto the TOP KNOBS to create a zigzag pattern, moving from the center out to the ends.

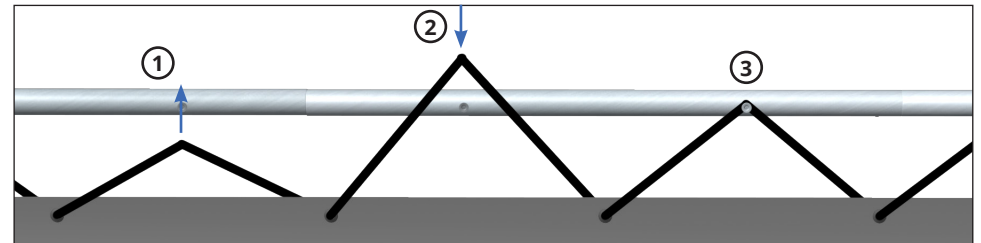

**STEP 2 | SIDE WALLS**

Attach the SIDE WALLS to the frame.

Connect the SIDE WALLS by first attaching the Velcro on the top edge to the Velcro that runs along the side of the top.

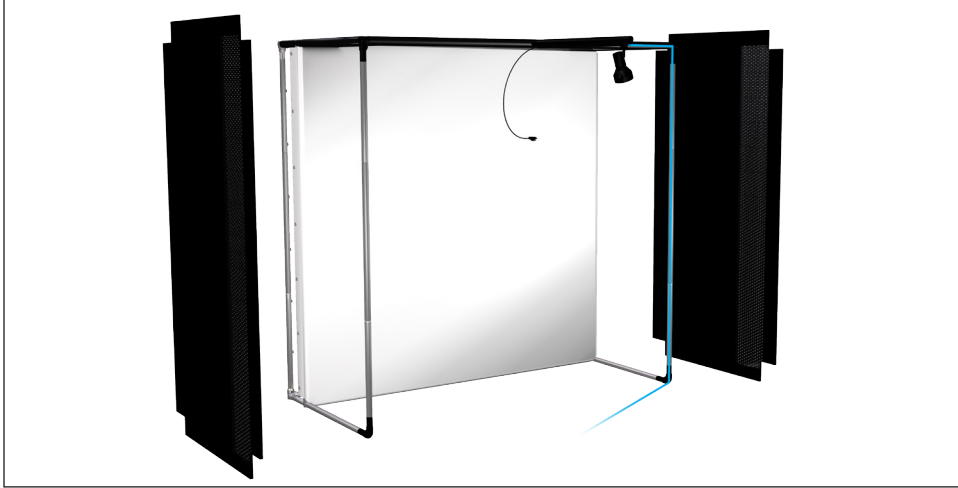

Second, attach the front edges by stretching the fabric around the frame and attaching the fabric back onto itself using the Velcro. Wrap any cables to the frame at this time.

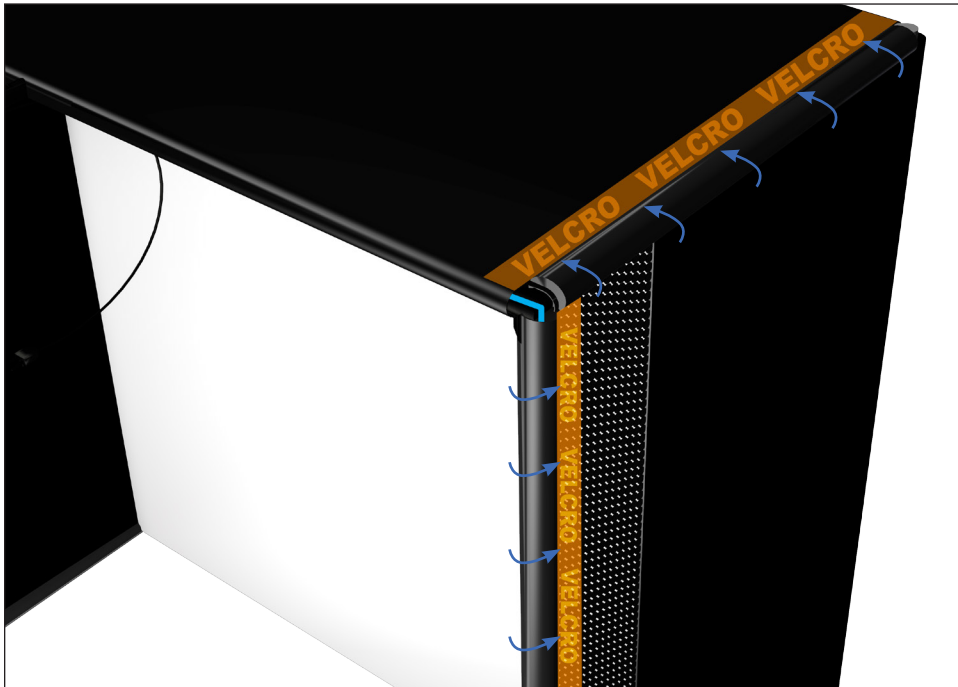

Next, attach the bottom edges using the same technique, stretch the fabric around the frame and attaching the fabric back onto itself using the Velcro.

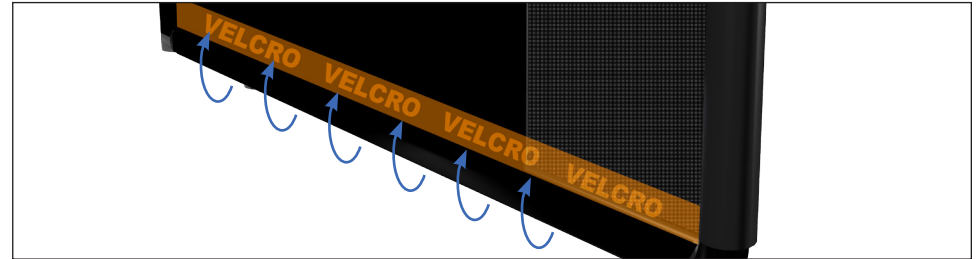

Lastly, attach the back edges by stretching the fabric around the frame and attaching the fabric back onto itself using the Velcro.

**STEP 3 | AWNING**

Attach the BRIM and the TRUGOLF BANNER to the top front edge of the simulator using the integrated Velcro. Start at the middle of the banner, attaching it around the LIGHT BAR [27], then move towards the sides.

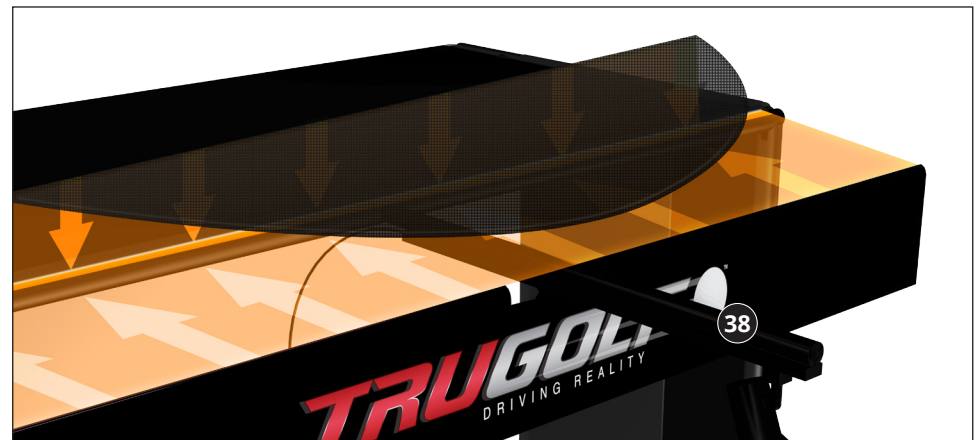

**STEP 4 | SIDE BAFFLES & NETS**

Attach the SCREEN BAFFLES to the SIDE WALLS using the integrated Velcro. Next, attach the SIDE NETS to the front outside edge of the SIDE WALLS. Fill WEIGHT BAGS with heavy material and connect to SIDE NETS.

*NOTE: Do not use liquid.*

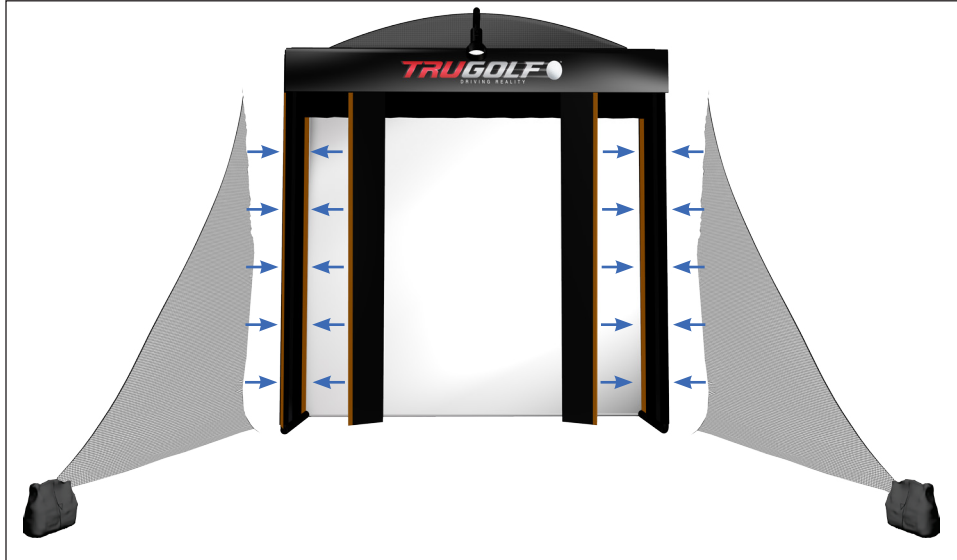
**FLOOR****STEP 1 | TURF & PLATFORM**

Unfold the TURF and place on the floor within the enclosure as shown below. Assemble the raised HITTING PLATFORM and position at front edge of turf.

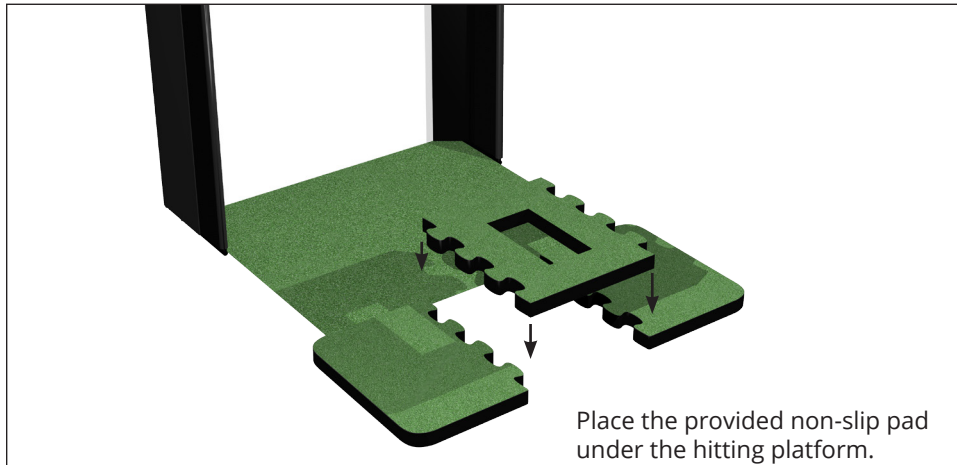
**WIRING****STEP 1 | CABLES**

First, run SERIAL CABLE and VIDEO CABLE under the TURF and HITTING PLATFORM to the center cutout. (SERIAL CABLE will be connected to the COMPUTER later.)

Next, run the **LEFT (15ft), RIGHT (15ft), & TOP (25ft)** BNC MICROPHONE CABLES to the center cutout in the raised HITTING PLATFORM.

*NOTE: Minimum 18 inches of slack on all cables connecting to the TruTrack Hitting Mat.*

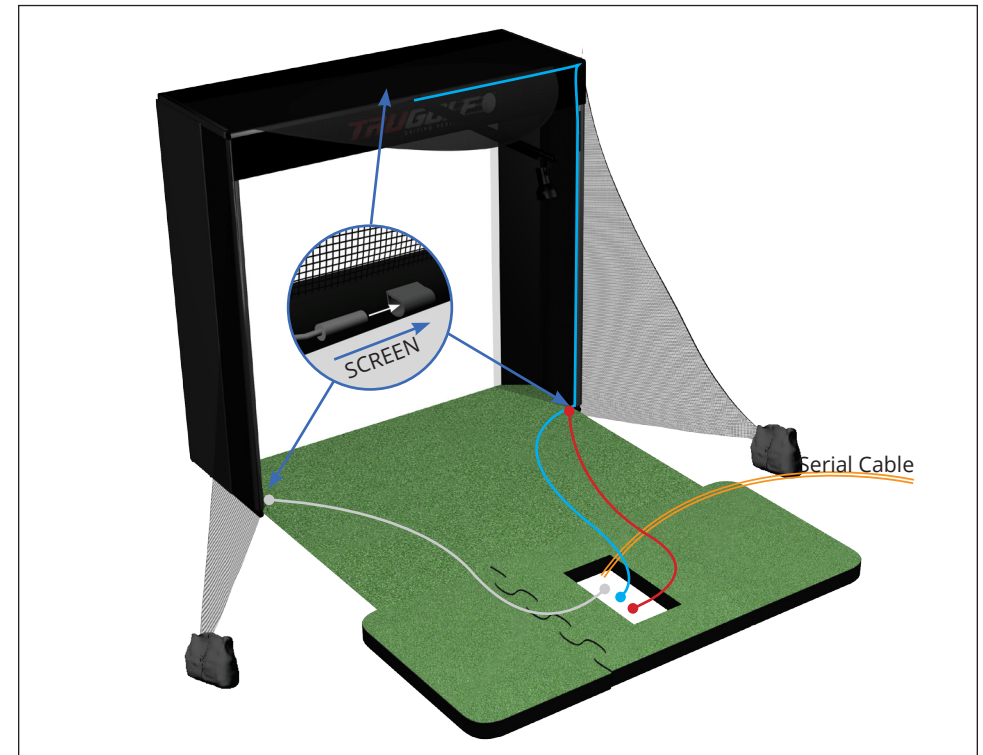
**STEP 2 | MICROPHONES**

Connect MICROPHONE to by twisting connections & place through hole and into sleeve with microphone pointing towards the screen.

*NOTE: An extra (1) microphone is included as a spare.*



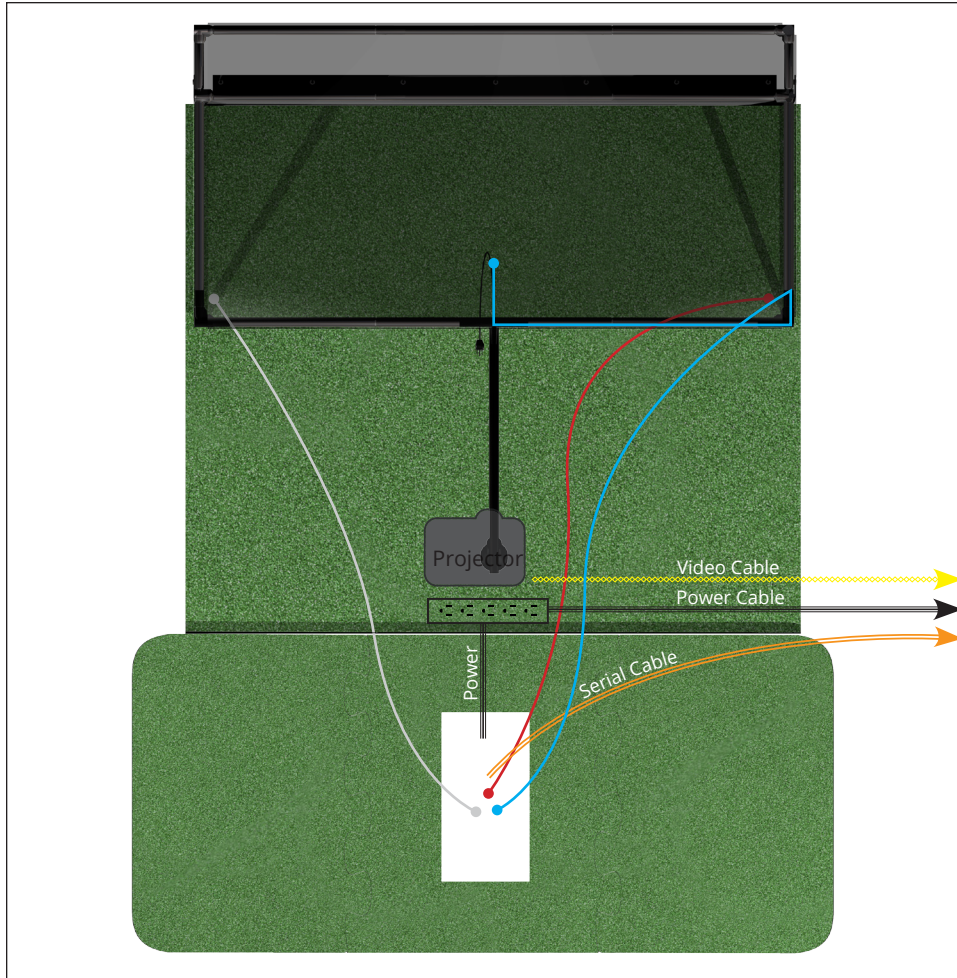

### STEP 3 | HITTING MAT

Connect the RIBBON CABLE on the HITTING MAT to the TRUTRACK CONTROL BOX.

Connect the POWER CABLE, SERIAL CABLE, and the BNC CABLES (x3) from the microphones to the TRUTRACK CONTROL BOX.

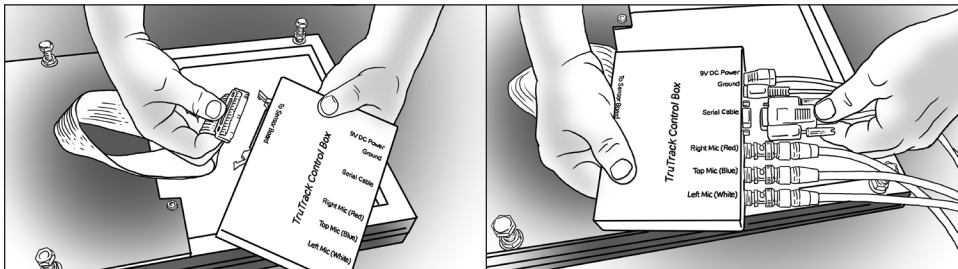

If needed, adjust the Hitting Mat legs so they are level with floor height. Finish by pushing Hitting Mat down into the floor opening.

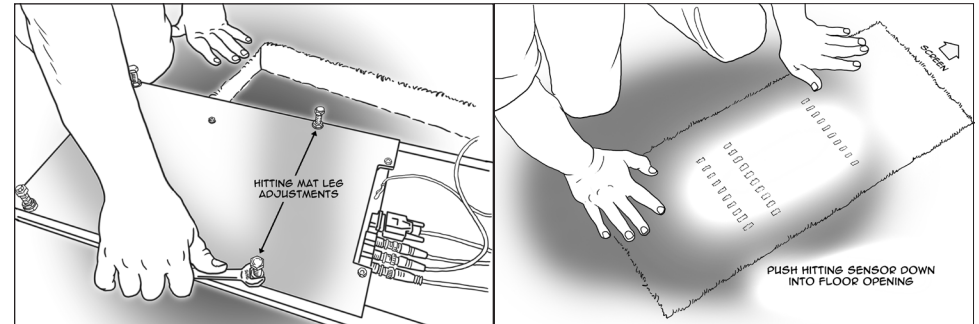

### STEP 4 | PROJECTOR

Position PROJECTOR so that lens is centered with the screen. Connect POWER CABLE and VIDEO CABLE to projector.

*NOTE: See Projector Manual for further instructions on adjusting the image.*

### STEP 5 | PROJECTOR COVER

Plug COVER FANS into POWER STRIP. Place COVER over projector.

*NOTE: Do Not scratch projector lens with projector cover. TruGolf will not replace projectors with scratched lens.*

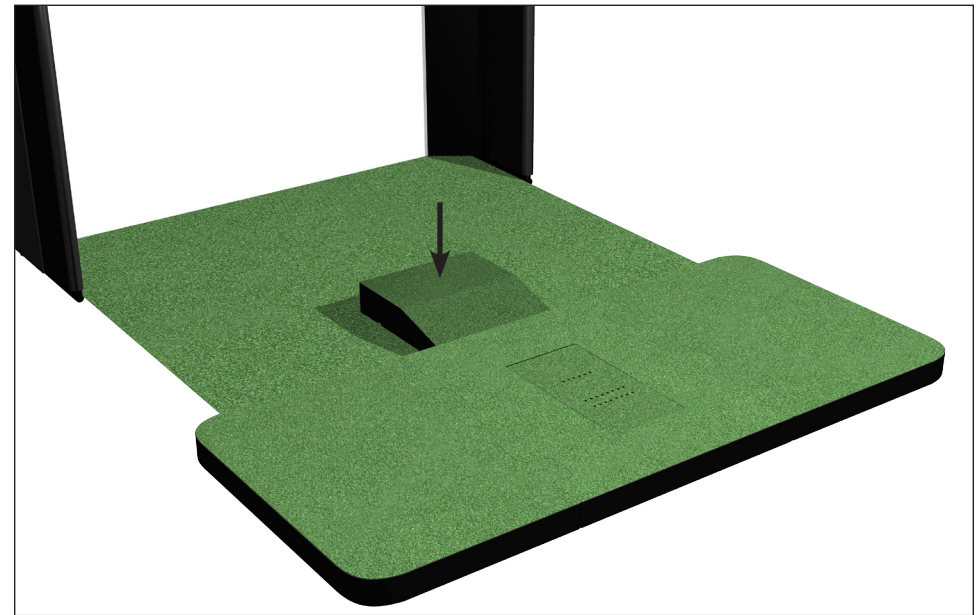



# COMPUTER COMPONENTS DIAGRAM

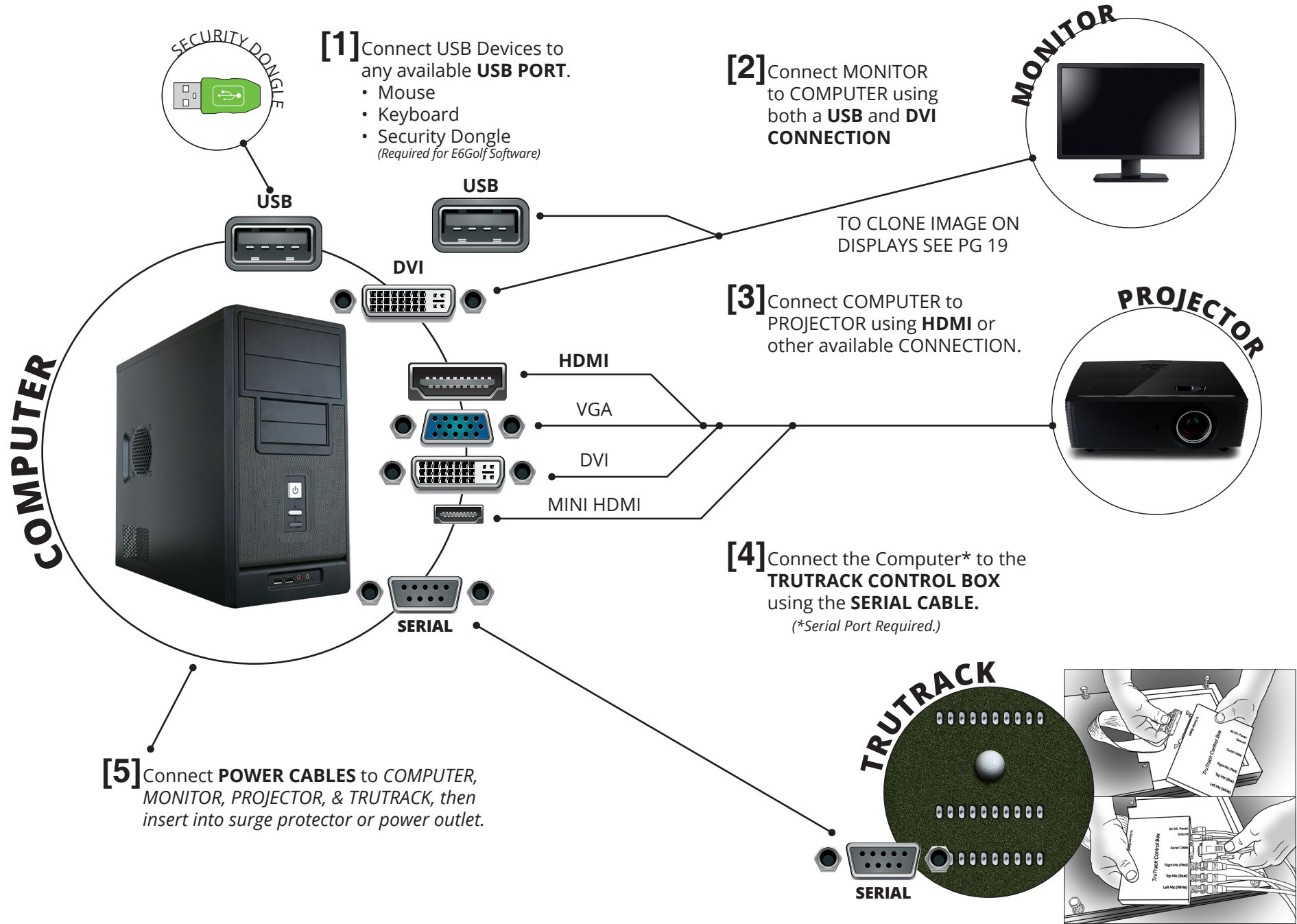

## OVERHEAD LIGHT INSTRUCTIONS

### INSTALLATION

1. Push the top portion of the head adapter into the slot of the track section.
2. Pull down the adapter's locking tab.
3. Turn "Ground Indicator" tab towards the ground groove on track to align ground tab with ground conductor.
4. Move adapter to the **end of the track closest to the Hitting Mat. Aim the lighting fixture at the club head sensors.**

### REMOVAL

1. Pull down the adapter's locking tab.
2. At the same time, rotate the adapter 90 degrees and remove from track.

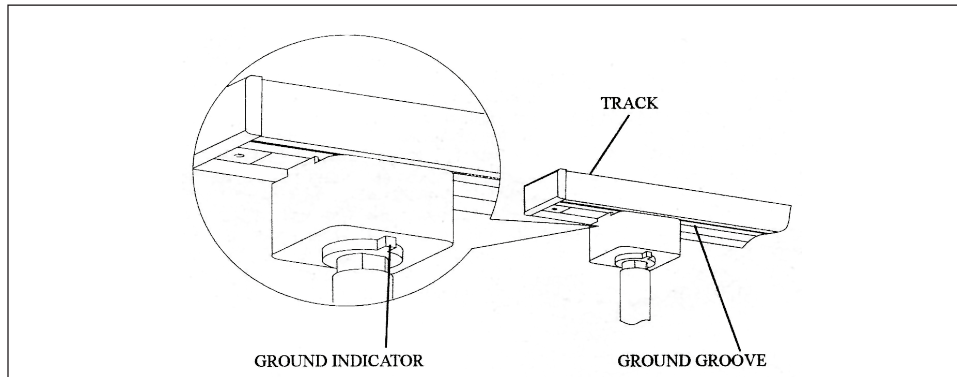

**CAUTION:** Refer to the re-lamping label located on the fixture for recommended maximum wattage. Adapter is designed to lock into the track section by turning adapter in one direction only. Turn the "ground indicator" tab towards the "ground groove" on the track to align the ground tab with the ground conductor inside the track.

### INSTALLING NEW BULB OR RE-LAMPING

1. Turning the power off. Make sure that the bulb is cool before re-lamping the fixture.
2. Remove the head from the track. The track head sleeve must be pulled down then twist 1/4 turn.
3. Twist to remove bulb from the socket, replace with new bulb.
4. Replace the track head onto the track. Pull down the locking sleeve and reverse the 1/4 turn.



OVERHEAD LIGHT MUST BE POSITIONED TO LIGHT THE 3 ROWS OF SENSORS ON THE HITTING MAT. OVERHEAD LIGHT MUST BE ON WHILE PLAYING.

## CLONE DISPLAYS

There are two methods to set up multiple monitors in Windows 7. Make sure that you connect the external monitors to your laptop or your desktop computer first.

### METHOD 1:

1. Press the **Windows logo key + P** on your keyboard.

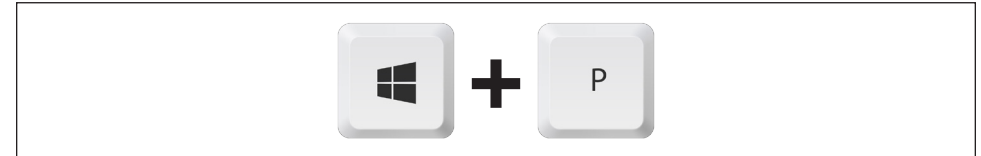

2. Select the **DUPLICATE** option

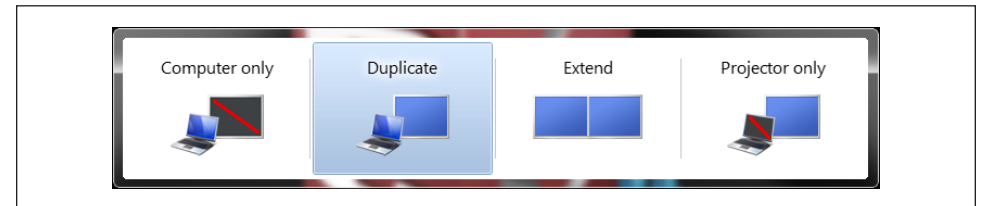

### METHOD 2:

1. **Right-click** any empty area of your desktop, and then click **Screen resolution**.
2. Click the Multiple displays drop-down list, and then select **Duplicate these displays**.

*Note: If you cannot see the additional monitor(s) listed, click Detect. If does not work, try restarting your computer and do step 1 to 2 again.*

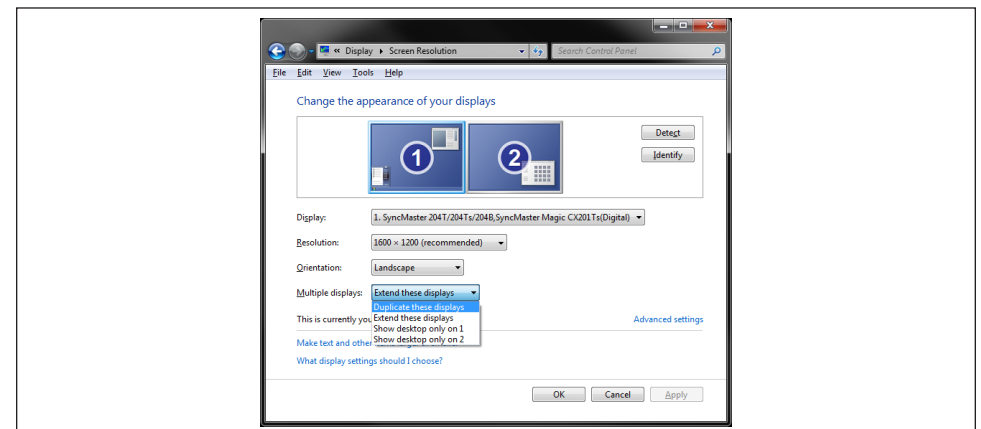
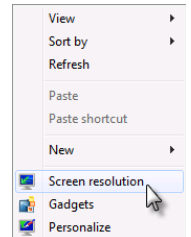

## BALL PLACEMENT: FULL SHOTS

DRIVER, WOODS, HYBRIDS & IRONS

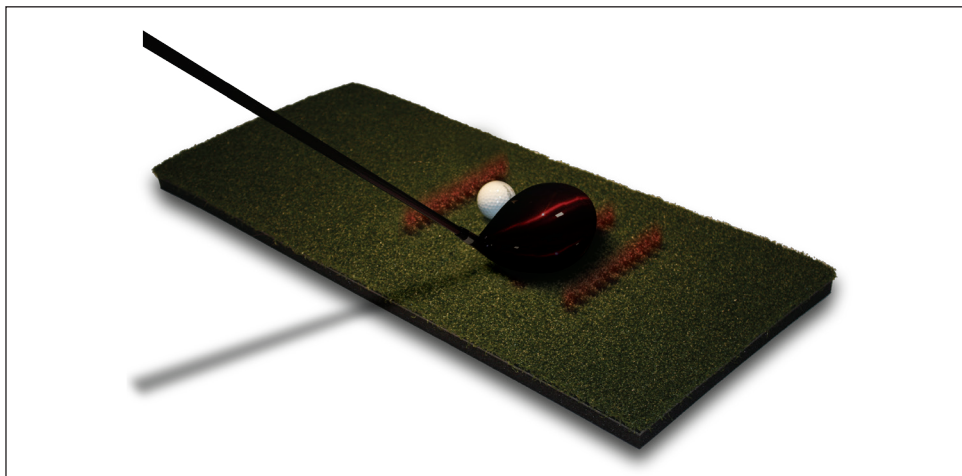

Place the ball on a tee between the FRONT and MIDDLE row of sensor holes closest to the screen. As your club passes over the sensors on its way to make contact with the ball, critical information is gathered helping determine the speed, path, and face angle of the club.

*NOTE: Rubber tees should be used just as one would use them in outdoor golf. The use of tees does not change ball placement specifications.*

## BALL PLACEMENT: PUTTING



For a putt, place the ball BEHIND the back row of sensor holes (3-4"), and then follow through to hit the putt. The speed and direction of PUTTS are determined exclusively by the movement of the ball over the THREE ROWS of sensor holes.

## TROUBLESHOOTING

### ERROR MESSAGE

*"No TruTrack system was found. Please make sure the system is plugged in and restart E6Golf."* Do the following:

1. Check all connections on TruTrack Hitting Mat.
2. Check that the TruTrack Power and Ground Cables are plugged in.
3. Check that the Power Strip is plugged in and turned on.

### SHOTS ARE NOT REGISTERING WHEN I HIT

1. Make sure the overhead spot light is turned on and the beam is focused on the 3 rows of sensors.
2. When chipping or putting be sure your head or body doesn't cast a shadow over the sensors, this will cause the sensors not to see the club head or ball pass over, resulting in no shot data being sent to E6Golf.
3. Make sure your club head is passing over each row of sensors as the club hits the ball. If the club head misses passing over the first or last row of sensors no shot will be detected.
4. Solid golf shots hit directly into the golf image screen are best detected by the tracking system. Shots hit into the netting above or to the side of the booth will not be detected.

### STATIC

Static electricity affects the TruTrack sensor system's ability to detect your shot. Static issues often present themselves through blinking club sensors or ball impact sensors in E6Golf's DIAGNOSTICS feature.

Run DIAGNOSTICS (see pg 22). Static may be the issue if you have one or more of the following indicators:

1. Optical sensors are flashing, and nothing is blocking the overhead light from shining on them
2. Acoustic sensors are flashing and there is no noise or vibration happening to/around the ball sensors

Static electricity is increased in low humidity. Environments using high levels of heating, air-conditioning, or those with a lot of insulation can have low humidity.

### REDUCE STATIC BY TRYING THE FOLLOWING:

1. Using a humidifier
2. Avoid installing on varnished or epoxy finished floors
3. Unplug sensors overnight for static to dissipate out
4. Use Industrial Grade Static Spray

TruGolf supplies Industrial Grade Static Spray for use with high static environments. Spray 3-4 feet above the club and ball sensors, as well as the Technique enclosure. Spray should be applied after vacuuming the club surface area. Spraying daily may be necessary.



## DIAGNOSTICS

E6Golf has built in DIAGNOSTICS to help troubleshoot the TruTrack tracking system. DIAGNOSTICS will automatically run if there is a problem when you launch E6Golf, Exit Practice or a Round to return to the Main Menu.

*NOTE: You can also access the DIAGNOSTICS from the Main Menu > Options or In-game by selecting the E6 icon, then select the DIAGNOSTICS option.*

There are several possibilities that may cause the DIAGNOSTICS to run.

1. Overhead light is off.
2. One or more Optical Sensors are covered.
3. Overhead light is turned on, but the beam is not focused within the yellow dashed lines as shown below.

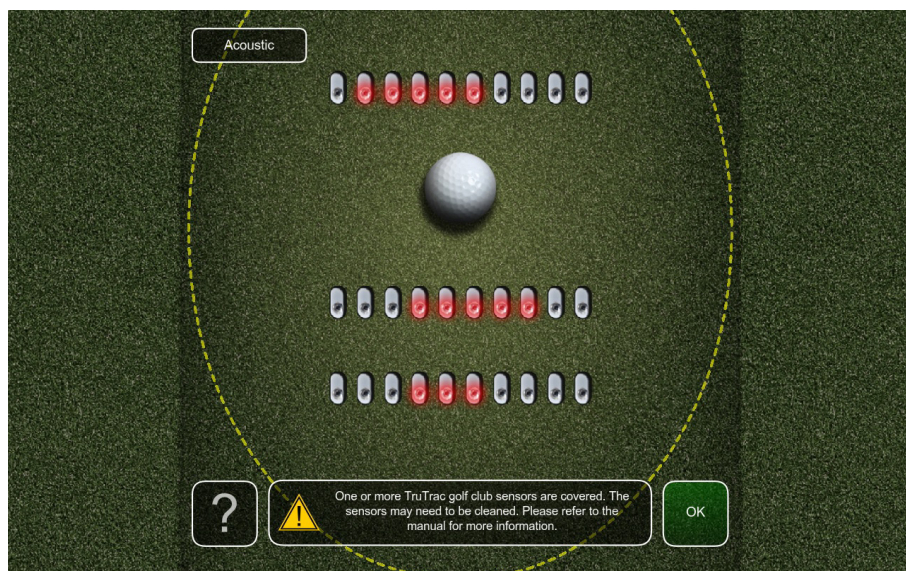

## OPTICAL SENSORS

Blocked or covered sensors are indicated in red.

Keep the sensor holes clear of any debris or overhanging grass turf that would block their view of the spotlight. If sensors are blocked, follow these steps:

1. Trim any overhanging grass with a pair of scissors
2. Vacuum an debris or grass trimmings from the holes

Club Head Sensors are working correctly, if you move a golf club just above a row of sensors, the sensors should change to red corresponding to the position of the club over the associated sensors.

To access the ACOUSTIC DIAGNOSTICS select the ACOUSTIC button at the top of the screen or click OK to return to E6Golf.

## ACOUSTIC SENSORS

ACOUSTICS DIAGNOSTICS allows you to test and verify connections of the three acoustic ball impact sensors. One is located in the top center of the frame and the other two are located near the floor on the right and left sides of the frame (refer to pg 13). Each of the bars correspond to an acoustic ball sensor of their same color.

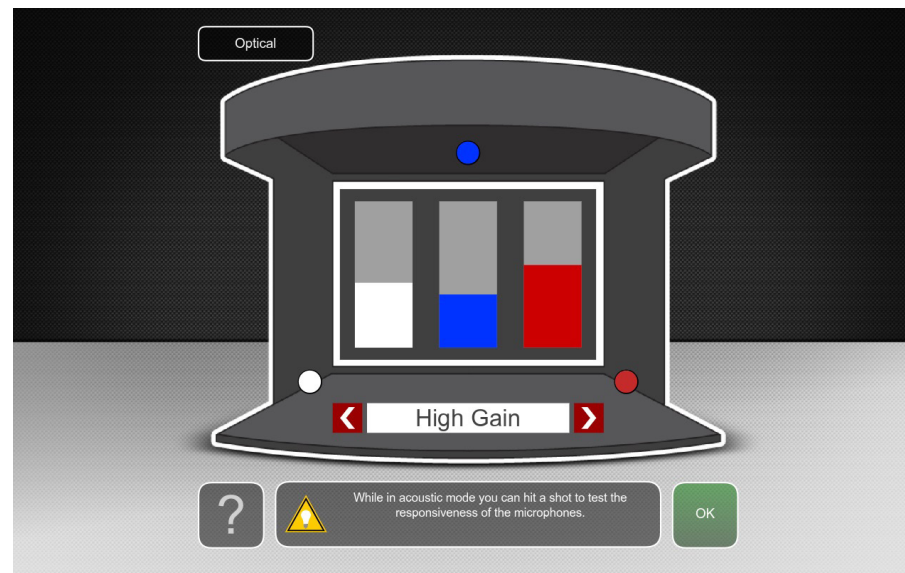

Tap each sensor and verify that the corresponding color bar responds. If incorrect, connect the correct mic cables to TruTrack. Do this until all sensors are connected correctly.

If any of the indicator bars do not respond when the ball is hit or tapped, this could indicated one or more of the follow:

1. Microphone is not connected to the cable.
2. Cable is not connected to TruTrack (see pg 14).
3. Microphone is covered.
4. Microphone or cable is defective.

If one or more sensors is nonresponsive replace microphones with the extras that were sent with the simulator. Tap sensors to verify that the related indicated bar is reacting, if not or to order addition mics contact TruGolf Customer Support.

To access the OPTICAL DIAGNOSTICS select the OPTICAL button at the top of the screen or click OK to return to E6Golf.







**TRUGOLF**   
DRIVING REALITY

Contact Sales please call  
866-711-GOLF or 801-298-1997

Customer Support please call  
877-711-6691 or 801-677-1123

TRUGOLF.COM