

# ULTRAPINS®

## TREATED STRAIGHT PINS

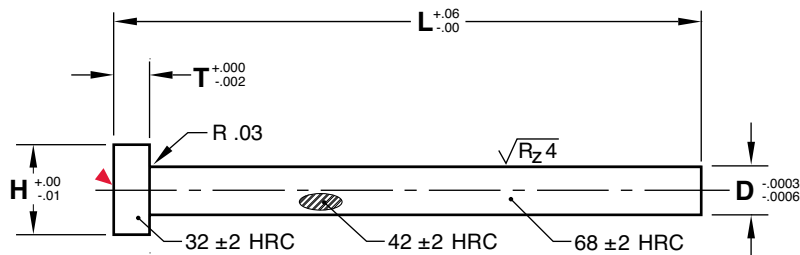

**M** H-13 **H** Core: 40-44 HRC, Surface:66-70 HRC **S** Chrome Plated: .00005-.00007" Thick ▶ CAD insertion point

Nominal Diameter	D Actual Diameter	H	T	L=6"	L=10"	L=14"	D Actual Oversized Pin Diam.	L=10" D .005 Oversize
				D Standard	D Standard	D Standard		
1/8	.1247 .1244	.25	.125	EPL125L6	EPL125L10	—	.1297 .1294	EPL130L10
5/32	.1560 .1557	.28	.156	EPL156L6	EPL156L10	—	.1610 .1607	EPL161L10
3/16	.1872 .1869	.37	.187	EPL187L6	EPL187L10	—	.1922 .1919	EPL192L10
7/32	.2185 .2182	.40	.187	EPL219L6	EPL219L10	—	.2235 .2232	EPL224L10
1/4	.2497 .2494	.43	.187	EPL250L6	EPL250L10	EPL250 L14	.2547 .2544	EPL255L10
5/16	.3122 .3119	.50	.250	—	EPL312L10	EPL312 L14	—	—
3/8	.3747 .3744	.62	.250	—	EPL375L10	EPL375 L14	—	—
1/2	.4997 .4994	.75	.250	—	EPL500L10	EPL500 L14	—	—

### Application Information:

- Maximum operating temperature: 1600° F (870° C)
- Not recommended for use with PVC or similarly corrosive materials.
- Contact Customer Service for availability on other diameters and lengths not shown.



# ULTRAPINS<sup>®</sup> TREATED SHOULDER PINS

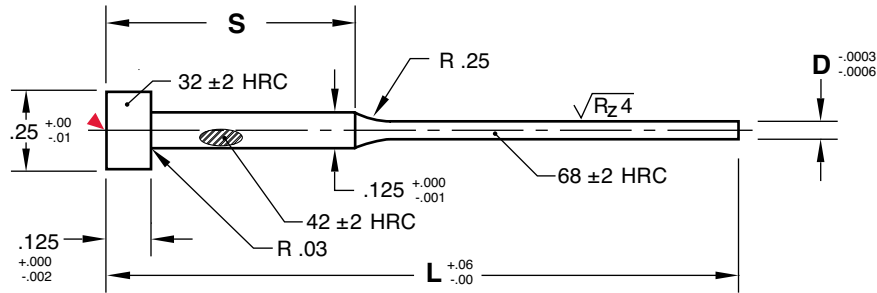

**M** H-13 **H** Core: 40-44 HRC, Surface: 66-70 HRC

**S** Chrome Plated: .00005-.00007" Thick

▶ CAD insertion point

Nominal Diameter	D Actual Diameter	S Shoulder Diameter	L=6" D Standard	L=10" D Standard	D Actual Oversized Pin Diameter	L=10" .005 Oversize
<b>1/32</b>	.0310 .0307	1/2	EPL031L6-05	—	—	—
		2	EPL031L6-20	—	—	—
<b>3/64</b>	.0466 .0463	1/2	EPL047L6-05	—	.0516 .0513	EPL052L10-05
		2	EPL047L6-20	EPL047L10-20		EPL052L10-20
<b>1/16</b>	.0622 .0619	1/2	EPL062L6-05	—	.0672 .0669	EPL067L10-05
		2	EPL062L6-20	EPL062L10-20		EPL067L10-20
<b>5/64</b>	.0778 .0775	1/2	EPL078L6-05	—	.0828 .0825	EPL083L10-05
		2	EPL078L6-20	EPL078L10-20		EPL083L10-20
<b>3/32</b>	.0935 .0932	1/2	EPL094L6-05	—	.0985 .0982	EPL099L10-05
		2	EPL094L6-20	EPL094L10-20		EPL099L10-20
<b>7/64</b>	.1091 .1088	1/2	EPL109L6-05	—	.1141 .1138	EPL114L10-05
		2	EPL109L6-20	EPL109L10-20		EPL114L10-20

## Application Information:

- Maximum operating temperature: 1600° F (870° C)
- Not recommended for use with PVC or similarly corrosive materials.
- Contact Customer Service for availability on other diameters and lengths not shown.