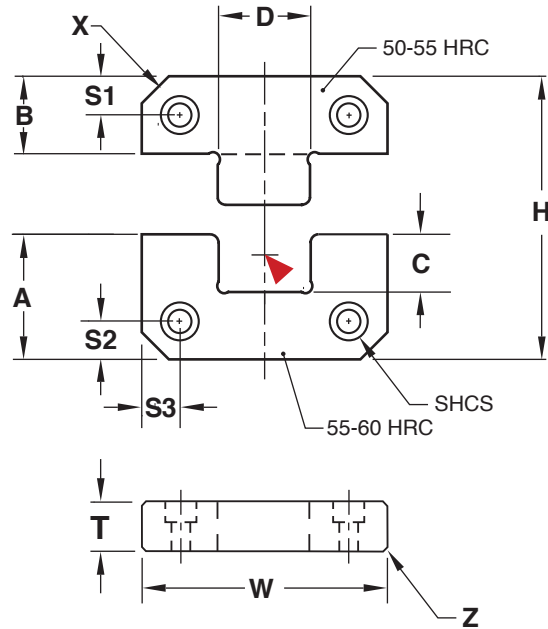

SIDE LOCKS

INCH STANDARD

Female: **M** 0-2 **H** 55-60 HRCMale: **M** 0-2 **H** 50-55 HRC

CAD insertion point

CATALOG NUMBER	T +.000 -.002	W +.0000 -.0004	A +.0000 -.0008	B +.0000 -.0008	C	D .0001/.0003 Clearance Per Side	H +.000 -.002	X Corner Chamfer	Z Chamfer	S1 ±.01	S2 ±.01	S3 ±.01	SHCS
SLS62X150	.620	1.500	.870	.870	.33	.500	1.74	.19	.02	.437	.281	.281	1/4-20 x 3/4"
SLS62X200	.620	2.000	.870	.870	.33	.680	1.74	.19	.04	.437	.375	.375	1/4-20 x 3/4"
SLS75X300	.745	3.000	1.370	1.360	.57	1.000	2.73	.38	.04	.688	.688	.375	3/8-16 x 1"
SLS75X400	.745	4.000	1.870	1.870	.79	1.375	3.74	.50	.04	.875	.875	.625	3/8-16 x 1"
SLS112X500	1.120	5.000	1.870	1.870	.79	1.750	3.74	.50	.04	.875	.875	.750	1/2-13 x 1-1/4"

Screws included.

METRIC STANDARD

CATALOG NUMBER	T +.00 -.05	W +.00 -.01	A +.00 -.02	B +.00 -.02	C	D .002/.008 Clearance Per Side	H +.00 -.04	X Corner Chamfer	Z Chamfer	S1/S2 ±.2	S3 ±.2	SHCS
SLMS13X38	13	38	22	22	8.5	12	44	5	.5	7	8	M5-.8 x 15
SLMS16X50	16	50	21.5	21.5	9.5	17	43	5	1	11	8	M6-1.0 x 18
SLMS19X75	19	75	36	36	15	25	72	8	1	18	12.5	M10-1.5 x 20
SLMS19X100	19	100	45	45	21	35	90	10	1	22	15	M10-1.5 x 20
SLMS25X125	25	125	45	45	21	45	90	10	1	22	20.5	M10-1.5 x 25

Screws included.