

SIDE LOCKS

NEEDLE BEARING - INCH STANDARD

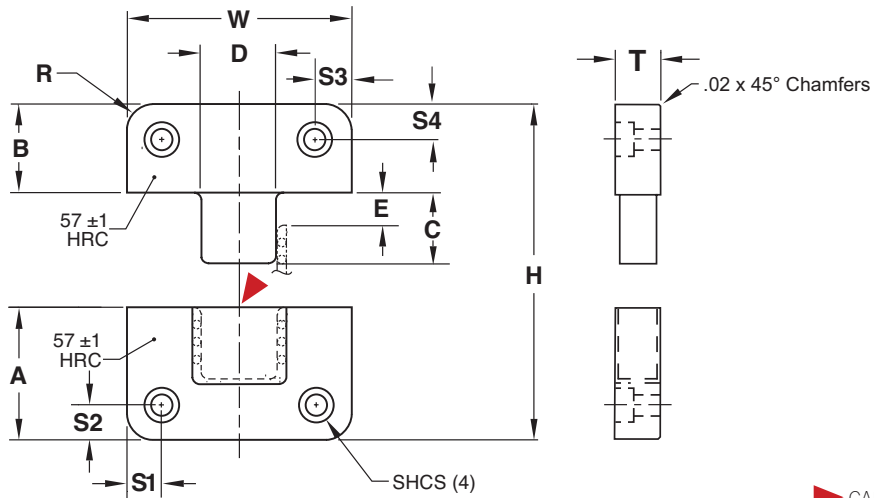

M 0-2 **H** 56-58 HRC **S** Black Oxide

CAD insertion point

CATALOG NUMBER	T +0.00 -0.05	W ±0.002	W Pocket Width +0.0005 -0.0000	A +0.00 -0.05	B +0.00 -0.05	C	D	E	H +0.00 -0.04	R Pocket Radius	S1 ±0.01	S2 ±0.01	S3 ±0.01	S4 ±0.01	SHCS
SLR50X125	.500	1.2495	1.250	1.375	.875	.66	.412	.210	2.250	.187	.171	.250	.171	.437	#8-32 x 5/8"
SLR50X150	.500	1.4995	1.500	.875	.875	.40	.500	.210	1.750	.187	.250	.250	.250	.250	#8-32 x 5/8"
SLR50X150-L	.500	1.4995	1.500	1.375	.875	.66	.550	.250	2.250	.187	.182	.376	.182	.500	#8-32 x 5/8"
SLR50X200	.500	1.9995	2.000	1.375	.875	.66	.750	.325	2.250	.187	.312	.312	.312	.312	#10-32 x 5/8"
SLR75X300	.750	2.9995	3.000	1.875	.875	.95	1.188	.575	2.750	.250	.375	.375	.375	.375	1/4-20 x 3/4"
SLR100X400	1.000	3.9995	4.000	2.375	1.375	1.34	1.855	.450	3.750	.500	.500	.500	.500	.500	3/8-16 x 1-1/8"

For technical information, refer to page C-13. Note: Cages are manufactured from resin or aluminium, depending on size.

Screws included.

NEEDLE BEARING - METRIC STANDARD

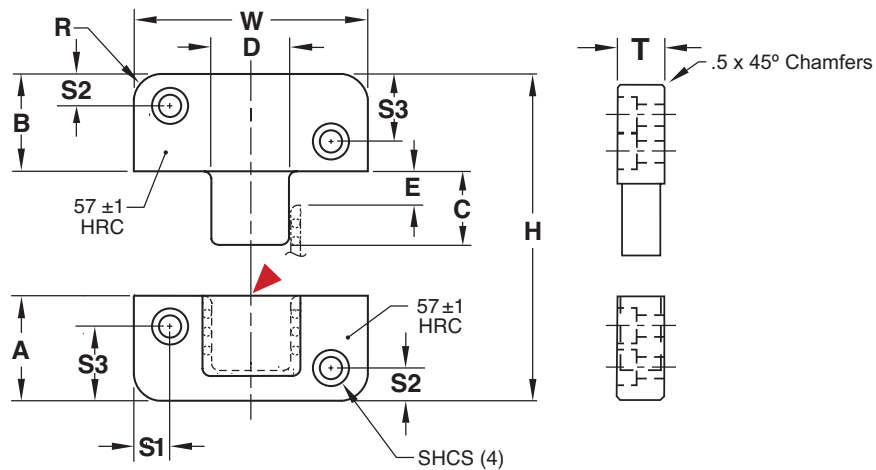

M 0-2 **H** 56-58 HRC **S** Black Oxide

CATALOG NUMBER	T +0.0 -0.12	W ±0.005	W Pocket Width +0.012 -0.0000	A +0.0 -0.12	B +0.0 -0.12	C	D	E	H +0.0 -0.1	R Pocket Radius	S1 ±0.25	S2 ±0.25	S3 ±0.25	SHCS
SLRM32X63	32	62.9	63	46	46	27	21	12.1	92	8	9	11	35	M8-1.25 x 35
SLRM40X100	40	99.9	100	66	66	36	33	19.5	132	10	13	18	48	M12-1.75 x 45

For technical information, refer to page C-13. Note: Cages are manufactured from resin or aluminium, depending on size.

Screws included.