



**Ag Connects**

## QUICK HITCH



**PART #25-040 CAT1 E-HITCH**

**PART # 25-005 CAT 1 QUICK HITCH**

**PART # 25-010 CAT 2 QUICK HITCH**

**PART # 25-019 CAT 2HD QUICK HITCH**

**PART # 25-020 CAT 3 QUICK HITCH**

**PART # 25-021 CAT 3 NARROW QUICK HITCH**

**PART # 25-022 CAT 2/3 QUICK HITCH**

# Operation Manual



This safety alert symbol identifies important safety messages in this manual. Failure to follow this important safety information may result in serious injury or death.



# TABLE OF CONTENTS

Intended Use .....	4
Personal Protective Equipment .....	4
General Safety .....	5
Assembly Instructions .....	6
Operation Instructions .....	8
Removal Instructions .....	10
Maintenance .....	11
Parts List CAT 1 Quick Hitch .....	12
Parts List CAT 2, 2HD, 3, 3N, 2/3 Quick Hitch .....	13
Warranty & Specifications .....	14
Registration .....	15

# IMPORTANT SAFETY INFORMATION



**WARNING**

## **WARNING:**

Read and thoroughly understand all instructions and safety information before assembling or operating this quick hitch. Failure to do so may cause serious injury or death. Do not allow anyone to operate this quick hitch who has not read this manual. A quick hitch can be dangerous if assembled or used improperly. Do not operate if you have doubts or questions concerning safe operation.

Call our customer service department at 720-437-7640, or email at [customerservice@tooltuffdirect.com](mailto:customerservice@tooltuffdirect.com) if you have any questions or concerns about the safe operation of this equipment.



**DANGER**

## **INTENDED USE**

The quick hitch is intended to speed the attachment of 3-point implements to a tractor.

Do not use the quick hitch for any purpose other than connecting a 3-point implement to a tractor.

## **PERSONAL PROTECTIVE EQUIPMENT:**

When operating this quick hitch it is essential that you wear safety gear including steel toe shoes and tight fitting gloves (no loose cuffs or draw strings).



## IMPORTANT SAFETY INFORMATION



### GENERAL SAFETY

Failure to follow warnings, cautions, assembly and operation instructions in the Operation Manual may result in serious injury or death.

#### Read the Operation Manual before operation.

- **Do not** permit children to operate this equipment at any time. Do not permit others that have not read and understood the complete Operation Manual to operate this equipment.
- Keep all people and pets a minimum of 10 feet away from the area where you connect the implement to the quick hitch.
- **Do not** operate the quick hitch when under the influence of alcohol, drugs or medication.
- **Do not** allow a person who is tired or otherwise impaired or not completely alert to operate the quick hitch.
- **Read the Tractor's operation manual** concerning the proper attachment and how to safely use a 3-point quick hitch.



DANGER

**ALWAYS OPERATE THIS QUICK HITCH FROM THE TRACTOR SEAT.**

**DO NOT ATTACH THE QUICK HITCH TO THE TRACTOR WITH THE ENGINE RUNNING.**

**DO NOT OPERATE THE QUICK HITCH WITH ANYONE IN CONTACT WITH ANY PART OF THE IMPLEMENT, PTO DRIVELINE OR MOVING PARTS.**

**SERIOUS INJURY CAN RESULT FROM ENTANGLEMENT WITH MOVING PARTS.**

- **NEVER** connect an implement to the quick hitch that does not connect directly to your tractor without a quick hitch. The implement must be approved for your tractor. (Check your tractor's manual for further information.) The purpose of the quick hitch is to act as a faster method of connecting previously connected implements to your tractor. The category of the tractor *must match* the category of the quick hitch *and* implement.

The only exception to this is that the CAT 2/3 quick hitch allows a CAT 2 tractor to connect to a CAT 3 implement.

- Always make sure that your tractor is capable of operating the implement.

# ASSEMBLY INSTRUCTIONS

## INSTRUCTIONS TO ATTACH THE 3-PT OF THE TRACTOR TO THE QUICK HITCH

### STEP 1:

Lower the tractor lift arms. Place the tractor lift arms in the slots of the quick hitch and align the holes. CAT 2 & 3 models have two slots to connect the tractor a-arms: The inside slot is for CAT 2 tractors and the outside slot is for CAT 3 tractors.

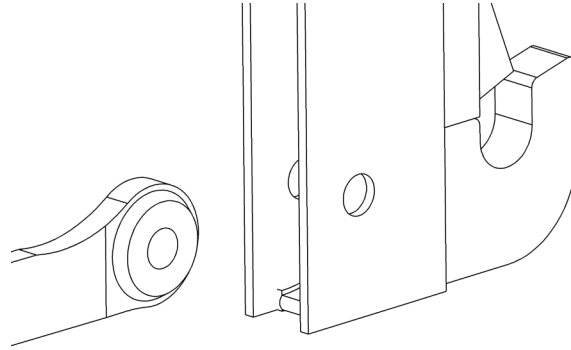

### STEP 2:

Connect the a-arm to the quick hitch using the lower arm pin [1] and lynch pin [2]

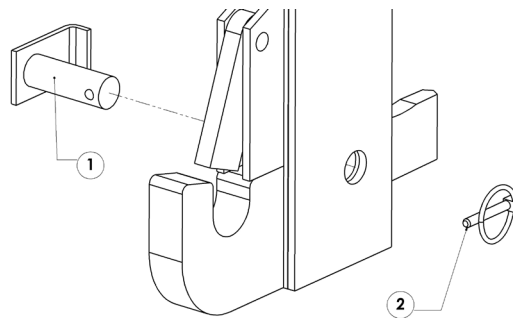

### STEP 3:

Place the tractor top link within the upper slot of the quick hitch and align the holes.

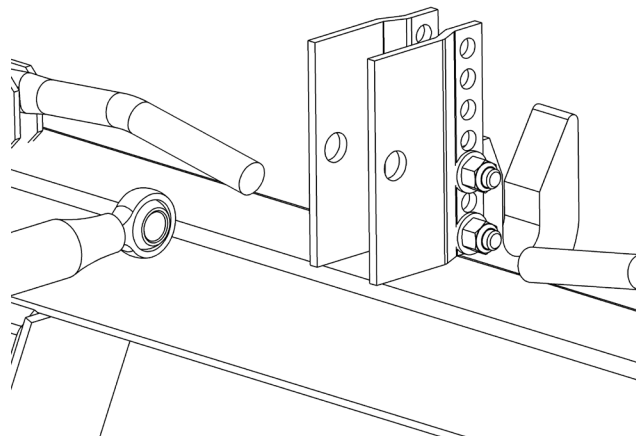

# ASSEMBLY INSTRUCTIONS

## STEP 4:

Connect the top link with the top link pin [1] and lynch pin [2] provided.

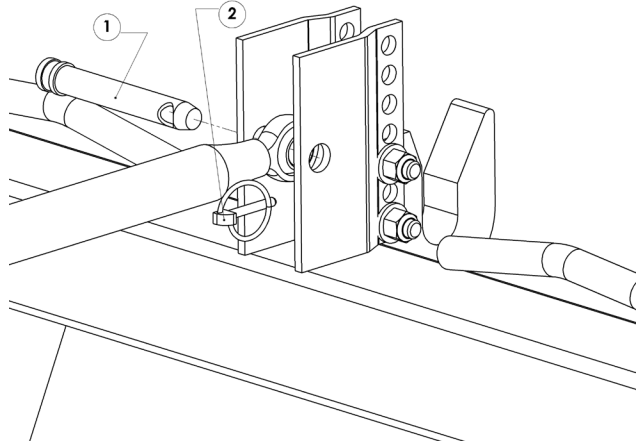

## INSTRUCTIONS TO ATTACH THE IMPLEMENT TO THE QUICK HITCH

### STEP 1:

Generally, bushings are required to connect your implement to the quick hitch. The bushings widen the diameter of the implement's lower hitch pin to fit snugly into the hooks on the quick hitch.

***Bushings are not used on the CAT 1 E-Hitch. The lower hooks of the E-Hitch are sized for CAT 1 7/8" lift arm pins.***

The bushings are shipped with roll pins already inserted. You must remove these before they can be installed onto your implement. Removing the roll pins requires a hammer and punch, and possibly a vise to hold them steady. Once you have removed the roll pins, slide the bushings over the hitch pins. Secure the bushing in place with the roll pins. A hammer will be needed to force the roll pin in place.

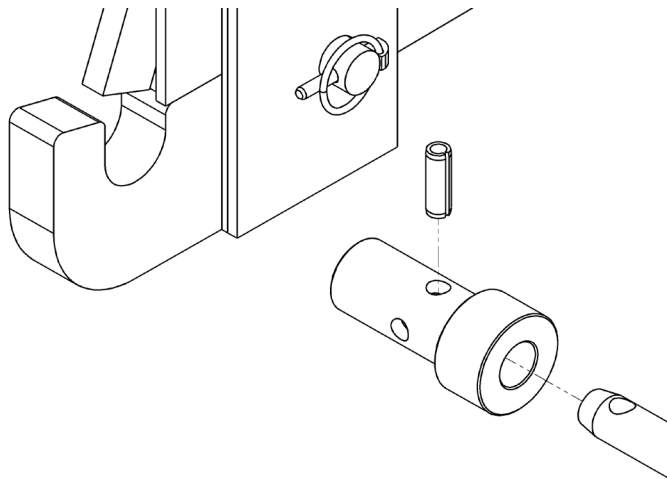

# OPERATING INSTRUCTIONS

## STEP 2:

Move the tractor to position the quick hitch's lower hooks below the implements bushings or lower hitch pin. Position the hook of the quick hitch below the mast pin of the implement.

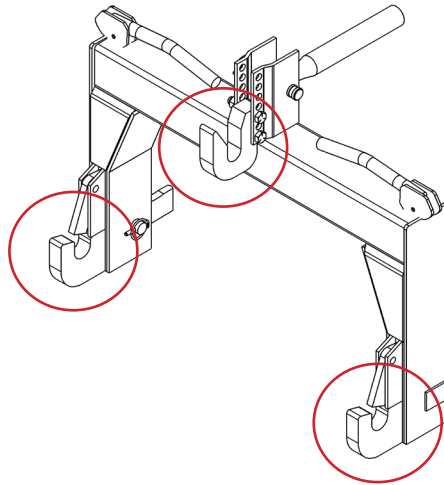

## STEP 3:

Raise the a-arms of the tractor to lift the implement. Verify that the bushings or lower hitch pins set completely within the quick hitch lower hooks and the mast pin captured by the quick hitch upper hook.

## STEP 4:

Connect the driveline from the implement to the tractor if the implement requires. See the tractor's owner's manual for instructions on how to connect a driveline.

## EXCEPTIONS:

The CAT 1 quick hitch allows the use of non-standard implements.

**If the mast pin or the lower hitch pins of the implement do not set all the way in the hooks, it might be necessary to raise or lower the top hook of the quick hitch. It may require a few tries to get the hook in the right location.**

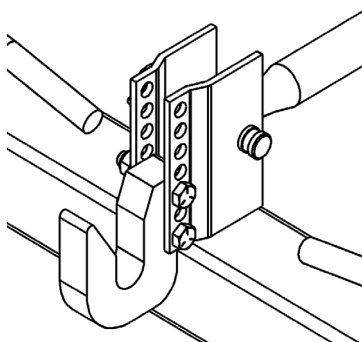



# OPERATING INSTRUCTIONS

Some Non-standard CAT 1 implements may require the use of the CAT 1 quick hitch adapter. Follow the below steps to attach the quick hitch to non-standard implements.

## STEP 1:

Remove the upper hook by removing the hex bolts and nuts.

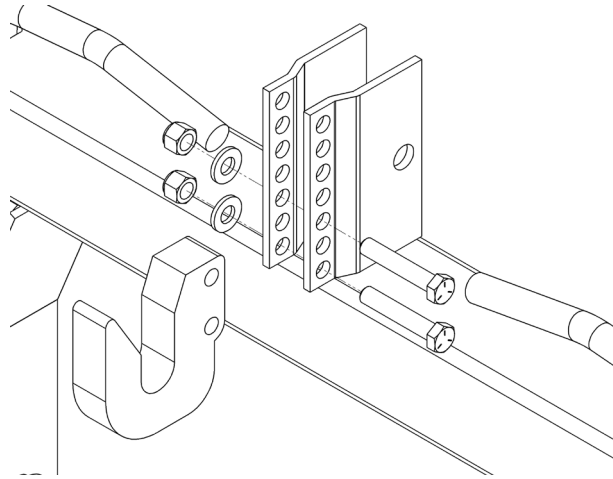

## STEP 2:

Slide the adapter bracket over the top bracket of the quick hitch and put the top link pin through both the quick hitch adapter and top link. Either hole of the quick hitch adapter can be used.

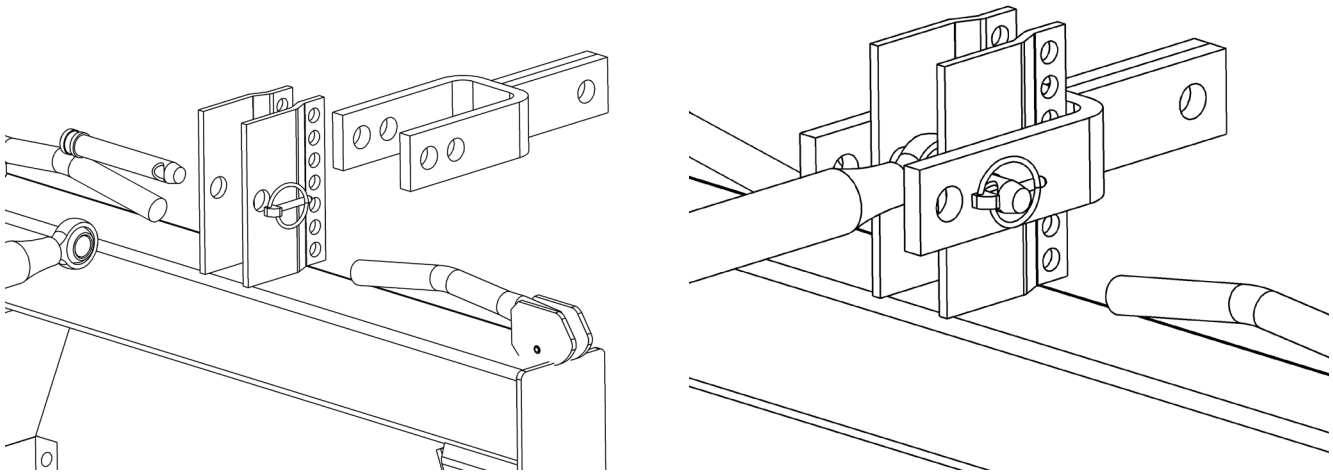

## STEP 3:

Connect the quick hitch adapter to the mast of the implement.

# OPERATING INSTRUCTIONS

## INSTRUCTIONS TO REMOVE THE IMPLEMENT FROM THE QUICK HITCH

### STEP 1:

Turn off the tractor and remove the PTO driveline if applicable. See the tractor's owner's manual for instructions.

Raise the tractor a-arms enough that the implement weight is on the quick hitch hooks.

Flip both quick hitch handles vertical. The handles will stay vertical or in the open position. Flipping the handles vertical will pull the locking plate inside the quick hitch freeing the implement's lower pins to be removed.

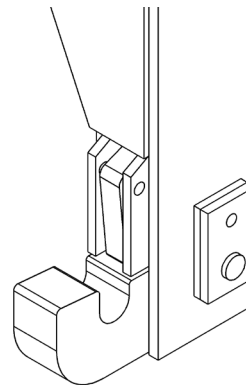
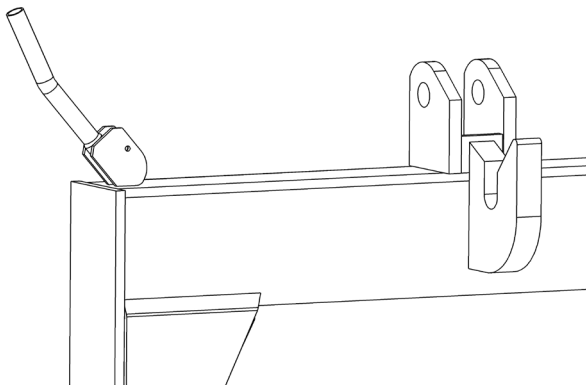

### STEP 2:

Lower the tractor's a-arms until the implements pins or bushings are out of the quick hitch lower hooks and mast from the quick hitch upper hook.

### STEP 3:

Verify that no parts of the implement or driveline are attached to the quick hitch and the tractor is clear to move forward without the quick hitch hitting any part of the implement.

Drive the tractor forward and then flip the handles back closed in the horizontal position.



WARNING

**ALWAYS PERFORM MAINTENANCE OPERATIONS WITH THE TRACTOR'S ENGINE POWERED OFF, AND PTO DISENGAGED.**

Clean dirt and debris off the quick hitch after each use.

Store the quick hitch in a clean and dry location.

Lubricate all moving parts periodically.

Check for damaged or worn parts after each use. Do not attach the quick hitch to a tractor or implement if parts are worn and need to be replaced.

# QUICK HITCH PARTS LIST

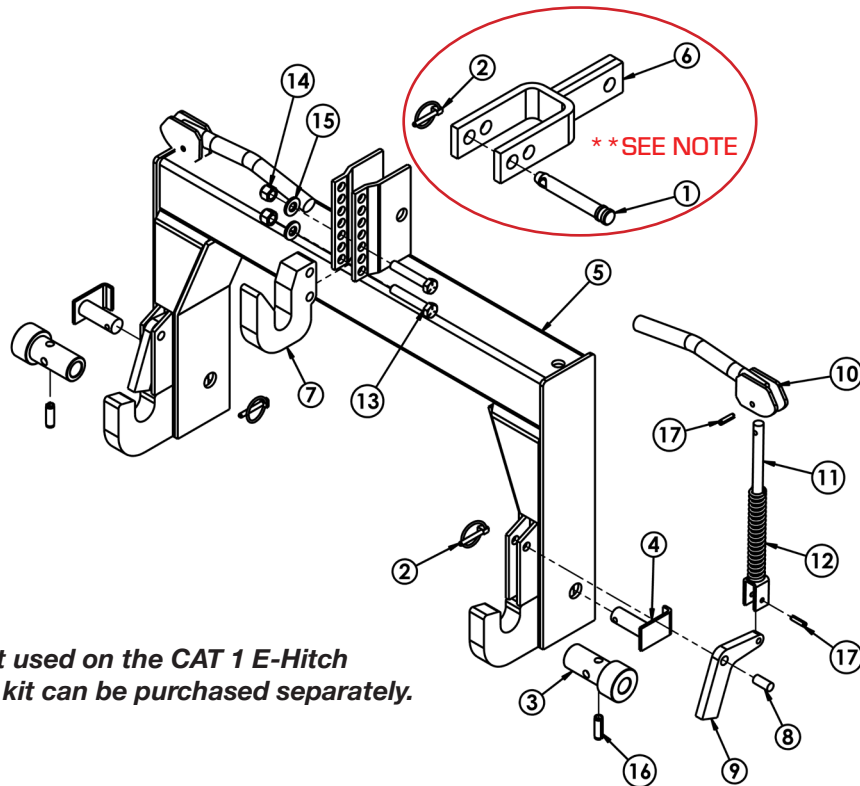

**\*\* Indicates parts not used on the CAT 1 E-Hitch Quick Hitch Adapter kit can be purchased separately.**

## CAT 1 QUICK HITCH P/N: 25-005, E-HITCH P/N: 25-040

ITEM NO.	PART NUMBER	DESCRIPTION	QTY.
1	25-038**	TOP LINK PIN	1
2	50-004**	1/4" LYNCH PIN	3
3	25-001**	CAT 1 QUICK HITCH BUSHING	2
4	25-003	CAT 1 PIN	2
5	25-004	CAT 1 QUICK HITCH, BARE	1
6	25-006**	QUICK HITCH ADAPTER	1
7	25-007	CAT 1 TOP HOOK	1
8	25-011	PIN, CAT 1	2
9	25-012	LOCK, CAT 1	2
10	25-013	HANDLE, QUICK HITCH	2
11	25-014	WELDMENT, ROD	2
12	25-015	SPRING, QH	2
13	N/A	BOLT, 1/2"-13 X 2-3/4", PT	2
14	N/A	LOCKNUT, 1/2"-13	2
15	N/A	WASHER, 1/2"	2
16	N/A**	SPRING PIN, 7/16" X 1-3/8"	2
17	N/A	SPRING PIN, 1/4" X 1"	4

# QUICK HITCH PARTS LIST

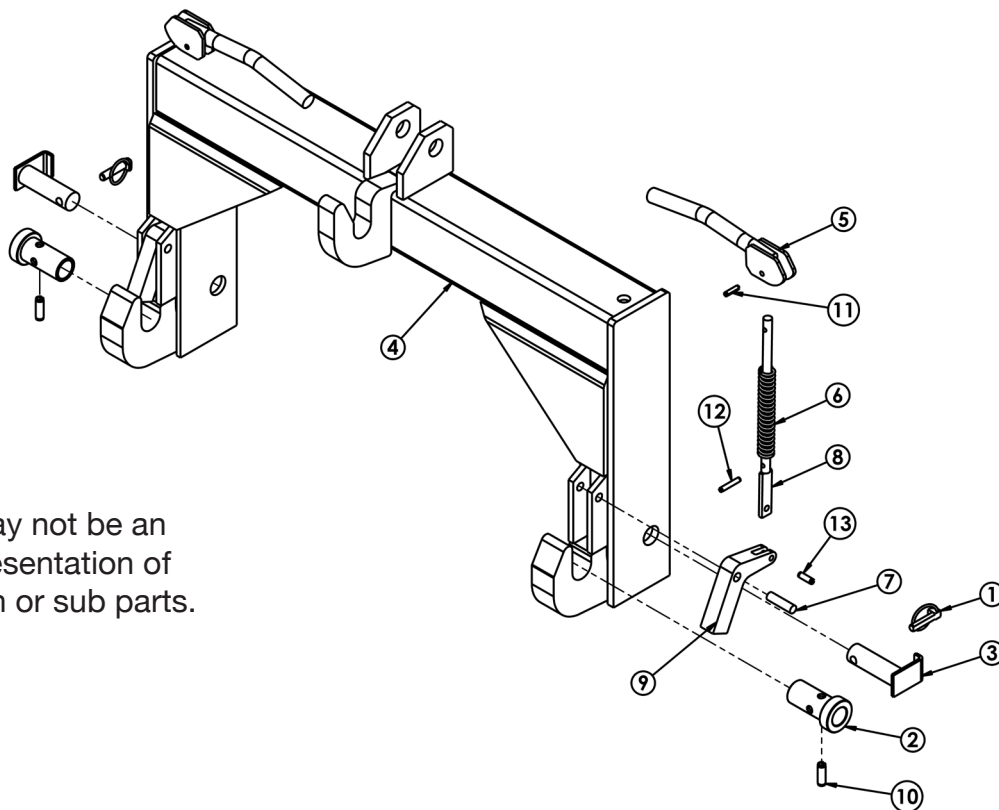

\*The photo may not be an accurate representation of the quick hitch or sub parts.

ITEM NO.	PART NUMBER					DESCRIPTION	QTY.
	CAT 2 P/N: 25-010	CAT 2 HD P/N: 25-019	CAT 3 P/N: 25-020	CAT 3N P/N: 25-021	CAT 2/3 P/N: 25-022		
1	50-005	50-005	50-005	50-005	50-005	7/16" LYNCH PIN	2
2	25-002	25-002	N/A	N/A	N/A	QUICK HITCH BUSHING	2
3	25-008	25-008	25-025	25-025	25-025	PIN	2
4	25-009	25-029	25-030	25-031	25-032	QUICK HITCH, BARE	1
5	25-013	25-013	25-013	25-013	25-013	HANDLE, QUICK HITCH	2
6	25-015	25-015	25-015	25-015	25-015	SPRING, QH	2
7	25-016	25-033	25-034	25-035	25-036	LOCK MOUNTING PIN	2
8	25-017	25-003	25-004	25-004	25-004	WELDMENT, ROD	2
9	25-018	25-018	25-018	25-018	25-018	LOCK	2
10	N/A	N/A	N/A	N/A	N/A	SPRING PIN, 7/16" X 1-3/8"	2
11	N/A	N/A	N/A	N/A	N/A	SPRING PIN, 1/4" X 1"	2
12	N/A	N/A	N/A	N/A	N/A	SPRING PIN, 1/4" X 1-1/2"	2
13	N/A	N/A	N/A	N/A	N/A	SPRING PIN, 5/16" X 1"	2

# WARRANTY

## IMPORTANT NOTICE

We, the manufacturer, reserve the right to change the product and/ or specifications in this manual without notification. The manual is for information use only and the pictures and drawings depicted herein are for reference only.

## Warranty Repair and Service

Do not return this product to the store for warranty issues or repair. Call our customer service department at **720-437-7640** for the location of the nearest service center.

Record the information below for future reference.

Model No. \_\_\_\_\_

Serial No. (if applicable) \_\_\_\_\_

Date of Purchase \_\_\_\_\_

Place of Purchase \_\_\_\_\_

# SPECIFICATIONS

SKU/Part No.	25-005 / 25-040	25-010	25-019	25-020	25-021	25-022
Model #	CAT 1 / E-Hitch	CAT 2	CAT 2 HD	CAT 3	CAT 3N	CAT 2/3
Description	Category 1 quick hitch	Category 2 quick hitch	Category 2 heavy duty quick hitch	Category 3 quick hitch	Category 3 narrow quick hitch	Category 2/3 quick hitch
Tractor category	1	2	2	3	3	2 or 3
Implement category	1	2	2	3	3	3
Tractor rating	50 HP	90 HP	150 HP	200 HP	200 HP	200 HP
Capacity	2500 lbs.	3600 lbs.	4000 lbs.	4000 lbs.	4000 lbs.	4000 lbs.
Inside lower hook spacing	27.1 in.	32.7 in.	32.7 in.	38.4 in.	38.4 in.	32.7 in.
Vertical hook spacing	14.8 to 18 in. (adjustable hook)	14.8 in.	14.8 in.	18.8 in.	18.8 in.	18.8 in.
Warranty	1-year limited	1-year limited	1-year limited	1-year limited	1-year limited	1-year limited

For Service or Questions:

**Call 720-437-7640**

# REGISTRATION

## Acceptance of responsibility:

I (purchaser) have read the Operation Manual and Limited Warranty or someone has read and explained all instructions to me. I understand this warranty does not cover any labor and that all disputes will be settled by binding arbitration. Warranty void if any attempt to repair or replace defective parts has been made by unauthorized personnel. The mark next to each item below confirms my acceptance of responsibility for the use and maintenance of this quick hitch. I understand that I alone am responsible for the proper maintenance, care and safe operation of this quick hitch.

- Received, read and understand the Operation Manual
- Specifications accepted
- Operations understood
- Maintenance requirements understood

I (purchaser) understand that persons who have not read and understand the operations manual should not be allowed to use the machinery. Children should not operate or be near the equipment. Anyone operating the quick hitch must have read the safety and operations manual.

Is this quick hitch used in a business:

No: \_\_\_\_\_ Yes, business type: \_\_\_\_\_

Owner / Purchaser Signature: \_\_\_\_\_

The warranty may be refused if the registration is not legible, completed and signed. It is the responsibility of the purchaser to assure that the registration form is received.

Agknx product warranty offers one year warranty against workmanship.

The warranty gives the consumer certain and specific rights which may vary from state to state.

Warranty does not cover normal wear, misuse, neglect, abuse, improper maintenance, overload beyond rated capacity, accidents, cosmetic defects, consumables, non-authorized replacement parts or accessories, operation with inadequate supply of gear box oil, improper fluid types or unauthorized adjustments.

**Warranty void if registration not postmarked within 15 days of purchase!**

**WARRANTY & REGISTRATION BY MAIL**

To register your device:

1. Fill in the form below,
2. Cut out the form, attach a copy of the receipt or proof of purchase, and
3. Mail to:

Tool Tuff Direct  
15000 West 44th Ave,  
Suite B Golden, CO 80403

**WARRANTY REGISTRATION FORM**

**QUICK HITCH**

*Warranty registration implies agreement to the terms of the "Acceptance of Responsibility" (above)*

Device Serial #:		
Purchase date:		
Purchased from (Store / City):		
Purchaser:		
Purchaser address:		
City:	State:	Zip code:
Purchaser phone #:	E-mail:	

**WARRANTY REGISTRATION BY E-MAIL**

Warranty registration may be completed by filling out the form above, taking a picture or scan the form *and* your proof of purchase, and emailing them to: [warranty@tooltuffdirect.com](mailto:warranty@tooltuffdirect.com)

Please write in the subject line of the warranty registration e-mail: Quick Hitch

**WARRANTY REGISTRATION BY ONLINE SUBMISSION**

Registration may be completed by following the QR code below. Use the camera app on your smartphone in the same manner you would if you were taking a photo. Your smartphone will recognize the code, and a link will appear on the screen. Tap the link and you will be directed to the form on our website.



For Service or Questions:  
**Call 720-437-7640**