

HYPER ⚡ SPLIT

Quick guide: Attaching the quick-mount brackets to the engine

This short guide shows how to attach the quick-mount brackets onto the engine. *This additional step must be completed before you move on to Step 4: Mounting the engine* (p.15 in the assembly guide).

 No tools are needed to attach the quick-mount brackets; they only need to be hand-tight. When you're ready to mount the engine, you will need the a 13mm socket with driver and an adjustable wrench (see Step 4) to tighten down the bolts.

- 1 Locate the quick-mount brackets (x 3) and flanged M8 bolts (x 3) in the hardware kit. Slide the quick-mount brackets over the engine mounts at the locations shown below.

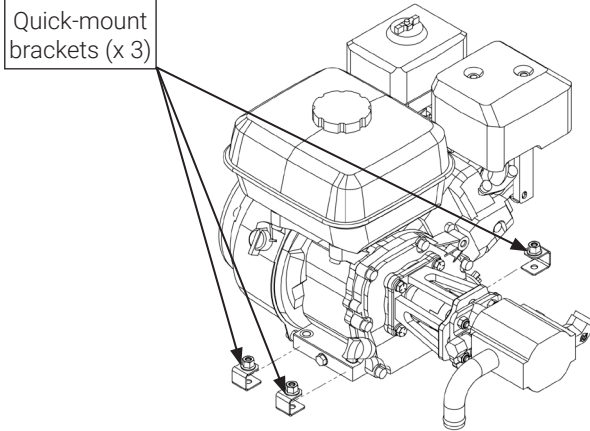

Revised view:

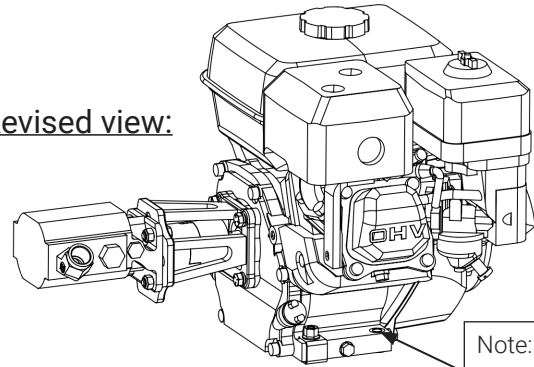

Note: This engine mount does not require a quick-mount bracket.

- 2 Set one M8 bolt through the bottom of each bracket, through the engine base, and begin threading it into the nut on the top of the quick-mount bracket as shown. **The bolts only need to engage the nut at this time, they should not be fully threaded; see below.**

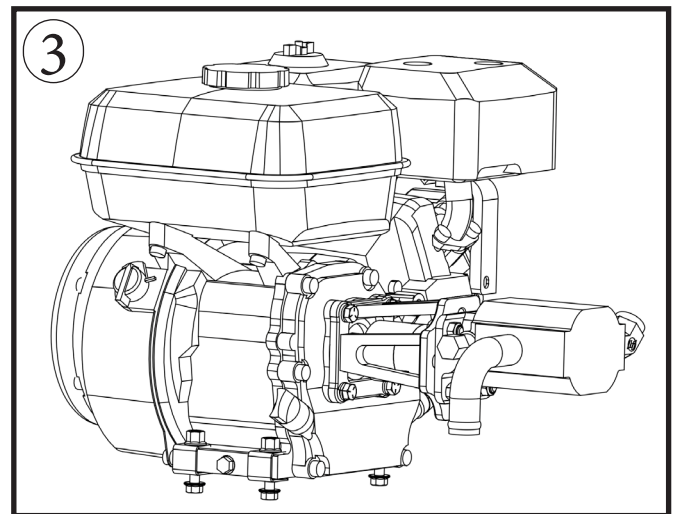
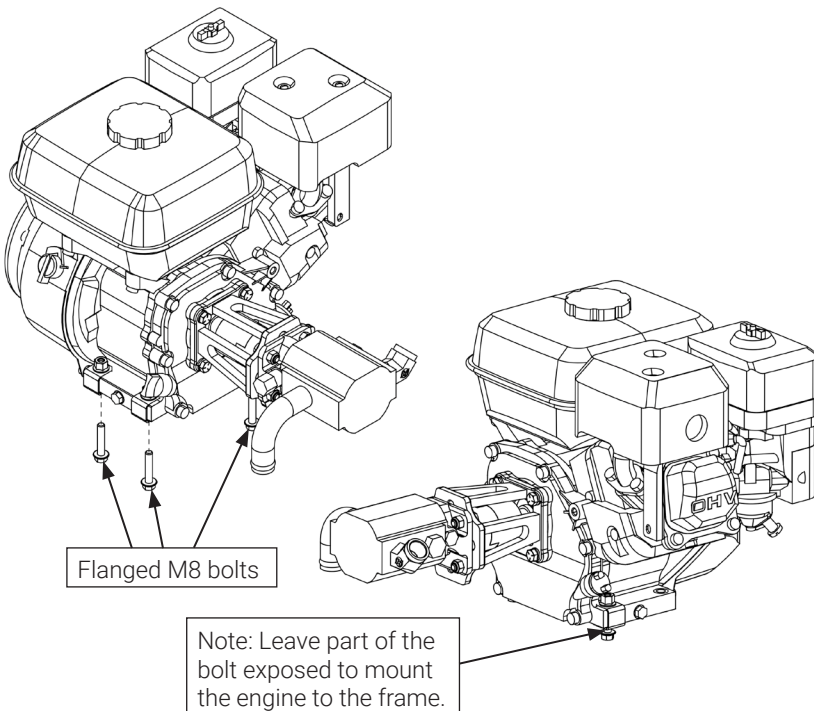

The quick-mount brackets are installed and the engine is ready to mount. Move on to Step 4.

Questions? For service call or email:
techsupport@tooltuffdirect.com
720-437-7640