

n°	Cod.	Description	Qt.	Dis.	Kg
1	4150002	SEGER 25E	2	-	0.002
2	40050/89	WASHER WHEELS	2	11741	0.08
3	5260001	SELF LUBRIFICANT BRONZINE	4	-	0.02
4	40050/87	METAL WHEEL Ø275	2	11740	28.37
5	40060/08	WHEEL SCHAFT	1	12813	6.74
6	40050/70	FLYWHEEL COVER CARTER	1	11611	6.95
7	5010607	SCREW TBE 6X16	15	-	0.005
8	40060/07	FLYWHEEL CARTER	1	12726	17.81
9	5350019	EMERGENCY STOP SWITCH	2	-	0.10
10	4200066	MOTOR Kw 5,5	1	-	50.1
11	4140801	KEY 8x7x40	1	-	0.02
12	40060/22	MOTOR PULLEY	1	13052	4.00
13	400210	DISTANZIALE PULEGGIA	1	11129	0.09
14	400246	WASHER D10	1	-	0.04
15	5031002	INSERT GROWER D10	7	-	0.002
16	5011011	SCREW 10x30	1	-	0.027
17	40050/73	MOTOR FRAME	1	11671	4.07
18	5021001	NUT M10	4	-	0.012
19	5031001	FLAT WASHER D10	4	-	0.005
20	5011018	SCREW TE 10X40	4	-	0.033
21	40050/84	PIN FRAME MOTOR	1	12113	0.29
22	5040401	COTTER PIN 4x40	2	-	0.004
23	5021402	NUT M14	1	-	0.014
24	5011401	SCREW TE 14x100	1	-	0.133
25	412076	BEARING 6308	1	-	0.64
26	40060/09	PINION FIRST PAIR	1	12735	4.82
27	4141205	KEY 12x8x40	1	-	0.03
28	4120077	BEARING 4310	1	-	1.57
29	4130031	OIL SEAL 50x80x10	2	-	0.02
30	40060/19	COVER WITH OIL SEAL	1	12740	2.19
31	5011028	SCREW TE 10X25	4	-	0.025
32	40060/04	FLYWHEEL	1	12734	177.1
33	4170003	BELT A70	4	-	0.2
34	400511	SHAFT RING	1	10645	0.12
35	5031202	GROWER D12	1	-	0.004
36	5011202	SCREW TE 12x40	3	-	0.048
37	5060002	CILINDRICO COVER	2	-	0.04
38	40060/01	CASING	1	12737	283.8
39	40060/20	ROLL BEARING COVER	1	12796	0.53
40	5010605	SCREW TCE 6X16	3	-	0.01
41	4150004	SEGER 72E	2	-	0.02
42	40042/31	BUSHING ECCENTRIC SHAFT	1	11582	1.49
43	4142003	KEY 20x12x120	1	-	0.22
44	40060/10	ECCENTRIC SHAFT	1	12743	18.88
45	40060/15	ROD BRONZINE	1	12742	1.45
46	40060/14	CONNECTING ROD	1	12733	24.76
47	40042/32	BRONZINE	1	11583	0.48
48	5091602	CILINDRICO PEG 16X60	3	-	0.09
49	40050/52	COVER SLIDE	1	11424	34.8
50	5010807	SCREW TCE 8x15	6	-	0.01
51	40050/103	SUPPORT	1	12129	0.14
52	5011221	SCREW TCE 12X45	6	-	0.06
53	5011804	SCREW TCE 18X50	8	-	0.16
54	40050/68	LIMIT SWITCH CARTER	1	12058	1.25
55	5010840	SCREW 8X50	2	-	0.02
56	5020602	NUT M6	1	-	0.002
57	5010610	SCREW TCE 6X20	1	-	0.007
58	5080002	GREASER 1/8" GAS	3	-	0.01
59	5300004	GREASER EXTENSION	2	-	0.03
60	40050/55	PLATE FOR SADDLE	2	11389	0.55
61	5010604	SCREW TPSCEI 6X16	10	-	0.00
62	5091201	CILINDRICO PEG 12X20	2	-	0.02
63	5011235	SCREW TCE M12x60 12K	2	-	0.07
64	40060/06	BLADE	2	12730	1.58
65	40060/05	SUPPORT FOR FIXED BLADE	1	12732	1.17
66	5011027	SCREW 10X25	5	-	0.02
67	40050/82	SIMPLE ROLL	2	11548	0.15
68	40050/81	ROLL WITH SHOULDER	2	11609	0.28
69	40050/83	ROLL PIN	1	11543	0.58
70	5010608	POINTED SPRIG 6X10	2	-	0.002
71	40050/76	PIN FOR CUTTER PROTECTION	1	12125	0.24
72	40050/62	SHEAR COVER	1	12696	3.10
73	40050/99	MAGNETE SUPPORT	1	11987	0.42
74	5030603	WASHER D6	3	-	0.003
75	5010615	SCREW TE 6X16	2	-	0.006
76	5010502	SCREW TE 5X10	3	-	0.003
77	-	SCREW TE 10X30	1	-	0.03
78	5021002	NUT M10	1	-	0.006
79	40050/100	BUSH AND LEVER KIT	1	12139	1.23
80	40030/67	SPRING PEDAL and CLUTCH	1	10941	0.03
81	5011016	SCREW TE 10X50	1	-	0.038
82	5020601	BOLT M6	1	-	0.003
83	5350150	ELECTRO MAGNETE	1	-	1.75
84	40050/77	PEDAL COVER	1	11632	2.34
85	40050/78	MAGNETE COVER	1	11633	3.75
86	5350147	METAL FOOT-PEDAL	1	-	1.7
87	5260002	SELF LUBRICATING BRONZINE	1	-	0.03
88	40050/56	CLUTCH GUIDE	2	11390	0.26
89	5011234	SCREW TCE M12x80 12K	2	-	0.08
90	5010825	SCREW TCE 8X12	1	-	0.01
91	-	WICK L=150	1	-	0.003
92	40042/11	SHEET OIL WELL	1	12120	0.09
93	40050/85	SUPPORT RODS	1	11744	8.54
94	40050/86	SUPPORT RODS	1	11745	2.07

n°	Cod.	Description	Qt.	Dis.	Kg
95	40042/57	REGISTER STOP ROD	1	10204	0.79
96	40060/21	PLATE	1	13056	1.10
97	5011427	SCREW TCE 14X120	2	-	0.17
98	40050/88	PEDAL SHAFT BUSHING	1	11793	0.11
99	4160001	OR 119	1	-	0.00
100	40050/24	PEDAL PIN	1	11387	0.88
101	5010844	SCREW TE 8x55	1	-	0.025
102	5020803	NUT M8	2	-	0.003
103	5040621	screw te 6x20	2	-	0.007
104	5010819	SCREW TE 8x35	1	-	0.018
105	5031203	WASHER D12	1	-	0.022
106	5021203	SELF BLOCKING BOLT M12	1	-	0.01
107	40050/61	TOTAL SUPPORT CLUTCH	1	12259	0.80
108	40050/59	LOCK PIN SUPPORT	1	12256	0.12
109	40035/49	SPRING FOR CLUTCH PIN	1	11892	0.01
110	40050/60	CLUTCH PIN	1	12257	0.07
111	5092003	CILINDRICO PIN 20X50	2	-	0.1
112	40050/5	CLUTCH	1	11292	1.02
113	40042/42	STOP CLUTCH	1	11902	0.10
114	40042/43	STOP CLUTCH	1	11519	0.14
115	40042/4	CLUTCH PLATE	1	11575	0.18
116	5091208	PIN 12X50	2	-	0.04
117	40050/96	GEAR INSPECTION COVER	1	11972	1.00
118	5070003	ALUMINIUM OIL LEVEL	1	-	0.04
119	40060/03	GEAR COVER	1	12736	55.8
120	5011036	SCREW TCE 10X35	11	-	0.033
121	40042/33	SHAFT BRONZINE	1	11584	0.34
122	40042/3	SPRING ROD PIN	1	11574	0.01
123	40042/20	CLUTCH SPRING ROD	1	11463	0.17
124	40042/22	CLUTCH SPRING	1	11580	0.02
125	40042/13	SUPPORT SPRING ROD	1	11577	0.07
126	5040201	COTTER PIN 2X25	1	-	0.001
127	5011008	SCREW TE10X110	3	-	0.076
128	40050/3	CROWN HUB	1	11394	18.21
129	40042/30	CROWN BRONZINE	2	11321	0.88
130	40060/17	CROWN SECOND PAIR	1	12727	51.17
131	40050/16	CROWN DISC HUB	1	10838	6.06
132	412085	BEARING NA 6910	2	-	0.53
133	40060/11	PINION SECOND PAIR	1	12738	9.61
134	4141405	KEY 14x9x70	1	-	0.07
135	40060/12	CROWN FIRST PAIR	1	12729	31.40
136	40060/18	CROWN SPACER	1	12739	0.22
137	5350082	FLYING PHASE PLUG	1	-	0.2
138	5350277	DIODE LINK	1	-	0.02
139	5350078	TRANSFORMER 30 VA	1	-	1.15
140	5350243	KIT SAFE-MOTOR HANDLE	1	-	0.12
141	5350141	ELECTRICAL PLANT	1	13051	2.5
142	5350242	EMPTY BOX CUTTER PLANT	1	-	0.62
143	5350272	MAGNET THERMAL C4	1	-	0.20
144	5350271	MAGNET THERMAL C6	1	-	0.20
145	5350269	SAFE-MOTOR SWITCH 10+16	1	-	0.4
146	5350251	COIL MINIMUM TENSION	1	-	0.20
147	5350276	TIME SWITCH	1	-	0.34
148	5350123	RELAIS START 24V AC	1	-	0.05
149	5350131	BASE FOR RELAIS START	1	-	0.05
150	40050/80	SWITCH FIXING PLATE	1	11654	3.61
151	40050/104	PROTECTION SHEET FLYWHEEL	1	12350	0.68
152	5011003	SCREW TE 10X20	2	-	0.022

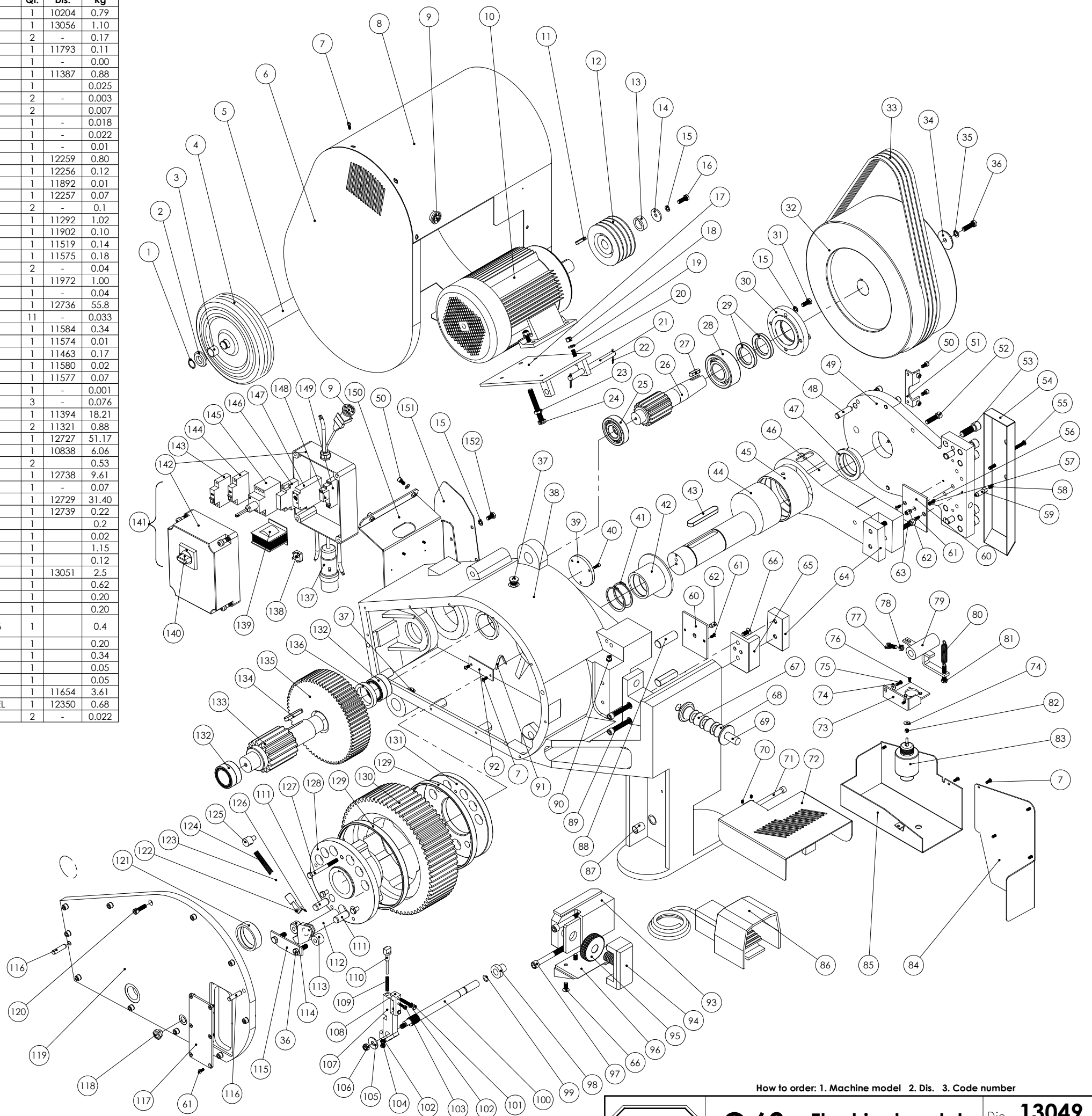

How to order: 1. Machine model 2. Dis. 3. Code number

TECMOR	C 62	Electrical pedal	Dis. 13049
			Data: 7.2.17