

SERVICE ENTRANCE

Steel



Part No	Trade Size	Pcs/ Unit Ctn	Pcs/ Ship Ctn	Wt(lbs)/ 100pcs
45110	3#8, 3#6, 3#4	100	1000	2
45120	3#3, 3#2	100	1000	3
45130	3#1, 3#0, 3#1/0, 3#2/0	25	100	9
45140	3#3/0, 3#4/0	25	100	11

NOMINAL DIMENSIONS (Inches):

Part No	A	B	C
45110	1.941	0.567	0.587
45120	2.555	1.000	0.894
45130	2.850	1.024	0.980
45140	2.835	0.984	0.984

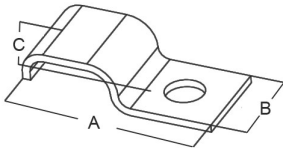

Straps

TYPE: One Hole, SE or SEU

FOR: Service Entrance

MATERIAL: Steel

FINISH: Zinc Electro-Plated

APPLICATIONS:

- Used to secure Type SE or SEU Service Entrance cable to a surface including wood and masonry

FEATURES:

- Ribbed for extra strength

COMPLIANCE:



File No.:
E313449



Electrical Resource International
440.878.1199
www.electrical-resource.com