



Connectors

FMC, AC & MC Cable

TYPE: Double "Snap-In", Cut-In (Old Work), Insulated
FOR: FMC, AC & MC Cable
BODY MATERIAL: Zinc Die Cast
BODY FINISH: Vibratory
BUSHING: Polycarbonate
SPRING: Electro-Plated, Hardend Steel

APPLICATIONS:

- Used to connect Flexible Metal Conduit, Armored or Metal Clad Cable to an old work (cut-in) steel box, load center, or other metal enclosure
- For use in dry locations only

FEATURES:

- One piece design
- No tool installation reducing labor and time
- Removable-Reusable without tools
- Secured, pre-assembled anti-short bushing
- 105° C rated throat liners

COMPLIANCE:



Electrical Resource International
440.878.1199
www.electrical-resource.com



Part No	Trade Size	Pcs/ Unit Ctn	Pcs/ Ship Ctn	Wt (lbs) / 100pcs
---------	------------	---------------	---------------	-------------------

25802	3/8" (1/2" KO)	50	500	6
-------	-------------------	----	-----	---

NOMINAL DIMENSIONS (Inches):

A	B	C
1.54	0.98	1.1

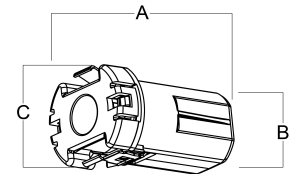

CABLE SPECIFICATIONS:

AL & STEEL AC	AL & STEEL MC/MCI-A/HCF
14-2 to 10-3	14-2 to 10-3

Snap-In & You're Connected!

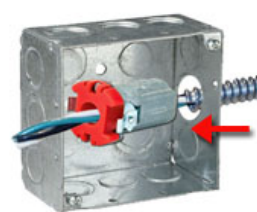

Feed wires through fitting.
Snap FMC into fitting.

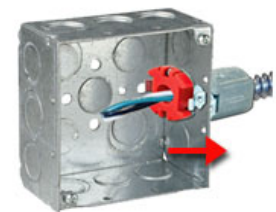

Snap fitting into box.
Press tabs to remove.