

## Couplings

**TYPE:** Screw-In  
**FOR:** Flexible Metal Conduit  
**MATERIAL:** Zinc Die Cast  
**FINISH:** Vibratory

### APPLICATIONS:

- Used to couple two lengths of Flexible Metal Conduit
- For use in dry locations only

### FEATURES:

- Screws into conduit for easy installation

### COMPLIANCE:



File No.:  
E244047



Part No	Trade Size	Pcs/ Unit Ctn	Pcs/ Ship Ctn	Wt(lbs)/ 100pcs
25510	1/2"	25	250	4
25520	3/4"	25	250	6
25530	1 "	10	100	11
25540	1-1/4"	10	100	22
25550	1-1/2"	5	50	34
25560	2 "	5	50	67

### NOMINAL DIMENSIONS (Inches):

Trade Size	A	B	C
1/2"	1.811	0.906	0.540
3/4"	2.051	1.197	0.738
1 "	2.413	1.350	0.920
1-1/4"	2.756	1.752	1.169
1-1/2"	3.094	2.106	1.400
2 "	3.276	2.657	1.885

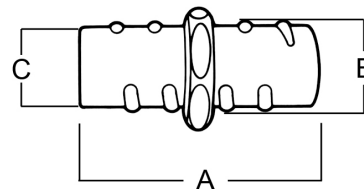

Electrical Resource International  
440.878.1199  
[www.electrical-resource.com](http://www.electrical-resource.com)