



THE GRAND TETON

I N S T A L L I N S T R U C T I O N S

HARDWARE CHECKLIST

Quantities marked in blue may be used in the preassembly of front adjustable mounts.
Exact hardware color counts may vary based on the options selected at checkout.

10

M6 x 1.0
(45mm)



28

1/4"-20 x 1"
Socket button



5

1/4"-20 x 0.75"
Socket button



12

1/4"-20
(9/16")



1

1/4"-20
(1/2")



13

1/4"-20
Tnut



4

1/4"-20
Nylock nut



50

1/4" Flat
Washer



10

M6 Bonded
Washer



2

FAIRING
BRACKETS



FAIRING
BRACE
(Full or half)

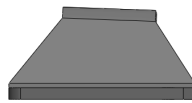

2

REAR
MOUNTING
BRACKETS



2

MIDDLE
MOUNTING
BRACKETS

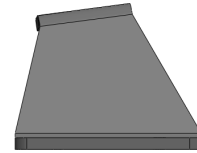

2

FRONT
MOUNTING
BRACKETS



6

MOUNTING
RUBBER

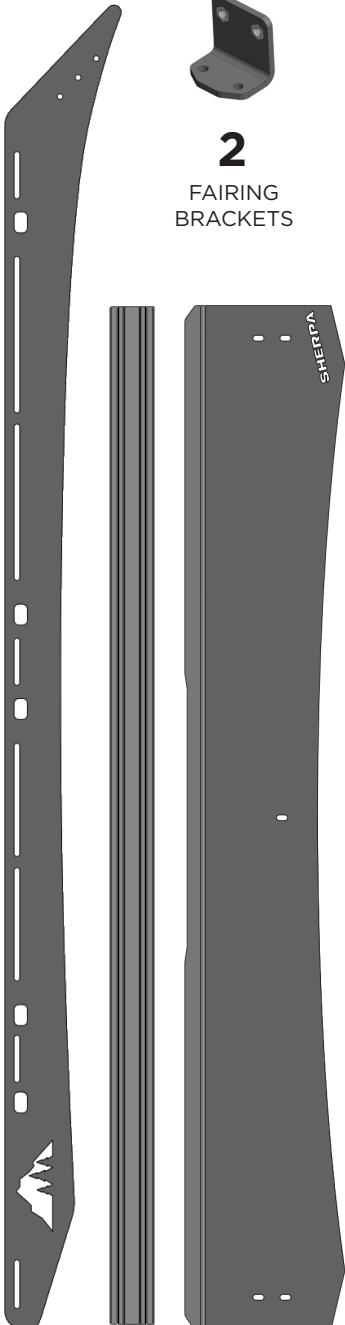

2x SIDEPLATES
6x CROSSBARS
1x FULL OR HALF FAIRING

BEFORE YOU BEGIN

Remove your stock roof rack (if applicable). Removal of the rain gutter trim is necessary for the installation, but can be cut and replaced if desired.

USING TNUTS

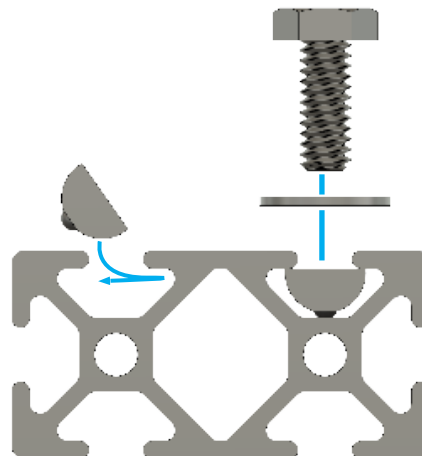

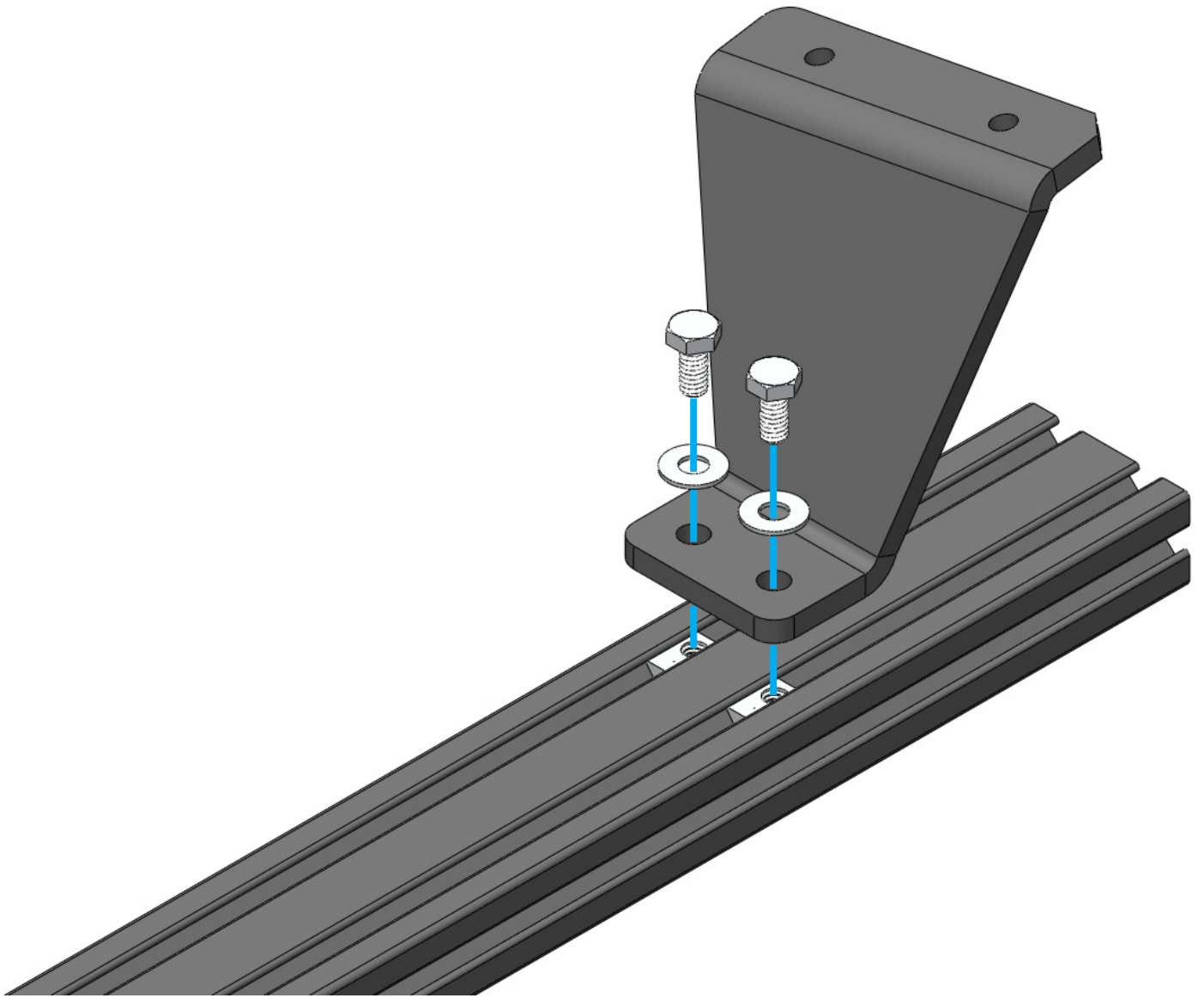

01

Required Components:

- 12x** 1/4"-20 x 9/16"
- 12x** 1/4" Flat Washers
- 12x** 1/4" Tnuts

Secure the tops of the mounting brackets to the wide faces of the cross members using the supplied T-nuts, 9/16" hex bolts, and flat washers.

Leave the hardware that attaches the mount to the crossbar loose. This will make it easier when placing the rack on the truck.

Later, the rack can be centered on the roof by measuring the **distance from the ends of the cross member to the inside-edge of the mounting brackets** on either side of the vehicle.

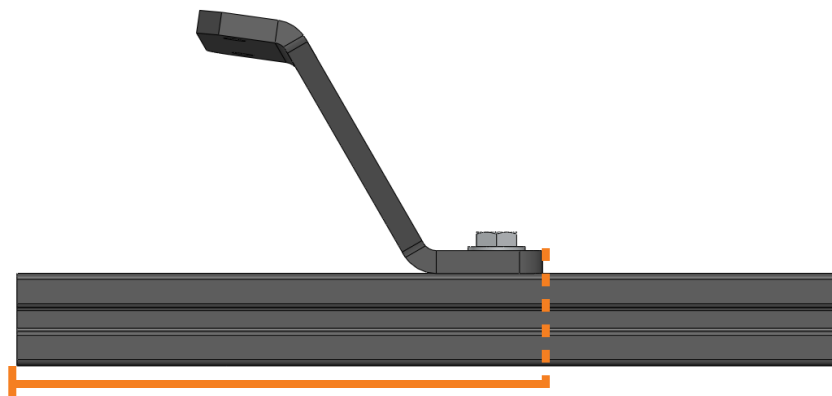

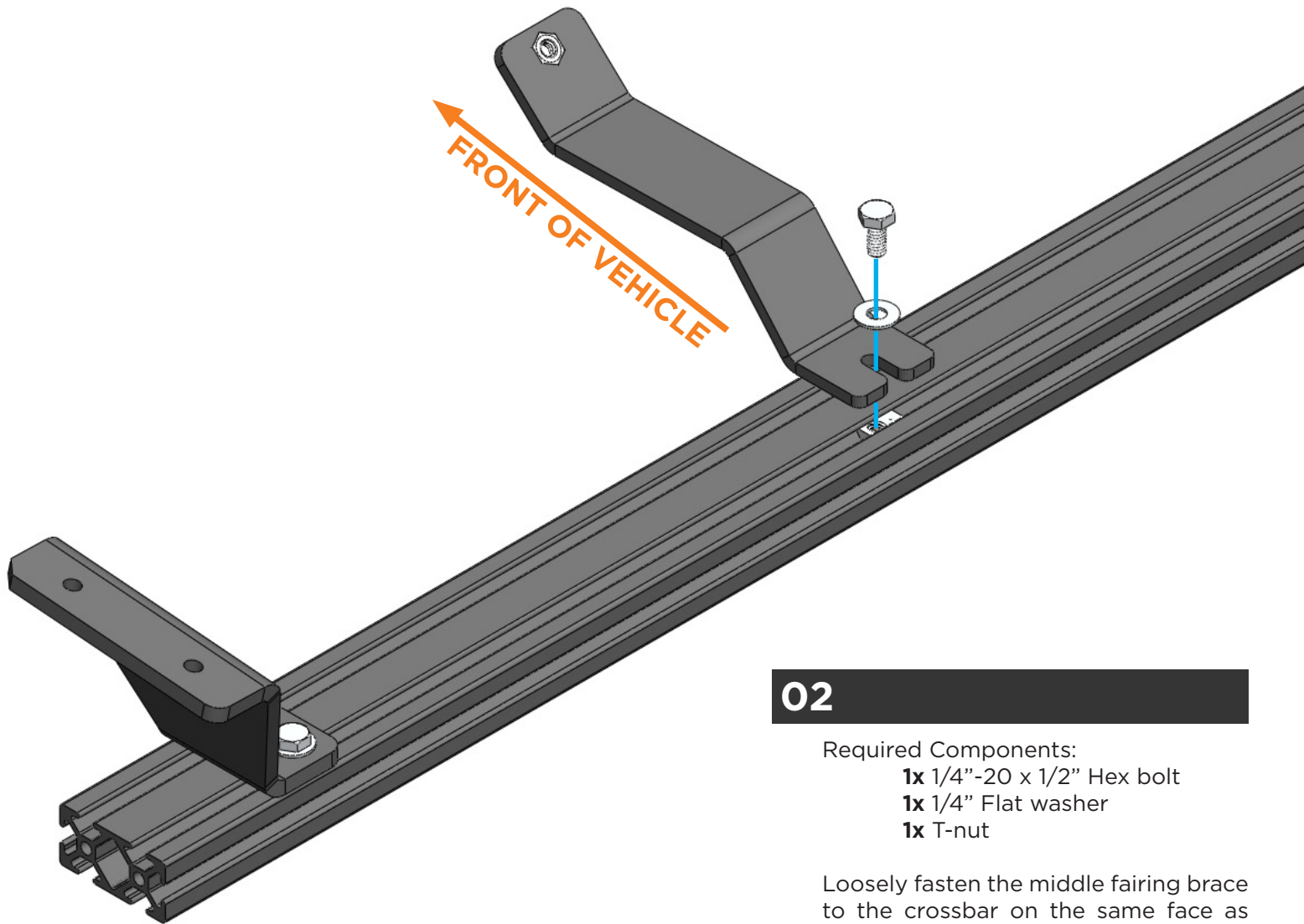

02

Required Components:

- 1x 1/4"-20 x 1/2" Hex bolt
- 1x 1/4" Flat washer
- 1x T-nut

Loosely fasten the middle fairing brace to the crossbar on the same face as the front mounts using the supplied 1/4"-20 x 1/2" hex bolt, flat washer, and t-nut. Note that the hardware will run through the 'far' channel in relation to the fairing. Slide the brace to the center of the crossbar and leave loose.

FULL FAIRING BRACE:

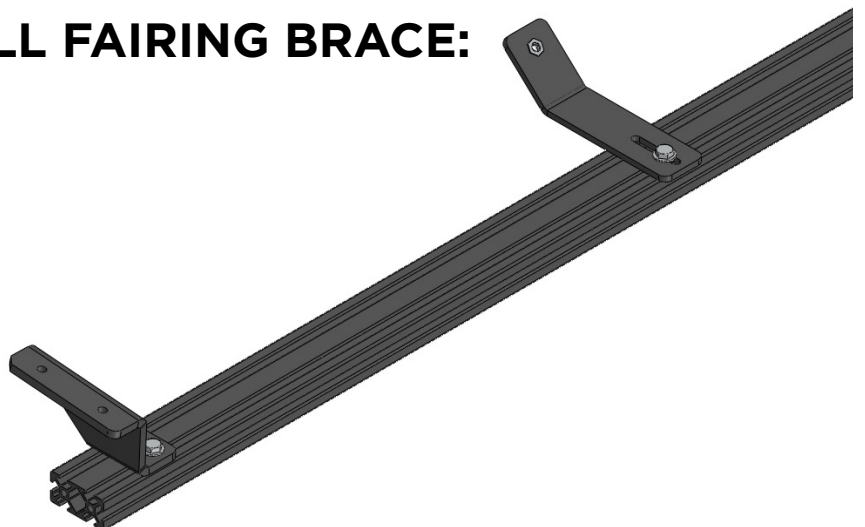

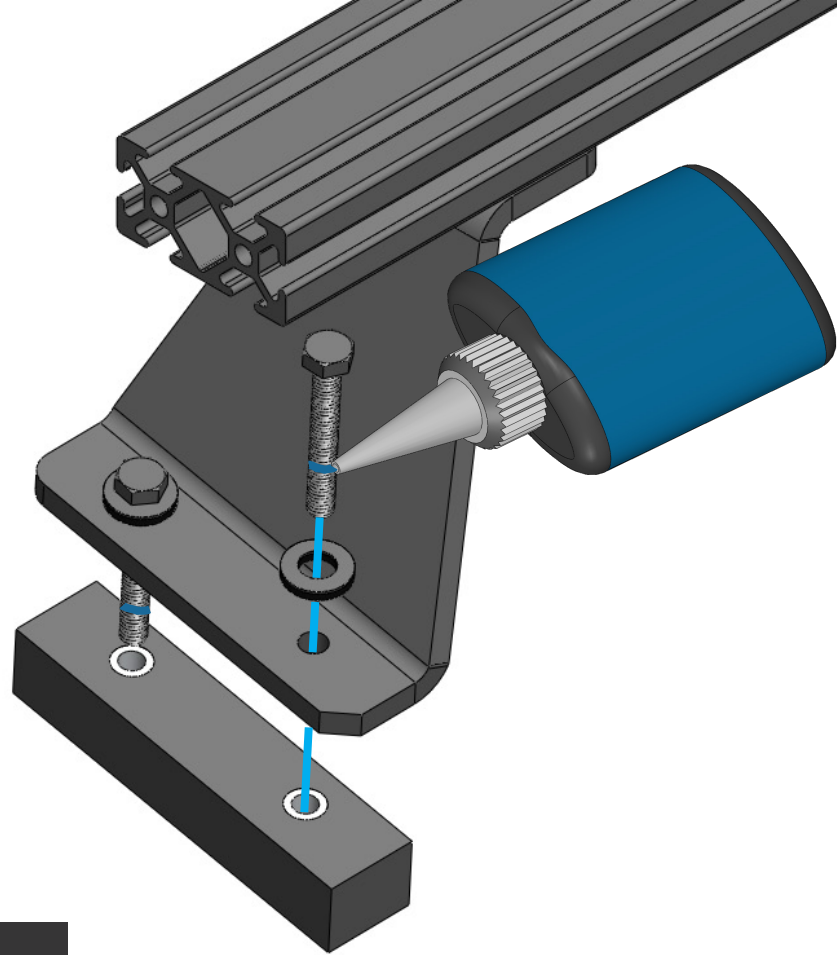

03

Required Components:

10x M6 Hex bolts

10x M6 Bonded washer

1x Bottle of threadlocker

Slide the rubber spacers over the front, middle, and rear sets of factory holes in the roof.

Place the mounting brackets on top of the rubber blocks.

Slide the M6 bonded washers on to the M6 hex bolts. Apply a small drop of the supplied threadlocker to the threads of the M6 hex bolts before sliding them down through the holes in the mounting brackets, and into the factory threads in the roof.

Position the mounting bracket over the rubber spacer and secure it with 10 bolts and bonded washers passed through the bracket, rubber, and into the holes in the roof.

The bonded washers should compress and become flat, but not concave. Do not over tighten these mounts.

TORQUE SPEC: 22in-lb

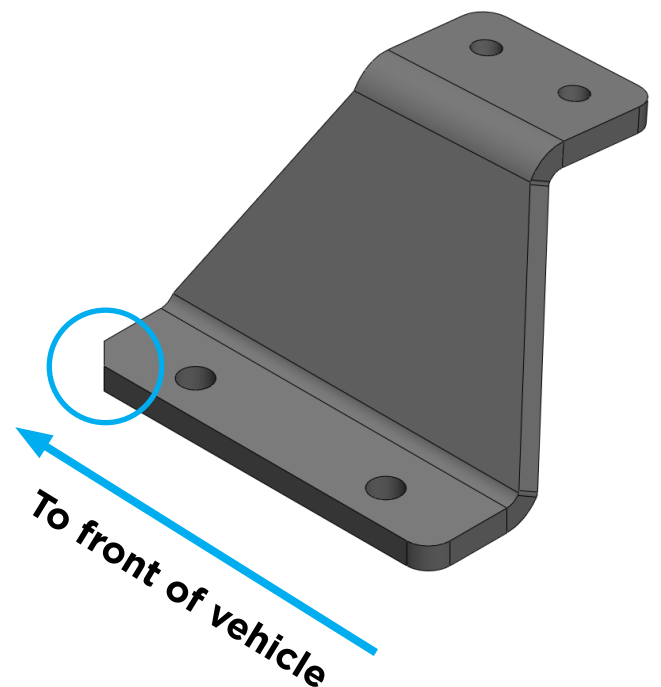

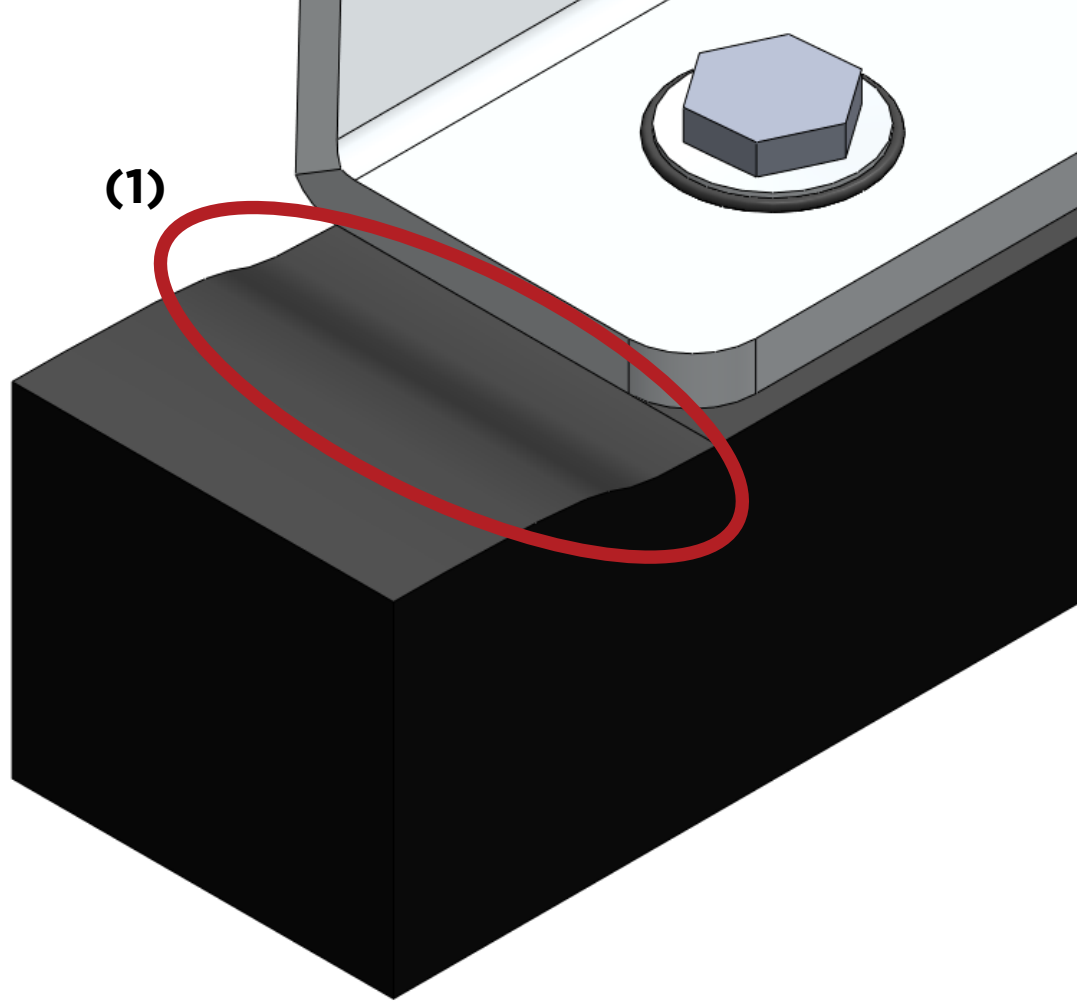

04

Be careful not to overtighten the mounting brackets to the roof. A properly tightened mount will be rigid if pulled on, but the rubber spacer will not be **visibly compressed** (1). Likewise, the rubber portion of the bonded washer will not show excessive 'mushroom'-ing out from underneath the metal portion (2).

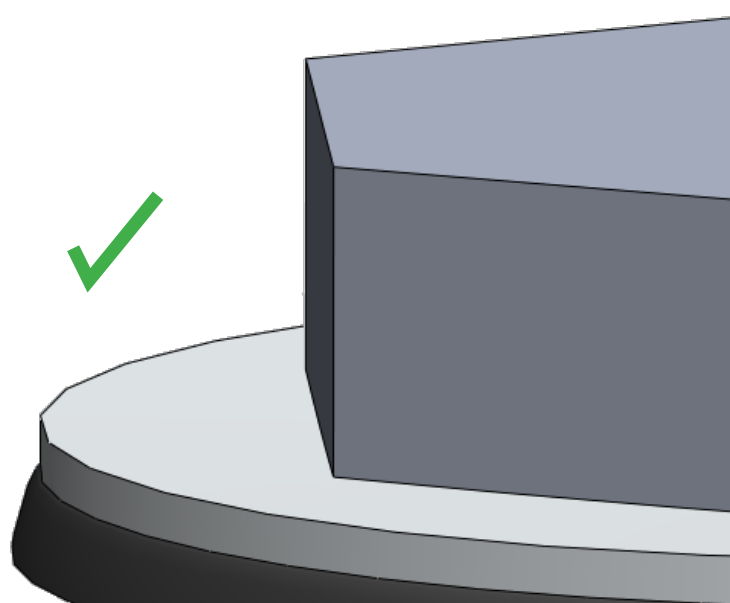
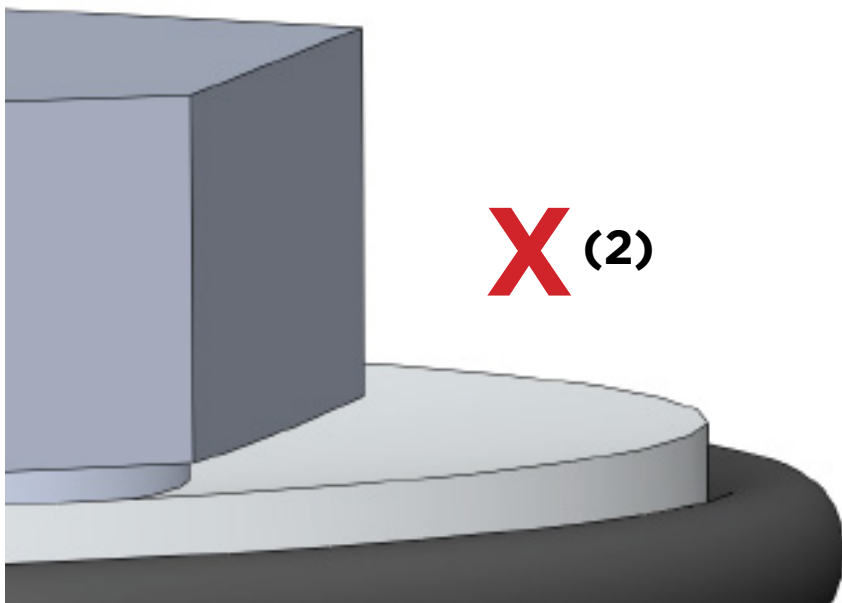

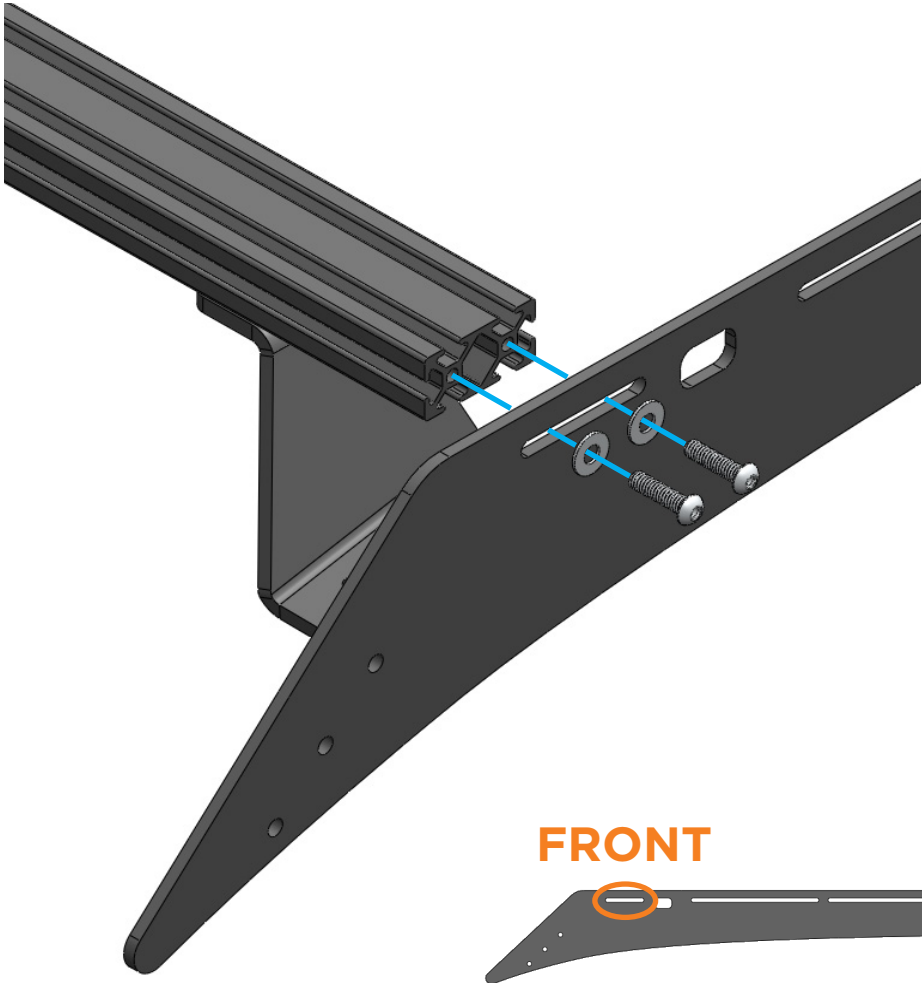

05

- Required Components:
4x 1/4"-20 x 1" Socket buttons
4x 1/4" Flat Washers

Fasten the mount assemblies to the sideplates by bolting into the ends of the crossbar with the supplied socket buttons and washers in the designated slots (refer to the diagram below).

FRONT

MIDDLE

REAR

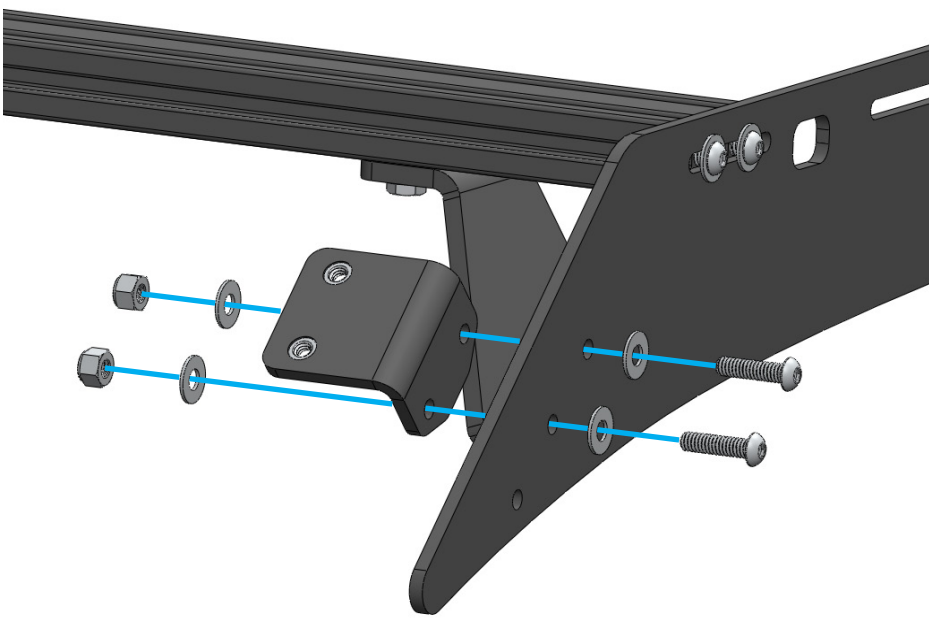

06

- Required Components:
4x 1/4"-20 x 1" Socket buttons
4x 1/4"-20 Nylock nuts
8x 1/4" Flat washers
2x Fairing brackets

Fasten the fairing brackets to the inside face of the sideplates using the supplied socket buttons, washers, and nylock nuts, as pictured.

For full-fairing installations, use the top two holes. For half fairings, use the bottom two.

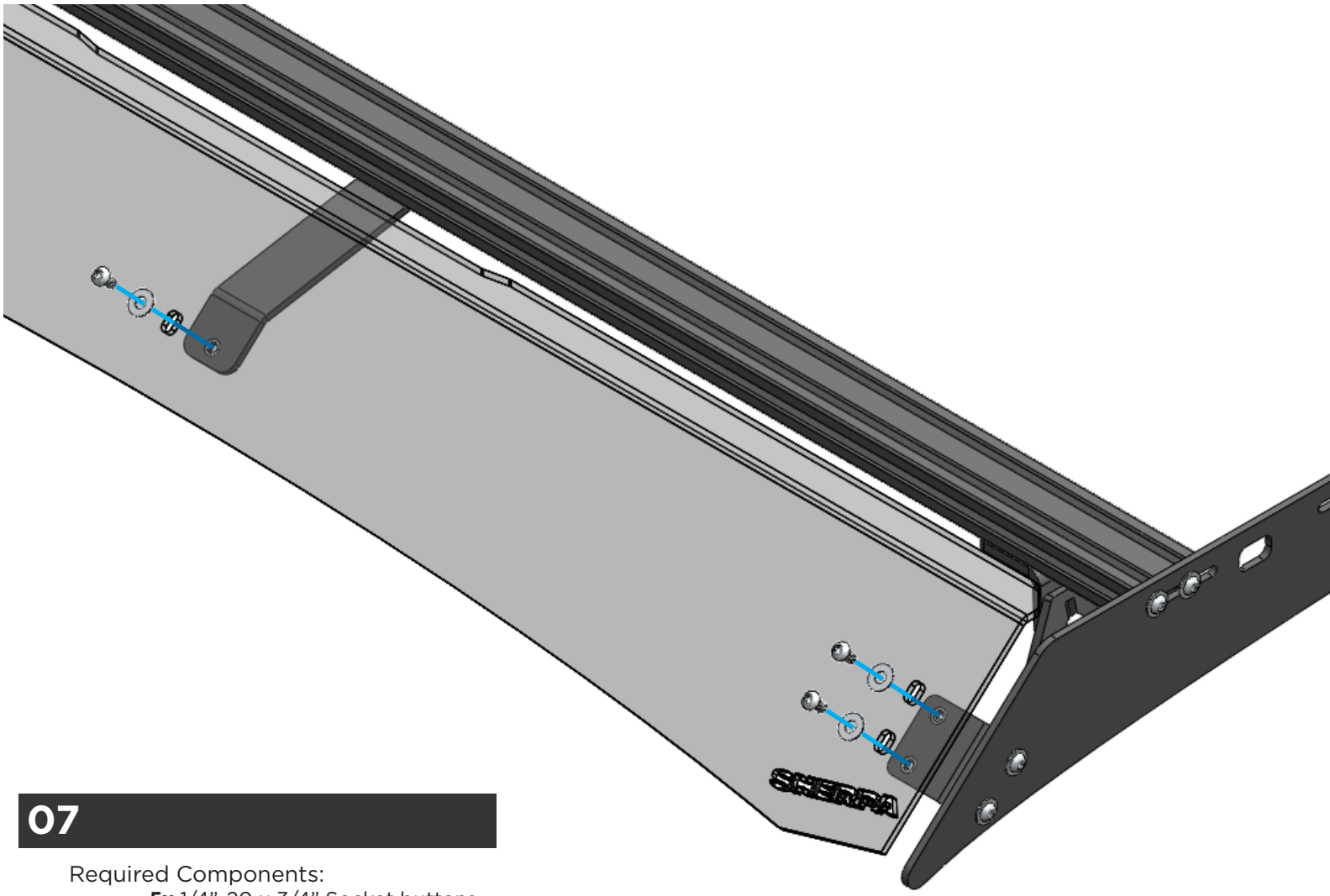

07

Required Components:

5x 1/4"-20 x 3/4" Socket buttons

5x 1/4" Flat washers

Place the fairing over the fairing brackets and fasten it to them using the supplied 1/4"-20 x 1/2" socket buttons and flat washers. **Do not exceed 35 in-lbs.** The hardware should be centered in the slots, but can be adjusted slightly up or down if needed. The bottom edge of the fairing should sit roughly 1/2" above the vehicle's roof and should not contact at any point.

TORQUE SPEC: 35 in-lb

Once the bracket hardware is tightened, move the fairing brace to the middle slot and install the final socket button and flat washer.

Tighten the **hex bolt** in the fairing brace under the front crossbar.

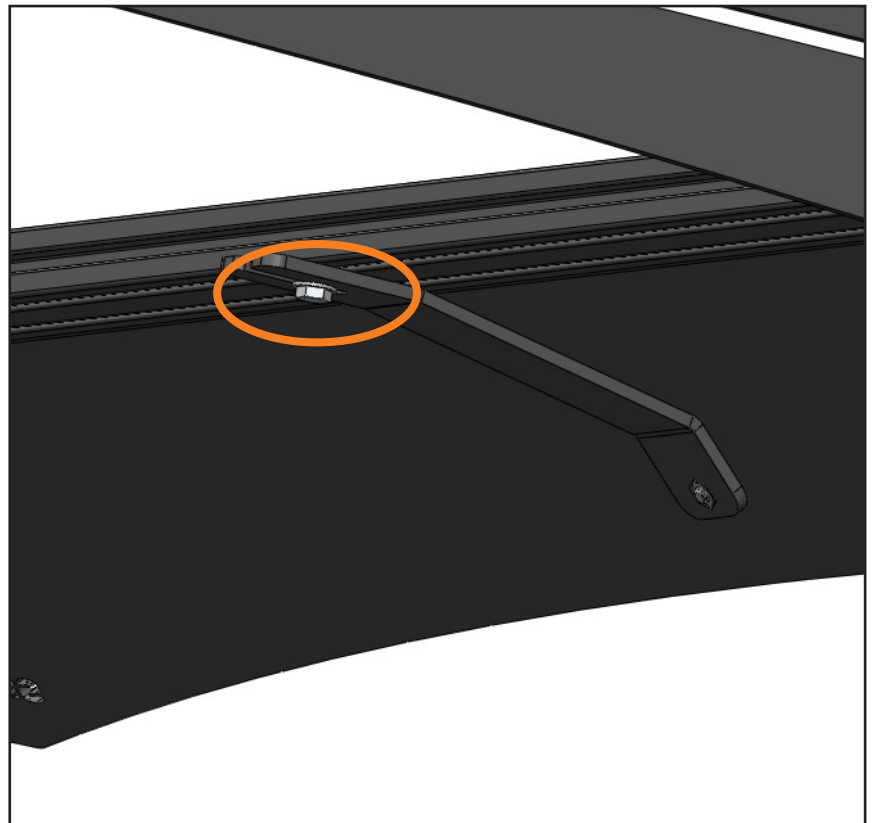



08

Required Components:

12x 1/4"-20 x 1" Socket buttons

12x 1/4" Flat Washers

3x Crossbars

Secure all of the remaining cross members to the rack system. Position according to your load requirements. Heavy loads should be evenly distributed across multiple crossbars are spaced accordingly.

EXPLORE.



All products built and designed by Sherpa Equipment Company are intended for off-road use and should be assembled, installed, and used according to Sherpa Equipment Company's recommendations. Sherpa Equipment Companies products should be used safely with good judgment towards others and surroundings.

By installing Sherpa Equipment Companies products on your vehicle you assume all liability. Sherpa Equipment Company will not be held liable for damages or loss associated with the installation or use of its products. It is recommended that you inspect your roof rack within the first 100 miles of installation and every 500 miles after.