

CAUTION!!

**DO NOT LEVERAGE ANY
TOOL AGAINST THE
BODY WHEN REMOVING
THE OEM ROOF RACK
PLASTIC END CAPS AS
THIS WILL CAUSE BODY
DAMAGE.**

DO NOT SET PRY TOOLS AGAINST ROOF TOP



CAUTION: USE ANTI-SEIZE LUBRICANT ON ALL SCREWS

GOBI TOYOTA 4 RUNNER 5TH GEN 2010-20 ROOF RACK INSTALLATION INSTRUCTIONS

Guidelines:

When using Load Carriers and Accessories, the user must understand the precautions. The points listed below will assist you in using the rack /carrier system and will encourage safety.

- For quality fits and safty, use only the recommended rack or accessory. Do not assume an accessory will fit, always check with dealer when obtaining new accessories. Use only approved accessories on load carriers. Using other brands will void your warrenty.
- Make sure all knobs, bolts, screws, straps, and locks are firmly attached, tightened and locked before every trip. Knobs, bolts, screws, straps, and locks must be periodically inspected for signs of wear, corrosion, and fatigue. Check your load at stops during the trip to insure continued fastening security.
- Check local and state laws governing projection of objects beyound the width of a vehicle. **Be aware of the width and height of your cargo since low clearance branches, bridges, and parking garages can affect the load** All cargo will affect the vehicle's driving behavior. Never drive with any lock, know, or rack in an open or unlocked position. All long loads such as, but not limited to sailboards, surfboards, kayaks, canoes, and lumber must be tied down front and rear to the bumpers or tow hooks, of the vehicle.
- Remove your rack accessories when they are not in use, before intering car washes, prior to taking in your vehicle for service, and whenever clearance may be an issue.
- All locks must be turned and moved periodically to insure smooth operation. Use graphite or similar dry lubricant to help this. Locks are designed to deter vandalism and theft. Remove valuable gear if your vehicle is unattended for an extended period. Place at least one key in the glove compartment.
- For safety to your vehicle and rack system, obey all posted speed limits and traffic cautions. Adapt your speed to the conditions of the road and the load being carried.
- Do not use load carriers and accessories for purposes other than those for which they were designed. Do not exceed their carrying capacity.
- Consult with your dealer if you have any questions regarding the operations and limits of this product. Review all instructions carefully.

CAUTION: USE ANTI-SEIZE LUBRICANT ON ALL SCREWS

GOBI TOYOTA 4 RUNNER 5TH GEN 2010-20 ROOF RACK INSTALLATION INSTRUCTIONS

Included in kit

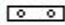
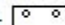
LETTER	DESCRIPTION	LOCATION	QUANTITY
A	GOBI TOYOTA 4 RUNNER 5TH GEN ROOF RACK	Main box	1
B	<p>WIND DEFLECTOR COMPLETE</p> <p><u>CONTENTS:</u></p> <p>1- Wind Deflector aluminum black powder coated (strapped to roof rack)</p> <p>3- Wind deflector mounting brackets pre-assembled to wind deflector</p> <p>1- Wind deflector clear wear strip packed in roll form (inside Bag #2)</p> <p>3- 1/4-20 x 3/4" Button head screw SS (inside Bag #2)</p> <p>6- 1/4" I.D. x 1/2" O.D. black nylon round washer (inside Bag #2)</p> <p>3- 1/4" Nylock nut SS (inside Bag #2)</p> <p>Wind deflector installation instructions inside Bag #2</p>	Wind deflector complete banded to roof rack including Bag #2	1
C	GOBI FRONT ADJUSTABLE SUPPORT BRACKETS DRIVER AND PASSENGER SIDE	Hardware box	1 ea.
D	GOBI RACK MIDDLE AND REAR SUPPORT BRACKETS	Hardware box	4
E	<p>GOBI RACK MOUNTING HARDWARE</p> <p><u>CONTENTS:</u> 4-Cover plates black powder coated</p> <p>12-Flat double hole rubber seals</p> <p>8-  4- </p> <p>8-1/2" Nylon spacers</p> <p>8-M8x50 Mounting screws SS</p> <p>8-5/16" Lock washers SS</p> <p>8-5/16" Water tight neoprene washers SS</p> <p>1-M5 Metric Allen wrench</p> <p>1-Packet of Anti-Seize lubricant</p>	BAG #3 Hardware Box	1
F	<p>GOBI RACK SUPPORT BRACKET HARDWARE</p> <p><u>CONTENTS:</u> 12- 3/8-16x1" Hex head bolt SS</p> <p>24- 3/8" Flat washer SS</p> <p>12- 3/8" Nylock nut SS</p> <p>6- Black rubber pad</p>	BAG #4 Hardware Box	1

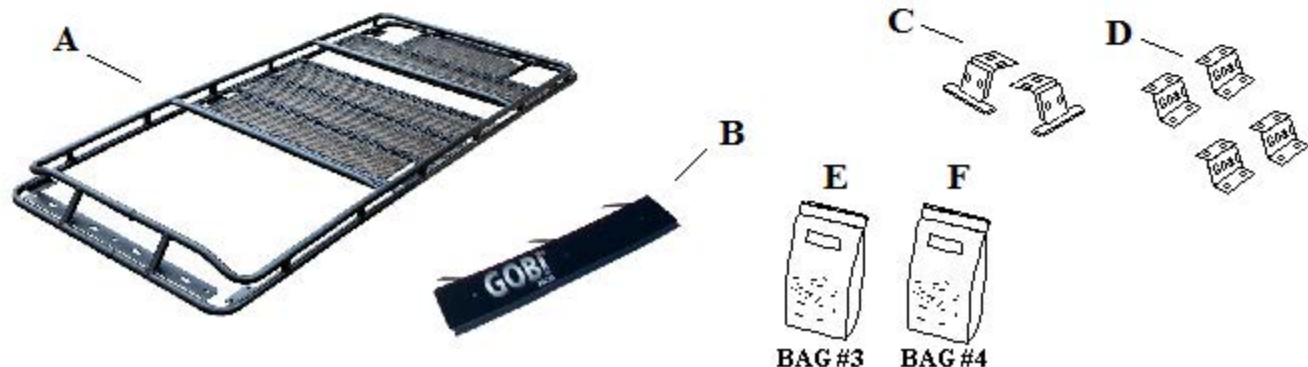

GOBI TOYOTA 4 RUNNER 5TH GEN 2010-20 ROOF RACK INSTALLATION INSTRUCTIONS

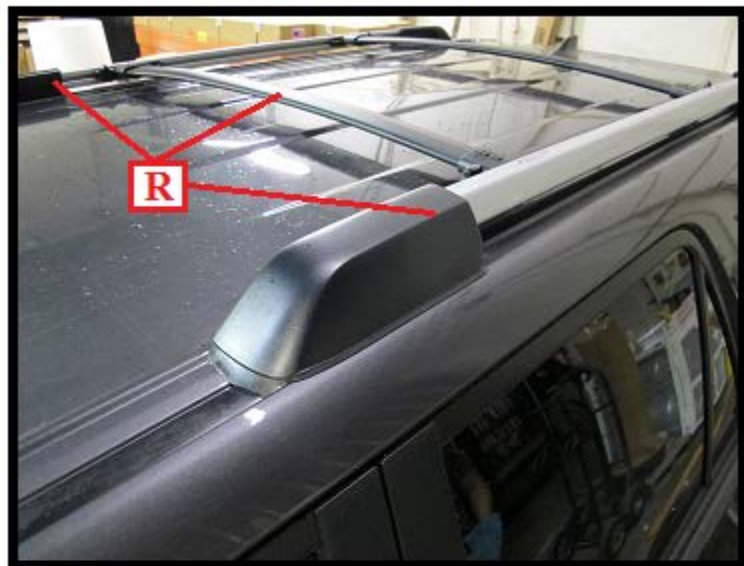
Fig. 1

The original roof top rails (R) as shown in Fig. 1 must be removed prior to Gobi rack installation.

To remove the OEM roof top rails use a thin pry tool and first remove the small plastic cover off the back end of the roof rail end cap (C) as shown in Fig. 2. This will provide space to use the thin pry tool to pull the end cap cover out and up as shown by the red arrows in Fig. 2. **(Do not pry against the vehicle to lift the end cap as this will damage the vehicle body).**

Fig. 2

Apply the same procedure to each end cap (C). Then remove the two hex head screws under each end cap using a 12mm ratchet. **CAUTION: DO NOT REMOVE SCREWS TOTALLY UNTIL BOTH SCREWS HAVE BEEN FULLY LOOSENED.** Lift the entire Original vehicle rail set (R) as shown in Fig. 1 off the roof top and set aside as it will no longer be needed. Clean the entire roof top at this time with mild soap and hot water. Make certain while you are cleaning the roof top that you do not allow water to enter the open screw holes on the vehicle roof top.

GOBI TOYOTA 4 RUNNER 5TH GEN 2010-20 ROOF RACK INSTALLATION INSTRUCTIONS

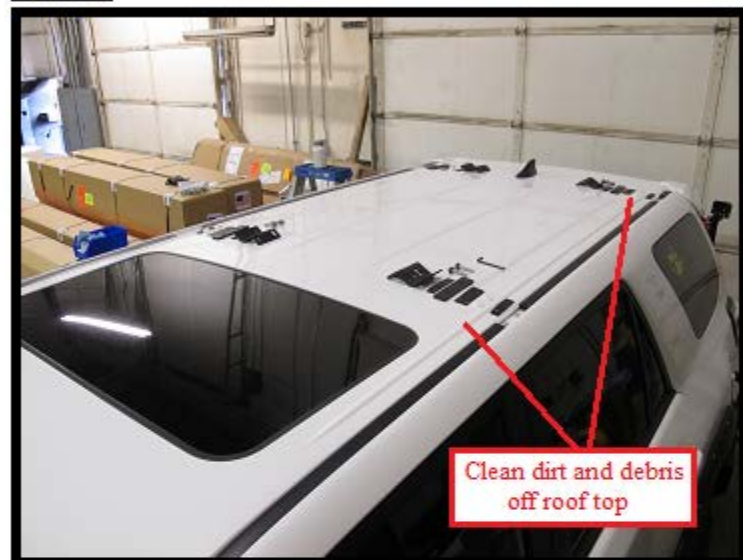
Fig. 3

Clean the roof top where each pad of the original roof rails was seated. Clean the area in and around each mounting point and remove all dirt and debris. As shown in Fig. 3 and Fig. 4.

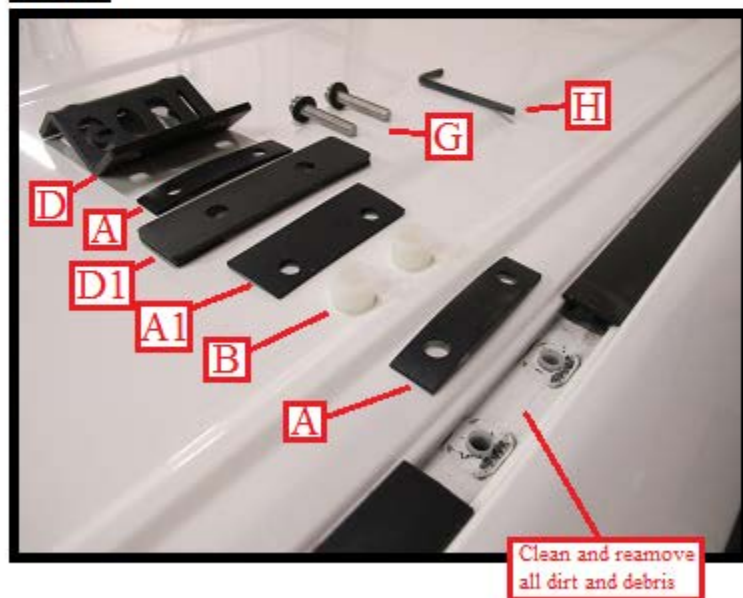
Fig. 4

Clean the area directly around each screw mounting point and lay out each part as shown in Fig. 4.

- A- (rubber seal)
- B- (nylon spacer x 2)
- A1- (rubber seal/debris cover)
- D1- (cover plate)
- A- (rubber seal)
- D- (roof rack support bracket middle and rear)
- G- (M8x50mm support bracket mounting screws, lock washers and water tight neoprene washer x 2)
- H- (5mm Allen wrench)

All above parts located in Bag #3 of your hardware kit for exception of (D) located in main hardware box.

GOBI TOYOTA 4 RUNNER 5TH GEN 2010-20 ROOF RACK INSTALLATION INSTRUCTIONS

Fig. 5

Place black seal (A) over and around each white straw tube as shown in Fig. 5 above.

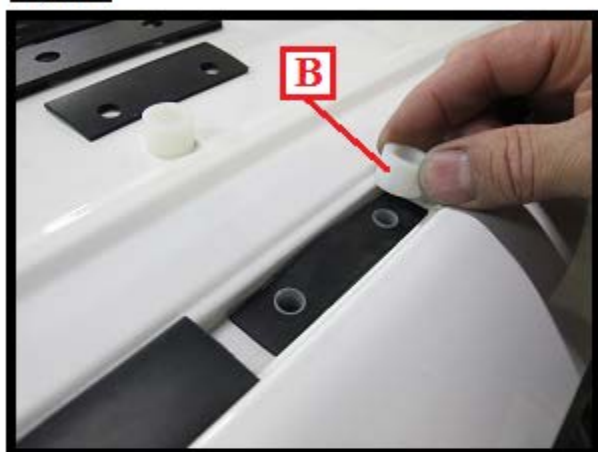
Fig. 6

Place one white nylon spacer (B) onto the rubber seal (A) and over each white straw tube as shown in Fig. 6 above.

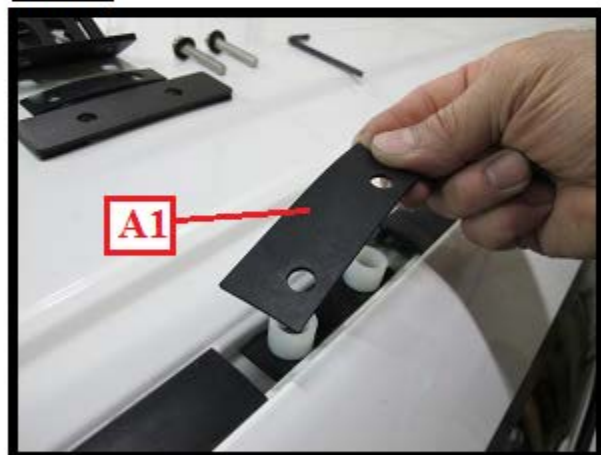
Fig. 7

Place black rubber seal/debris cover (A1) over both white nylon spacers as shown in Fig. 7 above.

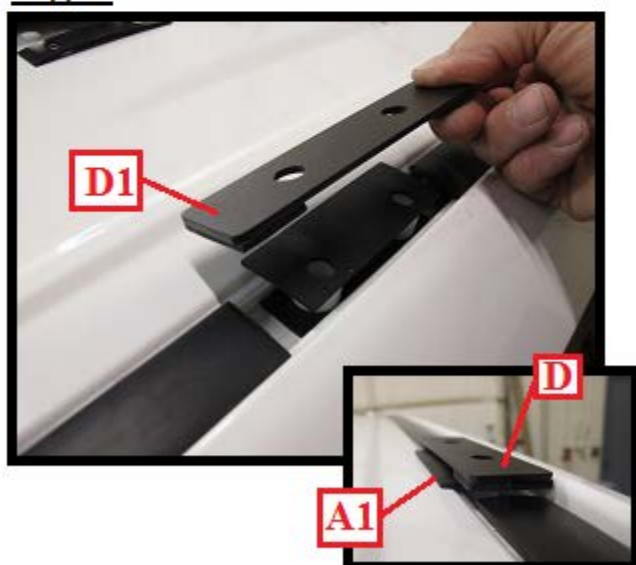
Fig. 8

Place the black powder coated cover plate (D1) over the black rubber seal/debris cover (A1) as shown in Fig. 8 above.

GOBI TOYOTA 4 RUNNER 5TH GEN 2010-20 ROOF RACK INSTALLATION INSTRUCTIONS

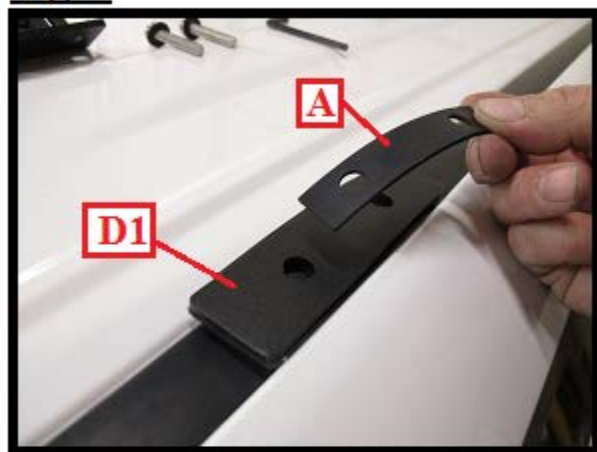
Fig. 9

Place one more seal (A) over the black powder coated cover plate (D1) and align all holes of all parts together with screw holes in roof top.

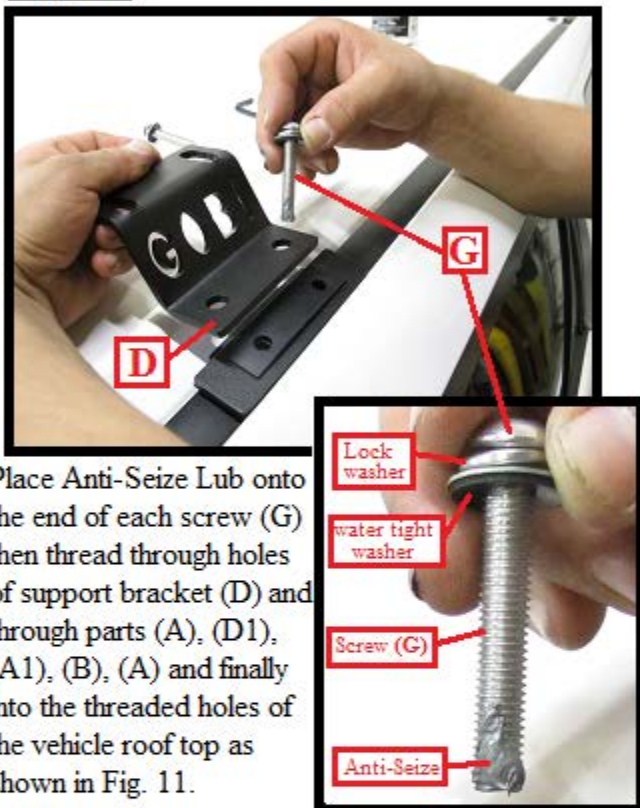
Fig. 10

Place Anti-Seize Lub onto the end of each screw (G) then thread through holes of support bracket (D) and through parts (A), (D1), (A1), (B), (A) and finally into the threaded holes of the vehicle roof top as shown in Fig. 11.

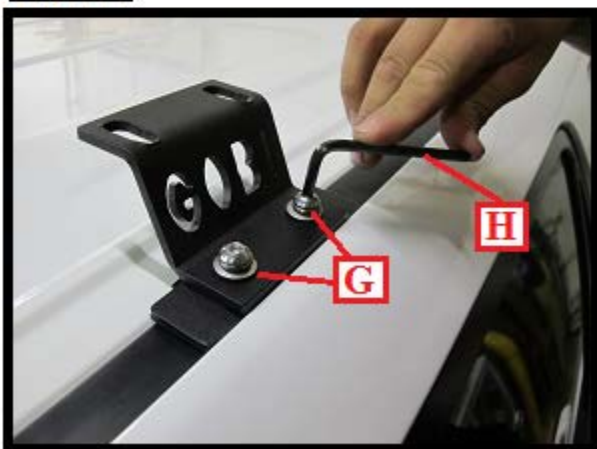
Fig. 11

Snug down both screws (G) using the 5mm Allen wrench (H) located in Bag #3 of your hardware kit. Do not fully tighten leave some play for adjustment.

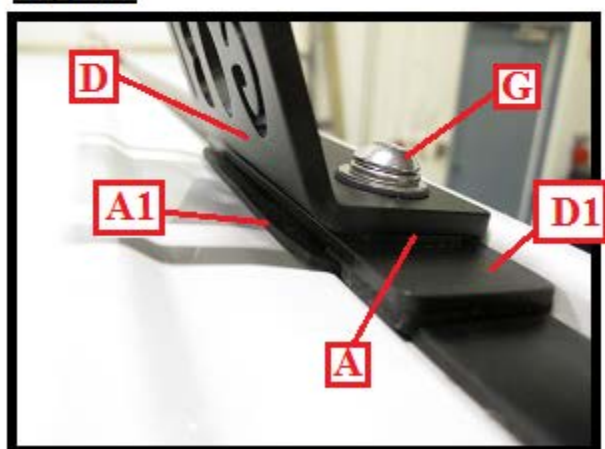
Fig. 12

The above picture shows a properly assembled Gobi roof rack support bracket (D) mounted to the Toyota 4 Runner 5th Gen roof top.

GOBI TOYOTA 4 RUNNER 5TH GEN 2010-20 ROOF RACK INSTALLATION INSTRUCTIONS

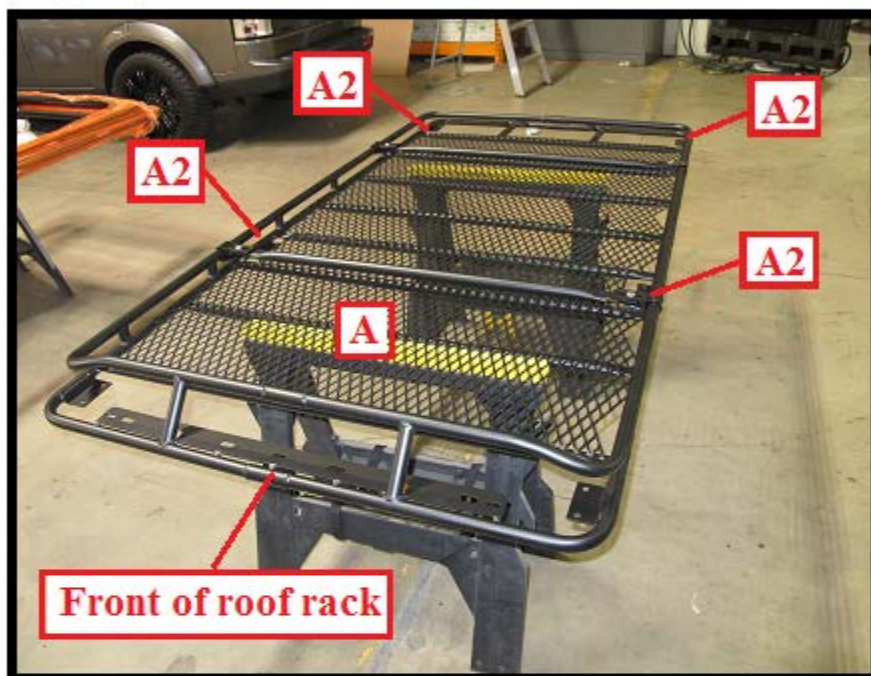
Fig. 13

With the help of others lift the Gobi roof rack (A) onto the roof top of your vehicle and align the 4 rear welded in flanges (A2) of Gobi rack (A) as shown in Fig. 13 with the 4 Gobi roof top support brackets (D) just recently installed as shown in Fig.14.

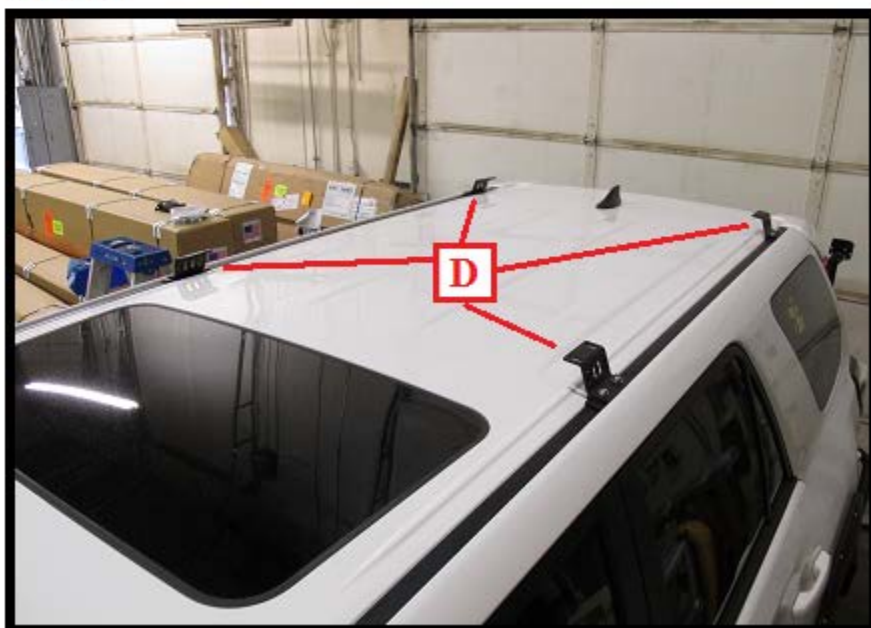
Fig. 14

GOBI TOYOTA 4 RUNNER 5TH GEN 2010-20 ROOF RACK INSTALLATION INSTRUCTIONS

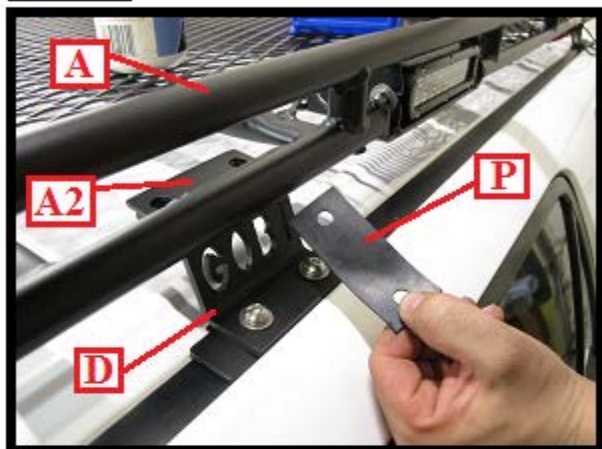
Fig. 15

Lift up rack (A) and slip a black rubber pad (P) located in Bag #4 of your hardware kit between flange (A2) and support bracket (D) and line up rubber pad holes with flange and support bracket as shown in Fig. 16 and 17.

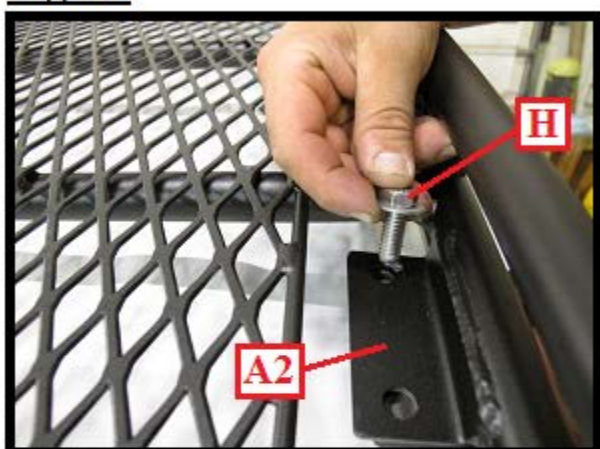
Fig. 16

Insert one 3/8-16 x 1" hex head screw and one 3/8" flat washer (H) through the top holes of flange (A2) and into rubber pad (P) then into support bracket (D) as shown in Fig. 16 and Fig. 17.

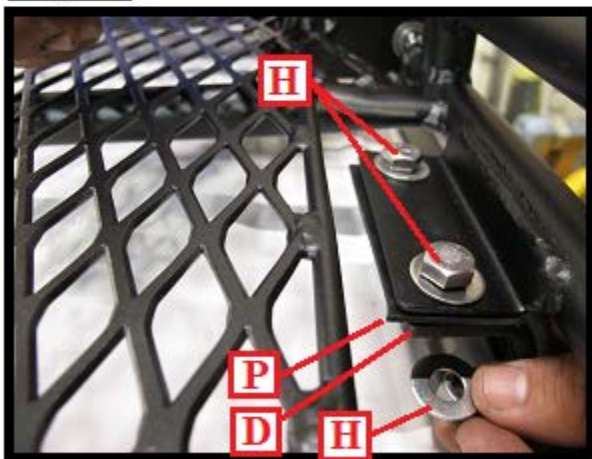
Fig. 17

Thread onto both screws (H) from the underside one 3/8" flat washer and 3/8" nylock nut as shown in Fig. 17. Finger tighten only. Apply the same procedure to the three remaining rear support brackets (D) and roof rack flanges (A2) and finger tighten only.

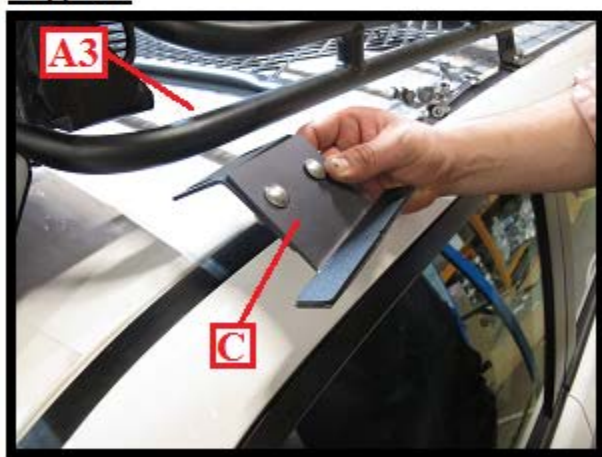
Fig. 18

Remove the driver side front support bracket (C) indicated by a label "DRIVER SIDE" located in your hardware box and slip under the front roof rack flange (A3) as shown in Fig. 18 through 21.

GOBI TOYOTA 4 RUNNER 5TH GEN 2010-20 ROOF RACK INSTALLATION INSTRUCTIONS

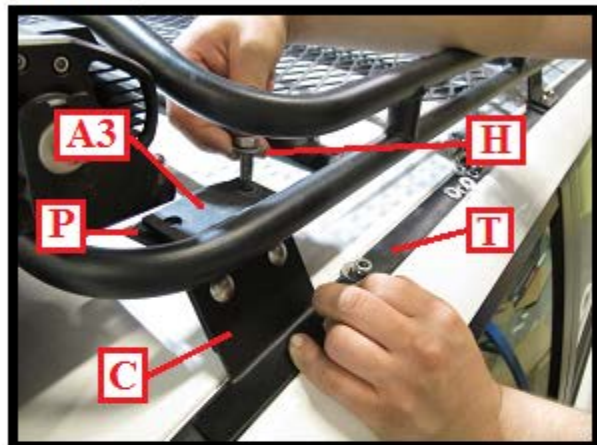
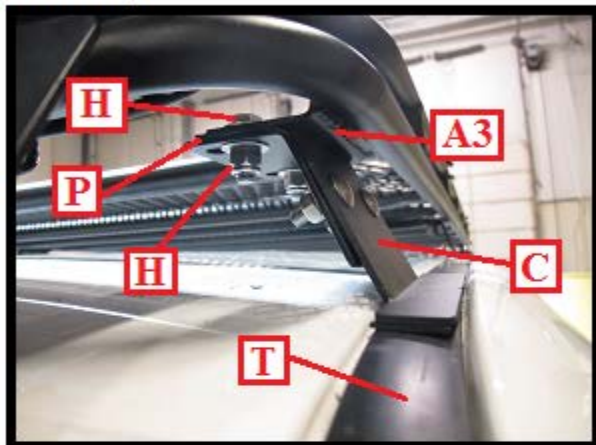
Fig. 19**Fig. 20**

Slip front Driver side support bracket (C) under roof rack front flange (A3) and over roof top rubber trim (T) as shown in Fig. 19 and 20. Then slip a rubber pad (P) between support bracket (C) and front roof rack flange (A3). Push into each hole one 3/8-16 x 1" hex head screw and 3/8" flat washer (H) down through rack flange (A3), rubber pad (P) and front support bracket (C) as shown in Fig. 19. Thread in place from the underside a 3/8" flat washer and 3/8" nylock nut located in Bag #4 as shown in Fig. 20. Do not fully tighten leave some room for adjustment. Apply the same procedure to the passenger side.

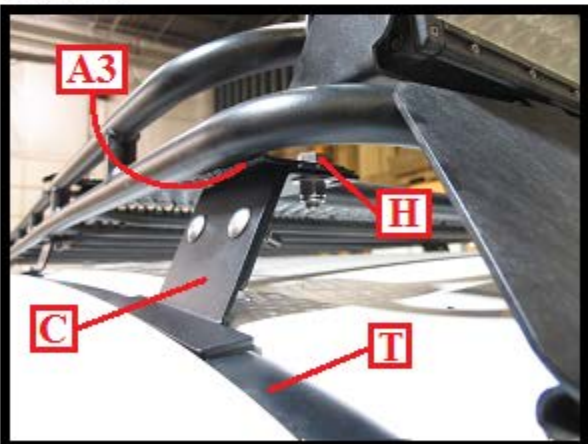
Fig. 21

After you have attached the passenger side front support bracket (C) as shown above, center roof rack on vehicle roof top. Recheck both support brackets (C) to make certain they are still positioned on roof top trim (T). Then fully tighten screws (H) both passenger and driver sides using two 9/16" box end or ratchet wrenches.

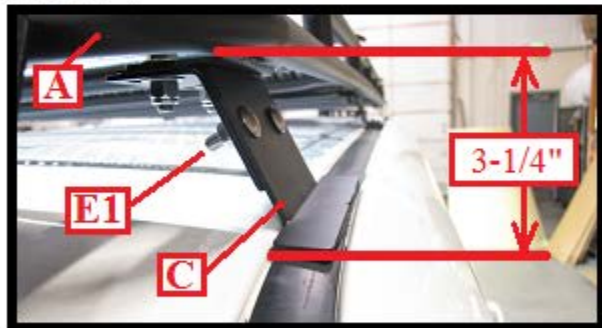
Fig. 22

Loosen screws (E1) on front Driver side support bracket (C) as shown above. Lift roof rack (A) while holding down support bracket (C) and adjust spacing between roof rack and roof top to measure approx. 3-1/4". After adjustment has been made fully tighten screws (E1) using a 1/2" box end wrench. Apply the same procedure to the passenger side. Now fully tighten all remaining screws (G) to roof top using a 5mm Allen wrench as shown in Fig. 11 then all remaining roof rack screws and nuts (H) to support brackets (D) as shown in Fig. 17.

ROOF RACK INSTALLATION COMPLETED

GOBI TOYOTA 4 RUNNER 5TH GEN 2010-20 ROOF RACK INSTALLATION INSTRUCTIONS

NOTE:

To properly install wind deflector to roof rack refer to wind deflector installation instructions supplied with your wind deflector mounting hardware



GOBI TOYOTA 4 RUNNER 5TH GEN ROOF RACK INSTALLATION COMPLETED