

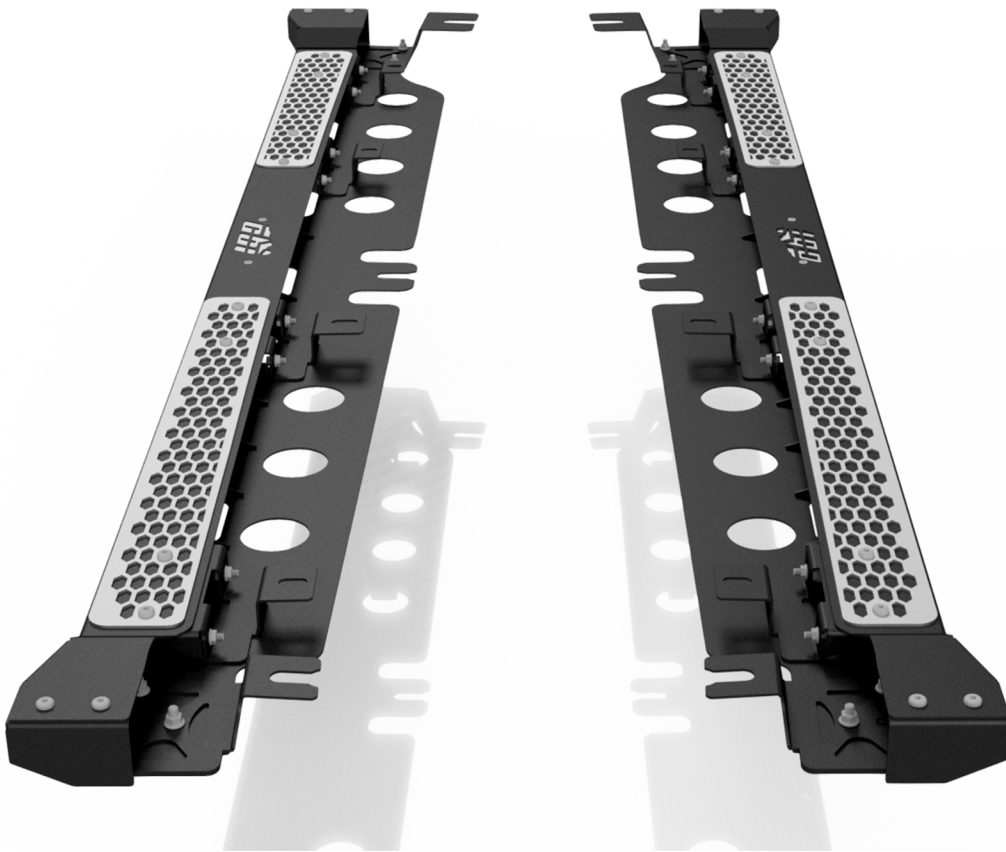

JEEP GLADIATOR ROCK SLIDER INSTALLATION GUIDE



All products built and designed by Prinsu Design Studio are intended for off-road use and should be assembled, installed, and used according to Prinsu Design Studio's recommendations. Prinsu Design Studio products should be used safely with good judgment towards others and the environment. By installing Prinsu Design Studio Products on your vehicle you assume all liability. Prinsu Design Studio will not be held liable for damages or loss associated with the installation or use of its products. Be smart, use good judgement, don't overload your vehicle to the point of inferior handling and maneuverability!



JEEP GLADIATOR ROCK SLIDER INSTALLATION GUIDE

INCLUDED HARDWARE LIST

PART	DESCRIPTION	QUANTITY
A	CARRIAGE BOLT ZINC 3/8"-16 x 1"	28
B	SERRATED HEX FLANGE NUT 3/8"-16	28
C	BUTTON HEAD SOCKET CAP SCREW 3/8"-16 x 1"	24
D	STEEL SPEED NUT 3/8"-16	24
E	STEEL HEX CAP SCREW 5/16"-18	16
F	SAE FLAT WASHER 5/16"	16
G	SS SERRATED HEX FLANGE NUT 5/16"-18	16
H	SS FLAT HD SOCKET #10 - 24 X 3/4"	4
I	STEEL K-LOCK NUT #10 - 24	4

All products built and designed by Prinsu Design Studio are intended for off-road use and should be assembled, installed, and used according to Prinsu Design Studio's recommendations. Prinsu Design Studio products should be used safely with good judgment towards others and the environment. By installing Prinsu Design Studio Products on your vehicle you assume all liability. Prinsu Design Studio will not be held liable for damages or loss associated with the installation or use of its products. Be smart, use good judgement, don't overload your vehicle to the point of inferior handling and maneuverability!



JEEP GLADIATOR ROCK SLIDER INSTALLATION GUIDE

STEP 1: REMOVE THE STOCK ROCK GUARDS AND THEN REMOVE THE THREE MIDDLE BODY MOUNT BOLTS

* ONLY DO ONE SIDE AT A TIME

* APPLY HEAT TO BODY MOUNT BOLTS TO BREAK DOWN LOCTITE



STEP 2: ATTACH MOUNTING BRACKETS TO PINCH WELD SEAM EXPOSED BY REMOVING THE STOCK ROCK GUARDS ...

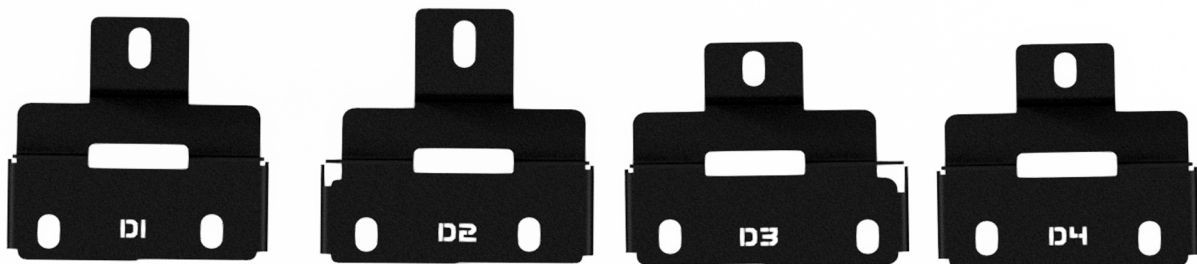

All products built and designed by Prinsu Design Studio are intended for off-road use and should be assembled, installed, and used according to Prinsu Design Studio's recommendations. Prinsu Design Studio products should be used safely with good judgment towards others and the environment. By installing Prinsu Design Studio Products on your vehicle you assume all liability. Prinsu Design Studio will not be held liable for damages or loss associated with the installation or use of its products. Be smart, use good judgement, don't overload your vehicle to the point of inferior handling and maneuverability!



JEEP GLADIATOR ROCK SLIDER INSTALLATION GUIDE

CONT'D: USE THE FACTORY HARDWARE TO BOLT TO THE UNDERBODY AND THE PROVIDED HARDWARE TO BOLT TO THE SEAM

PARTS

- (D) x 16
- (E) x 16
- (F) x 16
- (G) x 16

***FACTORY HARDWARE**

STEP 3: ATTACH FRONT AND REAR BODY MOUNT BOLT BRACKETS

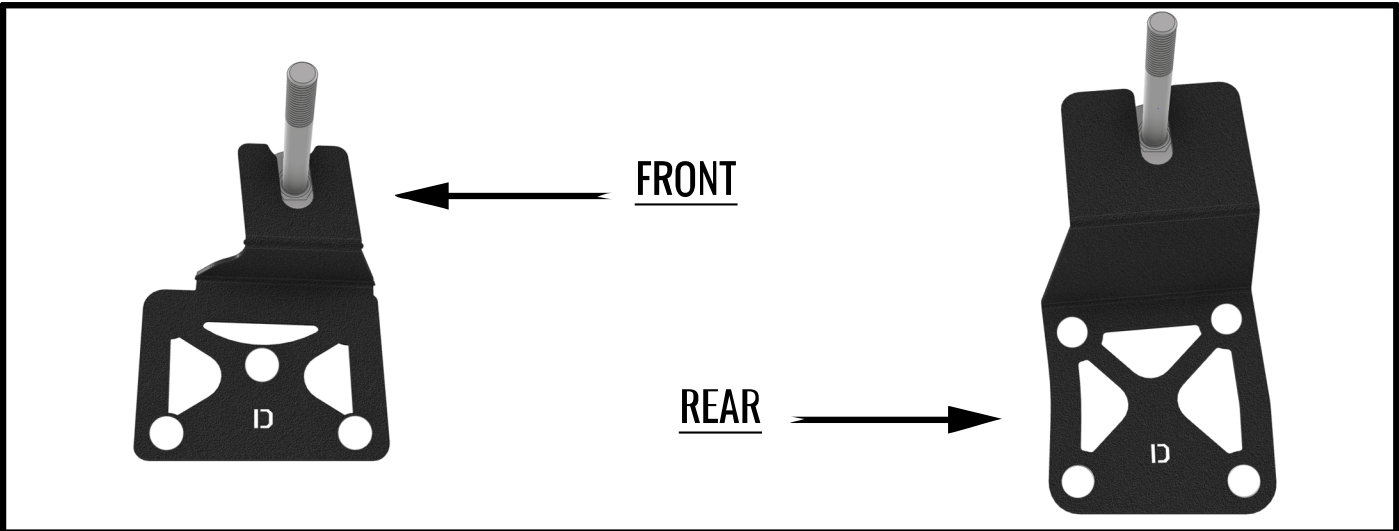

All products built and designed by Prinsu Design Studio are intended for off-road use and should be assembled, installed, and used according to Prinsu Design Studio's recommendations. Prinsu Design Studio products should be used safely with good judgment towards others and the environment. By installing Prinsu Design Studio Products on your vehicle you assume all liability. Prinsu Design Studio will not be held liable for damages or loss associated with the installation or use of its products. Be smart, use good judgement, don't overload your vehicle to the point of inferior handling and maneuverability!



JEEP GLADIATOR ROCK SLIDER INSTALLATION GUIDE

CONT'D: USE THE FACTORY HARDWARE TO BOLT THE BODY MOUNT BOLT BRACKETS TO THE VEHICLE

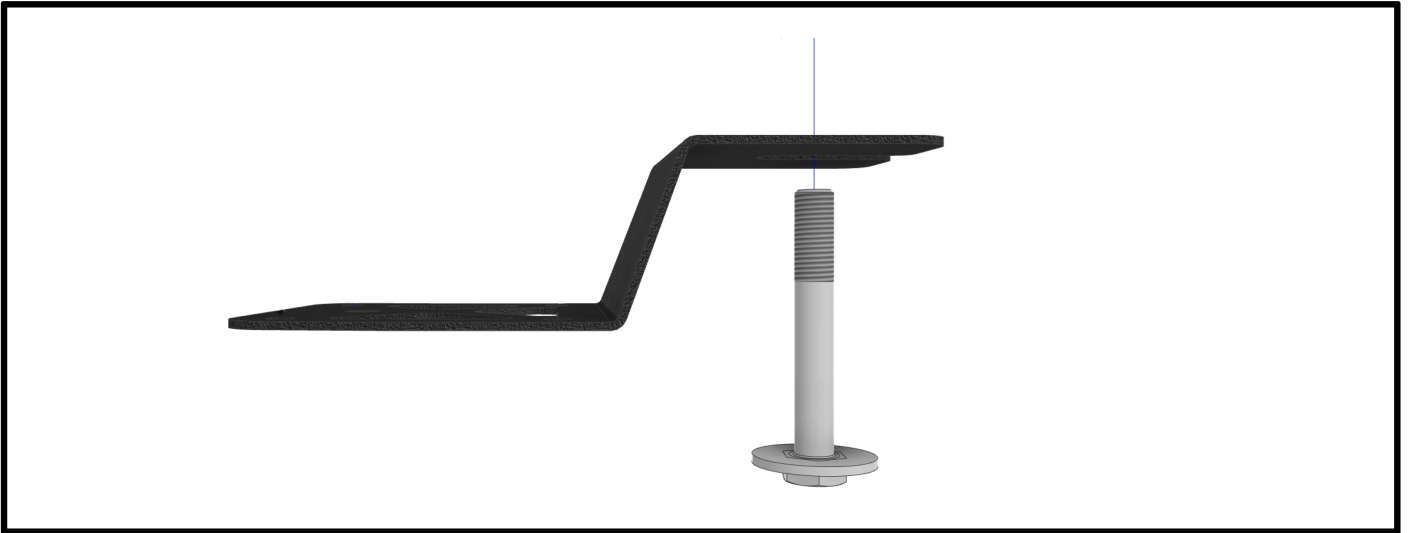

STEP 4: SLIDE THE BOTTOM PLATE INTO PLACE OVER THE MIDDLE BODY MOUNT BOLT THEN TIGHTEN ...

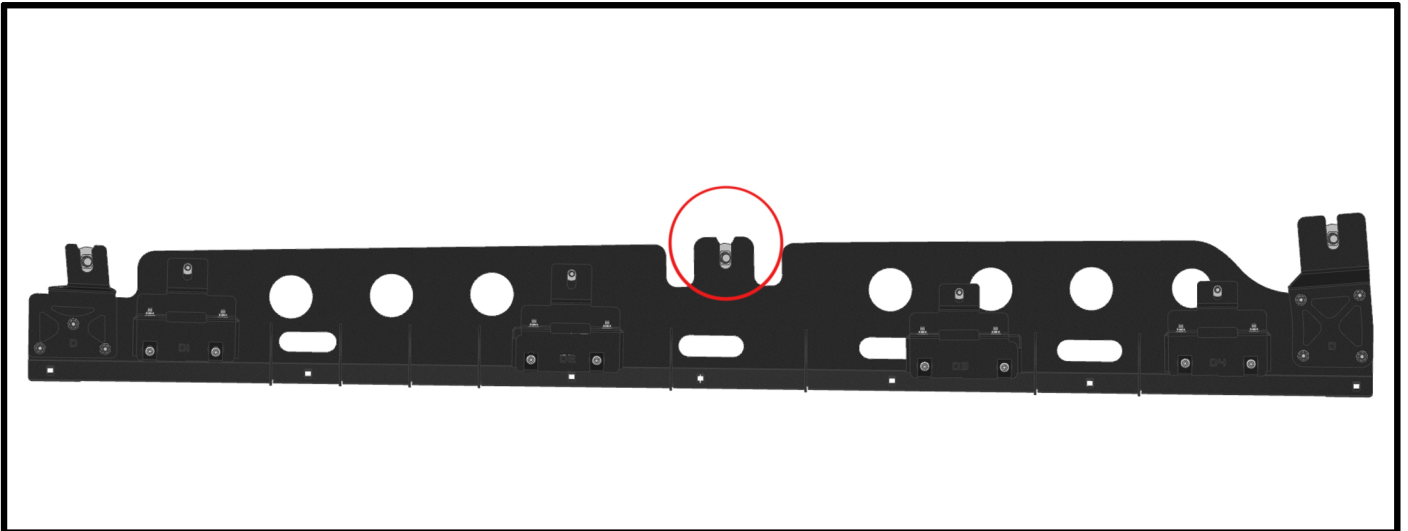

All products built and designed by Prinsu Design Studio are intended for off-road use and should be assembled, installed, and used according to Prinsu Design Studio's recommendations. Prinsu Design Studio products should be used safely with good judgment towards others and the environment. By installing Prinsu Design Studio Products on your vehicle you assume all liability. Prinsu Design Studio will not be held liable for damages or loss associated with the installation or use of its products. Be smart, use good judgement, don't overload your vehicle to the point of inferior handling and maneuverability!



JEEP GLADIATOR ROCK SLIDER INSTALLATION GUIDE

CONT'D: BOLT BODY MOUNT BRACKETS TO BOTTOM PLATE

PARTS
(A) x 14
(B) x 14

STEP 5: ATTACH LOGO BACKING TO TOP PLATE

PARTS
(H) x 4
(I) x 4

All products built and designed by Prinsu Design Studio are intended for off-road use and should be assembled, installed, and used according to Prinsu Design Studio's recommendations. Prinsu Design Studio products should be used safely with good judgment towards others and the environment. By installing Prinsu Design Studio Products on your vehicle you assume all liability. Prinsu Design Studio will not be held liable for damages or loss associated with the installation or use of its products. Be smart, use good judgement, don't overload your vehicle to the point of inferior handling and maneuverability!



JEEP GLADIATOR ROCK SLIDER INSTALLATION GUIDE

STEP 6: SLIDE THE TOP PLATE OVER OVER THE BOTTOM PLATE AND MOUNTING BRACKETS...

PARTS

(C) x 16

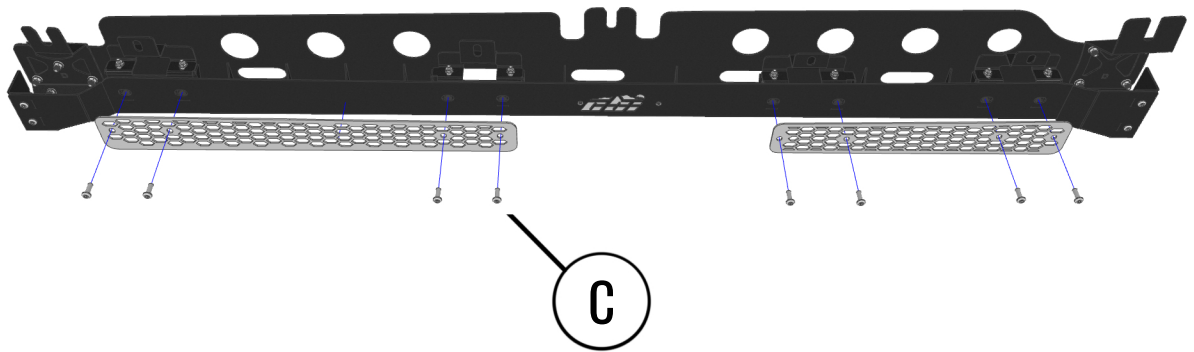

CONT'D: POSITION THE FRONT AND REAR GRIP PLATE AND TIGHTEN

*

TAKE NOTE THAT TO DETERMINE THE PROPER ORIENTATIN OF THE GRIP PLATES THE THINNER EDGE FACES TOWARDS THE VEHICLE

THIN EDGE

THICK EDGE

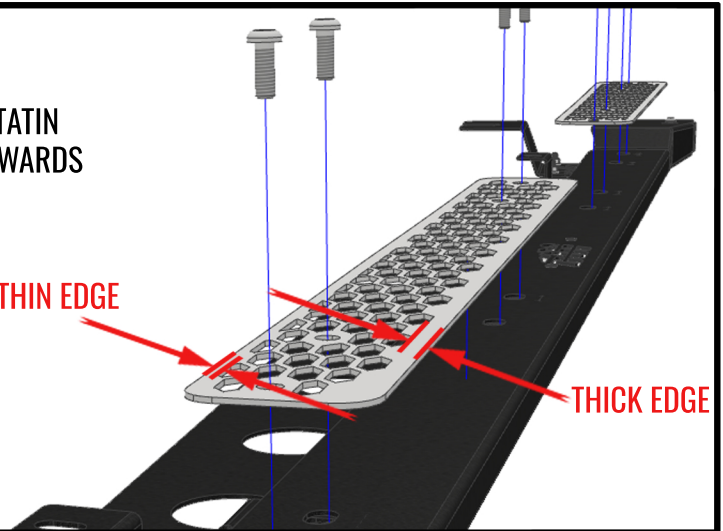

All products built and designed by Prinsu Design Studio are intended for off-road use and should be assembled, installed, and used according to Prinsu Design Studio's recommendations. Prinsu Design Studio products should be used safely with good judgment towards others and the environment. By installing Prinsu Design Studio Products on your vehicle you assume all liability. Prinsu Design Studio will not be held liable for damages or loss associated with the installation or use of its products. Be smart, use good judgement, don't overload your vehicle to the point of inferior handling and maneuverability!



JEEP GLADIATOR ROCK SLIDER INSTALLATION GUIDE

STEP 7: ATTACH TOP PLATE TO BOTTOM PLATE ...

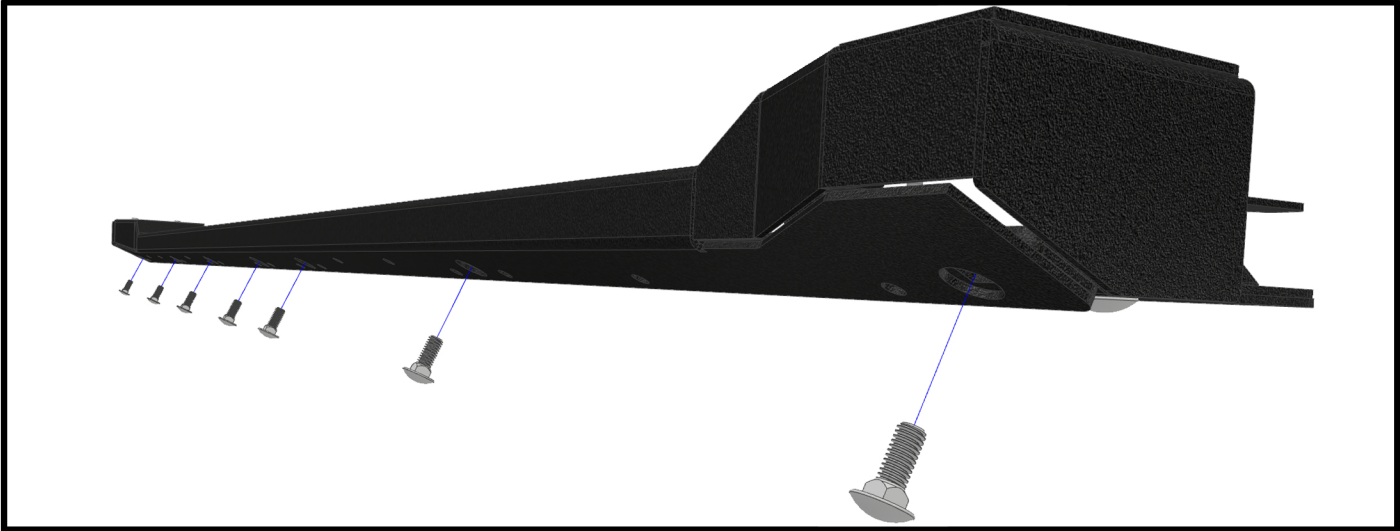

CONT'D: SLIDE CARRIGE BOLTS INTO THIER SLOTS & ATTACH FLANGE NUTS ON THE REAR TO TIGHTHEN

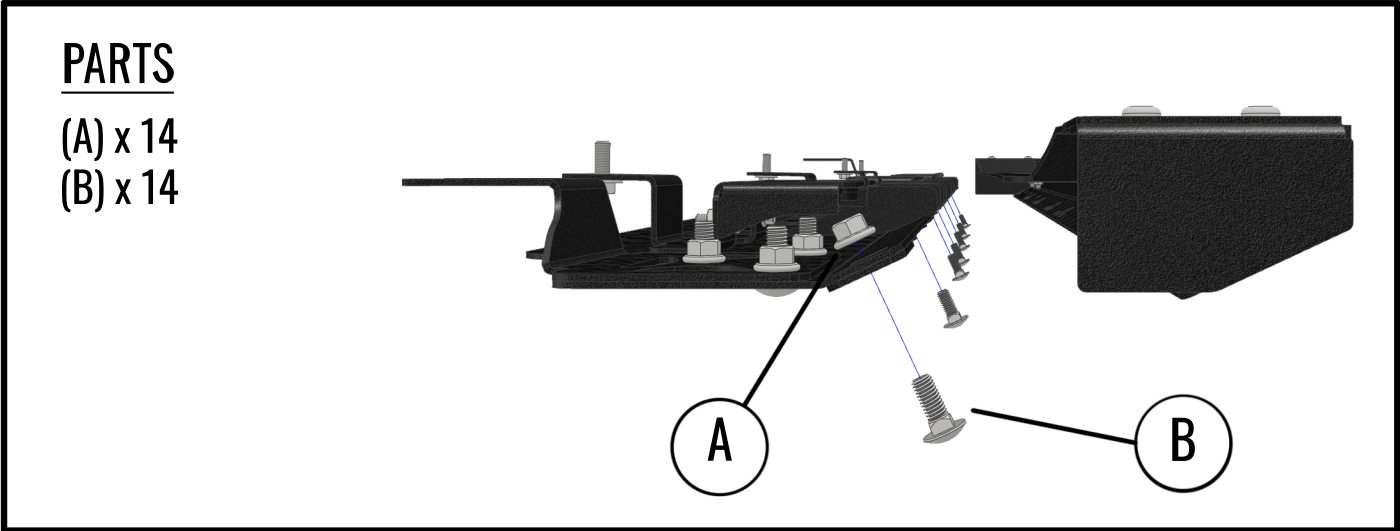

All products built and designed by Prinsu Design Studio are intended for off-road use and should be assembled, installed, and used according to Prinsu Design Studio's recommendations. Prinsu Design Studio products should be used safely with good judgment towards others and the environment. By installing Prinsu Design Studio Products on your vehicle you assume all liability. Prinsu Design Studio will not be held liable for damages or loss associated with the installation or use of its products. Be smart, use good judgement, don't overload your vehicle to the point of inferior handling and maneuverability!



JEEP GLADIATOR ROCK SLIDER INSTALLATION GUIDE

STEP 8: LASTLY ATTACH THE END CAP COVERS BY SLIDING THE CLIP NUTS OVER THE COVERS THEN BOLTING TO THE STEPS

PARTS

- (C) x 8
- (D) x 8

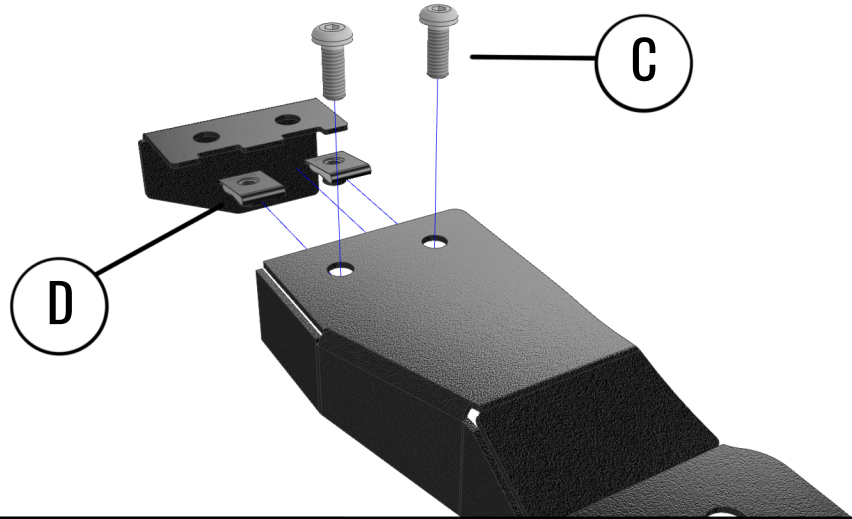

INSTALLATION COMPLETE:

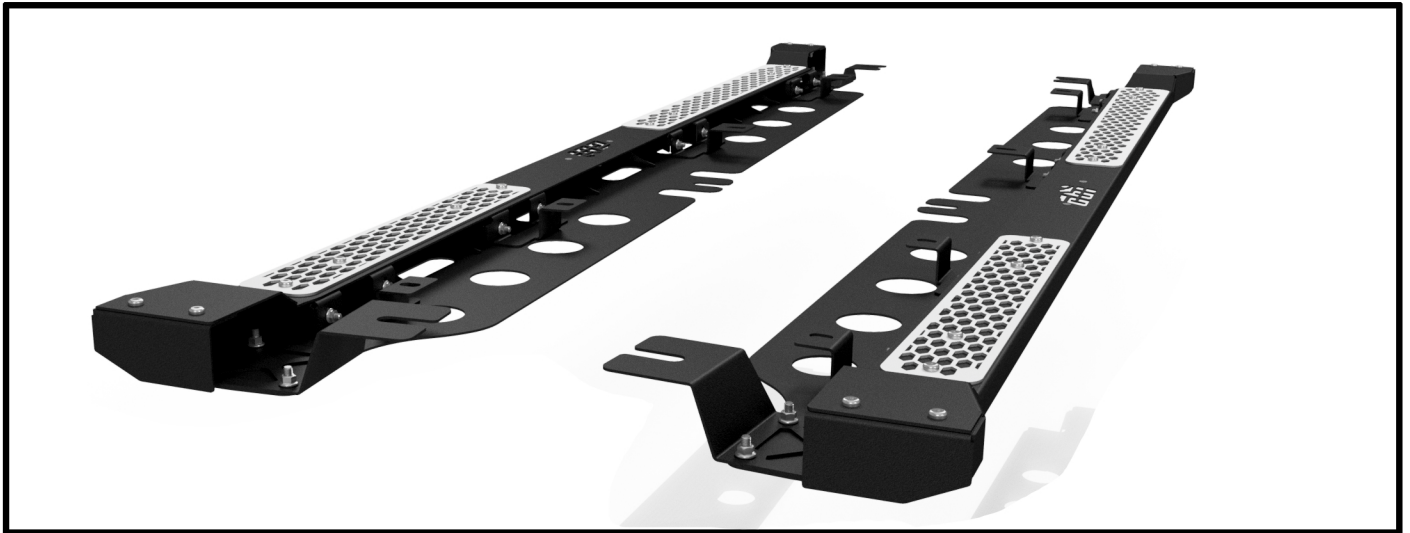

All products built and designed by Prinsu Design Studio are intended for off-road use and should be assembled, installed, and used according to Prinsu Design Studio's recommendations. Prinsu Design Studio products should be used safely with good judgment towards others and the environment. By installing Prinsu Design Studio Products on your vehicle you assume all liability. Prinsu Design Studio will not be held liable for damages or loss associated with the installation or use of its products. Be smart, use good judgement, don't overload your vehicle to the point of inferior handling and maneuverability!



WARRANTY / LIABILITY INFORMATION

CBI OFFROAD WARRANTY

CBI OFFROAD FAB will warranty all CBI OFFROAD FAB manufactured parts for a LIFETIME of use. This limited Lifetime Warranty is effective for as long as the original retail purchaser owns the product. This warranty terminates when the original retail purchaser sells or otherwise transfers the product to any other person. Each manufactured product must be installed following CBI OFFROAD FAB'S recommended fitment and installation procedures. Any customization or modification to the original product design, functionality, or use, either by said customer or by CBI OFFROAD FAB voids all warranty eligibility. It is the sole discretion of CBI Offroad to determine warranty eligibility.

Subject to the limitations and exclusions described in this warranty, CBI OFFROAD FAB will remedy defects in materials or workmanship by repairing or replacing, at its option, a defective product without charge for parts. In addition, CBI OFFROAD FAB may elect, at its option, not to repair or replace a defective product but rather issue to a purchaser a refund equal to the purchase price paid for the product or a credit to be used toward the purchase of a new CBI OFFROAD FAB product.

No warranty is given for defects caused by normal wear and tear, cosmetic rust, scratches, accidents, unlawful vehicle operation, products used for racing or competition, or modification of, or any types of repair of, a CBI OFFROAD FAB manufactured product.

The CBI OFFROAD FAB Warranty does not include the powder coated finish.

No warranty is given for defects resulting from conditions beyond CBI OFFROAD FAB'S control including, but not limited to, misuse, neglect, overloading, improperly maintained or failure to assemble, mount or use the product in accordance with CBI OFFROAD FAB'S written instructions or guidelines included with the product or implied use made available to the purchaser.

DISCLAIMER OF LIABILITY

REPAIR OR REPLACEMENT OF A DEFECTIVE PRODUCT OR THE ISSUANCE OF A REFUND OR CREDIT (AS DETERMINED BY CBI OFFROAD FAB) IS A PURCHASER'S EXCLUSIVE REMEDY UNDER THIS WARRANTY. DAMAGE TO A PURCHASER'S VEHICLE, CARGO AND/OR TO ANY OTHER PERSON OR PROPERTY IS EXCLUDED.

THIS WARRANTY IS EXPRESSLY MADE IN LIEU OF ANY AND ALL OTHER WARRANTIES, EXPRESS OR IMPLIED, INCLUDING THE WARRANTIES OF MERCHANTABILITY AND FITNESS FOR A PARTICULAR PURPOSE.

CBI OFFROAD FAB'S SOLE LIABILITY TO ANY PURCHASER IS LIMITED TO THE REMEDY SET FORTH ABOVE. IN NO EVENT WILL CBI OFFROAD FAB BE LIABLE FOR ANY LOST PROFITS, LOST SALES, OR FOR ANY CONSEQUENTIAL, DIRECT, INDIRECT, INCIDENTAL, SPECIAL, EXEMPLARY, OR PUNITIVE DAMAGES OR FOR ANY OTHER DAMAGES OF ANY KIND OR NATURE.

*** WARNING: Neither the seller nor the manufacturer will be liable for any loss, damage, or injury directly or indirectly arising from the use of or inability to determine the use of these products. Before using, the user shall determine the suitability of the product(s) for its intended use(s), and the user shall assume all responsibility and risk in connection therewith.***