

Installation Guide for 14-21 Toyota Tundra PRO-Series LED Tail lights

ALPHAREX specializes in designing and producing superior and uniquely stylish aftermarket automotive performance lighting with unrival innovative technology. The following installation guide we take you through the installation of your new **ALPHAREX TAIL LIGHTS** for your 14-21 Toyota Tundra step by step.



Table of Contents



PART I REMOVE TAIL LIGHTS

- **INSTALLATION TOOLS**
- **STEP 1.** Remove tail lights screws
- **STEP 2.** Remove the sockets and the tail lights

PART II INSTALL ALPHAREX TAIL LIGHTS

- **STEP 1.** Connect the sockets and install tail lights
- **STEP 2.** Complete Installation

PART I REMOVE TAIL LIGHTS

INSTALLATION TOOLS

PREPARE THESE TOOLS FOR INSTALLATION

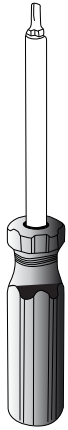

Torx
Screwdriver



1/4 Ratchet



1/4 Extension

T30
Star Torx



Socket

NOTE: Whenever using a power tool, please make sure do not overtighten the screws.

Whenever working on your vehicle always make sure your vehicle is parked with the ignition off.



STEP 1. REMOVE TAIL LIGHTS SCREWS

Open the trunk gate and start by removing the tail light's screws.



Use Torx screwdriver to remove the top and bottom T30 screws from each side of the tail lights.



Gently remove the tail lights by pulling outward.



STEP 2. REMOVE THE SOCKETS AND THE TAIL LIGHTS

In order to remove the tail light. First, twist to remove the TURN SIGNAL light bulb socket and remove light bulb. Second, twist to remove the REVERSE light bulb socket and retain the light bulb for later installation. Third, twist to remove the PARKING/ BRAKE light bulb socket and remove the light bulb.

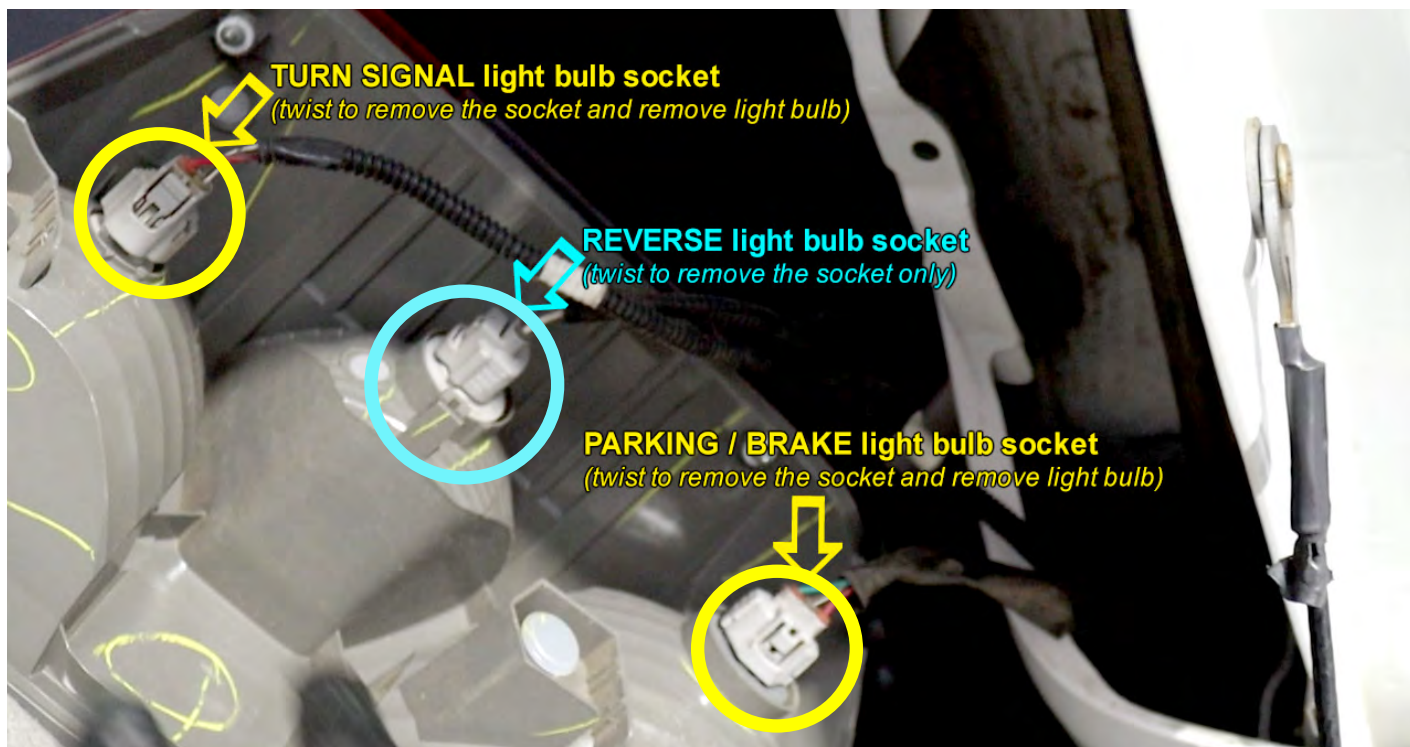

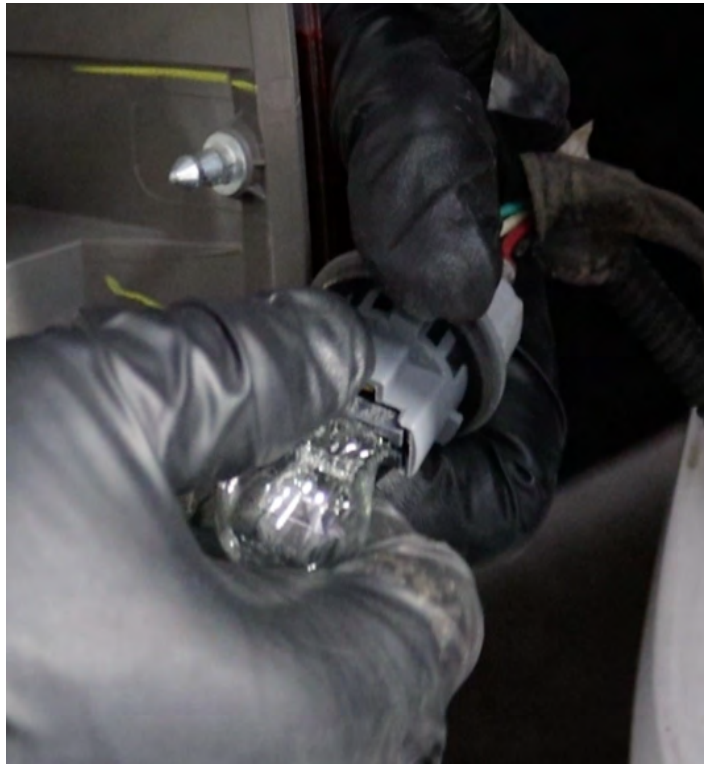

Repeat the same steps for the other side of the tail light for the removal.



PART II INSTALL ALPHAREX TAIL LIGHTS



STEP 1. CONNECT THE SOCKETS AND INSTALL TAIL LIGHTS

First, install the REVERSE light bulb socket directly to the bottom of the new ALPHAREX tail light. Twist clockwise to lock the socket.



Second, plug the PARKING / BRAKE light connector directly into the vehicle's socket.
Third, plug the TURN SIGNAL light connector directly into the vehicle's socket.
Make sure to twist (clockwise) and lock the sockets tightly to prevent any dirt/moisture built up.
Please follow the same steps for the other side of the tail light.

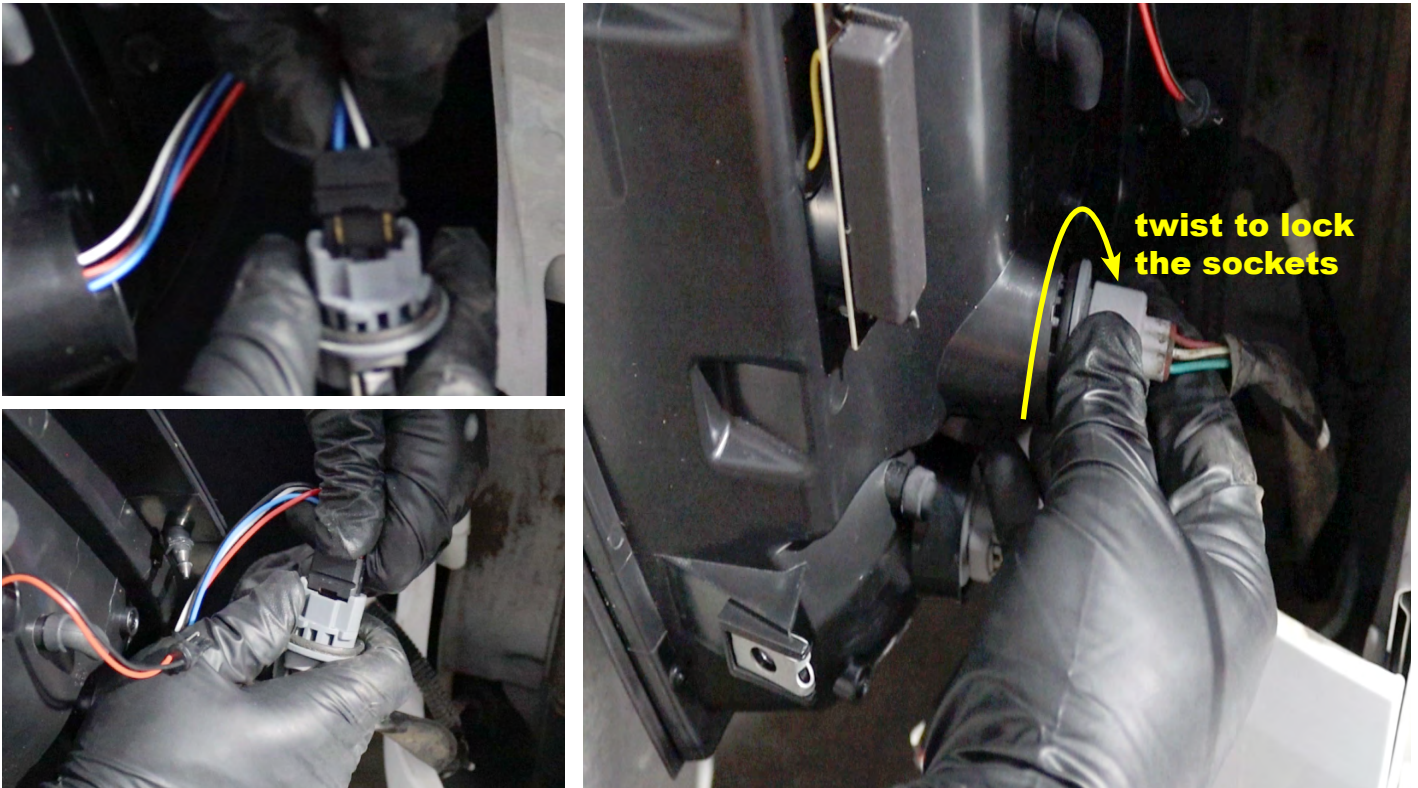

After the sockets are connected into the new ALPHAREX tail lights, reverse the removal process to install the new tail lights into the vehicle.



Use Torx screwdriver to tighten the 2 X T30 screws for each side.



STEP 2. COMPLETE INSTALLATION

Congratulations! You have completed the installation for ALPHAREX 14-21 Toyota Tundra PRO-Series LED tail lights.

