

# Tach/hour meter

Please read and understand following notice carefully, and correctly install and operate the product before using.

## 1 Notice



WARNING



DO NOT DISASSEMBLE



WATERPROOF

1. Please use the product accordance with the user manual strictly.
2. Please do not try to disassemble the main unit and its accessories.
3. This product with waterproof design can be used in the rain, and can be used underwater for a short while.
4. Fierce vibration and strong impact may make the product failure.
5. Little error will be happened when measuring, within the normal range.

## 2 Product accessories list

- Product x 1
- User manual x 1
- 3M Double-sided adhesive tape x 1
- Left plug x 1
- Right plug x 1
- Screws x 2

## 3 Product dimension

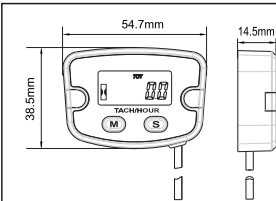

## 4 Installation

1. Notice: 3 different installation methods are available for the product. Please use any one of the 3 installation methods as per users' needs.

### a) Double-sided adhesive tape



### b) Screws



※Mounting plate should have the related fixing holes. If no, please make the fixing holes on the mounting plate.

### c) Aluminum Frame Mounting brackets.

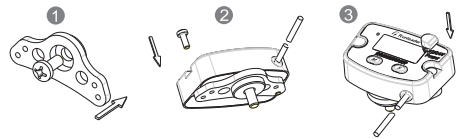

Notice: When users need aluminum alloy mounting bracket, please purchase it separately.

2. Wrap one side of the cable to engine's spark plug wire 5 circles or more, and fixed by zip ties.

Notice: If the cable was not be fixed firmly will affect the accuracy of the test data.

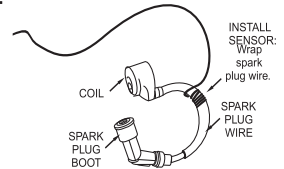

3. Verify the accuracy of the product installation

Start the engine, the hourglass on the LCD flashes, which shows the product is installed correctly.

## 5 Interface switching

There are six main interfaces, at non-setting state, short press the **S** button once for switching.

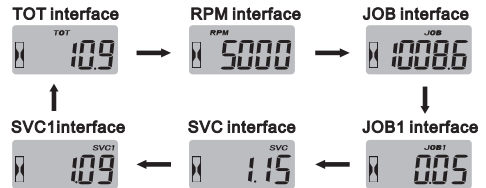

## 6 Interface operation/display

### 1. TOT function

#### TOT interface



※TOT counts up accumulated and non-resettable.

### 2. RPM function

View RPM in interface  
Engine on



OR

View RPM in interface  
Engine off



Short press  
M button

View MAX RPM  
MAX RPM blink



Long press  
M button 2S

MAX RPM reset to 0



Short press  
M button

View stroke



Long press  
M button 2S

Stroke blink



- a) Press **M** to add, press **S** to min. us.  
 b) Stroke mode in turns: 1P1R, 2P1R, 3P1R, 4P1R, 6P1R, 8P1R, 3P2R, 5P2R, 1P2R.  
 c) Long press **M** + **S** button together, then 2S to save and exit the setting.

### 3. Partial timer: JOB, JOB1.

#### JOB interface



Long press  
M button 2S

#### JOB1 interface



Short press  
M button

JOB time reset to 0



Long press  
M button 2S

JOB1 time reset to 0



### 4. SVC time: SVC, SVC1

- 1 Work method: countdown.
- 2 When SVC time counts down to 0, SVC alert begins.
- 3 When SVC set to 0, SVC interface will not be main interface to display all the time. Interface will return to TOT interface automatically. When SVC alert begins, press any button to reset it.

#### SVC interface



Long press  
M button 2S

#### SVC1 interface



**M** Increase



**S** Decrease



**M** + **S** Switch the setting digit



a) Setting Range: 00000-99999.

b) Long press **M** + **S** button together 2S to save and exit the setting.

※The interface operations for SVC2 are same as above.

## 7 Specification & Parameter

|                      |   |
|----------------------|---|
| Total hour range     | 99999H  |
| SVC range            | 99999H  |
| Timing tolerance     | <± 0.01%  |
| Timing accuracy      | 0-999.59 for 1min<br>1000.0-9999.9H for 0.1H<br>10000-99999H for 1H |
| Partial hour range   | 9999.9H   |
| Battery type         | CR2430  |
| Battery capacity     | 270mAh  |
| Housing material     | ABS   |
| Waterproof level     | IP68  |
| Display windows size | 28x13mm   |
| Product weight       | 88g   |
| Dimension            | 54.7x38.5x14.5mm  |

## 8 Trouble shooting

| Problems   | Possible reason  | Solution   |
|--|--|--|
| No display on screen   | 1.The battery is dead.   | 1.Replace to new product. (HM020R) .<br>2.Replace the product.   |
| Time no change or not accurate after 6 minutes or RPM is not accurate. | 1.Sensing line loose or wrapped less cycles.<br>2.Wire may damaged.<br>3.Stroke type setting is incorrect. | 1.Tighten or wrap more cycles.<br>2.Repair or change cable.  |
| LCD no change  | The meter crash.   | 1.Replace the product.<br>2.Replace to new product.  |
| Unclear display on LCD or color changed.                               | 1.Wrong angle of the product.<br>2.Direct sunlight for a long time.<br>3.Low battery.                      | 1.Adjust the angle.<br>2.Put the hour meter in the shade.<br>3.Replace to new product.<br>4.Replace the product. |

LATNEX® Canada-EMR Shielding Solutions Inc.

URL: [www.latnex.com](http://www.latnex.com) Email: [info@latnex.com](mailto:info@latnex.com)

Address: 399 Four Valley Drive Unit 13 Concord Ontario L4K 5Y8 Canada

Canada Tel: 416-583-2005

USA Tel: 310-746-3686



HM-R020