

# ECOFLOW

## User Manual

### R600 PRO KIT



**Contact us:**  
[support@ecoflow.com](mailto:support@ecoflow.com)  
[www.ecoflow.com](http://www.ecoflow.com)



1. Keep the product dry and away from fire.
2. Never disassemble, puncture, shock, crash, or incinerate the product.
3. Recycle and dispose of the product in accordance with the local regulations.
4. Avoid short circuit during use, otherwise the product will be damaged.
5. The installation and use of the product is only suitable for professionals who are familiar with the characteristics of external batteries such as lead-acid and lithium iron phosphate batteries.

# Features of PRO KIT

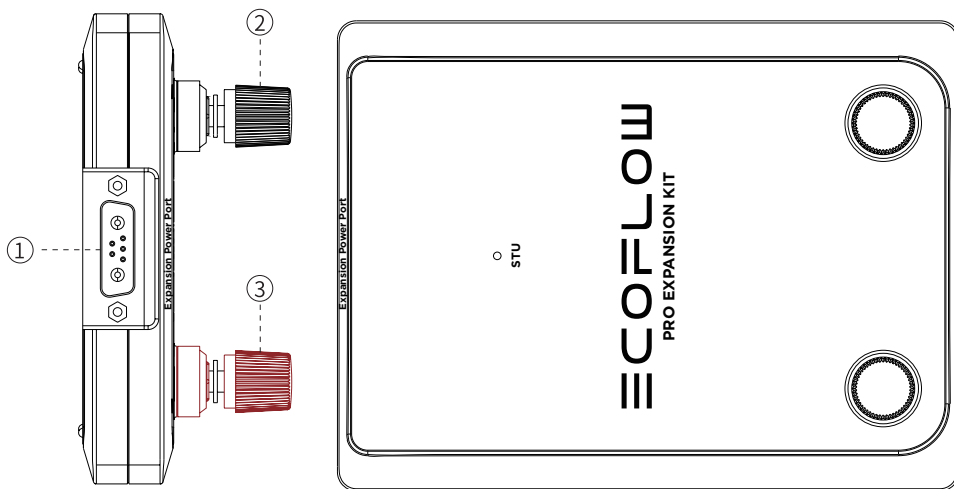

## 1. Expansion Power Port

This port is used for connecting the R600 PRO and PRO KIT with the expansion power cable. The firmware of PRO KIT can be upgraded when connected to R600 PRO. When connecting with the external battery, the maximum current and output are 8A (charging) and 750W (discharging) respectively.

## 2 & 3. 24V-/24V+ M6 Port

This set of terminals is used for connecting the external 24V lead-acid battery or 24V lithium iron phosphate battery to expand the capacity of R600 PRO. Please make sure the positive and negative terminals are connected with the external battery correctly, otherwise the PRO KIT might be damaged.

# 24V External Battery Installation

Please follow the steps below for installation. Ensure that the external battery is correctly connected with PRO KIT. Make sure the R600 PRO is turned off before connecting the R600 PRO and PRO KIT. Otherwise, PRO KIT will be damaged.

1. Remove the two expansion port screws on the lead-acid battery as shown in the figure ①. Then connect the black OT terminal cable to the black negative terminal, and red OT terminal cable to the red positive terminal.
2. Unscrew the two expansion port screws of the PRO KIT as shown in the figure ②, then connect the black OT terminal cable to the black negative terminal and the red OT terminal cable to the red positive terminal. Make sure that the black one is connected first, and then connect the red one.

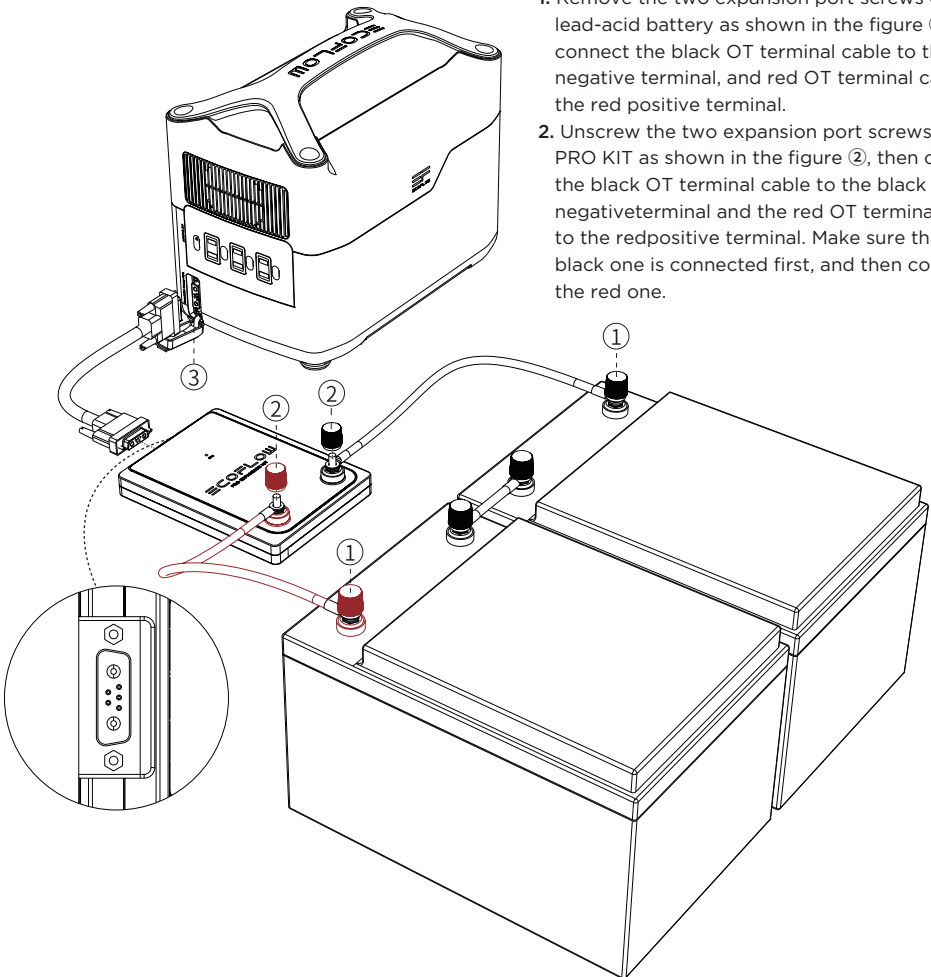

3. Remove the expansion power port cover of the R600 PRO as shown in the figure ③ and connect it to the expansion power cable, then connect the cable to the expansion power port of the PRO KIT.

## APP Settings

The default charging voltage of the device is 26-27V. Under this setting, the battery will not be fully charged. Users will need to select the battery type and fill in the under-voltage value, over-voltage value and max capacity on the APP manually before use. If two pieces of 12V are connected in series, for example, two sets of 12V lead-acid batteries with following specifications:

- Highest charging voltage: 13.6V
- Lowest discharging voltage: 10.5V
- Capacity: 200Ah

Then when you connect the two batteries in series, the specifications to fill in the APP will be:

- Over-voltage value:** 27.2V
- Under-voltage value:** 21V
- Maximum capacity:** 200Ah

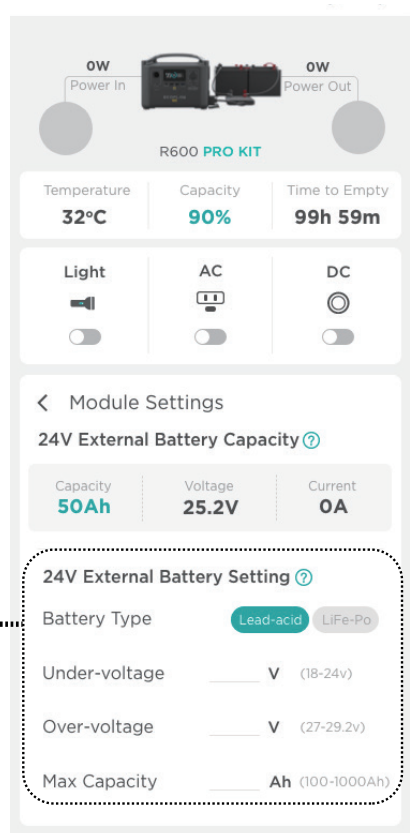

## Recommended Battery Type

Voltage Range	24-29.2Vdc
Maximum Discharge Current	30A Max
Charging Voltage	Default 26V-27Vdc 8A Max(Charging voltage could be adjusted on APP)
Cell Type	24V lead-acid battery ( $\geq 200\text{Ah}$ ) / 24V lithium iron phosphate battery
Discharge Temperature	14-140°F +/-5°F(-10-60°C +/-3°C)
Charging Temperature	32-113°F +/-5°F(0-45°C +/-3°C)

**\* Note:**

1. PRO KIT will manage and reserve some capacity of the lead-acid batteries to ensure that it will not be damaged. The reserved capacity percentage could be adjusted on APP. The default setting will be 30% or higher.
2. It is recommended to use a lead-acid battery 200Ah, discharge rate  $> 0.3C$ , and the battery voltage can still reach up to 20V under 900W load. A 100Ah cell may only be able to discharge 20% of its capacity depending on the load. Small loads can release more capacity.
3. If you use the 24V lithium iron phosphate battery, make sure the battery has its own BMS to ensure that its cells will not be overcharged or overdischarged.
4. If the voltage of the solar panel is higher than the voltage of the external battery, PRO KIT cannot be charged through solar power. Users will need to charge the units by the AC input port of R600 PRO.
5. The temperature protection will be triggered if the battery voltage is too low and after long-term heavy load discharge. Please place it in a well-ventilated place and after temperature protection, and wait for the product to cool down to use it again.

## What's in the Box?

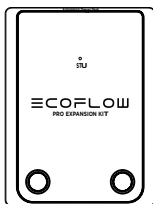

**R600 PRO KIT**

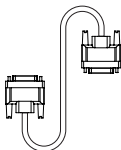

**1.5m Expansion  
Power Cable**

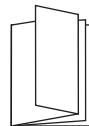

**User Manual and  
Warranty Card**