



## Install Guide

Fits All Yamaha  
Jet Boats 1998-Current

### Hardware Kit Contents Tools Needed For Install Included In This Kit

Hardware Kit Contents	Tools Needed For Install	Included In This Kit
A: Port Side Pivot Bolt Assembly	Ratchet	2 Left Fins (1 Single Engine)
B: Starboard Side Pivot Bolt Assy	10mm Socket	1 Cut Away Fin (1 Single Engine)
C: Anode Relocate Bracket & Screws	12mm Socket	2 Right Fins (1 Single Engine)
D: Medium Blue Thread Locker	11mm Socket	2 Actuators (1 Single Engine)
E: 5/8" Socket Cap	10mm Wrench	1 Hardware Kit (Half Kit For Single)
F: 5/16" Socket Cap	11mm Wrench	
G: Cross Tie	Cordless Drill (Optional)	
H: Steering Cable Clevis Bolt	M8 x 1.25 Tap (Optional)	
I: KickStand With Mount Hardware	5MM, 1/8", 3/32" Allen Wrenches (Supplied)	



Twin Engine Articulating Keel Models Use Cut Away Fin On Starboard Motor.  
Non-Articulating Keel Models Use Standard Fins.

## Preparation

1. Remove the safety lanyard & push your throttle lever(s) to full throttle position.
2. Remove reverse gate pivot bolts with 12mm socket.
3. Remove steering cable clevis with 11mm socket and wrench.
4. Remove anode with 10mm socket.

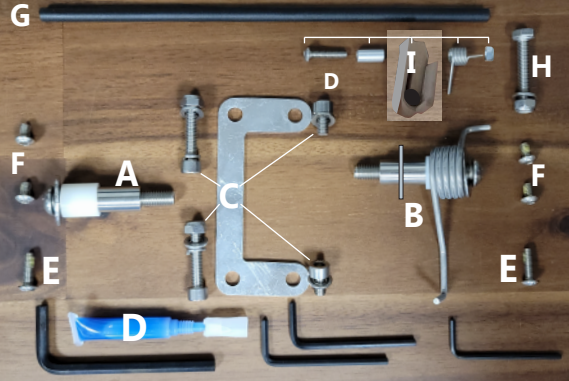

## Installation

- 1: Assemble factory anode w/anode relocate bracket (C) using long bolts and nylocks provided. Install the assembly to the jet pump using 10mm bolt/washers. **Ensure you liberally apply blue thread locker to all threads on 10mm bolts.** This will minimize corrosion & prevent loosening of bolts over time.



**PRO TIP:** If you have an M8 x 1.25 (image 2) clean all the reverse bucket pivot point threads of residual thread locker.

- 3: Install left side Thrust Vector fin using Port Side Pivot Bolt Assy (A) as shown in image 3. **It is critical to liberally coat all exposed threads with blue thread locker.** This will help prevent corrosion as well as prevent the bolt from loosening. Tighten bolt with 5mm allen wrench (supplied).

**NOTE:** Twin Engine Articulating Keel equipped boats use cut away left side fin. Non- AK boats use standard left side fin.

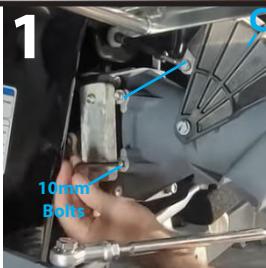

- 4: Install right side Thrust Vector fin using starboard side pivot bolt assy (B) as shown in image 5. **It is critical to liberally coat all exposed threads w/blue thread locker.** **PRO TIP:** To aid in setting spring tension thread only about 3 pivot bolt threads into deflector nozzle.

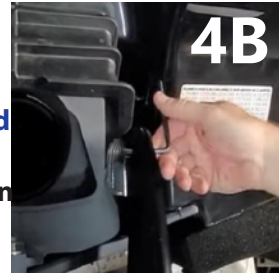

Rotate entire fin forward around steering arm. Next rotate spring leg to front side of steering arm. Rotate fin rearward and rest edge of fin against steering arm. Tighten mount bolt securely using supplied 5mm allen wrench.



- 5: Assemble KickStand to right side fin. Insert spring and sleeve into kickstand body. Place kickstand body against inside edge of fin, being careful to locate spring leg inside spring hole. Pass 8-32 screw through hole as shown and add nylock nut using supplied

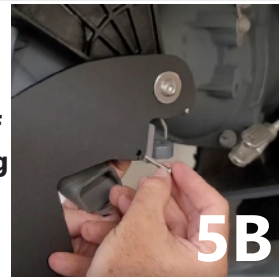

wrench and 9mm wrench. Tighten nut but ensure kickstand pivots freely.

- 6: Install new steering cable clevis bolt as shown in image 6. Use 10mm wrench and socket to tighten. Ensure nut is on top and head of bolt is on bottom. This allows you to remove the nozzle in the future without having to remove the Thrust Vector system. Do not crush clevis by overtightening. Look for approx 2 threads exposed on top of nut for ideal assembly.



- 7: Last, complete your install by adding the actuator as shown in image 7. You'll add 4, 10-32 x 5/16" screws in the top 4 holes plus 2, 10-32 x 5/8" screws to attach the 8.5" long cross tie. Use supplied 1/8" allen wrenches to complete this step. While installing the cross tie you'll use both wrenches simultaneously.



Test by lifting the fins. Ensure there is no binding. Repeat these steps on the second nozzle if applicable.

# DONE!