

















**Operating and maintenance instructions for:**

**Push trolley L87-106  
Gear type trolley L87-107**



## Security warnings

				
<p>1. Read before use!</p>	<p>2. Do not overload!</p>	<p>3. Do not work under a load!</p>	<p>4. Never pull the chain over an arris!</p>	<p>5. Never work with a damaged hoist!</p>
				
<p>6. Never lift human with this hoist!</p>	<p>7. Never throw the hoist</p>	<p>8. Do not wrap the load chain around the load</p>	<p>9. Never lengthen the lever</p>	<p>10. Never work up to the end of chain</p>
				
<p>11. Never attach the load on the tip of the hook!</p>	<p>12. Never work with a twisted or broken chain!</p>	<p>13. Never work without a safety latch!</p>	<p>14. Never remove the warning notice</p>	

## **Manual Instruction for:**

### **PLANETA - Gear (L87) & PLANETA - Push (L87) travel trolleys**

#### **I. PLANETA - Gear (L87) & PLANETA - Push (L87) travel trolleys**

1. The PLANETA trolleys are deliverable from 500 kg to 20 t.
2. The push travel trolley comprises 2 sideplates, on with the wheels with bearings are fitted, a threaded shaft with nuts, a hanger plate with suspension eye for the hoist, as well as spacers/ washers for the adjustable span.
3. The gear travel trolley has one sideplate fitted with a handchain-wheel, two geared wheels and a pinion for mechanical movement of the trolley, whilst all other parts are as for push trolley.

#### **II. Important indications**

1. Read instruction and make it available to operators on the device before using it.
2. Operator must be instructed properly with the device. Never leave the device under load unattended!
3. Never exceed carrying capacity indicated on the name plate. Do not draw any pull and lifting ropes or chains respectively over angles.
4. Do not transport persons or loads with the product over areas below which persons could be staying.
5. Device must be checked once a year by a technical expert, in case of harder operating conditions more often. Ask your retailer or PLANETA. The enterpriser is liable in case of damages and has to provide test certificates.
6. Check the device regarding damages, unfastened screws or twists before using it and eliminate failures.
7. Repair works on PLANETA hoisting devices shall only be carried out by the manufacturer or an instructed repair shop respectively by using PLANETA spare parts.
8. Check load carrying constructions, load securing devices, mountings, cross beams etc. regarding load carrying capacity and condition of the required loads by a technical expert.
9. Non-observance of the instruction, improper use, and corrosion by insufficient protection or product alterations without authority result in the expiry of the warranty.
10. Risk of corrosion in case of continuous contact with unfavourable atmospheric conditions as for example high humidity or harmful environmental influences as for example atmospheres with acid vapours, corrosive gases or high dust concentration cause early wear. This effectuates no claim under warranty.
11. Further information or spare part lists will kindly be provided by us or your specialist dealer.

#### **III. Assembly advices before initiation+ Operation**

1. Before installing the trolley, the wheel span needs to be set to that of the beam flange.
2. Ensure that the hanger plate is central to the two sideplates by fitting spacer washers accordingly.
3. When a clearance of 1-1.5 mm has been achieved between the wheels and the flange, the trolley can be installed on the beam and the nuts fastened and secured by the split pin.
4. Ensure that endstops are fitted to the runway, so that the trolley cannot run off.
5. Before applying a load to the trolley, make a test-run to be sure it runs smoothly back and forth along the entire runway.
6. The hoist may now be hooked on and the combination put into operation.

#### **IV. Maintenance and inspection**

The trolley is maintenance free.

# Spare parts

## PLANETA - Gear (L87-106) & PLANETA - Push (L87) travel trolleys

### Plain Trolley

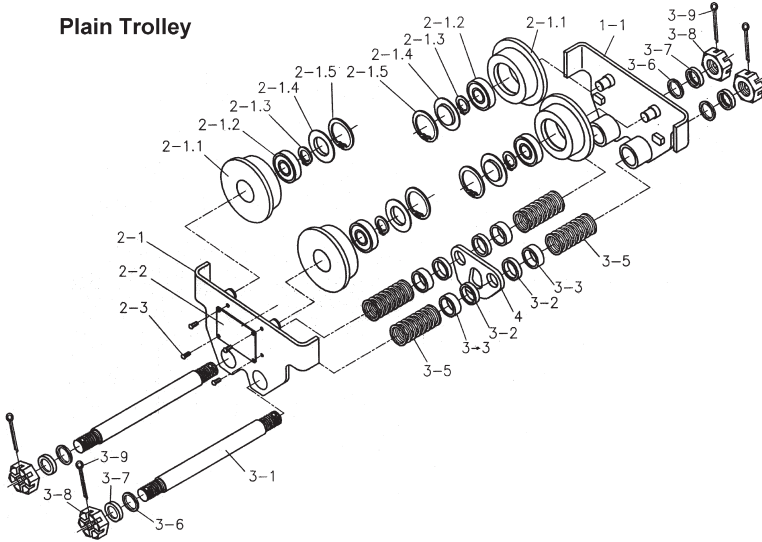

### Geared Trolley

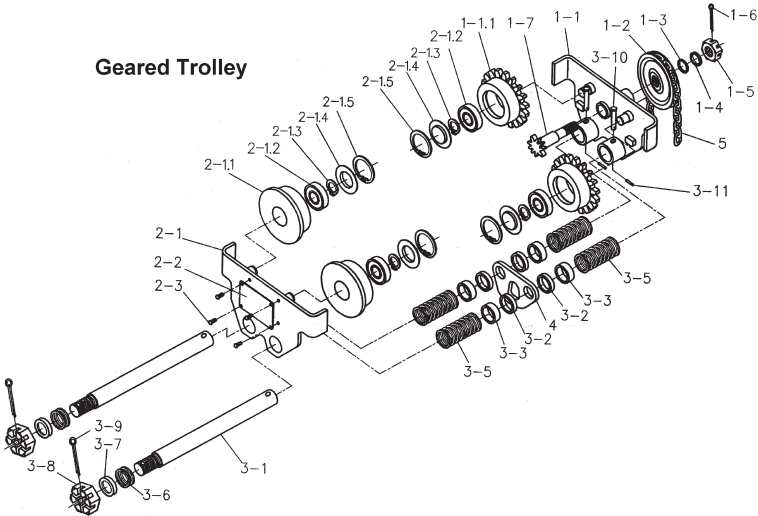

## Spare parts

### PLANETA - Gear (L87) & PLANETA - Push (L87) travel trolleys

#### Spare Parts for L87 Geared Trolley

Assembly Name	No.	Part Name	No.	Qty./PC
<b>Right Plate Assembly</b>	1	Right Plate	1-1	1
		Driven Wheel	1-1.1	2
		Ball Bearing GB/T276-94	2-1.2	2 (0.5T~3T) 4 (5T/8T/10T)
		Snap Ring GB894.1-86	2-1.3	2
		Bearing Cover	2-1.4	2
		Snap Ring GB893.1-86	2-1.5	2
		Hand Wheel	1-2	1
		Plain Washer GB97.1-86	1-3	1
		Spring Washer GB859-86	1-4	1
		Thin Castle Nut GB6181-86	1-5	1
		Split Pin GB91-86	1-6	1
<b>Left Plate Assembly</b>	2	Driving Shaft	1-7	1
		Left Plate	2-1	1
		Driven Wheel	2-1.1	2
		Ball Bearing GB/T276-94	2-1.2	2 (0.5T~3T) 4 (5T/8T/10T)
		Snap Ring GB894.1-86	2-1.3	2
		Bearing Cover	2-1.4	2
		Snap Ring GB893.1-86	2-1.5	2
		Name Plate	2-2	1
Rivet 2x6 GB827-86	2-3	4		
<b>Hanger Shaft Assembly</b> (0.5T: M=50~152) (1T: M=64~203) (1.5T: M=74~203) (2T: M=88~203) (3T: M=100~203) (5T: M=114~203) (8T: M=124~203) (10T: M=124~203)	3	Hanger Shaft	3-1	2
		Short Bushing	3-2	4
		Bushing	3-3	4
		Adjusting Washer	3-5	24 (0.5T/3T) 32 (1T/1.5T/2T) 28 (5T/8T/10T)
		Thin Adjusting Washer	3-6	4
		Step Washer	3-7	2
		Castle Nut	3-8	2
		Split Pin GB91-86	3-9	2
		Tight Pin	3-10	2
		Spring Pin GB879-86	3-11	2
		<b>Hanger Plate</b>	4	
<b>Hand Chain</b>	5			1

## Spare parts

### PLANETA - Gear (L87) & PLANETA - Push (L87) travel trolleys

#### Spare Parts for L87 Plain Trolley

Assembly Name	No.	Part Name	No.	Qty./PC	
<b>Right Plate Assembly</b>	1	Right Plate	1-1	1	
		Driven Wheel	2-1.1	2	
		Ball Bearing GB/T276-94	2-1.2	2 (0.5T~3T)	
				4 (5T/8T/10T)	
		Snap Ring GB894.1-86	2-1.3	2	
		Bearing Cover	2-1.4	2	
Snap Ring GB893.1-86	2-1.5	2			
<b>Left Plate Assembly</b>	2	Left Plate	2-1	1	
		Driven Wheel	2-1.1	2	
		Ball Bearing GB/T276-94	2-1.2	2 (0.5T~3T)	
				4 (5T/8T/10T)	
		Snap Ring GB894.1-86	2-1.3	2	
		Bearing Cover	2-1.4	2	
		Snap Ring GB893.1-86	2-1.5	2	
		Name Plate	2-2	1	
Rivet 2x6 GB827-86	2-3	4			
<b>Hanger Shaft Assembly</b> (0.5T: M=50~152) (1T: M=64~203) (1.5T: M=74~203) (2T: M=88~203) (3T: M=100~203) (5T: M=114~203) (8T: M=124~203) (10T: M=124~203)	3	Hanger Shaft	3-1	2	
		Short Bushing	3-2	4	
		Bushing	3-3	4	
		Adjusting Washer	3-5	24(0.5T)	
				32(1T/1.5T)	
				28(2T/3T/5T/8T/10T)	
		Thin Adjusting Washer	3-6	4	
		Step Washer	3-7	4	
		Castle Nut	3-8	4	
Split Pin GB91-86	3-9	4			
<b>Hanger Plate</b>	4			1	

# Test Certificate

**Order Number:** .....

**Order Date:** .....

**Type:** .....

**Capacity:** .....

**Serial Number:** .....

- has satisfactorily operated with overload of 50 % in the test stand.  
A certificate from rope is available.

**Date:** .....

**Expert** .....

## Annual inspections

**The aforementioned trolley was again inspected:**

Test date	Kind of test	Name/Signature	Test result
_____	_____	_____	_____
_____	_____	_____	_____
_____	_____	_____	_____
_____	_____	_____	_____
_____	_____	_____	_____
_____	_____	_____	_____
_____	_____	_____	_____
_____	_____	_____	_____
_____	_____	_____	_____
_____	_____	_____	_____

# EC INSTALLATION DECLARATION

Declaration for the installation of an incomplete machine according to EC directives 2006/42/EC, Addendum II B, 2004/108/EC, Addendum I and 2006/95/EC, Addendum III

We,

**PLANETA-Hebetechnik GmbH, Resser Str. 17, D-44653 Herne**

hereby declare that the incomplete machine

**Push trolley hoist,  
in payload range**                      **Type L87-106  
500 kg - 5.000 kg**

**Gear type trolley hoist,  
in payload range**                      **Type L87-107  
500 kg - 20.000 kg**

which was developed for lifting and lowering of loads, in the standard version, including load capacity control, is intended for installation in a machine and meets the basic requirements for the following EC directives, as applicable for the delivered scope:

## **EC Machine directive 2006/42/EC**

In addition, we declare that the technical documentation has been created according to addendum VII Part B of the directive 2006/42/EC. We commit to supply the special documentation of the hoist gear to the individual national agencies upon justified request. The transmission will be made electronically.

This declaration applies only to the hoist gear. Commissioning is prohibited until it has been established that the crane, in which the hoist gear is installed, meets the regulations of the above stated EC directives.

### **Authorized for the compilation of the relevant technical documentation:**

**PLANETA-Hebetechnik GmbH, Resser Str. 17, D-44653 Herne**

Herne, 30.12.2009

**PLANETA-Hebetechnik GmbH**

For the completion, installation and commissioning according to the operating instructions is responsible:

Location: ..... Date: .....

Person in charge: .....

Company: .....